

LATITUDE 39° 37' 30"

LONGITUDE 88° 27' 30"

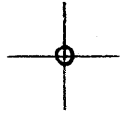

7'5 OGIS topo location

7.5' loc 1.41 S 15' loc _____
 2.08 W (calc.) _____

Company _____

Farm _____

Quad GLOVER GAP 7 1/2'

County WETZEL

District GRANT

WELL LOCATION MAP

File No. 103-0670

(047)

HOPE NATURAL GAS COMPANY.

LOCATION FOR WELL No. 575.....

Littleton..... DISTRICT

B. L. Morgan..... Farm, on waters of Willey Fork

Grant..... District, Wetzel..... County, West Virginia.

Case No. 328..... Acres 141..... N. 11..... S. ~~.....~~ E. 8..... W. ~~.....~~

Scale, one inch equals 80 Poles..... Sent to..... 1.....

Location to be.....

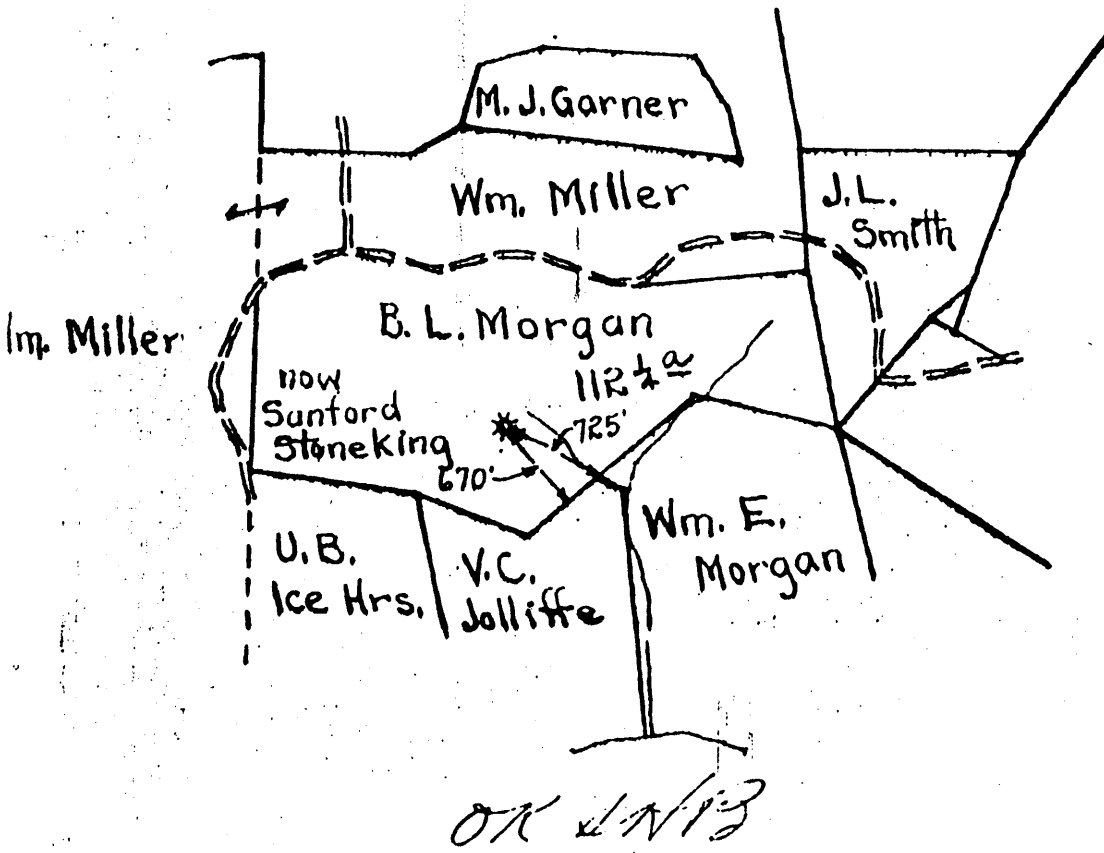

APR 103-0676

Bk 146, Pg 21.

RESERVE.....

SPECIAL INSTRUCTIONS.....

Location ~~meas.~~ 5-14-1914 by O.C. Straight As per plat, except as noted. On field map

..... 1..... Returned to Pittsburgh..... 1.....

Location changed on account of.....

Authorized by..... Date..... 1..... Signed.....

WELL RECORD

A. L. Morgan

Line *grove* District *Wetzel*
Farm *146* Acres
County *W. Va.* State

Well No. *575*

Rig Commenced 100

Rig Completed 100

Drilling Commenced *June 20* 100 *4.*

Drilling Completed *July 22* 100 *4.*

Schaffner Bros. Contractor.

LITHOLOGICAL FORMATION.	TOP.	BOTTOM.	REMARKS.
Conductor		11 ft.	
Maple town Coal	665		
Put in Coal	765		
Big Dunkard.	1245	1285	
Black Sand	1310	1325	
Gas Sand	1405	1441	
Salt Sand.	1525	1544	
1st gas	1530		
2nd gas	1535		
Total Depth		1544	
Test. 80/100 water This 8 1/4" casing. 5 lb. Hyd. This 4" opening.			

CASING RECORD.

Size	Charged to Well.		Put in Well.		Pulled Out.		Left in Well.		Transferred Before Completion.		Left at Well, Not in Use.	
	Feet	In	Feet	In	Feet	In	Feet	In	Feet	In	Feet	In
13	65		65									
10	1144		1144									
8 1/4	1570		1570									

Production }
 First 24 hours } Bbls.

Approved by

J. D. Wallace Supt.

NOTE.—Sum of three right hand columns equals first or "Charged to Well."
 Use as many sheets as necessary to make a complete record.
 In making out this record please use copying ink or an indelible pencil.

ART-103-0670