

LATITUDE 39° 35' 00"

LONGITUDE 80° 34' 30"

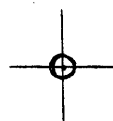

7'5 OGIS topo location

7.5' loc 1.34 S 15' loc _____
' 1.07 W (calc.) _____

Company _____

Farm _____

Quad PINE GROVE 7 1/2'

County WETZEL

District GRANT

WELL LOCATION MAP

File No. 103-0662

(1041)

LOCATION FOR WELL No. 304

PINE GROVE DISTRICT.

On *M N Hoge* Farm, on waters of *Lower Run of Fishing Ck.*
Grant District, *Wetzel* County, West Virginia.

Lease No. *432* Acres *532* Range: N. *9* S. *-* E. *-* W. *1*

Scale: *1"=800'* Made *Jan-29 1909*

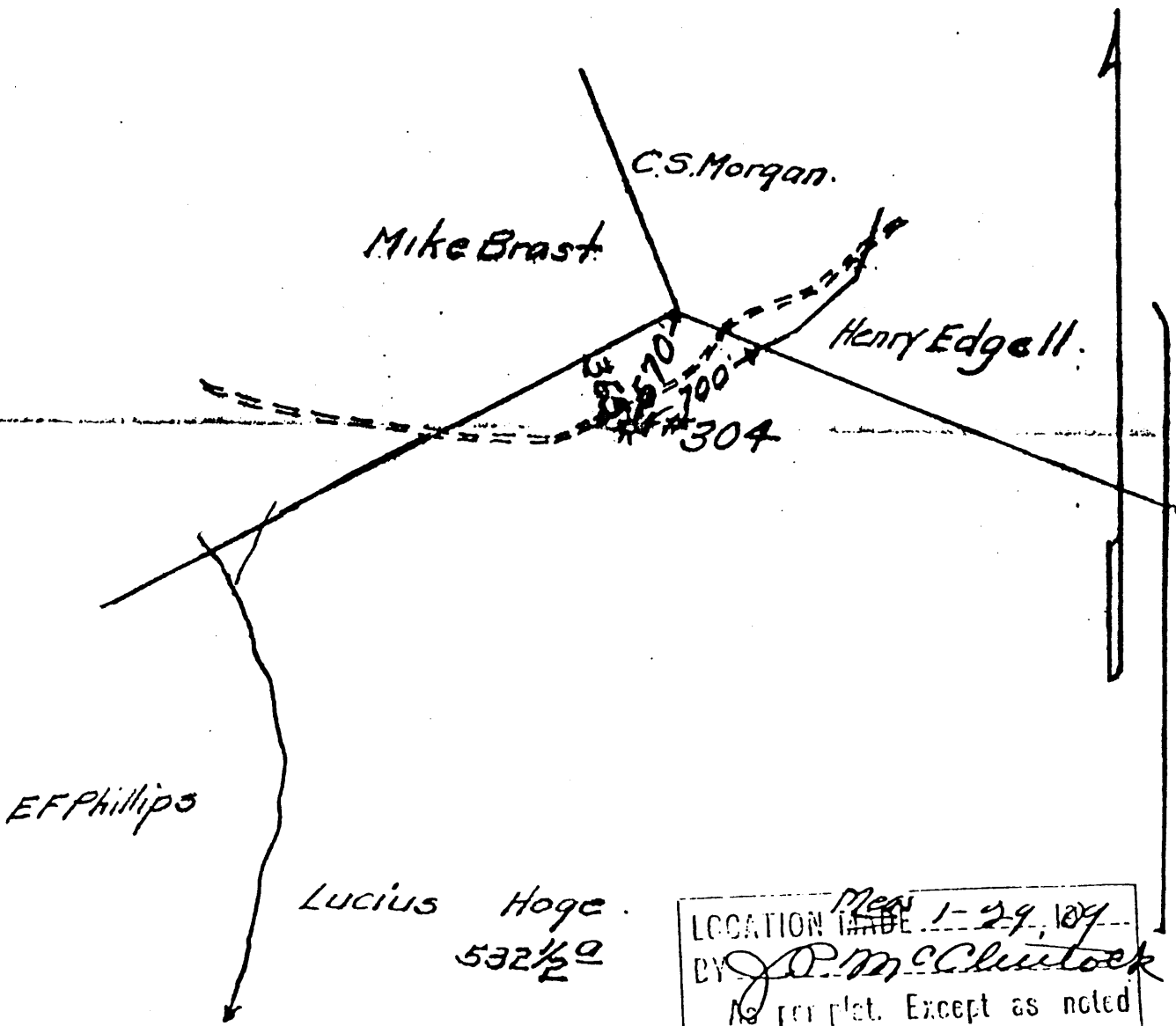

Lucius Hoge
532 1/2

LOCATION MADE *Jan 1-29, 1909*
 BY *J. P. McClintock*
 No per plat. Except as noted
 On Field map 19
 Returned to Pittsburg 19

ENTERED
 LINE MAP
23 1909
 BY *C & S*

ENTERED
 WELL BOOK
 LEASE RECORD
 LEASE DOCKET
 WALL MAP
 WORKING MAP
 LOCATION BOOK

RESERVE:

API # - 103-0662

SPECIAL INSTRUCTIONS:

WELL RECORD.

WVA

LOCATION FOR WELL No. 304

Grant District *24* County *24 Va.* State
 Well No. *304* **PINE GROVE DISTRICT.**

Rig Commenced *1189*
 On *MN Hoge* Farm, on waters of *Lower Run of Fishing Ck.*
 Drilling Commenced *Jan 2 1903*
Grant District *24* County *West Virginia.* Contractor *Netzel*

Lease No. *432* BOOK FOR ACRES *532* Range: *9* N. *10* W. *1*

Scale <i>800'</i>	<i>650</i>	Made <i>5:2</i>	<i>Jan 29 1909</i>
Pittsburg Coal	<i>1115</i>	<i>1117</i>	
Big Tujun	<i>2373</i>	<i>2413</i>	
Stray	<i>3103</i>	<i>3207</i>	
Slate	<i>3209</i>	<i>3213</i>	
Gordon	<i>3213</i>	<i>3232</i>	
Total depths		<i>3232</i>	

Gas at 3215 Very little gas in top Stray C.S. Morgan.

Mike Brast
 Well shut in *March 1903*
 Test shows *45'* depth
 Well shut in *show 350'*

304

EF Phillips

Lucius Hoge
532 1/2

APT # 103-0662

LOCATION *Map 1-24 109*
 BY *J.P. McClintock*

CASING RECORD

Size	Charged to Well.		Put in Well.		Pulled Out.		On Hand Well.	Transferred Before Completion.	Left at Well Not in Use.
	Feet	In	Feet	In	Feet	In			
<i>10</i>	<i>678</i>		<i>580</i>		<i>580</i>				
<i>8 1/2</i>	<i>1933</i>		<i>1410</i>	<i>2</i>	<i>3610</i>	<i>1020</i>			
<i>6 3/4</i>	<i>2677</i>		<i>2021</i>		<i>2521</i>				
<i>5 3/8</i>	<i>672</i>								
RESERVE:	<i>98</i>								

ENTERED *678*
 WELL BOOK *1933*
 LEASE RECORD *156*
 WALL MAP *672*
 WORKING MAP *98*
 LOCATION BOOK

6" line pipe was hauled by mistake and 6 3/4 casing

Production First 24 hours _____ Bbls. Approved by *APT # - 103-0662*
J.B. Wallace, Supt.

SPECIAL INSTRUCTIONS:
 Proof - Sum of Three right hand columns equals First or "Charged to Well."
 many sheets as necessary to make a complete record.
 In this record please use copying ink or an indelible pencil.

ENT'D

Well No. F. E. D.

M. N. HOGU Far

District

N. 9 S. E. W. 1

REPAIRS

Commenced June 11, 1915.

Completed August 7, 1915.

CASING AND TUBING RECORD

36

Size	Amount in Well		Amount Pulled	Amount Put in Well	Amount Left in Well	Disposition of Amount Pulled
	Before Repairs	After Repairs				
6 1/2	2021	2021			2021	<p>ENTERED WELL BOOK SEP 27 1915 C.A.V. LEAD BOOK LEASE BOOK AUG 21 1915 J.O.T. WALL MAP LITH MAP LOCATION BOOK GYTHAOTERS PLAT CONTRACTOR</p>
5 1/2		3325.11		3325.11	3325.11	

VOLUME AND PRESSURE TEST

AUG 24 1915 H.H.S.

Before Repairs				Pressure		After Repairs			
Size Opening	Liquid Used	Reading	Rock or Minute	Pounds	Size Opening	Liquid Used	Reading	Rock or Minute	Pounds
3"	Mercury	10/10	Rock	140	2"	Mercury	15/10	Rock	120

Names of Drillers		Time (Days)	Names of Tool Dressers		Time (Days)
T. L. Dunlap,		10	E. M. Yohq,		0
H. W. Rooks,		27	W. L. Cross,		31
A. L. Simpson,		40	T. E. Cross,		60

If well is drilled deeper, insert below the record of deeper drilling

Formation	Top	Bottom	Formation	Top	Bottom
Drilled from	3232				
to		3298			
formation					
Total		3298			

SHOOTING RECORD

Date	Quarts	Top of Shell	Bottom of Shell	Diameter	Sand	Test Before Shot			Test After Shot			Test taken after shot No. Hours	By Whom Shot
						Reading	Liquid	Opening	Reading	Liquid	Opening		
6-10-15		3232	3223	4 1/2"	3325.11	6/10	Mer	2"	10/10	Mer	2"	3 hours	M.T. Co. by Clell

PACKER RECORD

Size	Kind	Amount Anchor	Amount Above Anchor
3 1/2"			

Tubing Record if Well Never Previously Tubed

Date Tubed	Size	Amount Put in Well
		NOT TUBED

Remarks: 3 1/2" casing set in for liner in four sections from bottom of hole to top of hole with 5' casing from top of liner to top of hole with 5' casing from top of hole to bottom joint. Top perforation 3221'4" to 3222' length of second section 229'10" length of top section 183'

NOTE--Whenever a well is shot, tubed, drilled deeper or in any way repaired, fill out this report so far as it relates to work done and mail promptly.

1511.300-12

Foreman

Wet-662