

Hope Natural Gas Co.

LOCATION FOR WELL No. 18

Pine Grove DISTRICT.

On D H Cox Farm, on waters of Upper Run  
Grant District, Wetzel County, West Virginia.

Lease No. 528 Acres Range: N 8 S E W 1

Scale 1"=800' Made Feb. 4. 1909

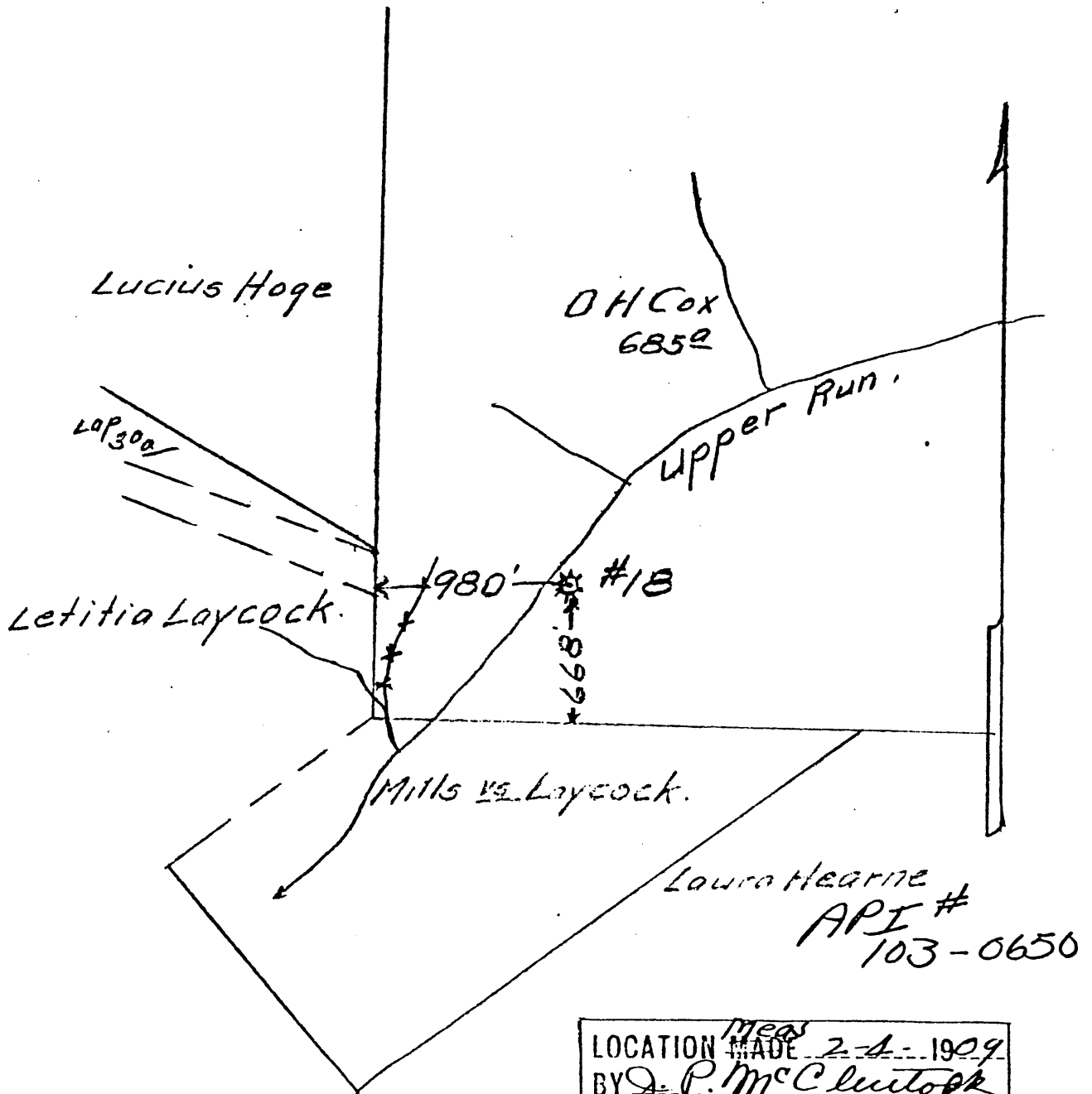

RESERVE:.....

SPECIAL INSTRUCTIONS:.....

LATITUDE 39° 35' 00"

03, 48, 08 LONGITUDE

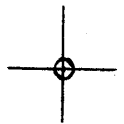

7'5 OGIS topo location

7.5' 10c	<u>2.34 S</u>	15' 10c	<u>2.34 S</u>
	<u>0.38 W</u>	(calc.)	<u>2.60 W</u>

Company \_\_\_\_\_

Farm \_\_\_\_\_

Quad PINE GROVE 7 1/2' <sup>Littleton SC</sup>

County WETZEL

District GRANT

WELL LOCATION MAP

File No. 103 - 650

(041)

Well No. 2 Farm, \_\_\_\_\_ Acres.  
 Grant District Wright County \_\_\_\_\_ State.



Rig Commenced Sept 23 1897 } Emery Contractor.  
 Rig Completed " 28 1897 }  
 Drilling Commenced Oct 10 1897 } Geo J. Gale Contractor.  
 Drilling Completed Dec 18 1897 }

FORMATION.	TOP.	REMARKS.	BOTTOM.
Condr.	16		
<del>10" " "</del>	<del>50</del>		
8 1/4 " "	1056		
6 1/8 " "	1558		
5 3/16 " "	2100		
1/4 Coal	535		540
Dark Sand	1050		1100
Saltr "	1350		1550
Little Lime	1650		1690
Panel Cave	1690		1700
Big Lime	1700		1750
" Dryum	1750		1990
Red Rock	2400		2500
Gordon	2595		
1st L. "	2630		
2d " "	2630		
Total Depth			2640

NOTE: A good record must show the formation from top to bottom of well.

103-0650  
API #