

Honorable Central Gas Co.

LOCATION FOR WELL No. 16

Pine Grove DISTRICT.

On J. U. Morgan Farm, on waters of Fishing Creek

Grant District, Wetzel County, West Virginia.

Lease No. 394 Acres Range: N. 9 S. — E. — W. 3

Scale 1" = 800' Made 10-28-1908

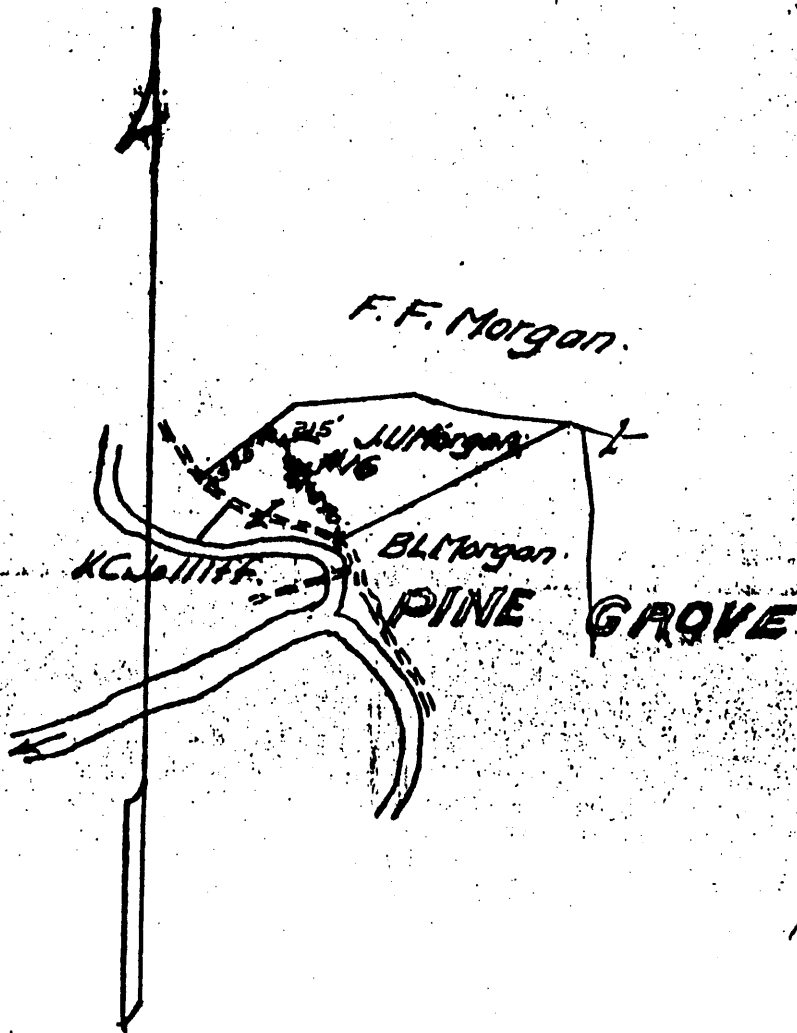

ENTERED
 LINE MAP
 1-11-10
 BY *[Signature]*

API - 103-0649

LOCATION ^{Map} MADE 10-28-1908
 BY J. P. McClutcher
 \$s per plat. Except as noted
 On field map 19
 Returned to Pittsburg 19

WELL LOG
LEASE RECORD
LEASE DOCKET
WELL MAP
WORKING MAP
LOCATION BOOK

RESERVE:

SPECIAL INSTRUCTIONS:

LATITUDE 39° 35' 00"

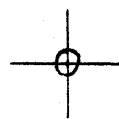

LONGITUDE 88° 40' 00"

7'5 OGIS topo location

7.5' loc 1.115 15' loc _____
0.67W (calc.) _____

Company _____

Farm _____

Quad PINE GROVE 7 1/2'

County WETZEL

District GRANT

WELL LOCATION MAP

File No. 103 - 0649

(035)

API - 103-0649

16

WELL NO.	COUNTY	LOCALITY	LOCATED	COMMENCED	COMPLETED	FACTORY	PURCHASED FROM	DATE PURCHASED	DATE SHOT IN	DATE CONNECTED	DATE TUNED ON	DATE RE-DRILLED	DATE RE-CONCRETED	DATE TO	DATE TO	DATE TO	DATE TO	DATE TO	DATE TO	DATE TO	DATE TO	DATE TO	VOLUME AND PRESSURE TESTS						SHOOTING		INITIAL OIL PRODUCTION				
																							FORMATION	TOP	BOTTOM	OIL AT	GAS AT	WATER AT	FRESH OR SALT	SIZE	PWT IN WELL	PULLED	DATE	BARRELS	DATE
102	Osage	Osage	1900	May 19, 1900	July 11, 1900	Smith	Smith			Aug 20, 1903	Sept 1, 1903												3"	11'	280	290	135	140	110	5,897,646	Osage	30	364	431,000	577,000
103	Osage	Osage	1900	May 19, 1900	July 11, 1900	Smith	Smith			Aug 20, 1903	Sept 1, 1903												3"	11'	180	190	135	140	110	1,250,648	Osage	30	364	431,000	577,000
104	Osage	Osage	1900	May 19, 1900	July 11, 1900	Smith	Smith			Aug 20, 1903	Sept 1, 1903												3"	11'	150	160	135	140	110	481,040	Osage	30	364	431,000	577,000
105	Osage	Osage	1900	May 19, 1900	July 11, 1900	Smith	Smith			Aug 20, 1903	Sept 1, 1903												3"	11'	145	155	135	140	110	577,570	Osage	30	364	431,000	577,000
106	Osage	Osage	1900	May 19, 1900	July 11, 1900	Smith	Smith			Aug 20, 1903	Sept 1, 1903												3"	11'	140	150	135	140	110	605,088	Osage	30	364	431,000	577,000
107	Osage	Osage	1900	May 19, 1900	July 11, 1900	Smith	Smith			Aug 20, 1903	Sept 1, 1903												3"	11'	140	150	135	140	110	537,600	Osage	30	364	431,000	577,000
108	Osage	Osage	1900	May 19, 1900	July 11, 1900	Smith	Smith			Aug 20, 1903	Sept 1, 1903												3"	11'	140	150	135	140	110	465,600	Osage	30	364	431,000	577,000
109	Osage	Osage	1900	May 19, 1900	July 11, 1900	Smith	Smith			Aug 20, 1903	Sept 1, 1903												3"	11'	140	150	135	140	110	330,720	Osage	30	364	431,000	577,000
110	Osage	Osage	1900	May 19, 1900	July 11, 1900	Smith	Smith			Aug 20, 1903	Sept 1, 1903												3"	11'	140	150	135	140	110	260,640	Osage	30	364	431,000	577,000
111	Osage	Osage	1900	May 19, 1900	July 11, 1900	Smith	Smith			Aug 20, 1903	Sept 1, 1903												3"	11'	140	150	135	140	110	218,130	Osage	30	364	431,000	577,000
112	Osage	Osage	1900	May 19, 1900	July 11, 1900	Smith	Smith			Aug 20, 1903	Sept 1, 1903												3"	11'	140	150	135	140	110	219,170	Osage	30	364	431,000	577,000
113	Osage	Osage	1900	May 19, 1900	July 11, 1900	Smith	Smith			Aug 20, 1903	Sept 1, 1903												3"	11'	140	150	135	140	110	243,120	Osage	30	364	431,000	577,000
114	Osage	Osage	1900	May 19, 1900	July 11, 1900	Smith	Smith			Aug 20, 1903	Sept 1, 1903												3"	11'	140	150	135	140	110	151,670	Osage	30	364	431,000	577,000
115	Osage	Osage	1900	May 19, 1900	July 11, 1900	Smith	Smith			Aug 20, 1903	Sept 1, 1903												3"	11'	140	150	135	140	110	97,970	Osage	30	364	431,000	577,000
116	Osage	Osage	1900	May 19, 1900	July 11, 1900	Smith	Smith			Aug 20, 1903	Sept 1, 1903												3"	11'	140	150	135	140	110	32,859	Osage	30	364	431,000	577,000

Hope Natural Gas Company

Report on Defective Well

Well No. 16
Name J. U. Morgan

ORIGINAL TEST

Date	Reading	Liquid	Opening	Hook	Sand	Date	Reading	Liquid	Opening	Hook	Sand
		no record				11/30/22	30/10				

Record of Casing and Tubing
 18 inch 2000 10 inch 364 8 inch 1011 6 inch 2110

Depth of Pittsburgh Coal 490 Original depth 2720
 Well Producing Gas from Stray Sands at depth 2554
 Well has made 2000 bbl. of Oil from 2000
 Amount of cavings in hole 2000 Amount of Water 2000
 Date well bailed out 9-23-20
 Date well 5/2/1911 30 atm Gordon 20/10-7

What should be done with well in my opinion: Well bailed out with bailing machine, and is now in good condition. Water only.

Date November 24th, 1922.

I would recommend OK as repaired

Approved: [Signature] By: [Signature]

Instructions from Pittsburgh office - Repair as per recommendation of Superintendent

Date DEC 8 1922