



STATE OF WEST VIRGINIA
DEPARTMENT OF MINES
OIL AND GAS DIVISION

This well originally plugged
under permit WET-451

NOTICE OF PROPOSED LOCATION OF OIL AND GAS WELL

To THE DEPARTMENT OF MINES,
Charleston, W. Va.

REDRILL

Everett F. Moore
COAL OPERATOR OR COAL OWNER
Moundsville
West Virginia
ADDRESS

THE MANUFACTURERS LIGHT AND HEAT CO.
NAME OF WELL OPERATOR
800 Union Trust Building
Pittsburgh, Pennsylvania
COMPLETE ADDRESS

COAL OPERATOR OR COAL OWNER
ADDRESS

August 21, 19 53
PROPOSED LOCATION
Proctor District

OWNER OF MINERAL RIGHTS
ADDRESS

Wetzel County
Well No. 1-1775 39° 45' 80° 40'
George & Mary Foland Farm

GENTLEMEN:

The undersigned well operator is entitled to drill upon the above named farm or tract of land for oil and gas, having fee title thereto, (or as the case may be) under grant or lease dated March 10, 1952, made by Mary Foland, Widow, to THE MANUFACTURERS LIGHT AND HEAT COMPANY, and recorded on the 17th day of April, 1952, in the office of the County Clerk for said County in Book 40, page 38.

The enclosed plat was prepared by a competent engineer and shows the proposed location of a well to be drilled for oil and gas by the undersigned well operator on the farm and in the Magisterial District and County above named, determined by survey and courses and distances from two permanent points, or land marks.

The undersigned well operator is informed and believes there are no coal operators operating beds of coal beneath said farm or tract of land on which said well is located, or within 500 feet of the boundaries of the same, who have mapped their workings and filed their maps as required by law, excepting the coal operators or coal owners (if any) above named as addressees.

The above named coal operators or coal owners (if any) are notified that any objections they may desire to make to such proposed location, or which they are required to make by Section 3 of said Code, if the drilling of a well at said proposed location will cause a dangerous condition in or about their respective coal mines, must be received by, or filed with the Department of Mines within ten* days from the receipt of a copy of this notice and accompanying plat by said Department. Said coal operators are further notified that forms for use in making such objections will be furnished to them by the Department of Mines promptly on request and that all such objections must set forth as definitely as is reasonably possible the ground or grounds on which such objections are based and indicate the direction and distance the proposed location should be moved to overcome same.

(The next paragraph is to be completed only in Department's copy.)

Copies of this notice and the enclosed plat were mailed by registered mail, or delivered to the above named coal operators or coal owners at their above shown respective address day before, or on the same day with the mailing or delivery of this copy to the Department of Mines at Charleston, West Virginia.

Very truly yours,

Paul D. Wood
ASST. LAND AGT. ~~WELLS OPERATOR~~

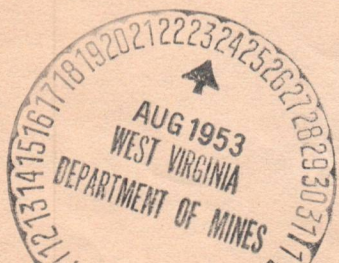

Address of Well Operator }

THE MANUFACTURERS LIGHT AND HEAT COMPANY
STREET
800 Union Trust Building
CITY OR TOWN 10/06/2023
Pittsburgh, Pennsylvania
STATE

*Section 3 If no such objections be filed or be found by the department of mines, within said period of ten days from the receipt of said notice and plat by the department of mines, to said proposed location, the department shall forthwith issue to the well operator a drilling permit reciting the filing of such plat, that no objections have been made by the coal operators to the location, or found thereto by the department, and that the same is approved and the well operator authorized to proceed to drill at said location.

387-Redrill

THE MANUFACTURING LIGHT AND HEAT CO.

Frederick W. Moore

300 Union Trust Building
Pittsburgh, Pennsylvania

Manufacturing
West Virginia

23

August 21,

Proctor

Weston

1-1178

George & Mary Toland

Miss Toland, widow

March 10, 1922

THE MANUFACTURING LIGHT AND HEAT COMPANY

April, 1922

23

O. S. G. No.

ASST. MGR. MANUFACTURING

THE MANUFACTURING LIGHT AND HEAT COMPANY

300 Union Trust Building

Pittsburgh, Pennsylvania

10/06/2023

A-10

September 3, 1953

The Manufacturers Light & Heat Company
800 Union Trust Building
Pittsburgh, Pennsylvania

Gentlemen:

Enclosed is permit WET-387-redrill for reopening Well No. 1-1775 on the George and Mary Poland Farm, Proctor District, Wetzel County. This well was abandoned under State Permit WET-451-Plugging.

Very truly yours,

Administrative Assistant
OIL AND GAS DIVISION

MG:g
encl

cc: Mr. D. F. Desist, Inspector
Mr. R. C. Tucker, Assistant State
Geologist

10/06/2023

A-12



THE MANUFACTURERS LIGHT AND HEAT COMPANY

800 UNION TRUST BUILDING

• PITTSBURGH 19 • PENNSYLVANIA

August 21, 1953

RE * Lease 26465, Well 1-1775
Proctor District
Wetzel County, West Virginia

Department of Mines
Oil and Gas Section
Charleston, West Virginia

Gentlemen:

We are enclosing, in duplicate, 'Notice of Proposed Location of Gas Well', as above numbered on the George Poland farm of 83 acres, situate in Proctor District, Wetzel County, West Virginia, as shown on the accompanying tracing, marked Y-13-876. We plan to reopen this well.

Yours very truly,

THE MANUFACTURERS LIGHT AND HEAT COMPANY

BY:

Paul F. Ward
Paul F. Ward
Assistant Land Agent

lgs

Enclosures

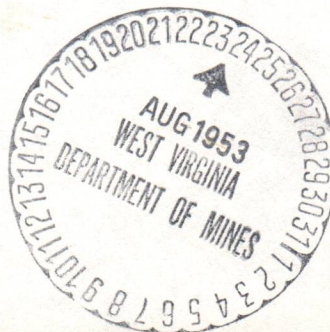

10/06/2023

THE MANUFACTURERS LIGHT AND HEAT COMPANY
800 UNION TRUST BUILDING
PITTSBURGH 19 • PENNSYLVANIA

August 21, 1923

RE * Lease 2045, Well I-1175
Proctor District
Wetzel County, West Virginia

Department of Mines
Oil and Gas Section
Charleston, West Virginia

Gentlemen:

We are enclosing, in duplicate, a notice of proposed location of Gas Well, as above numbered on the George Toland farm of 63 acres, situated in Proctor District, Wetzel County, West Virginia, as shown on the accompanying tracing, marked Y-13-376. We plan to reopen this well.

Yours very truly,

THE MANUFACTURERS LIGHT AND HEAT COMPANY

By: Paul T. Ward
Assistant Land Agent

Enclosure



A-11

STATE OF WEST VIRGINIA
OFFICE OF OIL AND GAS
NOTICE OF EXPIRED PERMIT

RECEIVED
DEC 12 1984
OIL & GAS DIVISION
DEPT. OF MINES

Permit number: 47-103-0387
Company: COLUMBIA GAS TRANS
Date: 27-Nov-84
Date issued: 8/21/53

County: WETZEL
Farm: GEORGE & MARY FOLAND
Well no.:
Date expired: / / 0

*This well was Re Drilled for storage
it is still an use for gas storage* *on 9-3-53*

I have inspected the above wellsite and found no well work done. Please
cancel this well work permit.

Signed: *R. A. Lowther*
Date: *Dec 11, 1984*

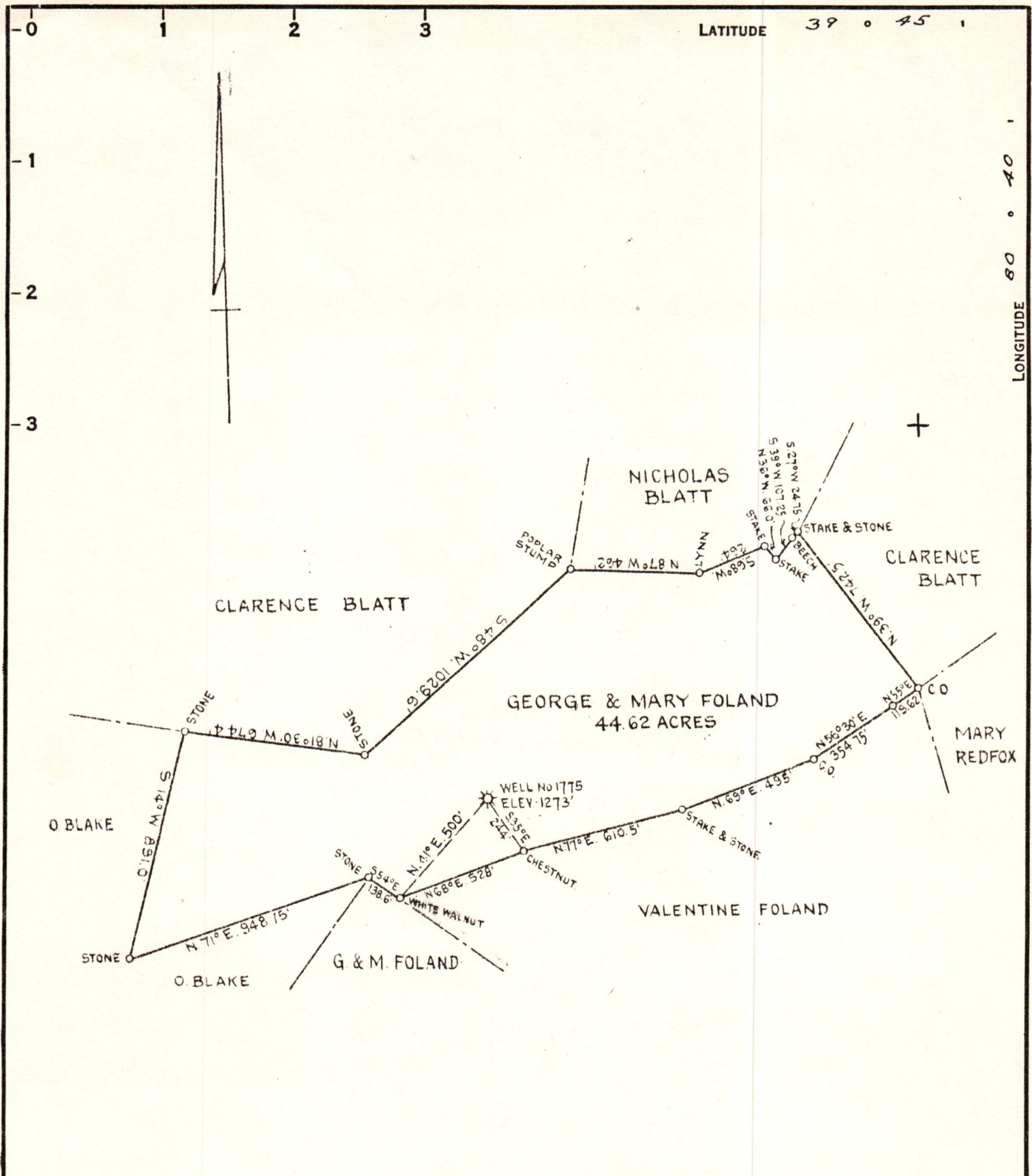

COAL OWNED BY Miss Marion Franklin Byers
 Reopened * (Everett Moore)

NEW LOCATION.....
 DRILL DEEPER.....
 ABANDONMENT.....

COMPANY The Manufacturers Light & Heat
 ADDRESS 800 Union Trust Bldg. Pgh. Pa.
 FARM George & Mary Foland
 TRACT 1 ACRES 44.62 LEASE NO. 26465
 WELL (FARM) NO. 1 SERIAL NO. 1775
 ELEVATION (SPIRIT LEVEL) 1273'
 QUADRANGLE Littleton
 COUNTY Wetzel DISTRICT Proctor
 ENGINEER John A. Landa
 ENGINEER'S REGISTRATION NO. _____
 FILE NO. _____ DRAWING NO. Y-13-876
 DATE 17 Aug 1953 SCALE 1" = 800'

STATE OF WEST VIRGINIA
 DEPARTMENT OF MINES
 OIL AND GAS DIVISION
 CHARLESTON

WELL LOCATION MAP 10/06/2023

FILE No. Wet-387-REDRILL

+ DENOTES LOCATION OF WELL ON UNITED STATES TOPOGRAPHIC MAPS, SCALE 1 TO 62,500, LATITUDE AND LONGITUDE LINES BEING REPRESENTED BY BORDER LINES AS SHOWN.

- DENOTES ONE INCH SPACES ON BORDER LINE OF ORIGINAL TRACING.