

11

Latitude 39° 35'

Longitude 80° 36'

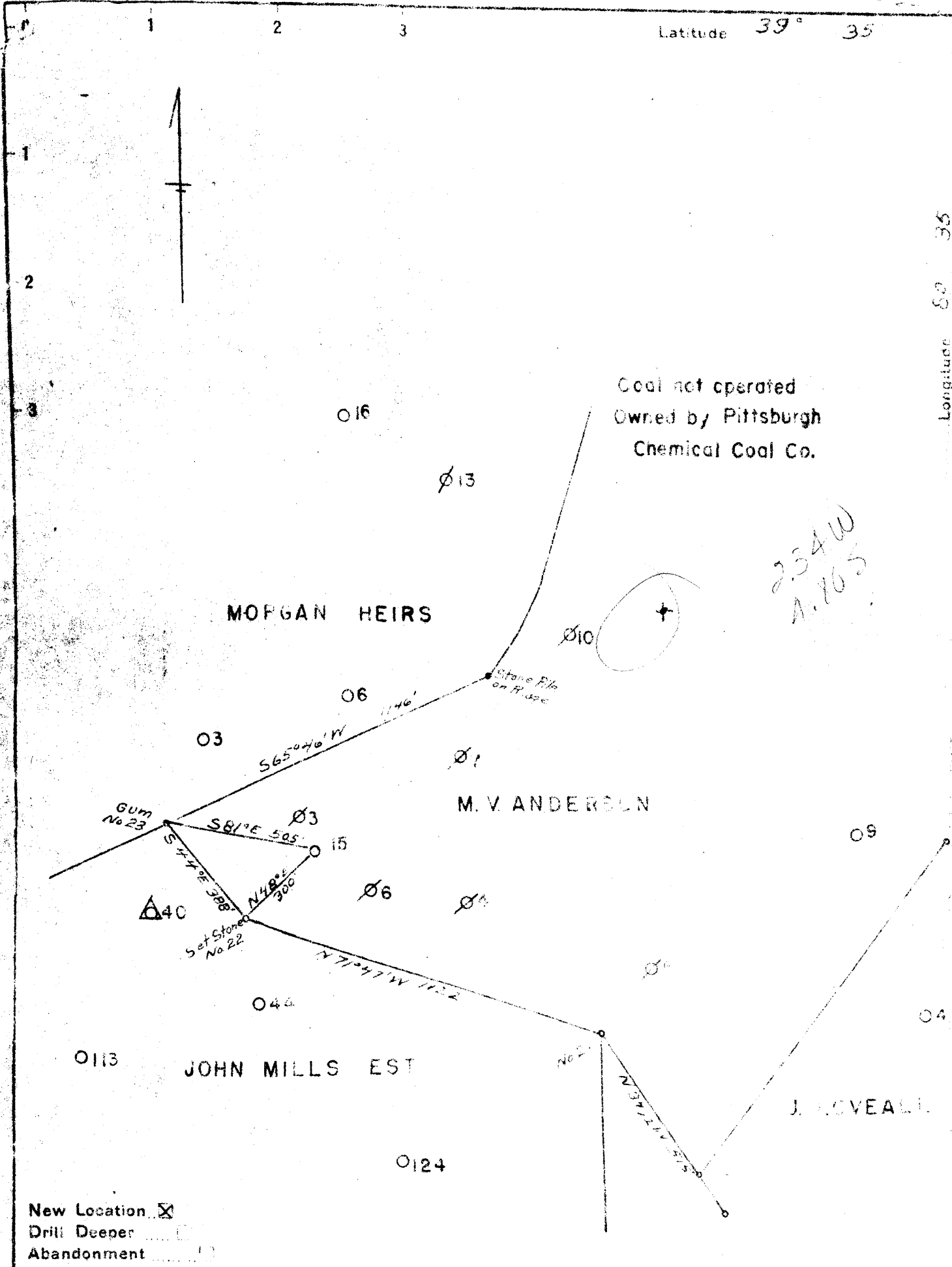

New Location   
 Drill Deeper   
 Abandonment

Company QUAKER STATE OIL REF CORP.  
 Address Box 1789, Parkersburg, W. Va.  
 Farm M. V. ANDERSON  
 Tract \_\_\_\_\_ Acres 175 Lease No. \_\_\_\_\_  
 Well (Farm) No. 15 Serial No. \_\_\_\_\_  
 Elevation (Spirit Level) 1282  
 Quadrangle Littleton  
 County Wetzel District Grant  
 Engineer [Signature]  
 Engineer's Registration No. 2492  
 File No. \_\_\_\_\_ Drawing No. \_\_\_\_\_  
 Date Jan. 7, 1952 Scale 1" = 400'

STATE OF WEST VIRGINIA  
 DEPARTMENT OF MINES  
 OIL AND GAS DIVISION  
 CHARLESTON

WELL LOCATION MAP  
 FILE NO. Wet-378

+ Denotes location of well on United States Topographic Maps, scale 1 to 62,500, latitude and longitude lines being represented by border lines as shown.  
 - Denotes one inch spaces on grid of original tracing

6-6 95

WEST VIRGINIA DEPARTMENT OF MINES  
OIL & GAS DIVISION  
W E L L R E C O R D

Permit No. WET 370  
Littleton Quad.

Oil

Company	Quaker State Oil Refining Corp.	CASING & TUBING	
Address	Box 1709, Parkersburg, W. Va.		
Farm	M.V. Anderson Acres 175	10	550
Location	Fishing Creek	8 $\frac{1}{2}$	1200
Well No.	15 Elev. 1282	6 5/8	2312 2312
District	Grant County - Wetzel		
Surface	L.S. Parks, Jacksonburg, W. Va.		Coal at 1042'
Mineral	Pgh. Chemical Coal Co., Morgantown, W. Va.		
Commenced	2/7/52		
Date Shot	4/2/52 from 2382 to 2400		
With	24 qts.		
Fresh water	190'		

Shale	0	190
Sand Gray	190	200
Shald	200	410
Sand Gray	410	420
Shale & Red Rock	420	545
Shale White	545	550
Shale	550	750
Sand	750	825
Lime	825	833
Shald	833	1042
✓ Coal Pgh.	1042	1047
Shale & Shells	1047	1080
Sand	1080	1090
Shale Black	1090	1115
Shale & Shells	1115	1155
Sand White	1155	1170
Shale	1170	1180
Sand Gray	1180	1232
Shale & Red Rock	1232	1285
Lime Gray	1285	1303
Shale & Shells	1303	1375
Red Rock	1375	1394
Lime	1394	1440
Shale Pink	1440	1475
✓ Sand Little Dunkard	1475	1500
Shale Pink	1500	1536
✓ Sand Big Dunkard	1536	1680
Shale	1680	1695
Sand	1695	1775
Shale	1775	1790
✓ Sand First Salt	1790	1825
Shale & Shells	1825	1925
✓ Sand Second Salt	1925	1985
Shale	1985	2050
✓ Sand Third Salt	2050	2130
Shale Black	2130	2165
Shale	2165	2176
Red Rock	2176	2232
Shale	2232	2249
✓ Maxton Sand	2249	2257
Shale	2257	2270
✓ Little Lime C	2270	2297
✓ Pencil Cave	2297	2301
✓ Big Lime	2301	2355
✓ Big Injun	2355	2408
TOTAL DEPTH		2408

2301  
1282  
1019

Water 140'  
Oil show 2373 - Baker core 2371-2400.