



STATE OF WEST VIRGINIA
DEPARTMENT OF MINES
OIL AND GAS DIVISION

NOTICE OF PROPOSED LOCATION OF OIL AND GAS WELL

To THE DEPARTMENT OF MINES,
Charleston, W. Va.

Imperial Oil & Gas Products Co., etal

COAL OPERATOR OR COAL OWNER

Frick Building, Pittsburgh, Penna.

ADDRESS

COAL OPERATOR OR COAL OWNER

Joseph Shiben, etal

OWNER OF MINERAL RIGHTS

New Martinsville, West Virginia

ADDRESS

P. C. McKenzie Company

NAME OF WELL OPERATOR

Pittsburgh, Penna. Box 10396

COMPLETE ADDRESS

October 8, 19 51

PROPOSED LOCATION

Grant District

Wetzel County

Well No. A 2
S. J. Robinson etal
No. 2 on 39' 40'
80' 30' Farm

GENTLEMEN:

The undersigned well operator is entitled to drill upon the above named farm or tract of land for oil and gas, having fee title thereto, (or as the case may be) under grant or lease dated Sept. 11, 1895, made by S. J. Robinson, to Philadelphia Company, and recorded on the 9-1895 day of _____, in the office of the County Clerk for said County in Book 47, page 469.

The enclosed plat was prepared by a competent engineer and shows the proposed location of a well to be drilled for oil and gas by the undersigned well operator on the farm and in the Magisterial District and County above named, determined by survey and courses and distances from two permanent points, or land marks.

The undersigned well operator is informed and believes there are no coal operators operating beds of coal beneath said farm or tract of land on which said well is located, or within 500 feet of the boundaries of the same, who have mapped their workings and filed their maps as required by law, excepting the coal operators or coal owners (if any) above named as addressees.

The above named coal operators or coal owners (if any) are notified that any objections they may desire to make to such proposed location, or which they are required to make by Section 3 of said Code, if the drilling of a well at said proposed location will cause a dangerous condition in or about their respective coal mines, must be received by, or filed with the Department of Mines within ten* days from the receipt of a copy of this notice and accompanying plat by said Department. Said coal operators are further notified that forms for use in making such objections will be furnished to them by the Department of Mines promptly on request and that all such objections must set forth as definitely as is reasonably possible the ground or grounds on which such objections are based and indicate the direction and distance the proposed location should be moved to overcome same.

(The next paragraph is to be completed only in Department's copy.)

Copies of this notice and the enclosed plat were mailed by registered mail, or delivered to the above named coal operators or coal owners at their above shown respective address Oct. 16, 1951 day before, or on the same day with the mailing or delivery of this copy to the Department of Mines at Charleston, West Virginia.

Very truly yours,

P. C. McKenzie Co.
WELL OPERATOR
By P. C. McKenzie
P.O. Box 10396
STREET
Pg. 34
CITY OR TOWN
Pennsylvania
STATE

10/06/2023

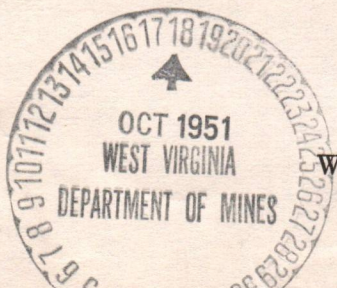

Address of Well Operator }

*Section 3 . . . If no such objections be filed or be found by the department of mines, within said period of ten days from the receipt of said notice and plat by the department of mines, to said proposed location, the department shall forthwith issue to the well operator a drilling permit reciting the filing of such plat, that no objections have been made by the coal operators to the location, or found thereto by the department, and that the same is approved and the well operator authorized to proceed to drill at said location.

P. C. MCKENZIE CO.

(INCORPORATED)

3829 WILLOW AVENUE, CASTLE SHANNON, PA.

MAILING ADDRESS — P. O. BOX 10396, PITTSBURGH 34, PA.

THE GRISCOM-RUSSELL CO.
HEAT EXCHANGERS
OIL COOLERS & HEATERS
INTER-COOLERS & AFTER-COOLERS
PROCESS CONDENSERS
AIR COOLERS & HEATERS
FIN-FAN COOLERS

LE ROI COMPANY
ENGINES
ENGINE GENERATOR SETS
ROTARY GAS COMPRESSORS

THE FLUOR CORP. LTD.
REFINERY & COMPRESSOR
STATION CONSTRUCTION
COOLING TOWERS
PULSATION DAMPENERS
MUFFLERS
GAS CLEANERS

October 16, 1951

Department of Mines
Oil & Gas Division
Charleston, West Virginia

Gentlemen:

Attached hereto is proposed location of oil and gas well located in Grant District, Wetzel County, West Virginia.

Very truly yours,

P. C. MCKENZIE COMPANY

P. C. McKenzie

PCM/nlm

Attachment

cc: Imperial Oil & Gas Products Co.
Frick Building
Pittsburgh 19, Pennsylvania
cc: Mr. J. M. Shields
Land Agent
c/o Equitable Gas Company
435 Sixth Avenue
Pittsburgh, Pennsylvania

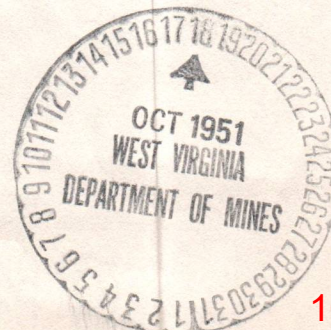

10/06/2023

A-10

October 18, 1951

Imperial Oil and Gas Products Company
Frick Building
Pittsburgh, Pennsylvania

Gentlemen:

We have received an application to drill well No. 2 on the S. J. Robinson et al farm, Grant District, Wetzel County from the P. C. McKenzie Company, Pittsburgh, Pennsylvania.

Copy of application and map of location should have been sent you by the well operator.

If there are any objections to the proposed location because of interference with your projected mining plans as shown on your map, please advise us on or before October 28, 1951.

Very truly yours,

Administrative Assistant
OIL AND GAS DIVISION

CNH:K

10/06/2023

A-11
October 29, 1951

F. G. McKenzie Company
P. O. Box 10396
Pittsburgh, Pennsylvania

Gentlemen:

Enclosed is permit WET-376 to drill Well
No. 2 on the S. J. Robinson et al Farm, Grant District,
Wetzel County.

Very truly yours,

Administrative Assistant
OIL AND GAS DIVISION

CNH:K
Encl-2

CC: Inspector D. F. Desist

10/06/2023

A-12

February 28, 1952

P. C. McKenzie Company
P. O. Box 10396
Pittsburgh, Pennsylvania

Gentlemen:

Please send two copies of well record of the drilling of Well No. 2 on the S. J. Robinson et al Farm, Grant District, Wetzel County for which permit WET-376 was issued October 29, 1951.

Forms OG-10 are enclosed.

Very truly yours,

Administrative Assistant
OIL AND GAS DIVISION

CNH:K
CC: Inspector D. F. Desist

10/06/2023

Formation	Color	Hard or Soft	Top	Bottom	Oil, Gas or Water	Depth Found	Remarks
Shale			848	851			
Lime	Hard		851	880			
Lime		Broken	880	885			
Coal (Mapletown)			885	886			
Lime			886	901			
Slate & Lime			901	927			
Lime		Broken	927	951			
Lime			951	960			
Lime		Firm	960	975			
Slate	Dark		975	987			
Shell		Gritty	987	988			
Coal (Pittsburgh)			988	997	Gas	991	
Slate			997	1004			
Lime			1004	1008			
	Total Depth			1008			

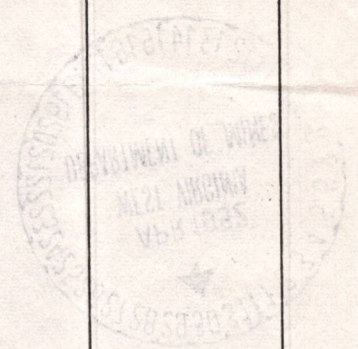

10/06/2023

Date _____, 19____
 APPROVED _____, Owner

By _____ (Title)



STATE OF WEST VIRGINIA
DEPARTMENT OF MINES
OIL AND GAS DIVISION

Littleton

WELL RECORD

Permit No. WET-376

Oil or Gas Well Gas
(KIND)

Company P. C. McKenzie Company
Address P. O. Box 10396, Pittsburgh 34, Pa.
Farm S. J. Robinson, etal Acres 90
Location (waters) Big Run
Well No. 2 Elev. 1265
District Grant County Wetzel
The surface of tract is owned in fee by _____
Address _____
Mineral rights are owned by Joseph Shiben, etal
Address New Martinsville, West Virginia
Drilling commenced Dec. 1, 1951
Drilling completed April 11, 1952
Date Shot April 16/52 From 991' To 993'
With _____
Open Flow 10/10ths Water in 1" Inch
_____/10ths Merc. in _____ Inch
Volume 33,000 Cu. Ft.
Rock Pressure 132 lbs. 19 hrs.
Oil _____ bbls., 1st 24 hrs.
Fresh water 65 feet _____ feet
Salt water _____ feet _____ feet

Casing and Tubing	Used in Drilling	Left in Well	Packers
Size			Kind of Packer
16			
13			
10			Size of
8 1/4	<u>13'</u>	<u>13'</u>	
6 5/8	<u>406'</u>	<u>Pulled</u>	Depth set
5 3/16	<u>969'</u>	<u>969'</u>	
3			Perf. top
2			Perf. bottom
Liners Used			Perf. top
			Perf. bottom

CASING CEMENTED _____ SIZE _____ No. Ft. _____ Date _____

COAL WAS ENCOUNTERED AT 885 FEET _____ INCHES
988 FEET _____ INCHES FEET _____ INCHES
FEET _____ INCHES FEET _____ INCHES

Formation	Color	Hard or Soft	Top	Bottom	Oil, Gas or Water	Depth Found	Remarks
Clay			0	12			
Rock			12	24			
Shale			24	47			
R. Rock			47	60			
Shale	Blue		60	79	Water	65'	20 gal. per hr.
Slate			79	95			
R. Rock			95	107			
Slate			107	110			
R. Rock			110	120			
Lime			120	142			
R. Rock			142	160			
Shale	Blue		160	180			
R. Rock			180	200			
Shale	Grey		200	205			
Lime			205	215			
Sand			215	225			
Slate	Dark		225	240			
Show of Coal			238				
Slate	Blue		240	260			
Shale			260	280			
Slate & lime			280	313			
R. Rock			313	325			
Slate & lime			325	385			
R. Rock			385	405			
Lime & slate			405	512			
Native Coal			512	513			
Slate			513	517			
Sand			517	535			
Lime & slate			535	643			
Show of Coal (Waynesburg)			543		Water	543	1 bailer per hr.
Lime			643	660			
Slate			660	680			
R. Rock			680	687			
Slate			687	700			
Lime & Slate			700	770			
Lime	Hard		770	823			
Slate			823	830			
Lime			830	848			

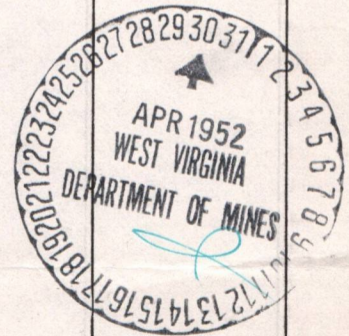

10/06/2023

1386

C-1

FERC-121

1.0 API well number: (If not available, leave blank. 14 digits.)	<u>47-103-237600000</u>			
2.0 Type of determination being sought: (Use the codes found on the front of this form.)	<u>108</u> Section of NGPA		Category Code	
3.0 Depth of the deepest completion location: (Only needed if sections 103 or 107 in 2.0 above.)	<u>N/A</u> feet			
4.0 Name, address and code number of applicant: (35 letters per line maximum. If code number not available, leave blank.)	<u>Penco Gas, Inc., Agent</u>			<u>014652</u>
	Name			
	<u>3930 Fulton Dr. N.W.</u>			Seller Code
	Street	<u>Ohio</u>	<u>West Va.</u>	
City	State	Zip Code		
5.0 Location of this well: [Complete (a) or (b).] (a) For onshore wells (35 letters maximum for field name.)	<u>Grant District</u>			
	Field Name			
(b) For OCS wells:	<u>N/A</u>			
	Area Name		Block Number	
(c) Name and identification number of this well: (35 letters and digits maximum.)	<u>S. J. Robinson No. 2</u>			
	Field Name			
(d) If code 4 or 5 in 2.0 above, name of the reservoir: (35 letters maximum.)	<u>N/A</u>			
	County			
6.0 (a) Name and code number of the purchaser: (35 letters and digits maximum. If code number not available, leave blank.)	<u>Equitable Gas Company</u>			<u>005939</u>
	Name			Buyer Code
(b) Date of the contract:	<u>0 4 5 4 8</u> Mo. Day Yr.			
(c) Estimated annual production:	<u>2500 MCF</u> MMcf.			
	(a) Base Price (\$/MMBTU)	(b) Tax	(c) All Other Prices [Indicate (+) or (-).]	(d) Total of (a), (b) and (c)
7.0 Contract price: (As of filing date. Complete to 3 decimal places.)	<u>. 6 6 8</u>	<u>---</u>	<u>---</u>	<u>. 6 6 8</u>
8.0 Maximum lawful rate: (As of filing date. Complete to 3 decimal places.)	<u>2 . 4 2 6</u>	<u>---</u>	<u>---</u>	<u>2 . 4 2 6</u>
9.0 Person responsible for this application:	<u>J. R. Barati</u>			<u>President</u>
	Name			Title
	<u>J. R. Barati</u>			
	Signature			
<u>SEP 17 1979</u>			<u>(216)492-4419</u>	
Date Application is Completed			Phone Number	

Agency Use Only
Date Received by Agency OCT 05 1979
Date Received by FERC

10/06/2023

PARTICIPANTS:

DATE:

FEB 18 1980

BUYER-SELLER CODE

WELL OPERATOR: Pemco Gas, Inc.

014652

FIRST PURCHASER: Equitable Gas Company

005939

OTHER: _____

W. Va. Department of Mines, Oil & Gas Division
 WELL DETERMINATION FILE NUMBER
7901005-108-103-0376
 Use Above File Number on all Communications
 Relating to Determination of this Well

~~Refer to original permit # 108-103-0376~~
 Qualified as Section 108 strapper well
 Rate 8 MCF
 new production recalculated
 and attached: 3-18-80

CHECK EACH ITEM AS COMPLETE OR NOTE WHAT IS MISSING

ITEM NO.

- 1 FERC-121 Items not completed - Line No. _____
- 2 IV-1 - Agent Thomas M. Hough
- 3 IV-2 - Well Permit _____
- 4 IV-6 - Well Plat
- 5 IV-35- Well Record Drilling Deepening _____
- 6 IV-36- Gas-Oil Test: Gas Only _____ Was Oil Produced? _____ Ratio _____
- 7 IV-39- Annual Production 1 years 8 mos.
- 8 IV-40- 90 day Production 90 Days off Line: _____
- 9 IV-48- Application for Certification. Complete?
- 10 - 17 IV Form #51 - 52 - 53 - 54 - 55 - 56 - 57 - 58. Complete Affidavit Signed
- 18 - 28 Other: Survey _____ Logs _____ Geological Charts _____ Structure Map _____
 1:4000 Map _____ Well Tabulations _____ Gas Analyses _____
- (5) Date commenced: 12-1-51
 Date Completed: 4-11-52 Deepened _____
- (5) Production Depth: 988-997
- (5) Production Formation: Coal
- (5) Final open flow 33 MCF
- (5) Static R.P. ~~_____~~ ^{AFTER FROG} 132 - 19 hrs.
- (6) Other Gas Test: ~~_____~~
- (7) Avg. Daily Gas from Annual Production: $\frac{3072}{365} = 8 \text{ MCF}$
- (8) Avg. Daily Gas from 90-day ~~_____~~ 798/91 = 9 MCF
- (8) Line Pressure: N/A PSIG from Daily Report _____
- (5) Oil Production: No From Completion Report _____
- (10-17) Does lease inventory indicate enhanced recovery being done: 10/06/2023
- (10-17) Is affidavit signed? Notarized?
- Does official well record with the Department confirm the submitted information? Yes
- Additional Information _____ Does computer program confirm? _____
- Was Determination Objected to? _____ By Whom? _____

JML

STATE OF WEST VIRGINIA
DEPARTMENT OF MINES, OIL AND GAS DIVISION

Date September 10 19 79
Operator's Well No. S. J. Robinson #2
API Well No. 47 - 103 - 237600000
State County Permit

WELL CLASSIFICATION FORM
STRIPPER GAS WELL
NGPA Section 108

DESIGNATED AGENT Thomas M. Hough
ADDRESS 1575 Smith Road No. 2
Charleston, West Va. 25314
LOCATION: Elevation 1265'
Watershed North Fork Fishing Creek
Dist. Grant County Wetzel Quad. Littleton
Gas Purchase Contract No. 4649
Meter Chart Code 01000
Date of Contract April 5, 1948

WELL OPERATOR Pemco Gas, Inc.
ADDRESS 3930 Fulton Dr. N.W.
Canton, Ohio 44718
GAS PURCHASER Equitable Gas Company
ADDRESS 420 Blvd. of the Allies
Pittsburgh, Pa. 15219

* * * * *

Provide a complete inventory of the lease and production equipment used for the well for the previous 24 months or, if less than 24 months, the period the well has been in production. Include a complete list of equipment or processes used in connection with recognized enhanced recovery techniques during completion or production. (Attach separate sheets, if necessary.)

- 13' - 8-1/4" casing
- 969' - 5-3/16" casing

Well not fractured

List all records reasonably available to you which contain information relevant to a determination of eligibility (including production records, B&O Tax Records and royalty payment records) and indicate the location of such records:

- Production records
- Bus. & Occup., Personal Property tax records
- Royalty payment records
- Permit application and plat
- Well completion record
- Equipment list
- Well log
- Gas Purchase Contract

Located at 3930 Fulton Dr. N.W. - Suite 107
Canton, Ohio 44718

10/06/2023

Describe the search made of any records listed above:

Reviewed files maintained on well.

Are you aware of any other information which would tend to be inconsistent with the information specified above? Yes _____ No X. If yes, indicate the type and source of the information.

AFFIDAVIT

I, J. R. Barati, having been first sworn according to law, state that I have caused to be made a diligent search of those records hereinbefore indicated in the manner herein described, that the information contained in this document is true and accurate and that on the basis of the records and examinations hereinbefore described, and to the best of my information, knowledge and belief, the well for which this certification is sought qualifies as a stripper well.

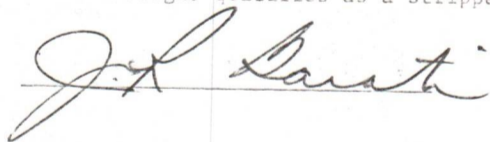

STATE OF Ohio
~~XXXXXXXXXXXXX~~

COUNTY OF Stark, TO WIT:

I, Gerald A. Warehime, a Notary Public in and for the state and county aforesaid, do certify that J. R. Barati, whose name is signed to the writing above, bearing date the 10th day of September, 1979, has acknowledged the same before me, in my county aforesaid.

Given under my hand and official seal this 10th day of September, 1979.

My term of office expires on the 20th day of February, 1981.

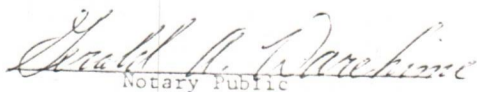
Notary Public

[NOTARIAL SEAL]

GERALD A. WAREHIME **10/06/2023**
Notary Public, Stark County, Ohio
My Commission Expires Feb. 20, 1981

1003-108-103-0316

Corrected
REPORT DATE 8/21/79

REPORT OF MONTHLY PRODUCTION
GAS VOLUMES IN MCF @ 14.73
OIL IN BARRELS @ 60 DEGREES

IV-39-WC

STATE OF WEST VIRGINIA
DEPARTMENT - MINES
DIVISION - OIL AND GAS

OPERATOR *Bence Gas Inc., Agent*

YEAR 1978

API 47-103-2376 FARM	<i>J. Robinson #2</i>	COUNTY	<i>Wetzel</i>	AVG. FLOW PRESSURE	<i>NA</i>	SHUT-IN PRESSURE	<i>NA</i>	TOTALS
GAS MCF						<i>249</i>	<i>329</i>	<i>1061</i>
OIL BRL	J- F- M- A- M- J- J- A- S- D-					<i>0</i>	<i>0</i>	<i>0</i>
DAYS ON LINE						<i>28</i>	<i>35</i>	<i>119</i>

YEAR 1979

API 47-103-2376 FARM	<i>J. Robinson #2</i>	COUNTY	<i>Wetzel</i>	AVG. FLOW PRESSURE	<i>NA</i>	SHUT-IN PRESSURE	<i>NA</i>	TOTALS
GAS MCF	<i>212</i>	<i>243</i>	<i>229</i>	<i>273</i>	<i>256</i>	<i>281</i>	<i>263</i>	<i>2011</i>
OIL BBL	J- F- M- A- M- J- J- A- S- D-					<i>0</i>	<i>0</i>	<i>0</i>
DAYS ON LINE	<i>28</i>	<i>33</i>	<i>30</i>	<i>30</i>	<i>31</i>	<i>29</i>	<i>31</i>	<i>243</i>

8/9/78 - 8/6/79

SUMMARIZATION SCHEDULE
Section 271.804 (b)

RECEIVED

Aug - 3072
and - 0
Aug - 362

In accordance with Section 271.804 (b) please list all other wells which are to be used in determining this well classification under 8 1980 Part 271 Subpart H.

OIL & GAS DIVISION
DEPT. OF MINES

API NUMBERS

10/06/2023

P. C. MCKENZIE CO.

(INCORPORATED)

3829 WILLOW AVENUE, CASTLE SHANNON, PA.

MAILING ADDRESS — P. O. BOX 10396, PITTSBURGH 34, PA.

THE GRISCOM-RUSSELL CO.
 HEAT EXCHANGERS
 OIL COOLERS & HEATERS
 INTER-COOLERS & AFTER-COOLERS
 PROCESS CONDENSERS
 AIR COOLERS & HEATERS
 FIN-FAN COOLERS

LE ROI COMPANY
 ENGINES
 ENGINE GENERATOR SETS
 ROTARY GAS COMPRESSORS
 GARRETT RELIEF VALVES

THE FLUOR CORP. LTD.
 REFINERY & COMPRESSOR
 STATION CONSTRUCTION
 COOLING TOWERS
 PULSATION DAMPENERS
 MUFFLERS
 GAS CLEANERS

March 18, 1952

State of West Virginia
 Department of Mines
 Charleston, West Virginia

Attention: Mr. C. N. Hall

Gentlemen:

This will acknowledge receipt of your letter, dated February 28th, concerning the well record of the drilling of Well #2 on the S. J. Robinson et al Farm, Grant District, Wetzel County, for which Permit WET-376 was issued on October 29, 1951.

Due to weather conditions, the contractor has been unable to start the well even though the machine has been on location since the early part of December. Upon advice from Mr. J. H. Newlon, our plans at present call for starting of drilling sometime this month.

If it is necessary that we renew our permit, we would appreciate your advising.

Very truly yours,

P. C. MCKENZIE COMPANY

E. R. Rigatti

ERR/nlm



E-5.

March 24, 1952

P. C. McKenzie Company
P. O. Box 10396
Pittsburgh 34, Pennsylvania

Att: Mr. E. R. Rigatti

Gentlemen:

We acknowledge receipt of your letter of March 18 advising us that Well No. 2 on the S. J. Robinson et al Tract, Grant District, Wetzel County - Permit WET-376, has not yet been started.

Permit has been renewed and will be valid until July 24, 1952.

Very truly yours,

Administrative Assistant
OIL AND GAS DIVISION

MG:g

10/06/2023

E-6

P. C. MCKENZIE CO.

(INCORPORATED)

3829 WILLOW AVENUE, CASTLE SHANNON, PA.

MAILING ADDRESS — P. O. BOX 10396, PITTSBURGH 34, PA.

THE GRISCOM-RUSSELL CO.
HEAT EXCHANGERS
OIL COOLERS & HEATERS
INTER-COOLERS & AFTER-COOLERS
PROCESS CONDENSERS
AIR COOLERS & HEATERS
FIN-FAN COOLERS

LE ROI COMPANY
ENGINES
ENGINE GENERATOR SETS
ROTARY GAS COMPRESSORS
GARRETT RELIEF VALVES

THE FLUOR CORP. LTD.
REFINERY & COMPRESSOR
STATION CONSTRUCTION
COOLING TOWERS
PULSATION DAMPENERS
MUFFLERS
GAS CLEANERS

April 28, 1952

Department of Mines
Oil & Gas Division
Charleston, West Virginia

Attention: Mr. C. N. Hall

Gentlemen:

Attached are two (2) copies of our record of the drilling of Well #2 on the S. J. Robinson et al Farm, Grant District, Wetzel County, West Virginia.

Very truly yours,

P. C. MCKENZIE COMPANY

E. R. Rigatti
E. R. Rigatti

ERR/nlm
Attachments

cc: Mr. J. M. Shields, Land Agent
c/o Equitable Gas Company
435 Sixth Avenue
Pittsburgh, Pennsylvania
Attachments (2)

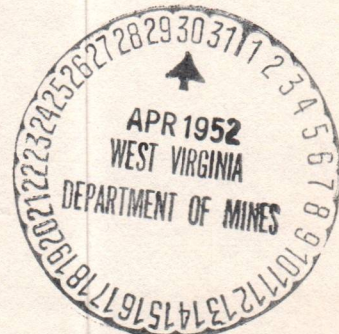

Latitude 39 40'

Longitude 80 50'

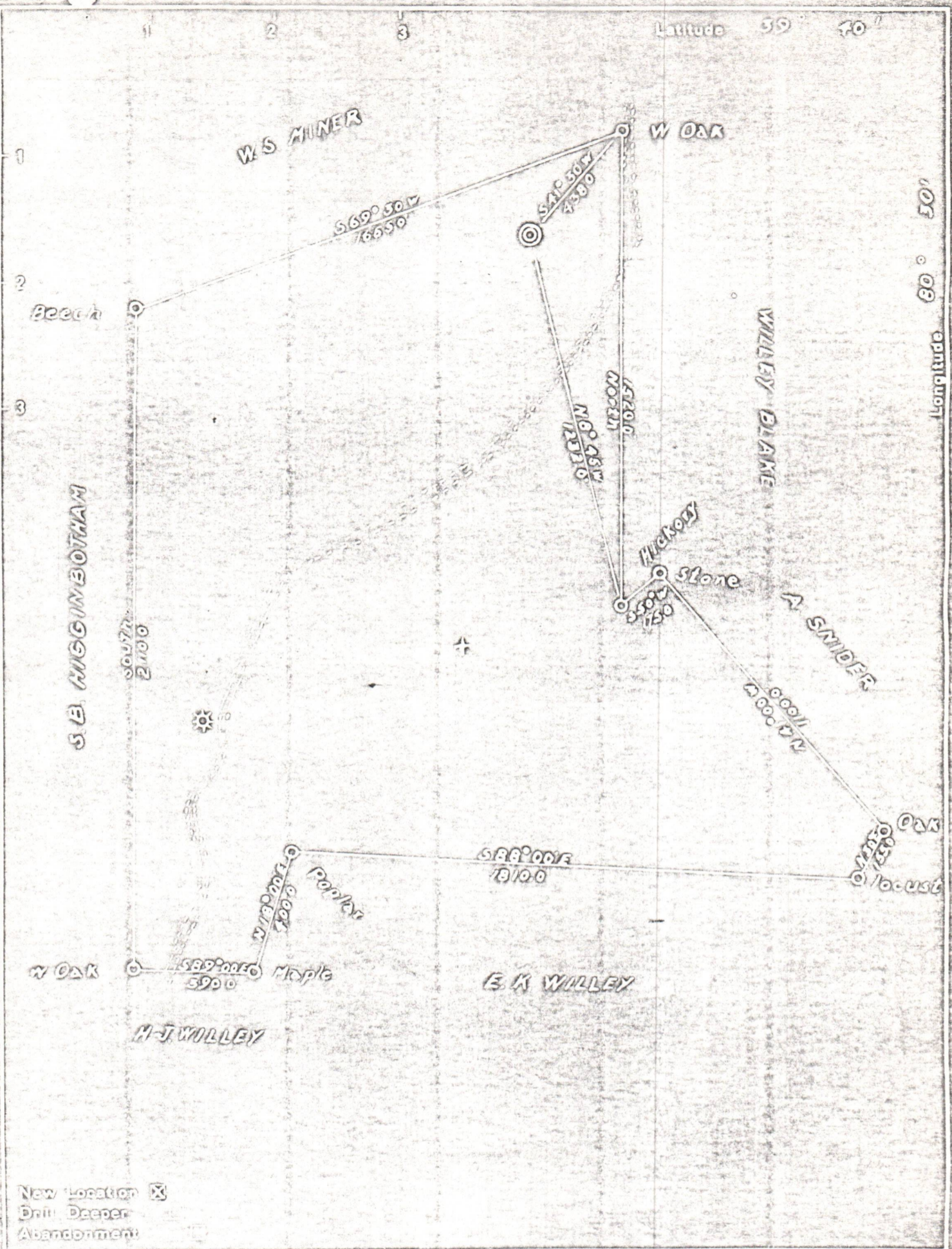

New Location X
 Drill Deeper
 Abandonment

Company P. C. McKENZIE Co.
 Address PITTSBURGH PA. BOX 10376
 Farm S. J. ROBINSON ET AL.
 Tract _____ Acres 20⁰ Lease No 2836
 Well Farm No 2 Serial No. _____
 Elevation (Spirit Level) 1265
 Quadrangle LITTLETON
 County WETZEL District GRANT
 Engineer G. L. McINTIRE
 Engineer's Registration No 1187
 File No. _____ Drawing No. _____
 Date 10/8/51 Scale 1" = 400'

STATE OF WEST VIRGINIA
 DEPARTMENT OF MINES
 OIL AND GAS DIVISION
 CHARLESTON

WELL LOCATION MAP
 FILE NO. **103-0376**

10/06/2023

+ Denotes location of well on United States Topographic Maps, scale 1" to 62,500', latitude and longitude lines being represented by border lines, if shown.
 - Denotes one-inch squares on border lines of original map.

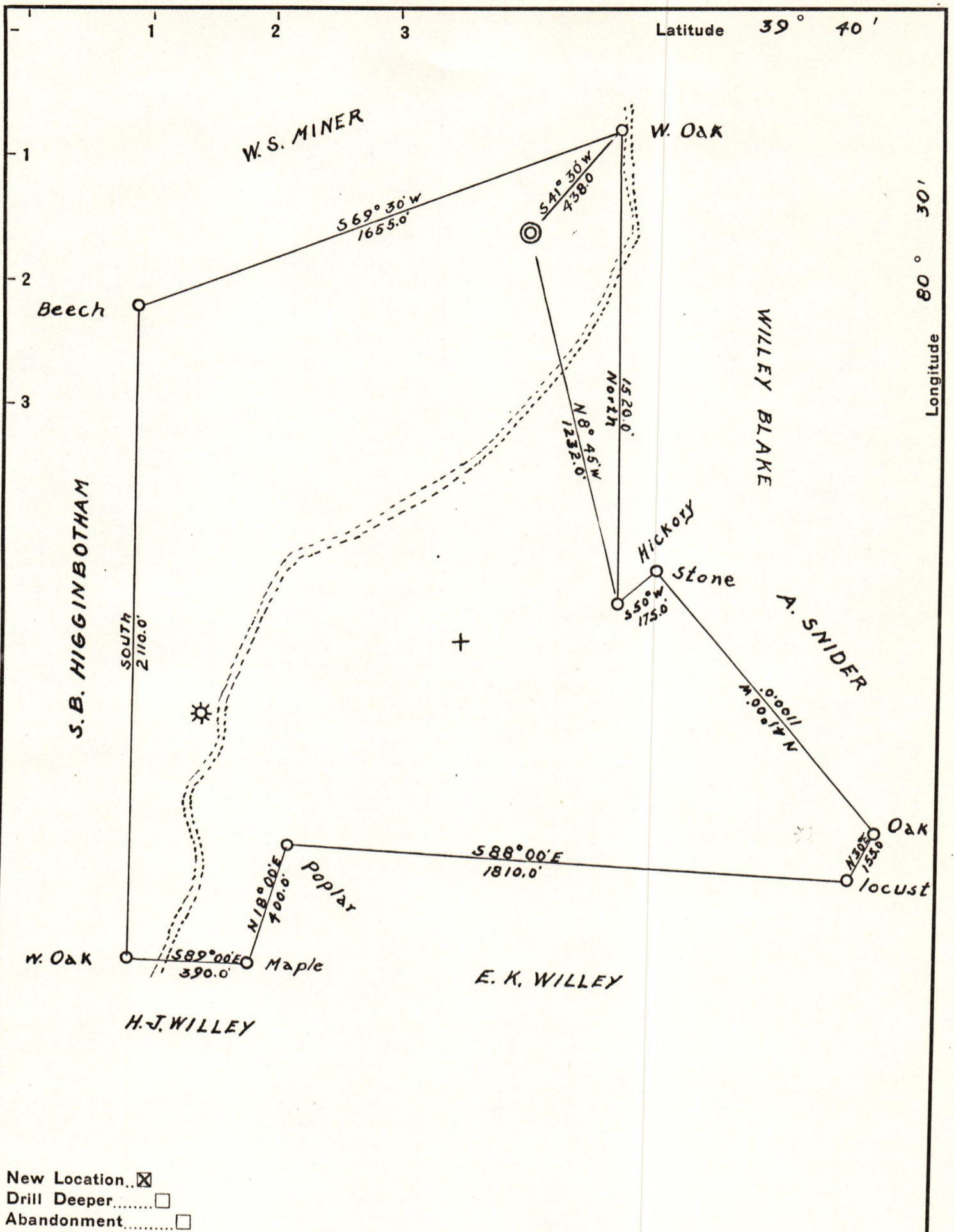

Company P. C. MCKENZIE Co.
 Address PITTSBURGH Pa. BOX 10396
 Farm S. J. ROBINSON ET AL.
 Tract _____ Acres 90[±] Lease No. 2836
 Well (Farm) No. 2 Serial No. _____
 Elevation (Spirit Level) 1265
 Quadrangle LITTLETON
 County WETZEL District GRANT
 Engineer GL. MCINTIRE
 Engineer's Registration No. 1187
 File No. _____ Drawing No. _____
 Date 10/8/51 Scale 1" = 400'

STATE OF WEST VIRGINIA
 DEPARTMENT OF MINES
 OIL AND GAS DIVISION
 CHARLESTON

WELL LOCATION MAP

FILE NO. Wet - 376

10/06/2023

+ Denotes location of well on United States Topographic Maps, scale 1 to 62,500, latitude and longitude lines being represented by border lines as shown.

- Denotes one inch spaces on border line of original tracing.