



STATE OF WEST VIRGINIA
DEPARTMENT OF MINES
OIL AND GAS DIVISION

Formerly Blagging
Permit W.V.-287

NOTICE OF PROPOSED LOCATION OF OIL AND GAS WELL

To THE DEPARTMENT OF MINES,
Charleston, W. Va.

~~Book~~ The Burton Coal Co

Kenneth Renner

~~Coal Operator or Coal Owner~~
Own the Pgn Vein under 13 Acres

NAME OF WELL OPERATOR

1914 Grant Bldg, Pittsburgh 19 Pa.

Littleton West Va.

ADDRESS

COMPLETE ADDRESS

and balance of 116 & 7/160 acres

October 17, 1949

owned by Everett F Moore

PROPOSED LOCATION

~~Coal Operator or Coal Owner~~
Moundsville West Va.

Way District

ADDRESS

Wetzel County

OWNER OF MINERAL RIGHTS

Well No. 1995 to be redrilled

ADDRESS

Mary A & W.H. Kimble Farm

GENTLEMEN:

The undersigned well operator is entitled to drill upon the above named farm or tract of land for oil and gas, having fee title thereto, (or as the case may be) under grant or lease dated Sept 20 1949, made by Mary A Kimble Heirs, to Kenneth Renner, and recorded on the 29th day of September 1949, in the office of the County Clerk for said County in Book 39A, page 293.

The enclosed plat was prepared by a competent engineer and shows the proposed location of a well to be drilled for oil and gas by the undersigned well operator on the farm and in the Magisterial District and County above named, determined by survey and courses and distances from two permanent points, or land marks.

The undersigned well operator is informed and believes there are no coal operators operating beds of coal beneath said farm or tract of land on which said well is located, or within 500 feet of the boundaries of the same, who have mapped their workings and filed their maps as required by law, excepting the coal operators or coal owners (if any) above named as addressees.

The above named coal operators or coal owners (if any) are notified that any objections they may desire to make to such proposed location, or which they are required to make by Section 3 of said Code, if the drilling of a well at said proposed location will cause a dangerous condition in or about their respective coal mines, must be received by, or filed with the Department of Mines within ten* days from the receipt of a copy of this notice and accompanying plat by said Department. Said coal operators are further notified that forms for use in making such objections will be furnished to them by the Department of Mines promptly on request and that all such objections must set forth as definitely as is reasonably possible the ground or grounds on which such objections are based and indicate the direction and distance the proposed location should be moved to overcome same.

(The next paragraph is to be completed only in Department's copy.)

Copies of this notice and the enclosed plat were mailed by registered mail, or delivered to the above named coal operators or coal owners at their above shown respective address _____ day before, or on the same day with the mailing or delivery of this copy to the Department of Mines at Charleston, West Virginia.

Very truly yours,

Kenneth Renner

WELL OPERATOR

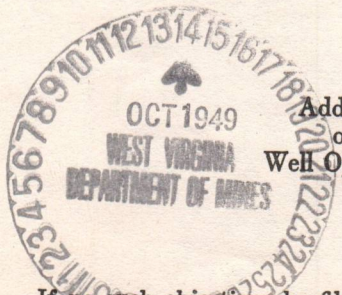

Address of Well Operator

STREET

Littleton West Va.

CITY OR TOWN

10/06/2023

STATE

*Section 3 If no such objections be filed or be found by the department of mines, within said period of ten days from the receipt of said notice and plat by the department of mines, to said proposed location, the department shall forthwith issue to the well operator a drilling permit reciting the filing of such plat, that no objections have been made by the coal operators to the location, or found thereto by the department, and that the same is approved and the well operator authorized to proceed to drill at said location.



STATE OF MISSISSIPPI
DEPARTMENT OF REVENUE
OIL AND GAS DIVISION

NOTICE OF PROPOSED LOCATION OF OIL AND GAS WELL

To the Landowner of the Tract
situated in the Parish of...

Honorable Johnnie
J. Harrison, Sheriff
Jefferson County, Mississippi

Know all men by these presents that the
land described in the above recited
instrument is owned by...

and is owned by Everett & Moore
and is situated in the Parish of...

Proposed Location

Mountainville West No. 1

to be located

in the Parish of...

The undersigned will locate the well on the above described land in accordance with the provisions of the laws of the State of Mississippi...

Johnnie Harrison
Sheriff

and the same was located in a certain...
in the Parish of...

It is hereby certified that the above described well is located on the above described land in accordance with the provisions of the laws of the State of Mississippi...

The undersigned hereby certifies that the above described well is located on the above described land in accordance with the provisions of the laws of the State of Mississippi...

Witness my hand and the seal of the Department of Revenue, Oil and Gas Division, at the City of Jackson, Mississippi, this... day of...

Johnnie Harrison
Sheriff

Johnnie Harrison

1914

10/06/2023

This document is a copy of the original and is not to be used as evidence in any court of law...

B-1

WEST VIRGINIA DEPARTMENT OF MINES
OIL AND GAS DIVISION

WELL RECORD

Permit No. 360

Oil or Gas Well Gas
(Kind)

Company The Manufacturers Light & Heat Co.
 Address 800 Union Trust Bldg., Pittsburgh, Pa.
 Farm W. H. Kimble Acres 1.10
 Location (waters) _____
 Well No. 1 - 1995 Elev. 1112 ft.
 District Clay County Wetzel
 The surface of tract is owned in fee by Agnes Hathaway
 Address Littleton, WVa.
 Mineral rights are owned by The Mfrs. Light & Heat Company
 Address Pittsburgh, Pa.
 Drilling commenced Sept. 20, 1916
 Drilling completed Nov. 9th, 1916
 Date shot _____ Depth of shot _____
 Open Flow 7/10ths Water in _____ Inch
7/10ths Merc. in 2" _____ Inch
 Volume _____ Cu. Ft.
 Rock Pressure _____ lbs. _____ hrs.
 Oil _____ bbls., 1st 24 hrs.
 Fresh water _____ feet _____ feet
 Salt water _____ feet _____ feet

Casing and Tubing	Used in Drilling	Left in Well	Packers
Size			
16			Kind of Packer
13			
10	217' 7"	215' 7"	Size of
8 1/4	1317' 11"	1317' 11"	
6 5/8	2943' 4"	2943' 4"	Depth set
5 3/16			
3	2982' 9"	2982' 9"	Perf. top
2			Perf. bottom
Liners Used			Perf. top
			Perf. bottom

CASING CEMENTED _____ SIZE _____ No. FT. _____ Date _____
 COAL WAS ENCOUNTERED AT 80 FEET 24 INCHES
484 FEET 108 INCHES 705 FEET 48 INCHES
812 FEET 72 INCHES _____ FEET _____ INCHES

Formation	Color	Hard or Soft	Top	Bottom	Oil Gas or Water	Depth Found	Remarks
Coal			80	82	Little water		
Sand			126	144			
Sand			347	356	215' - 10"		
Coal			484	493	Little Gas		
Mapletown Coal			705	709	" "		
Pittsburgh Coal			812	818	Steel line meas.		
Murphy Sand			930	998	Little gas at 935		
Little Dunkard sand			1217	1250			
Big Dunkard Sand			1317	1347	1317' - 8 1/4"		
Gas Sand			1475	1525			
1st Salt Sand			1581	1621	Gas 1586-and 1604		
Sand			1660	1685			
2nd Salt Sand			1795	1865			
Maxon Sand			1890	1920			
Little Lime			1935	2000			
Pencil Cave			2000	2010			
Big Lime			2019	2075			
Big Injun Sand			2075	2165			
Break in Big Injun			2165	2172			
Big Injun Sand			2172	2308			
30 Ft. Sand			2642	2665	2943' - 6 5/8		
Sand			2682	2702			
Gordon Sand			2872	2916	Gas 2909		
4th Sand			2948	2967	Gas 2947 and 2958		
Total depth				2967			

10/06/2023

B-2
Mannington N.W.



STATE OF WEST VIRGINIA
DEPARTMENT OF MINES
OIL AND GAS DIVISION

WELL RECORD

Permit No. WET-360

Oil or Gas Well One
(KIND)

Company <u>Kenneth Renner</u>	Casing and Tubing	Used in Drilling	Left in Well	Packers
Address <u>Littleton, W. Va.</u>	Size			
Farm <u>Mary A. & W. H. Kimble</u> Acres <u>140</u>	16			Kind of Packer
Location (waters) <u>Of Fish Creek</u>	13			
Well No. <u>#1</u> Elev. <u>1112</u>	10			Size of
District <u>Clay</u> County <u>Wetzel</u>	8 1/4	<u>520</u>		Depth set
The surface of tract is owned in fee by <u>Mary A. & W. H. Kimble Heirs</u> Address _____	6%			Perf. top
Mineral rights are owned by <u>Mary A. & W.H. Kimble Heirs</u> Address _____	5 3/16	<u>1500</u>		Perf. bottom
Drilling commenced <u>11/1/49</u>	3			Perf. top
Drilling completed <u>3/1/50</u>	2			Perf. bottom
Date Shot _____ From _____ To _____	Liners Used			
With _____				
Open Flow <u>30</u> /10ths Water in _____ <u>One</u> Inch				
_____ /10ths Merc. in _____ Inch	CASING CEMENTED	SIZE	No. Ft.	Date
Volume <u>57.730</u> Cu. Ft.				
Rock Pressure <u>230</u> lbs. <u>17</u> hrs.	COAL WAS ENCOUNTERED AT	FEET	INCHES	
Oil <u>None</u> bbls., 1st 24 hrs.	_____ FEET	_____ INCHES	_____ FEET	_____ INCHES
Fresh water _____ feet _____ feet	_____ FEET	_____ INCHES	_____ FEET	_____ INCHES
Salt water _____ feet _____ feet				

Formation	Color	Hard or Soft	Top	Bottom	Oil, Gas or Water	Depth Found	Remarks
Red Mud			Surface	60			
Cement			60	110			
Red Mud			110	464			
Cement			464	533			
Red Mud			533	685			
Cement			685	729			
Red Mud			729	792			
Cement			792	848			
Bridge			848				
Red Mud			930	998			
Bridge			998				
Red Mud			1217	1257			
Wood Plug			1257	1260			
Bridge			1260				
Red Mud			1660	1920			
Bridge			1920				
Wood Plug			2072	2075			
Red Mud			2075	2308			
Bridge			2308				
Wood Plug			2639	2642			
Red Mud			2642	2859			
Cement			2859	2869			
Wood Plug			2869	2872			
Red Mud			2872	2945			
Wood Plug			2945	2948			
Red Mud			2948	2967			
4th Sand			2948	2967			
Total depth				2967			

Casing already in hole
 99'-8" 10" casing
 810'-10" 8 1/4" casing
 406'-11" 6 5/8" casing
 This casing in addition to above amount shown

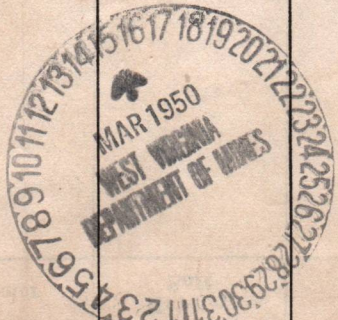

STATE OF WEST VIRGINIA
DEPARTMENT OF MINES
OIL AND GAS DIVISION

INSPECTOR'S WELL REPORT

Permit No. *Wetzel 287*

Oil or Gas Well. *Plug*
(KIND)

Company	Casing and Tubing	Used in Drilling	Left in Well	Packers
<i>Mfg. Light & Heat Co.</i>	Size			
<i>Pittsburgh Pa.</i>	16			Kind of Packer
<i>W.H. & Mary Kinble</i>	13			
Well No. <i>1995</i>	10			Size of
District <i>Clay</i> County <i>Wetzel</i>	8 1/4			
Drilling commenced	6 5/8			Depth set
Drilling completed	5 3/16			
Date shot	3			Perf. top
Initial Open Flow	2			Perf. bottom
Open Flow after tubing	Liners Used			Perf. top
Volume				Perf. bottom
Rock Pressure	CASING CEMENTED	SIZE	No. FT.	Date
Oil	COAL WAS ENCOUNTERED AT	FEET	INCHES	
Fresh water	FEET	INCHES	FEET	INCHES
Salt water	FEET	INCHES	FEET	INCHES

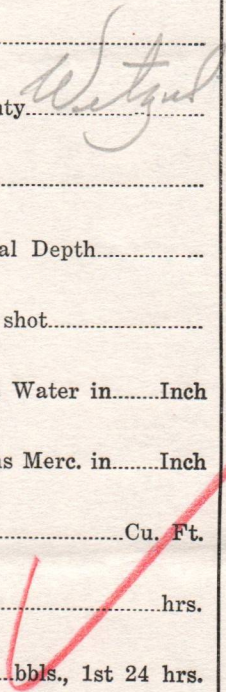

Drillers' Names

Well Abandoned and Plugged, 19

REMARKS:

Completed Feb 7, 1939



Feb. 14, 1939

DATE

D. H. ...

DISTRICT WELL INSPECTOR

10/06/2023

A-9

THE MANUFACTURERS LIGHT AND HEAT COMPANY

800 UNION TRUST BUILDING

PITTSBURGH, PENNSYLVANIA

January 6th, 1939.

IN RE - Lease 2703 (Well 1-1995)
Clay District
Wetzel County, W. Va.

Department of Mines,
Oil and Gas Section,
Charleston, W. Va.

Gentlemen:

We are enclosing "Well Record" and "Notice of Intention to Plug and Abandon Well", both in duplicate; also tracing marked Y-8-181 showing the location of the above numbered gas well on the Mary A. Kimble farm, which we wish to abandon.

Very truly yours,

THE MANUFACTURERS LIGHT & HEAT COMPANY,

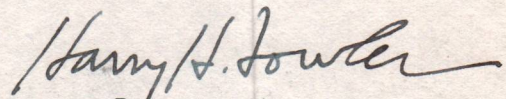

Land Department
Office Manager.

-0-

10/06/2023

As 10

October 17, 1949

The Burton Coal Company
1914 Grant Building
Pittsburgh 19, Pennsylvania

Gentlemen:

We are in receipt of notice to redrill Well No. 1995 on the Mary A. and W. H. Kimble Farm, Clay District, Wetzel County by Mr. Kenneth Renner, Littleton, West Virginia.

This well was abandoned February 9, 1949 by the Manufacturers Light & Heat Company, Pittsburgh, Pennsylvania and, no doubt, a copy of the map of location was filed with you at the time of abandonment. Since the present application is to redrill the well, there is no change of location. If, however, the drilling will interfere with present or projected mining, please notify this office on or before October 27, 1949.

Very truly yours,

Administrative Assistant
OIL AND GAS DIVISION

MG:g

10/06/2023

A-11

October 27, 1949

Mr. Kenneth Renner
Littleton, West Virginia

Dear Mr. Renner:

Enclosed is permit WET-360-R to redrill
Well No. 1995 on the Mary A. & W. H. Kimble Farm, Clay
District, Wetzel County.

Very truly yours,

Administrative Assistant
OIL AND GAS DIVISION

CNH:K
Encl-2

CC: Inspector Oliver W. Lineberg

10/06/2023

B-9
PROPOSED MANNER OF PLUGGING AND FILLING WELL

(REQUIRED BY RULES AND REGULATIONS)

WEST VIRGINIA DEPARTMENT OF MINES

OIL AND GAS DIVISION

WORK ORDER

Well to be plugged and filled as follows:

Total Depth	2967'
Red Mud	2967- 2948
Wood Plug	2948- 2945
Red Mud	2945- 2872
Wood Plug	2872- 2869
Cement	2869- 2859
Red Mud	2859- 2642
Wood Plug	2642- 2639
Bridge	2308
Red Mud	2308 -2075
Wood Plug	2075 -2072 Lift 6 5/8" Casing at 2075'
Bridge	1920
Red Mud	1920 -1660
Bridge	1260
Wood Plug	1260 -1257 Lift 8 1/4" Casing at 1250'
Red Mud	1257 -1217
Bridge	998
Red Mud	998 -930
Bridge	848
Cement	848 -792 30' Below Pittsburgh Coal 20' Above Pgh. Coal
Red Mud	792 -729
Cement	729 -685
Red Mud	685 -533
Cement	533 -464
Red Mud	464 -110 Lift 10" Casing 215'
Cement	110 - 60
Red Mud	60 - To Surface

Marker to be erected as per rule No. 18

WORK ORDER INTERPOSED BY THE DEPARTMENT OF MINES.

Same as above to 1920'

Fill with red clay 1920' - 1561' - 20' above 1st Salt Sand.

Wood Plug 1561' - 1558'

Cement 1558' - 1548' - sealing off Salt Sands.

Continue to fill 1548' - 1327' - 10' below 8 1/4" Casing.

Wood Plug 1327' - 1324'

To the Department of Mines, Cement 1324' -1319' - sealing hole completely.

Coal Owner or Operator, Set a permanent bridge at 848' - 30' below Pittsburgh Coal.

Lease or Property Owner, Cement 848' - 792' - 20' above Pittsburgh Coal

Complete as in original work order.

Gentlemen:

This "work order" is submitted for your approval and concurrence and unless notified of your disapproval or non-concurrence, the undersigned will proceed with the plugging and filling of said well in the above described manner on the date stated in the notice of intention to plug and abandon the said well on opposite side of this sheet.

Very truly yours, THE MANUFACTURERS LIGHT & HEAT CO.,

Harry H. Fowler
Land Dept. Office Mgr. Well Operator.

No objections have been filed by the coal owner or coal operator, or any available adjacent lease or property owners or interposed by the Department of Mines to the manner herein described for the plugging and filling of the well above mentioned. Therefore, the same is hereby approved this 7th day

of January 9, 1939

DEPARTMENT OF MINES
Oil and Gas Division

10/06/2023

By:

NOTE: This "work order" must be filed in duplicate, one copy for the files of the Department of Mines and the other to be approved or corrected and returned to the well operator as his authority for plugging said well.

NOTICE OF INTENTION TO PLUG AND ABANDON WELL

(REQUIRED BY SECTION 9, ARTICLE 4, CHAPTER 22 OF THE CODE)

WEST VIRGINIA DEPARTMENT OF MINES

OIL AND GAS DIVISION

To THE DEPARTMENT OF MINES,
Charleston, W. Va.

T. J. Rogerson

COAL OPERATOR OR COAL OWNER

Moundsville, W. Va.

ADDRESS

COAL OPERATOR OR COAL OWNER

ADDRESS

LEASE OR PROPERTY OWNER

ADDRESS

The Manufacturers Light & Heat Co

NAME OF WELL OPERATOR

800 Union Trust Building

Pittsburgh, Penna.

COMPLETE ADDRESS

January 6th,

19 39

WELL TO BE ABANDONED

Clay

District

Wetzel

County

Well No. 1995

39° 45'

80° 25'

130 acres

M.H. & Mary Kimble

Farm

Gentlemen:—

The undersigned well operator is about to abandon the above described well and will commence the work of plugging and abandoning said well on the 13th day of January, 19 39, (which date shall not be less than five days after the day on which this notice so mailed is received, or in due course should be received by the Department of Mines).

This notice is given you in order that your respective representatives may be present at the plugging and filling of said well. You are further notified that whether you are represented or not represented the undersigned will proceed on that date, or shortly thereafter, to plug and fill said well in the manner required by Section 10, Article 4, Chapter 22 of the Code and given in detail on the reverse side of this notice, in "Work Order."

This notice is being mailed by registered mail to each of you at the above addresses on the above date.

Very truly yours, THE MANUFACTURERS LIGHT & HEAT CO.,

Harry H. Fowle
Land Dept. Office Manager Well Operator.

NOTE: Upon the abandonment of all wells drilled prior to June 1, 1929, a plat prepared by a competent engineer, showing the district and county in which the tract of land is located, the name and acreage of the names of the owners of adjacent tracts, and the location of the about to be abandoned well, determined by survey, and the courses and distances of such well from two permanent points or landmarks on said tract, shall be submitted with this notice.

(Over)

WET-287

87

10/06/2023

AFFIDAVIT IN TRIPLICATE TO TIME AND MANNER OF PLUGGING AND FILLING WELL

(REQUIRED BY SECTION 9, ARTICLE 4, CHAPTER 22 OF THE CODE)

**WEST VIRGINIA DEPARTMENT OF MINES
OIL AND GAS DIVISION**

T. L. Rogerson

COAL OPERATOR OR OWNER

Moundsville, W. Va.

ADDRESS

COAL OPERATOR OR OWNER

ADDRESS

COAL OPERATOR OR OWNER

ADDRESS

The Manufacturers Light & Heat Co.

NAME OF WELL OPERATOR

800 Union Trust Bld'g. Pittsburgh Pa.

COMPLETE ADDRESS

Feb. 27th. 1939

19

WELL AND LOCATION

Clay

District

Wetzel

County

Well No. 1995

W.H. & M.A. Kimble

Farm

AFFIDAVIT TO BE MADE IN TRIPLICATE, ONE COPY TO BE MAILED BY REGISTERED MAIL TO THE DEPARTMENT, ONE COPY TO BE RETAINED BY THE WELL OPERATOR AND THE THIRD COPY (AND EXTRA COPIES IF REQUIRED) TO BE MAILED TO EACH COAL OPERATOR ABOVE NAMED AT THEIR RESPECTIVE ADDRESSES.

AFFIDAVIT

STATE OF WEST VIRGINIA,

COUNTY OF Wetzel

SS:

Levi J. Church

and

Josiah Church

being first duly sworn according to law depose and say that they are experienced in the work of plugging

and filling oil and gas wells and were employed by The Manufacturers Light & Heat Co, well operator, and participated in the work of plugging and filling the above well, that said work was commenced on the

10th day of January, 1939, and that the well was plugged and filled in the following manner:

Manner in which sand was plugged: Red mud 2967-2948, Wood plug 2948-2945, Red mud 2945-2872, Wood plug 2872-2869, Cement 2869-2859, Red mud 2859-2642, Wood plug 2642-2639, Bridge @ 2308, Red mud 2308-2075, Wood plug 2075-2072, Lifted 6 5/8" Casing and drove lead plug @ 2080, Bridge @ 1920, Red mud 1920-1561, Wood plug 1561-1558, Cement 1558-1548, Red mud 1548-1327, Wood plug 1327-1324, Cement 1324-1319, Bridge @ 848.

Manner in which coal was plugged: Cement 848-792, Red mud 792-729, Cement 729-685, Red mud 685-533, Cement 533-464, Red mud 464-110, Lifted 10" Casing, Cement 110-60, Red mud 60 to Surface.

Description of monument: Erected marker as per rule # 18

(THE ABOVE DESCRIPTIONS MUST BE IN DETAIL AND IN ACCORDANCE WITH THE PROVISIONS OF SECTION 10, ARTICLE 4, CHAPTER 22 OF THE CODE)

and that the work of plugging and filling said well was completed on the 9th day of February, 1939.

And further deponents saith not.

Levi J Church

Josiah Church

10/06/2023

Sworn to and subscribed before me this 6th day of March, 1939

Andy Church

Notary Public.

My Commission expires:

May - 16, 1940



Net-287

WEST VIRGINIA DEPARTMENT OF MINES
OIL AND GAS DIVISION
AFFIDAVIT IN TRIPLICATE TO TIME AND MANNER OF
PLUGGING AND FILLING WELL
(REQUIRED BY SECTION 2, ARTICLE 4, CHAPTER 22 OF THE CODE)

NAME OF WELL OPERATOR: The Manufacturers Light & Heat Co.
 COMPLETE ADDRESS: 800 Union Trust Bldg., Pittsburgh, Pa.
 DATE: Feb. 27th. 1933

NAME OF WELL OPERATOR: T. L. Rogerson
 COMPLETE ADDRESS: Mountsville, W. Va.
 DATE: Feb. 27th. 1933

NAME OF WELL OPERATOR: W. H. & M. A. Kimple
 COMPLETE ADDRESS: [illegible]
 DATE: Feb. 27th. 1933

AFFIDAVIT TO BE MADE IN TRIPLICATE ONE COPY TO BE MAILED BY REGISTERED MAIL TO THE DEPARTMENT. ONE COPY TO BE RETAINED BY THE WELL OPERATOR AND THE THIRD COPY (AND EXTRA COPIES IF REQUIRED) TO BE MAILED TO EACH COAL OPERATOR ABOVE NAMED AT THEIR RESPECTIVE ADDRESSES.

AFFIDAVIT

STATE OF WEST VIRGINIA
 County of Wetzel
 I, Levi J. Givens and Joel J. Church
 being first duly sworn according to law depose and say that they are experienced in the work of plugging and filling oil and gas wells and were employed by The Manufacturers Light & Heat Co. Well operator, and participated in the work of plugging and filling the above well, that said work was commenced on the 10th day of January, 1933, and that the well was plugged and filled in the following manner:

Manner in which sand was plugged: Wood plug 1327-1331, Cement 1331-1319, Bridge @ 818, Red mud 1320-1320, Red mud 1320-1321, Wood plug 1321-1328, Cement 1328-1319, Red mud 1319-1327, Red mud 2302-2075, Wood plug 2075-2075, Lined 6" casing and drive lead plug @ 2030, Wood plug 2302-2075, Cement 2075-2075, Red mud 2075-2075, Wood plug 2075-2075, Bridge @ 2302, Wood plug 2302-2075, Cement 2075-2075, Red mud 2075-2075, Wood plug 2075-2075, Bridge @ 2302, Red mud 2302-2075, Wood plug 2075-2075, Lined 6" casing and drive lead plug @ 2030.

Manner in which coal was plugged: Cement 818-732, Red mud 732-732, Cement 732-685, Red mud 685-552, Cement 552-441, Red mud 441-110, Lined 10" casing, Cement 110-60, Red mud 60 to surface.

Description of monument: Erected marker as per rule # 18

(THE ABOVE DESCRIPTIONS MUST BE IN DETAIL AND IN ACCORDANCE WITH THE PROVISIONS OF SECTION 10, ARTICLE 4, CHAPTER 22 OF THE CODE)

and that the work of plugging and filling said well was completed on the 27th day of February, 1933.

Sworn to and subscribed before me this 10th day of February, 1933.

Notary Public: [Signature]

My Commission expires: [illegible]



10/06/2023

E-5

Sept 8-1949

Dept of mines
Charleston W. Va.

I am writing for a permit to
clean out a gas well
or information on where
or how to obtain one

Respectfully Yours

Kenneth Renner
Littleton

W. Va.

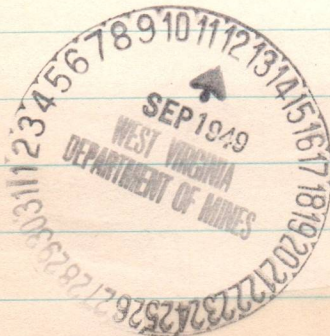

E-4



STATE OF WEST VIRGINIA
DEPARTMENT OF MINES
CHARLESTON

ARCH J. ALEXANDER
CHIEF

September 12, 1949

Mr. Kenneth Renner
Littleton, West Virginia

Dear Sir:

We are in receipt of your inquiry of September 8th regarding permit for cleaning out a well.

Your letter is not exactly clear as to your meaning. If the well, to which you refer, has been plugged and you wish to re-open it, this would be a job of re-drilling and a tracing of the well's location and application to re-drill, should be filed in this office. However, if this is a well which has ceased operating because it has not been kept in proper condition, then it will not be necessary to have a permit for the work, provided that it is not to be deepened. If the well is to be drilled deeper, then the same data must be filed as in the case of re-drilling.

Very truly yours,

C. Hall
Administrative Assistant
OIL AND GAS DIVISION.

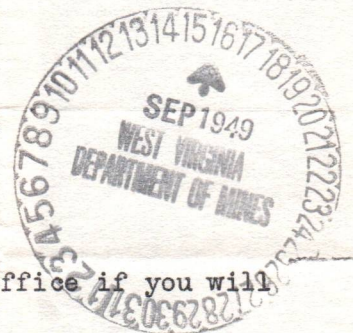

CNH:g

P. S. Forms can be obtained from this office if you will advise us in more detail.

CNH

Sept. 14 - 1949

Sir's in reply to your inquiry will say the well has been plugged for ten years and I want to redrill it and a permit for same and the well isn't to be drilled any deeper and please send me a form for redrilling Many Thanks Kenneth D Renner Littleton W Va

10/06/2023



STATE OF WEST VIRGINIA
DEPARTMENT OF MINES
CHARLESTON

ARCH J. ALEXANDER
CHIEF

1995

September 16, 1949

Mr. Kenneth Renner
Littleton, West Virginia

Dear Sir:

Enclosed is form OG-1 which please fill in completely and after the well number, show that the well is to be redrilled.

We note you state that this well was plugged about ten years ago. In this case, we, no doubt, have a tracing of the location. Please give us the following data so that it can be located in the files. If we have it, you will not need to have another map prepared.

1. Name of operator who abandoned the well. Mfg Light & Heat Co.
2. Well No. Serial No. 1995
3. Name of farm on which well is located Mary A & W.H. Kimble
4. District and County. Clay District, Wetzel County.

Very truly yours,

C.N. Hall
Administrative Assistant
OIL AND GAS DIVISION

MG:g
encl





State of West Virginia
DEPARTMENT OF MINES
CHARLESTON

September 10, 1943

APR 11 1943

Mr. Robert Henson
Martinsburg, West Virginia

Dear Sir:

Enclosed is form O-1 which please fill in completely and after the well number, show what the well is to be drilled.

We hope you state that this well was drilled about ten years ago. In this case, we do not have a record of the location. Please give the following data as far as you can find in the files. If you have it, you will not need to have another set prepared.

1. Name of operator who abandoned the well - Mr. W. H. Light & Son, Inc. No. 1000
2. Name of farm on which well is located - Mrs. A. W. H. Light, District and County, Clay District, Mineral County.

Very truly yours,

William
Assistant
Oil and Gas Division

1015
1943

A-12

February 24, 1950

Mr. Kenneth Renner
Littleton, West Virginia

Dear Sir:

Please send us two copies of the well record for the redrilling of Well No. 1995 on the Mary A. and W. H. Kimble Farm, Clay District, Wetzel County for which permit WET-360 was issued October 27, 1949.

Blanks are enclosed and we would appreciate a prompt reply so that this information can be included in the 1949 Annual Report.

Very truly yours,

Administrative Assistant
OIL AND GAS DIVISION

MG:g
encl

cc: Oliver W. Lineberg, Inspector

10/06/2023

0 1 2 3

Latitude 39 ° 45 '

Longitude 80 ° 25 '

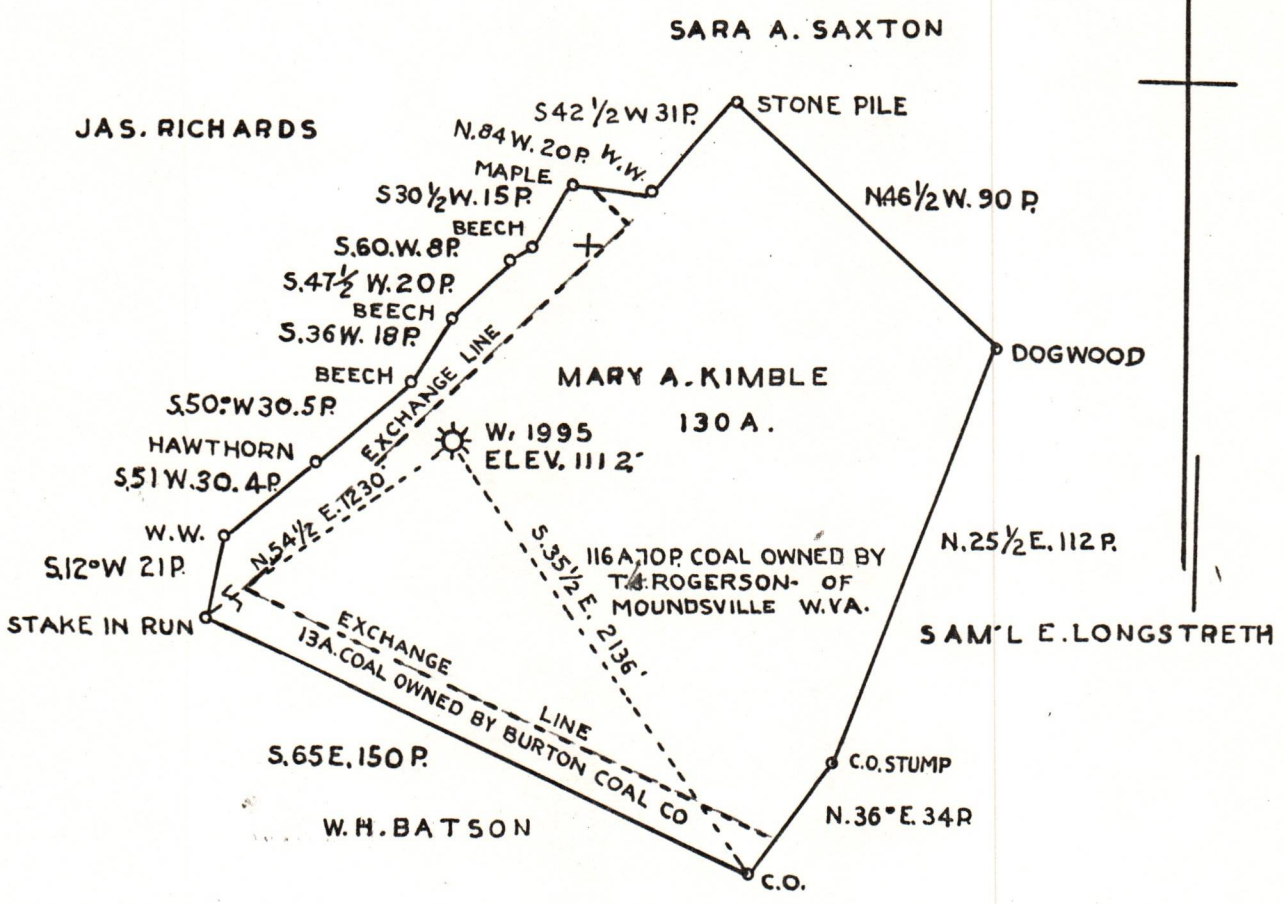

WELL ABANDONMENT
TO BE REDRILLED

KENNETH RENNER
 Company ~~THE MANUFACTURERS LIGHT & HEAT CO~~
 Address 800 UNION TRUST BLDG. PITTSBURGH PA
 Farm MARY A. KIMBLE
 Tract _____ Acres 130 Lease No. 2703
 Well (Farm) No. 1 Serial No. 1995
 Elevation (Spirit Level) 1112'
 Quadrangle MANNINGTON N.W. 1/4
 County WETZEL District CLAY
 Engineer *Kenneth Renner*
 Engineer's Registration No. _____
 File No. _____ Drawing No. Y-8-181
 Date DECEMBER 29-38 Scale 1" = 800'

STATE OF WEST VIRGINIA
DEPARTMENT OF MINES
OIL AND GAS DIVISION
CHARLESTON

WELL LOCATION MAP

FILE NO. *Wet - 360-Redrill* 10/06/2023

+ Denotes location of well on United States Topographic Maps, scale 1 to 62,500, latitude and longitude lines being represented by border lines as shown.

- Denotes one inch spaces on border line of original tracing.