



STATE OF WEST VIRGINIA
DEPARTMENT OF MINES
OIL AND GAS DIVISION

NOTICE OF PROPOSED LOCATION OF OIL AND GAS WELL

To THE DEPARTMENT OF MINES,
Charleston, W. Va.

BERTHA COAL HOLDING COMPANY

COAL OPERATOR OR COAL OWNER

% Robinson & Robinson

UNIONTOWN, PA.

ADDRESS

OWNERS of MINERAL RIGHTS:

EUNICE CAIN, 63 Linden Ave.,

~~COAL OPERATOR OR COAL OWNER~~

Moundsville, W.Va.

AUSTIN CAIN, 619 Rear 16th St.,

~~ADDRESS~~ Huntington, W.Va.

RUSSELL C. CAIN, U.S. Army.

MARTHA and NORWOOD CAIN,

~~OWNERS OF MINERAL RIGHTS~~

404 1/2 Wooster Rd., Barberten, Ohio

MARGUERITE, KENNETH and MARY CAIN,

Rt. #2, ~~ADDRESS~~ Cameron, W.Va.

CARNEGIE NATURAL GAS COMPANY

NAME OF WELL OPERATOR

1015 Frick Building

PITTSBURGH, PA.

COMPLETE ADDRESS

SEPTEMBER 25, 1945

PROPOSED LOCATION

CENTER District

WETZEL County

Well No. 1625 ^{390 35'} _{80' 30'}

J. J. JOHNSON & L. E. CAIN Farm

GENTLEMEN:

The undersigned well operator is entitled to drill upon the above named farm or tract of land for oil and gas, having fee title thereto, (or as the case may be) under grant or lease dated NOVEMBER 5, 1928, made by J. J. JOHNSON and L. E. CAIN, to CARNEGIE NATURAL GAS COMPANY, and recorded on the 1st day of DECEMBER, 1928, in the office of the County Clerk for said County in Book 22-A, page 281.

The enclosed plat was prepared by a competent engineer and shows the proposed location of a well to be drilled for oil and gas by the undersigned well operator on the farm and in the Magisterial District and County above named, determined by survey and courses and distances from two permanent points, or land marks.

The undersigned well operator is informed and believes there are no coal operators operating beds of coal beneath said farm or tract of land on which said well is located, or within 500 feet of the boundaries of the same, who have mapped their workings and filed their maps as required by law, excepting the coal operators or coal owners (if any) above named as addressees.

The above named coal operators or coal owners (if any) are notified that any objections they may desire to make to such proposed location, or which they are required to make by Section 3 of said Code, if the drilling of a well at said proposed location will cause a dangerous condition in or about their respective coal mines, must be received by, or filed with the Department of Mines within ten* days from the receipt of a copy of this notice and accompanying plat by said Department. Said coal operators are further notified that forms for use in making such objections will be furnished to them by the Department of Mines promptly on request and that all such objections must set forth as definitely as is reasonably possible the ground or grounds on which such objections are based and indicate the direction and distance the proposed location should be moved to overcome same.

(The next paragraph is to be completed only in Department's copy.)

Copies of this notice and the enclosed plat were mailed by registered mail, or delivered to the above named coal operators or coal owners at their above shown respective address _____ day _____ before, or on the same day with the mailing or delivery of this copy to the Department of Mines at Charleston, West Virginia.

Very truly yours,

CARNEGIE NATURAL GAS COMPANY,

By B. N. Archer
WELL OPERATOR Land Agent.

1015 FRICK BUILDING

STREET

PITTSBURGH

CITY OR TOWN

PENNSYLVANIA

STATE

10/06/2023



Address of Well Operator }

*Section 3 If no such objections be filed or be found by the department of mines, within said period of ten days from the receipt of said notice and plat by the department of mines, to said proposed location, the department shall forthwith issue to the well operator a drilling permit reciting the filing of such plat, that no objections have been made by the coal operators to the location, or found thereto by the department, and that the same is approved and the well operator authorized to proceed to drill at said location.



STATE OF WEST VIRGINIA
DEPARTMENT OF MINES
OIL AND GAS DIVISION

NOTICE OF PROPOSED LOCATION OF OIL AND GAS WELL

To The Department of Mines,
Charleston, W. Va.

CARNEGIE NATURAL GAS COMPANY
NAME OF WELL OPERATOR
1015 FRICK BUILDING
PITTSBURGH, PA.
COMPLETE ADDRESS
PROPOSED LOCATION
SEPTEMBER 25, 1915
DISTRICT
COUNTY
WETZEL
Well No. 1625
Farm
J. J. JOHNSON & L. E. CAIN

BETHA COAL HOLDING COMPANY
COAL OPERATOR OR COAL OWNER
Robinson & Robinson
WINTERTOWN, PA.
ADDRESS
OWNERS OF MINERAL RIGHTS:
RUSSELL C. CAIN, U.S. Army,
MARtha and WOODROO CAIN,
1015 WOODRUM RD., BARBERTON, OHIO
MARGUERITE, KENNETH and MARY CAIN,
Rt. #2, Xenia, Gamerton, W. Va.

The undersigned well operator is entitled to drill upon the above named farm or tract of land for oil and gas having fee title thereto, (or as the case may be) under grant or lease dated NOVEMBER 2, 1928 made by J. J. JOHNSON and L. E. CAIN to CARNEGIE NATURAL GAS COMPANY, and recorded on the 1st day of DECEMBER, 1928, in the office of the County Clerk for said County in Book 22-A, page 281.

The enclosed plat was prepared by a competent engineer and shows the proposed location of a well to be drilled for oil and gas by the undersigned well operator on the farm and in the Magisterial District and County above named, determined by survey and courses and distances from two permanent points, or land marks. The undersigned well operator is informed and believes there are no coal operators operating beds of coal beneath said farm or tract of land on which said well is located, or within 500 feet of the boundaries of the same, who have mapped their workings and filed their maps as required by law, excepting the coal operators or coal owners (if any) above named as addressees. The above named coal operators or coal owners (if any) are notified that any objections they may desire to make to such proposed location, or which they are required to make by Section 8 of said Code, if the drilling of a well at said proposed location will cause a dangerous condition in or about their respective coal mines must be received by, or filed with the Department of Mines within ten days from the receipt of a copy of this notice and accompanying plat by said Department. Said coal operators are further notified that forms for use in making such objections will be furnished to them by the Department of Mines promptly on request and that all such objections must set forth as definitely as is reasonably possible the ground or grounds on which such objections are based and indicate the direction and distance the proposed location should be moved to overcome same.

(The next paragraph is to be completed only in Department's copy.) Copies of this notice and the enclosed plat were mailed by registered mail, or delivered to the above named coal operators or coal owners at their above shown respective address _____ day before _____ or on the same day with the mailing or delivery of this copy to the Department of Mines at Charleston, West Virginia.

Very truly yours,
CARNegie NATURAL GAS COMPANY,
BY _____
WELL OPERATOR Land Agent,
1015 FRICK BUILDING
PITTSBURGH
PENNSYLVANIA

Address of Well Operator



10/06/2023

Section 8. If no such objections be filed or be found by the department of mines, within said period of ten days from the receipt of said notice and plat by the department of mines, to said proposed location, the department shall forthwith issue to the well operator a drilling permit reciting the filing of such plat, that no objections have been made by the coal operators to the location, or found hereby by the department, and that the same is approved and the well operator authorized to proceed to drill at said location.



STATE OF WEST VIRGINIA
DEPARTMENT OF MINES
OIL AND GAS DIVISION

NOTICE OF PROPOSED LOCATION OF OIL AND GAS WELL

To THE DEPARTMENT OF MINES,
Charleston, W. Va.

COAL OPERATOR OR COAL OWNER

ADDRESS

COAL OPERATOR OR COAL OWNER

ADDRESS

OWNER OF MINERAL RIGHTS

ADDRESS

THE MANUFACTURERS LIGHT AND HEAT COMPANY

NAME OF WELL OPERATOR
800 Union Trust Building
Pittsburgh, Pennsylvania

COMPLETE ADDRESS
October 20, 19 54

PROPOSED LOCATION
Center District
Wetzel County

Well No. F-23180

Eunice Cain, Agt. Farm

GENTLEMEN:

The undersigned well operator is entitled to drill upon the above named farm or tract of land for oil and gas, having fee title thereto, (or as the case may be) under grant or lease dated _____ March 29, 1952, made by Eunice Cain, et al, to The Manufacturers Light and Heat Company, and recorded on the 23rd day of May, 1952, in the office of the County Clerk for said County in Book 40-A, page 123.

The enclosed plat was prepared by a competent engineer and shows the proposed location of a well to be drilled for oil and gas by the undersigned well operator on the farm and in the Magisterial District and County above named, determined by survey and courses and distances from two permanent points, or land marks.

The undersigned well operator is informed and believes there are no coal operators operating beds of coal beneath said farm or tract of land on which said well is located, or within 500 feet of the boundaries of the same, who have mapped their workings and filed their maps as required by law, excepting the coal operators or coal owners (if any) above named as addressees.

The above named coal operators or coal owners (if any) are notified that any objections they may desire to make to such proposed location, or which they are required to make by Section 3 of said Code, if the drilling of a well at said proposed location will cause a dangerous condition in or about their respective coal mines, must be received by, or filed with the Department of Mines within ten* days from the receipt of a copy of this notice and accompanying plat by said Department. Said coal operators are further notified that forms for use in making such objections will be furnished to them by the Department of Mines promptly on request and that all such objections must set forth as definitely as is reasonably possible the ground or grounds on which such objections are based and indicate the direction and distance the proposed location should be moved to overcome same.

(The next paragraph is to be completed only in Department's copy.)

Copies of this notice and the enclosed plat were mailed by registered mail, or delivered to the above named coal operators or coal owners at their above shown respective address _____ day before, or on the same day with the mailing or delivery of this copy to the Department of Mines at Charleston, West Virginia.

Very truly yours,

Eunice Cain
LAND AGENT

THE MANUFACTURERS LIGHT AND HEAT COMPANY

STREET
800 UNION TRUST BUILDING
CITY OR TOWN
PITTSBURGH, PENNSYLVANIA
STATE

Address of Well Operator }

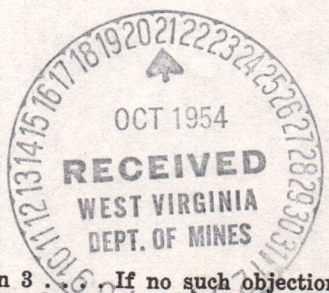

10/06/2023

*Section 3. If no such objections be filed or be found by the department of mines, within said period of ten days from the receipt of said notice and plat by the department of mines, to said proposed location, the department shall forthwith issue to the well operator a drilling permit reciting the filing of such plat, that no objections have been made by the coal operators to the location, or found thereto by the department, and that the same is approved and the well operator authorized to proceed to drill at said location.

Wet-330-Redhill



STATE OF WEST VIRGINIA
DEPARTMENT OF MINES
OIL AND GAS DIVISION

NOTICE OF PROPOSED LOCATION OF OIL AND GAS WELL

To The Department of Mines
Charleston, W. Va.

THE MANUFACTURERS LIGHT AND HEAT COMPANY

NAME OF WELL OPERATOR
800 Union Trust Building
Pittsburgh, Pennsylvania

COAL OPERATOR OR COAL OWNER

ADDRESS

October 20, 1952

PROPOSED LOCATION

COAL OPERATOR OR COAL OWNER

District

Center

ADDRESS

County

Waynes

OWNER OR MINERAL RIGHTS

Well No. T-23100

Farm

Twine Cain, Agt.

ADDRESS

GENTLEMEN:

The undersigned well operator is entitled to drill upon the above named farm or tract of land for oil and gas having fee title thereto, (or as the case may be) under grant or lease dated March 29, 1922, made by Twine Cain, et al. to The Manufacturers Light and Heat Company, and recorded on the 23rd day of May, 1922, in the office of the County Clerk for said County in Book 40-A, page 483.

The enclosed plat was prepared by a competent engineer and shows the proposed location of a well to be drilled for oil and gas by the undersigned well operator on the farm and in the Mineral District and County above named, determined by survey and courses and distances from two permanent points or land marks.

The undersigned well operator is informed and believes there are no coal operators operating beds of coal beneath said farm or tract of land on which said well is located, or within 500 feet of the boundary of the same, who have mapped their workings and filed their maps as required by law, excepting the coal operators or coal owners (if any) above named as addressees.

The above named coal operators or coal owners (if any) are notified that any objections they may desire to make to such proposed location, or which they are required to make by Section 3 of said Code, if the drilling of a well at said proposed location will cause a dangerous condition in or about their respective coal mines, must be received by or filed with the Department of Mines within ten days from the receipt of a copy of this notice and accompanying plat by said Department. Said coal operators are further notified that forms for use in making such objections will be furnished to them by the Department of Mines promptly on request and that all such objections must set forth as definitely as is reasonably possible the ground or grounds on which such objections are based and indicate the direction and distance the proposed location should be moved to overcome same.

(The next paragraph is to be completed only in Department's copy.)
Copies of this notice and the enclosed plat were mailed by registered mail or delivered to the above named coal operators or coal owners at their above shown respective address _____ day _____ before, or on the same day with the mailing or delivery of this copy to the Department of Mines at Charleston, West Virginia.

V. J. [Signature]
LAND AGENT

THE MANUFACTURERS LIGHT AND HEAT COMPANY

800 UNION TRUST BUILDING

PITTSBURGH, PENNSYLVANIA

Address of Well Operator

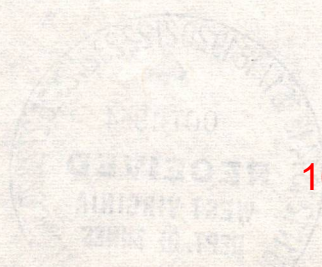

10/06/2023

Section 3, Code, 1941, if no such objections be filed or be found by the department of mines within said period of ten days from the receipt of this notice and plat by the department of mines, to said proposed location, the department shall forthwith issue to the well operator a drilling permit permitting the filing of such plat, that no objections have been made by the coal operators to the location, or found thereby by the department, and that the same is approved and the well operator authorized to proceed to drill at said location.

Permit Number WET-330-H

A-90
October 6, 1945

Carnegie Natural Gas Company
1015 Frick Building
Pittsburgh, Pennsylvania

Gentlemen:

Enclosed is permit WET-330 to drill Well
No. 1625 on the J. J. Johnson and L. E. Cain Farm,
Center District, Wetzel County.

Very truly yours,

Engineer
OIL AND GAS DIVISION

JEB:K
Encl-2

CC: Inspector D. F. Desist

10/06/2023



THE MANUFACTURERS LIGHT AND HEAT COMPANY
800 UNION TRUST BUILDING • PITTSBURGH 19 • PENNSYLVANIA

October 20, 1954

RE * Lease 26544, Foreign Well 23180
Center District, Wetzel County,
West Virginia

Department of Mines
Oil and Gas Division
Charleston, West Virginia

Gentlemen:

We are enclosing, in duplicate, 'Notice of Proposed Location of Gas Well', as above numbered on the Eunice Cain farm of 80 acres, being formerly operated by the Carnegie Natural Gas Company. Your department issued permit WET-330 to Carnegie for the drilling of this well. It is our intention to recondition this well.

Please advise us if you desire any additional information.

Yours very truly,

THE MANUFACTURERS LIGHT AND HEAT COMPANY

Ben S. Cooper
Ben S. Cooper, Land Agent

lgs

Enclosures

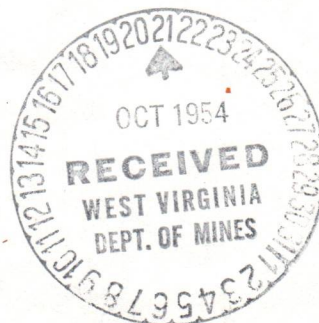

10/06/2023

THE MANUFACTURERS LIGHT AND HEAT COMPANY
80 UNION TRUST BUILDING
PITTSBURGH 19, PENNSYLVANIA

October 20, 1934

Mr. W. B. Cooper, Town of West Virginia
P.O. Box 100, West Virginia
West Virginia

Department of Mines
Oil and Gas Division
Charleston, West Virginia

Gentlemen:

We are enclosing to you a copy of the proposed lease
for the land, as shown on the attached map of 60 acres
being owned by the Town of West Virginia. This
land is being offered for lease to the Town of West
Virginia for the purpose of developing this well.

Please advise us if you desire any additional information.

Very truly yours,

THE MANUFACTURERS LIGHT AND HEAT COMPANY

[Handwritten Signature]
W. B. Cooper, Town Agent

Enclosure

A-10

November 1, 1954

The Manufacturers Light and Heat Company
800 Union Trust Building
Pittsburgh, Pennsylvania

Gentlemen:

Enclosed is permit WET-330-R to redrill
well No. F-23180 on the Eunice Cain, Agent farm,
Center District, Wetzel County.

Very truly yours,

Administrative Assistant
OIL AND GAS DIVISION

CNH:K
Encl-1

CC: Inspector Bryan Shuman

10/06/2023



THE MANUFACTURERS LIGHT AND HEAT COMPANY
800 UNION TRUST BUILDING • PITTSBURGH 19 • PENNSYLVANIA

November 9, 1955

RE * Lease 26544, Well 1-4317
Center District
Wetzel County, West Virginia

Department of Mines
Oil and Gas Division
Charleston, West Virginia

Gentlemen:

We are enclosing Well Record, in duplicate, for the above numbered well on the Johnson & Cain farm - your Permit WET-330-R. This well was formerly known as Foreign Well 23180 but should now be known as our Well 1-4317.

Yours very truly,

THE MANUFACTURERS LIGHT AND HEAT COMPANY

Walter A. Penning

ASST. LAND AGENT

lgs

Enclosure



10/06/2023

THE MANUFACTURERS LIGHT AND HEAT COMPANY
PITTSBURGH PA - PENNSYLVANIA

October 1, 1917

RE * Please Copy, West Virginia
Central Station
Martinsburg, West Virginia

Department of Mines
Oil and Gas Division
Charleston, West Virginia

Sir:

We are enclosing herewith, in duplicate, the
attached bill for the amount of \$100.00 - Ten Dollars - for
gas consumed during the month of September, 1917, for the
meter No. 12345, as shown on the bill.

Yours very truly,

THE MANUFACTURERS LIGHT AND HEAT COMPANY

ASST. TEND. ASST.

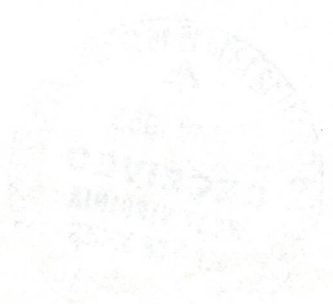

B-2

Formation	Color	Hard or Soft	Top	Bottom	Oil, Gas or Water	Depth Found	Remarks	
Sand	Light	Hard	1525'	1545'			Little Dunkard	
Slate	Dark	Soft	1545'	1560'				
Rock	Red	Soft	1560'	1575'				
Lime	Light	Hard	1575'	1615'				
Rock	Red	Soft	1615'	1623'				
Slate	Dark	Soft	1623'	1670'				
Sand	Light	Hard	1670'	1720'				Big Dunkard
Slate	Dark	Soft	1720'	1750'				
Sand	Light	Hard	1750'	1775'				
Slate	Dark	Soft	1775'	1800'				
Sand	Light	Hard	1800'	1837'				
Slate	Dark	Soft	1837'	1850'				
Sand	Light	Hard	1850'	1880'				
Slate	Light	Soft	1880'	1950'				
Slate	Dark	Soft	1950'	1980'				
Slate	Light	Soft	1980'	2010'				
Slate	Dark	Soft	2010'	2057'			2nd. Salt Sand	
Sand	Light	Hard	2057'	2100'	Water	2075'		
Slate	Dark	Soft	2100'	2125'		Hole Full	3rd. Salt Sand	
Sand	Light	Hard	2125'	2140'				
Slate	Light	Soft	2140'	2243'			Maxton Sand	
Sand	Light	Hard	2243'	2256'				
Slate	Dark	Soft	2256'	2266'			Little Lime	
Lime	Light	Hard	2266'	2275'				
Slate	Light	Soft	2275'	2292'			Pencil Cave	
Lime	Light	Hard	2292'	2340'				
Break	Dark	Soft	2340'	2341'			Big Lime	
Sand	Light	Hard	2341'	2590'	Gas	2400'-2402'		
Slate	Light	Soft	2590'	2594'			Big Injun	
Rock	Dark	Soft	2594'	2594'				
Total Depth				2594'				

OWNERS OF SURFACE AND MINERAL RIGHTS:

Eunice Cain, 63 Linden Ave., Moundsville, W.Va.
 Austin Cain, 619 Rear 16th Street, Huntington, W.Va.
 Russell C. Cain, U.S. Army.
 Martha & Norwood Cain, 40 1/2 Wooster Road, Barberton, Ohio
 Marguerite, Kenneth and Mary Cain, Rt. #2, Cameron, W.Va.

10/06/2023

Date APRIL 15, 194 6

APPROVED CARNEGIE NATURAL GAS COMPANY, Owner

By B. N. Archer
 (Title) Land Agent.

B-1



STATE OF WEST VIRGINIA DEPARTMENT OF MINES OIL AND GAS DIVISION

Littleton

WELL RECORD

Permit No. WET-330

Oil or Gas Well GAS (KIND)

Company Carnegie Natural Gas Company
Address Hundred, W. Va.
Farm J.J. Johnson and L. E. Cain Acres 80
Location (waters) Laurel Run
Well No. 1E-1625 Elev. 1367'
District Center County Wetzel
The surface of tract is owned in fee by L. E. Cain Heirs
Address SEE REVERSE SIDE
Mineral rights are owned by L. E. Cain heirs.
Address SEE REVERSE SIDE
Drilling commenced December 26, 1945
Drilling completed March 4, 1946
Date Shot Mar. 7, 1946 From 2400' To 2406'
With 15 quarts Nitro-glycerin
Open Flow 4 /10ths Water in 2" Inch
/10ths Merc. in Inch
Volume 84,000 Cu. Ft.
Rock Pressure 355 lbs. hrs.
Oil bbls., 1st 24 hrs.
Fresh water 1165 feet 2075 feet
Salt water feet feet

Table with 4 columns: Casing and Tubing, Used in Drilling, Left in Well, Packers. Rows include sizes 16, 13, 10, 8 1/4, 6 5/8, 5 3/16, 3, 2 and packer details like Kind of Packer, Size of, Depth set, Perf. top/bottom.

CASING CEMENTED SIZE No. Ft. Date
COAL WAS ENCOUNTERED AT 1055 FEET INCHES
1160 FEET INCHES FEET INCHES
FEET INCHES FEET INCHES

Main geological log table with columns: Formation, Color, Hard or Soft, Top, Bottom, Oil, Gas or Water, Depth Found, Remarks. Lists various rock types like Clay, Rock, Lime, Slate, Sand, Coal and their depths.

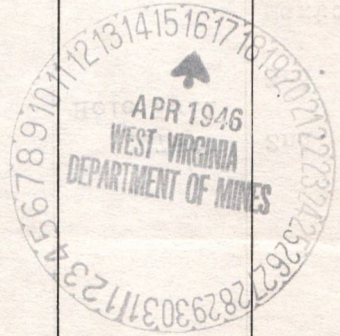

Mapletown
Pittsburgh
Water 1165' 1/4 Bailer
10/06/2023

B-3



STATE OF WEST VIRGINIA DEPARTMENT OF MINES OIL AND GAS DIVISION

Quadrangle Littleton

WELL RECORD

Permit No. WET-330-R

Oil or Gas Well Gas (KIND)

Company THE MANUFACTURERS LIGHT & HEAT COMPANY
Address 800 Union Trust Bldg., Pgh, Pa.
Farm Johnson and Cain Acres 80
Location (waters)
Well No. 1-4317 Elev. 1367'
District Center County Wetzell, W. Va.
The surface of tract is owned in fee by
Mineral rights are owned by
Drilling commenced November 19, 1954
Drilling completed May 10, 1955
Date Shot From To
With
Open Flow 40/10ths Water in 1/4 Inch
Volume 3099 Cu. Ft.
Rock Pressure lbs. hrs.
Oil bbls., 1st 24 hrs.
Fresh water feet feet
Salt water feet feet

Table with columns: Casing and Tubing, Used in Drilling, Left in Well, Packers. Rows include sizes 16, 13, 10, 8 1/4, 7 1/2, 5 3/16, 3, 2 and packer details.

CASING CEMENTED SIZE No. Ft. Date
COAL WAS ENCOUNTERED AT 1055 FEET INCHES
1174 FEET INCHES FEET INCHES
FEET INCHES FEET INCHES

Main well log table with columns: Formation, Color, Hard or Soft, Top, Bottom, Oil, Gas or Water, Depth Found, Remarks. Includes entries for Mapletown Coal, Pittsburgh Coal, 2nd Salt Sand, Maxton Sand, Big Injun Sand, and Total Depth.

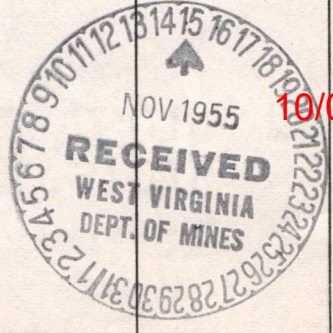

10/06/2023

B-4

STATE OF WEST VIRGINIA
DEPARTMENT OF MINES
OIL AND GAS DIVISION

INSPECTOR'S PLUGGING REPORT

Permit No. WET-330-P Well No. 1625

COMPANY Carnegie Natural Gas Co. ADDRESS 1015 Frick Bldg, Pittsburgh, Pa.

FARM J. J. Johnson & L. E. Corn DISTRICT Center COUNTY Wetzel

Filling Material Used Clay to 2099

Liner Location Amount Packer Location

PLUGS USED AND DEPTH PLACED			BRIDGES	CASING AND TUBING		
CEMENT-THICKNESS	WOOD-SIZE	LEAD	CONSTRUCTION-LOCATION	RECOVERED	SIZE	LOST
2099-2089						

Drillers' Names Mr. Albert Clark and Mr. Sam Masters

Remarks:

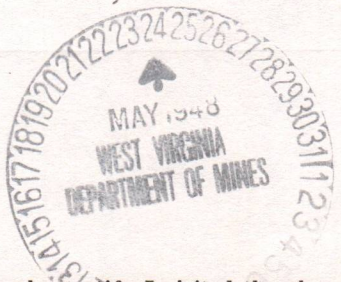

5/19/48
DATE

I hereby certify I visited the above well on this date.

Oliver W. Lumbay
DISTRICT WELL INSPECTOR

10/06/2023

STATE OF WEST VIRGINIA
DEPARTMENT OF MINES
OIL AND GAS DIVISION

INSPECTOR'S WELL REPORT

Permit No. _____

Oil or Gas Well _____
(KIND)

	CASING AND TUBING	USED IN DRILLING	LEFT IN WELL	PACKERS
Company _____	Size			
Address _____	16			Kind of Packer _____
Farm _____	13			
Well No. _____	10			Size of _____
District _____ County _____	8 1/4			
Drilling commenced _____	6 5/8			Depth set _____
Drilling completed _____ Total depth _____	5 3/16			
Date shot _____ Depth of shot _____	3			Perf. top _____
Initial open flow _____ /10ths Water in _____ Inch	2			Perf. bottom _____
Open flow after tubing _____ /10ths Merc. in _____ Inch	Liners Used _____			Perf. top _____
				Perf. bottom _____

	CASING CEMENTED	SIZE	No. FT.	Date
Volume _____ Cu. Ft.				
Rock pressure _____ lbs. _____ hrs.				
Oil _____ bbls., 1st 24 hrs.	COAL WAS ENCOUNTERED AT _____ FEET _____ INCHES			
Fresh water _____ feet _____ feet	_____ FEET	_____ INCHES	_____ FEET	_____ INCHES
Salt water _____ feet _____ feet	_____ FEET	_____ INCHES	_____ FEET	_____ INCHES

Drillers' Names _____

Remarks: _____

STATE OF WEST VIRGINIA
DEPARTMENT OF MINES
OIL AND GAS DIVISION

INSPECTOR'S PLUGGING REPORT

Permit No. WET-330-P.

Well No. _____

COMPANY Carnegie Natural Gas Co. ADDRESS Pittsburgh, Pa.

FARM J.J. Johnson & L. E. Cain DISTRICT Center COUNTY Wetzel

Filling Material Used _____

Liner Location Amount Packer Location

PLUGS USED AND DEPTH PLACED			BRIDGES	CASING AND TUBING		
CEMENT-THICKNESS	WOOD-SIZE	LEAD	CONSTRUCTION-LOCATION	RECOVERED	SIZE	LOST

Drillers' Names MR. Albert Clark and Mr. Sam Masters

Remarks: This well was plugged to the surface and completed Well log inclosed.

6/15/48
DATE

I hereby certify I visited the above well on this date.

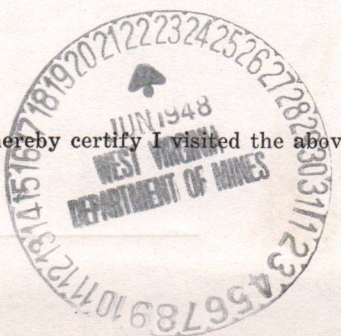

Oliver W. Luebke
DISTRICT WELL INSPECTOR

10/06/2023

STATE OF WEST VIRGINIA
 DEPARTMENT OF MINES
 OIL AND GAS DIVISION

INSPECTOR'S WELL REPORT

Permit No. _____

Oil or Gas Well
 (KIND) _____

		CASING AND TUBING	USED IN DRILLING	LEFT IN WELL	PACKERS
Company _____					
Address _____		Size			
Farm _____		16			Kind of Packer _____
Well No. _____		13			
District _____ County _____		10			Size of _____
Drilling commenced _____		8 1/4			
Drilling completed _____ Total depth _____		6 5/8			Depth set _____
Date shot _____ Depth of shot _____		5 3/16			
Initial open flow _____ /10ths Water in _____ Inch		3			Perf. top _____
Open flow after tubing _____ /10ths Merc. in _____ Inch		2			Perf. bottom _____
Volume _____ Cu. Ft.		Liners Used			Perf. top _____
Rock pressure _____ lbs. _____ hrs.					Perf. bottom _____
Oil _____ bbls., 1st 24 hrs.		CASING CEMENTED _____ SIZE _____ No. FT. _____ Date _____			
Fresh water _____ feet _____ feet		COAL WAS ENCOUNTERED AT _____ FEET _____ INCHES			
Salt water _____ feet _____ feet		_____ FEET _____ INCHES _____ FEET _____ INCHES			

Drillers' Names _____

Remarks: _____

DATE

DISTRICT WELL INSPECTOR

10/06/2023



B-6

STATE OF WEST VIRGINIA
DEPARTMENT OF MINES
OIL AND GAS DIVISION

INSPECTOR'S WELL REPORT

Permit No. ~~MAA~~ 330

Oil or Gas Well _____
(KIND)

Company <u>Magg's Heat Co</u>	CASING AND TUBING	USED IN DRILLING	LEFT IN WELL	PACKERS
Address <u>Pittsburgh PA</u>	Size			
Farm <u>Sumner Dale</u>	16			Kind of Packer _____
Well No. <u>F28180</u>	13			
District <u>Liberty</u> County <u>Marshall</u>	10			Size of _____
Drilling commenced _____	8 1/4			Depth set _____
Drilling completed _____ Total depth <u>1200'</u>	6 5/8			
Date shot _____ Depth of shot _____	5 3/16			Perf. top _____
Initial open flow _____ /10ths Water in _____ Inch	3			Perf. bottom _____
Open flow after tubing _____ /10ths Merc. in _____ Inch	2			Perf. top _____
Volume _____ Cu. Ft.	Liners Used _____			Perf. bottom _____
Rock pressure _____ lbs. _____ hrs.	CASING CEMENTED _____ SIZE _____ No. FT. _____ Date _____			
Oil _____ bbls., 1st 24 hrs.	COAL WAS ENCOUNTERED AT _____ FEET _____ INCHES			
Fresh water _____ feet _____ feet	_____ FEET _____ INCHES _____ FEET _____ INCHES			
Salt water _____ feet _____ feet	_____ FEET _____ INCHES _____ FEET _____ INCHES			

Drillers' Names _____

Remarks: No one at well, information from farmer

1-25-55
DATE

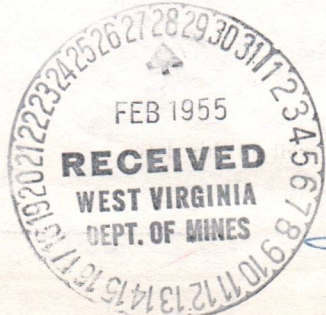

Bryan Thurman
DISTRICT WELL INSPECTOR

10/06/2023

STATE OF WEST VIRGINIA
 DEPARTMENT OF MINES
 OIL AND GAS DIVISION

INSPECTOR'S PLUGGING REPORT

Permit No. _____ Well No. _____

COMPANY _____ ADDRESS _____

FARM _____ DISTRICT _____ COUNTY _____

Filling Material Used _____

Liner	Location	Amount	Packer	Location		
PLUGS USED AND DEPTH PLACED			BRIDGES	CASING AND TUBING		
CEMENT-THICKNESS	WOOD-SIZE	LEAD	CONSTRUCTION-LOCATION	RECOVERED	SIZE	LOST

Drillers' Names _____

Remarks:

_____ I hereby certify I visited the above well on this date.

DATE

DISTRICT WELL INSPECTOR
 10/06/2023

STATE OF WEST VIRGINIA
DEPARTMENT OF MINES
OIL AND GAS DIVISION

B-1

Well 330-P

INSPECTOR'S WELL REPORT

Permit No. ~~MA 12-330 B~~

Oil or Gas Well _____
(KIND)

Company	CASING AND TUBING	USED IN DRILLING	LEFT IN WELL	PACKERS
				Kind of Packer
Address	Size			
Farm	16			Kind of Packer
Well No.	13			Size of
District	10			Size of
County	8 1/4			Depth set
Drilling commenced	6 5/8			Depth set
Drilling completed	5 3/16			Perf. top
Total depth	3			Perf. bottom
Date shot	2			Perf. bottom
Depth of shot	Liners Used			Perf. top
Initial open flow				Perf. bottom
/10ths Water in				
Inch				
Open flow after tubing				
/10ths Merc. in				
Inch				
Volume	Cu. Ft.	CASING CEMENTED	SIZE	No. FT.
				Date
Rock pressure	lbs.			
	hrs.			
Oil	bbls., 1st 24 hrs.	COAL WAS ENCOUNTERED AT	FEET	INCHES
Fresh water	feet		FEET	INCHES
	feet		FEET	INCHES
Salt water	feet		FEET	INCHES
	feet		FEET	INCHES

Drillers' Names No information, no one at well.

Remarks:

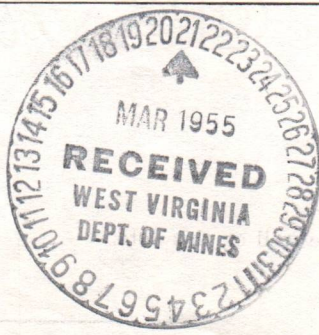

3-18-55
DATE

Byron Sherman
DISTRICT WELL INSPECTOR

10/06/2023

STATE OF WEST VIRGINIA
DEPARTMENT OF MINES
OIL AND GAS DIVISION

INSPECTOR'S PLUGGING REPORT

Permit No. _____ Well No. _____

COMPANY _____ ADDRESS _____

FARM _____ DISTRICT _____ COUNTY _____

Filling Material Used _____

PLUGS USED AND DEPTH PLACED			BRIDGES	CASING AND TUBING		
CEMENT-THICKNESS	WOOD-SIZE	LEAD	CONSTRUCTION-LOCATION	RECOVERED	SIZE	LOST

Drillers' Names _____

Remarks: _____

_____ I hereby certify I visited the above well on this date.
DATE

DISTRICT WELL INSPECTOR
10/06/2023

B-9

PROPOSED MANNER OF PLUGGING AND FILLING WELL

(REQUIRED BY RULES AND REGULATIONS)

WEST VIRGINIA DEPARTMENT OF MINES

OIL AND GAS DIVISION

WORK ORDER

Well to be plugged and filled as follows: TOTAL DEPTH - 2594'

Clay 2594 - 2326
5-3/16" Wood Plug 2326 - 2323
Cement 2323 - 2313

Remove 2303' of 5-3/16" casing.

Bridge 2286 -- (2) sack neat cement on bridge.
Clay to 2094
Cement 2094 - 2084

Remove 2074' of 6-5/8" casing.

Clay 2084 - 2037
Cement 2037 - 2027
Bridge 1565 -- (2) sack neat cement on bridge.
Clay to 1539
Cement 1539 - 1529

Remove 1519' of 8-1/4" casing.

Bridge 1195
Cement 1195 - 1140 -- through Pittsburgh Coal.
Clay 1140 - 1090
Cement 1090 - 1035 -- through Mapleton Coal.
Clay 1035 - 223
Cement 223 - 213

Remove 203' of 10" casing.

Clay 213 to surface.

Erect marker such as described in Rule 18, 1931 Regulations.
All work to be done in workmanlike manner.

To the Department of Mines
Coal Owner or Operator,
Lease or Property Owner.

Gentlemen:

This "work order" is submitted for your approval and concurrence and unless notified of your disapproval or non-concurrence, the undersigned will proceed with the plugging and filling of said well in the above described manner on the date stated in the notice of intention to plug and abandon the said well on opposite side of this sheet.

Very truly yours, CARNEGIE NATURAL GAS COMPANY,

By: [Signature]
President. Well Operator.

No objections have been filed by the coal owner or coal operator, or any available adjacent lease or property owners or interposed by the Department of Mines to the manner herein described for the plugging and filling of the well above mentioned. Therefore, the same is hereby approved this

29th day of April, 194 8.

10/06/2023

DEPARTMENT OF MINES
Oil and Gas Division

By: C. N. Hall

NOTE: This "work order" shall be filed in triplicate, one copy for the files of the Department of Mines; one to be approved or corrected and returned to the well operator as his authority for plugging said well; and one for the well inspector.



STATE OF WEST VIRGINIA
DEPARTMENT OF MINES
OIL AND GAS DIVISION

NOTICE OF INTENTION TO PLUG AND ABANDON WELL

(REQUIRED BY SECTION 9, ARTICLE 4, CHAPTER 22 OF THE CODE)

To THE DEPARTMENT OF MINES,
Charleston, W. Va.

HEIRS of L. E. CAIN, By:
COAL OPERATOR OR COAL OWNER
EUNICE CAIN, Attorney-in-Fact,
63 Linden Avenue,
MOUNDSVILLE, WEST VIRGINIA
ADDRESS

CARNEGIE NATURAL GAS COMPANY
NAME OF WELL OPERATOR
1015 Frick Building
PITTSBURGH, PA.
COMPLETE ADDRESS

APRIL 28 1948

COAL OPERATOR OR COAL OWNER
ADDRESS

WELL TO BE ABANDONED

CENTER District

WETZEL County

HEIRS of L. E. CAIN, By:
LEASE OR PROPERTY OWNER
EUNICE CAIN, Attorney-in-Fact,
63 Linden Avenue,
MOUNDSVILLE, WEST VIRGINIA
ADDRESS

Well No. 1625
J. J. JOHNSON & L. E. CAIN Farm

NOTIFY INSPECTOR OLIVER W. LINEBERG, MORGANTOWN, W. VA.

Gentlemen:— PHONE 3967 - 24 HOURS IN ADVANCE OF PLUGGING DATE.

The undersigned well operator is about to abandon the above described well and will commence the work of plugging and abandoning said well on the 3rd day of MAY, 1948, (which date shall not be less than five days after the day on which this notice so mailed is received, or in due course should be received by the Department of Mines.)

This notice is given you in order that your respective representatives may be present at the plugging and filling of said well. You are further notified that whether you are represented or not represented the undersigned will proceed on that date, or shortly thereafter, to plug and fill said well in the manner required by Section 10, Article 4, Chapter 22 of the Code and given in detail on the reverse side of this notice, in "Work Order."

This notice is being mailed by registered mail to each of you at the above addresses on the above date.



Very truly yours,
CARNEGIE NATURAL GAS COMPANY,

By *[Signature]*
President. Well Operator.

10/06/2023

NOTE: Upon the abandonment of all wells drilled prior to June 1, 1929, a plat prepared by a competent engineer, showing the district and county in which the tract of land is located, the name and acreage of same, the names of the owners and adjacent tracts, and the location of the about to be abandoned well, determined by survey, and the courses and distances of such well from two permanent points or landmarks on said tract, shall be submitted with this notice.

(Over)

B-10 FORM OG-8



STATE OF WEST VIRGINIA DEPARTMENT OF MINES OIL AND GAS DIVISION

AFFIDAVIT OF PLUGGING AND FILLING WELL

AFFIDAVIT SHOULD BE MADE IN TRIPPLICATE, ONE COPY MAILED TO THE DEPARTMENT, ONE COPY TO BE RETAINED BY THE WELL OPERATOR AND THE THIRD COPY (AND EXTRA COPIES IF REQUIRED) SHOULD BE MAILED TO EACH COAL OPERATOR AT THEIR RESPECTIVE ADDRESSES.

HEIRS of L. E. Cain, By: EUNICE CAIN, Attorney-in-Fact, 63 Linden Avenue, Moundsville, West Virginia.

CARNEGIE NATURAL GAS COMPANY 1015 FRICK BUILDING, PITTSBURGH, PA.

COAL OPERATOR OR OWNER ADDRESS

COMPLETE ADDRESS June 23, 1948.

Heirs of L. E. Cain, By: Eunice Cain, Attorney-in-Fact, 63 Linden Avenue, Moundsville, West Virginia.

WELL AND LOCATION Center District

Wetzel County

Well No. 1625

J. J. Johnson & L. E. Cain Farm

STATE INSPECTOR SUPERVISING PLUGGING Oliver W. Lineberg

AFFIDAVIT

STATE OF WEST VIRGINIA, County of Wetzel } ss: Albert Clark and Samuel B. Masters

being first duly sworn according to law depose and say that they are experienced in the work of plugging and filling oil and gas wells and were employed by Carnegie Natural Gas Company, well operator, and participated in the work of plugging and filling the above well, that said work was commenced on the 6 day of May, 1948, and that the well was plugged and filled in the following manner:

Table with columns: SAND OR ZONE RECORD, FILLING MATERIAL, PLUGS USED, CASING. Includes rows for Clay, Plug, Cement, Bridge, and Coal Seams (Pittsburgh, Mapleton).

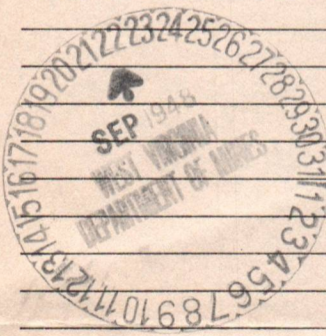

and that the work of plugging and filling said well was completed on the 16 day of June, 1948.

10/06/2023

And further deponents saith not.

Handwritten signatures: Albert Clark, Samuel B. Masters, O. F. Wise

Sworn to and subscribed before me this 11th day of Aug., 1948.

My commission expires: April 11-1954

Notary Public. Permit No. Wet-330-P

STATE OF WEST VIRGINIA
 DEPARTMENT OF MINES
 OIL AND GAS DIVISION

AFFIDAVIT OF PLACING AND FILING WELL

ALPHABETICALLY BY NAME OF OPERATOR AND BY NUMBER OF WELL TO BE PLACED AND BY NUMBER OF WELL TO BE FILED IN THE ORDER IN WHICH THEY ARE TO BE PLACED AND FILED, AND BY THE NAME OF THE OPERATOR OF EACH WELL TO BE PLACED AND FILED.

OPERATOR: CARNEGIE NATURAL GAS COMPANY
 JOHN WALKER BUILDING
 PITTSBURGH, PA.
 NAME OF A. F. Cain, Jr.
 ATTORNEY-IN-FACT
 63 Linden Avenue
 Mountbelle, West Virginia

County: Putnam
 Name: J. A. Johnson & L. E. Cain
 Well No: 1322
 Name of A. F. Cain, Jr.
 ATTORNEY-IN-FACT
 63 Linden Avenue
 Mountbelle, West Virginia
 Driver: A. Lindberg

STATE OF WEST VIRGINIA
 County of Putnam
 Albert Clark
 Sheriff
 I, Albert Clark, Sheriff of Putnam County, West Virginia, do hereby certify that the above is a true and correct copy of the original as filed in my office on this 8th day of _____, 1922.

Well No.	Operator	Placed	Filed	Notes
1322	Carnegie Natural Gas Company	1922	1922	18" x 10" at base, casing 10 1/2" at top, 30" high, traveled 4000 ft.
1323	Carnegie Natural Gas Company	1922	1922	18" x 10" at base, casing 10 1/2" at top, 30" high, traveled 4000 ft.
1324	Carnegie Natural Gas Company	1922	1922	18" x 10" at base, casing 10 1/2" at top, 30" high, traveled 4000 ft.
1325	Carnegie Natural Gas Company	1922	1922	18" x 10" at base, casing 10 1/2" at top, 30" high, traveled 4000 ft.
1326	Carnegie Natural Gas Company	1922	1922	18" x 10" at base, casing 10 1/2" at top, 30" high, traveled 4000 ft.
1327	Carnegie Natural Gas Company	1922	1922	18" x 10" at base, casing 10 1/2" at top, 30" high, traveled 4000 ft.
1328	Carnegie Natural Gas Company	1922	1922	18" x 10" at base, casing 10 1/2" at top, 30" high, traveled 4000 ft.
1329	Carnegie Natural Gas Company	1922	1922	18" x 10" at base, casing 10 1/2" at top, 30" high, traveled 4000 ft.
1330	Carnegie Natural Gas Company	1922	1922	18" x 10" at base, casing 10 1/2" at top, 30" high, traveled 4000 ft.
1331	Carnegie Natural Gas Company	1922	1922	18" x 10" at base, casing 10 1/2" at top, 30" high, traveled 4000 ft.
1332	Carnegie Natural Gas Company	1922	1922	18" x 10" at base, casing 10 1/2" at top, 30" high, traveled 4000 ft.
1333	Carnegie Natural Gas Company	1922	1922	18" x 10" at base, casing 10 1/2" at top, 30" high, traveled 4000 ft.
1334	Carnegie Natural Gas Company	1922	1922	18" x 10" at base, casing 10 1/2" at top, 30" high, traveled 4000 ft.
1335	Carnegie Natural Gas Company	1922	1922	18" x 10" at base, casing 10 1/2" at top, 30" high, traveled 4000 ft.
1336	Carnegie Natural Gas Company	1922	1922	18" x 10" at base, casing 10 1/2" at top, 30" high, traveled 4000 ft.
1337	Carnegie Natural Gas Company	1922	1922	18" x 10" at base, casing 10 1/2" at top, 30" high, traveled 4000 ft.
1338	Carnegie Natural Gas Company	1922	1922	18" x 10" at base, casing 10 1/2" at top, 30" high, traveled 4000 ft.
1339	Carnegie Natural Gas Company	1922	1922	18" x 10" at base, casing 10 1/2" at top, 30" high, traveled 4000 ft.
1340	Carnegie Natural Gas Company	1922	1922	18" x 10" at base, casing 10 1/2" at top, 30" high, traveled 4000 ft.

10/06/2023

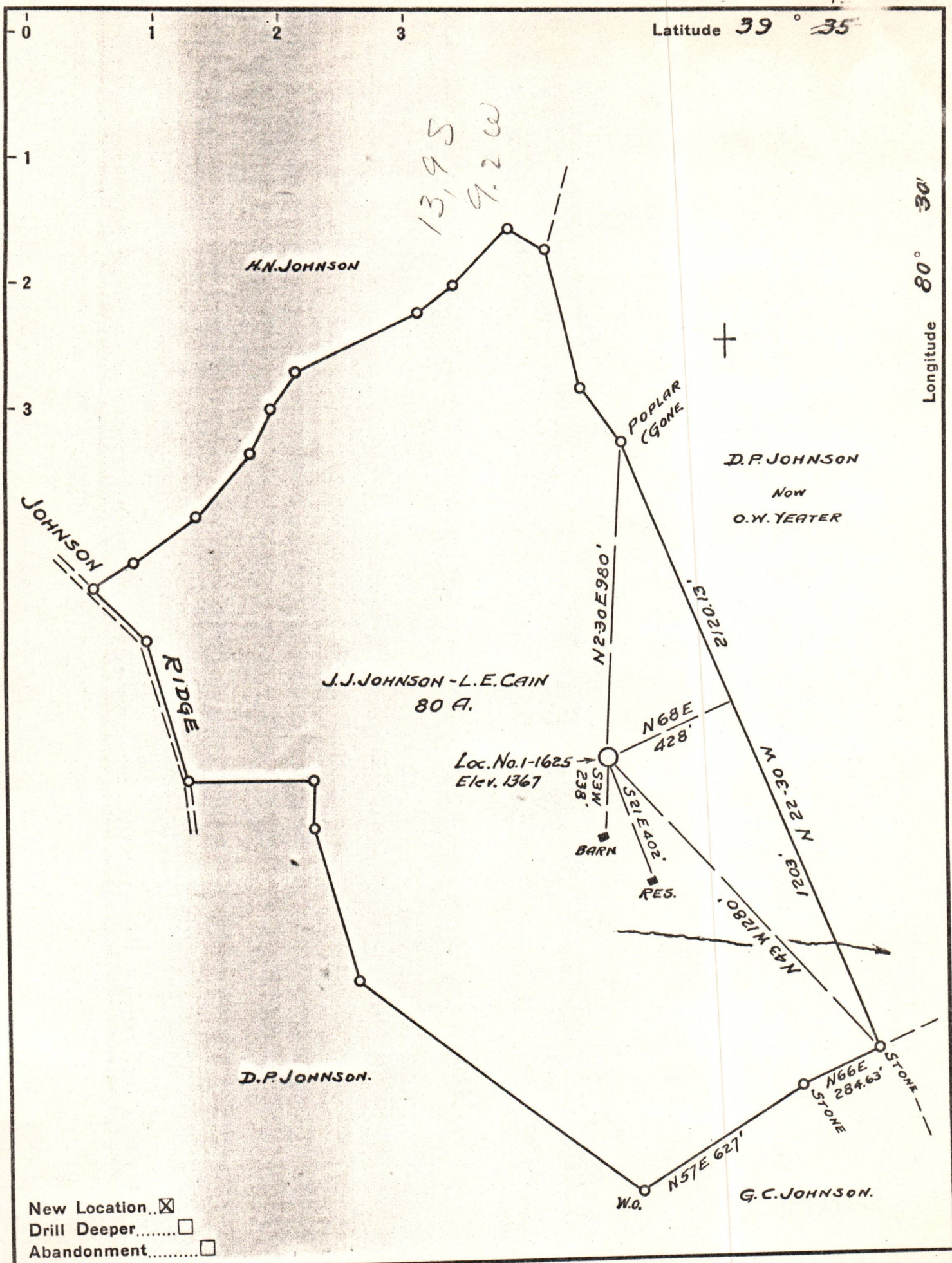

New Location...
 Drill Deeper.....
 Abandonment.....

Company CARNEGIE NATURAL GAS CO.
 Address PITTSBURGH, PA.
 Farm J.J. JOHNSON & L.E. CAIN
 Tract _____ Acres 80 Lease No. E-13182-71
 Well (Farm) No. 1 Serial No. 1625
 Elevation (Spirit Level) 1367'
 Quadrangle LITTLETON N.E. 1/4.
 County WETZEL District CENTER
 Engineer D.T. BRITTON
 Engineer's Registration No. _____
 File No. _____ Drawing No. _____
 Date 9-25-45 Scale 1"=400'

STATE OF WEST VIRGINIA
 DEPARTMENT OF MINES
 OIL AND GAS DIVISION
 CHARLESTON

WELL LOCATION MAP
 FILE NO. WEL-330 10/06/2023

+ Denotes location of well on United States Topographic Maps, scale 1 to 62,500, latitude and longitude lines being represented by border lines as shown.
 - Denotes one inch spaces on border line of original tracing.