

STATE OF WEST VIRGINIA  
DEPARTMENT OF MINES  
OIL AND GAS DIVISION  
DRILLING DEEPER

NOTICE OF PROPOSED LOCATION OF OIL AND GAS WELL

To THE DEPARTMENT OF MINES,  
Charleston, W. Va.

T. L. Rogerson,

COAL OPERATOR OR COAL OWNER

Moundsville, W. Va.

ADDRESS

Everett F. Moore

COAL OPERATOR OR COAL OWNER

Moundsville, W. Va.

ADDRESS

OWNER OF MINERAL RIGHTS

ADDRESS

THE MANUFACTURERS LIGHT & HEAT COMPANY

NAME OF WELL OPERATOR

800 Union Trust Bldg., Pittsburgh, Pa.

COMPLETE ADDRESS

April 13th,

1945

PROPOSED LOCATION

Church

District

Wetzel

County

Well No.

2 - 1962

89° 45'  
80° 25'

Drill Deeper

S. S. Teagarden

Farm

GENTLEMEN:

deeper

The undersigned well operator is entitled to drill upon the above named farm or tract of land for oil and gas, having fee title thereto, (or as the case may be) under grant or lease dated November 5th, 1908, made by S. S. Teagarden, et al, to The Wheeling Natural Gas Company, and recorded on the 13th day of July, 1909, in the office of the County Clerk for said County in Book 107, page 142.

The enclosed plat was prepared by a competent engineer and shows the proposed location of a well to be drilled for oil and gas by the undersigned well operator on the farm and in the Magisterial District and County above named, determined by survey and courses and distances from two permanent points, or land marks.

The undersigned well operator is informed and believes there are no coal operators operating beds of coal beneath said farm or tract of land on which said well is located, or within 500 feet of the boundaries of the same, who have mapped their workings and filed their maps as required by law, excepting the coal operators or coal owners (if any) above named as addressees.

The above named coal operators or coal owners (if any) are notified that any objections they may desire to make to such proposed location, or which they are required to make by Section 3 of said Code, if the drilling of a well at said proposed location will cause a dangerous condition in or about their respective coal mines, must be received by, or filed with the Department of Mines within ten\* days from the receipt of a copy of this notice and accompanying plat by said Department. Said coal operators are further notified that forms for use in making such objections will be furnished to them by the Department of Mines promptly on request and that all such objections must set forth as definitely as is reasonably possible the ground or grounds on which such objections are based and indicate the direction and distance the proposed location should be moved to overcome same.

(The next paragraph is to be completed only in Department's copy.)

Copies of this notice and the enclosed plat were mailed by registered mail, or delivered to the above named coal operators or coal owners at their above shown respective address this day before, or on the same day with the mailing or delivery of this copy to the Department of Mines at Charleston, West Virginia.

Very truly yours, THE MANUFACTURERS LIGHT & HEAT CO.,

*Larry H. Jowett*

Land Dept. WELL OPERATOR Office Mgr.

800 Union Trust Building

STREET

Pittsburgh

CITY OR TOWN

Pennsylvania

STATE

10/06/2023

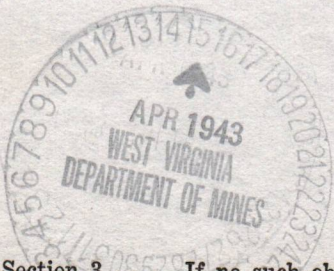

Address of Well Operator }

\*Section 3 . . . . If no such objections be filed or be found by the department of mines, within said period of ten days from the receipt of said notice and plat by the department of mines, to said proposed location, the department shall forthwith issue to the well operator a drilling permit reciting the filing of such plat, that no objections have been made by the coal operators to the location, or found thereto by the department, and that the same is approved and the well operator authorized to proceed to drill at said location.

STATE OF WEST VIRGINIA  
DEPARTMENT OF MINES  
OIL AND GAS DIVISION  
DRILLING DEPARTMENT  
NOTICE OF PROPOSED LOCATION OF OIL AND GAS WELL

To The Department of Mines,  
Charleston, W. Va.

THE MANUFACTURERS LIGHT & HEAT COMPANY

T. L. Robinson,  
COAL OPERATOR OR COAL OWNER

800 Union Trust Bldg., Pittsburgh, Pa.

Moundsville, W. Va.  
ADDRESS

APRIL 13th, 1908

Everett F. Moore  
COAL OPERATOR OR COAL OWNER

PROPOSED LOCATION

Moundsville, W. Va.  
ADDRESS

Church District

OWNER OF MINERAL RIGHTS

County

ADDRESS

Well No. 2 - 1908  
S. S. Teagarden

Farm

DEPARTMENT:  
The undersigned well operator is entitled to drill upon the above named farm or tract of land for oil and gas, having fee title thereto, (or as the case may be) under grant or lease dated November 5th, 1908 made by S. S. Teagarden, et al., to The Wheeling Natural Gas Company, and recorded on the 15th day of July, 1908, in the office of the County Clerk for said County in Book 107, page 112.

The enclosed plat was prepared by a competent engineer and shows the proposed location of a well to be drilled for oil and gas by the undersigned well operator on the farm and in the Mineral District and County above named, determined by survey and courses and distances from two permanent points or land marks.

The undersigned well operator is informed and believes there are no coal operators operating beds of coal beneath said farm or tract of land on which said well is located, or within 500 feet of the boundary of the same, who have mapped their workings and filed their maps as required by law, excepting the coal operators or coal owners (if any) above named as addressees.

The above named coal operators or coal owners (if any) are notified that any objections they may desire to make to such proposed location, or which they are required to make by Section 8 of said Code, if the drilling of a well at said proposed location will cause a dangerous condition in or about their respective coal mines, must be received by or filed with the Department of Mines within ten days from the receipt of a copy of this notice and accompanying plat by said Department. Said coal operators are further notified that forms for use in making such objections must set forth as definitely as is reasonably possible the promptly on request and that all such objections are based and indicate the direction and distance the proposed location should be moved to overcome same.

(The next paragraph is to be completed only in Department's copy.)  
Copies of this notice and the enclosed plat were mailed by registered mail, or delivered to the above named coal operators or coal owners at their above shown respective addresses this day before, or on the same day with the mailing or delivery of this copy to the Department of Mines at Charleston, West Virginia.

Very truly yours, THE MANUFACTURERS LIGHT & HEAT CO.,

Land Dept. Well Operator Office Mt. Pleasant  
300 Union Trust Building  
Pittsburgh  
Pennsylvania

Address of Well Operator

10/06/2023

Section 8 . . . . . If no such objections be filed or be found by the department of mines, within said period of ten days from the receipt of said notice and plat by the department of mines, to said proposed location, the department shall forthwith issue to the well operator a drilling permit reciting the facts of such plat, that no objections have been made by the coal operators to the location, or found thereto by the department, and that the same is approved and the well operator authorized to proceed to drill at said location.

Permit Number WET-280

A-10

April 26, 1943

The Manufacturers Light & Heat Company  
800 Union Trust Building  
Pittsburgh, Pennsylvania

Gentlemen:

Permit WEF-290 to drill Well No. 2-1962 on  
the S. S. Teagarden Farm, Church District, Wetzel County,  
is enclosed.

Very truly yours,

Secretary  
OIL AND GAS DIVISION

MG/jh  
enc-2

CC: Inspector A. A. Hurley

10/06/2023

A-11

# THE MANUFACTURERS LIGHT AND HEAT COMPANY

800 UNION TRUST BUILDING

PITTSBURGH, PENNSYLVANIA

April 13th, 1943.

IN RE - Well No. 2 - 1962  
Church District  
Wetzel County, W. Va.

Department of Mines,  
Oil and Gas Section,  
Charleston, W. Va.

Gentlemen:

We are enclosing "Application for Permission"  
to drill deeper the above numbered well on the S. S. Tea-  
garden tract of 76 acres, the location being shown on tracing  
marked Y-10-891 enclosed.

Also attached is a log of the well, to the  
present depth of 1927 feet.

Yours very truly,

THE MANUFACTURERS LIGHT & HEAT COMPANY,

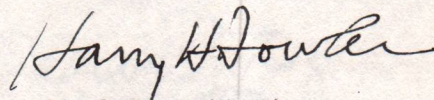

Land Department  
Office Manager.

-0-

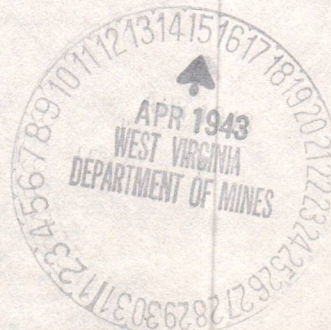

10/06/2023



STATE OF WEST VIRGINIA  
DEPARTMENT OF MINES  
OIL AND GAS DIVISION

WELL RECORD

Permit No. Drilled in 1916

Oil or Gas Well Gas  
(KIND)

Company The Mfrs Light & Heat Company  
 Address 800 Union Trust Bldg., Pittsburgh, Pa.  
 Farm S. S. Teagarden Acres 76  
 Location (waters).....  
 Well No. 2 - 1962 Elev. 1318 ft.  
 District Church County Wetzel  
 The surface of tract is owned in fee by Lizzie Teagarden  
 % Bank of Hundred Address Hundred, W. Va.  
 Mineral rights are owned by The Mfrs Light & Heat Co.  
800 Union Trust Bldg Address Pittsburgh, Pa.  
 Drilling commenced 11/2/16  
 Drilling completed 1/17/17  
 Date Shot From To  
 With  
 Open Flow /10ths Water in Inch  
 /10ths Merc. in Inch  
 Volume Cu. Ft.  
 Rock Pressure 428 lbs. hrs.  
 Oil bbls., 1st 24 hrs.  
 Fresh water feet feet  
 Salt water feet feet

Casing and Tubing	Used in Drilling	Left in Well	Packers
Size			
16			Kind of Packer
13			
10	300	300	Size of
8 1/4	1470	1470	8 1/4 x 6
6			Depth set
5 3/16			2784
4"	1930	1930	Perf. top
2			Perf. bottom
Liners Used			Perf. top
			Perf. bottom

CASING CEMENTED SIZE No. Ft. Date

COAL WAS ENCOUNTERED AT 900 FEET 60 INCHES  
995 FEET 96 INCHES FEET INCHES  
 FEET INCHES FEET INCHES

Formation	Color	Hard or Soft	Top	Bottom	Oil, Gas or Water	Depth Found	Remarks
Sand			20	25			
Sand			125	140			
Sand			600	635			
Sand			800	815			
Mapletown Coal			900	905			
Pittsburgh Coal			995	1003	Little Gas		
Big Dunkard Sand			1470	1505			
Sand			1555	1595			
Gas Sand			1690	1710			
First Salt Sand			1913	1927	Gas at 1925		
Total depth				1927	Packer swedged to 4"		

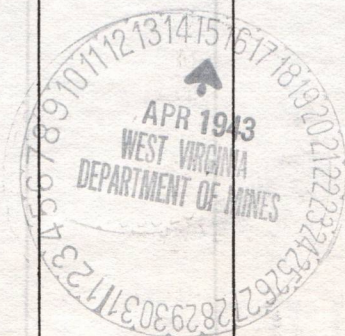

10/06/2023

B-3

Formation	Color	Hard or Soft	Top	Bottom	Oil, Gas or Water	Depth Found	Remarks
Pink rock			3080	3084			
Gordon Sand			3084	3096			
Slate			3096	3125			
4th sand			3125	3175	Gas 3170-3173		
Slate & Shells			3175	3250			
Slate & Shells			3250	3461			
Total Depth			3461				



10/06/2023

Date October 7, 1955

DEPARTMENT OF MINES

APPROVED THE MANUFACTURERS LIGHT AND HEAT CO., Owner

By [Signature]  
LAND AGENT (Title)



STATE OF WEST VIRGINIA  
DEPARTMENT OF MINES  
OIL AND GAS DIVISION

B-2

Quadrangle \_\_\_\_\_

WELL RECORD

Permit No. WET-290

Oil or Gas Well Gas  
(KIND)

Company THE MANUFACTURERS LIGHT AND HEAT COMPANY  
Address 800 UNION TRUST BLDG., PGH., PENNA.

Farm S. S. Teagarden Acres \_\_\_\_\_

Location (waters) \_\_\_\_\_

Well No. 1962 Elev. \_\_\_\_\_

District Church County Wetzel

The surface of tract is owned in fee by \_\_\_\_\_  
Address \_\_\_\_\_

Mineral rights are owned by \_\_\_\_\_  
Address \_\_\_\_\_

Drilling commenced November 2, 1916

Drilling completed January 1917

Date Shot \_\_\_\_\_ From \_\_\_\_\_ To \_\_\_\_\_

With \_\_\_\_\_

Open Flow \_\_\_\_\_ /10ths Water in \_\_\_\_\_ Inch

\_\_\_\_\_ /10ths Merc. in \_\_\_\_\_ Inch

Volume \_\_\_\_\_ Cu. Ft.

Rock Pressure 428 lbs. \_\_\_\_\_ hrs.

Oil \_\_\_\_\_ bbls., 1st 24 hrs.

Fresh water \_\_\_\_\_ feet \_\_\_\_\_ feet

Salt water \_\_\_\_\_ feet \_\_\_\_\_ feet

Casing and Tubing	Used in Drilling	Left in Well	Packers
Size			
16			Kind of Packer
18			
10	300	300	Size of $8\frac{1}{4} \times 6$
8 $\frac{1}{4}$	1470	1470	
6 $\frac{5}{8}$	2220'9"	2220'9"	Depth set <u>2784</u>
5 $\frac{3}{16}$			
3 $\frac{1}{4}$	1930	1930	Perf. top
2			Perf. bottom
Liners Used			Perf. top
			Perf. bottom

CASING CEMENTED \_\_\_\_\_ SIZE \_\_\_\_\_ No. Ft. \_\_\_\_\_ Date \_\_\_\_\_

COAL WAS ENCOUNTERED AT 900 FEET \_\_\_\_\_ INCHES

995 FEET \_\_\_\_\_ INCHES FEET \_\_\_\_\_ INCHES

FEET \_\_\_\_\_ INCHES FEET \_\_\_\_\_ INCHES

Formation	Color	Hard or Soft	Top	Bottom	Oil, Gas or Water	Depth Found	Remarks
Sand			20	25			
Sand			125	140			
Sand			600	635			
Sand			800	815			
Mapletown Coal			900	905			
Pittsburgh Coal			995	1003			
Sand Big Dunkard			1470	1505			
" " "			1555	1595			
Gas Sand			1690	1710			
1st Salt Sand			1913	1927	Gas at 1925		
Total Depth			1927				
DRILLED DEEPER:							
Commenced May 24, 1943 Completed July 2, 1943							
Salt Sand			1927	2010			
Slate			2010	2024			
Maxon Sand			2024	2065			
Pink rock			2065	2075			
Sand shell			2075	2080			
Red Rock			2080	2090			
Lime shells			2090	2125			
Slate			2125	2132			
Little Lime			2132	2169			
Pencil cave			2169	2174			
Big Lime			2174	2246			
Big Injun sand			2246	2462			
Slate & Shells			2462	2575			
Lime			2575	2600			
Slate & Shells			2600	2835			
Sand			2835	2855			
Slate & Shells			2855	2954			
50 ft. sand			2954	2965			
Slate			2965	2985			
30 ft. sand			2985	2997			
Slate			2997	3024			
Gordon Stray			3024	3052	Gas @ 3041-3042		
Slate			3052	3062			
Sand			3062	3080			

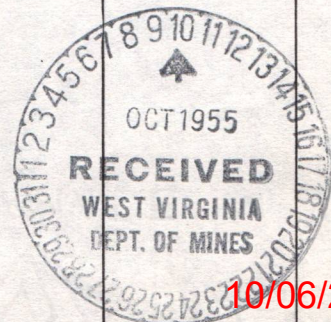

10/06/2023



*Mannington W.V.*

THE MANUFACTURERS LIGHT & HEAT COMPANY

*73-4*

RECORD OF WELL NO. 1962 ON S. S. Teagarden FARM Hundred FIELD  
 Church DISTRICT Wetzell COUNTY West Virginia STATE Y-10-891 SKETCH  
 DRILLING COMMENCED May 24, 1943 DRILLING COMPLETED July 2, 1943  
 CONTRACTOR Harry Moore ADDRESS Hundred, W. Va. ELEVATION 1318 feet  
 DRILLER' NAME Arthur L. Butcher, Harry L. Jones, Charles W. Critchfield  
 APPROVED BY *Harry H. Fowler* Land Department., Office Manager

DRILLING DEEPER COMPANY WELL #1962 ON THE S. S. TEAGARDEN FARM.

<u>FORMATION</u>	<u>THICKNESS</u>	<u>TOP</u>	<u>BOTTOM</u>
Salt Sand	83	1927	2010
Slate	14	2010	2024
Maxon Sand	41	2025	2065
Pink rock	10	2065	2075
Sand Shell	5	2075	2080
Red Rock	10	2080	2090
Lime Shells	35	2090	2125
Slate	7	2125	2132
Little Lime	37	2132	2169
Pencil Cave	5	2169	2174
Big Lime	72	2174	2246
Big Injun Sand	216	2246	2462
Slate & Shells	173	2462	2575
Lime	25	2575	2600
Slate & Shells	235	2600	2835
Sand	20	2835	2855
Slate & Shells	99	2855	2954
50 Foot Sand	11	2954	2965
Slate	20	2965	2985
30 Foot Sand	12	2985	2997
Slate	27	2997	3024
Gordon Stray	28	3024	3052
Slate	10	3052	3062
Sand	18	3062	3080
Pink rock	4	3080	3084
Gordon Sand	12	3084	3096
Slate	29	3096	3125
4th Sand	50	3125	3175
Slate & Shells	75	3175	3250
Slate & Shells	211	3250	3461
TOTAL DEPTH			3461

Gas @ 3041 - 3042

Gas 3170 - 3173'

*Permit Wet-290  
Drill deeper*

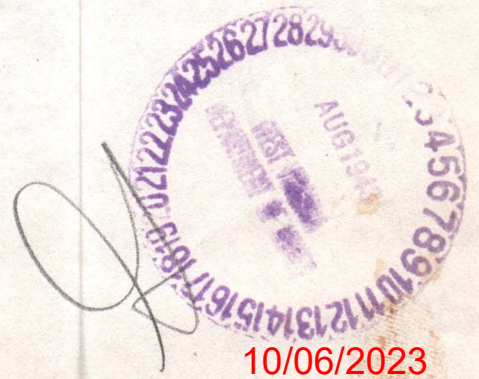

10/06/2023

B-5

STATE OF WEST VIRGINIA  
DEPARTMENT OF MINES  
OIL AND GAS DIVISION

INSPECTOR'S PLUGGING REPORT

Permit No. WET-290-P

Well No. 1962

COMPANY M.M.'s Light and Heat Co ADDRESS \_\_\_\_\_

FARM S.S. Tenyarden DISTRICT Church COUNTY WETZEL

Filling Material Used Clay Cement

Liner Location Amount Packer Location

PLUGS USED AND DEPTH PLACED			BRIDGES	CASING AND TUBING		
CEMENT-THICKNESS	WOOD-SIZE	LEAD	CONSTRUCTION-LOCATION	RECOVERED	SIZE	LOST

*Rigging up.*

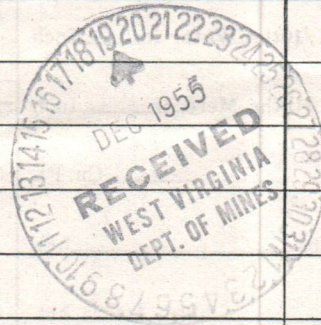

Drillers' Names Walter Morris and Roy Gregg

Remarks:

12 14 55 I hereby certify I visited the above well on this date.  
DATE

Bryan Shuman  
DISTRICT WELL INSPECTOR  
10/06/2023

STATE OF WEST VIRGINIA  
DEPARTMENT OF MINES  
OIL AND GAS DIVISION

INSPECTOR'S WELL REPORT

Permit No. \_\_\_\_\_

Oil or Gas Well \_\_\_\_\_  
(KIND)

Company _____ Address _____ Farm _____ Well No. _____ District _____ County _____ Drilling commenced _____ Drilling completed _____ Total depth _____ Date shot _____ Depth of shot _____ Initial open flow _____ /10ths Water in _____ Inch Open flow after tubing _____ /10ths Merc. in _____ Inch Volume _____ Cu. Ft. Rock pressure _____ lbs. _____ hrs. Oil _____ bbls., 1st 24 hrs. Fresh water _____ feet _____ feet Salt water _____ feet _____ feet	CASING AND TUBING	USED IN DRILLING	LEFT IN WELL	PACKERS
	Size			Kind of Packer _____
	16			
	13			
	10			Size of _____
	8 1/4			
	6 5/8			Depth set _____
	5 3/16			
	3			Perf. top _____
	2			Perf. bottom _____
	Liners Used			Perf. top _____
				Perf. bottom _____
	CASING CEMENTED _____ SIZE _____ No. FT. _____ Date _____			
	COAL WAS ENCOUNTERED AT _____ FEET _____ INCHES			
	_____ FEET _____ INCHES _____ FEET _____ INCHES			
	_____ FEET _____ INCHES _____ FEET _____ INCHES			

Drillers' Names \_\_\_\_\_

Remarks:

DATE

DISTRICT WELL INSPECTOR

10/06/2023



STATE OF WEST VIRGINIA

STATE OF WEST VIRGINIA  
DEPARTMENT OF MINES  
OIL AND GAS DIVISION

INSPECTOR'S WELL REPORT

Permit No. \_\_\_\_\_

Oil or Gas Well \_\_\_\_\_  
(KIND)

Company _____ Address _____ Farm _____ Well No. _____ District _____ County _____ Drilling commenced _____ Drilling completed _____ Total depth _____ Date shot _____ Depth of shot _____ Initial open flow _____ /10ths Water in _____ Inch Open flow after tubing _____ /10ths Merc. in _____ Inch Volume _____ Cu. Ft. Rock pressure _____ lbs. _____ hrs. Oil _____ bbls., 1st 24 hrs. Fresh water _____ feet _____ feet Salt water _____ feet _____ feet	CASING AND TUBING	USED IN DRILLING	LEFT IN WELL	PACKERS
	Size _____ 16 _____ 13 _____ 10 _____ 8 1/4 _____ 6 5/8 _____ 5 3/16 _____ 3 _____ 2 _____ Liners Used _____			

CASING CEMENTED \_\_\_\_\_ SIZE \_\_\_\_\_ No. FT. \_\_\_\_\_ Date \_\_\_\_\_

COAL WAS ENCOUNTERED AT \_\_\_\_\_ FEET \_\_\_\_\_ INCHES  
\_\_\_\_\_ FEET \_\_\_\_\_ INCHES \_\_\_\_\_ FEET \_\_\_\_\_ INCHES  
\_\_\_\_\_ FEET \_\_\_\_\_ INCHES \_\_\_\_\_ FEET \_\_\_\_\_ INCHES

Drillers' Names \_\_\_\_\_

Remarks:

10/06/2023

DISTRICT WELL INSPECTOR

DATE

73-9

PROPOSED MANNER OF PLUGGING AND FILLING WELL

(REQUIRED BY RULES AND REGULATIONS)

WEST VIRGINIA DEPARTMENT OF MINES

OIL AND GAS DIVISION

WORK ORDER

Well to be plugged and filled as follows:

Total Depth	3461	
Bridge	3052	
Clay	3052	3031
Cement	3031	3021
Clay	3021	2221
Lift 6 3/8" casing		
Cement	2221	2211
Bridge	2034	
Clay	2034	1915
Cement	1915	1905
Clay	1905	1800
Lift 8 1/4" casing		
Bridge	1505	
Clay	1505	1470
Cement	1470	1460
Bridge	1105	
Clay	1105	1033
Cement	1033	975
Clay	975	935
Cement	935	880
Clay	880	300
Lift 10" casing		
Clay	300	0

SET BRIDGE BEFORE LIFTING 8-1/4" CASING

Pittsburgh Coal 995 - 1003

Mapletown Coal 900 - 905

SET A SUITABLE PLUG AT 300' for fresh water Protection

Erect Monument as per rule 18

To the Department of Mines  
Coal Owner or Operator,  
Lease or Property Owner.

Gentlemen:

This "work order" is submitted for your approval and concurrence and unless notified of your disapproval or non-concurrence, the undersigned will proceed with the plugging and filling of said well in the above described manner on the date stated in the notice of intention to plug and abandon the said well on opposite side of this sheet.

Very truly yours,

THE MANUFACTURERS LIGHT AND HEAT COMPANY

*Ben Cooper*  
LAND AGENT Well Operator.

No objections have been filed by the coal owner or coal operator, or any available adjacent lease or property owners or interposed by the Department of Mines to the manner herein described for the plugging and filling of the well above mentioned. Therefore, the same is hereby approved

10th day of October, 1955, 19\_\_.

DEPARTMENT OF MINES  
Oil and Gas Division

By: *E. J. Holly*

NOTE: This "work order" shall be filed in triplicate, one copy for the files of the Department of Mines; one to be approved or corrected and returned to the well operator as his authority for plugging said well; and one for the well inspector.



STATE OF WEST VIRGINIA  
DEPARTMENT OF MINES  
OIL AND GAS DIVISION

NOTICE OF INTENTION TO PLUG AND ABANDON WELL  
(REQUIRED BY SECTION 9, ARTICLE 4, CHAPTER 22 OF THE CODE)

To THE DEPARTMENT OF MINES,  
Charleston, W. Va.

Coal Operator or Coal Owner

The Manufacturers Light and Heat Company  
Name of Well Operator

Address

800 Union Trust Building  
Pittsburgh 19, Penn.  
Complete Address

Coal Operator or Coal Owner

OCT 7 - 1955 10 19 55

WELL TO BE ABANDONED

Address

Church District  
Wetzel County

Lease or Property Owner

Well No. 1962

Address

S. S. Teagarden Farm

Inspector to be notified RYAN SHUMAN - TELEPHONE, PINEGROVE (TUXEDO - 9-5674)  
24 HOURS IN ADVANCE OF PLUGGING DATE

Gentlemen:—

The undersigned well operator is about to abandon the above described well and will commence

the work of plugging and abandoning said well on the date inspector is notified (which date shall not be less than five days after the day on which this notice so mailed is received, or in due course should be received by the Department of Mines).

This notice is given you in order that your respective representatives may be present at the plugging and filling of said well. You are further notified that whether you are represented or not represented the undersigned will proceed on that date, or shortly thereafter, to plug and fill said well in the manner required by Section 10, Article 4, Chapter 22 of the Code and given in detail on the reverse side of this notice, in "Work Order."

This notice is being mailed by registered mail to each of you at the above addresses on the above date.

Very truly yours,  
THE MANUFACTURERS LIGHT AND HEAT COMPANY  
Paul Cooper  
LAND AGENT Well Operator.

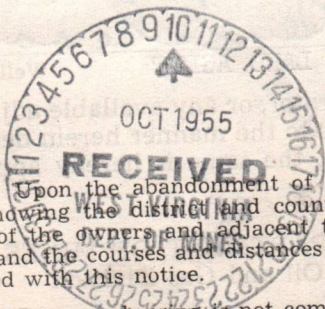

NOTE: Upon the abandonment of all wells drilled prior to June 1, 1929, a plat prepared by a registered engineer, showing the district and county in which the tract of land is located, the name and acreage of the tract, the names of the owners and adjacent tracts, and the location of the about to be abandoned well, determined by survey, and the courses and distances of such well from two permanent points or landmarks on said tract, shall be submitted with this notice.

NOTE: In case plugging is not commenced within four months from the above date, this permit shall expire and be of no further force or effect.

(over)

WET-1018 PERMIT NUMBER  
290-P

10/06/2023

2730  
290  
B-8

STATE OF WEST VIRGINIA  
DEPARTMENT OF MINES  
OIL AND GAS DIVISION

**PARTIAL**  
**AFFIDAVIT OF PLUGGING AND FILLING WELL**

AFFIDAVIT SHOULD BE MADE IN TRIPPLICATE, ONE COPY MAILED TO THE DEPARTMENT, ONE COPY TO BE RETAINED BY THE WELL OPERATOR AND THE THIRD COPY (AND EXTRA COPIES IF REQUIRED) SHOULD BE MAILED TO EACH COAL OPERATOR AT THEIR RESPECTIVE ADDRESSES.

COAL OPERATOR OR OWNER The Manufacturers Light and Heat Co.  
NAME OF WELL OPERATOR  
800 Union Trust Building  
Pittsburgh 19, Pennsylvania  
COMPLETE ADDRESS

ADDRESS \_\_\_\_\_

COAL OPERATOR OR OWNER \_\_\_\_\_  
WELL AND LOCATION  
February 15, 1956  
Church District  
Wetzel County

ADDRESS \_\_\_\_\_

LEASE OR PROPERTY OWNER \_\_\_\_\_  
Well No. 1962  
S. S. Teagarden Farm

ADDRESS \_\_\_\_\_

STATE INSPECTOR SUPERVISING PLUGGING Partial Bryan Shuman

**AFFIDAVIT**

STATE OF WEST VIRGINIA, }  
 County of WETZEL } ss:

Walter J. Morris and Roy Gregg  
 being first duly sworn according to law depose and say that they are experienced in the work of plugging and filling oil and gas wells and were employed by The Manufacturers Light and Heat Co. well operator, and participated in the work of Partial plugging and filling the above well, that said work was commenced on the 16th day of December, 1955, and that the well was plugged and filled in the following manner:

SAND OR ZONE RECORD FORMATION	FILLING MATERIAL	PLUGS USED SIZE & KIND	CASING	
			CSG PULLED	CSG LEFT IN
Total Depth	3461			
Bridge at	3052		10"	3"
Clay	3052 3030		359'	125'
Cement	3030 3020			
Clay	3020 2230		7"	
Cement	2230 2220		2224'	
Pulled 6 5/8" Casing ( All)				
Clay	2220 2095			
Cleaned out to 2095				
New Total Depth		2095		
(Note) Well partially plugged from 3461' to 2095, after pulling 6 5/8" casing sufficient gas was found in Salt Sand at 1925' to justify in keeping well.				
COAL SEAMS		DESCRIPTION OF MONUMENT		
(NAME)				
(NAME)				
(NAME)				
(NAME)				

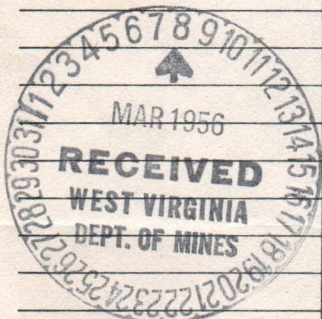

and that the work of plugging and filling said well was completed on the 25th day of January, 19 56.

And further deponents saith not.

Sworn to and subscribed before me this 29 day of February, 19 56.

My commission expires:

Walter J. Morris  
Roy Gregg 10/06/2023  
John T. Ballinger  
 Notary Public.

Permit No. Wet-290-P

**JOHN T. BALLINGER**  
 NOTARY PUBLIC  
 My Commission expires Feb. 11, 1962



STATE OF WEST VIRGINIA  
 DEPARTMENT OF MINES  
 AND OIL DIVISION

STATE OF WEST VIRGINIA  
 DEPARTMENT OF MINES AND OIL DIVISION  
 ASSESSMENT OF PRODUCTION AND RENTING WELL

THIS REPORT SHOULD BE MADE IN FULL AND NOT IN PART. THE REPORT SHOULD BE MADE IN FULL AND NOT IN PART. THE REPORT SHOULD BE MADE IN FULL AND NOT IN PART.

The Manufacturer Light and Heat Co.  
 800 Union Trust Building  
 Pittsburgh 19, Pennsylvania

February 15, 1955

WILLIAM LOCATION

Church

Coal

Well No. 1902

S. S. Ferguson

Partial

APPENDIX

STATE OF WEST VIRGINIA

County of Mingo

Walter J. Morris

Roy Gregg

being that my sworn statement to law books and say that they are expected to be made in full and not in part. The Manufacturer Light and Heat Co. was contacted on the 15th of December, 1955, and that the well was partially plugged and filled in the following manner:

DATE OF WELL RECORD	DEPTH MATERIAL	WELL NO.	DEPTH
	Total Depth		3161
	Bridge at		3025
	Clay	3030	3025
	Cement	3030	3030
	Clay	3030	3030
	Cement	2230	2230
	Clay	2230	2230
	Plugged 5/8" casing (All)		2025
	Clay		2025
	Cleaned out to		2025
	New Total Depth		2025

(Note) Well partially plugged from 3161 to 2025, after pulling 5/8" casing sufficient gas was found in belt band at 1925, so casing in keeping well.

And that the work of plugging and filling said well was completed on the 25th day of January, 1955.

10/06/2023

JOHN T. BALLINGER  
 NOTARY PUBLIC  
 My Commission expires Feb. 11, 1962

C-7

STATE OF WEST VIRGINIA  
DEPARTMENT OF MINES  
OIL AND GAS DIVISION

INSPECTOR'S PLUGGING REPORT

Permit No. WV 290-P

Well No. 1962

COMPANY MAR'S LIGHT AND HEAT CO ADDRESS \_\_\_\_\_

FARM S.S. Teagarden DISTRICT Church COUNTY WV 261

Filling Material Used Clay, Cement

Liner Location Amount Packer Location

PLUGS USED AND DEPTH PLACED			BRIDGES	CASING AND TUBING		
CEMENT-THICKNESS	WOOD-SIZE	LEAD	CONSTRUCTION-LOCATION	RECOVERED	SIZE	LOST
Drilling out bridge and testing for production. May not be available.						

Drillers' Names Walter Morris Roy Hogg

Remarks:

12-29-55  
DATE

I hereby certify I visited the above well on this date.

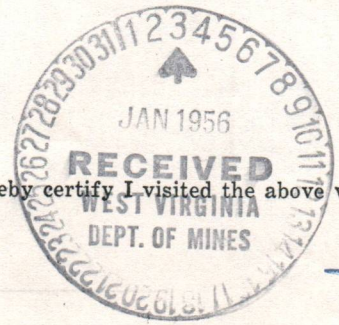

Bryan Thurman

DISTRICT WELL INSPECTOR

10/06/2023

STATE OF WEST VIRGINIA  
DEPARTMENT OF MINES  
OIL AND GAS DIVISION

INSPECTOR'S WELL REPORT

Permit No. \_\_\_\_\_

Oil or Gas Well \_\_\_\_\_  
(KIND)

		CASING AND TUBING	USED IN DRILLING	LEFT IN WELL	PACKERS
Company _____		Size			Kind of Packer _____
Address _____		16			
Farm _____		13			
Well No. _____		10			Size of _____
District _____ County _____		8 1/4			
Drilling commenced _____		6 5/8			Depth set _____
Drilling completed _____ Total depth _____		5 3/16			
Date shot _____ Depth of shot _____		3			Perf. top _____
Initial open flow _____ /10ths Water in _____ Inch		2			Perf. bottom _____
Open flow after tubing _____ /10ths Merc. in _____ Inch		Liners Used			Perf. top _____
Volume _____ Cu. Ft.					Perf. bottom _____
Rock pressure _____ lbs. _____ hrs.		CASING CEMENTED _____ SIZE _____ No. FT. _____ Date _____			
Oil _____ bbls., 1st 24 hrs.		COAL WAS ENCOUNTERED AT _____ FEET _____ INCHES			
Fresh water _____ feet _____ feet		_____ FEET _____ INCHES _____ FEET _____ INCHES			
Salt water _____ feet _____ feet		_____ FEET _____ INCHES _____ FEET _____ INCHES			

Drillers' Names \_\_\_\_\_

Remarks:

DATE

DISTRICT WELL INSPECTOR

10/06/2023

018

STATE OF WEST VIRGINIA  
DEPARTMENT OF MINES  
OIL AND GAS DIVISION

INSPECTOR'S PLUGGING REPORT

Permit No. WAT-590-P Well No. 1962

COMPANY Map's Light and Heat Co ADDRESS Pittsburgh 19 - PA.  
FARM S.S. Tengarten DISTRICT Church COUNTY Wetzel

Filling Material Used \_\_\_\_\_

PLUGS USED AND DEPTH PLACED			BRIDGES	CASING AND TUBING		
CEMENT-THICKNESS	WOOD-SIZE	LEAD	CONSTRUCTION-LOCATION	RECOVERED	SIZE	LOST

Running Test on Salt Sand Gas

Drillers' Names Walter Marshall Ray Dreyer  
Remarks: This may be partial plugging. No information on amount of gas.

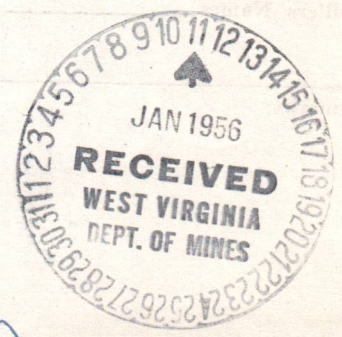

1 3 56 I hereby certify I visited the above well on this date.  
DATE

Bryan Sherman  
DISTRICT WELL INSPECTOR  
10/06/2023

STATE OF WEST VIRGINIA  
DEPARTMENT OF MINES  
OIL AND GAS DIVISION

INSPECTOR'S WELL REPORT

Permit No. \_\_\_\_\_

Oil or Gas Well \_\_\_\_\_  
(KIND)

		CASING AND TUBING	USED IN DRILLING	LEFT IN WELL	PACKERS
Company _____		Size			Kind of Packer _____
Address _____		16			
Farm _____		13			
Well No. _____		10			Size of _____
District _____ County _____		8 1/4			
Drilling commenced _____		6 5/8			Depth set _____
Drilling completed _____ Total depth _____		5 3/16			
Date shot _____ Depth of shot _____		3			Perf. top _____
Initial open flow _____ /10ths Water in _____ Inch		2			Perf. bottom _____
Open flow after tubing _____ /10ths Merc. in _____ Inch		Liners Used			Perf. top _____
Volume _____ Cu. Ft.					Perf. bottom _____
Rock pressure _____ lbs. _____ hrs.		CASING CEMENTED _____ SIZE _____ No. FT. _____ Date _____			
Oil _____ bbls., 1st 24 hrs.		COAL WAS ENCOUNTERED AT _____ FEET _____ INCHES			
Fresh water _____ feet _____ feet		_____ FEET _____ INCHES _____ FEET _____ INCHES			
Salt water _____ feet _____ feet		_____ FEET _____ INCHES _____ FEET _____ INCHES			

Drillers' Names \_\_\_\_\_

Remarks: \_\_\_\_\_

DATE \_\_\_\_\_

DISTRICT WELL INSPECTOR  
**10/06/2023**

C-9

STATE OF WEST VIRGINIA  
DEPARTMENT OF MINES  
OIL AND GAS DIVISION

INSPECTOR'S PLUGGING REPORT

Permit No. WV-290-P

Well No. 1962

COMPANY Max's Night and Heat Co ADDRESS Pittsburgh PA

FARM S.S. Toogarden DISTRICT Church COUNTY Wetzel

Filling Material Used \_\_\_\_\_

PLUGS USED AND DEPTH PLACED			BRIDGES	CASING AND TUBING		
CEMENT-THICKNESS	WOOD-SIZE	LEAD	CONSTRUCTION-LOCATION	RECOVERED	SIZE	LOST

*Trying to remove 10" casing pipe @ 20'*

Drillers' Names Water Morris & Ray Deegy

No additional plugging. 4" casing not removed.

Remarks: No information available from drillers as to test

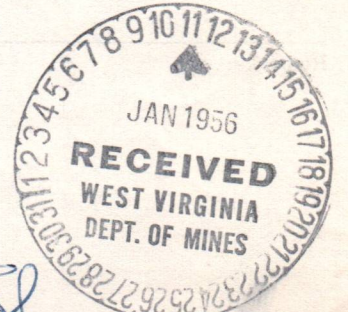

1-6 56 I hereby certify I visited the above well on this date.

*[Signature]*  
DISTRICT WELL INSPECTOR

10/06/2023

STATE OF WEST VIRGINIA  
DEPARTMENT OF MINES  
OIL AND GAS DIVISION

## INSPECTOR'S WELL REPORT

Permit No. \_\_\_\_\_

Oil or Gas Well \_\_\_\_\_  
(KIND)

	CASING AND TUBING	USED IN DRILLING	LEFT IN WELL	PACKERS
Company _____	Size			
Address _____	16			Kind of Packer _____
Farm _____	13			
Well No. _____	10			Size of _____
District _____ County _____	8 1/4			
Drilling commenced _____	6 5/8			Depth set _____
Drilling completed _____ Total depth _____	5 3/16			
Date shot _____ Depth of shot _____	3			Perf. top _____
Initial open flow _____ /10ths Water in _____ Inch	2			Perf. bottom _____
Open flow after tubing _____ /10ths Merc. in _____ Inch	Liners Used			Perf. top _____
Volume _____ Cu. Ft.				Perf. bottom _____
Rock pressure _____ lbs. _____ hrs.	CASING CEMENTED _____ SIZE _____ No. FT. _____ Date _____			
Oil _____ bbls., 1st 24 hrs.	COAL WAS ENCOUNTERED AT _____ FEET _____ INCHES			
Fresh water _____ feet _____ feet	_____ FEET _____ INCHES _____ FEET _____ INCHES			
Salt water _____ feet _____ feet	_____ FEET _____ INCHES _____ FEET _____ INCHES			

Drillers' Names \_\_\_\_\_

Remarks:

DATE

DISTRICT WELL INSPECTOR

10/06/2023

10

STATE OF WEST VIRGINIA  
DEPARTMENT OF MINES  
OIL AND GAS DIVISION

INSPECTOR'S PLUGGING REPORT

Permit No. WET 290-P

Well No. 1962

COMPANY W.P.'s Right and We-Tee ADDRESS \_\_\_\_\_

FARM S.S. Teagarden DISTRICT Church COUNTY Wetzel

Filling Material Used Clay & Cement

Liner	Location	Amount	Packer	Location			
PLUGS USED AND DEPTH PLACED			BRIDGES		CASING AND TUBING		
CEMENT-THICKNESS	WOOD-SIZE	LEAD	CONSTRUCTION-LOCATION	RECOVERED	SIZE	LOST	

Continuing GAS TEST

Drillers' Names Walter Morris & Roy Huggins

Remarks:

1-10-56  
DATE

I hereby certify I visited the above well on this date.

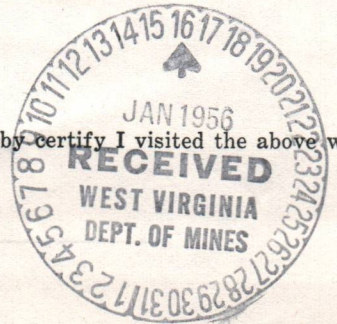

[Signature]  
DISTRICT WELL INSPECTOR

10/06/2023



STATE OF WEST VIRGINIA  
DEPARTMENT OF MINES  
OIL AND GAS DIVISION

INSPECTOR'S WELL REPORT

Permit No. \_\_\_\_\_

Oil or Gas Well \_\_\_\_\_  
(KIND)

		CASING AND TUBING	USED IN DRILLING	LEFT IN WELL	PACKERS
Company _____		Size			Kind of Packer _____
Address _____		16			
Farm _____		13			
Well No. _____		10			Size of _____
District _____ County _____		8 1/4			
Drilling commenced _____		6 5/8			Depth set _____
Drilling completed _____ Total depth _____		5 3/16			
Date shot _____ Depth of shot _____		3			Perf. top _____
Initial open flow _____ /10ths Water in _____ Inch		2			Perf. bottom _____
Open flow after tubing _____ /10ths Merc. in _____ Inch		Liners Used			Perf. top _____
Volume _____ Cu. Ft.					Perf. bottom _____
Rock pressure _____ lbs. _____ hrs.		CASING CEMENTED _____	SIZE _____	No. FT. _____	Date _____
Oil _____ bbls., 1st 24 hrs.		COAL WAS ENCOUNTERED AT _____ FEET _____ INCHES			
Fresh water _____ feet _____ feet		_____ FEET _____ INCHES _____ FEET _____ INCHES			
Salt water _____ feet _____ feet		_____ FEET _____ INCHES _____ FEET _____ INCHES			

Drillers' Names \_\_\_\_\_

Remarks: \_\_\_\_\_

DATE

DISTRICT WELL INSPECTOR

10/06/2023



STATE OF WEST VIRGINIA  
DEPARTMENT OF MINES  
OIL AND GAS DIVISION

INSPECTOR'S WELL REPORT

Permit No. \_\_\_\_\_

Oil or Gas Well \_\_\_\_\_  
(KIND)

		CASING AND TUBING	USED IN DRILLING	LEFT IN WELL	PACKERS
Company _____		Size			Kind of Packer _____
Address _____		16			
Farm _____		13			
Well No. _____		10			Size of _____
District _____ County _____		8 1/4			
Drilling commenced _____		6 5/8			Depth set _____
Drilling completed _____ Total depth _____		5 3/16			
Date shot _____ Depth of shot _____		3			Perf. top _____
Initial open flow _____ /10ths Water in _____ Inch		2			Perf. bottom _____
Open flow after tubing _____ /10ths Merc. in _____ Inch		Liners Used			Perf. top _____
Volume _____ Cu. Ft.					Perf. bottom _____
Rock pressure _____ lbs. _____ hrs.		CASING CEMENTED _____ SIZE _____ No. FT. _____ Date _____			
Oil _____ bbls., 1st 24 hrs.		COAL WAS ENCOUNTERED AT _____ FEET _____ INCHES			
Fresh water _____ feet _____ feet		_____ FEET _____ INCHES _____ FEET _____ INCHES			
Salt water _____ feet _____ feet		_____ FEET _____ INCHES _____ FEET _____ INCHES			

Drillers' Names \_\_\_\_\_

Remarks: \_\_\_\_\_

DATE \_\_\_\_\_

DISTRICT WELL INSPECTOR  
10/06/2023

STATE OF WEST VIRGINIA  
DEPARTMENT OF MINES  
OIL AND GAS DIVISION

**INSPECTOR'S PLUGGING REPORT**

Permit No. WAT 290-P Well No. 1962

COMPANY M. Sub Right And Heat Co ADDRESS Pittsburgh PA  
FARM SS. Tangarden DISTRICT Church COUNTY Wetzel

Filling Material Used Clay, Cement and Stone

Liner	Location	Amount	Packer	Location
PLUGS USED AND DEPTH PLACED			BRIDGES	
CEMENT-THICKNESS	WOOD-SIZE	LEAD	CONSTRUCTION-LOCATION	CASING AND TUBING
				RECOVERED    SIZE    LOST
	Bridge 3052'			2220' 9 5/8"
	Clay - 3052' - 3030'			300' 10"
	3030 - 3020'			
	Clay 2020' - 2230'			
	2230' - 2220'			
	Bridge 1600' Cleared out to 2095'. TOTAL DEPTH 2095'			
	Gas 42/10 in 1"			
	Volume 50.793' per day			
	Rock pressure 1340/48 hrs			

Drillers' Names Walter Morris & Ray Heagy

Remarks: My previous reports show that 2220' 5/8" casing was removed, it showed gas in salt sand. Therefore has been partially plugged as shown above.

30 56 I hereby certify I visited the above well on this date.  
DATE

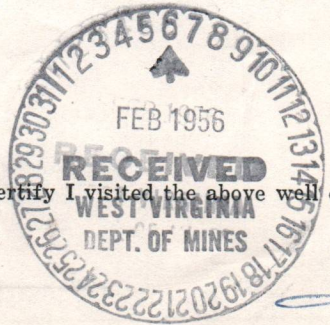

Bryan Shuman  
DISTRICT WELL INSPECTOR

10/06/2023

STATE OF WEST VIRGINIA  
DEPARTMENT OF MINES  
OIL AND GAS DIVISION

INSPECTOR'S WELL REPORT

Permit No. \_\_\_\_\_

Oil or Gas Well \_\_\_\_\_  
(KIND)

		CASING AND TUBING	USED IN DRILLING	LEFT IN WELL	PACKERS
Company _____		Size _____			Kind of Paeker _____
Address _____		16 _____			
Farm _____		18 _____			
Well No. _____		10 _____			Size of _____
District _____ County _____		8 1/4 _____			
Drilling commenced _____		6 5/8 _____			Depth set _____
Drilling completed _____ Total depth _____		5 8/16 _____			
Date shot _____ Depth of shot _____		3 _____			Perf. top _____
Initial open flow _____ /10ths Water in _____ Inch		2 _____			Perf. bottom _____
Open flow after tubing _____ /10ths Merc. in _____ Inch		Liners Used _____			Perf. top _____
Volume _____ Cu. Ft.					Perf. bottom _____
Rock pressure _____ lbs. _____ hrs.		CASING CEMENTED _____ SIZE _____ No. FT. _____ Date _____			
Oil _____ bbls., 1st 24 hrs.		COAL WAS ENCOUNTERED AT _____ FEET _____ INCHES			
Fresh water _____ feet _____ feet		_____ FEET _____ INCHES _____ FEET _____ INCHES			
Salt water _____ feet _____ feet		_____ FEET _____ INCHES _____ FEET _____ INCHES			

Drillers' Names \_\_\_\_\_

Remarks:

DATE

DISTRICT WELL INSPECTOR

10/06/2023

E-4



THE MANUFACTURERS LIGHT AND HEAT COMPANY  
800 UNION TRUST BUILDING • PITTSBURGH 19 • PENNSYLVANIA

October 7, 1955

RE \* Lease 2730, Well 1962  
Church District  
Wetzel County, West Virginia

Department of Mines  
Oil and Gas Division  
Charleston, West Virginia

Gentlemen:

We are enclosing 'Notice of Intention to Plug and Abandon Well' in triplicate, and 'Well Record' in duplicate, for the above mentioned well on the S. S. Teagarden tract. This well was drilled deeper under your permit WET-290.

Yours very truly,

THE MANUFACTURERS LIGHT AND HEAT COMPANY

Ben S. Cooper, Land Agent

lgs

Enclosures



10/06/2023

THE MANUFACTURERS LIGHT AND HEAT COMPANY  
HOLLAND STREET PITTSBURGH - PENNSYLVANIA

October 7, 1937

15 \* James St., Wall St.  
New York District  
New York, New York

Dear Sirs:

Reference:

We are enclosing herewith a copy of the report of the  
investigation conducted by the Bureau of Standards for the  
purpose of determining the efficiency of the lamps used  
in the above mentioned premises. This report was prepared  
under the supervision of the Bureau of Standards.

Very truly yours,

THE MANUFACTURERS LIGHT AND HEAT COMPANY

*[Handwritten Signature]*  
Tom E. Cooper, President

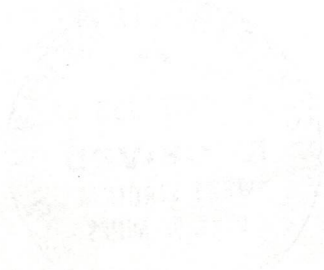



THE MANUFACTURERS LIGHT AND HEAT COMPANY  
800 UNION TRUST BUILDING • PITTSBURGH 19 • PENNSYLVANIA

March 6, 1956

Department of Mines  
Oil and Gas Section  
Charleston, West Virginia

RE \* Lease 2730, Well 1962  
Church District  
Wetzel County, W. Va.

Gentlemen:

We are enclosing 'Affidavit of Partial Plugging and Filling Well', as above numbered on the S. S. Teagarden farm - your Permit No. WET-290-P.

Yours very truly,

THE MANUFACTURERS LIGHT AND HEAT COMPANY

Walter A. Perrin  
Land Agent

jh

Enclosure



10/06/2023



Latitude 39° 45'

Longitude 80° 25'

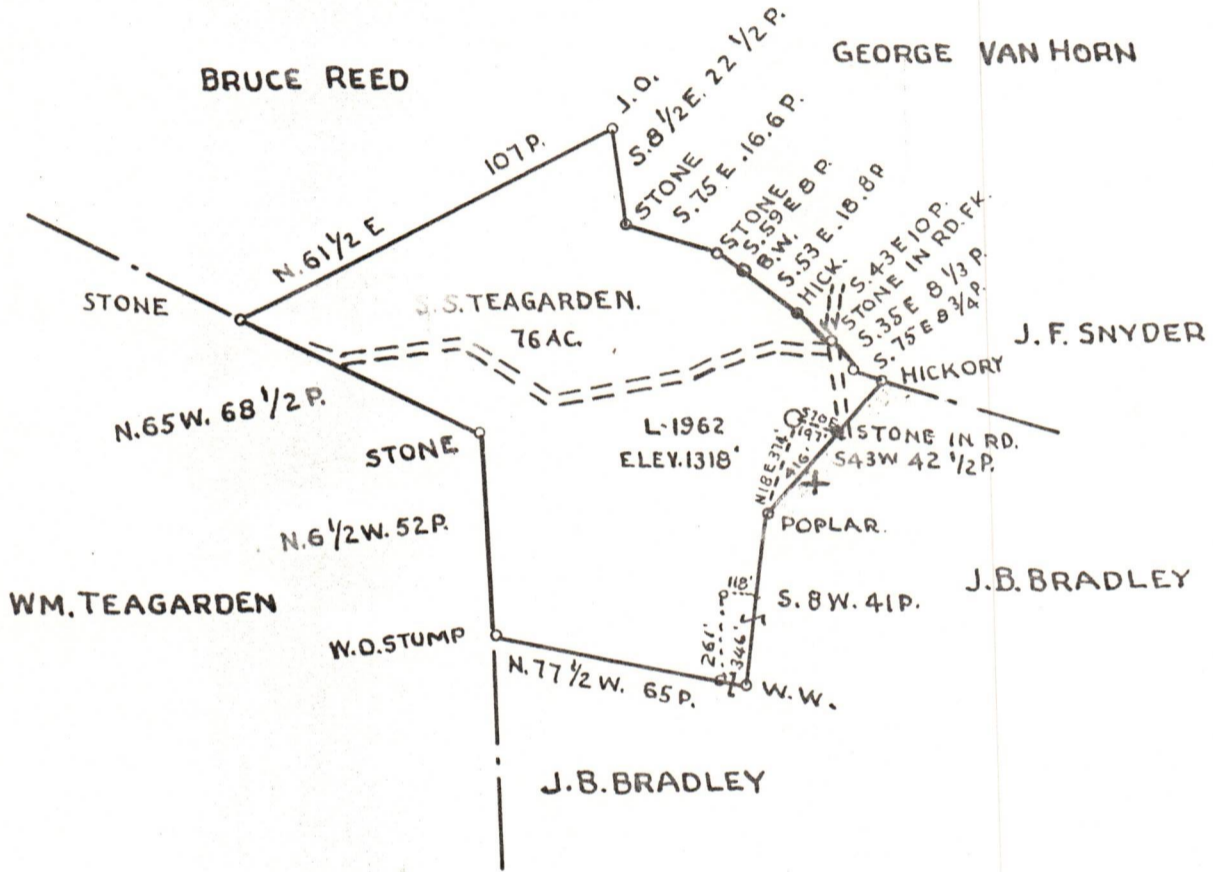

COAL OWNED BY T.L. ROGERSON 1/2 INTEREST AND EVERETT F. MOORE 1/2 INTEREST

New Location ::

Drill Deeper .....

Abandonment .....

Company THE MANUFACTURERS LIGHT AND HEAT CO.  
 Address 800 UNION TRUST BLDG. PITTSBURGH PENNA.  
 Farm S.S. TEAGARDEN  
 Tract \_\_\_\_\_ Acres 76 Lease No. 2730  
 Well (Farm) No. 2 Serial No. 1962  
 Elevation (Spirit Level) 1318'  
 Quadrangle MANNINGTON N.W. 1/4  
 County WETZEL District CHURCH  
 Engineer J. L. Mercer  
 Engineer's Registration No. \_\_\_\_\_  
 File No. INV. BK. W-14 P-4 Drawing No. Y-10-891  
 Date APRIL 13 1943 Scale 1" = 800

STATE OF WEST VIRGINIA  
 DEPARTMENT OF MINES  
 OIL AND GAS DIVISION  
 CHARLESTON

WELL LOCATION MAP  
 File No. WET-290 10/06/2023

+ Denotes location of well on United States Topographic Maps, scale 1 to 62,500, latitude and longitude lines being represented by border lines as shown.

— Denotes one inch spaces on border line of original tracing.