

STATE OF WEST VIRGINIA  
DEPARTMENT OF MINES  
OIL AND GAS DIVISION

NOTICE OF PROPOSED LOCATION OF OIL AND GAS WELL

To THE DEPARTMENT OF MINES,  
Charleston, W. Va.

J. LITTLETON DAWSON  
COAL OPERATOR OR COAL OWNER  
UNIONTOWN, PA.  
ADDRESS

CARNEGIE NATURAL GAS COMPANY  
NAME OF WELL OPERATOR  
1014 FRICK BLDG.,  
PITTSBURGH, PA.  
COMPLETE ADDRESS

COAL OPERATOR OR COAL OWNER  
ADDRESS

NOVEMBER 17, 1941.  
PROPOSED LOCATION

proctor District

THURMAN L. GODDARD, BEEBE, W. VA.  
OWNER OF MINERAL RIGHTS  
N. H. GODDARD,  
403 Annadale Ave., MOUNDSVILLE, W. VA.  
ADDRESS

Wetzel County

Well No. 1-1568. 39° 45'  
80° 40'

THURMAN L. GODDARD Farm

GENTLEMEN:

The undersigned well operator is entitled to drill upon the above named farm or tract of land for oil and gas, having fee title thereto, (or as the case may be) under grant or lease dated MAY 10, 1941, made by THURMAN L. GODDARD ET UX, ET AL, to CARNEGIE NATURAL GAS COMPANY, and recorded on the 1st day of JULY, 1941, in the office of the County Clerk for said County in Book 35-A, page 252.

The enclosed plat was prepared by a competent engineer and shows the proposed location of a well to be drilled for oil and gas by the undersigned well operator on the farm and in the Magisterial District and County above named, determined by survey and courses and distances from two permanent points, or land marks.

The undersigned well operator is informed and believes there are no coal operators operating beds of coal beneath said farm or tract of land on which said well is located, or within 500 feet of the boundaries of the same, who have mapped their workings and filed their maps as required by law, excepting the coal operators or coal owners (if any) above named as addressees.

The above named coal operators or coal owners (if any) are notified that any objections they may desire to make to such proposed location, or which they are required to make by Section 3 of said Code, if the drilling of a well at said proposed location will cause a dangerous condition in or about their respective coal mines, must be received by, or filed with the Department of Mines within ten\* days from the receipt of a copy of this notice and accompanying plat by said Department. Said coal operators are further notified that forms for use in making such objections will be furnished to them by the Department of Mines promptly on request and that all such objections must set forth as definitely as is reasonably possible the ground or grounds on which such objections are based and indicate the direction and distance the proposed location should be moved to overcome same.

(The next paragraph is to be completed only in Department's copy.)

Copies of this notice and the enclosed plat were mailed by registered mail, or delivered to the above named coal operators or coal owners at their above shown respective address \_\_\_\_\_ day \_\_\_\_\_ before, or on the same day with the mailing or delivery of this copy to the Department of Mines at Charleston, West Virginia.

Very truly yours,

CARNEGIE NATURAL GAS COMPANY  
By B. N. Archer  
WELL OPERATOR Land Agent.

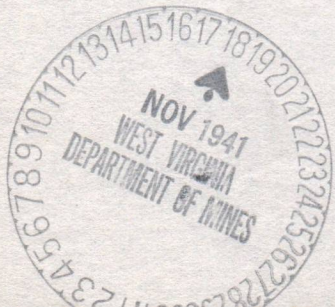

Address of Well Operator }

1014 FRICK BUILDING STREET  
PITTSBURGH, CITY OR TOWN  
PENNSYLVANIA STATE

10/13/2023

\*Section 3. If no such objections be filed or be found by the department of mines, within said period of ten days from the receipt of said notice and plat by the department of mines, to said proposed location, the department shall forthwith issue to the well operator a drilling permit reciting the filing of such plat, that no objections have been made by the coal operators to the location, or found thereto by the department, and that the same is approved and the well operator authorized to proceed to drill at said location.

STATE OF WEST VIRGINIA  
DEPARTMENT OF MINES  
OIL AND GAS DIVISION

NOTICE OF PROPOSED LOCATION OF OIL AND GAS WELL

To The Department of Mines,  
Charleston, W. Va.

CARNegie NATURAL GAS COMPANY  
NAME OF WELL OPERATOR  
1011 FRICK BLDG.  
PITTSBURGH, PA.  
COMPLETE ADDRESS

J. LITTLETON DAWSON  
COAL OPERATOR OR COAL OWNER  
UNIONTOWN, PA.  
ADDRESS

NOVEMBER 17, 1911  
PROPOSED LOCATION

COAL OPERATOR OR COAL OWNER

District

ADDRESS

County

THURMAN J. GODDARD, LESSEE, W. VA.  
OWNER OF MINERAL RIGHTS

Well No. 1-1568

N. F. GODDARD,  
103 Amanda Ave., MOUNDSVILLE, W. VA.  
ADDRESS

THURMAN J. GODDARD  
Farm

The undersigned well operator is entitled to drill upon the above named farm or tract of land for oil and gas, having fee title thereto, (or as the case may be) under grant or lease dated

MAY 10, 1911, made by THURMAN J. GODDARD ET AL, to

CARNegie NATURAL GAS COMPANY and recorded on the 1st day

of JULY, 1911, in the office of the County Clerk for said County in

Book 32-A, page 222

The enclosed plat was prepared by a competent engineer and shows the proposed location of a well to be drilled for oil and gas by the undersigned well operator on the farm and in the Mineral District and County above named, determined by survey and compass and distance from two permanent points, or land marks.

The undersigned well operator is informed and believes there are no coal operators operating beds of coal beneath said farm or tract of land on which said well is located, or within 500 feet of the boundary of the same, who have mapped their workings and filed their maps as required by law, excepting the coal operators or coal owners (if any) above named as addressees.

The above named coal operators or coal owners (if any) are notified that any objections they may desire to make to such proposed location, or which they are required to make by Section 8 of said Code, if the drilling of a well at said proposed location will cause a dangerous condition in or about their respective coal mines, must be received by or filed with the Department of Mines within ten days from the receipt of a copy of this notice and accompanying plat by said Department. Said coal operators are further notified that forms for use in making such objections will be furnished to them by the Department of Mines promptly on request and that all such objections must set forth as definitely as is reasonably possible the ground or grounds on which such objections are based and indicate the direction and distance the proposed location should be moved to overcome same.

(The next paragraph is to be completed only in Department's copy.)

Copies of this notice and the enclosed plat were mailed by registered mail, or delivered to the above

named coal operators or coal owners at their above shown respective addresses, on the same day with the mailing or delivery of this copy to the Department of Mines at Charleston, West Virginia.

Very truly yours,

CARNegie NATURAL GAS COMPANY

WELL OPERATOR  
Land Agent.

JOHN FRICK BUILDING

STREET

PITTSBURGH

CITY OR TOWN

PENNSYLVANIA

STATE

Address  
of  
Well Operator

Section 8. . . . If no such objections be filed or be found by the department of mines, within said period of ten days from the receipt of said notice and plat by the department of mines, to said proposed location, the department shall forthwith issue to the well operator a drilling permit reciting the date of such plat, that no objections have been made by the coal operators to the location, or found thereby by the department, and that the same is approved and the well operator authorized to proceed to drill at said location.

PERMIT NUMBER

JANETT PRINTING COMPANY, CHARLESTON, W. VA.

10/13/2023

A-10

November 28, 1941

Carnegie Natural Gas Company  
1014 Frick Building  
Pittsburgh, Pennsylvania

Gentlemen:

The following permits are enclosed:

MON-140 to drill deeper Well No. 3-95 on the  
J. H. Michael Farm, Grant District, Monongalia County.

WRT-269 to drill Well No. 1-1668 on the  
Thurman L. Goddard Farm, Proctor District, Wetzel County.

Very truly yours,

Secretary  
OIL AND GAS DIVISION

ME/am  
enc-4

10/13/2023

B-2

Formation	Color	Hard or Soft	Top	Bottom	Oil, Gas or Water	Depth Found	Remarks
Slate	Light	Soft	1268'	1300'			
Lime	Light	Hard	1300'	1310'			
Sand	Light	Hard	1310'	1323'			
Slate	Dark	Soft	1323'	1335'			
Rock	Red	Soft	1335'	1355'			
Slate	Light	Soft	1355'	1375'			
Lime	Dark	Medium	1375'	1379'			
Slate	Dark	Soft	1379'	1427'			
Sand	Dark	Hard	1427'	1435'			Steel Line 1431'
Slate	Dark	Soft	1435'	1460'			
L.D. Sand	Light	Hard	1460'	1497'			
Slate	Dark	Soft	1497'	1537'			
B.D. Sand	Light	Hard	1537'	1570'			
Slate	Light	Soft	1570'	1590'			
Slate	Soft	Dark	1590'	1610'			
Lime	Light	Hard	1610'	1620'			
G. Sand	Light	Hard	1620'	1665'			
Slate	Dark	Soft	1665'	1674'			
Lime	Light	Hard	1674'	1690'			
Slate	Dark	Soft	1690'	1718'			
1st. S. Sand	Light	Hard	1718'	1830'	Water	1820'	
Slate	Dark	Soft	1830'	1858'			
2nd. S. Sand	Light	Hard	1858'	1915'			
Slate	Dark	Soft	1915'	1925'			
Lime	Light	Hard	1925'	1938'			
Slate	Dark	Soft	1938'	1997'			
3d. S. Sand	Light	Hard	1997'	2025'			
Lime	Light	Hard	2025'	2045'			
Slate	Dark	Soft	2045'	2100'			
L. Lime	Light	Hard	2100'	2110'			
Slate	Dark	Soft	2110'	2115'			
Blue Mud Sand	Light	Hard	2115'	2125'			
B. Lime	Light	Hard	2125'	2177'			
B.I. Sand	Light	Hard	2177'	2440'			Steel Line 2380'
Slate	Dark	Soft	2440'	2455'			
Lime Shells	Light	Soft	2455'	2595'			
Berea Sand	Light	Hard	2595'	2618'			
Slate	Light	Soft	2618'	2620'			Steel Line 2604'
Lime	Light	Hard	2620'	2740'			
Slate	Light	Soft	2740'	2795'			
Lime Shells	Light	Hard	2795'	2895'			
Rock	Red	Soft	2895'	2900'			
Lime Shells	Light	Hard	2900'	2932'			
Rock	Red	Soft	2932'	2940'			
Lime Shells	Light	Hard	2940'	2998'			
Sand	Light	Hard	2998'	3006'			
Slate	Light	Soft	3006'	3010'			
Lime	Light	Hard	3010'	3040'			
G. Sand	Dark	Hard	3040'	3052'	Gas	3050'	
TOTAL DEPTH			3071'				

10/13/2023

MAY 12, 19...

Date....., 19.....

CARNEGIE NATURAL GAS COMPANY

APPROVED....., Owner

By.....  
(Title) Geologist.

WEST VIRGINIA DEPARTMENT OF MINES  
OIL AND GAS DIVISION

WELL RECORD

Permit No. WET-269

Oil or Gas Well Gas  
(Kind)

Company Carnegie Natural Gas  
Address Pittsburgh, Penna.  
Farm Thurman L. Goddard Acres 16  
Location (waters) Whetstone Creek  
Well No. 1568 Elev. 1211  
District Proctor County Wetzel  
The surface of tract is owned in fee by Thurman L. Goddard  
Address Bee Bee, W. Va.  
Mineral rights are owned by Thurman L. and N. H. Goddard  
Address Bee Bee, W. Va.  
Drilling commenced December 1, 1911  
Drilling completed February 12, 1912  
Date shot ---- Depth of shot ----  
Open Flow /10ths Water in ---- Inch  
10/10ths Merc. in 5-3/16" Inch  
Volume 2,913.000 Cu. Ft.  
Rock Pressure 930 lbs. lbs. 24 hrs.  
Oil ----- bbls., 1st 24 hrs.  
Fresh water 130 feet 1820 feet  
Salt water ----- feet ----- feet

Casing and Tubing	Used in Drilling	Left in Well	Packers
Size			
16			Kind of Packer
13			Bottom Hole
10	200'	200'	Size of <u>5-3/16"</u>
8 1/4	1380'	1380'	
6 5/8			Depth set <u>2108</u>
5 3/16	2108'	2108'	
3			Perf. top
2			Perf. bottom
Liners Used	None		Perf. top
			Perf. bottom

CASING CEMENTED ----- SIZE ----- No. FT. ----- Date -----  
COAL WAS ENCOUNTERED AT 958 FEET ----- INCHES  
1048 FEET ----- INCHES FEET ----- INCHES  
----- FEET ----- INCHES FEET ----- INCHES

Formation	Color	Hard or Soft	Top	Bottom	Oil Gas or Water	Depth Found	Remarks
Clay	Yellow	Soft	0'	10'			
Lime	Light	Hard	10'	18'			
Slate	Light	Soft	18'	35'			
Rock	Red	Soft	35'	48'			
Lime	Light	Hard	48'	64'			
Slate	Dark	Soft	64'	125'			
Lime	Light	Hard	125'	148'	Water	130'	
Slate	Dark	Soft	148'	185'			
Lime	Light	Hard	185'	210'			
Rock	Red	Soft	210'	225'			
Lime	Light	Hard	225'	240'			
Slate	Dark	Soft	240'	300'			
Rock	Red	Soft	300'	350'			
Lime	Light	Hard	350'	378'			
Slate	Light	Soft	378'	415'			
Rock	Red	Soft	415'	427'			
Slate	Light	Soft	427'	445'			
Sand	White	Hard	445'	460'			
Slate	Dark	Soft	460'	530'			
Rock	Red	Soft	530'	542'			
Lime	Light	Hard	542'	560'			
Slate	Dark	Soft	560'	675'			
Lime	Light	Hard	675'	700'			
Rock	Red	Soft	700'	710'			
Lime	Light	Hard	710'	740'			
Slate	Light	Soft	740'	785'			
Lime	Light	Hard	785'	875'	Gas	870'	Just a show
Sand	Light	Hard	875'	890'			
Lime	Light	Hard	890'	958'			
M. Coal	Black	Soft	958'	962'			Steel Line 962'
Lime	Light	Hard	962'	1030'			
Slate	Dark	Soft	1030'	1048'			
P. Coal	Dark	Soft	1048'	1053'			Steel Line 1053'
Slate	Light	Soft	1053'	1087'			
Sand	Light	Hard	1087'	1110'			
Rock	Red	Soft	1110'	1120'			
Slate	White	Soft	1120'	1150'			
Rock	Red	Soft	1150'	1187'			
Lime	Light	Hard	1187'	1235'			
Rock	Red	Soft	1235'	1245'			
Lime	Light	Hard	1245'	1268'			



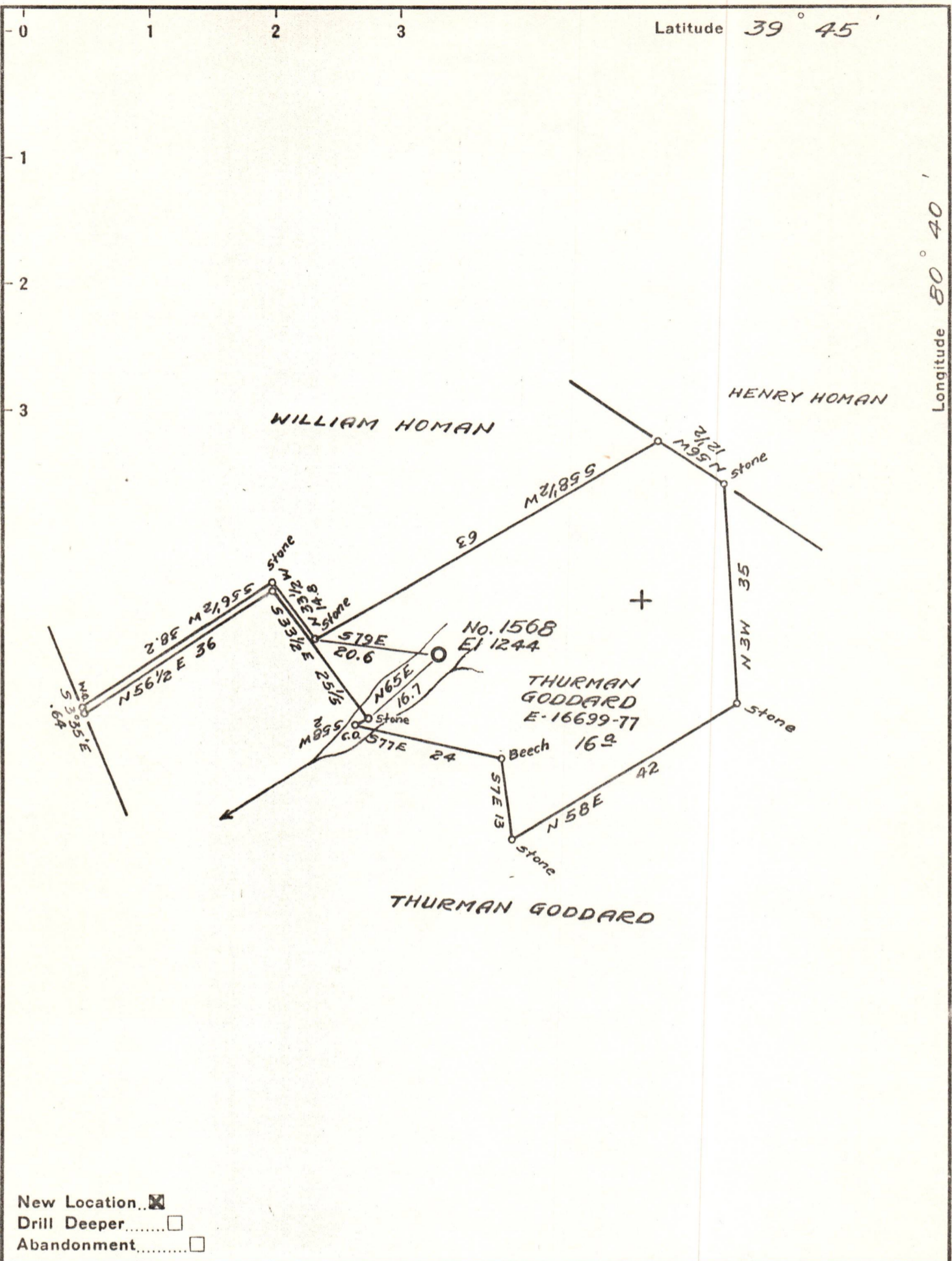

New Location   
 Drill Deeper   
 Abandonment

Company CARNEGIE NATURAL GAS  
 Address PITTSBURGH, PENNA.  
 Farm THURMAN L. GODDARD  
 Tract \_\_\_\_\_ Acres 16 Lease No. E-16699-77  
 Well (Farm) No. 1 Serial No. 1568  
 Elevation (Spirit Level) 1244  
 Quadrangle LITTLETON NW  
 County WETZEL District PROCTOR  
 Engineer R. L. SWEENEY  
 Engineer's Registration No. \_\_\_\_\_  
 File No. \_\_\_\_\_ Drawing No. \_\_\_\_\_  
 Date NOV 17, 1941 Scale 1" = 20 rods

STATE OF WEST VIRGINIA  
 DEPARTMENT OF MINES  
 OIL AND GAS DIVISION  
 CHARLESTON

WELL LOCATION MAP  
 FILE NO. WET-269 10/13/2023

+ Denotes location of well on United States Topographic Maps, scale 1 to 62,500, latitude and longitude lines being represented by border lines as shown.

- Denotes one inch spaces on border line of original tracing.