

NOTICE OF PROPOSED LOCATION OF OIL AND GAS WELL

(REQUIRED BY SECTION 2, CHAPTER 22, CODE 1931)

WEST VIRGINIA DEPARTMENT OF MINES

OIL AND GAS SECTION

To THE DEPARTMENT OF MINES,
Charleston, W. Va.

Copy to

Roosevelt Coal & Coke Co.,

THE MANUFACTURERS LIGHT & HEAT COMPANY

COAL OPERATOR OR COAL OWNER

NAME OF WELL OPERATOR

902 Diamond Bank Bldg., Pittsburgh, Pa.

800 Union Trust Building, Pittsburgh, Pa.

ADDRESS

COMPLETE ADDRESS

COAL OPERATOR OR COAL OWNER

September 15th, 1941

193

PROPOSED LOCATION

ADDRESS

Proctor

District

OWNER OF MINERAL RIGHTS

Wetzel

County

ADDRESS

Well No. 1 - 3617

39° 45'
80° 40'

William Estep

Farm

GENTLEMEN:

The undersigned well operator is entitled to drill upon the above named farm or tract of land for oil and gas, having fee title thereto, (or as the case may be) under grant or lease dated

August 28th, 1939

made by William Estep, single,

to

The Manufacturers Light & Heat Company

and recorded on the 16th day

of September, 1939

in the office of the County Clerk for said County in

O&G Book 33-A, page 369

The enclosed plat was prepared by a competent engineer and shows the proposed location of a well to be drilled for oil and gas by the undersigned well operator on the farm and in the Magisterial District and County above named, determined by survey and courses and distances from two permanent points, or land marks.

The undersigned well operator is informed and believes there are no coal operators operating beds of coal beneath said farm or tract of land on which said well is located, or within 500 feet of the boundaries of the same, who have mapped their workings and filed their maps as required by law, excepting the coal operators or coal owners (if any) above named as addressees.

The above named coal operators or coal owners (if any) are notified that any objections they may desire to make to such proposed location, or which they are required to make by Section 3 of said Code, if the drilling of a well at said proposed location will cause a dangerous condition in or about their respective coal mines, must be received by, or filed with the Department of Mines within ten* days from the receipt of a copy of this notice and accompanying plat by said Department. Said coal operators are further notified that forms for use in making such objections will be furnished to them by the Department of Mines promptly on request and that all such objections must set forth as definitely as is reasonably possible the ground or grounds on which such objections are based and indicate the direction and distance the proposed location should be moved to overcome same.

(The next paragraph is to be completed only in Department's copy.)

Copies of this notice and the enclosed plat were mailed by registered mail, or delivered to the above named coal operators or coal owners at their above shown respective address this day before, or on the same day with the mailing or delivery of this copy to the Department of Mines at Charleston, West Virginia.

Very truly yours, THE MANUFACTURERS LIGHT & HEAT CO.,

Harry H. Fowler

Land Dept. WELL OPERATOR Office Manager

800 Union Trust Building

STREET

Address of Well Operator }

Pittsburgh

CITY OR TOWN

Pennsylvania

STATE

10/13/2023

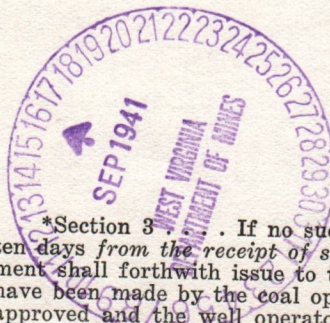

*Section 3. If no such objections be filed, or be found by the department of mines, within said period of ten days from the receipt of said notice and plat by the department of mines, to said proposed location, the department shall forthwith issue to the well operator a drilling permit reciting the filing of such plat, that no objections have been made by the coal operators to the location, or found thereto by the department, and that the same is approved and the well operator authorized to proceed to drill at said location.

266

NOTICE OF PROPOSED LOCATION OF OIL AND GAS WELL

WEST VIRGINIA DEPARTMENT OF MINES
OIL AND GAS SECTION

To The Boardman of Mines
Charleston, W. Va.

Roosevelt Coal & Coke Co.,

THE MANUFACTURERS LIGHT & HEAT COMPANY

NAME OF WELL OPERATOR

NAME OF MINERAL RIGHTS

NAME OF COAL OPERATOR

PROPOSED LOCATION

ADDRESS

PROCTOR

COUNTY OF MINERAL RIGHTS

Wetzel

ADDRESS

William Esch

DATE

The undersigned well operator is notified to file upon the above named tract of land for

oil and gas having to this date, or as the case may be, under lease or leasehold

August 28th, 1939

made by William Esch, et al.

The Manufacturers Light & Heat Company

1939

September, 1939

in the office of the County Clerk for said county in

000 Book 33-1 Page 369

The enclosed plat was prepared by a competent engineer and shows the proposed location of a well to be drilled for oil and gas by the undersigned well operator on the tract and in the mineral interest owned and jointly above named, determined by survey and records and distance from two permanent points of land marked.

The undersigned well operator is informed and believes there are no other operators operating on or beneath said tract or part of land on which said well is located or within 500 feet of the boundary of the tract, who have mapped their workings and their maps are returned by law to the coal operators or coal owners (if any) above named as addressed.

The above named coal operators or coal owners (if any) are notified that any objection they may desire to make to such proposed location or which they are required to make by Section 7 of Act No. 11 of the Session of 1937, or which will cause a dangerous condition to or about the proposed well, must be received by or filed with the Department of Mines within ten days from the receipt of a copy of this notice and accompanying plat by said Department. Said coal operators and persons mentioned in this notice will be furnished to them by the Department of Mines promptly on request and that all such objections must set forth as distinctly as is reasonably possible the ground or grounds on which such objection are based and indicate the direction and distance the proposed location should be moved to overcome same.

(The next paragraph is to be completed only in Department's report.)
Copies of this notice and the enclosed plat were mailed by registered mail, in duplicate, to the above named coal operators or coal owners at their above shown respective addresses, and a copy of this copy to the Department of Mines at Charleston, West Virginia, on the same day with the mailing or delivery of this copy to the Department of Mines at Charleston, West Virginia.

Very truly yours, THE MANUFACTURERS LIGHT & HEAT COMPANY

800 Union Trust Building
Pittsburgh
CITY OF YORK
PENNSYLVANIA

Address of Well Operator

10/13/2023

Section 7. . . . If no such objections be filed, or be found by the Department of Mines within said period of ten days from the receipt of said notice and plat by the Department of Mines, it shall be deemed that the proposed location of the well is lawful and the well operator is drilling pursuant to the provisions of said Act. . . .



STATE OF WEST VIRGINIA
DEPARTMENT OF MINES
OIL AND GAS DIVISION

NOTICE OF PROPOSED LOCATION OF OIL AND GAS WELL

To THE DEPARTMENT OF MINES,
Charleston, W. Va.

ROOSEVELT COAL & COKE COMPANY
COAL OPERATOR OR COAL OWNER

Wilmerding, Pennsylvania
ADDRESS

COAL OPERATOR OR COAL OWNER

ADDRESS

OWNER OF MINERAL RIGHTS

ADDRESS

THE MANUFACTURERS LIGHT AND HEAT COMPANY
NAME OF WELL OPERATOR

800 UNION TRUST BUILDING
PITTSBURGH, PENNSYLVANIA
COMPLETE ADDRESS

February 16, 1954

PROPOSED LOCATION

Proctor District

Wetzel County

Well No. 1-3617 39° 45'
80° 40'

Frank Estep Farm

GENTLEMEN:

The undersigned well operator is entitled to ~~drill~~ ^{reopen} upon the above named farm or tract of land for oil and gas, having fee title thereto, (or as the case may be) under grant or lease dated April 5, 1952, made by William Estep, to THE MANUFACTURERS LIGHT AND HEAT COMPANY, and recorded on the 12th day of May, 1952, in the office of the County Clerk for said County in Book 40-A, page 111.

The enclosed plat was prepared by a competent engineer and shows the proposed location of a well to be drilled for oil and gas by the undersigned well operator on the farm and in the Magisterial District and County above named, determined by survey and courses and distances from two permanent points, or land marks.

The undersigned well operator is informed and believes there are no coal operators operating beds of coal beneath said farm or tract of land on which said well is located, or within 500 feet of the boundaries of the same, who have mapped their workings and filed their maps as required by law, excepting the coal operators or coal owners (if any) above named as addressees.

The above named coal operators or coal owners (if any) are notified that any objections they may desire to make to such proposed location, or which they are required to make by Section 3 of said Code, if the drilling of a well at said proposed location will cause a dangerous condition in or about their respective coal mines, must be received by, or filed with the Department of Mines within ten* days from the receipt of a copy of this notice and accompanying plat by said Department. Said coal operators are further notified that forms for use in making such objections will be furnished to them by the Department of Mines promptly on request and that all such objections must set forth as definitely as is reasonably possible the ground or grounds on which such objections are based and indicate the direction and distance the proposed location should be moved to overcome same.

(The next paragraph is to be completed only in Department's copy.)

Copies of this notice and the enclosed plat were mailed by registered mail, or delivered to the above named coal operators or coal owners at their above shown respective address _____ day _____ before, or on the same day with the mailing or delivery of this copy to the Department of Mines at Charleston, West Virginia.

Very truly yours,

LAND AGENT
THE MANUFACTURERS LIGHT AND HEAT COMPANY
STREET
800 UNION TRUST BUILDING
CITY OR TOWN 10/13/2023
PITTSBURGH, PENNSYLVANIA
STATE

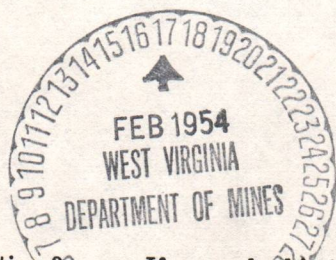

Address of Well Operator }

*Section 3. . . . If no such objections be filed or be found by the department of mines, within said period of ten days from the receipt of said notice and plat by the department of mines, to said proposed location, the department shall forthwith issue to the well operator a drilling permit reciting the filing of such plat, that no objections have been made by the coal operators to the location, or found thereto by the department, and that the same is approved and the well operator authorized to proceed to drill at said location.

266-Redrill



STATE OF WEST VIRGINIA
DEPARTMENT OF MINES
OIL AND GAS DIVISION

NOTICE OF PROPOSED LOCATION OF OIL AND GAS WELL

To The Department of Mines
Charleston, W. Va.

THE MANUFACTURERS LIGHT AND HEAT COMPANY

ROOSEVELT COAL & COKE COMPANY

NAME OF WELL OPERATOR

COAL OPERATOR OR COAL OWNER

300 UNION TRUST BUILDING
PITTSBURGH, PENNSYLVANIA

Wilmering, Pennsylvania

February 16, 1924

PROPOSED LOCATION

COAL OPERATOR OR COAL OWNER

Proctor District

ADDRESS

Wetzel County

OWNER OF MINERAL RIGHTS

Well No. 1-3614

ADDRESS

Frank Tatep

Gentlemen:

The undersigned well operator is entitled to mine upon the above named farm or tract of land for oil and gas, having for this purpose, (or as the case may be) under grant or lease dated

April 5, 1922 made by William Tatep

and recorded on the 12th day

of May, 1922 in the office of the County Clerk for said County in

Book 40-A page 111

The enclosed plat was prepared by a competent engineer and shows the proposed location of a well to be drilled for oil and gas by the undersigned well operator on the farm and in the Mineral District of Wetzel County above named, determined by survey and courses and bearings from two permanent points or land marks.

The undersigned well operator is informed and believes there are no coal operators operating beds of coal beneath said farm or tract of land on which said well is located, or within 500 feet of the bounds of the same, who have trapped their workings and filed their maps as required by law, excepting the coal operators or coal owners (if any) above named as addressees.

The above named coal operators or coal owners (if any) are notified that any objections they may desire to make to such proposed location, or which they are required to make by Section 3 of said Code, if the drilling of a well at said proposed location will cause a dangerous condition in or about their respective coal mines, must be received by, or filed with the Department of Mines within ten days from the receipt of a copy of this notice and accompanying plat by said Department. Said coal operators are further notified that terms for use in making such objections will be furnished to them by the Department of Mines promptly on request and that all such objections must set forth as definitely as is reasonably possible the ground or grounds on which such objections are based and indicate the direction and distance the proposed location should be moved to overcome same.

(The next paragraph is to be completed only in Department's copy.)

Copies of this notice and the enclosed plat were mailed by registered mail, or delivered to the above named coal operators or coal owners at their above shown respective addresses

on the same day with the mailing or delivery of this copy to the Department of Mines at Charleston, West Virginia.

Very truly yours,

Frank Tatep
MANUFACTURERS LIGHT AND HEAT COMPANY

THE MANUFACTURERS LIGHT AND HEAT COMPANY

300 UNION TRUST BUILDING

PITTSBURGH, PENNSYLVANIA

Address

of

Well Operator



10/13/2023

Section 7. If no such objections be filed or be found by the department of mines within said period of ten days from the receipt of said notice and plat by the department of mines, the department shall forthwith issue to the well operator a definite permit setting the line of said well, and no objections have been made by any coal operators or land owners to the location, or found hereby by the department, and that the same is approved, and the well operator authorized to proceed to drill at said location.

A-18

September 26, 1941

The Manufacturers Light & Heat Company
800 Union Trust Building
Pittsburgh, Pennsylvania

Gentlemen:

Permit WET-206 to drill Well No. 1-3617 on the
William Estep Farm, Proctor District, Wetzel County, is
enclosed.

Very truly yours,

Secretary
OIL AND GAS DIVISION

ME/qm
enc-2

Lat39d-45'
Long80d-40'

10/13/2023

A-11

February 27, 1954

The Manufacturers Light and Heat Company
800 Union Trust Building
Pittsburgh, Pennsylvania

Gentlemen:

Enclosed are permits for the redrilling of the following wells:

<u>Permit No.</u>	<u>Well No.</u>	<u>Farm</u>	<u>District</u>
Wet-266-R	1-3617	Frank Estep	Proctor
Wet-317-R	F-22215	Joseph M. Estep	Proctor

Very truly yours,

Administrative Assistant
OIL AND GAS DIVISION

CNH:K
Encl-4

CC: Inspector Oliver W. Lineberg

10/13/2023

The Manufacturers Light & Heat Company

Division 4

Record of Well No. 3617 on William Estep Farm 65 Acres

Reader Proctor Field Wetzel District Wetzel County W.Va. State

Rig Commenced 9/12/41 19 , Completed 9/26/41 19

Drilling Commenced 10/1/41 19 , Completed 11/10/41 19

Contractor T.E. Little Address New Matamoras, Ohio.

Driller' Name John Carroll, C.A. Postlethwait, T.C. Rawo.

CASING AND TUBING RECORD

Conductor	13"	10"	8 1/4"	7"	6 5/8"	5 3/8"	4"	3"		
Used in Drlg.		<u>521'-11"</u>	<u>1740'-8"</u>		<u>2353'-9"</u>					
Left in Well										

PACKER RECORD

SHOOTING RECORD

Size	Depth Set	Type Packer	Date	Type Explosive	Amount	DEPTH		Volume Before Cu. Ft.	Volume After Cu. Ft.
						Top	Bottom		
			<u>11/11/41</u>	<u>Glycerine</u>	<u>50qts</u>	<u>3230</u>	<u>3241</u>	<u>3.919</u>	<u>8.661</u>

VOLUME AND PRESSURE

Date	Reading In Inches	Liquid	Size Orifice	Volume	Sand	PRESSURE IN MIN.					24 Hr. R. P.	Max. R. P.	Hours	
						1	5	10	30	60				

TOTAL INITIAL OPEN FLOW

3.919

CUBIC FEET PER 24 HOURS

FORMATION	TOP	BOTTOM	THICKNESS	REMARKS
Clay	0	16	16	
Slate	16	56	40	
Red rock	56	76	20	
Slate	76	101	25	
Sand	101	121	20	
Slate	121	161	40	
Red rock	161	186	25	
Slate	186	213	27	
Red rock	213	223	10	
Slate	223	275	52	
Lime	275	280	5	
Slate	280	285	5	
Red rock	285	298	13	
Slate	298	325	27	
Red rock	325	344	19	
Lime	344	351	7	
Red rock	351	365	14	
Slate	365	391	26	
Red rock	391	402	11	
Slate	402	415	13	
Red rock	415	420	5	
Slate	420	438	18	
Red rock	438	445	7	
Lime	445	452	7	
Slate	452	460	8	
Red rock	460	470	10	
Sand	470	480	10	
Red rock	480	490	10	

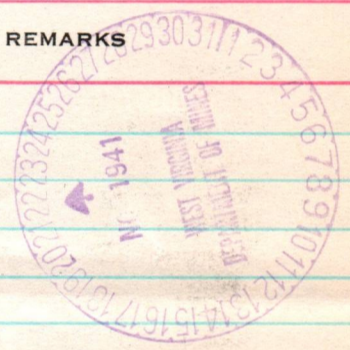

10/13/2023

Examined above information and measurements and found to be correct by
 _____ Contractor

Examined and Approved by
 _____ Field Superintendent

NOTE—The above blank must be filled out carefully by the contractor, with a complete and accurate record of the well, and accompany, when presented for payment of the bill for drilling. All formations and known sands must be given by their proper name, with steel line measurements, and under the head of "Remarks" must be recorded in what sand and at what depth Oil, Gas or Water was found, the quantity of same, the quality of the sand, and thickness of pay.

WELL RECORD

CO.

Well No. _____

Farm _____

District _____

County _____

State _____

Owned by _____

Division _____

Date _____

194

Entered W. R. Book Folio _____

By _____

10/13/2023

Sheet # 2

Company

Division

Record of Well No. 3617

on

Farm

Acres

Field

District
Township

County

State

Rig Commenced

19

Completed

19

Drilling Commenced

19

Completed

19

Contractor

Address

Driller' Name

CASING AND TUBING RECORD

	Conductor	13"	10"	8 1/4"	7"	6 5/8"	5 3/8"	4"	3"		
Used in Drlg.											
Left in Well											

PACKER RECORD

SHOOTING RECORD

Size	Depth Set	Type Packer	Date	Type Explosive	Amount	DEPTH		Volume Before Cu. Ft.	Volume After Cu. Ft.
						Top	Bottom		

VOLUME AND PRESSURE

Date	Reading In Inches	Liquid	Size Orifice	Volume	Sand	PRESSURE IN MIN.					24 Hr. R. P.	Max. R. P.	Hours
						1	5	10	30	60			

TOTAL INITIAL OPEN FLOW

CUBIC FEET PER 24 HOURS

FORMATION	TOP	BOTTOM	THICKNESS	REMARKS
Slate	490	510	20	522' - 10"
Lime	510	520	10	
Slate	520	526	6	
Red rock	526	532	6	
Slate	532	555	23	
Lime	555	570	15	
Sand	570	595	25	
Slate	595	620	25	
Red rock	620	633	13	
Slate	633	655	22	
Red rock	655	671	16	
Lime	671	677	6	
Slate	677	680	3	
Lime	680	705	25	
Slate	705	730	25	
Lime	730	745	15	
Slate	745	773	28	
Shale	773	785	12	
Slate	785	807	22	
Lime	807	815	8	
Red rock	815	820	5	
Slate	820	851	31	
Coal	851	852	1	
Lime	852	866	14	
Slate	866	925	59	
Lime	925	937	12	
Slate	937	958	21	
Red rock	958	973	15	



10/13/2023

Examined above information and measurements and found to be correct by

Examined and Approved by

Contractor

Field Superintendent

NOTE—The above blank must be filled out carefully by the contractor, with a complete and accurate record of the well, and accompany, when presented for payment of the bill for drilling. All formations and known sands must be given by their proper name, with steel line measurements, and under the head of "Remarks" must be recorded in what sand and at what depth Oil, Gas or Water was found, the quantity of same, the quality of the sand, and thickness of pay.

WELL RECORD

CO.

Well No. _____

Farm _____

District _____

County _____

State _____

Owned by _____

Division _____

Date _____

194

Entered W. R. Book Folio _____

By _____

10/13/2023

B-3

266

SHEET # 3

Company

Division

Record of Well No. 3617

on

Farm

Acres

Field

District Township

County

State

Rig Commenced 19 , Completed 19

Drilling Commenced 19 , Completed 19

Contractor Address

Driller' Name

CASING AND TUBING RECORD

	Conductor	13"	10"	8 1/4"	7"	6 5/8"	5 3/16"	4"	3"		
Used in Drlg.											
Left in Well											

PACKER RECORD

SHOOTING RECORD

Size	Depth Set	Type Packer	Date	Type Explosive	Amount	DEPTH		Volume Before Cu. Ft.	Volume After Cu. Ft.
						Top	Bottom		

VOLUME AND PRESSURE

Date	Reading In Inches	Liquid	Size Orifice	Volume	Sand	PRESSURE IN MIN.					24 Hr. R. P.	Max. R. P.	Hour	
						1	5	10	30	60				

TOTAL INITIAL OPEN FLOW

CUBIC FEET PER 24 HOURS

FORMATION	TOP	BOTTOM	THICKNESS	REMARKS
Lime	973	993	20	
Slate	993	997	4	
Lime	997	1047	50	
Red rock	1047	1062	15	
Lime	1062	1126	64	
Mapletown Coal	1126	1127	1	
Shale	1127	1135	8	
Lime	1135	1208	73	
Slate	1208	1223	15	
Pitts. Coal	1223	1225	2	
Slate	1225	1232	7	
Lime	1232	1238	6	
Sand	1238	1248	10	
Slate	1248	1257	9	
Lime	1257	1278	21	
Slate	1278	1315	37	
Sand	1315	1330	15	
Slate	1330	1350	20	
Shale	1350	1358	8	
Lime	1358	1395	37	
Slate	1395	1405	10	
Red rock	1405	1452	47	
Slate	1452	1500	48	
Red rock	1500	1525	25	
Slate	1525	1537	12	
Lime	1537	1555	18	
Shale	1555	1561	6	
Lime	1561	1582	21	



1127
30

10/13/2023

Examined above information and measurements and found to be correct by

Examined and Approved by

Contractor

Field Superintendent

NOTE—The above blank must be filled out carefully by the contractor, with a complete and accurate record of the well, and accompany, when presented for payment of the bill for drilling. All formations and known sands must be given by their proper name, with steel line measurements, and under the head of "Remarks" must be recorded in what sand and at what depth Oil, Gas or Water was found, the quantity of same, the quality of the sand, and thickness of pay.

WELL RECORD

CO.

Well No. _____

Farm _____

District _____

County _____

State _____

Owned by _____

Division _____

Date _____

194

Entered W. R. Book Folio _____

By _____

10/13/2023

13-4

266

Division _____ SHEET # 4 Company _____
 Record of Well No. 3617 on _____ Farm _____ Acres _____
 Field _____ District Township _____ County _____ State _____
 Rig Commenced 19 , Completed 19
 Drilling Commenced 19 , Completed 19
 Contract _____ Address _____
 Driller' Name _____

CASING AND TUBING RECORD

Conductor	13"	10"	8 1/4"	7"	6 5/8"	5 3/8"	4"	3"		
Used in Drlg.										
Left in Well										

PACKER RECORD

SHOOTING RECORD

Size	Depth Set	Type Packer	Date	Type Explosive	Amount	DEPTH		Volume Before Cu. Ft.	Volume After Cu. Ft.
						Top	Bottom		

VOLUME AND PRESSURE

Date	Reading In Inches	Liquid	Size Orifice	Volume	Sand	PRESSURE IN MIN.					24 Hr. R. P.	Max. R. P.	Hours	
						1	5	10	30	60				

TOTAL INITIAL OPEN FLOW

CUBIC FEET PER 24 HOURS

FORMATION	TOP	BOTTOM	THICKNESS	REMARKS
Sand	1582	1590	8	
Slate	1590	1600	10	
Little Dunkard	1600	1629	29	
Slate	1629	1665	36	
Lime	1665	1668	3	
Sand	1668	1675	7	
Slate	1675	1712	37	
Big Dunkard	1712	1718	6	
Slate	1718	1748	30	
Lime	1748	1825	77	
Shale	1825	1836	11	
Lime	1836	1858	22	
Lime (Gritty)	1858	1877	19	
Slate	1877	1885	8	
1st Salt sand	1885	1902	17	
Slate	1902	1925	23	
2nd salt sand	1925	1995	70	Water @ 1972' - 3/4 bbl per hr
Slate	1995	2145	150	
Lime	2145	2190	45	
Slate	2190	2238	48	
Maxon sand	2238	2258	20	
Slate	2258	2265	7	
Lime	2265	2290	25	
Blue Mundy	2290	2316	26	
Big Lime	2316	2365	49	
Big Injun sand	2365	2625	260	Salt water @ 2370'
Slate	2625	2650	25	
Lime	2650	2690	40	

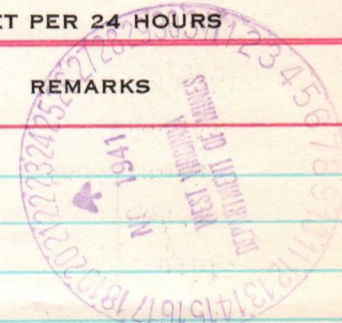

1740' - 8 1/4'

2353' - 9" - 6 5/8'

10/13/2023

Examined above information and measurements and found to be correct by

Examined and Approved by

Contractor

Field Superintendent

NOTE—The above blank must be filled out carefully by the contractor, with a complete and accurate record of the well, and accompany, when presented for payment of the bill for drilling. All formations and known sands must be given by their proper name, with steel line measurements, and under the head of "Remarks" must be recorded in what sand and at what depth Oil, Gas or Water was found, the quantity of same, the quality of the sand, and thickness of pay.

WELL RECORD

CO.

Well No. _____

Farm _____

District _____

County _____

State _____

Owned by _____

Division _____

Date _____

194

Entered W. R. Book Folio _____

By _____

10/13/2023

B-5

266

SHEET # 5

Company

Division

Record of Well No. 3617

on

Farm

Acres

Field

District Township

County

State

Rig Commenced 19 , Completed 19

Drilling Commenced 19 , Completed 19

Contractor Address

Driller' Name

CASING AND TUBING RECORD

	Conductor	13"	10"	8 1/4"	7"	6 5/8"	5 3/16"	4"	3"		
Used in Drig.											
Left in Well											

PACKER RECORD

SHOOTING RECORD

Size	Depth Set	Type Packer	Date	Type Explosive	Amount	DEPTH		Volume Before Cu. Ft.	Volume After Cu. Ft.
						Top	Bottom		

VOLUME AND PRESSURE

Date	Reading In Inches	Liquid	Size Orifice	Volume	Sand	PRESSURE IN MIN.					24 Hr. R. P.	Max. R. P.	Hours	
						1	5	10	30	60				

TOTAL INITIAL OPEN FLOW

CUBIC FEET PER 24 HOURS

FORMATION	TOP	BOTTOM	THICKNESS	REMARKS
Lime	2690	2698	8	
Slate	2698	2718	20	
Lime	2718	2758	40	
Slate	2758	2765	7	
Berea sand	2765	2790	25	
Slate	2790	2802	12	
Lime	2802	2822	20	
Slate & Shells	2822	2850	28	
Gritty lime	2850	2865	15	
Slate	2865	2875	10	
Lime	2875	2885	10	
Slate	2885	2968	83	
50 foot lime	2968	2990	22	
Slate & Shells	2990	3063	73	
Red rock	3063	3133	70	
Slate	3133	3175	42	
Lime	3175	3188	13	
Slate	3188	3220	42	
Gordon stray	3220	3225	5	
Slate	3225	3230	5	
Gordon sand	3230	3243	13	Gas @ 3235'
Slate	3243	3252	9	
Lime	3252	3258	6	
Slate	3258	3300	82	
Total depth	3330			

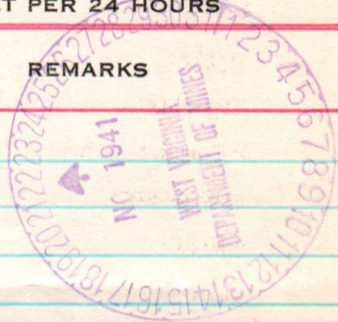

10/13/2023

Examined above information and measurements and found to be correct by

Examined and Approved by

Contractor

Harry ... Field Superintendent

NOTE—The above blank must be filled out carefully by the contractor, with a complete and accurate record of the well, and accompany, when presented for payment of the bill for drilling. All formations and known sands must be given by their proper name, with steel line measurements, and under the head of "Remarks" must be recorded in what sand and at what depth Oil, Gas or Water was found, the quantity of same, the quality of the sand, and thickness of pay.

WELL RECORD

THE MANUFACTURERS LIGHT & HEAT CO.

CO.

Well No. 3617

Farm William Estep

District Proctor

County Metzel

State West Va

Owned by THE MANUFACTURERS LIGHT & HEAT CO.

Division _____

Date 1914

Entered W. R. Book Folio _____

By _____

10/13/2023

13-7

Formation	Color	Hard or Soft	Top	Bottom	Oil, Gas or Water	Depth Found	Remarks
Gordon Sand			3230	3243	Gas	3235	
Slate & Lime			3243	3330			
Total depth				3330			

10/13/2023

Date December 30th, 1941

APPROVED THE MANUFACTURERS LIGHT & HEAT COMPANY, Owner

By Jerry H. Fowler
Land Dept. (Title)

STATE OF WEST VIRGINIA
DEPARTMENT OF MINES
OIL AND GAS DIVISION

WELL RECORD

Permit No. WET 266

Oil or Gas Well Dry Hole
(KIND)

Company The Manufacturers Light & Heat Co.
 Address 800 Union Trust Bldg., Pittsburgh, Pa.
 Farm William Estep Acres 65
 Location (waters).....
 Well No. 1 - 3617 Elev. 1410 ft.
 District Proctor County Wetzel
 The surface of tract is owned in fee by William Estep
2211 Marshall Ave., Address Elm Grove, W. Va.
 Mineral rights are owned by The M L & H Co.
800 Union Trust Bldg., Address Pittsburgh, Pa.
 Drilling commenced 10/1/41
 Drilling completed 11/10/41
 Date shot 11/11/41 Depth of shot 3230-3241
 Open Flow /10ths Water in..... Inch
 /10ths Merc. in..... Inch
 Volume..... Cu. Ft.
 Rock Pressure..... lbs..... hrs.
 Oil..... bbls., 1st 24 hrs.
 Fresh water..... feet..... feet
 Salt water..... feet..... feet

Casing and Tubing	Used in Drilling	Left in Well	Packers
Size			
16			Kind of Packer.....
13			
10	521' 11"	0	Size of.....
8 1/4	1740' 8"	0	
6 5/8	2353' 9"	0	Depth set.....
5 3/16			
3			Perf. top.....
2			Perf. bottom.....
Liners Used.....			Perf. top.....
			Perf. bottom.....

CASING CEMENTED..... SIZE..... No. Ft..... Date.....
 COAL WAS ENCOUNTERED AT 851 FEET 12 INCHES
1126 FEET 12 INCHES 1223 FEET 24 INCHES
 FEET..... INCHES..... FEET..... INCHES

Formation	Color	Hard or Soft	Top	Bottom	Oil, Gas or Water	Depth Found	Remarks
Clay, Slate & Rock			0	101			
Sand			101	121			
Slate, Rock, Lime			121	470			
Sand			470	480			
Rock, Slate, Lime			480	570			
Sand			570	595			
Slate, Rock, Lime, Shale			595	851			
Coal			851	852			
Lime, Slate, Rock			852	1126			
Mapletown Coal			1126	1127			
Shale, Lime, Slate			1127	1223			
Pittsburgh Coal			1223	1225			
Slate & Lime			1225	1238			
Sand			1238	1248			
Lime & Slate			1248	1315			
Sand			1315	1330			
Slate, Shale, Lime, Rock			1330	1582			
Sand			1582	1590			
Slate			1590	1600			
Little Dunkard			1600	1629			
Slate & Lime			1629	1668			
Sand			1668	1675			
Slate			1675	1712			
Big Dunkard			1712	1718			
Slate, Lime, Shale			1718	1885			
1st Salt Sand			1885	1902			
Slate			1902	1925			
2nd Salt Sand			1925	1995	Water	1972 ft	
Slate & Lime			1995	2238			
Maxon Sand			2238	2258			
Slate & Lime			2258	2290			
Blue Mundy			2290	2316			
Big Lime			2316	2365			
Big Injun Sand			2365	2625	Salt water	2370 ft.	10/13/2023
Slate & Lime			2625	2765			
Berea Sand			2765	2790			
Slate, Lime, Shells			2790	2968			
50-Foot Lime			2968	2990			
Slate, Shells, Rock			2990	3220			
Gordon Stray			3220	3225			
Slate			3225	3230	over		

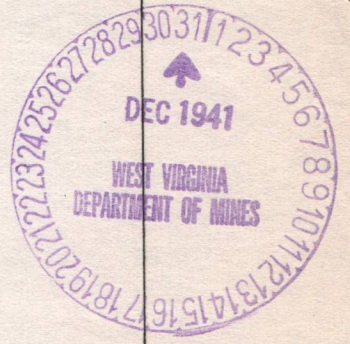

73-9

PROPOSED MANNER OF PLUGGING AND FILLING WELL
 (REQUIRED BY RULES AND REGULATIONS)
WEST VIRGINIA DEPARTMENT OF MINES
 OIL AND GAS DIVISION
WORK ORDER

Well to be plugged and filled as follows:

Total Depth	3330	
Clay	3300 - 3210	
Wood Plug	3210 - 3207	
Cement	3207 - 3197	
Clay	3197 - 2948	
Wood Plug	2948 - 2945	
Cement	2945 - 2935	
Bridge at	2745	
Wood Plug	2745 - 2741	
Cement	2741 - 2731	
Clay	2731 - 2345	
Wood Plug	2345 - 2342	
Cement	2342 - 2332	Lift 6 5/8" Casing
Clay	2332 - 2218	
Wood Plug	2218 - 2215	
Cement	2215 - 2205	
Clay	2205 - 1865	
Wood Plug	1865 - 1862	
Cement	1862 - 1852	
Bridge at	1600	Lift 8 1/4" Casing
Wood Plug	1600 - 1597	
Clay	1597 - 1315	
Wood Plug	1315 - 1313	
Bridge at	1255	
Cement	1255 - 1203	Sealing Pittsburgh Coal 30' below to 20' above
Clay	1203 - 1157	
Cement	1157 - 1106	
Clay	1106 - 882	
Cement	882 - 831	Sealing Coal Seam 30' below to 20' above
Clay	831 - 521	
Wood Plug	521 - 518	
Clay	518 to Surface	

Erect Monument as per Rule #18.

To the Department of Mines
Coal Owner or Operator,
Lease or Property Owner.

Gentlemen:

This "work order" is submitted for your approval and concurrence and unless notified of your disapproval or non-concurrence, the undersigned will proceed with the plugging and filling of said well in the above described manner on the date stated in the notice of intention to plug and abandon the said well on opposite side of this sheet.

Very truly yours,

THE AMUFACTURERS LIGHT & HEAT COMPANY

Well Operator.

No objections have been filed by the coal owner or coal operator, or any available adjacent lease or property owners or interposed by the Department of Mines to the manner herein described for the plugging and filling of the well above mentioned. Therefore, the same is hereby approved this 22^d day

of NOVEMBER 41, 19

DEPARTMENT OF MINES
Oil and Gas Division

10/13/2023

By:

NOTE: This "work order" shall be filed in triplicate, one copy for the files of the Department of Mines; one to be approved or corrected and returned to the well operator as his authority for plugging said well; and one for the well inspector.

B-8

FORM OG-9

STATE OF WEST VIRGINIA
DEPARTMENT OF MINES
OIL AND GAS DIVISION

NOTICE OF INTENTION TO PLUG AND ABANDON WELL

(REQUIRED BY SECTION 9, ARTICLE 4, CHAPTER 22 OF THE CODE)

To THE DEPARTMENT OF MINES,
Charleston, W. Va.

COAL OPERATOR OR COAL OWNER

ADDRESS

COAL OPERATOR OR COAL OWNER

ADDRESS

LEASE OR PROPERTY OWNER

ADDRESS

THE MANUFACTURERS LIGHT & HEAT COMPANY

NAME OF WELL OPERATOR

800 UNION TRUST BUILDING

PITTSBURGH, PENNA.

COMPLETE ADDRESS

NOVEMBER 20, 1941 19

WELL TO BE ABANDONED

PROCTOR District

WETZEL County

Well No. ~~311~~ 3617

WILLIAM ESTEP Farm

NOTE: IF PLUGGING CANNOT BEGIN ON DATE SPECIFIED BELOW, PLEASE
NOTIFY DEPARTMENT OF MINES, OIL AND GAS DIVISION.

Gentlemen:—

The undersigned well operator is about to abandon the above described well and will commence the work of plugging and abandoning said well on the 25 day of November, 1941, (which date shall not be less than five days after the day on which this notice so mailed is received, or in due course should be received by the Department of Mines.)

This notice is given you in order that your respective representatives may be present at the plugging and filling of said well. You are further notified that whether you are represented or not represented the undersigned will proceed on that date, or shortly thereafter, to plug and fill said well in the manner required by Section 10, Article 4, Chapter 22 of the Code and given in detail on the reverse side of this notice, in "Work Order."

This notice is being mailed by registered mail to each of you at the above addresses on the above date.

Very truly yours,

THE MANUFACTURERS LIGHT & HEAT COMPANY
Well Operator.

NOTE: Upon the abandonment of all wells drilled prior to June 1, 1929, a plat prepared by a competent engineer, showing the district and county in which the tract of land is located, the name and acreage of same, the names of the owners and adjacent tracts, and the location of the about to be abandoned well, determined by survey, and the courses and distances of such well from two permanent points or landmarks shall be submitted with this notice.

(Over)

WET-266-F PERMIT NUMBER

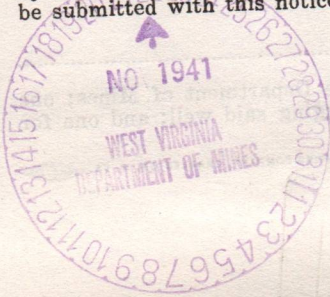

WET-266-8

10/13/2023

B-10
FORM OG-8

STATE OF WEST VIRGINIA
DEPARTMENT OF MINES
OIL AND GAS DIVISION

AFFIDAVIT OF PLUGGING AND FILLING WELL

AFFIDAVIT SHOULD BE MADE IN TRIPLICATE, ONE COPY MAILED TO THE DEPARTMENT, ONE COPY TO BE RETAINED BY THE WELL OPERATOR AND THE THIRD COPY (AND EXTRA COPIES IF REQUIRED) SHOULD BE MAILED TO EACH COAL OPERATOR AT THEIR RESPECTIVE ADDRESSES.

Roosevelt Coal & Coke Co.,
COAL OPERATOR OR OWNER
902 Diamond Bank Bldg.
Pittsburgh Pa.
ADDRESS

The Manufacturers Light & Heat Company
NAME OF WELL OPERATOR
800 Union Trust Building,
Pittsburgh Pa.
COMPLETE ADDRESS

COAL OPERATOR OR OWNER
ADDRESS

December 18th, 1941
WELL AND LOCATION

LEASE OR PROPERTY OWNER
ADDRESS

Proctor District
Wetzel County

Well No. 3617
William Estep Farm

STATE INSPECTOR SUPERVISING PLUGGING.....

AFFIDAVIT

STATE OF WEST VIRGINIA,
County of Wetzel } SS:

J. C. Rawe and Elmer Rawe

being first duly sworn according to law depose and say that they are experienced in the work of plugging and filling oil and gas wells and were employed by The Manufacturers Light & Heat Co., well operator, and participated in the work of plugging and filling the above well, that said work was commenced on the 27th day of November, 1941, and that the well was plugged and filled in the following manner:

SAND OR ZONE RECORD	FILLING MATERIAL			PLUGS USED	CASING		
	FORMATION	CONTENT	FROM TO		SIZE & KIND	CSG PULLED	CSG LEFT IN
		Clay	3330	3210			
		Wood plug	3210	3207	6 5/8" Wood	2353'-9"	of 6 5/8"
		Cement	3207	3197		1740'-8"	of 8 1/4"
		Clay	3197	2948			
		Wood plug	2948	2945	6 5/8" Wood	521'-11"	of 10"
		Cement	2945	2935			
		Bridged	2745	2741			
		Wood plug	2741	2731	6 5/8" Wood		
		Cement	2731	2715			
		Clay	2715	2415			
		Wood plug	2415	2412	6 5/8" Wood		
		Cement	2412	2332			
		Clay	2332	2218			
		Wood plug	2218	2215	6 5/8" Wood		
		Cement	2215	2205			
		Clay	2205	1862			
		Wood plug	1862	1852	6 5/8" Wood		
		Cement	1852	1600			
		Bridged	1600	1597			
		Wood plug	1597	1315	8 1/4" Wood		
		Clay	1315	1313			
		Wood plug	1313	1255	8 1/4" Wood		
		Bridged	1255	1203			
		Cement	1203	1157			
		Clay	1157	1106			
		Cement	1106	882	8 1/4" Wood		
		Clay	882	831			
		Cement	831	521			
		Clay	521	518			
		Wood plug	518	to surface			
		Clay	1255	1203			
		Cement	1157	1106			
		Cement	882	831			
		Cement	521	518			
(NAME)		Wood plug	521	518	Monument erected as per rule # 18		
(NAME)	Pitts.coal	Cement	1255	1203			
(NAME)	Mapletown Coal	Cement	1157	1106			
(NAME)	Coal	Cement	882	831			

OK
DRC
4/11/42

and that the work of plugging and filling said well was completed on the 3rd day of December, 1941.

And further deponents saith not.

J. C. Rawe
Elmer Rawe

10/13/2023

Sworn to and subscribed before me this 20 day of Dec, 1941.

[Signature]
Notary Public.

My commission expires:
Feb 4th 1946

Permit No. Wet-2665

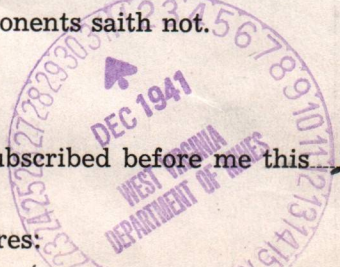
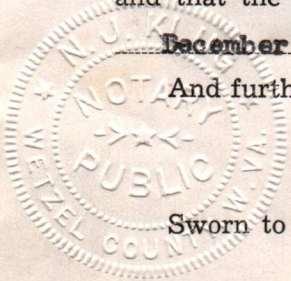

11/25/41

STATE OF WEST VIRGINIA
DEPARTMENT OF MINES
OIL AND GAS DIVISION

AFFIDAVIT OF PLUGGING AND FILLING WELL

AFFIDAVIT SHOULD BE MADE IN TRIPPLICATE, ONE COPY TO BE RETAINED BY THE WELL OPERATOR AND THE OTHER TWO COPIES TO BE DELIVERED TO THE COUNTY CLERK AT THEIR RESPECTIVE RESIDENCES.

The manufacturer Light & Heat Co.,
 300 Third Street Building,
 Pittsburgh Pa.
 Well No. 3017
 William Estep
 District
 County

Rosevelt Oil & Coke Co.,
 902 Diamond Bank Bldg.,
 Pittsburgh Pa.
 LEASE OR PROPERTY OWNER
 ADDRESS
 WELL OPERATOR OR OWNER

AFFIDAVIT

STATE OF WEST VIRGINIA
County of Mingo

and
 being first duly sworn according to law depose and say that they are experienced in the work of
 plugging and filling oil and gas wells and were employed by The manufacturer Light & Heat Co.,
 well operator and participated in the work of plugging and filling the above well, that said work
 was commenced on the 27th day of November, 1941, and that the well was plugged
 and filled in the following manner:

CASING		PLUG USED		FILLING MATERIAL		BAND OR ZONE RECORDED
DEPTH FEET	DATE LAPPED	SIZE & KIND	NO.	FROM	CONTENT	FORMATION
2558'-2"	of 6 7/8"	6 7/8" wood	3210	3210	Clay	
1710'-0"	of 6"	6 5/8" wood	3209	3210	Wood plug	
521'-11"	of 10"	6 7/8" wood	3208	3209	Cement	
		6 7/8" wood	3207	3208	Clay	
		6 7/8" wood	3206	3207	Wood plug	
		6 7/8" wood	3205	3206	Cement	
		6 7/8" wood	3204	3205	Clay	
		6 7/8" wood	3203	3204	Wood plug	
		6 7/8" wood	3202	3203	Cement	
		6 7/8" wood	3201	3202	Clay	
		6 7/8" wood	3200	3201	Wood plug	
		6 7/8" wood	3199	3200	Cement	
		6 7/8" wood	3198	3199	Clay	
		6 7/8" wood	3197	3198	Wood plug	
		6 7/8" wood	3196	3197	Cement	
		6 7/8" wood	3195	3196	Clay	
		6 7/8" wood	3194	3195	Wood plug	
		6 7/8" wood	3193	3194	Cement	
		6 7/8" wood	3192	3193	Clay	
		6 7/8" wood	3191	3192	Wood plug	
		6 7/8" wood	3190	3191	Cement	
		6 7/8" wood	3189	3190	Clay	
		6 7/8" wood	3188	3189	Wood plug	
		6 7/8" wood	3187	3188	Cement	
		6 7/8" wood	3186	3187	Clay	
		6 7/8" wood	3185	3186	Wood plug	
		6 7/8" wood	3184	3185	Cement	
		6 7/8" wood	3183	3184	Clay	
		6 7/8" wood	3182	3183	Wood plug	
		6 7/8" wood	3181	3182	Cement	
		6 7/8" wood	3180	3181	Clay	
		6 7/8" wood	3179	3180	Wood plug	
		6 7/8" wood	3178	3179	Cement	
		6 7/8" wood	3177	3178	Clay	
		6 7/8" wood	3176	3177	Wood plug	
		6 7/8" wood	3175	3176	Cement	
		6 7/8" wood	3174	3175	Clay	
		6 7/8" wood	3173	3174	Wood plug	
		6 7/8" wood	3172	3173	Cement	
		6 7/8" wood	3171	3172	Clay	
		6 7/8" wood	3170	3171	Wood plug	
		6 7/8" wood	3169	3170	Cement	
		6 7/8" wood	3168	3169	Clay	
		6 7/8" wood	3167	3168	Wood plug	
		6 7/8" wood	3166	3167	Cement	
		6 7/8" wood	3165	3166	Clay	
		6 7/8" wood	3164	3165	Wood plug	
		6 7/8" wood	3163	3164	Cement	
		6 7/8" wood	3162	3163	Clay	
		6 7/8" wood	3161	3162	Wood plug	
		6 7/8" wood	3160	3161	Cement	
		6 7/8" wood	3159	3160	Clay	
		6 7/8" wood	3158	3159	Wood plug	
		6 7/8" wood	3157	3158	Cement	
		6 7/8" wood	3156	3157	Clay	
		6 7/8" wood	3155	3156	Wood plug	
		6 7/8" wood	3154	3155	Cement	
		6 7/8" wood	3153	3154	Clay	
		6 7/8" wood	3152	3153	Wood plug	
		6 7/8" wood	3151	3152	Cement	
		6 7/8" wood	3150	3151	Clay	

day of _____ 1941
 My commission expires _____
 Notary Public



C-6



STATE OF WEST VIRGINIA
DEPARTMENT OF MINES
OIL AND GAS DIVISION

Quadrangle Littleton

WELL RECORD

Permit No. Wet-266 Redrill

Oil or Gas Well _____
(KIND)

Company The Manufacturers Light & Heat Co.
Address Pittsburgh, Penna.
Farm Frank Estep Acres 65
Location (waters) Lynn Camp
Well No. 3617 Elev. 1410'
District Proctor County Wetzel
The surface of tract is owned in fee by _____
Address _____
Mineral rights are owned by _____
Address _____

Drilling commenced Feb. 17, 1954
Drilling completed Mar. 26, 1954
Date Shot _____ From _____ To _____
With Well was not shot.
Open Flow _____ /10ths Water in None Inch
_____ /10ths Merc. in None Inch
Volume None Cu. Ft.
Rock Pressure None lbs. _____ hrs.
Oil _____ bbls., 1st 24 hrs.
Fresh water _____ feet _____ feet
Salt water _____ feet _____ feet

Casing and Tubing	Used in Drilling	Left in Well	Packers
Size			
16			Kind of Packer _____
13			
10	<u>514' - 6"</u>	<u>514' - 6"</u>	Size of _____
8 1/4	<u>1733' - 8"</u>	<u>1733' - 8"</u>	
6 5/8	<u>2262' - 8"</u>	<u>2262' - 8"</u>	Depth set _____
5 3/16			
3			Perf. top _____
2			Perf. bottom _____
Liners Used			Perf. top _____
			Perf. bottom _____

CASING CEMENTED	SIZE	No. Ft.	Date
<u>Mapletown coal</u>		<u>1126 - 1128</u>	
<u>COAL WAS ENCOUNTERED AT</u>		<u>1223 - 1225</u>	
<u>Pittsburgh coal</u>			
FEET	INCHES	FEET	INCHES
FEET	INCHES	FEET	INCHES

Formation	Color	Hard or Soft	Top	Bottom	Oil, Gas or Water	Depth Found	Remarks
Removed clay - cement and wood plugs, from top to a total depth of 2350'							
Filled back with stone and clay from 2350' to 2341							
Set lead plug, 2341' to 2339'							
Filled back with stone and cement from 2339' to 2256 Bottom of Maxon sand.							
Top of Maxon sand 2245'							
7" Casing set 1 Ft. in the Maxon sand or a depth of 2246'							
New total depth, 2256.							
<u>514' - 6"</u>							cemented with 200 bags of cement and 2 bags of aquajel Return to surface.
<u>1733' - 8"</u>							cemented with 400 bags of cement and 2 bags of Aquajel Return to surface.
<u>2262' - 8"</u>							Cemented with 225 bags of cement and 2 bags of Aquajel Return to surface.

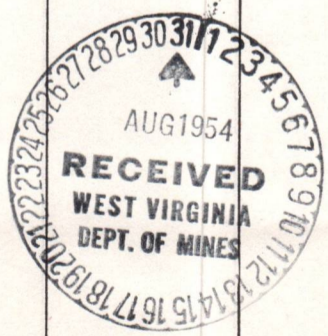

10/13/2023

(Title)

By _____

APPROVED

Owner, _____

Date

19 ____

Remarks	Depth Found	Oil, Gas or Water	Bottom	Top	Hard or Soft	Color	Formation

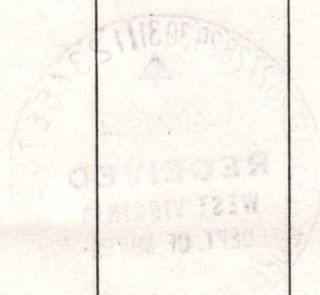

2023-10/13



STATE OF WEST VIRGINIA
DEPARTMENT OF MINES
OIL AND GAS DIVISION

WELL RECORD

Permit No. WET-266-R

Oil or Gas Well Stor.
(KIND)

Company THE MANUFACTURERS LIGHT AND HEAT CO.
Address 800 Union Trust Bldg., Pgh., Penna.

Farm Frank Estep Acres 65

Location (waters) _____

Well No. 3617 Elev. _____

District Proctor County Wetzel

The surface of tract is owned in fee by _____
Address _____

Mineral rights are owned by _____
Address _____

Drilling commenced February 22, 1954

Drilling completed March 26, 1954

Date Shot _____ From _____ To _____

With _____

Open Flow 0 /10ths Water in 3/8 Inch
_____ /10ths Merc. in _____ Inch

Volume 0000 Cu. Ft.

Rock Pressure 0 lbs. _____ hrs.

Oil _____ bbls., 1st 24 hrs.

Fresh water _____ feet _____ feet

Salt water _____ feet _____ feet

Casing and Tubing	Used in Drilling	Left in Well	Packers
Size			
16			Kind of Packer _____
18			
10		5 1/8"	Size of _____
8 1/4		1733' 11"	
6 5/8	7	2262' 11"	Depth set _____
5 3/16			
3			Perf. top _____
2			Perf. bottom _____
Liners Used			Perf. top _____
			Perf. bottom _____

CASING CEMENTED _____ SIZE _____ No. Ft. _____ Date _____

COAL WAS ENCOUNTERED AT _____ FEET _____ INCHES

_____ FEET _____ INCHES FEET _____ INCHES

_____ FEET _____ INCHES FEET _____ INCHES

Formation	Color	Hard or Soft	Top	Bottom	Oil, Gas or Water	Depth Found	Remarks
Top of Maxon Sand			2245		Schlumberger	Measurement	
Bottom of Maxon Sand				2256			
Set Lead Plug				2339	7" delivery string set at	2246'	
Cement & Rocks			2339	2260			
Cal Seal			2260	2256	10-3/4" casing cemented with 200 bags cement		no return.
Total Depth				2256	8-5/8" casing cemented with 400 bags cement		good return.
					7" casing cemented with 225 bags cement		good return

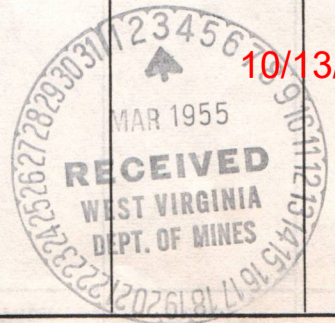

10/13/2023

STATE OF WEST VIRGINIA
DEPARTMENT OF MINES
OIL AND GAS DIVISION

INSPECTOR'S PLUGGING REPORT

Permit No. Net J 66 R Well No. _____

COMPANY _____ ADDRESS _____

FARM _____ DISTRICT _____ COUNTY _____

Filling Material Used _____

Liner	Location	Amount	Packer	Location		
PLUGS USED AND DEPTH PLACED			BRIDGES	CASING AND TUBING		
CEMENT-THICKNESS	WOOD-SIZE	LEAD	CONSTRUCTION-LOCATION	RECOVERED	SIZE	LOST

Drillers' Names _____

Remarks: _____

_____ I hereby certify I visited the above well on this date.

DATE

DISTRICT WELL INSPECTOR
10/13/2023

C-8

STATE OF WEST VIRGINIA
DEPARTMENT OF MINES
OIL AND GAS DIVISION

INSPECTOR'S WELL REPORT

Permit No. Met 266R

Oil or Gas Well _____
(KIND)

Company Magg's Light And Heat Co
 Address Pittsburgh Pa
 Farm Frank Westp
 Well No. 1-3619
 District proctor County Metz
 Drilling commenced _____
 Drilling completed 2-1-55 Total depth 2010'
 Date shot _____ Depth of shot _____
 Initial open flow _____ /10ths Water in _____ Inch
 Open flow after tubing _____ /10ths Merc. in _____ Inch
 Volume _____ Cu. Ft.
 Rock pressure _____ lbs. _____ hrs.
 Oil _____ bbls., 1st 24 hrs.
 Fresh water _____ feet _____ feet
 Salt water _____ feet _____ feet

CASING AND TUBING	USED IN DRILLING	LEFT IN WELL	PACKERS
Size			
16			Kind of Packer _____
13			
10			Size of _____
8 1/4			
6 5/8			Depth set _____
5 3/16			
3			Perf. top _____
2			Perf. bottom _____
Liners Used			Perf. top _____
			Perf. bottom _____

CASING CEMENTED _____ SIZE _____ No. FT. _____ Date _____
 COAL WAS ENCOUNTERED AT _____ FEET _____ INCHES
 _____ FEET _____ INCHES FEET _____ INCHES
 _____ FEET _____ INCHES FEET _____ INCHES

Drillers' Names Ray Louther Martin Jameson
Robert Rist Jack Bishop
 Remarks: Completed - to be used for storage

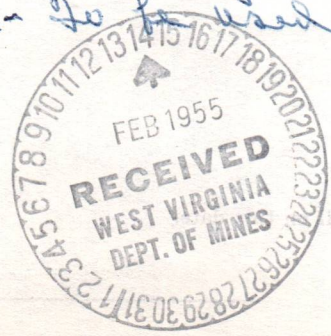

2-9-54
DATE

Bryan Shuman
DISTRICT INSPECTOR

10/13/2023

C-9

STATE OF WEST VIRGINIA
DEPARTMENT OF MINES
OIL AND GAS DIVISION

INSPECTOR'S WELL REPORT

Permit No. Wet 266R

Oil or Gas Well Gas
(KIND)

		CASING AND TUBING	USED IN DRILLING	LEFT IN WELL	PACKERS
Company	<u>Manufacturer Light & Heat Co</u>	Size			Kind of Packer
Address	<u>Pittsburgh Pa</u>	16			
Farm	<u>Frank Estep</u>	13			
Well No.	<u>1-3617</u>	10			Size of
District	<u>Proctor</u> County <u>Wet</u>	8 1/4			
Drilling commenced	<u>Feb 27-54</u>	6 5/8			Depth set
Drilling completed	<u>Total depth 1268</u>	5 3/16			
Date shot		3			Perf. top
Depth of shot		2			Perf. bottom
Initial open flow	/10ths Water in _____ Inch	Liners Used			Perf. top
Open flow after tubing	/10ths Merc. in _____ Inch				Perf. bottom
Volume	Cu. Ft.	CASING CEMENTED	SIZE	No. FT.	Date
Rock pressure	lbs. _____ hrs.				
Oil	bbls., 1st 24 hrs.	COAL WAS ENCOUNTERED AT	FEET	INCHES	
Fresh water	feet _____ feet		FEET	INCHES	FEET
Salt water	feet _____ feet		FEET	INCHES	FEET

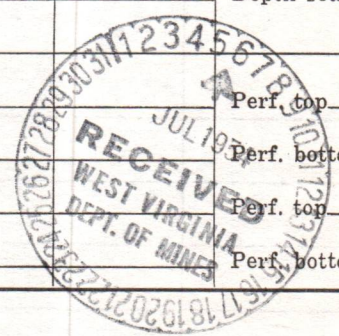

Drillers' Names Okey Lowther Martin Jamison
Bob Ritz & Jack Bishop
 Remarks: With Inspector Shuman

6-29-54
DATE

C. M. Costello
DISTRICT WELL INSPECTOR

10/13/2023

STATE OF WEST VIRGINIA
DEPARTMENT OF MINES
OIL AND GAS DIVISION
INSPECTOR'S PLUGGING REPORT

Permit No. _____ Well No. _____

COMPANY _____ ADDRESS _____

FARM _____ DISTRICT _____ COUNTY _____

Filling Material Used _____

Liner	Location	Amount	Packer	Location			
PLUGS USED AND DEPTH PLACED			BRIDGES		CASING AND TUBING		
CEMENT-THICKNESS	WOOD-SIZE	LEAD	CONSTRUCTION-LOCATION		RECOVERED	SIZE	LOST

Drillers' Names _____

Remarks: _____

DATE I hereby certify I visited the above well on this date.

DISTRICT WELL INSPECTOR
10/13/2023

C-10

STATE OF WEST VIRGINIA
DEPARTMENT OF MINES
OIL AND GAS DIVISION

INSPECTOR'S WELL REPORT

Permit No. WETS 266 R

Oil or Gas Well Gas
(KIND)

Company <u>Manufacturers Light & Heat Co</u>	CASING AND TUBING	USED IN DRILLING	LEFT IN WELL	PACKERS
Address <u>Pittsburgh Pa.</u>	Size			
Farm <u>Frank E Step</u>	16			Kind of Packer
Well No. <u>1-3617</u>	13			
District <u>Proctor</u> County <u>Wetzel</u>	10			Size of
Drilling commenced <u>July 27-54</u>	8 1/4			
Drilling completed <u>Total depth 1268</u>	6 5/8			Depth set
Date shot _____ Depth of shot _____	5 3/16			
Initial open flow _____ /10ths Water in _____ Inch	3			Perf. top
Open flow after tubing _____ /10ths Merc. in _____ Inch	2			Perf. bottom
Volume _____ Cu. Ft.	Liners Used			Perf. top
Rock pressure _____ lbs. _____ hrs.				Perf. bottom
Oil _____ bbls., 1st 24 hrs.	CASING CEMENTED _____ SIZE _____ No. FT. _____ Date _____			
Fresh water _____ feet _____ feet	COAL WAS ENCOUNTERED AT _____ FEET _____ INCHES			
Salt water _____ feet _____ feet	_____ FEET _____ INCHES _____ FEET _____ INCHES			

Drillers' Names O Key Hawthorn Martin Jameson
Bob Ritz Jack Bishop

Remarks: With Inspector Casto

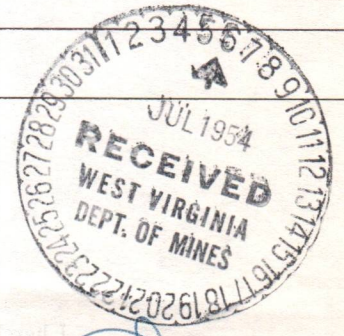

6-29-54
DATE

Bryan Summer
DISTRICT SUPERVISOR

10/13/2023

STATE OF WEST VIRGINIA
DEPARTMENT OF MINES
OIL AND GAS DIVISION
INSPECTOR'S PLUGGING REPORT

Permit No. 9 _____ Well No. _____

COMPANY _____ ADDRESS _____

FARM _____ DISTRICT _____ COUNTY _____

Filling Material Used _____

Liner		Location	Amount	Packer	Location		
PLUGS USED AND DEPTH PLACED			BRIDGES		CASING AND TUBING		
CEMENT-THICKNESS	WOOD-SIZE	LEAD	CONSTRUCTION-LOCATION		RECOVERED	SIZE	LOST

Drillers' Names _____

Remarks: _____

_____ I hereby certify I visited the above well on this date.
DATE

DISTRICT WELL INSPECTOR
10/13/2023

2-11

STATE OF WEST VIRGINIA
DEPARTMENT OF MINES
OIL AND GAS DIVISION

INSPECTOR'S WELL REPORT

Storage

Permit No. WET-266R

Oil or Gas Well Gas
(KIND)

		CASING AND TUBING	USED IN DRILLING	LEFT IN WELL	PACKERS
Company	<u>Manufacturers Light and Heat</u>	Size			
Address	<u>Pittsburgh Pa</u>	16			Kind of Packer
Farm	<u>Frank E Step</u>	13			
Well No.	<u>1-3617</u>	10			Size of
District	<u>Proctor</u> County <u>Wetzel</u>	8 1/4			
Drilling commenced	<u>Feb 54</u>	6 5/8			Depth set
Drilling completed	Total depth <u>1140</u>	5 3/16			
Date shot	Depth of shot	3			Perf. top
Initial open flow	/10ths Water in	2			Perf. bottom
Open flow after tubing	/10ths Merc. in	Liners Used			Perf. top
Volume	Cu. Ft.				Perf. bottom
Rock pressure	lbs. hrs.	CASING CEMENTED	SIZE	No. FT.	Date
Oil	bbls., 1st 24 hrs.	COAL WAS ENCOUNTERED AT			
Fresh water	feet	FEET INCHES FEET INCHES			
Salt water	feet	FEET INCHES FEET INCHES			

Drillers' Names Okey Howther Martin Jameson

Robert Rist Jack Bishop
Remarks: Drilling in cave, no gas and permit O.K.

7-6-54
DATE

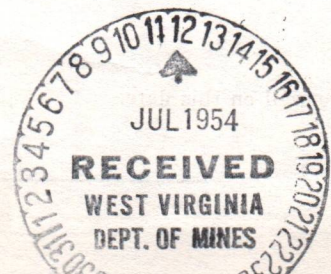

Bryan Shuman
DISTRICT INSPECTOR

10/18/2023

STATE OF WEST VIRGINIA
 DEPARTMENT OF MINES
 OIL AND GAS DIVISION
INSPECTOR'S PLUGGING REPORT

Permit No. _____ Well No. _____

COMPANY _____ ADDRESS _____

FARM _____ DISTRICT _____ COUNTY _____

Filling Material Used _____

Liner	Location	Amount	Packer	Location		
PLUGS USED AND DEPTH PLACED			BRIDGES	CASING AND TUBING		
CEMENT-THICKNESS	WOOD-SIZE	LEAD	CONSTRUCTION-LOCATION	RECOVERED	SIZE	LOST

Drillers' Names _____

Remarks: _____

_____ I hereby certify I visited the above well on this date.

DATE

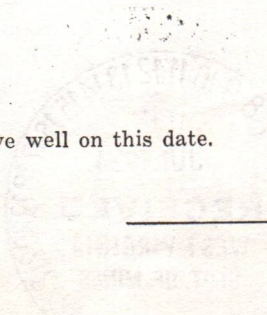

DISTRICT WELL INSPECTOR
10/13/2023

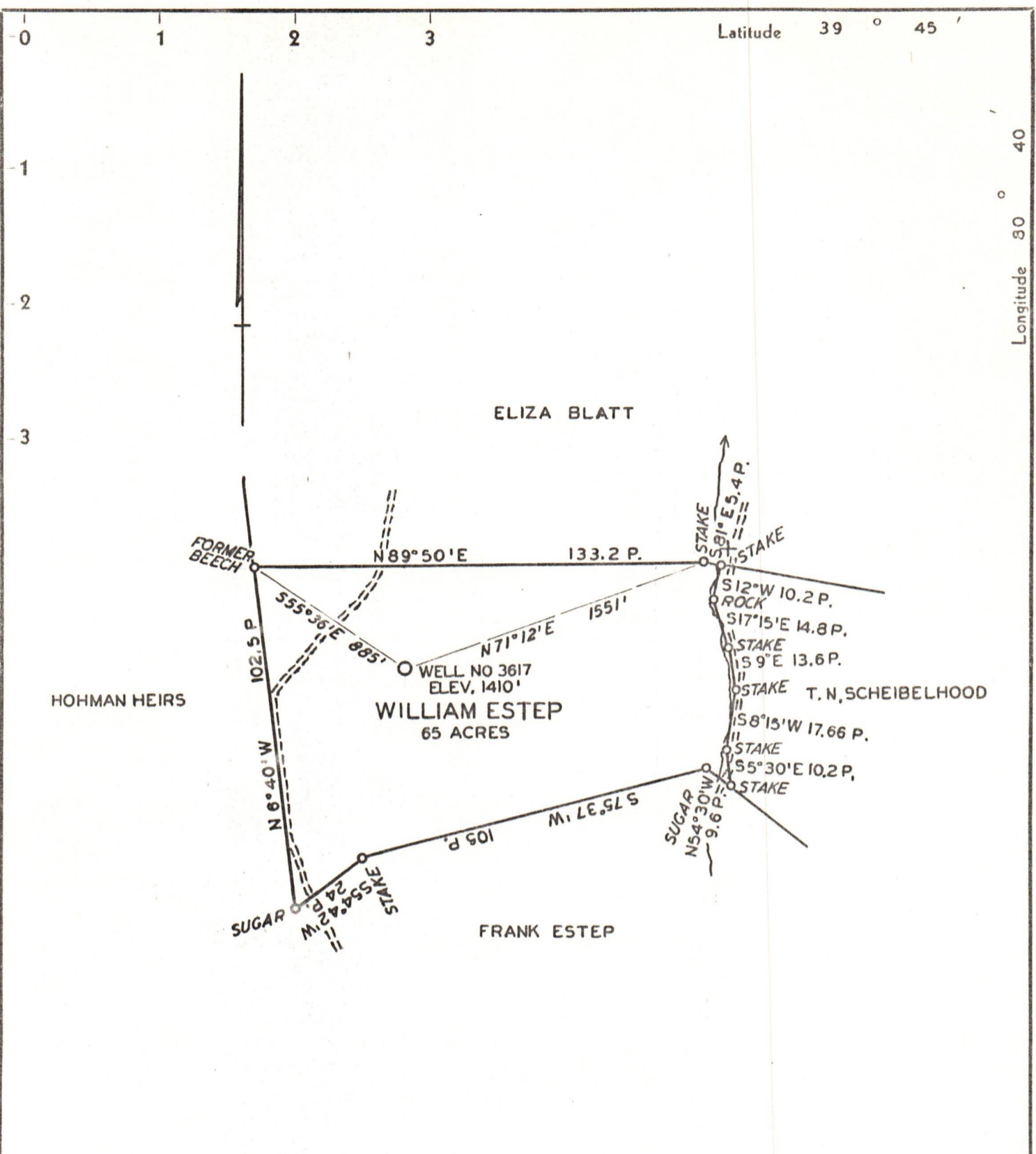

COAL OWNED BY ROOSEVELT COAL & COKE CO.
WILMERDING - PA.

New Location...
 Drill Deeper.....
 Abandonment.....

Company THE MANUFACTURERS LIGHT & HEAT CO.
 Address 800 UNION TRUST BLDG. PITTSBURGH, PA.
 Farm WILLIAM ESTEP
 Tract 1 Acres 65 Lease No. 19241
 Well (Farm) No. 1 Serial No. 3617
 Elevation (Spirit Level) 1410'
 Quadrangle LITTLETON N. W.
 County WETZEL District PROCTOR
 Engineer: A. J. Russell
 Engineer's Registration No. _____
 File No. _____ Drawing No. Y-10-288
 Date SEPT. 4, 1941 Scale 1" = 40 RDS. - 660'

STATE OF WEST VIRGINIA
 DEPARTMENT OF MINES
 OIL AND GAS DIVISION
 CHARLESTON

WELL LOCATION MAP
 File No. WET-266-REDRILL

10/13/2023

+ Denotes location of well on United States Topographic Maps, scale 1 to 62,500, latitude and longitude lines being represented by border lines as shown.

— Denotes one inch spaces on border line of original tracing.