

STATE OF WEST VIRGINIA
DEPARTMENT OF MINES
OIL AND GAS DIVISION

NOTICE OF PROPOSED LOCATION OF OIL AND GAS WELL

To THE DEPARTMENT OF MINES,
Charleston, W. Va.

Henry Hohman (1/2)

COAL OPERATOR OR COAL OWNER

R#1 - Proctor, West Va.

ADDRESS

Estella L. Newman - Samuel Furbee - Nancy Furbee
Little - Roy Huff Furbee (Heirs of Lydia Furbee)

COAL OPERATOR OR COAL OWNER

Proctor, W. Va.

ADDRESS

Same as Coal Owner

OWNER OF MINERAL RIGHTS

As above

ADDRESS

S. J. Brendel

NAME OF WELL OPERATOR

565 Union Trust Bldg
Pittsburgh, Penna.

COMPLETE ADDRESS

February 7th, 1941

PROPOSED LOCATION

Proctor District

Wetzel County

Well No. 1 ^{39' 45'} _{80' 40'}

Henry Hohman Farm

GENTLEMEN:

The undersigned well operator is entitled to drill upon the above named farm or tract of land for oil and gas, having fee title thereto, (or as the case may be) under grant or lease dated January 12, 1939, made by Henry & Mary Hohman, to M. P. Wells (Assigned to S.J. Brendel as of Jan. 21, 1941), and recorded on the _____ day of _____, in the office of the County Clerk for said County in Book _____, page _____. (Lease filed for record)

The enclosed plat was prepared by a competent engineer and shows the proposed location of a well to be drilled for oil and gas by the undersigned well operator on the farm and in the Magisterial District and County above named, determined by survey and courses and distances from two permanent points, or land marks.

The undersigned well operator is informed and believes there are no coal operators operating beds of coal beneath said farm or tract of land on which said well is located, or within 500 feet of the boundaries of the same, who have mapped their workings and filed their maps as required by law, excepting the coal operators or coal owners (if any) above named as addressees.

The above named coal operators or coal owners (if any) are notified that any objections they may desire to make to such proposed location, or which they are required to make by Section 3 of said Code, if the drilling of a well at said proposed location will cause a dangerous condition in or about their respective coal mines, must be received by, or filed with the Department of Mines within ten* days from the receipt of a copy of this notice and accompanying plat by said Department. Said coal operators are further notified that forms for use in making such objections will be furnished to them by the Department of Mines promptly on request and that all such objections must set forth as definitely as is reasonably possible the ground or grounds on which such objections are based and indicate the direction and distance the proposed location should be moved to overcome same.

(The next paragraph is to be completed only in Department's copy.)

Copies of this notice and the enclosed plat were mailed by registered mail, or delivered to the above named coal operators or coal owners at their above shown respective address _____ day _____ before, or on the same day with the mailing or delivery of this copy to the Department of Mines at Charleston, West Virginia.

Very truly yours,

S. J. Brendel
WELL OPERATOR

565 Union Trust Building

STREET

Pittsburgh, Penna.

CITY OR TOWN

STATE

10/13/2023



Address of Well Operator }

*Section 3 If no such objections be filed or be found by the department of mines, within said period of ten days from the receipt of said notice and plat by the department of mines, to said proposed location, the department shall forthwith issue to the well operator a drilling permit reciting the filing of such plat, that no objections have been made by the coal operators to the location, or found thereto by the department, and that the same is approved and the well operator authorized to proceed to drill at said location.

251

STATE OF WEST VIRGINIA
DEPARTMENT OF MINES
OIL AND GAS DIVISION

NOTICE OF PROPOSED LOCATION OF OIL AND GAS WELL

To The Department of Mines,
Charleston, W. Va.

Henry Hohman (1/2)
COAL OPERATOR OR COAL OWNER

S. J. Brendel
NAME OF WELL OPERATOR
555 Union Trust Bldg
Pittsburgh, Penna.

R#1 - Proctor, West Va.
ADDRESS

Estelle L. Newman - Samuel Furbee - Nancy Furbee
Little - Roy Huff Furbee (Heirs of Lydia Furbee)
COAL OPERATOR OR COAL OWNER

February 7th
19 41
PROPOSED LOCATION

Proctor, W. Va.
ADDRESS

Same as Coal Owner
OWNER OF MINERAL RIGHTS

As above
ADDRESS

Proctor
District

Wetzel
County

Well No. 1
39' W2.
80' N0.

Henry Hohman
Farm

AGREEMENT:

The undersigned well operator is entitled to drill upon the above named farm or tract of land for oil and gas having fee title thereto, (or as the case may be) under grant or lease dated January 12, 1933 made by Henry & Mary Hohman to M. P. Weira (Assigned to S. J. Brendel as of Jan. 21, 1941) and recorded on the _____ in the office of the County Clerk for said County in Book _____ page _____ (Lease filed for record)

The enclosed plat was prepared by a competent engineer and shows the proposed location of a well to be drilled for oil and gas by the undersigned well operator on the farm and in the Magisterial District and County above named, determined by survey and courses and distances from two permanent points, or land marks.

The undersigned well operator is informed and believes there are no coal operators operating beds of coal beneath said farm or tract of land on which said well is located, or within 500 feet of the boundary of the same, who have mapped their workings and filed their maps as required by law, excepting the coal operators or coal owners (if any) above named as addressees.

The above named coal operators or coal owners (if any) are notified that any objections they may desire to make to such proposed location, or which they are required to make by Section 8 of said Code, if the drilling of a well at said proposed location will cause a dangerous condition in or about their respective coal mines, must be received by or filed with the Department of Mines within ten days from the receipt of a copy of this notice and accompanying plat by said Department. Said coal operators are further notified that forms for use in making such objections will be furnished to them by the Department of Mines promptly on request and that all such objections must set forth as definitely as is reasonably possible the ground or grounds on which such objections are based and indicate the direction and distance the proposed location should be moved to overcome same.

(The next paragraph is to be completed only in Department's copy.)
Copies of this notice and the enclosed plat were mailed by registered mail, or delivered to the above named coal operators or coal owners at their above shown respective addresses _____ days before _____ on the same day with the mailing or delivery of this copy to the Department of Mines at Charleston, West Virginia.

Very truly yours,

WELL OPERATOR
555 Union Trust Building
Pittsburgh, Penna.
CITY OR TOWN
STATE

Address of Well Operator

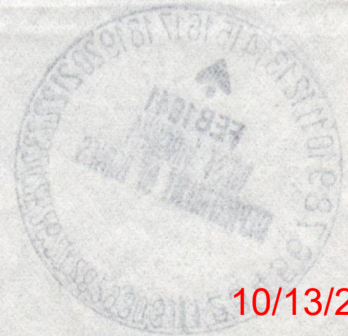

10/13/2023

*Section 8. . . . If no such objections be filed or be found by the department of mines, within said period of ten days from the receipt of such notice and plat by the department of mines, to said proposed location, the department shall forthwith issue to the well operator a drilling permit reciting the filing of such plat that no objections have been made by the coal operators to the location, or found thereto by the department, and that the same is approved and the well operator authorized to proceed to drill at said location.

PERMIT NUMBER WET-251

A-10

February 27, 1941

Mr. S. J. Brendel
566 Union Trust Building
Pittsburgh, Pennsylvania

Dear Sir:

Permit WET-251 to drill Well No. 1 on the
Henry Hohman Farm, Proctor District, Wetzel County,
is enclosed.

Duplicate permit shall be posted on the rig.

When the well is completed, please file com-
plete record on the enclosed forms OG-10.

Very truly yours,

Secretary
OIL AND GAS DIVISION

ME/am
enc-4

Lat 39d-45'
Long 80d-40'

10/13/2023

Formation	Color	Hard or Soft	Top	Bottom	Oil, Gas or Water	Depth Found	Remarks
Pink Rock			1365'	1380'			
Lime Shell			1380'	1382'			
Pink Rock			1382'	1384'			
Slate-Gray			1384'	1428'			
Slate-Black			1428'	1478'			
Gas Sand-White		Soft	1478'	1500'			
Slate	Dark	Soft	1500'	1550'			
Lime Shells			1550'	1610'			
1st Salt Sand			1610'	1672'	Water-1649'	(10' of Water sand)	
Slate			1672'	1674'			
Lime Stone Shell			1674'	1678'			
Slate			1678'	1710'			
2nd Salt Sand		Hard	1710'	1760'			
Slate		Soft	1760'	1830'			
3rd Salt Sand		Hard	1830'	1870'			
Slate		Soft	1870'	1875'			
Lime Shells		Hard	1875'	1900'			
Slate		Hard	1900'	1925'			
Sand			1925'	1930'			
Slate			1930'	1940'			
Lime			1940'	1950'			
Slate			1950'	1960'			
Pencil Cave			1960'	1969'			
Blue Monday			1969'	1995'			
Big Lime			1995'	2050'			
Injun		Hard	2050'	2253'			
Slate		Soft	2253'	2278'			
Squaw Sand	Dark	Hard	2278'	2300'			
Slate		Soft	2300'	2325'			
Lime Shells		Hard	2325'	2350'			
Slate		Soft	2350'	2390'			
Lime Shells		Hard	2390'	2400'			
Slate		Soft	2400'	2420'			
Lime Shells		Hard	2420'	2435'			
Slate		Soft	2435'	2450'			
Lime Shells		Hard	2450'	2475'			
Slate		Soft	2475'	2500'			
Lime		Hard	2500'	2535'			
Slate		Soft	2535'	2570'			
Lime Shells		Hard	2570'	2585'			
Slate		Soft	2585'	2590'			
Gritty Lime		Hard	2590'	2600'			
Slate		Soft	2600'	2625'			
Lime Shells		Hard	2625'	2675'			
Slate		Soft	2675'	2695'			
Lime Shells		Hard	2695'	2760'			
Pink Rock		Soft	2760'	2780'			
Slate		Soft	2780'	2866'			
Stray Sand		Hard	2866'	2884'			
Slate		Soft	2884'	2915'			
Lime Shell		Hard	2915'	2923'			
Gordon Sand		Hard	2923'	2928'	Gas Pay	2924' - 2926'	
Total Depth				2928'			

Well gauged 4,900,000 cu. ft. Open Flow but blew out and was tubed and shut in after blowing open for 72 hours. Well Shut in was 1,750,000 cu. ft.

10/13/2023

Date May 27th 1941.

APPROVED *J. Brundel* Owner

By (Title)

STATE OF WEST VIRGINIA
DEPARTMENT OF MINES
OIL AND GAS DIVISION

WELL RECORD

Permit No. 251

Oil or Gas Well Gas
(KIND)

Company S. J. Brendel, et al
Address 565 Union Trust Bldg - Pittsburgh, Pa.
Farm Henry Hohman Acres 42
Location (waters) _____
Well No. 1 Elev. 1140'
District Proctor County Wetzel
The surface of tract is owned in fee by Henry Hohman
Address Moundsville, W.Va.
Mineral rights are owned by Henry Hohman & Lydia Furbee Heirs
Address Moundsville
Drilling commenced Mar. 15, 1941
Drilling completed May 12, 1941
Date shot Not shot Depth of shot _____
Open Flow /10ths Water in Inch _____
/10ths Merc. in Inch _____
Volume 1,750,000 (Shut In) Cu. Ft. _____
Rock Pressure 1000 lbs. 72 hrs. _____
Oil _____ bbls., 1st 24 hrs. _____
Fresh water 1330 feet _____ feet _____
Salt water 1649 feet 1659 feet _____

Casing and Tubing	Used in Drilling	Left in Well	Packers
Size			
16.			Kind of Packer
13.			Anchor
10.		<u>211'-10"</u>	Size of <u>3x6-5/8x16</u>
8 1/4.		<u>1397'- 8"</u>	
6 5/8.		<u>1673'- 8"</u>	Depth set.
5 3/16.		<u>2872'</u>	
3.		<u>2928'</u>	Perf. top.
2.			Perf. bottom.
Liners Used			Perf. top.
			Perf. bottom.

CASING CEMENTED _____ SIZE _____ No. Ft. _____ Date _____
COAL WAS ENCOUNTERED AT 805 to 810' FEET _____ INCHES
905 to 910' FEET _____ INCHES _____ FEET _____ INCHES
_____ FEET _____ INCHES _____ FEET _____ INCHES

Formation	Color	Hard or Soft	Top	Bottom	Oil, Gas or Water	Depth Found	Remarks
Shale		Soft	-	10'			
Sand Stone		Hard	10'	25'			
Red Rock	Red	Soft	25'	45'			
Lime	White	Hard	45'	70'			
Slate-Shells	Med.		70'	200'			
Lime	Hard		200'	230'			
Red Rock		Soft	230'	265'			
Gritty Lime		Med.					
Slate-Shells			265'	400'			
Red Rock		Soft	400'	420'			
Gritty Lime		Med.	420'	460'			
Slate-Shells			460'	535'			
Coal Bloss.			535'	540'			Waynesburg Coal
Lime Stone			540'	580'			
Red Rock			580'	600'			
Lime		Hard	600'	805'			
Coal			805'	810'			Mapletown Coal
Lime		Hard	810'	880'			
Slate			880'	895'			
Lime			895'	900'			
Slate			900'	905'			
Coal			905'	910'			Pgh. Coal
Gritty Lime			910'	955'			
Slate		Soft	955'	980'			
Lime Shells			980'	995'			
Red Rock		Soft	995'	1010'			
Lime		Hard	1010'	1030'			
Red Rock		Soft	1030'	1065'			
Lime		Hard	1065'	1095'			
Slate		Soft	1095'	1110'			
Lime		Hard	1110'	1135'			
Red Rock		Soft	1135'	1145'			
Lime Shells		Hard	1145'	1155'			
Red Rock		Soft	1155'	1180'			
Slate		Soft	1180'	1195'			
Lime, Little Dunkard		Hard	1195'	1260'			
Sand		Hard	1260'	1335'			
Black Shale			1335'	1350'			
Gritty Lime			1350'	1355'			
Black Shale			1355'	1360'			
Gritty Lime			1360'	1365'			



10/13/2023

Water-1330' & Gas at 1260' (Show)

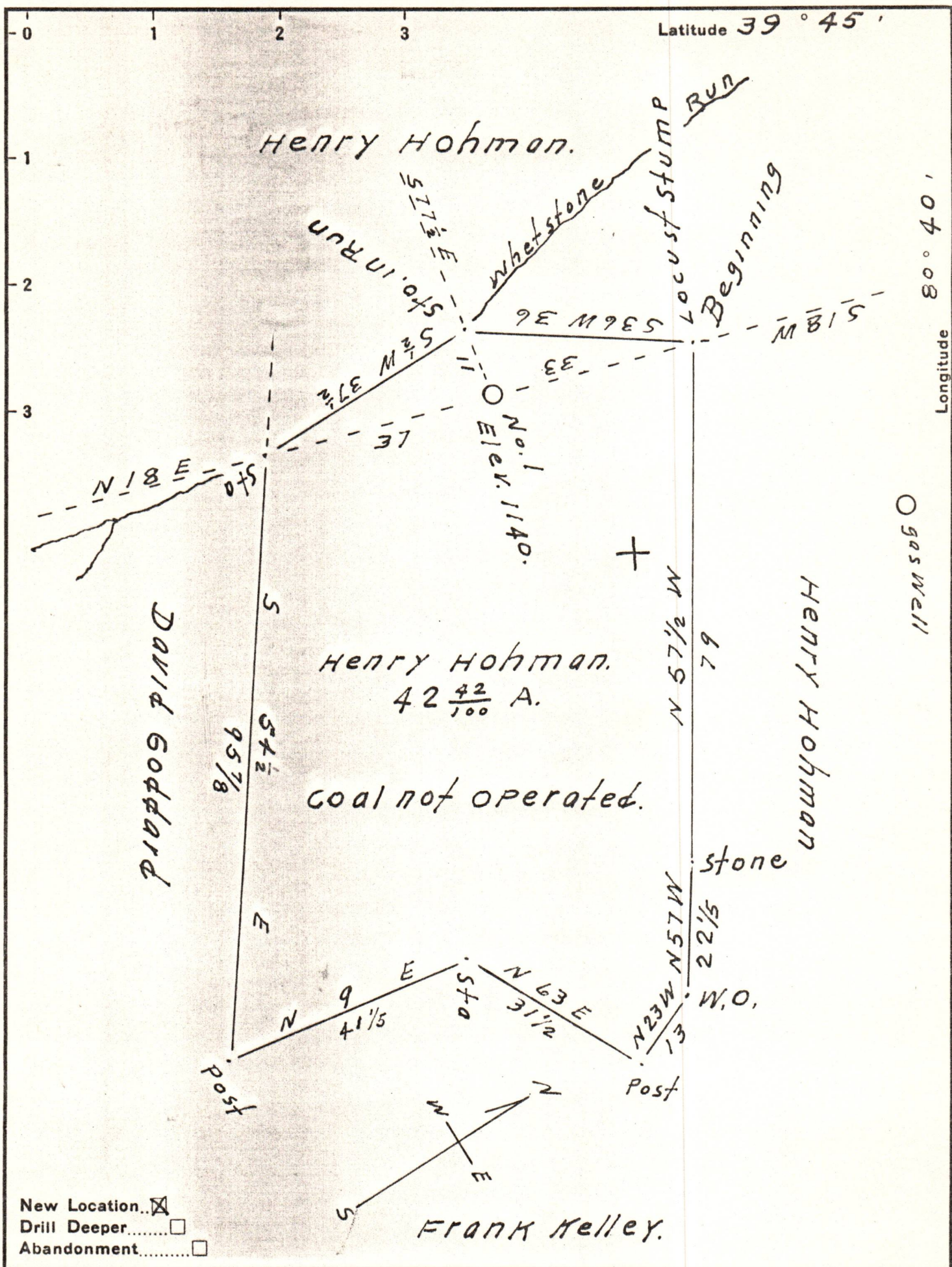

Company S. J. Brendel
 Address Pittsburgh Pa.
 Farm Henry Hohman
 Tract 1 Acres 42 $\frac{42}{100}$ Lease No. _____
 Well (Farm) No. 1 Serial No. _____
 Elevation (Spirit Level) 1140 Feet
 Quadrangle Littleton
 County Meigs District Proctor
 Engineer J. M. Cochran
 Engineer's Registration No. Co. Surveyor
 File No. _____ Drawing No. _____
 Date 2-6-1941 Scale 1-in. = 20 Rods

STATE OF WEST VIRGINIA
 DEPARTMENT OF MINES
 OIL AND GAS DIVISION
 CHARLESTON

WELL LOCATION MAP
 FILE NO. WET-251 10/13/2023

+ Denotes location of well on United States Topographic Maps, scale 1 to 62,500, latitude and longitude lines being represented by border lines as shown.
 - Denotes one inch spaces on border line of original tracing.