

STATE OF WEST VIRGINIA
DEPARTMENT OF MINES
OIL AND GAS DIVISION

NOTICE OF PROPOSED LOCATION OF OIL AND GAS WELL

To THE DEPARTMENT OF MINES,
Charleston, W. Va.

1/2 -- BENEDUM-TREES OIL COMPANY
COAL OPERATOR OR COAL OWNER
PITTSBURGH, PA.
ADDRESS *See letter attached*

CARNEGIE NATURAL GAS COMPANY
NAME OF WELL OPERATOR
1014 FRICK BUILDING
PITTSBURGH, PA.
COMPLETE ADDRESS

1/2 -- STATE of WEST VIRGINIA.
COAL OPERATOR OR COAL OWNER
ADDRESS

NOVEMBER 27, 1940., ~~1935~~
PROPOSED LOCATION

GRANT District

HOPE CONSTRUCTION & REFINING CO.,
OWNER OF MINERAL RIGHTS

WETZEL County

CLARKSBURG, W. VA.
ADDRESS

Well No. 4-1550. 39° 35'
80° 30'

MIKE BARR Farm

GENTLEMEN :

The undersigned well operator is entitled to drill upon the above named farm or tract of land for oil and gas, having fee title thereto, (or as the case may be) under grant or lease dated OCTOBER 17, 1908, made by BENEDUM-TREES OIL COMPANY and THE xto PARKER and EDWARDS OIL CO. to CARNEGIE NATURAL GAS CO, and recorded on the 8th day of AUGUST, 1912, in the office of the County Clerk for said County in Book 2-A, page 180.

The enclosed plat was prepared by a competent engineer and shows the proposed location of a well to be drilled for oil and gas by the undersigned well operator on the farm and in the Magisterial District and County above named, determined by survey and courses and distances from two permanent points, or land marks.

The undersigned well operator is informed and believes there are no coal operators operating beds of coal beneath said farm or tract of land on which said well is located, or within 500 feet of the boundaries of the same, who have mapped their workings and filed their maps as required by law, excepting the coal operators or coal owners (if any) above named as addressees.

The above named coal operators or coal owners (if any) are notified that any objections they may desire to make to such proposed location, or which they are required to make by Section 3 of said Code, if the drilling of a well at said proposed location will cause a dangerous condition in or about their respective coal mines, must be received by, or filed with the Department of Mines within ten* days from the receipt of a copy of this notice and accompanying plat by said Department. Said coal operators are further notified that forms for use in making such objections will be furnished to them by the Department of Mines promptly on request and that all such objections must set forth as definitely as is reasonably possible the ground or grounds on which such objections are based and indicate the direction and distance the proposed location should be moved to overcome same.

(The next paragraph is to be completed only in Department's copy.)

Copies of this notice and the enclosed plat were mailed by registered mail, or delivered to the above named coal operators or coal owners at their above shown respective address _____ day _____ before, or on the same day with the mailing or delivery of this copy to the Department of Mines at Charleston, West Virginia.

Very truly yours,

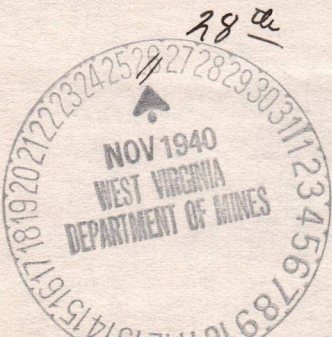

Address of Well Operator }

CARNEGIE NATURAL GAS COMPANY
WELL OPERATOR
1014 FRICK BUILDING
STREET
PITTSBURGH,
CITY OR TOWN
PENNSYLVANIA.
STATE

10/13/2023

*Section 3 . . . If no such objections be filed or be found by the department of mines, within said period of ten days from the receipt of said notice and plat by the department of mines, to said proposed location, the department shall forthwith issue to the well operator a drilling permit reciting the filing of such plat, that no objections have been made by the coal operators to the location, or found thereto by the department, and that the same is approved and the well operator authorized to proceed to drill at said location.

248

A-10

Carnegie Natural Gas Company

UNITED STATES STEEL CORPORATION SUBSIDIARY

General Offices, Frick Building

Pittsburgh, Pa.

CLARENCE SWEENEY
GENERAL SUPERINTENDENT

November 27, 1940.

West Virginia Department of Mines,
Oil and Gas Division,
Charleston, West Virginia

Dear Sirs:

We are enclosing Notice of Proposed
Location, together with tracing, for well #4-1550
on the Mike Barr farm in Grant District, Wetzel
County, West Virginia.

We request that you forward us Drilling
Permit for this well.

Yours very truly,

CARNEGIE NATURAL GAS COMPANY,

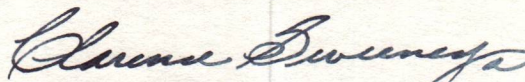

General Superintendent.

BHA :mv
cc2
enc.

A-11

November 28, 1940

Benedum-Trees Oil Company
Pittsburgh, Pennsylvania

Gentlemen:

A notice of proposed location of Well No. 4-1550 on the Mike Barr Farm, Grant District, Wetzel County, has been received from Carnegie Natural Gas Company, Pittsburgh, Pennsylvania. A copy of the notice and location plat should have been mailed you by the well operator.

If you have any objections to the proposed location, please file same not later than December 8, 1940.

Very truly yours,

Secretary
OIL AND GAS DIVISION

MG/em

10/13/2023

A-12

BENEDUM-TREES OIL COMPANY

BENEDUM-TREES BUILDING

PITTSBURGH, PENNA. November 29, 1940.

State of West Virginia,
Department of Mines,
Charleston, West Va.

Gentlemen: -

With reference to your letter of November 28th, being a notice of proposed location of Well #4 on the Mike Barr farm, Grant District, Wetzel County, West Virginia, we would advise that we turned over our interest in this tract to the Arkansas Natural Gas Company of Shreveport, Louisiana, to whom we refer you.

Very truly yours,

BENEDUM-TREES OIL COMPANY

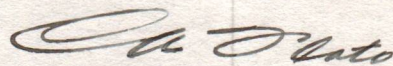

CAF:G

C.A. Floto, Treasurer



10/13/2023

B-1

WEST VIRGINIA DEPARTMENT OF MINES
OIL AND GAS DIVISION

Littleton

WELL RECORD

Permit No. WET-248.

Oil or Gas Well Gas and Oil.
(Kind)

Company Carnegie Natural Gas Company,
 Address 1014 Frick Building, Pittsburgh, Pa.
 Farm Mike Barr Acres 1004
 Location (waters) North Fork of Fishing Creek.
 Well No. 4, E-1550. Bar. Elev. 1170'
 District Grant County Wetzel
 The surface of tract is owned in fee by SEE REVERSE SIDE
 Address _____
 Mineral rights are owned by Hope Construction &
Refining Company, Address Clarksburg, W.Va.
 Drilling commenced January 8th, 1941.
 Drilling completed February 27th, 1941.
 Date shot 3-19-41 Depth of shot 1980-1990'
 Open Flow 4 to 8/10ths Water in 2" Inch
 _____/10ths Merc. in _____ Inch
 Volume 84,000 to 119,000 Cu. Ft.
 Rock Pressure 450 lbs. 48 Hrs. hrs.
 Oil Filled up 6" hole - 200' in 1 Hr. bbls., 1st 24 hrs.
425' in 8 Hrs.
 Fresh water 160 feet feet
 Salt water 1440 feet feet

Casing and Tubing	Used in Drilling	Left in Well	Packers
Size			
16.			Kind of Packer
13.	59'	59'	
10.	520'	520'	Size of
8 1/4	1112'	1112'	
6 5/8. 20#	1860'	1860'	Depth set
5 3/16			
3.			Perf. top 1964'
2.		1996'	Perf. bottom 1974'
Liners Used			Perf. top
			Perf. bottom

CASING CEMENTED _____ SIZE _____ No. FT. _____ Date _____
 COAL WAS ENCOUNTERED AT 506' FEET _____ INCHES
608' FEET _____ INCHES _____ FEET _____ INCHES
 _____ FEET _____ INCHES _____ FEET _____ INCHES

Formation	Color	Hard or Soft	Top	Bottom	Oil Gas or Water	Depth Found	Remarks
Gravel	Gray		0	16			
Slate	Light		16	30			
Red Rock	Red		30	38			
Lime	Light		38	57			
Slate	Light		57	110			
Lime	Light		110	120			
Slate	Light		120	135			
Lime	Light		135	180	Water	160	Fresh Hole Full.
Slate	Dark		180	215			
Lime	Light		215	225			
Sand	Light		225	235			
Slate	Dark		235	245			
Sand	Light		245	262			
Coal	Black		262	265			
Slate	Light		265	285			
Lime	Light		285	305			
Slate	Dark		305	312			
Red Rock	Red		312	325			
Slate	Light		325	395			
Lime	Light		395	431			
Slate	Light		431	440			
Lime	Light		440	497			
Slate	Dark		497	505			
Mapletown Coal	Black		505	506			Run Steel Line at 506'
Lime	White		506	560			
Slate	Light		560	570			
Lime	White		570	590			
Slate	Dark		590	608			
Pittsburgh Coal	Black		608	612	Gas	612	2.633 Cu Ft.
Slate	Light		612	628			Run Steel Line at 612'
Lime	Light		628	640			
Sand	Dark		640	650			
Red Rock	Red		650	658			
Lime	Dark		658	670			
Slate	Light		670	675			
Red Rock	Red		675	715			
Lime	Light		715	730			
Murphy Sand	Dark	Med.	730	762	Gas	738-747	42.160 Cu Ft.
Slate	Dark						

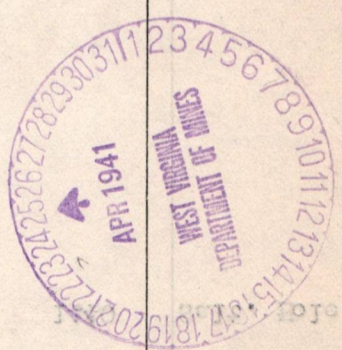

10/13/2023

E-4

December 3, 1940

Arkansas Natural Gas Company
Shreveport, Louisiana

Gentlemen:

A notice of proposed location of Well No. 4-1550 on the Mike Barr Farm, Grant District, Wetzel County, has been received from Carnegie Natural Gas Company, Pittsburgh, Pennsylvania. A copy of the notice and location plat should have been mailed you by the well operator.

Very truly yours,

Secretary
OIL AND GAS DIVISION

MG/am

10/13/2023

E-6

ARKANSAS NATURAL GAS CORPORATION

SHREVEPORT, LOUISIANA

December 6, 1940.

Wet-248
Drill

Department of Mines
Oil and Gas Division
Charleston, W. Va.

Atten: Miss Marie E. Griffith, Secretary

Gentlemen:

We are in receipt of your letter dated December 3rd, concerning filing of application by Carnegie Natural Gas Company, Pittsburgh, Pennsylvania, to drill well No. 4-1550 on the Mike Barr Farm, Grant District, Wetzel County.

During the early part of this year we sold and transferred all of our right, title and interest in the Barr Farm to the Hope Construction and Refining Company and Hope Natural Gas Company. Therefore, it was perfectly proper that no notice be given to us by the operator.

Yours very truly,

ARKANSAS NATURAL GAS CORPORATION

By:

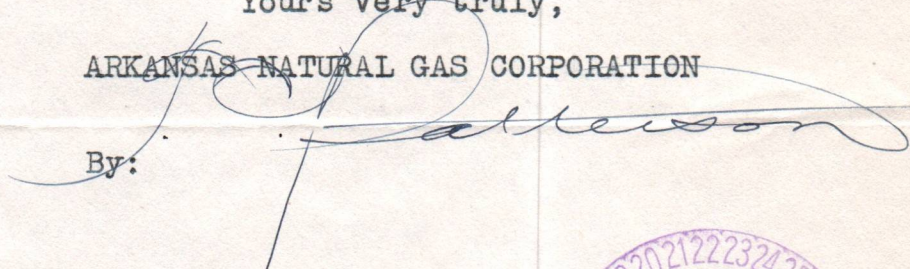

TCP:L



10/13/2023

WILLIAMS WINDMILL CO. CORPORATION

DEPARTMENT OF MINES

DEPARTMENT OF MINES

Department of Mines
Windmill Division
Charleston, W. Va.

Attention:

There are in receipt of your letter dated December 1st, concerning failure of regulation in mine No. 12, District No. 12, West Virginia. The mine is located on the West side of the mine shaft. The mine is located in the West side of the mine shaft. The mine is located in the West side of the mine shaft.

On the 12th day of December, 1920, the mine was inspected and it was found that the mine was in a satisfactory condition. The mine was inspected and it was found that the mine was in a satisfactory condition. The mine was inspected and it was found that the mine was in a satisfactory condition.

Very truly yours,

WILLIAMS WINDMILL CO. CORPORATION

E-5

December 9, 1940

Carnegie Natural Gas Company
1014 Frick Building
Pittsburgh, Pennsylvania

Gentlemen:

Permit WET-248 to drill Well No. 4-1550 on
the Mike Barr Farm, Grant District, Wetzel County,
is enclosed.

Very truly yours,

Secretary
OIL AND GAS DIVISION

MG/am
enc-2

Lat 39°-35'
Long 80°-30'

10/13/2023

E-1

Carnegie Natural Gas Company

UNITED STATES STEEL CORPORATION SUBSIDIARY

General Offices, Frick Building

Pittsburgh, Pa.

April 23, 1941.

CLARENCE SWEENEY
~~H. J. HESS~~
GENERAL SUPERINTENDENT.

*File wet - 248
DU*

West Virginia Department of Mines,
Oil and Gas Division,
Charleston, W. Va.

Dear Sirs:

In compliance with rules and regulations,
we have enclosed, in duplicate, Well Record for
well #4-1550 on the Mike Barr farm in Grant Dis-
trict, Wetzel County, West Virginia.

This well was drilled under Permit No.
WET-248 issued December 9, 1940.

Yours very truly,

CARNEGIE NATURAL GAS COMPANY,

Clarence Sweeney
General Superintendent.

CS:mv
cc2
enc.



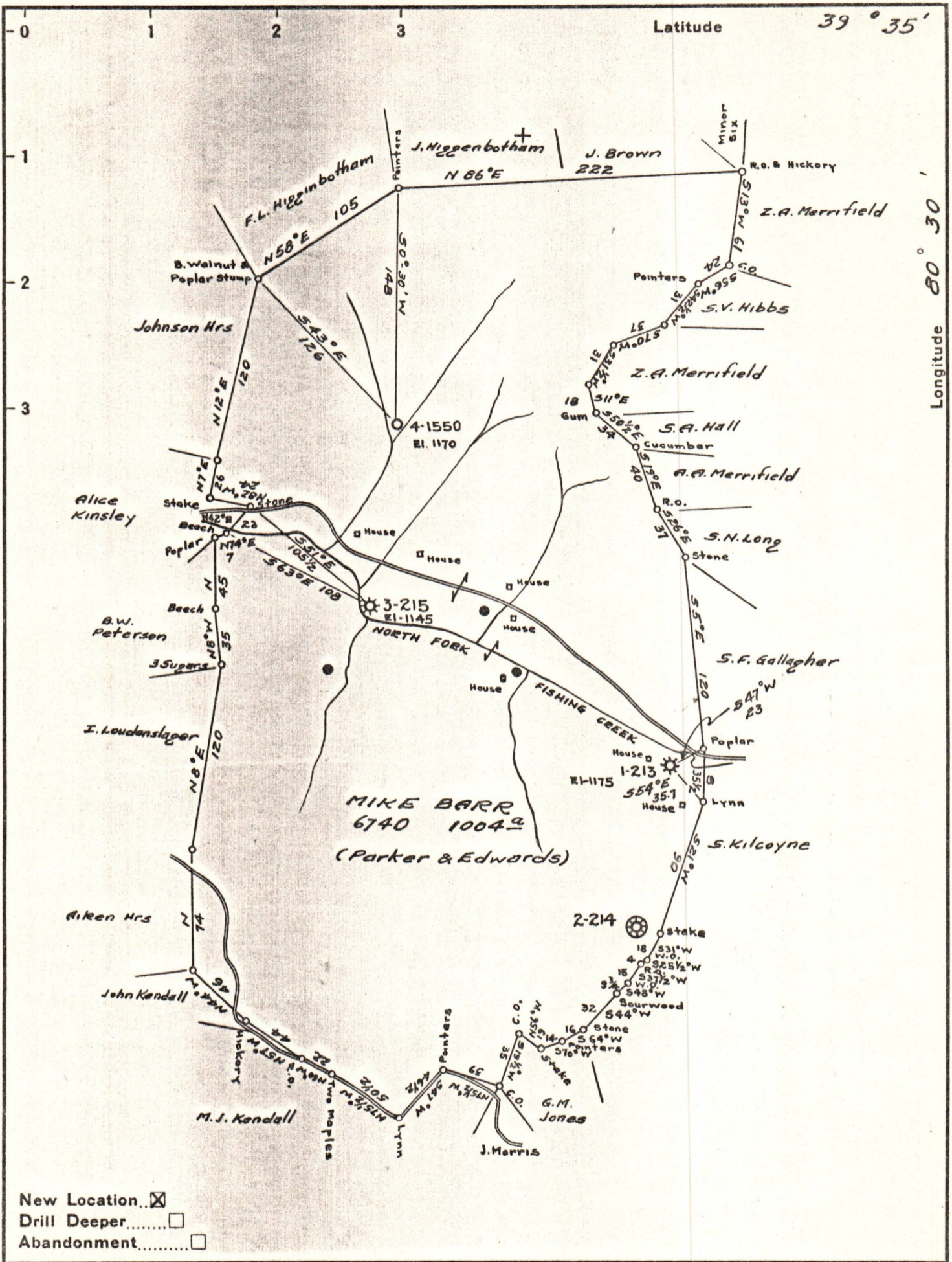

Company CARNEGIE NATURAL GAS
 Address PITTSBURGH, PA.
 Farm MIKE BARR
 Tract _____ Acres 1004 Lease No. 6740-74
 Well (Farm) No. 4 Serial No. 1550
 Elevation (Spirit Level) 1170
 Quadrangle LITTLETON SE
 County WETZEL District GRANT
 Engineer R.L. SWEENEY
 Engineer's Registration No. _____
 File No. _____ Drawing No. _____
 Date 11-25-40 Scale 1" = 80 rods

STATE OF WEST VIRGINIA
 DEPARTMENT OF MINES
 OIL AND GAS DIVISION
 CHARLESTON

WELL LOCATION MAP
 FILE NO. WET-248

10/13/2023

+ Denotes location of well on United States Topographic Maps, scale 1 to 62,500, latitude and longitude lines being represented by border lines as shown.

- Denotes one inch spaces on border line of original tracing.