

0 1 2 3 LATITUDE 39° 40'

LONGITUDE 80° 45'

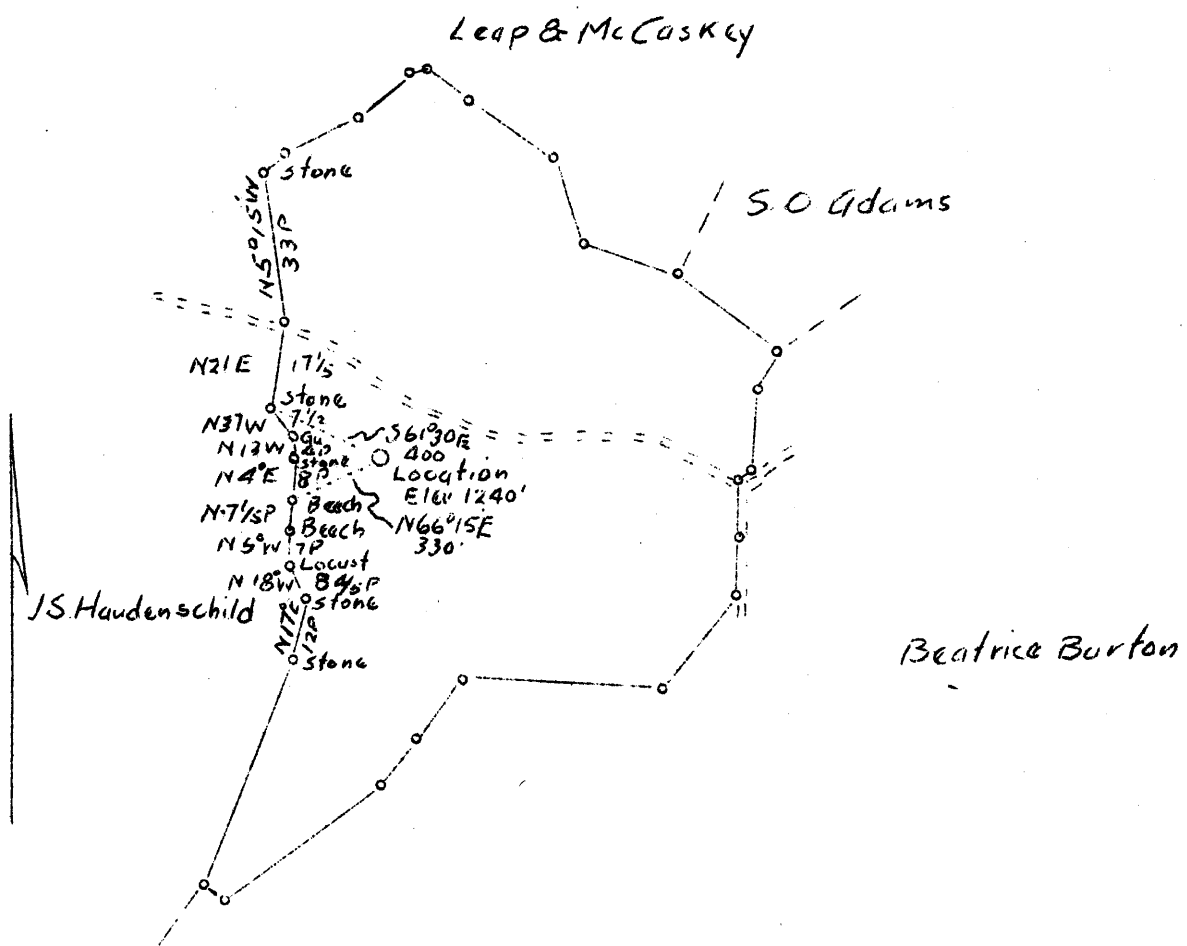

ABD
3/37
0.1 W
1.3 9

Company Columbian Carbon Co.
 Address Box 1240, Charleston, W. Va.
 Farm Franklin Fitzsimmons
 Tract Acres 64.58 Lease No. C-452
 Well (Farm) No. 1 Serial No. _____
 Elevation (Spirit Level) 1240'
 Quadrangle New Martinsville
 County Wetzel District Proctor
 Engineer C. A. Branham
 Engineer's Registration No. 683
 File No. _____ Drawing No. _____
 Date 1/16/37 Scale 1" = 660'

STATE OF WEST VIRGINIA
 Department of Mines
 OIL AND GAS DIVISION
 Charleston

WELL LOCATION MAP
 File No. WET-151

+ Denotes location of well on U. S. Topographic Maps, scale 1 to 62,500 latitude and longitude lines being represented by border lines as shown

- Denotes one inch spaces on border line of original tracing.

6-0 39 (000)

WEST VIRGINIA DEPARTMENT OF MINES
OIL AND GAS DIVISION

510

WELL RECORD

Ames 507

Permit No. Wet-151

Oil or Gas Well Dry hole
(Kind)

Company COLIMBIAN CARBON COMPANY
 Address Box 1240 - Charleston, W. Va.
 Farm Frank. Fitzsimons Acres 64.58
 Location (waters) Long Run
 Well No. 1 (GW-576) Elev. 1240
 District Proctor County Netzel
 The surface of tract is owned in fee by Frank. Fitzsimons
Hrs. Address See below
 Mineral rights are owned by (oil & gas only) SAME
 Address _____
 Drilling commenced February 13, 1937
 Drilling completed March 19, 1937
 Date shot _____ Depth of shot _____
 Open Flow /10ths Water in _____ Inch
 /10ths Merc. in _____ Inch
 Volume Dry hole. Cu. Ft. _____
 Rock Pressure _____ lbs. _____ hrs.
 Oil _____ bbls., 1st 24 hrs.
 Fresh water _____ feet _____ feet
 Salt water 2024 feet _____ feet

Casing and Tubing	Used in Drilling	Left in Well	Packers
Size			
16 <u>Cond.</u>	<u>13'</u>		Kind of Packer
13			
10	<u>410' 3"</u>		Size of
8 1/4	<u>1570'</u>		
6 5/8	<u>2065'</u>		Depth set
5 3/16			
3			Perf. top
2			Perf. bottom
Liners Used			Perf. top
			Perf. bottom

CASING CEMENTED _____ SIZE _____ No. FT. _____ Date _____
 COAL WAS ENCOUNTERED AT 949 FEET 48 INCHES
 _____ FEET _____ INCHES _____ FEET _____ INCHES
 _____ FEET _____ INCHES _____ FEET _____ INCHES

vs/o Gladie Howell, Agent & Atty-in-fact for Fitzsimons Hrs., of Doolin Rt., New Martinsville, W. Va.

D.E. Mason, New Martinsville, W. Va.		Soft	Top	Bottom	Oil Gas or Water	Depth Found	Remarks
Clay	red		0	16			
Red Rock			16	55			
Lime		broken	55	115			
Red Rock			115	150			
Lime		broken	150	180			
Red Rock			180	180			
Slate	white		180	200			
Red Rock			200	230			
Lime	white		230	245			
Red Rock			245	275			
Slate	white		275	305			
Lime	white		305	318			
Slate & Shells	"		318	372			
Red Rock			372	397			
Slate	white		397	421			
Lime	white		421	436			
Slate	white		436	518			
Lime	grey	hard	518	528			
Slate	white		528	559			
Lime	dark		559	594			
Red Rock			594	600			
Slate & Shells	white		600	640			
Red Rock			640	648			
Slate & Shells			648	745			
Lime	grey	hard	745	758			
Red Rock			758	764			
Lime	grey	hard	764	846			
Slate	white		846	850			
Slate & Shells			850	918			
Lime	white	hard	918	930			
Slate & Shells			930	949			
Coal		<u>Pitts.</u>	949	955	Gas	952'	Show SLM 954'
Slate & Shells			955	1002			
Red Rock			1002	1014			
Slate & Shells	white		1014	1082			
Red Rock			1082	1115			
Lime		broken	1115	1135			
Slate & Shells	white		1135	1240			
Red Rock			1240	1285			
Slate	white		1285	1302			
Sand	white		1302	1304	Oil Gas	Spring 1949	Boysie
Slate	white		1304	1314			



Formation	Color	Hard or Soft	Top	Bottom	Oil, Gas or Water	Depth Found	Remarks
Red Rock			1314	1346			
Lime		gritty	1346	1383			SLM 1371'
Slate & Shells			1383	1440			
Lime		broken	1440	1475			
Slate	white		1475	1480			
Lime <i>Gas Sand</i>		gritty	1480	1520			
1st Salt Sand	white	hard	1520	1571			
Slate <i>ST</i>	black		1571	1608			
2nd Salt Sand	white		1608	1646			
Slate & Shells	black		1646	1760			
3rd Salt Sand	white		1760	1810			
Slate & Shells	black		1810	1860			
Lime	black	hard	1860	1889			
Slate	black	soft	1889	1932			
4th Salt Sand	white	hard	1932	1964			
Slate & Shells	black		1964	2005	Salt Water	2024'	1/4 blr. per hr.
Maxon	white	soft	2005	2026			
Lime	black	hard	2026	2036			
Slate			2036	2047			
Little Lime		hard	2047	2057			
Pencil Cave			2057	2060			
Big Lime			2060	2103			SLM 2065
Big Injun			2103	2147			
Slate Break			2147	2221			
Sand			2221	2351			
TOTAL DEPTH				<u>2351'</u>	2060 1240 820		

Date March 23, 19 37

APPROVED..... COLUMBIAN CARBON COMPANY..... Owner

By..... [Signature].....
(Title) Supt.