

Jan 5/20/88

4 1/2 4/6 24.75

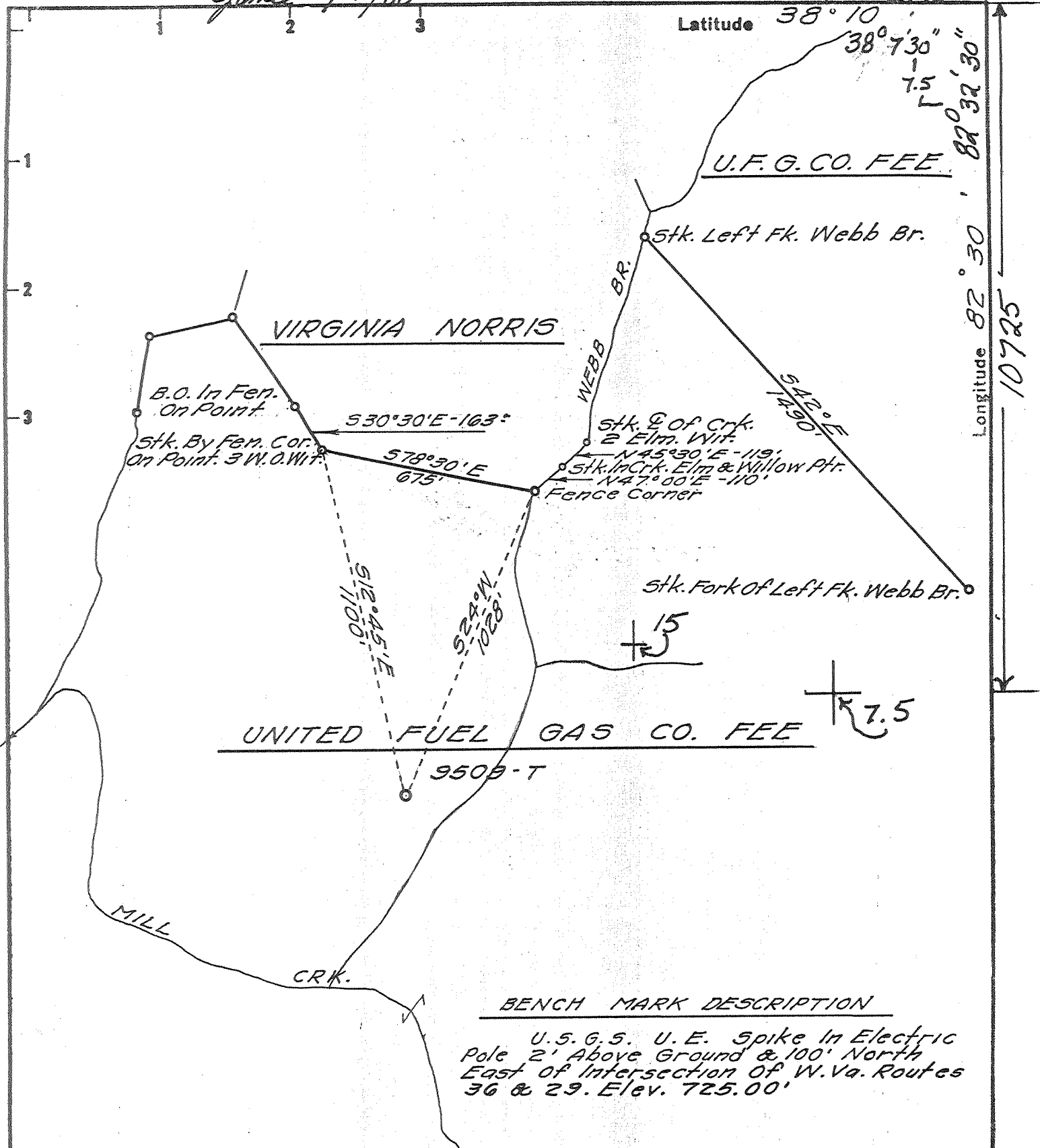

- Fracture Before 6/5/29
- New Location
- Drill Deeper
- Redrill
- Abandonment

I, the undersigned, hereby certify that this map is correct to the best of my knowledge and belief and shows all the information required by Paragraph 5 of the Rules and Regulations of the Oil and Gas Section of the Mining Laws of West Virginia.

The accuracy of this survey is within the limits and as prescribed in paragraph 5 by the Oil and Gas Division of the Department of Mines Regulations.

Company Columbia Gas Transmission Corp.
 Address P.O. Box 1273-Charleston, W.V. 25325
 Surface: Tommie Hatfield

Farm UNITED FUEL GAS CO. FEE
T. L. Black DEED 9342-
 Tract 08 Acres 10,500 Lease No. _____

Well (Farm) No. _____ Serial No. 9509-T
 Elevation (Spirit Level) 597.96'
 Quadrangle LOUISA 15 & 7.5
 County WAYNE District BUTLER
 Engineer Adrian Edelman
 Engineer's Registration No. 2330
 File No. 12-41 Drawing No. _____
 Date APR. 15, '69 Scale 1" = 400'

STATE OF WEST VIRGINIA
 DEPARTMENT OF MINES
 OIL AND GAS DIVISION
 CHARLESTON

WELL LOCATION MAP
 FILE NO. Way-1549-P

+ Denotes location of well on United States Topographic Maps, scale 1" to 62,500 latitude and longitude lines being represented by border lines as shown.

MAY 20 1988

- Denotes one inch spaces on border line of original tracing.

47-099

4/24/69 CER
38° 07' 30"

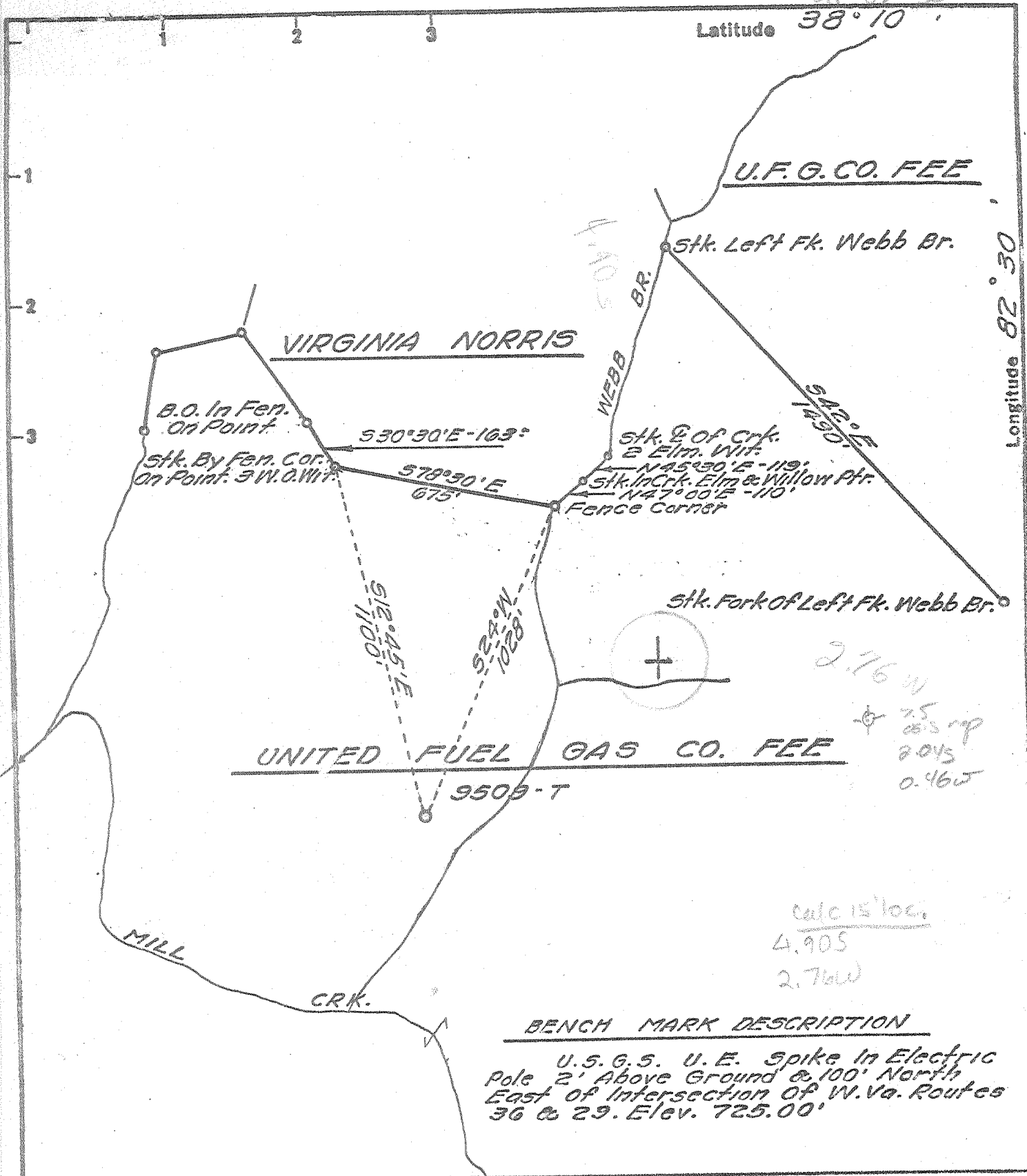

Longitude 82° 30' 30"

2.76 W
2.75
2.05
0.46 W

Calc 15' loc.
4.905
2.76 W

BENCH MARK DESCRIPTION

U.S.G.S. U.E. Spike in Electric Pole 2' Above Ground & 100' North East of Intersection of W.Va. Routes 36 & 29. Elev. 725.00'

Fracture Before 6/5/29
 New Location
 Drill Deeper
 Redrill
 Abandonment

I, the undersigned, hereby certify that this map is correct to the best of my knowledge and belief and shows all the information required by Paragraph 5 of the Rules and Regulations of the Oil and Gas Section of the Mining Laws of West Virginia.
 The accuracy of this survey is within the limits and as prescribed in paragraph 5 by the Oil and Gas Division of the Department of Mines Regulations.

Company UNITED FUEL GAS CO.
 Address CHARLESTON, W. VA.
 Farm UNITED FUEL GAS CO. FEE
 T. L. Black DEED 9342-
 Tract 08 Acres 10,500 Lease No. _____
 Well (Farm) No. _____ Serial No. 9509-T
 Elevation (Spirit Level) 597.96'
 Quadrangle LOUISA 66
 County WAYNE District BUTLER
 Engineer Adrian Edgeman
 Engineer's Registration No. 2330
 File No. 12-41 Drawing No. _____
 Date APR. 15, '69 Scale 1" = 400'

STATE OF WEST VIRGINIA
 DEPARTMENT OF MINES
 OIL AND GAS DIVISION
 CHARLESTON

WELL LOCATION MAP
 FILE NO. Way-1549

+ Denotes location of well on United States Topographic Maps, scale 1 to 62,500 latitude and longitude lines being represented by border lines as shown.
 - Denotes one inch spaces on border line of original tracing.

Deep Well (Tusc.)
 MAY 04 1969



RECEIVED

DEC 31 1969

STATE OF WEST VIRGINIA & GAS DIVISION
DEPARTMENT OF MINES OF MINES
OIL AND GAS WELLS DIVISION

- Rotary
- Spudder
- Cable Tools
- Storage
- E. NOLL

Quadrangle Louisa 38° 15'
6-52
Permit No. WAY-1519

WELL RECORD

Oil or Gas Well Gas Well
(KIND)

Company United Fuel Gas Company
Address P.O. Box 1273 Charleston, W. Va.
Farm United Fuel Gas Co. Fee Acres. 10,500
Location (waters) Wobb Branch
Well No. 9509-T Elev. 597.96'
District Butler County Wayne
The surface of tract is owned in fee by United Fuel Gas Co.
Address Charleston, W. Va.
Mineral rights are owned by United Fuel Gas Co.
Address Charleston, W. Va.
Drilling commenced May 15, 1969
Drilling completed July 26, 1969
Date Shot From To

Casing and Tubing	Used in Drilling	Left in Well	Packers
Size			Kind of Packer
16			
13-3/8"		48'	Size of
10-3/4"		171'	
8-5/8"		1343'	Depth set
3-7"	3187'	824'	Perf. Top <u>3352'</u>
5 3/16"		3576'	Perf. Bottom <u>3367'</u>
4 1/2"			Perf. top <u>3400'</u>
3"			Perf. bottom <u>3431'</u>
2"			Perf. top <u>3468'</u>
Liners Used			Perf. bottom <u>3494'</u>

With Final Open Flow 9 /10ths Water in 2" Inch
/10ths Merc. in Inch
Volume 127 MCF Cu. Ft.
Rock Pressure 1325 lbs. 5 Days hrs.
Oil bbls., 1st 24 hrs.
WELL ACIDIZED (DETAILS)

Attach copy of cementing record.
CASING CEMENTED 4-1/2" SIZE 650' No. Ft. 8-5-69 Date
Amount of cement used (bags) 55 Bags
Name of Service Co. Dowell Inc.
COAL WAS ENCOUNTERED AT 75 FEET 48 INCHES
FEET INCHES FEET INCHES
FEET INCHES FEET INCHES

WELL FRACTURED (DETAILS) Frac. Corniferous Line 8-11-69 with 3,000# 10/20 Sand & 15,000# 20/40 Sand & 560 Bbls of water, 8-12-69 15,000# 20/40 Sand & 596 Bbls. water, 8-13-69 10,000# 20/40 sand & 630 Bbls. of water.
RESULT AFTER TREATMENT (Initial open Flow or bbls.) 9/10 W-2" - 127 MCF
ROCK PRESSURE AFTER TREATMENT 1325# HOURS 5 Days 127,000
Fresh Water 55' Feet Salt Water 632' Feet
Producing Sand Corniferous Line 3352-3494 Depth 3555' Total Depth 3940' hole plugged back to 3555'

Formation	Color	Hard or Soft	Top	Bottom	Oil, Gas or Water	Depth	Remarks
Surface			0	48			
Sand			48	70	Hole full of water at 55'		
Slate			70	75			
Coal			75	79			
Slate			79	90			
Sand			90	128			
Slate			128	136			
Sand			136	154			
Slate			154	162			
Sand			162	248			
Slate			248	290			
Sand			290	348			
Slate			348	370			
Sand			370	432			
Slate			432	473			
Line			473	485			
Slate			485	630	Show of Gas at 488'		
Salt Sand			630	1010	Hole full of water at 632'		
Slate			1010	1025			
Line			1025	1035			
Sand			1035	1040			
Little Lime			1040	1072			
Slate			1072	1074			
Sand			1074	1095			
Big Line			1095	1210			
Injun Sand			1210	1315			
Slate & Shells			1315	1800			
Brown Shale			1800	1811			
Berea			1811	1838	Show of Oil at 1814'		

Formation	Color	Hard or Soft	Top //	Bottom	Oil, Gas or Water	Depth Found	Remarks
Slate & Shells			1838	1911			Shut in 9-19-69 in 4-1/2"
Brown Shale			1911	2055			Casing
Shale White			2055	2110			
Shale White			2110	2140			
Shale Brown			2140	2280			LOGGED
Shale White			2280	2300			
Shale Brown			2300	2590			Gamma Ray
Gray Shale			2590	2778			Density
Brown Shale			2778	2822			Dual Induction
Corniferous Lime			2822	3498			Temperature
Big Six			3498	3525			
Red Rock			3525	3680			
Slate & Shells			3680	3738			
Red Rock			3738	3830			
Slate			3830	3855			2822
Red Rock			3855	3874			
Slate			3874	3887			
Clinton Sand	Tuscarora		3887	3913			
Slate & Shells			3913	3940			
Total Depth			3940				
Hole Plugged back to			3555				

Date December 30, 1969

APPROVED UNITED FUEL GAS COMPANY, Owner

By *Harold Foster*
Supervising Engineer - (Title) Civil Eng. Dept.

STATE OF WEST VIRGINIA
DEPARTMENT OF ENERGY
DIVISION OF OIL AND GAS

AFFIDAVIT OF PLUGGING AND FILLING WELL.

AFFIDAVITE SHOULD BE IN TRIPLICATE, one copy mailed to the Division, one copy to be retained by the Well Operator and the third copy (and extra copies if required) should be mailed to each coal operator at their respective addresses.

Farm name: HATFIELD, TOMMIE Operator Well No.: 19509-T

LOCATION: Elevation: 597.96 Quadrangle: LOUISA
District: BUTLER County: WAYNE
Latitude: 10725 Feet South of 38 Deg. 7 Min. 30 Sec.
Longitude 2475 Feet West of 82 Deg. 32 Min. 30 Sec.

Company: Columbia Gas Transmission Corp. Coal Operator: Columbia Gas Transmission
P.O. Box 1273 or Owner P.O. Box 1273
Charleston, WV 25325 Charleston, WV 25325

Agent: R. C. Weidner Coal Operator
Inspector: Jerry Holcomb or Owner
Permit Issued: 05/20/88

RECEIVED
AUG 25 1988

AFFIDAVIT

STATE OF WEST VIRGINIA,
County of Wayne ss:

DIVISION OF OIL & GAS
DEPARTMENT OF ENERGY

Earl Larch and James S. Reeves being

first duly sworn according to law depose and say that they are experienced in the work of plugging and filling oil and gas wells and were employed by Columbia Gas System, well operator, and participated in the work of plugging and filling the above well, that said work was commenced on the 1st day of August, 1988, and that the well was plugged and filled in the following manner:

TYPE	FROM	TO	PIPE REMOVED	LEFT
3% KCL Water	3576	3300		
S. Model 4 1/2" Baker Plug	3300		4 1/2" = 2300	1276
Cement	3300	3250	7" = -0-	834
Gel	3250	2220	8 5/8" = 655'	688
Cement	2220	2170	10 3/4" = -0-	171
Gel	2170	1834		
Cement	1834	1784		
Gel	1784	1385		
Cement	1385	1335		
Gel	1335	640		
Cement	640	590		

[Signature] 8/30/88

Description of monument: 8 5/8" x 30" Riser stating: Columbia Gas Trans. - Permit # 47-099-1549-P; 8-4-88.

and that the work of plugging and filling said well was completed on the 4th day of August, 1988.

And further deponents saith not.

[Signature: James S. Reeves]

Sworn and subscribe before me this 8th day of August, 1988

My commission expires: July 23, 1996

[Signature: Janet L. Stevens]
Notary Public

Columbia Gas Transmission
Well 9509-T
Permit # 47-099-1549-P

<u>TYPE</u>	<u>FROM</u>	<u>TO</u>	<u>PIPE REMOVED</u>	<u>LEFT</u>
Gel	590	192		
Cement	192	142		
Gel	142	102		
Cement	102	Surface		

RECEIVED
AUG 25 1988

DIVISION OF OIL & GAS
DEPARTMENT OF ENERGY