



STATE OF WEST VIRGINIA
DEPARTMENT OF MINES
OIL AND GAS DIVISION

NOTICE OF PROPOSED LOCATION OF OIL AND GAS WELL

To THE DEPARTMENT OF MINES,
Charleston, W. Va.

COAL OPERATOR OR COAL OWNER

ADDRESS

COAL OPERATOR OR COAL OWNER

ADDRESS

United Fuel Gas Company
OWNER OF MINERAL RIGHTS

ADDRESS

United Fuel Gas Company
NAME OF WELL OPERATOR

Charleston, W. Va.
COMPLETE ADDRESS

September 30, 19 63
PROPOSED LOCATION

Lincoln District

Wayne County

Well No. 9309 82° 25' E. 682.60'

UNITED FUEL GAS CO. MIN. TR. #1 Farm
14,591.12 Acres

GENTLEMEN:

The undersigned well operator is entitled to drill upon the above named farm or tract of land for oil and gas, having fee title thereto, (or as the case may be) under grant or lease dated December 26, 1946, made by Huntington Development & Gas Co., to United Fuel Gas Company, and recorded on the 27th day of December 1946, in the office of the County Clerk for said County in Book 234, page 318.

The enclosed plat was prepared by a competent engineer and shows the proposed location of a well to be drilled for oil and gas by the undersigned well operator on the farm and in the Magisterial District and County above named, determined by survey and courses and distances from two permanent points, or land marks.

The undersigned well operator is informed and believes there are no coal operators operating beds of coal beneath said farm or tract of land on which said well is located, or within 500 feet of the boundaries of the same, who have mapped their workings and filed their maps as required by law, excepting the coal operators or coal owners (if any) above named as addressees.

The above named coal operators or coal owners (if any) are notified that any objections they may desire to make to such proposed location, or which they are required to make by Section 3 of said Code, if the drilling of a well at said proposed location will cause a dangerous condition in or about their respective coal mines, must be received by, or filed with the Department of Mines within ten* days from the receipt of a copy of this notice and accompanying plat by said Department. Said coal operators are further notified that forms for use in making such objections will be furnished to them by the Department of Mines promptly on request and that all such objections must set forth as definitely as is reasonably possible the ground or grounds on which such objections are based and indicate the direction and distance the proposed location should be moved to overcome same.

(The next paragraph is to be completed only in Department's copy.)

Copies of this notice and the enclosed plat were mailed by registered mail, or delivered to the above named coal operators or coal owners at their above shown respective address _____ day _____ before, or on the same day with the mailing or delivery of this copy to the Department of Mines at Charleston, West Virginia.

Very truly yours,

UNITED FUEL GAS COMPANY
WELL OPERATOR

P. O. Box 1273
STREET

Charleston 25
CITY OR TOWN

West Virginia
STATE

10/27/2023

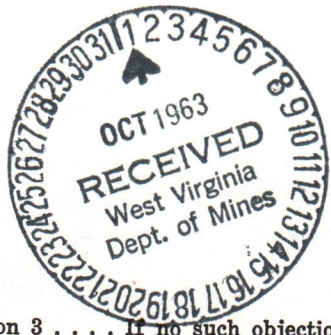

Address of Well Operator }

*Section 3 If no such objections be filed or be found by the department of mines, within said period of ten days from the receipt of said notice and plat by the department of mines, to said proposed location, the department shall forthwith issue to the well operator a drilling permit reciting the filing of such plat, that no objections have been made by the coal operators to the location, or found thereto by the department, and that the same is approved and the well operator authorized to proceed to drill at said location.

BLANKET BOND

1477

October 11, 1963
"Centennial Year"

United Fuel Gas Company
P. O. Box 1273
Charleston 25, West Virginia

Att: Mr. Bernard Moon

Gentlemen:

Enclosed is Permit WAY-1477 for drilling Well
No. 9309 on the United Fuel Gas Co. Min. Tr. #1 Lease,
Lincoln District, Wayne County.

Very truly yours,

Executive Secretary
OIL AND GAS DIVISION

GW/jb
enclosure

cc: Mr. Kenneth E. Butcher, Inspector

Mr. R. C. Tucker, Assistant State
Geologist

10/27/2023



STATE OF WEST VIRGINIA
DEPARTMENT OF MINES
OIL AND GAS DIVISION

Rotary
Spudder
Cable Tools
Storage

Quadrangle Wayne

Permit No. WAY-1477

WELL RECORD

Oil or Gas Well Gas
(KIND)

Company United Fuel Gas Co.
Address P.O. Box 1273 Charleston 25, W. Va.
Farm United Fuel Gas Co. Min. Tr. #1 Acres 14,591.12
Location (waters) Mill Creek
Well No. 9309 Elev. 682.60
District Lincoln County Wayne
The surface of tract is owned in fee by United Fuel Gas Co.
Address Charleston, W. Va.
Mineral rights are owned by _____
Address _____
Drilling commenced 11-11-63
Drilling completed 12-16-63
Date Shot 12-17-63 From _____ To _____
With 7600# Ind. Gelatin
Open Flow 1 1/2/10ths Water in _____ Inch
_____/10ths Merc. in _____ Inch
Volume 110,000 Cu. Ft.
Rock Pressure _____ lbs. X 20 hrs.
Oil _____ bbls., 1st 24 hrs.
WELL ACIDIZED _____
WELL FRACTURED _____

Casing and Tubing	Used in Drilling	Left in Well	Packers
Size			Kind of Packer
16			
13		None Cemented	
10 3/4	25'		Size of
8 1/4 5/8	248		Depth set
6 5/8			Perf. top
5 3/16 7"	1065'		Perf. bottom
3			Perf. top
2			Perf. bottom
Liners Used			Perf. top
			Perf. bottom

CASING CEMENTED _____ SIZE _____ No. Ft. _____ Date _____
COAL WAS ENCOUNTERED AT _____ FEET _____ INCHES
_____ FEET _____ INCHES _____ FEET _____ INCHES
_____ FEET _____ INCHES _____ FEET _____ INCHES

RESULT AFTER TREATMENT _____
ROCK PRESSURE AFTER TREATMENT _____
Fresh Water _____ Feet Salt Water _____ Feet

Formation	Color	Hard or Soft	Top	Bottom	Oil, Gas or Water	Depth	Remarks
Soil			0	30			
Sandman			30	45			
Slate			45	285			
Sand			285	310			
Slate			310	670			
Salt Sand			670	720			
Slate			720	760			
Sand			760	995			
Slate			995	1041			
Big Lime			1041	1200			
Injun Sand			1200	1350			
Slate & Shells			1350	1775			
Coffee Shale			1775	1797			
Berea Grit			1797	1900			
Slate			1900	1920			
Brown Shale			1920	2004			
Gray Shale			2004	2150			
Brown Shale			2150	2630			
Gray Shale			2630	2665			
Slate			2665	2724			
Total Depth			2724'				

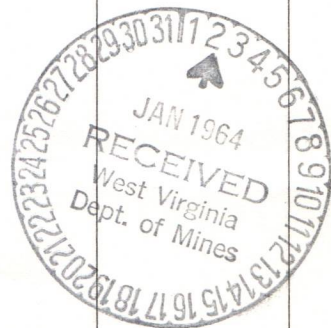

10/27/2023

UNITED FUEL GAS COMPANY
COMPANY

1477

SERIAL WELL NO. 9309

LEASE NO. No Ref.

MAP SQUARE 14-39

RECORD OF WELL NO. <u>9309</u> on the	CASING AND TUBING				TEST BEFORE SHOT
<u>UFG Co. Min. Tr. #1</u> <u>14,591.12</u> Acres	SIZE	WEIGHT	USED IN DRILLING	LEFT IN WELL	<u>0</u> /10 of Water in _____ in
in <u>Lincoln</u> District	<u>10-3/4"</u>	<u>32#</u>	<u>25'</u>		/10 of Merc. in _____ in
<u>Wayne</u> County	<u>8-5/8"</u>	<u>32#</u>	<u>248'</u>		Volume _____ Cu. f
State of: <u>West Virginia</u>	<u>7"</u>	<u>20#</u>	<u>1065'</u>		TEST AFTER SHOT
Field: <u>Central Division</u>					<u>12</u> /10 of Water in <u>2"</u> in
Rig Commenced <u>By Contractor</u> 19					/10 of Merc. in _____ in
Rig Completed <u>By Contractor</u> 19					Volume <u>146 MCF</u> Cu. f
Drilling Commenced <u>November 11,</u> 19 <u>63</u>					<u>1</u> Hours After Sh
Drilling Completed <u>December 16,</u> 19 <u>63</u>					Rock Pressure _____
Drilling to cost _____ per foot					Date Shot <u>12-17-63</u>
Contractor is: <u>Frather Drilling and Producing Co., Inc.</u>					<u>7500# Ind. Gelatin</u>
Address: <u>Oil Springs, Kentucky</u>	SHUT IN				Size of Torpedo _____
	Date _____				Oil Flowed _____ bbls. 1st 24 hr
Driller's Name <u>Joe Risner</u>	_____ in. Tubing or Casing				Oil Pumped _____ bbls. 1st 24 hr
<u>Manford McCarty</u>	Size of Packer _____				Well abandoned and
	Kind of Packer _____				Plugged _____ 19 _____
Drilling Permit No. <u>WAY-1477</u>	1st. Perf. Set _____ from _____				
Elevation: <u>682.60'</u>	2nd Perf. Set _____ from _____				

DRILLER'S RECORD

FORMATION	TOP	BOTTOM	THICKNESS	REMARKS
Soil	0	30	30	
Sand	30	45	15	
Slate	45	285	240	
Sand	285	310	25	
Slate	310	670	360	
Salt Sand	670	720	50	
Slate	720	760	40	
Sand	760	995	235	
Slate	995	1041	46	
Big Lime	1041	1200	159	
Injun Sand	1200	1350	150	
Slate & Shells	1350	1775	425	
Coffee Shale	1775	1797	22	
Berea Grit	1797	1900	103	
Slate	1900	1920	20	
Brown Shale	1920	2004	84	
Gray Shale	2004	2150	146	

APPROVED

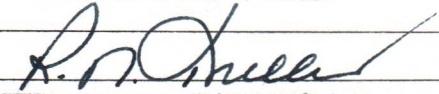

DIVISION SUPERINTENDENT

10/27/2023

STATE OF WEST VIRGINIA
DEPARTMENT OF MINES
OIL AND GAS DIVISION

INSPECTOR'S WELL REPORT

Permit No. Way-1477

Oil or Gas Well
(KIND)

		CASING AND TUBING	USED IN DRILLING	LEFT IN WELL	PACKERS
Company	<u>U.F.M. Co.</u>	Size			Kind of Packer
Address	<u>Charleston, W.Va.</u>	16			
Farm	<u>U.F.M. Co.</u>	13			
Well No.	<u>9309</u>	10	<u>25-</u>		Size of
District	<u>Lincoln</u> County <u>Wayne</u>	8 1/4			Depth set
Drilling commenced	<u>11-1-63</u>	6 3/8			
Drilling completed	Total depth	5 3/16			Perf. top
Date shot	Depth of shot	3			Perf. bottom
Initial open flow	/10ths Water in	2			Perf. top
Open flow after tubing	/10ths Merc. in	Liners Used			Perf. bottom
Volume	Cu. Ft.	CASING CEMENTED	SIZE	No. FT.	Date
Rock pressure	lbs.				
Oil	bbls., 1st 24 hrs.	COAL WAS ENCOUNTERED AT	West Virginia	FEET	INCHES
Fresh water	feet		Dept. of Mines	FEET	INCHES
Salt water	feet			FEET	INCHES

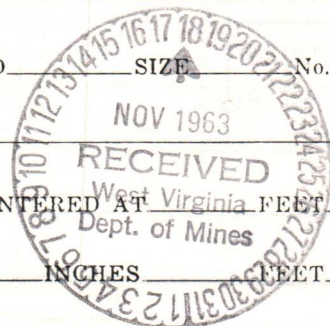

Drillers' Names Homer Six
 Remarks: Contr. Prather drilling co. Cable tools
Total depth 100-

11-14-63
DATE

K.E. Butcher
DISTRICT WELL INSPECTOR

Permit WAY-1477-P

December 18, 1963

APPROVED BY

Marie E. Griffith
Executive Secretary
OIL AND GAS DIVISION

Mrs. M. E. Griffith
State Department of Mines
Charleston, West Virginia

Notify Inspector Kenneth Butcher,
Warboursville, W. Va. PH^o Re-61933
24 HOURS IN ADVANCE OF PLUGGING

Dear Mrs. Griffith:

We propose to plug and abandon Well No. 9309, on the United Fuel Gas Co. Min. Tr. No. 1 Farm, Lincoln District, Wayne County, West Virginia, Map Square 14-39, in the following manner:

Set Bridge at	1777'	- 20' above Berea
Put 2 sacks cement on top of bridge		
Crushed Stone	1767' - 1762'	
Mud & Clay	1762' - 1662'	
Set Bridge at	1380'	- 30' below Injun Sand
Put 2 sacks cement on top of bridge		
Crushed Stone	1370' - 1365'	
Mud & Clay	1365' - 1085'	
Pull 7" Casing	1065'	
Mud & Clay	1085' - 1021'	- 20' above Big Lime
Cement	1021' - 1011'	
Crushed Stone	1011' - 1006'	
Set Bridge at	750'	- 30' below Salt Sand
Put 2 sacks cement on top of bridge		
Crushed Stone	740' - 735'	
Mud & Clay	735' - 650'	- 20' above Salt Sand
Cement	650' - 640'	
Crushed Stone	640' - 635'	
Set Bridge at	278'	- 30' below 8" Casing
Put 2 sacks cement on top of bridge		
Crushed Stone	268' - 263'	
Pull 8" Casing	248'	
Mud & Clay	263' - 10'	
Cement	10' - Surface	

Erect monument 30" above the surface with inscription "United Fuel Gas Co. Well No. 9309 - Abandoned Date _____".

Yours very truly,

R. N. Tullis

R. N. Tullis
Division Superintendent

RNT:jcr

10/27/2023

PROPOSED MANNER OF PLUGGING AND FILLING WELL

(REQUIRED BY RULES AND REGULATIONS)

WEST VIRGINIA DEPARTMENT OF MINES

OIL AND GAS DIVISION

WORK ORDER

Well to be plugged and filled as follows:

Set Bridge at	1777'	- 20' above Berea
Put 2 sacks cement on top of bridge		
Crushed Stone	1767' - 1762'	
Mud & Clay	1762' - 1662'	
Set Bridge at	1380'	- 30' below Injun Sand
Put 2 sacks cement on top of bridge		
Crushed Stone	1370' - 1365'	
Mud & Clay	1365' - 1085'	
Pull 7" Casing	1065'	
Mud & Clay	1085' - 1021'	- 20' above Big Lime
Cement	1021' - 1011'	
Crushed Stone	1011' - 1006'	
Set Bridge at	750'	- 30' below Salt Sand
Put 2 sacks cement on top of bridge		
Crushed Stone	740' - 735'	
Mud & Clay	735' - 650'	- 20' above Salt Sand
Cement	650' - 640'	
Crushed Stone	640' - 635'	
Set Bridge at	278'	- 30' below 8" Casing
Put 2 sacks cement on top of bridge		
Crushed Stone	268' - 263'	
Pull 8" Casing	248'	
Mud & Clay	263' - 10'	
Cement	10' - Surface	

Erect monument 30" above the surface with inscription "United Fuel Gas Co. Well No. 9309 - Abandoned Date _____".

To the Department of Mines
Coal Owner or Operator,
Lease or Property Owner.

Gentlemen:

This "work order" is submitted for your approval and concurrence and unless notified of your disapproval or non-concurrence, the undersigned will proceed with the plugging and filling of said well in the above described manner on the date inspector is notified after permit is issued.

Very truly yours,

UNITED FUEL GAS COMPANY

Well Operator

No objections have been filed by the coal owner or coal operator, or any available adjacent lease or property owners or interposed by the Department of Mines to the manner herein described for the plugging and filling of the well above mentioned. Therefore, the same is hereby approved.

18th day of DECEMBER, 19 63.

DEPARTMENT OF MINES
Oil and Gas Division

By: Marie E. Gipich

NOTE: This "work order" shall be filed in triplicate, one copy for the files of the Department of Mines; one to be approved or corrected and returned to the well operator as his authority for plugging said well; and one for the well inspector.

10/27/2023



STATE OF WEST VIRGINIA
DEPARTMENT OF MINES
OIL AND GAS DIVISION

NOTICE OF INTENTION TO PLUG AND ABANDON WELL

(REQUIRED BY SECTION 9, ARTICLE 4, CHAPTER 22 OF THE CODE)

To THE DEPARTMENT OF MINES,
Charleston, W. Va.

Coal Operator	<u>United Fuel Gas Company</u>	Name of Well Operator
Address	<u>P. O. Box 1273</u>	<u>Charleston, W. Va. 25325</u>
Coal Owner	<u>December 23, 1963</u>	Date
Address	<u>Lincoln</u>	District
<u>United Fuel Gas Company</u>	<u>Wayne</u>	County
Lease or Property Owner	Well No. <u>9309</u>	
Address	<u>UNITED FUEL GAS CO. MIN. TR. #1</u>	Farm
Inspector to be notified <u>Kenneth Butcher</u>	Telephone Number <u>RE-6-MM1933</u>	<u>Barboursville, W. Va.</u>

24 HOURS IN ADVANCE OF PLUGGING

Gentlemen:—

The undersigned well operator is about to abandon the above described well and will commence

the work of plugging and abandoning said well on the date inspector is notified (which date shall not be less than five days after the day on which this notice so mailed is received, or in due course should be received by the Department of Mines).

This notice is given you in order that your respective representatives may be present at the plugging and filling of said well. You are further notified that whether you are represented or not represented the undersigned will proceed on that date, or shortly thereafter, to plug and fill said well in the manner required by Section 10, Article 4, Chapter 22 of the Code and given in detail on the reverse side of this notice, in "Work Order."

This notice is being mailed by registered mail to each of you at the above addresses on the above date.

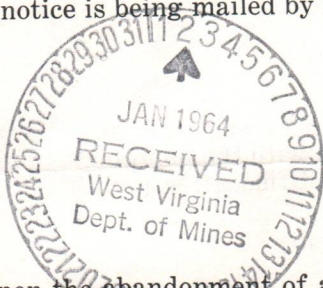

Very truly yours,

UNITED FUEL GAS COMPANY
Well Operator

NOTE: Upon the abandonment of any well drilled prior to June 1, 1929, a plat prepared by a registered engineer, shall be filed with THREE COPIES OF APPLICATION, (OG-9) AND "WORK ORDER" AND TWO COPIES OF THE WELL RECORD, (OG-10). The map must show the district and county in which the tract of land is located, the name and acreage of same, the name or names of the owners and names of adjacent tracts and the location of the well to be abandoned, determined by survey with the courses and distances of such well from two permanent points or landmarks on said tract.

10/27/2023

NOTE: In case plugging is not commenced within four months from the date of permit, same shall expire and be of no further force or effect.

NOTE: PERMIT IS NOT TRANSFERABLE.

WAY-1477-P

Permit Number

BLANKET BOND

way-1477-P

ATTENDANT OF DRIBBING AND FILLING WELL

STATEMENT MADE IN TESTIMONY THAT THE FOLLOWING IS A TRUE AND CORRECT STATEMENT OF THE WORK DONE BY THE ATTENDANT OF DRIBBING AND FILLING WELL...

Name of Mine: _____
Name of Attendant: _____
Date: _____

County: _____
District: _____

STATE OF WEST VIRGINIA
DEPARTMENT OF MINES
AND METALLURGY
STATEMENT MADE IN TESTIMONY THAT THE FOLLOWING IS A TRUE AND CORRECT STATEMENT OF THE WORK DONE BY THE ATTENDANT OF DRIBBING AND FILLING WELL...

101 - 101
101 - 101
101 - 101



10/27/2023

STATE OF WEST VIRGINIA
DEPARTMENT OF MINES
OIL AND GAS DIVISION

AFFIDAVIT OF PLUGGING AND FILLING WELL

AFFIDAVIT SHOULD BE MADE IN TRIPPLICATE. ONE COPY MAILED TO THE DEPARTMENT, ONE COPY TO BE RETAINED BY THE WELL OPERATOR AND THE THIRD COPY (AND EXTRA COPIES IF REQUIRED) SHOULD BE MAILED TO EACH COAL OPERATOR AT THEIR RESPECTIVE ADDRESSES.

COAL OPERATOR OR OWNER	United Fuel Gas Company
ADDRESS	P.O. Box 1273, Charleston, W. Va.
COAL OPERATOR OR OWNER	NAME OF WELL OPERATOR
ADDRESS	COMPLETE ADDRESS
LEASE OR PROPERTY OWNER	January 16, 19 64
ADDRESS	WELL AND LOCATION
	Lincoln District
	Wayne County
	Well No. 9309
	United Fuel Gas Co. Min. Tr. #1 Farm

STATE INSPECTOR SUPERVISING PLUGGING Kenneth Butcher

AFFIDAVIT

STATE OF WEST VIRGINIA,
County of Wayne } SS:

Earl Prather and H. P. Pelphrey
being first duly sworn according to law depose and say that they are experienced in the work of plugging and filling oil and gas wells and were employed by PRATHER DLG. & PROD., CO., INC., well operator, and participated in the work of plugging and filling the above well, that said work was commenced on the 30th. day of December, 19 63, and that the well was plugged and filled in the following manner:

SAND OR ZONE RECORD	FILLING MATERIAL	PLUGS USED	CASING	
			CSG PULLED	CSG LEFT IN
FORMATION	Set bridge at 1777'	SIZE & KIND		
	Put 2 sacks cement on top of bridge	10-3/4"	-	26'
	Crushed Stone 1767' - 1762'	8-5/8"	248'	•
	Mud & Clay 1762' - 1662'	7"	1072'	-
	Set bridge at 1380'			
	Put 2 sacks cement on top of bridge			
	Crushed Stone 1370' - 1365'			
	Mud & Clay 1365' - 1085'			
	Pulled 7" Casing 1072'			
	Mud & Clay 1085' - 1021'			
	Cement 1021' - 1011'			
	Crushed Stone 1011' - 1006'			
	Set bridge at 750'			
	Put 2 sacks cement on top of bridge			
	Crushed Stone 740' - 735'			
	Mud & Clay 735' - 650'			
COAL SEAMS	Cement 650' - 640'			
(NAME)	Crushed Stone 640' - 635'	DESCRIPTION OF MONUMENT		
(NAME)	Set Bridge at 278'	Erected monument 30" above the surface		
(NAME)	Put 2 sacks cement on top of bridge	with inscription "United Fuel Gas Co.		
(NAME)	Crushed Stone 268' - 263'	Well No. 9309 - Abandoned 1-8-64:		



and that the work of plugging and filling said well was completed on the 8th. day of January, 19 64.

And further deponents saith not.

x Earl Prather
x H. P. Pelphrey 10/27/2023

Sworn to and subscribed before me this 30 day of Jan, 19 64.

Anna Prather
Notary Public.

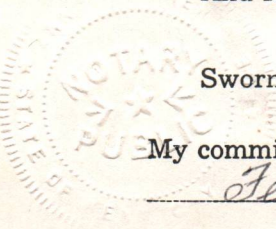

My commission expires: Feb. 2, 1968

Permit No. WAY-1477-P

AFFIDAVIT OF PRODUING AND FILLING WELL

AFFIDAVIT SHOULD BE MADE IN TRIPlicate. One copy shall be retained by the affiant, one copy shall be filed in the office of the State Engineer, and one copy shall be filed in the office of the State Auditor.

United Fuel Gas Company

P.O. Box 1213, Charleston, W. Va.

January 16, 1939

Location

3309

United Fuel Gas Co. Mine, Tr. #1

Location

AFFIDAVIT

STATE OF WEST VIRGINIA

County of Wayne

1939

I, the undersigned, being duly sworn, depose and say that the work on the well was completed on the 16th day of January, 1939, and that the well was filled with cement to the top of the casing. The well was filled with cement to the top of the casing and the casing was set to the top of the well. The well was filled with cement to the top of the casing and the casing was set to the top of the well. The well was filled with cement to the top of the casing and the casing was set to the top of the well.

1777	Set bridge at	1777	10-3/4"	-	25'
1781 - 1782	Crushed stone	1781 - 1782	8-5/8"	25'	-
1782 - 1783	1/2" clay	1782 - 1783	7"	102'	-
1783	Set bridge at	1783			
1783 - 1784	Crushed stone	1783 - 1784			
1784 - 1785	1/2" clay	1784 - 1785			
1785 - 1786	1/2" clay	1785 - 1786			
1786 - 1787	1/2" clay	1786 - 1787			
1787 - 1788	Crushed stone	1787 - 1788			
1788	Set bridge at	1788			
1788 - 1789	Crushed stone	1788 - 1789			
1789 - 1790	1/2" clay	1789 - 1790			
1790 - 1791	Crushed stone	1790 - 1791			
1791	Set bridge at	1791			
1791 - 1792	Crushed stone	1791 - 1792			
1792 - 1793	1/2" clay	1792 - 1793			
1793 - 1794	Cement	1793 - 1794			
1794 - 1795	Crushed stone	1794 - 1795			
1795	Set bridge at	1795			
1795 - 1796	Crushed stone	1795 - 1796			
1796 - 1797	1/2" clay	1796 - 1797			
1797 - 1798	Crushed stone	1797 - 1798			
1798	Set bridge at	1798			
1798 - 1799	Crushed stone	1798 - 1799			
1799 - 1800	1/2" clay	1799 - 1800			
1800 - 1801	Crushed stone	1800 - 1801			
1801	Set bridge at	1801			
1801 - 1802	Crushed stone	1801 - 1802			
1802 - 1803	1/2" clay	1802 - 1803			
1803 - 1804	Crushed stone	1803 - 1804			
1804	Set bridge at	1804			
1804 - 1805	Crushed stone	1804 - 1805			
1805 - 1806	1/2" clay	1805 - 1806			
1806 - 1807	Crushed stone	1806 - 1807			
1807	Set bridge at	1807			
1807 - 1808	Crushed stone	1807 - 1808			
1808 - 1809	1/2" clay	1808 - 1809			
1809 - 1810	Crushed stone	1809 - 1810			
1810	Set bridge at	1810			
1810 - 1811	Crushed stone	1810 - 1811			
1811 - 1812	1/2" clay	1811 - 1812			
1812 - 1813	Crushed stone	1812 - 1813			
1813	Set bridge at	1813			
1813 - 1814	Crushed stone	1813 - 1814			
1814 - 1815	1/2" clay	1814 - 1815			
1815 - 1816	Crushed stone	1815 - 1816			
1816	Set bridge at	1816			
1816 - 1817	Crushed stone	1816 - 1817			
1817 - 1818	1/2" clay	1817 - 1818			
1818 - 1819	Crushed stone	1818 - 1819			
1819	Set bridge at	1819			
1819 - 1820	Crushed stone	1819 - 1820			
1820 - 1821	1/2" clay	1820 - 1821			
1821 - 1822	Crushed stone	1821 - 1822			
1822	Set bridge at	1822			
1822 - 1823	Crushed stone	1822 - 1823			
1823 - 1824	1/2" clay	1823 - 1824			
1824 - 1825	Crushed stone	1824 - 1825			
1825	Set bridge at	1825			
1825 - 1826	Crushed stone	1825 - 1826			
1826 - 1827	1/2" clay	1826 - 1827			
1827 - 1828	Crushed stone	1827 - 1828			
1828	Set bridge at	1828			
1828 - 1829	Crushed stone	1828 - 1829			
1829 - 1830	1/2" clay	1829 - 1830			
1830 - 1831	Crushed stone	1830 - 1831			
1831	Set bridge at	1831			
1831 - 1832	Crushed stone	1831 - 1832			
1832 - 1833	1/2" clay	1832 - 1833			
1833 - 1834	Crushed stone	1833 - 1834			
1834	Set bridge at	1834			
1834 - 1835	Crushed stone	1834 - 1835			
1835 - 1836	1/2" clay	1835 - 1836			
1836 - 1837	Crushed stone	1836 - 1837			
1837	Set bridge at	1837			
1837 - 1838	Crushed stone	1837 - 1838			
1838 - 1839	1/2" clay	1838 - 1839			
1839 - 1840	Crushed stone	1839 - 1840			
1840	Set bridge at	1840			
1840 - 1841	Crushed stone	1840 - 1841			
1841 - 1842	1/2" clay	1841 - 1842			
1842 - 1843	Crushed stone	1842 - 1843			
1843	Set bridge at	1843			
1843 - 1844	Crushed stone	1843 - 1844			
1844 - 1845	1/2" clay	1844 - 1845			
1845 - 1846	Crushed stone	1845 - 1846			
1846	Set bridge at	1846			
1846 - 1847	Crushed stone	1846 - 1847			
1847 - 1848	1/2" clay	1847 - 1848			
1848 - 1849	Crushed stone	1848 - 1849			
1849	Set bridge at	1849			
1849 - 1850	Crushed stone	1849 - 1850			
1850 - 1851	1/2" clay	1850 - 1851			
1851 - 1852	Crushed stone	1851 - 1852			
1852	Set bridge at	1852			
1852 - 1853	Crushed stone	1852 - 1853			
1853 - 1854	1/2" clay	1853 - 1854			
1854 - 1855	Crushed stone	1854 - 1855			
1855	Set bridge at	1855			
1855 - 1856	Crushed stone	1855 - 1856			
1856 - 1857	1/2" clay	1856 - 1857			
1857 - 1858	Crushed stone	1857 - 1858			
1858	Set bridge at	1858			
1858 - 1859	Crushed stone	1858 - 1859			
1859 - 1860	1/2" clay	1859 - 1860			
1860 - 1861	Crushed stone	1860 - 1861			
1861	Set bridge at	1861			
1861 - 1862	Crushed stone	1861 - 1862			
1862 - 1863	1/2" clay	1862 - 1863			
1863 - 1864	Crushed stone	1863 - 1864			
1864	Set bridge at	1864			
1864 - 1865	Crushed stone	1864 - 1865			
1865 - 1866	1/2" clay	1865 - 1866			
1866 - 1867	Crushed stone	1866 - 1867			
1867	Set bridge at	1867			
1867 - 1868	Crushed stone	1867 - 1868			
1868 - 1869	1/2" clay	1868 - 1869			
1869 - 1870	Crushed stone	1869 - 1870			
1870	Set bridge at	1870			
1870 - 1871	Crushed stone	1870 - 1871			
1871 - 1872	1/2" clay	1871 - 1872			
1872 - 1873	Crushed stone	1872 - 1873			
1873	Set bridge at	1873			
1873 - 1874	Crushed stone	1873 - 1874			
1874 - 1875	1/2" clay	1874 - 1875			
1875 - 1876	Crushed stone	1875 - 1876			
1876	Set bridge at	1876			
1876 - 1877	Crushed stone	1876 - 1877			
1877 - 1878	1/2" clay	1877 - 1878			
1878 - 1879	Crushed stone	1878 - 1879			
1879	Set bridge at	1879			
1879 - 1880	Crushed stone	1879 - 1880			
1880 - 1881	1/2" clay	1880 - 1881			
1881 - 1882	Crushed stone	1881 - 1882			
1882	Set bridge at	1882			
1882 - 1883	Crushed stone	1882 - 1883			
1883 - 1884	1/2" clay	1883 - 1884			
1884 - 1885	Crushed stone	1884 - 1885			
1885	Set bridge at	1885			
1885 - 1886	Crushed stone	1885 - 1886			
1886 - 1887	1/2" clay	1886 - 1887			
1887 - 1888	Crushed stone	1887 - 1888			
1888	Set bridge at	1888			
1888 - 1889	Crushed stone	1888 - 1889			
1889 - 1890	1/2" clay	1889 - 1890			
1890 - 1891	Crushed stone	1890 - 1891			
1891	Set bridge at	1891			
1891 - 1892	Crushed stone	1891 - 1892			
1892 - 1893	1/2" clay	1892 - 1893			
1893 - 1894	Crushed stone	1893 - 1894			
1894	Set bridge at	1894			
1894 - 1895	Crushed stone	1894 - 1895			
1895 - 1896	1/2" clay	1895 - 1896			
1896 - 1897	Crushed stone	1896 - 1897			
1897	Set bridge at	1897			
1897 - 1898	Crushed stone	1897 - 1898			
1898 - 1899	1/2" clay	1898 - 1899			
1899 - 1900	Crushed stone	1899 - 1900			
1900	Set bridge at	1900			
1900 - 1901	Crushed stone	1900 - 1901			
1901 - 1902	1/2" clay	1901 - 1902			
1902 - 1903	Crushed stone	1902 - 1903			
1903	Set bridge at	1903			
1903 - 1904	Crushed stone	1903 - 1904			
1904 - 1905	1/2" clay	1904 - 1905			
1905 - 1906	Crushed stone	1905 - 1906			
1906	Set bridge at	1906			
1906 - 1907	Crushed stone	1906 - 1907			
1907 - 1908	1/2" clay	1907 - 1908			
1908 - 1909	Crushed stone	1908 - 1909			
1909	Set bridge at	1909			
1909 - 1910	Crushed stone	1909 - 1910			
1910 - 1911	1/2" clay	1910 - 1911			
1911 - 1912	Crushed stone	1911 - 1912			
1912	Set bridge at	1912			
1912 - 1913	Crushed stone	1912 - 1913			
1913 - 1914	1/2" clay	1913 - 1914			
1914 - 1915	Crushed stone	1914 - 1915			
1915	Set bridge at	1915			
1915 - 1916	Crushed stone	1915 - 1916			
1916 - 1917	1/2" clay	1916 - 1917			
1917 - 1918	Crushed stone	1917 - 1918			
1918	Set bridge at	1918			
1918 - 1919	Crushed stone	1918 - 1919			
1919 - 1920	1/2" clay	1919 - 1920			
1920 - 1921	Crushed stone	1920 - 1921			
1921	Set bridge at	1921			
1921 - 1922	Crushed stone	1921 - 1922			
1922 - 1923	1/2" clay	1922 - 1923			
1923 - 1924	Crushed stone	1923 - 1924			
1924	Set bridge at	1924			

STATE OF WEST VIRGINIA
DEPARTMENT OF MINES
OIL AND GAS DIVISION

Rotary
Spudder
Cable Tools
Storage

INSPECTOR'S WELL REPORT

Permit No. Way-1477P

Oil or Gas Well
(KIND)

Company	CASING AND TUBING	USED IN DRILLING	LEFT IN WELL	PACKERS
<u>U. F. M. Co.</u>	Size			
<u>Charleston, W. Va.</u>	16			Kind of Packer
<u>U. F. M. Co.</u>	13			
<u>9309</u>	10			Size of
<u>Lincoln</u> County <u>Wayne</u>	8 1/4			
Drilling commenced	6 5/8			Depth set
Drilling completed <u>2255</u> Total depth	5 3/16			
Date shot	3			Perf. top
Depth of shot	2			Perf. bottom
Initial open flow /10ths Water in Inch	Liners Used			Perf. top
Open flow after tubing /10ths Merc. in Inch				Perf. bottom
Volume Cu. Ft.	CASING CEMENTED	SIZE	No. FT	Date
Rock pressure lbs. hrs.	NAME OF SERVICE COMPANY			
Oil bbls., 1st 24 hrs.	COAL WAS ENCOUNTERED AT			INCHES
Fresh water feet feet		FEEET	INCHES	FEEET INCHES
Salt water feet feet		FEEET	INCHES	FEEET INCHES

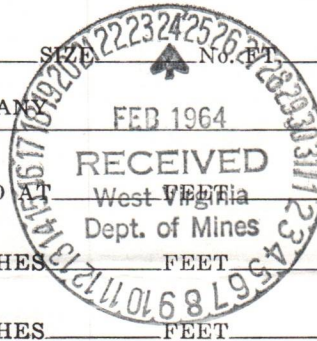

Drillers' Names Hammer Six

Prather drilling co., Cash
Remarks:

Final inspection made for land release.

2-21-64
DATE

K. E. Butcher
DISTRICT WELL INSPECTOR

10/27/2023

February 25, 1964

Mr. Bernard Moon
United Fuel Gas Company
P. O. Box 1273
Charleston, West Virginia

Dear Mr. Moon:

The final inspection report for your Well No. 9309 on the United Fuel Gas Company Farm, Lincoln District, Wayne County, has been received in our office. Plugging was done under Permit WAY-1477-P.

As our Inspector, Mr. Kenneth Butcher, reports that everything is in good order, we are releasing this well under the Blanket Bond by which it is covered.

Yours very truly,

GURMER WAMOCK

sm

10/27/2023

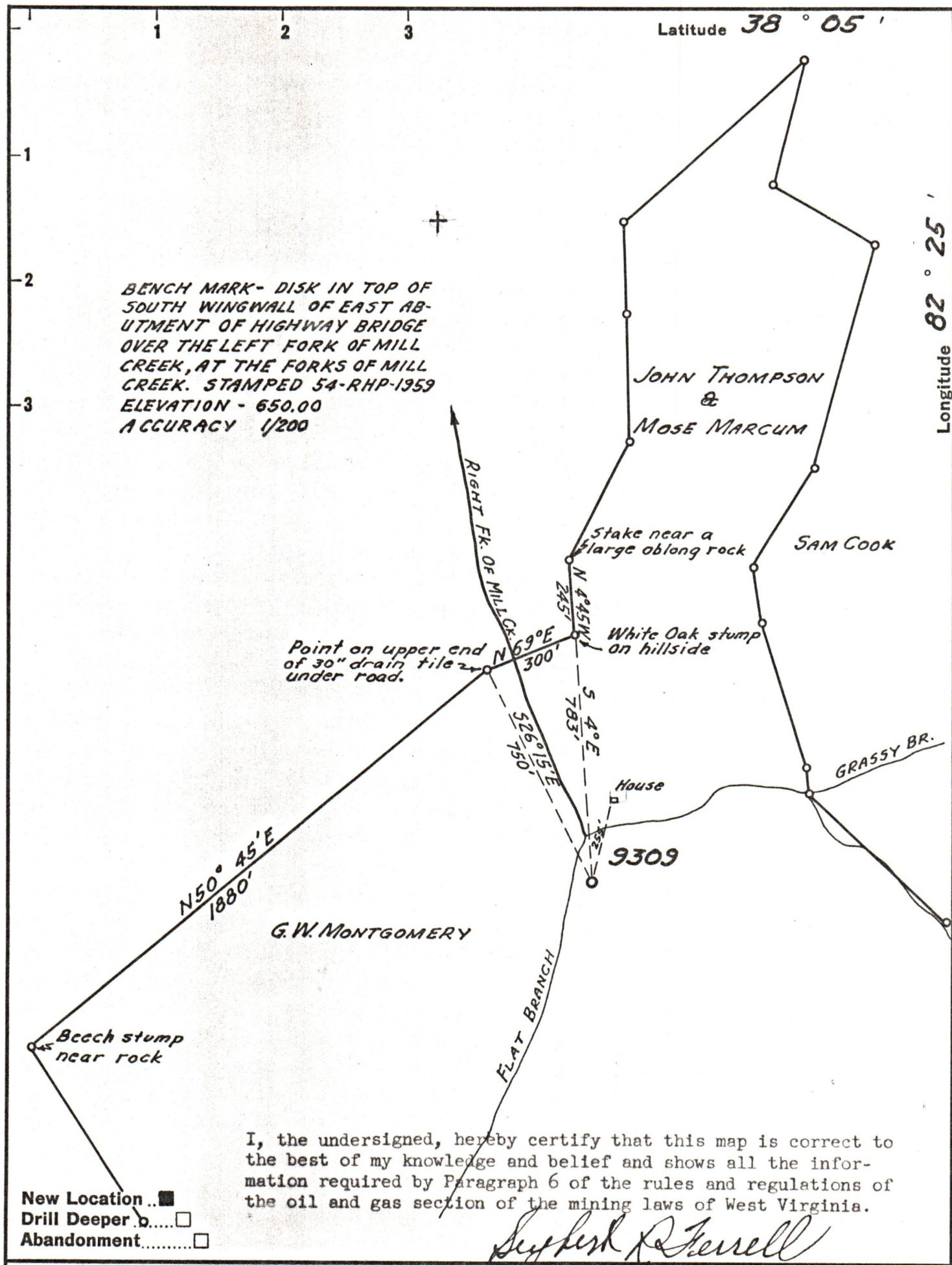

BENCH MARK- DISK IN TOP OF SOUTH WINGWALL OF EAST ABUTMENT OF HIGHWAY BRIDGE OVER THE LEFT FORK OF MILL CREEK, AT THE FORKS OF MILL CREEK. STAMPED 54-RHP-1959 ELEVATION - 650.00 ACCURACY 1/200

Point on upper end of 30" drain tile under road.

Stake near a large oblong rock

White Oak stump on hillside

House

9309

I, the undersigned, hereby certify that this map is correct to the best of my knowledge and belief and shows all the information required by Paragraph 6 of the rules and regulations of the oil and gas section of the mining laws of West Virginia.

Sybert R. Ferrell

New Location
 Drill Deeper
 Abandonment

Company UNITED FUEL GAS CO.
 Address CHARLESTON, W.VA.
 Farm UNITED FUEL GAS CO. MIN. TR. 1
 Tract 1 Acres 14,591.12 Lease No. NO REF.
 Well (Farm) No. _____ Serial No. 9309
 Elevation (Trig. Level) 682.60
 Quadrangle WAYNE
 County WAYNE District LINCOLN
 Engineer Sybert R. Ferrell
 Engineer's Registration No. 2529
 File No. 14-39 Drawing No. _____
 Date 9-10-63 Scale 1" = 400'

STATE OF WEST VIRGINIA
 DEPARTMENT OF MINES
 OIL AND GAS DIVISION
 CHARLESTON

WELL LOCATION MAP
 FILE NO. WAY-1477

10/27/2023

+ Denotes location of well on United States Topographic Maps, scale 1 to 62,500, latitude and longitude lines being represented by border lines as shown.

- Denotes one inch spaces on border line of original tracing.