



STATE OF WEST VIRGINIA
DEPARTMENT OF MINES
CHARLESTON

W. F. Eigenbrod
XXXXXXXXXX

September 21, 1963
"Centennial Year"

C
O
P
Y

United Fuel Gas Company
P. O. Box 1273
Charleston 25, West Virginia

Att: Mr. Bernard Moon

Gentlemen:

Enclosed are permits for drilling the following wells:

<u>PERMIT NO.</u>	<u>WELL NO.</u>	<u>FARM</u>	<u>DISTRICT</u>
WAY-1474	9310	United Fuel Gas Co.Min.Tr.#3	Lincoln
WAY-1475-R	2396	United Fuel Gas Co.Min.Tr.#1	Grant

Very truly yours,

Executive Secretary
OIL AND GAS DIVISION

GW/jb
enclosure

cc: Mr. Kenneth E. Butcher, Inspector
Mr. R. C. Tucker, Assistant State Geologist



STATE OF WEST VIRGINIA
DEPARTMENT OF MINES
CHARLESTON

W. F. Elphinstone
XXXXXXXXXX

September 21, 1933
"Centennial Year"

COPY

United Fuel Gas Company
P. O. Box 1273
Charleston 25, West Virginia

Att: Mr. Bernard Moon

Gentlemen:

Enclosed are permits for drilling the following wells:

<u>PERMIT NO.</u>	<u>WELL NO.</u>	<u>FARM</u>	<u>DISTRICT</u>
WAY-1474	2310	United Fuel Gas Co. Min. Tr. #3 Lincoln	
WAY-1475-R	2328	United Fuel Gas Co. Min. Tr. #1 Grant	

Very truly yours,

Executive Secretary
OIL AND GAS DIVISION

GW/jb
enclosure

cc: Mr. Kenneth E. Butcher, Inspector
Mr. R. C. Tucker, Assistant State Geologist



STATE OF WEST VIRGINIA
DEPARTMENT OF MINES
OIL AND GAS DIVISION

NOTICE OF PROPOSED LOCATION OF OIL AND GAS WELL

To THE DEPARTMENT OF MINES,
Charleston, W. Va.

RE - DRILL

United Fuel Gas Company
COAL OPERATOR OR COAL OWNER

United Fuel Gas Company
NAME OF WELL OPERATOR

ADDRESS

Charleston, W. Va.
COMPLETE ADDRESS

COAL OPERATOR OR COAL OWNER

September 10, 19 63

PROPOSED LOCATION

ADDRESS

Grant District

United Fuel Gas Company
OWNER OF MINERAL RIGHTS

Wayne County

P. O. Box 1273
Charleston 25, W. Va.
ADDRESS

Well No. 2396 38° 05' 82° 20' E 1117.61'

UNITED FUEL GAS CO. MIN. TR. #1 Farm
40, 639.36 acres

GENTLEMEN:

The undersigned well operator is entitled to drill upon the above named farm or tract of land for oil and gas, having fee title thereto, (or as the case may be) under grant or lease dated December 26, 1946, made by Huntington Dev. & Gas Co., to United Fuel Gas Company, and recorded on the 27th day of December 1946, in the office of the County Clerk for said County in Book 234, page 318.

The enclosed plat was prepared by a competent engineer and shows the proposed location of a well to be drilled for oil and gas by the undersigned well operator on the farm and in the Magisterial District and County above named, determined by survey and courses and distances from two permanent points, or land marks.

The undersigned well operator is informed and believes there are no coal operators operating beds of coal beneath said farm or tract of land on which said well is located, or within 500 feet of the boundaries of the same, who have mapped their workings and filed their maps as required by law, excepting the coal operators or coal owners (if any) above named as addressees.

The above named coal operators or coal owners (if any) are notified that any objections they may desire to make to such proposed location, or which they are required to make by Section 3 of said Code, if the drilling of a well at said proposed location will cause a dangerous condition in or about their respective coal mines, must be received by, or filed with the Department of Mines within ten* days from the receipt of a copy of this notice and accompanying plat by said Department. Said coal operators are further notified that forms for use in making such objections will be furnished to them by the Department of Mines promptly on request and that all such objections must set forth as definitely as is reasonably possible the ground or grounds on which such objections are based and indicate the direction and distance the proposed location should be moved to overcome same.

(The next paragraph is to be completed only in Department's copy.)

Copies of this notice and the enclosed plat were mailed by registered mail, or delivered to the above named coal operators or coal owners at their above shown respective address _____ day _____ before, or on the same day with the mailing or delivery of this copy to the Department of Mines at Charleston, West Virginia.

Very truly yours,

UNITED FUEL GAS COMPANY
WELL OPERATOR

P. O. Box 1273
STREET

Charleston 25
CITY OR TOWN

West Virginia
STATE

Address of Well Operator }

10/27/2023

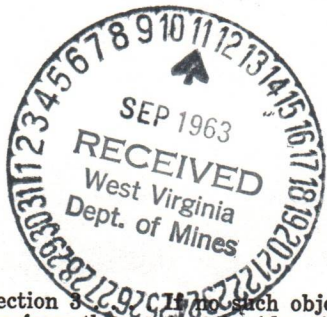

*Section 3 of the Code provides that no such objections be filed or be found by the department of mines, within said period of ten days from the receipt of said notice and plat by the department of mines, to said proposed location, the department shall forthwith issue to the well operator a drilling permit reciting the filing of such plat, that no objections have been made by the coal operators to the location, or found thereto by the department, and that the same is approved and the well operator authorized to proceed to drill at said location.

BLANKET BOND

1475-R-111

STATE OF WEST VIRGINIA
DEPARTMENT OF MINES
OFFICE OF THE COMMISSIONER

NOTICE OF PROPOSED LOCATION OF OIL AND GAS WELL

RE - DRILL

To The Director of Mines
Charleston, W. Va.

United Fuel Gas Company

United Fuel Gas Company

Charleston, W. Va.

P. O. Box 1213
Charleston 25, W. Va.

September 10, 1946

December 20, 1946

Grant

United Fuel Gas Company

Wayne

P. O. Box 1213

Charleston 25, W. Va.

UNITED FUEL GAS CO. INC. P. O. BOX 1213

The undersigned well operator is hereby notified that the proposed location of a well on the above described land is being proposed by the undersigned well operator and that the same is being proposed for the purpose of drilling for oil and gas.

The proposed location of the well is shown on the attached map and is located on the north side of the road leading from the highway to the farm of the undersigned well operator.

The proposed location of the well is shown on the attached map and is located on the north side of the road leading from the highway to the farm of the undersigned well operator.

The proposed location of the well is shown on the attached map and is located on the north side of the road leading from the highway to the farm of the undersigned well operator.

The proposed location of the well is shown on the attached map and is located on the north side of the road leading from the highway to the farm of the undersigned well operator.

The proposed location of the well is shown on the attached map and is located on the north side of the road leading from the highway to the farm of the undersigned well operator.

The proposed location of the well is shown on the attached map and is located on the north side of the road leading from the highway to the farm of the undersigned well operator.

The proposed location of the well is shown on the attached map and is located on the north side of the road leading from the highway to the farm of the undersigned well operator.

The proposed location of the well is shown on the attached map and is located on the north side of the road leading from the highway to the farm of the undersigned well operator.

UNITED FUEL GAS COMPANY

P. O. Box 1213

Charleston 25

West Virginia



10/27/2023

BLANKET BOND

WAY-107-18



STATE OF WEST VIRGINIA
 DEPARTMENT OF MINES
 OIL AND GAS DIVISION
 RE - DRILL
 WELL RECORD

Quadrangle Wayne
 Permit No. WAY-1475-R

Oil or Gas Well Gas
 (KIND)

Company United Fuel Gas Co.
 Address P.O. Box 1273 Charleston 25, W. Va.
 Farm United Fuel Gas Co. Min. TR. #1 Acres 40,639.36
 Location (waters) Right Fork of Rich Creek
 Well No. 2396 Elev. 1117.61
 District Grant County Wayne
 The surface of tract is owned in fee by _____
 Address _____
 Mineral rights are owned by United Fuel Gas Company
 Address Charleston, W. Va.
 Drilling commenced 9-27-63
 Drilling completed 10-10-63
 Date Shot _____ From _____ To _____
 With _____
 Open Flow /10ths Water in _____ Inch
 /10ths Merc. in _____ Inch
 Volume 112,000 - Injun Cu. Ft.
 Rock Pressure 220 lbs. 48 hrs.
 Oil _____ bbls., 1st 24 hrs.
 WELL ACIDIZED _____
 WELL FRACTURED _____

Casing and Tubing	Used in Drilling	Left in Well	Packers
Size			Kind of Packer _____
16			
13			
10			Size of _____
8 1/4		309	
6 5/8			Depth set _____
5 3/16			
3 1/2	1716' 65 sacks cement		Perf. top _____
2			Perf. bottom _____
Liners Used			Perf. top _____
			Perf. bottom _____

CASING CEMENTED _____ SIZE _____ No. Ft. _____ Date _____
 COAL WAS ENCOUNTERED AT 210 FEET 60 INCHES
 _____ FEET _____ INCHES FEET _____ INCHES
 _____ FEET _____ INCHES FEET _____ INCHES

RESULT AFTER TREATMENT _____
 ROCK PRESSURE AFTER TREATMENT _____
 Fresh Water _____ Feet Salt Water 935' Feet

Formation	Color	Hard or Soft	Top	Bottom	Oil, Gas or Water	Depth	Remarks
Soil			0	20	Show of oil	1609-1637'	
Coal			210	215			
Slate & Sand			215	895	Show gas	1668-1678'	
Salt Sand			895	1020			
Slate & Sand			1020	1365	Water	935'	
Maxon Sand			1365	1370			
Slate			1370	1373	Perforated at	1656-1668'	with 24 shots.
Little Lime			1373	1421			
Big Lime			1421	1591	Fractured Injun	10-17-63	with 400#
Slate			1591	1607	sand laden fluid and	6,000#	10-20 sand
Injun Sand			1607	1690	Final open flow after fracture	7/10 W	
Slate			1690	1730	2" 112 M		
Total Depth			1730'				



Shut in 10-28-63 in 3 1/2" tubing.
 LOGS RUN:
 Gamma Ray
 Density

10/27/2023

STATE OF WEST VIRGINIA
DEPARTMENT OF MINES
OIL AND GAS DIVISION

Rotary
Spudder
Cable Tools
Storage

INSPECTOR'S WELL REPORT

Permit No. Way-1475R

Oil or Gas Well _____
(KIND)

Company	CASING AND TUBING	USED IN DRILLING	LEFT IN WELL	PACKERS
<u>U.F.H. Co.</u>	Size			Kind of Packer
<u>Charleston W.Va.</u>	16			
<u>U.F.H. Co.</u>	13			
<u>2396</u>	10			Size of
District <u>Grant</u> County <u>Marye</u>	8 1/4			
Drilling commenced	6 5/8			Depth set
Drilling completed _____ Total depth _____	5 3/16			
Date shot _____ Depth of shot _____	3			Perf. top
Initial open flow _____ /10ths Water in _____ Inch	2			Perf. bottom
Open flow after tubing _____ /10ths Merc. in _____ Inch	Liners Used			Perf. top
Volume _____ Cu. Ft.				Perf. bottom
Rock pressure _____ lbs. _____ hrs.	CASING CEMENTED _____ SIZE _____ No. FT. _____ Date _____			
Oil _____ bbls., 1st 24 hrs.	NAME OF SERVICE COMPANY _____			
Fresh water _____ feet _____ feet	COAL WAS ENCOUNTERED AT _____ FEET _____ INCHES			
Salt water _____ feet _____ feet	_____ FEET _____ INCHES			
	_____ FEET _____ INCHES			

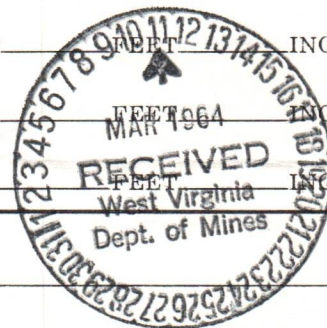

Drillers' Names _____

Remarks: _____

Final inspection for bond Release.

2-27-64

DATE

H. E.

DISTRICT WELL INSPECTOR

10/27/2023

March 30, 1964

Mr. Bernard Moon
United Fuel Gas Company
P.O. Box 1273
Charleston, West Virginia

Dear Mr. Moon:

The final inspection report for your Well No. 2396 on the United Fuel Gas Company Farm, Grant District, Wayne County, has been received in our office. This redrilling was done under Permit WAY-1475-R.

As our Inspector, Mr. Kenneth Butcher, reports that everything is in good order, we are releasing this well under the Blanket Bond by which it is covered.

Yours very truly,

GURMER WAMOCK

sm

10/27/2023

Latitude 38° 05'

BENCH MARK DESCRIPTION
U.F.G. Co. Well No 2040. Ground
At Well Casing. Elev. 1139.26'

Accuracy of One Part in 200'



U.F.G. CO. MIN.

Longitude 82° 20'

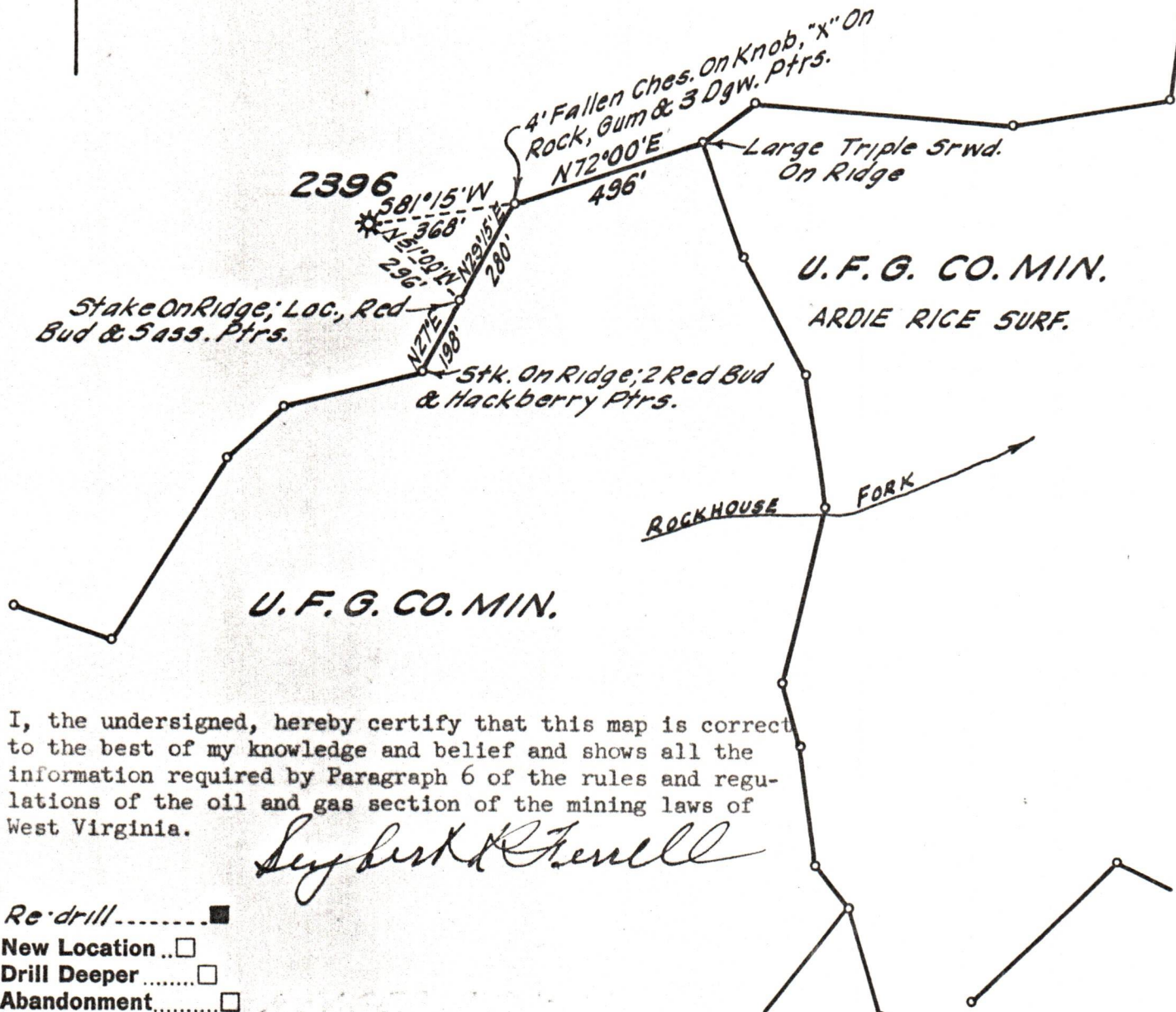

I, the undersigned, hereby certify that this map is correct to the best of my knowledge and belief and shows all the information required by Paragraph 6 of the rules and regulations of the oil and gas section of the mining laws of West Virginia.

Sybert R. Russell

- Re-drill.....
- New Location...
- Drill Deeper.....
- Abandonment.....

Company UNITED FUEL GAS CO.
 Address CHARLESTON, W. VA.
 Farm UNITED FUEL GAS CO. MIN.
 Tract 1 Acres 40639.96 REF. 24686
 Well (Farm) No. _____ Serial No. 2396
 Elevation (Spirit Level) 1117.61'
 Quadrangle WAYNE
 County WAYNE District GRANT
 Engineer Sybert R. Russell
 Engineer's Registration No. 2529
 File No. 20-39 Drawing No. _____
 Date 8-20-63 Scale 1"=400'

STATE OF WEST VIRGINIA
DEPARTMENT OF MINES
OIL AND GAS DIVISION
CHARLESTON

WELL LOCATION MAP

FILE NO. WAY-1475-R 10/27/2023

PLUGGED UNDER PERMIT WAY-12

+ Denotes location of well on United States Topographic Maps, scale 1 to 62,500, latitude and longitude lines being represented by border lines as shown.

- Denotes one inch spaces on border line of original tracing.