



STATE OF WEST VIRGINIA
DEPARTMENT OF MINES
OIL AND GAS DIVISION

NOTICE OF PROPOSED LOCATION OF OIL AND GAS WELL

To THE DEPARTMENT OF MINES,
Charleston, W. Va.

_____	<u>United Fuel Gas Company</u>
COAL OPERATOR OR COAL OWNER	NAME OF WELL OPERATOR
_____	<u>Charleston, W. Va.</u>
ADDRESS	COMPLETE ADDRESS
_____	<u>January 4</u> , 19 <u>63</u>
COAL OPERATOR OR COAL OWNER	PROPOSED LOCATION
_____	<u>Grant</u> District
ADDRESS	<u>Wayne</u> County
<u>United Fuel Gas Company</u>	<u>38° 05'</u>
OWNER OF MINERAL RIGHTS	Well No. <u>9232</u> <u>82° 20' E. 789.67'</u>
<u>Charleston, W. Va.</u>	
ADDRESS	

UNITED FUEL GAS CO. MIN. TR. #1 Farm
40, 578.86 Acres

GENTLEMEN:
The undersigned well operator is entitled to drill upon the above named farm or tract of land for oil and gas, having fee title thereto, (or as the case may be) under grant or lease dated December 26, 1946, made by Huntington Development & Gas Co., to United Fuel Gas Co., and recorded on the 27th day of December 1946, in the office of the County Clerk for said County in Book 234, page 318.

The enclosed plat was prepared by a competent engineer and shows the proposed location of a well to be drilled for oil and gas by the undersigned well operator on the farm and in the Magisterial District and County above named, determined by survey and courses and distances from two permanent points, or land marks.

The undersigned well operator is informed and believes there are no coal operators operating beds of coal beneath said farm or tract of land on which said well is located, or within 500 feet of the boundaries of the same, who have mapped their workings and filed their maps as required by law, excepting the coal operators or coal owners (if any) above named as addressees.

The above named coal operators or coal owners (if any) are notified that any objections they may desire to make to such proposed location, or which they are required to make by Section 3 of said Code, if the drilling of a well at said proposed location will cause a dangerous condition in or about their respective coal mines, must be received by, or filed with the Department of Mines within ten* days from the receipt of a copy of this notice and accompanying plat by said Department. Said coal operators are further notified that forms for use in making such objections will be furnished to them by the Department of Mines promptly on request and that all such objections must set forth as definitely as is reasonably possible the ground or grounds on which such objections are based and indicate the direction and distance the proposed location should be moved to overcome same.

(The next paragraph is to be completed only in Department's copy.)
Copies of this notice and the enclosed plat were mailed by registered mail, or delivered to the above named coal operators or coal owners at their above shown respective address _____ day _____ before, or on the same day with the mailing or delivery of this copy to the Department of Mines at Charleston, West Virginia.

Very truly yours,

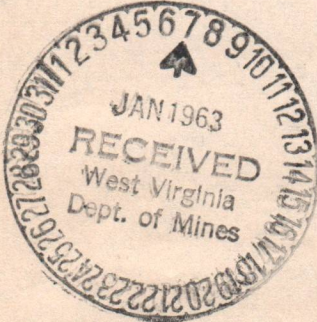

Address of Well Operator }

UNITED FUEL GAS COMPANY
WELL OPERATOR

P. O. Box 1273
STREET

Charleston 25
CITY OR TOWN

West Virginia
STATE

10/27/2023

*Section 3 If no such objections be filed or be found by the department of mines, within said period of ten days from the receipt of said notice and plat by the department of mines, to said proposed location, the department shall forthwith issue to the well operator a drilling permit reciting the filing of such plat, that no objections have been made by the coal operators to the location, or found thereto by the department, and that the same is approved and the well operator authorized to proceed to drill at said location.

1450



STATE OF WEST VIRGINIA
DEPARTMENT OF MINES
OIL AND GAS DIVISION

NOTICE OF PROPOSED LOCATION OF OIL AND GAS WELL

To The Department of Mines,
Charleston, W. Va.

NAME OF WELL OPERATOR: United Fuel Gas Company
ADDRESS: Charleston, W. Va.
COAL OPERATOR OR COAL OWNER: _____
ADDRESS: _____
PROPOSED LOCATION: _____
DATE: January 19 1963
COUNTY: Wayne
TOWN: _____
WELL NO.: 9832

NAME OF WELL OPERATOR: UNITED FUEL GAS CO., MIL. TR. 11
ADDRESS: Charleston, W. Va.
COAL OPERATOR OR COAL OWNER: _____
ADDRESS: _____
PROPOSED LOCATION: _____
DATE: December 1946
COUNTY: _____
TOWN: _____
WELL NO.: _____

The enclosed plat was prepared by a competent engineer and shows the proposed location of a well to be drilled for oil and gas by the undersigned well operator on the land and in the Mineral District and County whose names, determined by survey and corners and distances from two permanent points or land marks.

The undersigned well operator is informed and believes there are no coal operators operating beds of coal beneath said tract of land on which said well is located or within 500 feet of the boundary of the same who have mapped their workings and filed their maps as required by law, extending the coal operators or coal owners (if any) above named an address.

The above named coal operators or coal owners (if any) are notified that any objections they may desire to make to such proposed location, or which they are required to make by Section 3 of said Code, if the drilling of a well at said proposed location will cause a dangerous condition in or about their respective coal mines must be received by or filed with the Department of Mines within ten days from the receipt of a copy of this notice and accompanying plat by said Department. Said coal operators are further notified that copies for use in making such objections will be furnished to them by the Department of Mines promptly on request and that all such objections must set forth as definitely as is reasonably possible the ground or grounds on which such objections are based and indicate the direction and distance the proposed location should be moved to overcome same.

The next paragraph is to be completed only in Department's copy.

Copies of this notice and the enclosed plat were mailed by registered mail to the above named coal operators or coal owners at their above shown respective addresses _____ day _____ before _____ of the same day with the mailing or delivery of this copy to the Department of Mines at Charleston, West Virginia.

Very truly yours,

UNITED FUEL GAS COMPANY
WELL OPERATOR
P. O. Box 1213
Charleston 25
West Virginia

Address of Well Operator

10/27/2023

If no such objections be filed or be found by the department of mines within said period of ten days from the mailing of this notice and plat, the location of the proposed well shall be deemed to be approved and the well operator shall be authorized to proceed to drill the well. If any objections have been filed by the coal operators to the location of said well, the department and that the same is approved and the well operator authorized to proceed to drill the well.

Permit Number: WV-1450

A-10

January 17, 1963

United Fuel Gas Company
P. O. Box 1273
Charleston 25, West Virginia

Att: Mr. Bernard Moon

Gentlemen:

Enclosed is Permit WAY-1450 for drilling Well
No. 9232 on United Fuel Gas Company Mineral Tract #1
Lease, Grant District, Wayne County.

Very truly yours,

Executive Secretary
OIL AND GAS DIVISION

GW/jb
enclosure

cc: Mr. Kenneth E. Butcher, Inspector
Mr. R. C. Tucker, Assistant State
Geologist

10/27/2023

B-2

Formation	Color	Hard or Soft	Top 28	Bottom	Oil, Gas or Water	Depth Found	Remarks
					LOGS RUN: Gamma Ray Density Induction Temperature		
			1000	1000			
			950	950			
			900	900			
			850	850			
			800	800			
			750	750			
			700	700			
			650	650			
			600	600			
			550	550			
			500	500			
			450	450			
			400	400			
			350	350			
			300	300			
			250	250			
			200	200			
			150	150			
			100	100			
			50	50			
			0	0			

10/27/2023

Date July 16, 1963

APPROVED UNITED FUEL GAS COMPANY, Owner

By S. R. Ferrell (Title)

Civil Engineering Department



STATE OF WEST VIRGINIA
DEPARTMENT OF MINES
OIL AND GAS DIVISION 28

Quadrangle Wayne

Permit No. WAY-1450

WELL RECORD

Oil or Gas Well Gas
(KIND)

Company United Fuel Gas Company
Address P.O. Box 1273 Charleston 25, W. Va.
Farm UNITED FUEL GAS CO. MIN. TR. #1 Acres 40,578.86
Location (waters) Rich Creek
Well No. 9232 Elev. 789.67'
District Grant County Wayne
The surface of tract is owned in fee by _____
Address _____
Mineral rights are owned by United Fuel Gas Co.
Address _____
Drilling commenced 5-13-63
Drilling completed 6-1-63
Date Shot _____ From _____ To _____
With _____
Open Flow _____ /10ths Water in _____ Inch
24 /10ths Merc. in 3 Inch
Volume 1,715,000 - Injun Cu. Ft.
Rock Pressure 4 270 lbs. 48 hrs.
Oil _____ bbls., 1st 24 hrs.
WELL ACIDIZED _____
WELL FRACTURED _____

Casing and Tubing	Used in Drilling	Left in Well	Packers
Size			Kind of Packer
16			
13			
10 3/4		23'	Size of
8 5/8		237	
7"	1086'	Pulled	Depth set
5 3/16			
3 1/2	Cemented	1339'	Perf. top
2			Perf. bottom
Liners Used			Perf. top
			Perf. bottom

CASING CEMENTED _____ SIZE _____ No. Ft. _____ Date _____
COAL WAS ENCOUNTERED AT _____ FEET _____ INCHES
_____ FEET _____ INCHES FEET _____ INCHES
_____ FEET _____ INCHES FEET _____ INCHES

RESULT AFTER TREATMENT _____

ROCK PRESSURE AFTER TREATMENT _____

Fresh Water 125 Feet 630 Salt Water _____ Feet

Formation	Color	Hard or Soft	Top	Bottom	Oil, Gas or Water	Depth	Remarks
Surface			0	10			
Sand			10	65	Hole full water	125'	
Slate			65	125	Hole full water	630'	
Sand			125	175			
Slate			175	275	Gas	1131-1135'	2/10 W 1" 15 M
Sand			275	325			
Slate			325	400	Gas	1160-1165'	36/10 W 1" 63 M
Sand			400	450			
Slate			450	525	Gas	1258'	4/10 W 1" 21 M
Sand			525	665			
Slate			665	720	Show oil	1277-1287'	
Sand			720	890			
Slate			890	930	Gas	1300-1315'	54/10 W 1" 77 M
Sand			930	957			
Slate			957	1035	Test	1355'	50/10 W 1" 75 M
Little Lime			1035	1069			
Slate			1069	1071			
Big Lime			1071	1254	Perforated at	1304' and 1305'	with 52 two radial jets.
Dark Shell			1254	1262			
Slate			1262	1266			
Red Injun			1266	1285	Fractured Injun	6-6-63	with 600 bbls. water, 5,200# 10-20 Sand
Gray Injun			1285	1325	Test when shut in	24/10 Merc. 3"	1,715 M
Slate & Shells			1325	1352			
Total Depth			1352'				

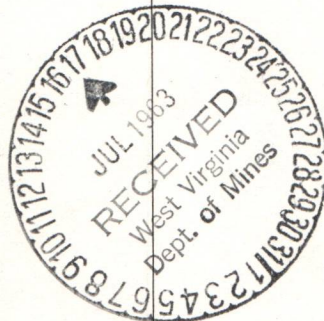

10/27/2023

B-3

UNITED FUEL GAS COMPANY
COMPANY

SERIAL WELL NO. 9232 LEASE NO. Ref. 24689 MAP SQUARE 20-39

RECORD OF WELL NO. <u>9232</u> on the	CASING AND TUBING				TEST BEFORE SHOT <u>Frac.</u>
UFG Co. Min. Tr. #1 farm of <u>40,578.86</u> Acres	SIZE	WEIGHT	USED IN DRILLING	LEFT IN WELL	<u>20</u> /10 of Water in <u>1"</u> inch
in <u>Grant</u> District	<u>10-3/4"</u>	<u>32#</u>	<u>23'</u>	<u>23'</u>	/10 of Merc. in <u> </u> inch
<u>Wayne</u> County	<u>8-5/8"</u>	<u>24#</u>	<u>239'</u>	<u>239'</u>	Volume <u>47</u> MCF Cu. ft.
State of: <u>West Virginia</u>	<u>7"</u>	<u>20#</u>	<u>1086'</u>	<u>None'</u>	TEST AFTER SHOT
Field: <u>Central Division</u>	<u>3-1/2"</u>	<u>7#</u>	<u>1346'</u>	<u>1346'</u>	XXX /10 of Water in <u> </u> inch
Rig Commenced <u>May 10,</u> 19 <u>63</u>					<u>24</u> /10 of Merc. in <u>3"</u> inch
Rig Completed <u>May 13,</u> 19 <u>63</u>					Volume <u>1,715</u> MCF Cu. ft.
Drilling Commenced <u>May 13,</u> 19 <u>63</u>					When Shut In <u> </u> Hours After Shot
Drilling Completed <u>June 1,</u> 19 <u>63</u>					Rock Pressure <u>48 Hr. 270#</u>
Drilling to cost <u> </u> per foot					Date XXX <u>Frac. 6-6-63</u>
Contractor is: <u>M & E Well Service</u>					<u>600 Bbl. Water & 5200#</u>
Address: <u>Hamlin, W. Va.</u>					Size of Torpedo <u>10/20 Sand</u>
					SHUT IN
					Date <u>6-10-63</u>
Driller's Name <u>Halden Moore</u>	<u>3 1/2"</u> in. Tubing				Oil Flowed <u> </u> bbls. 1st 24 hrs.
<u>Noah Buzzard</u>	Size of Packer <u>3-1/2"</u>				Oil Pumped <u> </u> bbls. 1st 24 hrs.
	Kind of Packer <u>Guide Shoe</u>				Well abandoned and
					Plugged <u> </u> 19 <u> </u>
Drilling Permit No. <u>WAY-1450</u>					1st. Perf. Set <u> </u> from <u> </u>
Elevation: <u>789.67'</u>					2nd Perf. Set <u> </u> from <u> </u>

DRILLER'S RECORD

FORMATION	TOP	BOTTOM	THICKNESS	REMARKS
Surface	0	10	10	
Sand	10	65	55	
Slate	65	125	60	Water @ 125' - Hole Full
Sand	125	175	50	
Slate	175	275	100	
Sand	275	325	50	
Slate	325	400	75	
Sand	400	450	50	
Slate	450	525	75	
Sand	525	665	140	Water @ 630' - Hole Full
Slate	665	720	55	
Sand	720	890	170	
Slate	890	930	40	
Sand	930	957	27	
Slate	957	1035	78	
Little Limestone	1035	1069	34	
Slate	1069	1071	2	

APPROVED
[Signature]
DIVISION SUPERINTENDENT

10/27/2023

B-5

FORM U 127-B C S D

June 6, 19 63

Mr. W. B. Osbourn, Supt. Prod. & Storage

Well No. 9232 (Serial No.) on U.F.G. Co. Min. Tr. #1 Farm

Was ~~shot~~ this date with 600 Ebl. Water and 5200# 10/20 Sand quarts

Number of Shells _____

Length of Shells _____

Top of Shot _____

Bottom of Shot _____

Top of Injun Sand Sand 1266 feet
(Name of Sand)

Bottom of Injun Sand Sand 1325 feet
(Name of Sand)

Total Depth of Well 1352'

Results: When Shut In - 2 1/2" M-3" - 1,715 MCF

Remarks: _____

Signed *L. O. Miller* District Supt.

NOTE-When a well is shot this form must be filled out and sent to the General Superintendent.

10/27/2023

OG-11
B-6

STATE OF WEST VIRGINIA
DEPARTMENT OF MINES
OIL AND GAS DIVISION

INSPECTOR'S WELL REPORT

Permit No. Way-1450

Oil or Gas Well _____
(KIND)

Company <u>U. F. S. Co.</u>	CASING AND TUBING	USED IN DRILLING	LEFT IN WELL	PACKERS
	Address <u>Charleston, W. Va.</u>	Size		
Farm <u>U. F. S. Co. Tr. #1</u>	16			
Well No. <u>9232</u>	13			
District <u>Grant</u> County <u>Wayne</u>	10			Size of
Drilling commenced _____	8 1/4			
Drilling completed _____ Total depth _____	6 5/8			Depth set
Date shot _____ Depth of shot _____	5 3/16			
Initial open flow _____ /10ths Water in _____ Inch	3			Perf. top
Open flow after tubing _____ /10ths Merc. in _____ Inch	2			Perf. bottom
Volume _____ Cu. Ft.	Liners Used			Perf. top
Rock pressure _____ lbs. _____ hrs.				Perf. bottom
Oil _____ bbls., 1st 24 hrs.	CASING CEMENTED _____ SIZE _____ No. FT. _____ Date _____			
Fresh water _____ feet _____ feet	COAL WAS ENCOUNTERED AT _____ FEET _____ INCHES			
Salt water _____ feet _____ feet	_____ FEET _____ INCHES FEET _____ INCHES			
	_____ FEET _____ INCHES FEET _____ INCHES			

Drillers' Names _____

Remarks: Road & location completed

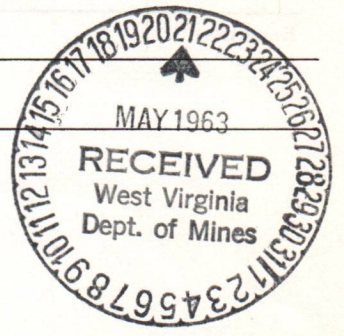

5-17-63
DATE

H. E. Butcher
DISTRICT WELL INSPECTOR
10/27/2023

B-7

STATE OF WEST VIRGINIA
DEPARTMENT OF MINES
OIL AND GAS DIVISION

INSPECTOR'S WELL REPORT

Permit No. Way-1450

Oil or Gas Well _____
(KIND)

		CASING AND TUBING	USED IN DRILLING	LEFT IN WELL	PACKERS
Company	<u>U.F.Y. Co.</u>	Size			Kind of Packer
Address	<u>Charleston, W.Va.</u>	16			
Farm	<u>U.F.Y. Co. tr. #1</u>	13			
Well No.	<u>9232</u>	10			Size of
District	<u>Grant</u> County <u>Wayne</u>	8 1/4			
Drilling commenced	<u>5-13-63</u>	6 5/8			Depth set
Drilling completed		5 3/16			
Date shot		3			Perf. top
Initial open flow		2			Perf. bottom
Open flow after tubing		Liners Used			Perf. top
Volume					Perf. bottom
Rock pressure		CASING CEMENTED	SIZE	No. FT.	Date
Oil					
Fresh water		COAL WAS ENCOUNTERED AT	FEET	INCHES	
Salt water			FEET	INCHES	

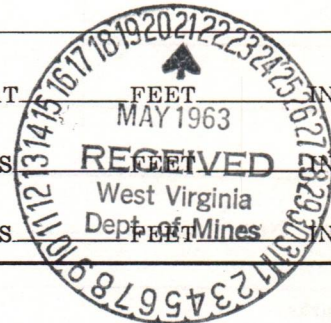

Drillers' Names Maah Buzzard

Remarks: Contr. M.E. Well Service Cable tools
Just started.

5-18-63
DATE

K.E. Butcher
DISTRICT WELL INSPECTOR
10/27/2023

U.S. DEPARTMENT OF ENERGY
Federal Energy Regulatory Commission
Washington, D.C. 20426

**APPLICATION FOR DETERMINATION OF THE MAXIMUM LAWFUL
PRICE UNDER THE NATURAL GAS POLICY ACT (NGPA)**
(Sections 102, 103, 107 and 108)

PLEASE READ BEFORE COMPLETING THIS FORM:

General Instructions:

Complete this form if you are applying for price classification under sections 102, 103, 107 or 108 of the NGPA. A separate application is required for each well. If any reservoir qualifies for a category which differs from the category applicable to the producing well, separate applications must be made for the producing well and the reservoir. Complete each appropriate item on the reverse side of this page. The code numbers used in items 4.0 and 6.0 can be obtained from the Buyer/Seller Code Book. If there is more than one purchaser or contract, identify the additional information in the space below. Enter any additional remarks in the space below.

Submit the completed application to the appropriate Jurisdictional Agency as listed in title 18 of the CFR, part 274.501. If there are any questions, call (202) 275-4539.

Specific Instructions for Item 2.0, Type of Determination:

<u>Section of NGPA</u>	<u>Category Code</u>	<u>Description</u>
102	1	New OCS Lease
102	2	New onshore well (2.5 mile test)
102	3	New onshore well (1,000 feet deeper test)
102	4	New onshore reservoir
102	5	New reservoir on old OCS Lease
103	-	New onshore production well
107	-	High cost natural gas
108	-	Stripper well

Other Purchasers/Contracts:

<u>Contract Date</u> (Mo. Day Yr.)	<u>Purchaser</u>	<u>Buyer Code</u>
_____	_____	_____
_____	_____	_____
_____	_____	_____

Remarks:

3813 99A

C-1

RECEIVED

APR 5 1982

1.0 API well number: (If not assigned, leave blank. 14 digits.)	<u>-47 -099 -01450</u>			OIL & GAS DIVISION
2.0 Type of determination being sought (Use the codes found on the front of this form.)	<u>108</u> Section of NGPA	<u>—</u> Category Code	DEPT. OF MINES	
3.0 Depth of the deepest completion location (Only needed if sections 103 or 107 in 2.0 above.)	<u>N/A</u> feet			
4.0 Name, address and code number of applicant (35 letters per line maximum. If code number not available, leave blank.)	<u>Columbia Gas Transmission Corporation</u> Name		<u>004030</u> Seller Code	
	<u>P. O. Box 1273</u> Street			
	<u>Charleston</u> City	<u>WV</u> State	<u>25325</u> Zip Code	
5.0 Location of this well (Complete (a) or (b).)	<u>W Va. field Area B</u>			
(a) For onshore wells (35 letters maximum for field name.)	<u>Wayne</u> Field Name	<u>WV</u> State		
(b) For OCS wells	<u>N/A</u> Area Name	<u>—</u> Block Number		
	Date of Lease Mo. Day Yr.		<u>—</u> OCS Lease Number	
(c) Name and identification number of this well (35 letters and digits maximum.)	<u>TCO MIN TR #1 809232</u>			
(d) If code 4 or 5 in 2.0 above, name of the reservoir (35 letters maximum.)	<u>N/A</u>			
6.0 (a) Name and code number of the purchaser (35 letters and digits maximum. If code number not available, leave blank.)	<u>*</u> Name	<u>004030</u> Buyer Code		
(b) Date of the contract:	Mo. Day Yr. *			
(c) Estimated total annual production from the well	<u>1</u> Million Cubic Feet			
	(a) Base Price	(b) Tax	(c) All Other Prices (Indicate (+) or (-).)	(d) Total of (a), (b) and (c)
7.0 Contract price (As of filing date. Complete to 3 decimal places.)	S/MMBTU <u>—</u>	<u>—</u>	<u>—</u>	<u>—</u>
8.0 Maximum lawful rate (As of filing date. Complete to 3 decimal places.)	S/MMBTU <u>—</u>	<u>—</u>	<u>—</u>	<u>—</u>
9.0 Person responsible for this application	<u>Albert H. Mathena, Jr., Director, Production Eng.</u>			
Agency Use Only	Name		Title	
Date Received by Juris. Agency	<u>Albert H. Mathena, Jr.</u> Signature			
<u>APR 5 1982</u>	<u>3-25-82</u> Date Application is Completed		<u>(304) 346-0951</u> Phone Number	
Date Received by FERC				

*This is a pipeline production well. No contract exists and no sales are made

10/27/2023

PARTICIPANTS:

DATE: AUG 19 1982

BUYER-SELLER CODE

WELL OPERATOR: Columbia Gas Trans. Corp.

004030

FIRST PURCHASER: X

X

OTHER: _____

W. Va. Department of Mines, Oil & Gas Division
 WELL DETERMINATION FILE NUMBER
820405-108-099-1450
 Use Above File Number on all Communications
 Relating to Determination of this Well

QUALIFIED

CHECK EACH ITEM AS COMPLETE OR NOTE WHAT IS MISSING

- ITEM NO.
1. FERC -121 Items not completed - Line No. All 7.0, 8.0 b,c,d
 2. IV-1 Agent James L. Weekley
 3. IV-2 Well Permit _____
 4. IV-6 Well Plat _____
 5. IV-35 Well Record Drilling Deepening _____
 6. IV-36 Gas-Oil Test: Gas Only _____ Was Oil Produced? _____ Ratio _____
 7. IV-39 Annual Production 4 + 2 Months years
 8. IV-40 90 day Production 91 Days off line: _____
 9. IV-48 Application for certification. Complete?
 - 10-17. IV Form 51 - 52 - 53 - 54 - 55 - (56) - 57 - 58 Complete? Affidavit Signed
 - 18-28. Other: Survey _____ Logs _____ Geological Charts _____
 Structure Map _____ 1: 4000 Map _____ Well Tabulations _____
 Gas Analyses _____
 - (5) Date commenced: 5-13-63 Date completed 6-1-63 Deepened _____
 - (5) Production Depth: 1300-15
 - (5) Production Formation: Gray Injun
 - (5) Final Open Flow: 1715 MCF
 - (5) After Frac. R. P. 270# 48 hrs.
 - (6) Other Gas Test: _____
 - (7) Avg. Daily Gas from Annual Production: $\frac{1272}{363} = 3.5$ MCF
 - (8) Avg. Daily Gas from 90-day ending w/1-120 days $\frac{411}{91} = 4.5$ MCF
 - (8) Line Pressure: NA PSIG from Daily Report
 - (5) Oil Production: yes From Completion Report 1277-78
 - 17. Does lease inventory indicate enhanced recovery being done NO
 - 17. Is affidavit signed? Notarized?
 - Does official well record with the Department confirm the submitted information? NO 10/27/2023
 - Additional information _____ Does computer program confirm? _____
 - Is Determination Objected to _____ By Whom? _____

C-4

Describe the search made of any records listed above:

Are you aware of any other information which would tend to be inconsistent with the information specified above? Yes ___ No ✓. If yes, indicate the type and source of the information.

AFFIDAVIT

I, Albert H. Mathena, Jr., having been first sworn according to law, state that I have caused to be made a diligent search of those records hereinbefore indicated in the manner herein described, that the information contained in this document is true and accurate and that on the basis of the records and examinations hereinbefore described, and to the best of my information, knowledge and belief, the well for which this certification is sought qualifies as a stripper well.

Albert H. Mathena, Jr.

STATE OF WEST VIRGINIA,

COUNTY OF Kanawha, TO WIT:

I, Larry G. Burdette, a Notary Public in and for the state and county aforesaid, do certify that Albert H. Mathena, Jr. whose name is signed to the writing above, bearing date the 25 day of March, 19 82, has acknowledged the same before me, in my county aforesaid.

Given under my hand and official seal this 25 day of March, 19 82

My term of office expires on the 13 day of August, 19 89.

Larry G. Burdette
Notary Public

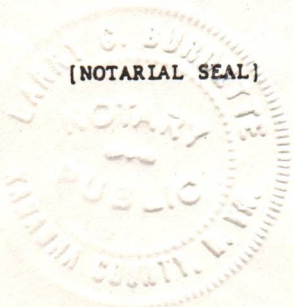

10/27/2023

C-3

STATE OF WEST VIRGINIA
DEPARTMENT OF MINES, OIL AND GAS DIVISION

Date _____ 19__

Operator's Well No. 809232

API Well No. 47 - 099 01450
State County Permit

WELL CLASSIFICATION FORM

STRIPPER GAS WELL
NGPA Section 108

DESIGNATED AGENT James L. Weekley

ADDRESS P. O. Box 1273
Charleston, WV 25325

WELL OPERATOR Columbia Gas Trans. Corp.

ADDRESS P. O. Box 1273
Charleston, WV 25325

LOCATION: Elevation 789

Watershed _____

Dist. Stonewall County Wayne Quad. _____

GAS PURCHASER NA

Gas Purchase Contract No. NA

ADDRESS _____

Meter Chart Code _____

Date of Contract NA

* * * * *

This is a pipeline production well and no gas purchase contract exists.

Provide a complete inventory of the lease and production equipment used for the well for the previous 24 months or, if less than 24 months, the period the well has been in production. Include a complete list of equipment or processes used in connection with recognized enhanced recovery techniques during completion or production. (Attach separate sheets, if necessary.)

NOT REQUIRED PER FERC REGULATIONS

List all records reasonably available to you which contain information relevant to a determination of eligibility (including production records, B&O Tax Records and royalty payment records) and indicate the location of such records:

SEE ATTACHED PRODUCTION SHEETS

(Faint handwritten notes)



Date 3-25, 19 82

Operator's Well No. 809232
API Well No. 47 - 099 - 01450
State County Permit

STATE APPLICATION FOR WELL CLASSIFICATION

Previous File No. _____
(If Applicable)

WELL OPERATOR Columbia Gas Trans. Corp.
ADDRESS P. O. Box 1273
Charleston, W. Va. 25325

DESIGNATED AGENT James L. Weekley
ADDRESS P. O. Box 1273
Charleston, W. Va. 25325

Gas Purchase Contract No. NA* and Date _____
(Month, day and year)

Meter Chart Code _____

Name of First Purchaser NA*

(Street or P. O. Box)

(City) (State) (Zip Code)

FERC Seller Code NA*

FERC Buyer Code NA*

TYPE OF DETERMINATION BEING SOUGHT:

- (1) Initial determination (See FERC Form 121.) Section of NGPA 108
- (2) Determination that increased production is the result of enhanced recovery technology.
- (3) Determination of a seasonally affected well.

Category Code

Production Engineering

*This well is a pipeline production and no gas purchase contract exists.

Albert H. Mathena, Jr., Director-
Name (Print) Title

Albert H. Mathena, Jr.
Signature

P. O. Box 1273
Street or P. O. Box

Charleston, W. Va. 25325
City State (Zip Code)

(304) 346-0951
Area Code Phone Number

(Certificate of Proof of Service to Purchaser)

A copy of this filing is being retained by Columbia Gas Transmission Corporation, owner and operator of the identified well.

(All of the above to be completed by the Operator/Applicant)

(To be completed by Jurisdictional Agency. Executed copy to be returned to Operator/Applicant and purchaser, if known).

The Department of Mines has received a request, for certification of the above described well as meeting the requirements of Section _____ under the Natural Gas Policy Act of 1975 (NGPA); or for determination that increased production is the result of enhanced recovery technology under Section 108 of (NGPA); or for determination of a seasonally affected well under Section 109 of (NGPA).

All interested parties are hereby notified that on the _____ day of _____, 19____, at the office of the Oil and Gas Division in Charleston, West Virginia, or as soon thereafter as it may be heard, there will be a public hearing, if requested, or if objection is filed.

This Application is assigned File No. _____

Initial review of information submitted indicates the well is. is not entitled to certification as claimed under the Natural Gas Policy Act (NGPA). A review of this evidence and any additional evidence will be made at the time appointed for a public hearing or as soon thereafter as the matter may be heard.

Unless objections are timely filed or a request for a hearing is made within fifteen (15) days, a hearing will not be held except on ex parte motion of the department and the matter will go to determination.

WEST VIRGINIA DEPARTMENT OF MINES

APR 5 1982

Date received by _____
Jurisdictional Agency

By [Signature]
Title _____
10/27/2023

C-6

STATE OF WEST VIRGINIA
DEPARTMENT OF MINES
OIL AND GAS DIVISION

INSPECTOR'S WELL REPORT

Permit No. Way-1450

Oil or Gas Well _____
(KIND)

Company	CASING AND TUBING	USED IN DRILLING	LEFT IN WELL	PACKERS
<u>U.F.M. Co.</u>	Size			
<u>Charleston, W.Va.</u>	16			Kind of Packer _____
<u>U.F.M. Co. Tr. #1</u>	13			
<u>Well No. 9232</u>	10			Size of _____
<u>District Grant County Wayne</u>	8 1/4	<u>239'</u>		
<u>Drilling commenced 5-13-63</u>	6 5/8			Depth set _____
<u>Drilling completed _____ Total depth _____</u>	5 3/16			
<u>Date shot _____ Depth of shot _____</u>	3			Perf. top _____
<u>Initial open flow _____ /10ths Water in _____ Inch</u>	2			Perf. bottom _____
<u>Open flow after tubing _____ /10ths Merc. in _____ Inch</u>	Liners Used			Perf. top _____
<u>Volume _____ Cu. Ft.</u>				Perf. bottom _____
<u>Rock pressure _____ lbs. _____ hrs.</u>	CASING CEMENTED _____	SIZE _____	No. FT. _____	Date _____
<u>Oil _____ bbls., 1st 24 hrs.</u>	COAL WAS ENCOUNTERED _____			INCHES _____
<u>Fresh water _____ feet _____ feet</u>	_____ FEET _____ INCHES			INCHES _____
<u>Salt water <u>660 - hole full</u> feet _____ feet</u>	_____ FEET _____ INCHES			INCHES _____

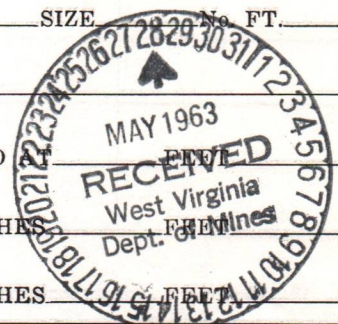

Drillers' Names Maah Buzzard

Remarks: Contr. M.E. Well Service Cable tools
Total depth 815'

5-23-63
DATE

M.E. Butcher
DISTRICT WELL INSPECTOR
10/27/2023

STATE OF WEST VIRGINIA
DEPARTMENT OF MINES
OIL AND GAS DIVISION

C-7

INSPECTOR'S WELL REPORT

Permit No. Way-1450

Oil or Gas Well _____
(KIND)

Company	CASING AND TUBING	USED IN DRILLING	LEFT IN WELL	PACKERS
<u>U.F.M. Co.</u>	Size			
<u>Charles Ton, W.Va.</u>	16			Kind of Packer
<u>U.F.M. Co. tr. 1</u>	13			
<u>9232</u>	10			Size of
<u>Grant County Wayne</u>	8 1/4			
<u>5-13</u>	6 5/8	<u>1088'</u>		Depth set
	5 3/16			
	3			Perf. top
	2			Perf. bottom
	Liners Used			Perf. top
				Perf. bottom
	CASING CEMENTED	SIZE	No. FT.	Date
	COAL WAS ENCOUNTERED AT			
		FEET	INCHES	FEET
		FEET	INCHES	FEET
		FEET	INCHES	FEET

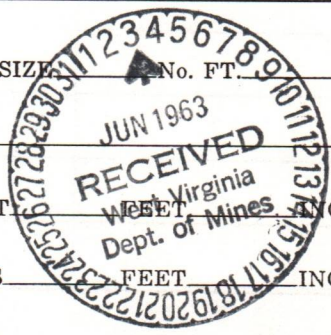

Drillers' Names Moah Buzard

M.E. Well Service Co total depth 1100

Remarks: Checked because they were running 7" pipe.

5-31-63

DATE

H.E. Butcher

DISTRICT WELL INSPECTOR

10/27/2023

REPORT DATE FEB 16, 1982
REPORT TIME 13.31

COLUMBIA GAS TRANSMISSION CORPORATION
N.G.P.A. SECTION 108
APPLICATION FOR WELL CLASSIFICATION

PAGE 4623

API WELL NO. 47-099-01450

WELL NUMBER : 809232G
FARM NAME : TCO MIN TR NO 1

PRODUCING UNIT	STATE	LEASE	MEAS. STA. NUMBER	WELL COUNT	THREE MONTH MCF/DAY	DATE MMY	DAYS ON LINE	VOLUME -100- PERCENT	MCF/DAY -100- PERCENT	LINE PRES. PSIA
809232G	WV	1E		1.000000	3.2	1278	30	26	9	67
809232G				1.000000		1178	31	135	4.4	75
809232G				1.000000		1078	30	131	4.4	66
809232G				1.000000		0978	29	125	4.3	82
809232G				1.000000		0878	31	135	4.4	60
809232G				1.000000		0778	30	132	4.4	56
809232G				1.000000		0678	31	137	4.4	55
809232G				1.000000		0578	30	133	4.4	51
809232G				1.000000		0478	31	137	4.4	52
809232G				1.000000		0378	28	122	4.4	45
809232G				1.000000		0278	31	132	4.3	47
809232G				1.000000		0178	31	130	4.2	49

10/27/2023

REPORT DATE FEB 16, 1982
 REPORT TIME 15.28

COLUMBIA GAS TRANSMISSION CORPORATION
 N.G.P.A. SECTION 108
 APPLICATION FOR WELL CLASSIFICATION

PAGE 4623

API WELL NO. 47-099-0145D

WELL NUMBER : 809232G
 FARM NAME : TCO MIN TR NO 1

PRODUCING UNIT	STATE	LEASE	MEAS. STA. NUMBER	WELL COUNT	THREE MONTH MCF/DAY	DATE MMY	DAYS ON LINE	VOLUME -100- PERCENT	MCF/DAY -100- PERCENT	LINE PRES. PSIA
809232G	WV	1E		1.000000	.9	1279	30	26	.9	63
809232G				1.000000		1179	31	27	.9	68
809232G				1.000000		1079	28	24	.9	77
809232G				1.000000		0979	31	27	.9	68
809232G				1.000000		0879	31	136	4.4	74
809232G				1.000000		0779	30	130	4.3	76
809232G				1.000000		0679	31	129	4.3	84
809232G				1.000000		0579	30	129	.9	76
809232G				1.000000		0479	31	27	.9	59
809232G				1.000000		0379	28	122	4.4	46
809232G				1.000000		0279	31	136	4.4	49
809232G				1.000000		0179	31	27	.9	48

10/27/2023

REPORT DATE FEB 16, 1982
 REPORT TIME 14.08

COLUMBIA GAS TRANSMISSION CORPORATION
 N.G.P.A. SECTION 108
 APPLICATION FOR WELL CLASSIFICATION

PAGE 4623

API WELL NO. 47-099-01450--

WELL NUMBER : 809232G
 FARM NAME : TCO MIN TR NO 1

PRODUCING UNIT	STATE	LEASE	MEAS. STA. NUMBER	WELL COUNT	THREE MONTH MCF/DAY	DATE MMY	DAYS ON LINE	VOLUME -100- PERCENT	MCF/DAY -100- PERCENT	LINE PRES. PSIA
809232G	WV	1E		1.000000	1.8	1280	30	26	.9	59
809232G				1.000000		1180	11	48	4.4	64
809232G				1.000000		1080	0	0	.0	0
809232G				1.000000		0980	0	0	.0	0
809232G				1.000000		0880	0	0	.0	0
809232G				1.000000		0780	0	0	.0	0
809232G				1.000000		0680	5	5	1.0	56
809232G				1.000000		0580	30	26	.9	75
809232G				1.000000		0480	31	27	.9	53
809232G				1.000000		0380	29	25	.9	62
809232G				1.000000		0280	31	27	.9	53
809232G				1.000000		0180	31	136	4.4	64

*Compressor Down
 off to manage supply*

10/27/2023

REPORT DATE FEB 16, 1982
 REPORT TIME 14.57

COLUMBIA GAS TRANSMISSION CORPORATION
 N.G.P.A. SECTION 108
 APPLICATION FOR WELL CLASSIFICATION

PAGE 4524

API WELL NO. 47-099-01450

WELL NUMBER : 809232G
 FARM NAME : TCO MIN TR NO 1

PRODUCING UNIT	STATE	LEASE	MEAS. STA. NUMBER	WELL COUNT	THREE MONTH MCF/DAY	DATE MMY	DAYS ON LINE	VOLUME -100- PERCENT	MCF/DAY -100- PERCENT	LINE PRES. PSIA
809232G	WV	1E		1.000000	4.5	1281	30	135	4.5	58
809232G				1.000000		1181	31	139	4.5	59
809232G				1.000000		1081	30	137	4.6	59
809232G				1.000000		0981	29	131	4.5	60
809232G				1.000000		0881	31	141	4.5	61
809232G				1.000000		0781	30	134	4.5	61
809232G				1.000000		0681	31	137	4.4	65
809232G				1.000000		0581	30	133	4.4	67
809232G				1.000000		0481	31	55	1.8	57
809232G				1.000000		0381	28	49	1.8	54
809232G				1.000000		0281	31	54	1.7	55
809232G				1.000000		0181	31	27	.9	55

10/27/2023

REPORT DATE MAR 25, 1982
REPORT TIME 10.26

COLUMBIA GAS TRANSMISSION CORPORATION
N.G.P.A. SECTION 108
APPLICATION FOR WELL CLASSIFICATION

PAGE1351

API WELL NO. ~~47-099-0450~~

WELL NUMBER : 809232G
FARM NAME : TCO MIN TR NO 1

PRODUCING UNIT	STATE	LEASE	MEAS. STA. NUMBER	WELL COUNT	THREE MONTH MCF/DAY	DATE MMY	DAYS ON LINE	VOLUME -100- PERCENT	MCF/DAY -100- PERCENT	LINE PRES. PSIA
809232G	WV	1E		1.000000	4.5	0282	31	140	4.5	53
809232G				1.000000		0182	31	139	4.5	54

10/27/2023

Latitude 38° 05'

Longitude 82° 20'

U. F. G. CO. MIN.

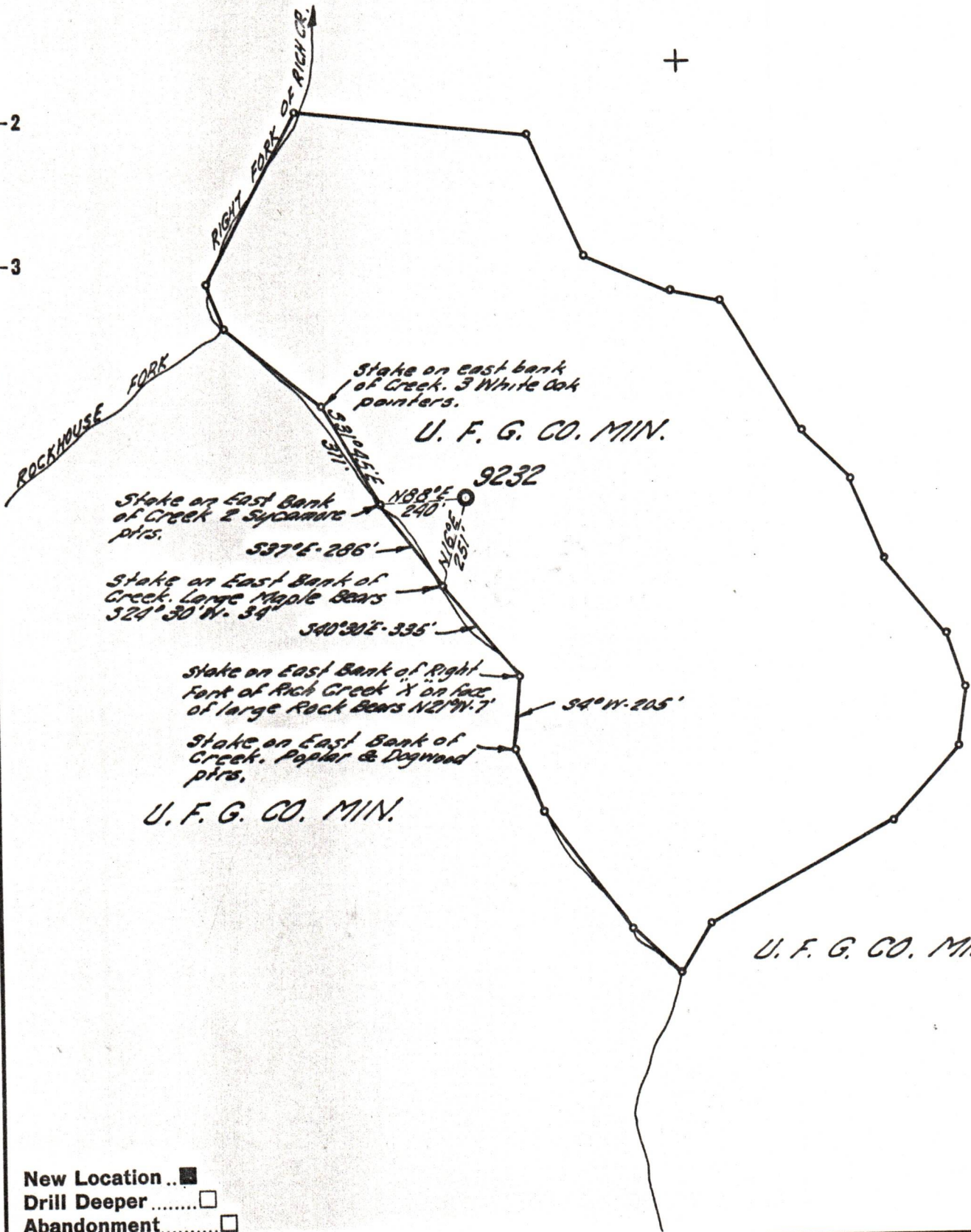

- New Location...
- Drill Deeper.....
- Abandonment.....

Company UNITED FUEL GAS CO.
 Address CHARLESTON, W.VA.
 Farm UNITED FUEL GAS CO. MIN.
 Tract 1 Acres 40.578 ^{86 REF} 24689 Lease No. 24689
 Well (Farm) No. _____ Serial No. 9232
 Elevation (Spirit Level) 789.67'
 Quadrangle WAYNE
 County WAYNE District GRANT
 Engineer Paul E. Roach
 Engineer's Registration No. 66.9
 File No. 20-39 Drawing No. _____
 Date 12-26-62 Scale 1" = 400'

STATE OF WEST VIRGINIA
 DEPARTMENT OF MINES
 OIL AND GAS DIVISION
 CHARLESTON

WELL LOCATION MAP

FILE NO. WAY-11057/2023

+ Denotes location of well on United States Topographic Maps, scale 1 to 62,500, latitude and longitude lines being represented by border lines as shown.

- Denotes one inch spaces on border line of original tracing.