



STATE OF WEST VIRGINIA
DEPARTMENT OF MINES
OIL AND GAS DIVISION

NOTICE OF PROPOSED LOCATION OF OIL AND GAS WELL

To THE DEPARTMENT OF MINES,
Charleston, W. Va.

COAL OPERATOR OR COAL OWNER

ADDRESS

COAL OPERATOR OR COAL OWNER

ADDRESS

United Fuel Gas Co.

OWNER OF MINERAL RIGHTS

ADDRESS

United Fuel Gas Company

NAME OF WELL OPERATOR

Charleston, W. Va.

COMPLETE ADDRESS

September 26, 19 62

PROPOSED LOCATION

Lincoln District

Wayne County

38° 05'

Well No. 9233 82° 20' E 80 3.16'

UNITED FUEL GAS CO. MINERAL Farm

6,473 acres

GENTLEMEN:

The undersigned well operator is entitled to drill upon the above named farm or tract of land for oil and gas, having fee title thereto, (or as the case may be) under grant or lease dated February 15, 1926, made by Ray Coffman, et ux, to The Old Colony Oil & Gas Co., and recorded on the 26th day of August 1926, in the office of the County Clerk for said County in Book 148, page 87.

The enclosed plat was prepared by a competent engineer and shows the proposed location of a well to be drilled for oil and gas by the undersigned well operator on the farm and in the Magisterial District and County above named, determined by survey and courses and distances from two permanent points, or land marks.

The undersigned well operator is informed and believes there are no coal operators operating beds of coal beneath said farm or tract of land on which said well is located, or within 500 feet of the boundaries of the same, who have mapped their workings and filed their maps as required by law, excepting the coal operators or coal owners (if any) above named as addressees.

The above named coal operators or coal owners (if any) are notified that any objections they may desire to make to such proposed location, or which they are required to make by Section 3 of said Code, if the drilling of a well at said proposed location will cause a dangerous condition in or about their respective coal mines, must be received by, or filed with the Department of Mines within ten* days from the receipt of a copy of this notice and accompanying plat by said Department. Said coal operators are further notified that forms for use in making such objections will be furnished to them by the Department of Mines promptly on request and that all such objections must set forth as definitely as is reasonably possible the ground or grounds on which such objections are based and indicate the direction and distance the proposed location should be moved to overcome same.

(The next paragraph is to be completed only in Department's copy.)

Copies of this notice and the enclosed plat were mailed by registered mail, or delivered to the above named coal operators or coal owners at their above shown respective address _____ day _____ before, or on the same day with the mailing or delivery of this copy to the Department of Mines at Charleston, West Virginia.

Very truly yours,

UNITED FUEL GAS COMPANY

WELL OPERATOR

P. O. Box 1273

STREET

Charleston 25

CITY OR TOWN

West Virginia

STATE

10/27/2023

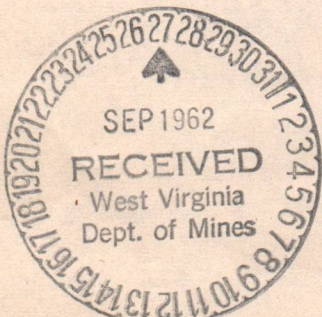

Address of Well Operator }

*Section 3 If no such objections be filed or be found by the department of mines, within said period of ten days from the receipt of said notice and plat by the department of mines, to said proposed location, the department shall forthwith issue to the well operator a drilling permit reciting the filing of such plat, that no objections have been made by the coal operators to the location, or found thereto by the department, and that the same is approved and the well operator authorized to proceed to drill at said location.

1446

WAY-1446

PERMIT NUMBER

A-10

UNION CARBIDE OLEFINS COMPANY • DIVISION OF



CORPORATION

P. O. BOX 8004, SOUTH CHARLESTON, WEST VIRGINIA

October 3, 1962

Mr. Seybert R. Ferrell
United Fuel Gas Company
P. O. Box 1273
Charleston, West Virginia

Dear Mr. Ferrell:

The location of the United Fuel Gas Company well No. 9239 on the Blue Creek Coal and Land Company property of Union Carbide Corporation appears satisfactory. The Stockton-Lewiston, Coalburg; and No. 2 Gas coal seams, with elevations between 870 and 940 feet; 785 feet and 885 feet; and 600 and 700 feet, respectively, are minable coal seams and should be protected as specified in Section 5, Article 4, Chapter 22 of the Code of the Oil and Gas Laws of the State of West Virginia.

Very truly yours,

John W. Heimaster
Bore Mining Department

/spm

cc: Mrs. M. E. Griffith ←
Oil and Gas Division
W. Va. Dept. of Mines



10/27/2023

CORPORATION



UNION CARBIDE OLEFINS COMPANY • DIVISION OF

P. O. BOX 8004, SOUTH CHARLESTON, WEST VIRGINIA

October 3, 1965

Mr. Seybert R. Ferrell
United Fuel Gas Company
P. O. Box 1273
Charleston, West Virginia

Dear Mr. Ferrell:

The location of the United Fuel Gas Company well No. 9239 on the Blue Creek Coal and Land Company property of Union Carbide Corporation appears satisfactory. The Stockton-Lawston, Coalburg and No. 2 Gas coal seams, with elevations between 870 and 940 feet; 785 feet and 865 feet; and 600 and 780 feet, respectively, are minable coal seams and should be protected as specified in Section 5, Article 4, Chapter 22 of the Code of the Oil and Gas Laws of the State of West Virginia.

Very truly yours,

John W. Holmster
John W. Holmster
Data Mining Department

Yspn

cc: Mrs. M. E. Griffin
Oil and Gas Division
W. Va. Dept. of Mines

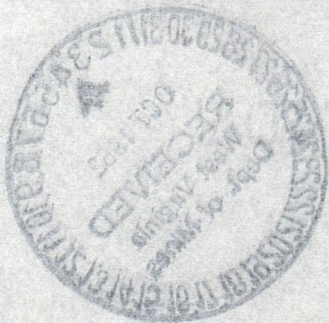

10/27/2023

A-11

October 8, 1962
"Centennial '63"

United Fuel Gas Company
P. O. Box 1273
Charleston 25, West Virginia

Att: Mr. Bernard Moon

Gentlemen:

Enclosed are permits for drilling the following wells:

<u>PERMIT NO.</u>	<u>WELL NO.</u>	<u>FARM</u>	<u>DISTRICT</u>
KAN-1916	9239	Blue Creek Coal & Land Company	Elk
WAY-1446	9233	United Fuel Gas Company Mineral	Lincoln

Very truly yours,

Executive Secretary
OIL AND GAS DIVISION

GW/jb
enclosure

cc: Mr. Dana Lawson, Inspector

Mr. Kenneth E. Butcher, Inspector

Mr. R. C. Tucker, Assistant
State Geologist

A-12

UNITED FUEL GAS COMPANY

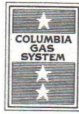

ADDRESS REPLY TO
POST OFFICE BOX 1273
CHARLESTON 25, WEST VIRGINIA

March 18, 1963

State of West Virginia
Department of Mines
Oil & Gas Division
Charleston, West Virginia

Gentlemen:

Please reinstate Drilling Permit No. WAY-1446,
Well No. 9233, United Fuel Gas Co. Mineral Lease, in the
County of Wayne, Lincoln District, which expired February 8,
1963.

Very truly yours,

A handwritten signature in cursive script that reads "S. R. Ferrell".

S. R. Ferrell, Superintendent
Civil Engineering Department

SRF:wr



10/27/2023

UNITED FUEL GAS COMPANY

March 15, 1903

State of West Virginia
Department of Mines
Office of Gas Division
Charleston, West Virginia

I hereby certify that the following is a true and correct copy of the original as filed in my office on the 15th day of March, 1903, in the County of Boone, Lincoln District, which original is hereby certified to be a true and correct copy of the original as filed in my office on the 15th day of March, 1903.

S. B. Powell, Superintendent



Formation	Color	Hard or Soft	Top	Bottom	Oil, Gas or Water	Depth Found	Remarks
			1100	1100			
			1050	1050			
			1000	1000			
			950	950			
			900	900			
			850	850			
			800	800			
			750	750			
			700	700			
			650	650			
			600	600			
			550	550			
			500	500			
			450	450			
			400	400			
			350	350			
			300	300			
			250	250			
			200	200			
			150	150			
			100	100			
			50	50			
			0	0			

10/27/2023

Date June 24, 19 63
 APPROVED UNITED FUEL GAS COMPANY, Owner
 By S. H. Ferrell
 (Title)
 Supt., Civil Engineering Dept.



STATE OF WEST VIRGINIA
DEPARTMENT OF MINES
OIL AND GAS DIVISION

Quadrangle Wayne

Permit No. WAY-1446

WELL RECORD

Oil or Gas Well Gas
(KIND)

Company United Fuel Gas Company
Address P.O. Box 1273 Charleston 25, W. Va.
Farm United Fuel Gas Co. Mineral Acres 6473
Location (waters) West Fork of 12 Pole Creek
Well No. 9233 Elev. 803.16
District Lincoln County Wayne
The surface of tract is owned in fee by _____
Address _____
Mineral rights are owned by United Fuel Gas Co.
Address Charleston, W. Va.
Drilling commenced 4-23-63
Drilling completed 5-23-63
Date Shot _____ From _____ To _____
With _____
Open Flow 46 /10ths Water in _____ Inch
3 /10ths Merc. in _____ Inch
Volume 2,374,000 - Injun Cu. Ft.
Rock Pressure 470 lbs. 70 hrs.
Oil _____ bbls., 1st 24 hrs.
WELL ACIDIZED _____
WELL FRACTURED _____

Casing and Tubing	Used in Drilling	Left in Well	Packers
Size			Kind of Packer
16			
13			
10 <u>3/4</u>		<u>30'</u>	Size of
<u>8 5/8</u>		<u>209</u>	
<u>6 7/8</u>	<u>1195'</u>	<u>Pulled</u>	Depth set
<u>5 3/16</u>			
<u>3 1/2</u>	<u>Cemented</u>	<u>1443'</u>	Perf. top
<u>2</u>			Perf. bottom
Liners Used			Perf. top
			Perf. bottom

CASING CEMENTED _____ SIZE _____ No. Ft. _____ Date _____
COAL WAS ENCOUNTERED AT 173 FEET 24 INCHES
_____ FEET _____ INCHES FEET _____ INCHES
_____ FEET _____ INCHES FEET _____ INCHES

RESULT AFTER TREATMENT

ROCK PRESSURE AFTER TREATMENT

Fresh Water 45 Feet Salt Water _____ Feet

Formation	Color	Hard or Soft	Top	Bottom	Oil, Gas or Water	Depth	Remarks
Clay			0	4	Water 45'		
Sand			4	45			
Slate			45	110	Show gas 604;		
Sand			110	173			
Coal			173	175	Show gas 1276'		
Sand			175	200			
Slate			200	255	Cored from 1353-1409'		
Sand			255	290			
Slate			290	350	Perforated from 1385-1388' with two radial jets.		
Sand			350	375			
Slate			375	425			
Sand			425	450	Fractured Injun 5-29-63 with 586 bbls. water, 11,000# 10-20 mesh sand.		
Slate			450	565	Test when shut in 46/10 Merc. 3"		
Sand			565	725	2,374 M		
Slate & Shells			725	745			
Sand			745	1074			
Slate			1074	1090			
Red Rock			1090	1095	FINAL OPEN FLOW - 2,374 M Injun		
Slate			1095	1100	70 Hr. R.P. 470#		
Lime			1100	1115			
Sand			1115	1127	Shut in 5-31-63 in 3 1/2" tubing.		
Little Lime			1127	1168			
Big Lime			1168	1346	LOGS RUN:		
Slate			1346	1348	Gamma Ray		
Red Injun			1348	1376	Density		
Gray Injun			1376	1406	Induction		
Slate & Shells			1406	1443	Temperature		
Total Depth			1443'				

(over)

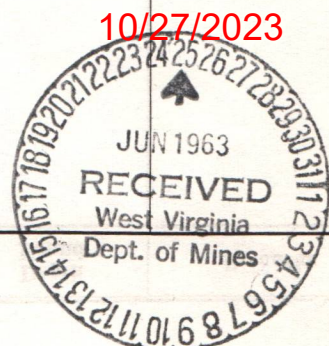

STATE OF WEST VIRGINIA
DEPARTMENT OF MINES
OIL AND GAS DIVISION

INSPECTOR'S WELL REPORT

Permit No. WAY-1446

Oil or Gas Well _____
(KIND)

Company	CASING AND TUBING	USED IN DRILLING	LEFT IN WELL	PACKERS
<u>U.F.M. Co.</u>	Size			Kind of Packer
Address <u>Charleston, W.Va.</u>	16			
Farm <u>U.F.M. Co.</u>	13			
Well No. <u>9233</u>	10			Size of
District <u>Lincoln</u> County <u>Wayne</u>	8 1/4	<u>209-</u>		
Drilling commenced <u>April, 23</u>	6 5/8	<u>1195-</u>		Depth set
Drilling completed _____ Total depth _____	5 3/16			
Date shot _____ Depth of shot _____	3			Perf. top
Initial open flow _____ /10ths Water in _____ Inch	2			Perf. bottom
Open flow after tubing _____ /10ths Merc. in _____ Inch	Liners Used			Perf. top
Volume _____ Cu. Ft.				Perf. bottom
Rock pressure _____ lbs. _____ hrs.	CASING CEMENTED _____ SIZE _____ No. FT. _____ Date _____			
Oil _____ bbls., 1st 24 hrs.	COAL WAS ENCOUNTERED AT _____ FEET _____ INCHES			
Fresh water <u>40-</u> feet <u>hole full</u> feet	_____ FEET _____ INCHES			
Salt water <u>630-</u> feet <u>hole full</u> feet	_____ FEET _____ INCHES			

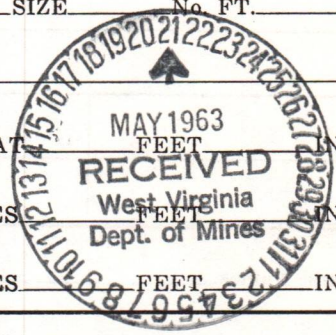

Drillers' Names Halden Moore

Remarks: Contr. M.E. Well Service Cable tools
Total Depth 1195-

5-13-63
DATE

M.E. Butcher
DISTRICT WELL INSPECTOR
10/27/2023

STATE OF WEST VIRGINIA
DEPARTMENT OF MINES
OIL AND GAS DIVISION

INSPECTOR'S WELL REPORT

Permit No. Way-1446

Oil or Gas Well _____
(KIND)

Company	CASING AND TUBING	USED IN DRILLING	LEFT IN WELL	PACKERS
<u>U.F.G. Co.</u>				
Address <u>Charleston, W. Va.</u>	Size			
Farm <u>U.F.G. Co.</u>	16			Kind of Packer
Well No. <u>9233</u>	13			
District <u>Lincoln</u> County <u>Wayne</u>	10			Size of
Drilling commenced <u>4-23-63</u>	8 1/4			
Drilling completed <u>5-23</u> Total depth <u>1439'</u>	6 5/8			Depth set
Date shot _____ Depth of shot _____	5 3/16			
Initial open flow _____ /10ths Water in _____ Inch	3			Perf. top
Open flow after tubing _____ /10ths Merc. in _____ Inch	2			Perf. bottom
Volume _____ Cu. Ft.	Liners Used			Perf. top
Rock pressure _____ lbs. _____ hrs.				Perf. bottom
Oil _____ bbls., 1st 24 hrs.	CASING CEMENTED _____ SIZE _____ No. FT. _____ Date _____			
Fresh water _____ feet _____ feet	COAL WAS ENCOUNTERED AT _____ FEET _____ INCHES			
Salt water _____ feet _____ feet	_____ FEET _____ INCHES			

Other information has been reported,

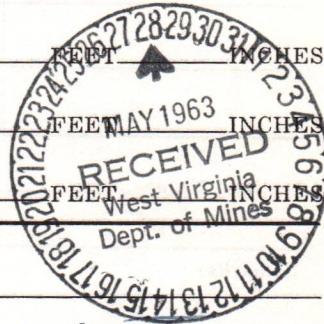

Drillers' Names Halden Moore

Contr. M.E. Well Service Cable Tools

Remarks: They were drilled in gun sand (1353 to 1409') for test purposes - Plan to sand - frac.

5-20-63
DATE

H.E. Butcher
DISTRICT WELL INSPECTOR

10/27/2023

STATE OF WEST VIRGINIA
DEPARTMENT OF MINES
OIL AND GAS DIVISION

INSPECTOR'S WELL REPORT

Permit No. Way-1446

Oil or Gas Well Gas
(KIND)

Company	CASING AND TUBING	USED IN DRILLING	LEFT IN WELL	PACKERS
<u>U.F.S. Co.</u>				
Address <u>Charleston, W. Va.</u>	Size			
Farm <u>U.F.S. Co.</u>	16			Kind of Packer
Well No. <u>9233</u>	13			Size of
District <u>Lincoln</u> County <u>Wayne</u>	10			
Drilling commenced <u>4-18</u> app.	8 1/4			Depth set
Drilling completed <u>5-14</u> app. Total depth <u>1443</u>	6 5/8			
<u>sand-frac</u> Date shot _____ Depth of shot <u>1387</u>	5 3/16			Perf. top
<u>Single point entry</u>	3			Perf. bottom
Initial open flow _____ /10ths Water in _____ Inch	2			Perf. top
Open flow after tubing _____ /10ths Merc. in _____ Inch				Perf. bottom
Volume <u>1,400,000</u> after frac. Cu. Ft.	Liners Used			
Rock pressure _____ lbs. _____ hrs.	CASING CEMENTED _____ SIZE _____ FT. _____ Date _____			
Oil _____ bbls., 1st 24 hrs.	COAL WAS ENCOUNTERED _____ INCHES			
Fresh water _____ feet _____ feet	_____ FEET _____ INCHES			
Salt water _____ feet _____ feet	_____ FEET _____ INCHES			

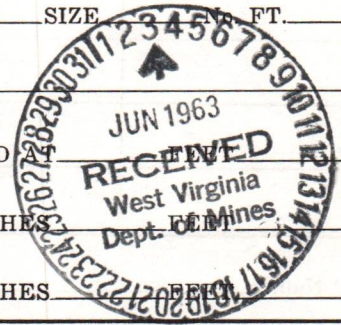

Drillers' Names Halden Moore

Remarks: Contr. M.E. Well Service, Cable tools

(Maxine Perkins) ↑
Material used, 560 bbl. water + 11,000 lb. sand
Work performed by Dow Chemical Co.

5-29-63

DATE

H. E. Butcher

DISTRICT WELL INSPECTOR

10/27/2023

E-6

March 19, 1963
"Centennial Year"

United Fuel Gas Company
P. O. Box 1273
Charleston 25, West Virginia

Att: Mr. Bernard Moon

Gentlemen:

In compliance with your request of March 18,
we have reinstated your Permit WAY-1446 for drilling
Well No. 9233 on the United Fuel Gas Company Mineral
Lease, Lincoln District, Wayne County.

Very truly yours,

Assistant Director
OIL AND GAS DIVISION

MG/jb

cc: Mr. Kenneth Butcher, Inspector

10/27/2023

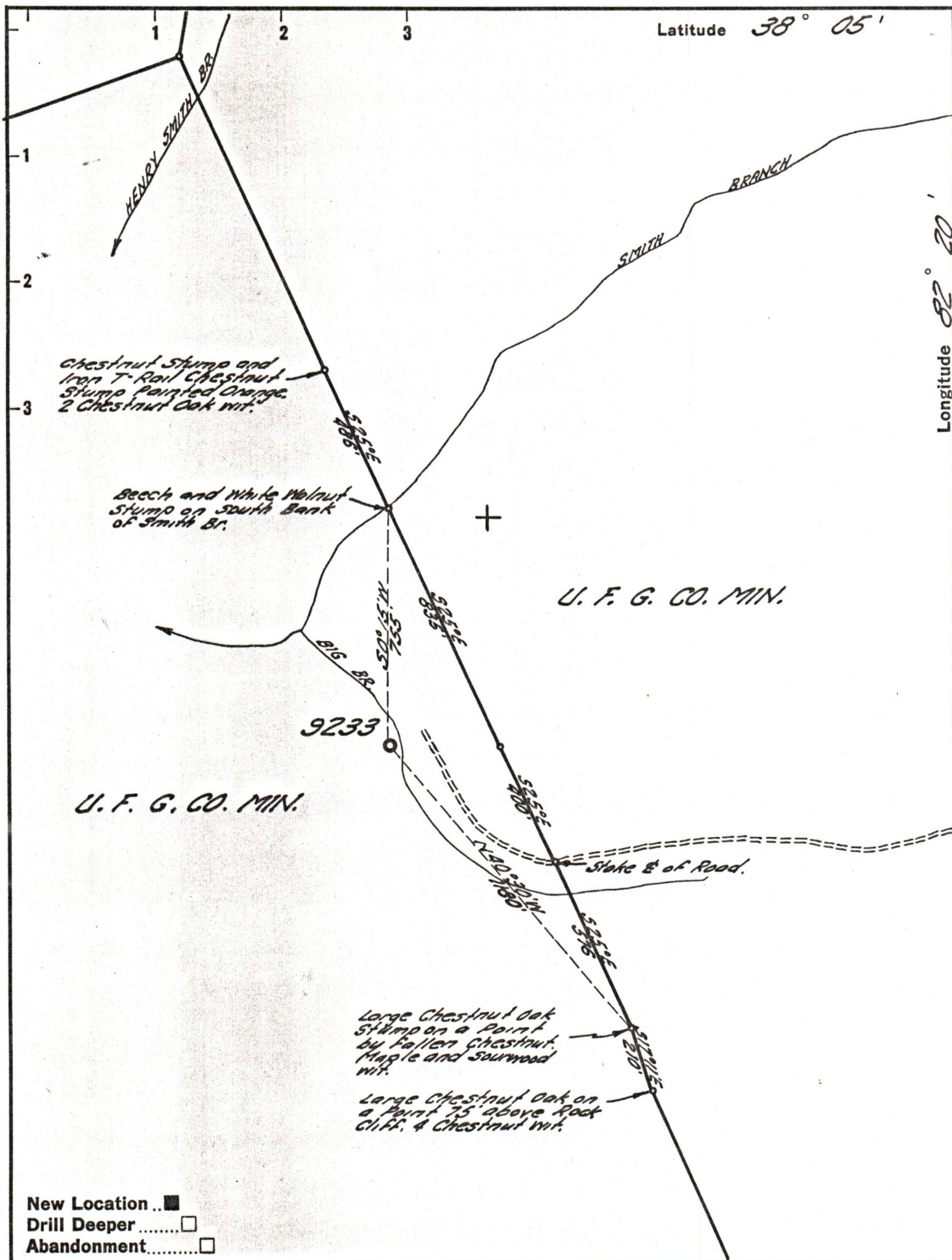

Company UNITED FUEL GAS CO.
 Address CHARLESTON, W. VA.
 Farm UNITED FUEL GAS CO. MIN.
 Tract _____ Acres 6.473 DEED Lease No. 35723
 Well (Farm) No. _____ Serial No. 9233
 Elevation (Spirit Level) 803.16'
 Quadrangle WAYNE
 County WAYNE District LINCOLN
 Engineer Seybert R. Ferrell
 Engineer's Registration No. 2529
 File No. 20-37 Drawing No. _____
 Date 8-30-62 Scale 1" = 400'

STATE OF WEST VIRGINIA
 DEPARTMENT OF MINES
 OIL AND GAS DIVISION
 CHARLESTON

WELL LOCATION MAP
 FILE NO. WAY-1476 10/27/2023

+ Denotes location of well on United States Topographic Maps, scale 1 to 62,500, latitude and longitude lines being represented by border lines as shown.

- Denotes one inch spaces on border line of original tracing.