

A-10.

September 27, 1962
"Centennial '63"

United Fuel Gas Company
P. O. Box 1273
Charleston 25, West Virginia

Att: Mr. Bernard Moon

Gentlemen:

Enclosed are permits for drilling the following wells:

<u>PERMIT NO.</u>	<u>WELL NO.</u>	<u>FARM</u>	<u>DISTRICT</u>
KAN-1909	9230	Blue Creek Coal & Land Co.	Elk
WAY-1444	9229	United Fuel Gas Co. Min. Tr. #1	Lincoln

Very truly yours,

Executive Secretary
OIL AND GAS DIVISION

GW/jb
enclosure

cc: Mr. Dana Lawson, Inspector

Mr. Kenneth E. Butcher, Inspector

Mr. R. C. Tucker, Assistant State
Geologist



STATE OF WEST VIRGINIA
DEPARTMENT OF MINES
OIL AND GAS DIVISION

Quadrangle Wayne
Permit No. WAY-1444

WELL RECORD

Oil or Gas Well Gas
(KIND)

Company United Fuel Gas Company
Address P.O. Box 1273 Charleston 25, W. Va.
Farm United Fuel Gas Co. Min. Tr. #1 Acres 13,672.82
Location (waters) Lost Creek
Well No. 9229 Elev. 669.99'
District Lincoln County Wayne
The surface of tract is owned in fee by United Fuel Gas Co.
Address _____
Mineral rights are owned by _____
Address _____
Drilling commenced 10-6-62
Drilling completed 10-28-62
Date Shot _____ From _____ To _____
With _____
Open Flow _____ /10ths Water in _____ Inch
12 /10ths Merc. in 2 Inch
Volume 539,000 - Injun Cu. Ft.
Rock Pressure 490 lbs. 48 hrs.
Oil _____ bbls., 1st 24 hrs.
WELL ACIDIZED _____
WELL FRACTURED _____

Casing and Tubing	Used in Drilling	Left in Well	Packers
Size			Kind of Packer _____
16			
13		15'	Size of _____
10 3/4		292	Depth set _____
8 1/2 5/8	1137'	Pulled	
6 7/8			
5 3/16			
3 1/2	Cemented	1295'	Perf. top _____
2			Perf. bottom _____
Liners Used			Perf. top _____
			Perf. bottom _____

CASING CEMENTED _____ SIZE _____ No. Ft. _____ Date _____
COAL WAS ENCOUNTERED AT _____ FEET _____ INCHES
_____ FEET _____ INCHES FEET _____ INCHES
_____ FEET _____ INCHES FEET _____ INCHES

RESULT AFTER TREATMENT
ROCK PRESSURE AFTER TREATMENT
Fresh Water 22 Feet 630 Salt Water _____ Feet _____

Formation	Color	Hard or Soft	Top	Bottom	Oil, Gas or Water	Depth	Remarks
Surface			0	13			
Sand			13	70	Hole full water 22'; 630'		
Slate			70	94			
Sand			94	112	Show gas 1248-1258'		
Slate			112	130			
Sand			130	145	Frac notch cut at 1249-1250'		
Slate			145	256			
Sand			256	287	Test before fracture - show.		
Slate			287	390	Fractured Injun 112 11-2-62 with 900		
Sand			390	410	bbls. water and 57,000# sand.		
Slate			410	512	Final open flow 12/10 Merc. 2" 539 M		
Sand			512	625			
Water Sand			625	648			
Sand			648	665	Shut in 11-6-62 in 3 1/2" tubing		
Slate			665	683			
Sand			683	890			
Slate			890	907	LOGS RUN:		
Sand			907	912	Gamma Ray		
Slate			912	940	Density		
Sand			940	997			
Slate			997	999			
Little Lime			999	1021			
Big Lime			1021	1195			
Injun Sand			1195	1282			
Broken Sand			1282	1300			
Slate			1300	1320			
Total Depth			1320'				

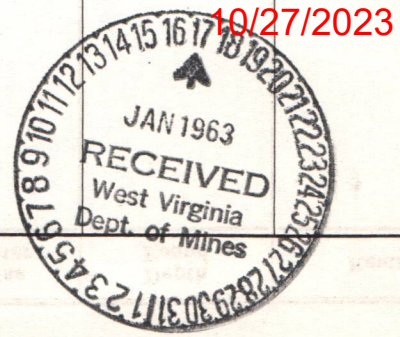

B-1

STATE OF WEST VIRGINIA
DEPARTMENT OF MINES
OIL AND GAS DIVISION

INSPECTOR'S WELL REPORT

Permit No. Way-1444

Oil or Gas Well _____
(KIND)

Company	CASING AND TUBING	USED IN DRILLING	LEFT IN WELL	PACKERS
<u>U.F.M. Co. Tr. 1</u>	Size			Kind of Packer _____
<u>Charles town wa.</u>	16			Size of _____
<u>U.F.M. Co. Tr. 1</u>	13			Depth set _____
<u>9229</u>	10			Perf. top _____
<u>Lincoln County Wayne</u>	8 1/4	<u>294'</u>		Perf. bottom _____
<u>Oct. 6-62</u>	6 5/8	<u>1137'</u>		Perf. top _____
Drilling commenced _____	5 3/16			Perf. bottom _____
Drilling completed _____	3			
Date shot _____	2			
Initial open flow _____	Liners Used			
Open flow after tubing _____				
Volume _____	CASING CEMENTED _____	SIZE _____	No. FT. _____	Date _____
Rock pressure _____				
Oil _____	COAL WAS ENCOUNTERED AT _____	FEET _____	INCHES _____	
Fresh water <u>35'</u>	_____	FEET _____	INCHES _____	
Salt water <u>625'</u>	_____	FEET _____	INCHES _____	

Drillers' Names Halden Moore

Remarks: E. G. E. Minis

Coal tools
Total depth 1145'

10-25-62
DATE

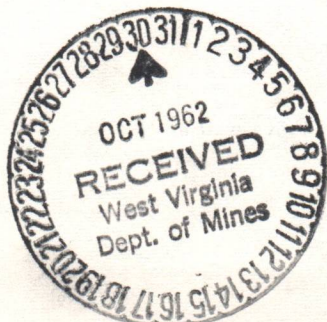

H. E. Butcher
DISTRICT WELL INSPECTOR

10/27/2023

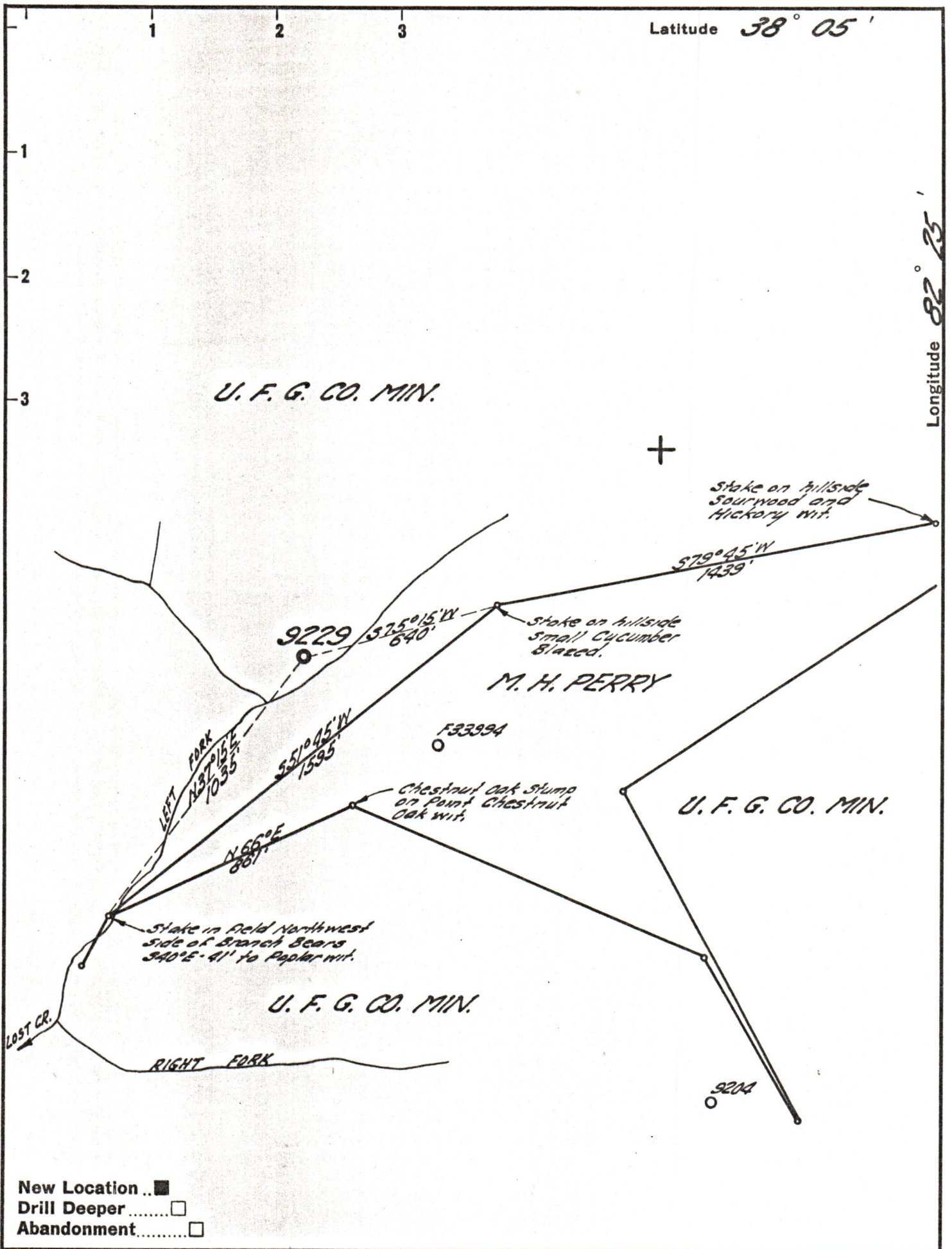

Latitude $38^{\circ} 05'$

Longitude $82^{\circ} 25'$

U. F. G. CO. MIN.



Stake on hillside Saurwood and Hickory wit.

$579^{\circ}45'W$
1439'

Stake on hillside Small cucumber Blaced.

M. H. PERRY

F33994

U. F. G. CO. MIN.

Chestnut Oak Stump on Point Chestnut Oak wit.

$551^{\circ}45'W$
1593'

$466^{\circ}E$
987'

LEFT FORK
 $N37^{\circ}15'E$
1035'

Stake in field Northwest side of Branch Bears $340^{\circ}E-41'$ to Poplar wit.

U. F. G. CO. MIN.

RIGHT FORK

9204

- New Location ..
- Drill Deeper
- Abandonment

Company UNITED FUEL GAS CO.
 Address CHARLESTON, W. VA.
 Farm UNITED FUEL GAS CO. MIN.
 Tract 1 Acres 13672.82 Lease No. NO REF.
 Well (Farm) No. _____ Serial No. 9229
 Elevation (Spirit Level) 669.99'
 Quadrangle WAYNE
 County WAYNE District LINCOLN
 Engineer Seybert R. Ferrell
 Engineer's Registration No. 2529
 File No. 16-37 Drawing No. _____
 Date 8-14-62 Scale 1" = 400'

STATE OF WEST VIRGINIA
 DEPARTMENT OF MINES
 OIL AND GAS DIVISION
 CHARLESTON

WELL LOCATION MAP
 FILE NO. WAY-1444 10/27/2023

+ Denotes location of well on United States Topographic Maps, scale 1 to 62,500, latitude and longitude lines being represented by border lines as shown.

- Denotes one inch spaces on border line of original tracing.