



STATE OF WEST VIRGINIA  
DEPARTMENT OF MINES  
OIL AND GAS DIVISION

NOTICE OF PROPOSED LOCATION OF OIL AND GAS WELL

To THE DEPARTMENT OF MINES,  
Charleston, W. Va.

COAL OPERATOR OR COAL OWNER	<u>United Fuel Gas Company</u>
ADDRESS	NAME OF WELL OPERATOR <u>Charleston, West Virginia</u>
COAL OPERATOR OR COAL OWNER	COMPLETE ADDRESS <u>May 1, 1962</u>
ADDRESS	PROPOSED LOCATION <u>Lincoln</u> District
<u>United Fuel Gas Company</u>	<u>Wayne</u> County
OWNER OF MINERAL RIGHTS	Well No. <u>9201</u> <u>38° 05'</u> <u>82° 25' E 688.08'</u>
<u>Charleston, W. Va.</u>	<u>United Fuel Gas Co. Min. Tr. #1</u> Farm <u>13,672.82 Acres</u>
ADDRESS	

GENTLEMEN:

The undersigned well operator is entitled to drill upon the above named farm or tract of land for oil and gas, having fee title thereto, (or as the case may be) under grant or lease dated December 26, 1946, made by Huntington Development & Gas Co., to United Fuel Gas Co., and recorded on the 27th day of December 1946, in the office of the County Clerk for said County in Book 234, page 318.

The enclosed plat was prepared by a competent engineer and shows the proposed location of a well to be drilled for oil and gas by the undersigned well operator on the farm and in the Magisterial District and County above named, determined by survey and courses and distances from two permanent points, or land marks.

The undersigned well operator is informed and believes there are no coal operators operating beds of coal beneath said farm or tract of land on which said well is located, or within 500 feet of the boundaries of the same, who have mapped their workings and filed their maps as required by law, excepting the coal operators or coal owners (if any) above named as addressees.

The above named coal operators or coal owners (if any) are notified that any objections they may desire to make to such proposed location, or which they are required to make by Section 3 of said Code, if the drilling of a well at said proposed location will cause a dangerous condition in or about their respective coal mines, must be received by, or filed with the Department of Mines within ten\* days from the receipt of a copy of this notice and accompanying plat by said Department. Said coal operators are further notified that forms for use in making such objections will be furnished to them by the Department of Mines promptly on request and that all such objections must set forth as definitely as is reasonably possible the ground or grounds on which such objections are based and indicate the direction and distance the proposed location should be moved to overcome same.

(The next paragraph is to be completed only in Department's copy.)

Copies of this notice and the enclosed plat were mailed by registered mail, or delivered to the above named coal operators or coal owners at their above shown respective address \_\_\_\_\_ day \_\_\_\_\_ before, or on the same day with the mailing or delivery of this copy to the Department of Mines at Charleston, West Virginia.

Very truly yours,

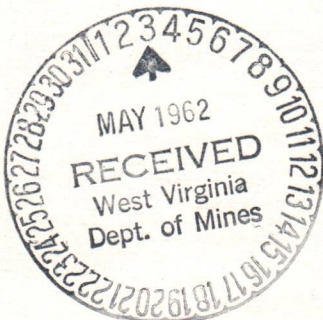

Address of Well Operator }

UNITED FUEL GAS COMPANY  
WELL OPERATOR  
P. O. Box 1273  
STREET  
Charleston 25  
CITY OR TOWN  
West Virginia  
STATE

10/27/2023

\*Section 3 . . . . If no such objections be filed or be found by the department of mines, within said period of ten days from the receipt of said notice and plat by the department of mines, to said proposed location, the department shall forthwith issue to the well operator a drilling permit reciting the filing of such plat, that no objections have been made by the coal operators to the location, or found thereto by the department, and that the same is approved and the well operator authorized to proceed to drill at said location.

1422



B-2



STATE OF WEST VIRGINIA  
DEPARTMENT OF MINES  
CHARLESTON

May 14, 1962  
"Centennial '63"

C  
O  
P  
Y

United Fuel Gas Company  
P. O. Box 1273  
Charleston 25, West Virginia

Att: Mr. Bernard Moon

Gentlemen:

Enclosed are permits for drilling the following wells:

<u>PERMIT NO.</u>	<u>WELL NO.</u>	<u>FARM</u>	<u>DISTRICT</u>
HARDY-3	9058-T	Anna Baughman, et al	South Fork
KAN-1865	9194	Georges Creek Land & Mining	Malden
KAN-1866	9180	David Ward	Cabin Creek
WAY-1421	9197	U.F. Gas Co. Min. Tr. #1	Lincoln
WAY-1422	9201	U.F. Gas Co. Min. Tr. #1	Lincoln
WAY-1423	9204	U.F. Gas Co. Min. Tr. #1	Lincoln
WAY-1424	9198	U.F. Gas Co. Min. Tr. #1	Lincoln

Very truly yours,

Assistant Director  
OIL AND GAS DIVISION

MG/jb  
enclosure

cc: Mr. Andrew Casto  
Mr. Dana Lawson, Inspector  
Mr. Kenneth E. Butcher, Inspector  
  
Mr. R. C. Tucker, Assistant State  
Geologist

10/27/2023





STATE OF WEST VIRGINIA  
 DEPARTMENT OF MINES  
 CHARLESTON

May 14, 1902  
 "Continental" No. 1

COPY

Division of Geology  
 P. O. Box 1212  
 Charleston 25, West Virginia

Dear Mr. Bennett:

Enclosed

are reports for drilling the following wells:

WELL NO.	DATE	DEPTH	LOCATION
WAY-1021	1901-2	100	U.S. Geo. Surv. Sta. 41
WAY-1022	1901	100	U.S. Geo. Surv. Sta. 42
WAY-1023	1901	100	U.S. Geo. Surv. Sta. 43
WAY-1024	1901	100	U.S. Geo. Surv. Sta. 44
WAY-1025	1901	100	U.S. Geo. Surv. Sta. 45
WAY-1026	1901	100	U.S. Geo. Surv. Sta. 46
WAY-1027	1901	100	U.S. Geo. Surv. Sta. 47
WAY-1028	1901	100	U.S. Geo. Surv. Sta. 48

Very truly yours,

Assistant Director  
 OLD AND GAR RIVERS

REPLY  
 Enclosure

Mr. E. C. Fisher, Assistant State Geologist  
 Mr. Kenneth E. Sullivan, Inspector  
 Mr. John Lammie, Inspector  
 Mr. Andrew Gault







B-1



STATE OF WEST VIRGINIA  
DEPARTMENT OF MINES  
OIL AND GAS DIVISION

Quadrangle Wayne

WELL RECORD

Permit No. WAY-1422

Oil or Gas Well Gas  
(KIND)

Company United Fuel Gas Company  
Address P.O. Box 1273; Charleston 25, W. Va.  
Farm United Fuel Gas Co. Min. Tr. #1 Acres 13,672.82  
Location (waters) Right Fork of Lost Creek  
Well No. 9201 Elev. 688.08'  
District Lincoln County Wayne  
The surface of tract is owned in fee by \_\_\_\_\_  
Address \_\_\_\_\_  
Mineral rights are owned by United Fuel Gas Co.  
Address \_\_\_\_\_  
Drilling commenced 8-3-62  
Drilling completed 10-23-62  
Date Shot \_\_\_\_\_ From \_\_\_\_\_ To \_\_\_\_\_  
With \_\_\_\_\_  
Open Flow \_\_\_\_\_ /10ths Water in \_\_\_\_\_ Inch  
7 /10ths Merc. in 4 Inch  
Volume 1,639,000 - Injun Cu. Ft.  
Rock Pressure 460 lbs. 48 hrs.  
Oil \_\_\_\_\_ bbls., 1st 24 hrs.  
WELL ACIDIZED \_\_\_\_\_  
WELL FRACTURED \_\_\_\_\_

Casing and Tubing	Used in Drilling	Left in Well	Packers
Size			Kind of Packer
16			
13			
10 <u>3/4</u>		<u>10'</u>	Size of
8 <u>5/8</u>		<u>260</u>	
6 <u>7"</u>	<u>1150'</u>	<u>Pulled</u>	Depth set
5 <u>3/16</u>			
4 <u>1/2</u>	<u>Cemented</u>	<u>1316'</u>	Perf. top
2			Perf. bottom
Liners Used			Perf. top
			Perf. bottom

CASING CEMENTED \_\_\_\_\_ SIZE \_\_\_\_\_ No. Ft. \_\_\_\_\_ Date \_\_\_\_\_  
COAL WAS ENCOUNTERED AT 170 FEET 48 INCHES  
\_\_\_\_\_ FEET \_\_\_\_\_ INCHES FEET \_\_\_\_\_ INCHES  
\_\_\_\_\_ FEET \_\_\_\_\_ INCHES FEET \_\_\_\_\_ INCHES

RESULT AFTER TREATMENT \_\_\_\_\_  
ROCK PRESSURE AFTER TREATMENT \_\_\_\_\_  
Fresh Water \_\_\_\_\_ Feet Salt Water \_\_\_\_\_ Feet

Formation	Color	Hard or Soft	Top	Bottom	Oil, Gas or Water	Depth	Remarks
Surface			0	10	Gas	1180'	10/10 W 2" 133 M
Sand			10	62			
Slate			62	90	Oil	1187'	250' in 6" hole
Sand			90	120			
Slate			120	133	Gas	1276-1284'	2/10 W 2" 26 60 M
Sand			133	170			
Coal			170	174	Perforated	4 1/2"	casing at 1276-1282' with 13 shots.
Slate			174	245			
Lime			245	250			
Sand			250	259	Test before fracture	2/10 W 2" 60 M	
Slate			259	273	Fractured	Injun 10-26-62	with 25,000# sand, 450 bbls. water and 500 gallons mud acid.
Sand			273	429			
Slate			429	505			
Sand			505	685	Final open flow when shut in	7/10 Merc. 4" 1,639 M	
Slate			685	693			
Lime			693	730			
Sand			730	824			
Lime			824	865	Shut in	10-30-62	in 4 1/2" casing.
Sand			865	885			
Lime			885	910			
Sand			910	1040	LOGS RUN:		
Lime			1040	1054	Gamma Ray		
Big Lime			1054	1229	Neutron		
Injun Sand			1229	1309	Density		
Slate & Shells			1309	1321	Induction		
Total Depth			1321'				

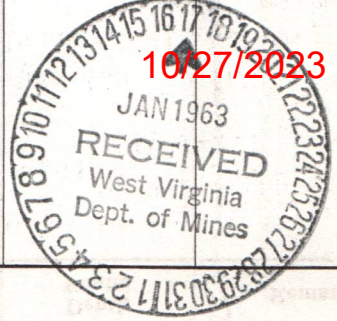



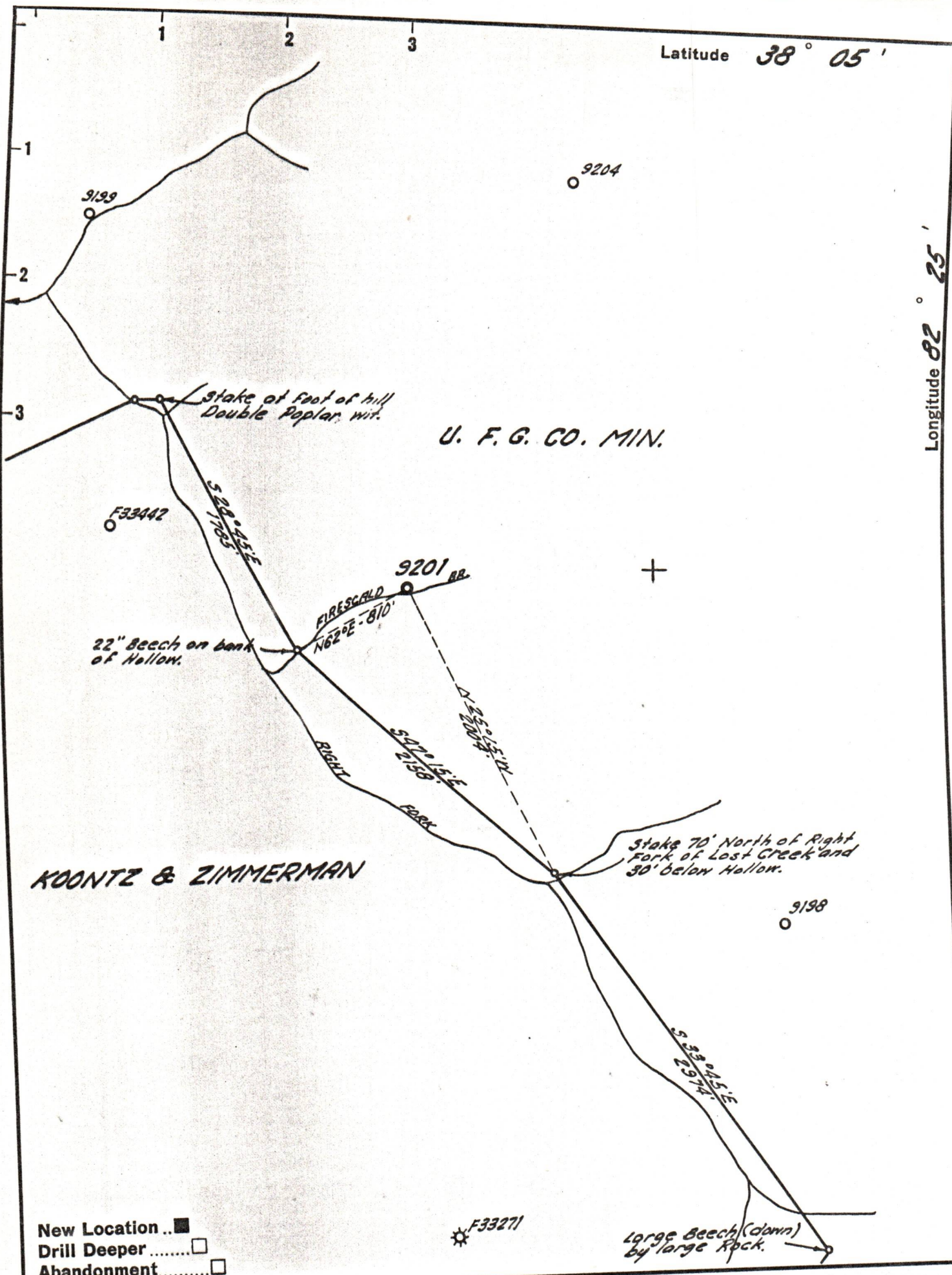

New Location   
 Drill Deeper   
 Abandonment

Company UNITED FUEL GAS CO.  
 Address CHARLESTON, W. VA.  
 Farm UNITED FUEL GAS CO. MIN.  
 Tract 1 Acres 13672.82 Lease No. NO REF.  
 Well (Farm) No. \_\_\_\_\_ Serial No. 9201  
 Elevation (Spirit Level) 688.08'  
 Quadrangle WAYNE  
 County WAYNE District LINCOLN  
 Engineer Sybert R. Herrell  
 Engineer's Registration No. 2529  
 File No. 16-35 Drawing No. \_\_\_\_\_  
 Date 4-3-62 Scale 1" = 800'

STATE OF WEST VIRGINIA  
 DEPARTMENT OF MINES  
 OIL AND GAS DIVISION  
 CHARLESTON

**WELL LOCATION MAP**  
 FILE NO. WAYNE 1422 10/27/2023

+ Denotes location of well on United States Topographic Maps, scale 1 to 62,500, latitude and longitude lines being represented by border lines as shown.  
 - Denotes one inch spaces on border line of original tracing.