

A-1



STATE OF WEST VIRGINIA  
DEPARTMENT OF MINES  
OIL AND GAS DIVISION

NOTICE OF PROPOSED LOCATION OF OIL AND GAS WELL

To THE DEPARTMENT OF MINES,  
Charleston, W. Va.

|                             |   |
|-----------------------------|---|
| _____                       | <u>United Fuel Gas Company</u>                                    |
| COAL OPERATOR OR COAL OWNER | NAME OF WELL OPERATOR   |
| _____                       | <u>Charleston, West Virginia</u>                                  |
| ADDRESS                     | COMPLETE ADDRESS  |
| _____                       | <u>February 26</u> , 19 <u>62</u>                                 |
| COAL OPERATOR OR COAL OWNER | PROPOSED LOCATION   |
| _____                       | <u>Grant</u> District   |
| ADDRESS                     | <u>Wayne</u> County   |
| <u>United Fuel Gas Co.</u>  | Well No. <u>9151</u> <u>38° 00'</u> <u>82° 15' E</u> <u>787.0</u> |
| OWNER OF MINERAL RIGHTS     | <u>United Fuel Gas Co. Min.Tr.#1</u> Farm                         |
| <u>Charleston, W. Va.</u>   | <u>40, 578.86 Acres</u>   |
| ADDRESS                     |   |

GENTLEMEN:

The undersigned well operator is entitled to drill upon the above named farm or tract of land for oil and gas, having fee title thereto, (or as the case may be) under grant or <sup>deed</sup> lease dated December 26, 1946, made by Huntington Development & Gas Co., to United Fuel Gas Co., and recorded on the 27th day of December 1946, in the office of the County Clerk for said County in Book 234, page 318.

The enclosed plat was prepared by a competent engineer and shows the proposed location of a well to be drilled for oil and gas by the undersigned well operator on the farm and in the Magisterial District and County above named, determined by survey and courses and distances from two permanent points, or land marks.

The undersigned well operator is informed and believes there are no coal operators operating beds of coal beneath said farm or tract of land on which said well is located, or within 500 feet of the boundaries of the same, who have mapped their workings and filed their maps as required by law, excepting the coal operators or coal owners (if any) above named as addressees.

The above named coal operators or coal owners (if any) are notified that any objections they may desire to make to such proposed location, or which they are required to make by Section 3 of said Code, if the drilling of a well at said proposed location will cause a dangerous condition in or about their respective coal mines, must be received by, or filed with the Department of Mines within ten\* days from the receipt of a copy of this notice and accompanying plat by said Department. Said coal operators are further notified that forms for use in making such objections will be furnished to them by the Department of Mines promptly on request and that all such objections must set forth as definitely as is reasonably possible the ground or grounds on which such objections are based and indicate the direction and distance the proposed location should be moved to overcome same.

(The next paragraph is to be completed only in Department's copy.)

Copies of this notice and the enclosed plat were mailed by registered mail, or delivered to the above named coal operators or coal owners at their above shown respective address \_\_\_\_\_ day \_\_\_\_\_ before, or on the same day with the mailing or delivery of this copy to the Department of Mines at Charleston, West Virginia.

Very truly yours,

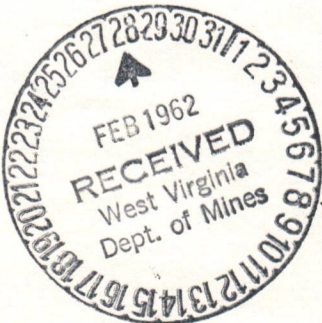

Address of Well Operator }

UNITED FUEL GAS COMPANY  
WELL OPERATOR

Charleston 25 P.O. Box 1273  
STREET

West Virginia  
CITY OR TOWN **10/27/2023**

STATE

\*Section 3 . . . . If no such objections be filed or be found by the department of mines, within said period of ten days from the receipt of said notice and plat by the department of mines, to said proposed location, the department shall forthwith issue to the well operator a drilling permit reciting the filing of such plat, that no objections have been made by the coal operators to the location, or found thereto by the department, and that the same is approved and the well operator authorized to proceed to drill at said location.

1399



STATE OF WEST VIRGINIA  
DEPARTMENT OF MINES  
OF OIL AND GAS DIVISION

NOTICE OF PROPOSED LOCATION OF OIL AND GAS WELL

In the presence of three  
Commissioners

United Fuel Gas Company

Charleston, West Virginia

February 20, 1940

Grant

Wojcie

United Fuel Gas Co.

Charleston, W. Va.

United Fuel Gas Co., Min. Div.

Huntington Development & Gas Co.

United Fuel Gas Co.

December 1940

313

234



10/27/2023

UNITED FUEL GAS COMPANY

Charleston 27, P.O. Box 12173

West Vir. Div.

A-10



STATE OF WEST VIRGINIA  
DEPARTMENT OF MINES  
CHARLESTON

March 10, 1962  
"Centennial '63"

C  
O  
P  
Y

United Fuel Gas Company  
P. O. Box 1273  
Charleston 25, West Virginia

Att: Mr. Bernard Moon

Gentlemen:

Enclosed are permits for drilling the following wells:

| PERMIT NO. | WELL NO. | FARM                            | DISTRICT |
|------------|----------|---------------------------------|----------|
| WAY-1399   | 9151     | United Fuel Gas Co. Min. Tr. #1 | Grant    |
| WAY-1400   | 9152     | United Fuel Gas Co. Min. Tr. #1 | Grant    |

Very truly yours,

Assistant Director  
OIL AND GAS DIVISION

NG/mc  
enclosure

cc: Mr. Kenneth E. Butcher, Inspector

Mr. R. C. Tucker, Assistant  
State Geologist



STATE OF WEST VIRGINIA  
 DEPARTMENT OF MINES  
 CHARLESTON

March 10, 1965  
 Charleston, W. Va.

476

COPY

United Fuel Gas Company  
 P. O. Box 1273  
 Charleston 25, West Virginia  
 Attn: Mr. Bernard Egan  
 Gentlemen:

Enclosed are permits for drilling the following wells:

| PERMIT NO. | WELL NO. | FAIRY                           | DISTRICT |
|------------|----------|---------------------------------|----------|
| WAY-1333   | 9151     | United Fuel Gas Co. Min. Tr. VI | Grant    |
| WAY-1100   | 9152     | United Fuel Gas Co. Min. Tr. VI | Grant    |

Very truly yours,

Assistant Director  
 OIL AND GAS DIVISION

WJ/ac  
 enclosure

cc: Mr. Kenneth E. Butcher, Inspector

Mr. R. C. Tucker, Assistant  
 State Geologist



STATE OF WEST VIRGINIA  
DEPARTMENT OF MINES  
OIL AND GAS DIVISION 24

Quadrangle Naugatuck

Permit No. WAY-1399

WELL RECORD

Oil or Gas Well Gas  
(KIND)

Company United Fuel Gas Company  
Address P. O. Box 1273; Charleston 25, W. Va.  
Farm United Fuel Gas Co. Min. Tr. #1 Acres 40,578.86  
Location (waters) East Fork  
Well No. 9151 Elev. 787.02  
District Grant County Wayne  
The surface of tract is owned in fee by \_\_\_\_\_  
Address \_\_\_\_\_  
Mineral rights are owned by United Fuel Gas Co.  
Address Charleston, W. Va.

Drilling commenced March 30, 1962  
Drilling completed May 12, 1962  
Date Shot 5-14-62 From \_\_\_\_\_ To \_\_\_\_\_  
With \_\_\_\_\_

Open Flow /10ths Water in \_\_\_\_\_ Inch  
\_\_\_\_\_ /10ths Merc. in \_\_\_\_\_ Inch  
Volume 353 M - B. Im. & Inj. 146 M & Shale 207 M Cu. Ft.  
Rock Pressure 355 lbs. 48 hrs.  
Oil 270 bbls., 1st 24 hrs.

WELL ACIDIZED \_\_\_\_\_  
WELL FRACTURED \_\_\_\_\_

RESULT AFTER TREATMENT \_\_\_\_\_

ROCK PRESSURE AFTER TREATMENT \_\_\_\_\_

Fresh Water 60 Feet Salt Water 1135 Feet

| Casing and Tubing | Used in Drilling | Left in Well | Packers               |
|-------------------|------------------|--------------|-----------------------|
| Size              |                  |              | Kind of Packer        |
| 16                |                  |              | Hookwall              |
| 13                |                  |              | Anchor                |
| 10 3/4            |                  | 33'          | Size of _____ x _____ |
| 8 1/2 5/8         |                  | 265          | 2-3/8" x 7"           |
| 7 3/8             | 1393'            | Pulled       | 2-3/8" x 4 1/2"       |
| 5 3/16            |                  |              | Depth set             |
| 4 1/2             |                  | 1673         | 1670                  |
| 2 3/8             |                  | 1438         | 1662                  |
|                   |                  | 1662         | Perf. top             |
|                   |                  |              | Perf. bottom          |
|                   |                  |              | Perf. top             |
|                   |                  |              | Perf. bottom          |

CASING CEMENTED \_\_\_\_\_ SIZE \_\_\_\_\_ No. Ft. \_\_\_\_\_ Date \_\_\_\_\_

COAL WAS ENCOUNTERED AT 57 FEET 36 INCHES  
178 FEET 36 INCHES FEET INCHES  
FEET INCHES FEET INCHES

| Formation      | Color | Hard or Soft | Top  | Bottom | Oil, Gas or Water  | Depth               | Remarks            |
|----------------|-------|--------------|------|--------|--|---------------------|--------------------|
| Clay           |       |              | 0    | 32     | Water 60'  |                     |                    |
| Sand           |       |              | 32   | 57     |  |                     |                    |
| Coal           |       |              | 57   | 60     | Salt water   | 1135'               | 3 bailers per hour |
| Sand           |       |              | 60   | 178    |  |                     |                    |
| Coal           |       |              | 178  | 181    | Show gas & oil   | 1435'               |                    |
| Slate          |       |              | 181  | 191    |  |                     |                    |
| Sand           |       |              | 191  | 203    | Gas  | 1533-1539'          | 12/10 W 1" 37 M    |
| Slate          |       |              | 203  | 247    |  |                     |                    |
| Sand           |       |              | 247  | 260    | Test at top of Shale   | 4/10 W 1" 21 M      |                    |
| Slate          |       |              | 260  | 275    |  |                     |                    |
| Sand           |       |              | 275  | 310    | Gas  | 3000-3012'          | 8/10 W 1" 30 M     |
| Slate          |       |              | 310  | 460    |  |                     |                    |
| Sand           |       |              | 460  | 475    | Test   | 3209'               | 6/10 W 1" 26 M     |
| Slate          |       |              | 475  | 525    |  |                     |                    |
| Broken Sand    |       |              | 525  | 610    | Test before shot   | 5/10 W 1" 24 M      |                    |
| Slate          |       |              | 610  | 640    | Shot 5-14-62 with 7,000# Armstrong Gelatin and 2,100# DuPont Gelatin from 2151-3209' |                     |                    |
| Sand           |       |              | 640  | 690    | Test 1 hour after shot   | 9/10 Merc. 2" 467 M |                    |
| Slate          |       |              | 690  | 700    | Test 18 hrs. after shot  | 9/10 W 2" 127 M     |                    |
| Sand           |       |              | 700  | 738    |  |                     |                    |
| Slate          |       |              | 738  | 830    | Perforated at 1588-1604', 2 shots/foot   |                     |                    |
| Salt Sand      |       |              | 830  | 967    |  |                     |                    |
| Slate          |       |              | 967  | 995    |  |                     |                    |
| Broken Sand    |       |              | 995  | 1050   |  |                     |                    |
| Hard Sand      |       |              | 1050 | 1109   |  |                     |                    |
| Slate          |       |              | 1109 | 1130   | Fractured Injun 5-17-62 with 468 bbls. water and 25,000# 20-40 sand                  |                     |                    |
| Broken Sand    |       |              | 1130 | 1250   |  |                     |                    |
| Slate & Shells |       |              | 1250 | 1285   |  |                     |                    |
| Red Rock       |       |              | 1285 | 1290   |  |                     |                    |
| Slate          |       |              | 1290 | 1313   | Perforated at 1527-1539' 2 shots/foot  |                     |                    |
| Little Lime    |       |              | 1313 | 1351   |  |                     |                    |

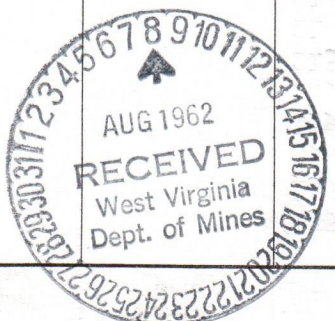

B-2

| Formation       | Color | Hard or Soft | Top 24 | Bottom | Oil, Gas or Water   | Depth Found    | Remarks       |
|-----------------|-------|--------------|--------|--------|---|----------------|---------------|
| Slate           |       |              | 1351   | 1353   | Acidized Big  | Lime 5-17-62   | with 3,500    |
| Big Lime        |       |              | 1353   | 1545   | gallons 15% Hcl   |                |               |
| Red Injun Sand  |       |              | 1545   | 1593   |   |                |               |
| Gray Injun Sand |       |              | 1593   | 1650   | Final open flow - 12/10                                       | W 2" 146 M Big |               |
| Slate & Shells  |       |              | 1650   | 2135   | Lime and Injun, 24/10   | W 2" 207 M     |               |
| Coffee Shale    |       |              | 2135   | 2145   | Shale   |                |               |
| Berea Grit      |       |              | 2145   | 2155   |   |                |               |
| Shell           |       |              | 2155   | 2175   |   |                | B.Im.&Inj.146 |
| Sand            |       |              | 2175   | 2190   | FINAL OPEN FLOW - 353 M                                       | - Shale 207M   |               |
| Slate & Shells  |       |              | 2190   | 2250   | 48 Hr. R.P. 355# casing                                       |                |               |
| Brown Shale     |       |              | 2250   | 2285   | 48 Hr. R.P. 270# tubing                                       |                |               |
| Slate & Shells  |       |              | 2285   | 2870   |   |                |               |
| Brown Shale     |       |              | 2870   | 3182   |   |                |               |
| White Slate     |       |              | 3182   | 3209   |   |                |               |
| Total Depth     |       |              | 3209'  |        |   |                |               |
|                 |       |              |        |        | LOGS RUN:<br>Gamma Ray<br>Density<br>Induction<br>Temperature |                |               |
|                 |       |              |        |        | Shut in 5-23-62 in 2-3/8" tubing.                             |                |               |

10/27/2023

Date August 3, 19 62

APPROVED UNITED FUEL GAS COMPANY, Owner

By S.R. Ferrell  
(Title)  
Supt., Civil Engineering Dept.

UNITED FUEL GAS COMPANY  
COMPANY

SERIAL WELL NO. 9151 LEASE NO. No Ref. MAP SQUARE 24-33

| RECORD OF WELL NO. <u>9151</u> on the |                               | CASING AND TUBING |            |                  |              | TEST BEFORE SHOT                          |                                   |
|---------------------------------------|-------------------------------|-------------------|------------|------------------|--------------|---|-----------------------------------|
| FG Co Min. Tr. #1                     | Acres                         | SIZE              | WEIGHT     | USED IN DRILLING | LEFT IN WELL |   |                                   |
| <u>40,578.86</u>                      |                               |                   |            |                  |              | <u>5</u>                                  | <u>/10 of Water in 1" inch</u>    |
| <u>Grant</u>                          | <u>District</u>               | <u>10-3/4"</u>    | <u>32#</u> | <u>33'</u>       | <u>33'</u>   |   | <u>/10 of Merc. in _____ inch</u> |
| <u>Wayne</u>                          | <u>County</u>                 | <u>8-5/8"</u>     | <u>24#</u> | <u>268'</u>      | <u>268'</u>  | <u>Volume 24 MCF</u>                      | <u>Cu. ft.</u>                    |
| State of: <u>West Virginia</u>        |                               | <u>7"</u>         | <u>20#</u> | <u>1393'</u>     | <u>None</u>  | TEST AFTER SHOT                           |                                   |
| Field: <u>Central Division</u>        |                               | <u>4-1/2"</u>     | <u>11#</u> | <u>1673'</u>     | <u>1673'</u> | <u>B. Lime &amp; Injun</u>                |                                   |
| Rig Commenced                         | <u>By Contractor</u> 19       | <u>2-3/8"</u>     | <u>4#</u>  | <u>1438'</u>     | <u>1438'</u> | <u>12 /10 of Water in 2" inch</u>         |                                   |
| Rig Completed                         | <u>By Contractor</u> 19       |                   |            |                  |              | <u>Shale</u>                              |                                   |
| Drilling Commenced                    | <u>March 30,</u> 19 <u>62</u> | <u>2-3/8"</u>     | <u>4#</u>  | <u>1671'</u>     | <u>1671'</u> | <u>24 /10 of Merc. in 2" inch</u>         |                                   |
| Drilling Completed                    | <u>May 12,</u> 19 <u>62</u>   |                   |            |                  |              | <u>B. Lime &amp; Injun 146 MCF</u>        |                                   |
| Drilling to cost                      | per foot                      |                   |            |                  |              | <u>Volume Shale 207 MCF</u>               |                                   |
| Contractor is:                        | <u>E. J. Elkins</u>           |                   |            |                  |              | <u>When Shut In Hours After Shot</u>      |                                   |
| Address:                              | <u>Hamlin, W. Va.</u>         |                   |            |                  |              | <u>Rock Pressure</u>                      |                                   |
| Driller's Name                        | <u>Halden Moore</u>           |                   |            |                  |              | <u>Date Shot 5-14-62</u>                  |                                   |
|                                       | <u>Homer Yeager</u>           |                   |            |                  |              | <u>1000# Armstrong &amp; 2100#</u>        |                                   |
| Drilling Permit No.                   | <u>WAY-1399</u>               |                   |            |                  |              | <u>Size of Torpedo Dupont Gelatin</u>     |                                   |
| Elevation:                            | <u>787.02'</u>                |                   |            |                  |              | <u>"See Below"</u>                        |                                   |
|                                       |                               |                   |            |                  |              | <u>Oil Flowed _____ bbls. 1st 24 hrs.</u> |                                   |
|                                       |                               |                   |            |                  |              | <u>Oil Pumped _____ bbls. 1st 24 hrs.</u> |                                   |
|                                       |                               |                   |            |                  |              | <u>Well abandoned and</u>                 |                                   |
|                                       |                               |                   |            |                  |              | <u>Plugged _____ 19 _____</u>             |                                   |
|                                       |                               |                   |            |                  |              | <u>1st. Perf. Set _____ from _____</u>    |                                   |
|                                       |                               |                   |            |                  |              | <u>2nd Perf. Set _____ from _____</u>     |                                   |

DRILLER'S RECORD

| FORMATION   | TOP | BOTTOM | THICKNESS | REMARKS                                  |
|-------------|-----|--------|-----------|--|
| Clay        | 0   | 32     | 32        | Frac. Injun 5/17/62 with 468 Bbl. Water  |
| Sand        | 32  | 57     | 25        | & 25,000# Sand. Acid. B. Lime on 5/17/62 |
| Coal        | 57  | 60     | 3         | with 3500 Gal. 15% HCL Acid              |
| Sand        | 60  | 178    | 118       | Water @ 60'                              |
| Coal        | 178 | 181    | 3         |  |
| Slate       | 181 | 191    | 10        |  |
| Sand        | 191 | 203    | 12        |  |
| Slate       | 203 | 247    | 44        |  |
| Sand        | 247 | 260    | 13        |  |
| Slate       | 260 | 275    | 15        |  |
| Sand        | 275 | 310    | 35        |  |
| Slate       | 310 | 460    | 150       |  |
| Sand        | 460 | 475    | 15        |  |
| Slate       | 475 | 525    | 50        |  |
| Broken Sand | 525 | 610    | 85        |  |
| Slate       | 610 | 640    | 30        |  |
| Sand        | 640 | 690    | 50        |  |

**APPROVED**

*[Signature]*  
DIVISION SUPERINTENDENT

10/27/2023

SERIAL WELL NO. 9151

LEASE NO. No Ref.

MAP SQUARE 24-33

DRILLER'S RECORD

| FORMATION       | TOP   | BOTTOM | THICKNESS | REMARKS                             |
|-----------------|-------|--------|-----------|-------------------------------------|
| Slate           | 690   | 700    | 10        |                                     |
| Sand            | 700   | 738    | 38        |                                     |
| Slate           | 738   | 830    | 92        |                                     |
| Salt Sand       | 830   | 967    | 137       |                                     |
| Slate           | 967   | 995    | 28        |                                     |
| Broken Sand     | 995   | 1050   | 55        |                                     |
| Hard Sand       | 1050  | 1109   | 59        |                                     |
| Slate           | 1109  | 1130   | 21        |                                     |
| Broken Sand     | 1130  | 1250   | 120       | Salt Water @ 1135' - 3 BPH          |
| Slate Shell     | 1250  | 1285   | 35        |                                     |
| Red Rock        | 1285  | 1290   | 5         |                                     |
| Slate           | 1290  | 1313   | 23        |                                     |
| Little Lime     | 1313  | 1351   | 38        |                                     |
| Slate           | 1351  | 1353   | 2         |                                     |
| Big Lime        | 1353  | 1545   | 192       | Show of Gas @ Oil @ 1435'           |
| Red Injun Sand  | 1545  | 1593   | 48        | Gas Pay @ 1533'-1532' - 12/10 W-1"  |
| Gray Injun Sand | 1593  | 1650   | 57        |                                     |
| Slate & Shells  | 1650  | 2135   | 485       |                                     |
| Coffee Shale    | 2135  | 2145   | 10        |                                     |
| Berea Grit      | 2145  | 2155   | 10        |                                     |
| Shell           | 2155  | 2175   | 20        |                                     |
| Sand Berea      | 2175  | 2190   | 15        |                                     |
| Slate & Shells  | 2190  | 2250   | 60        |                                     |
| Brown Shale     | 2250  | 2285   | 35        | Gas Test @ top of Shale - 1/10 W-1" |
| Slate & Shells  | 2285  | 2870   | 585       |                                     |
| Brown Shale     | 2870  | 3182   | 312       | Gas Pay @ 3000'-3012' - 8/10 W-1"   |
| White Slate     | 3182  | 3209   | 27        | When drilling completed 6/10 W-1"   |
| TOTAL DEPTH     | 3209' |        |           |                                     |

Devonian Shale - 2190' to 3209'  
Total Shale - 1019'

no sand logged  
no electric log

Mary S. Friend  
Geologist

10/27/2023



B-3

FORM U 127-B C & D

May 17, 19 62

Mr. W.W. Ferrell, Supt. Prod. & Storage

Well No. 9151 (Serial No.) on U.F.G. Co. Min. Tr. #1 Farm  
Acid.

Was ~~shot~~ this date with 3500 Gal. 15% HCL Acid \_\_\_\_\_ quarts

Number of Shells \_\_\_\_\_

Length of Shells \_\_\_\_\_

Top of Shot \_\_\_\_\_

Bottom of Shot \_\_\_\_\_

Top of \_\_\_\_\_ Big Lime Sand 1353 feet  
(Name of Sand)

Bottom of \_\_\_\_\_ Big Lime Sand 1545 feet  
(Name of Sand)

Total Depth of Well 3209'

Results: When Shut In - B. Lime & Injun - 12/10 W-2" -  
146 MCF

Remarks: \_\_\_\_\_

Signed \_\_\_\_\_  
District Supt.

NOTE-When a well is shot this form must be filled out and sent to the General Superintendent.

10/27/2023

May 17, 19 62

Mr. W.W. Ferrell, Supt. Prod. & Storage

Well No. 9151 (Serial No.) on U.F.G. Co. Min. Tr. #1 Farm  
Frac. 468 Bbl. Water and  
Was shot this date with 25,000# 20/40 Sand quarts

Number of Shells \_\_\_\_\_

Length of Shells \_\_\_\_\_

Top of Shot \_\_\_\_\_

Bottom of Shot \_\_\_\_\_

Top of Injun Sand Sand 1545 feet  
(Name of Sand)

Bottom of Injun Sand Sand 1650 feet  
(Name of Sand)

Total Depth of Well 3209'

Results: When Shut In - Big Lime & Injun - 12/10 W-2" -  
146 MCF

Remarks: \_\_\_\_\_

Signed *W.W. Ferrell* District Supt.

NOTE-When a well is shot this form must be filled out and sent to the General Superintendent.

10/27/2023

B-1

FORM U 127-B C S D

May 11, 19 62

Mr. W.W. Ferrell, Supt. Prod. & Storage

Well No. 9151 (Serial No.) on U.F.G. Co. Min. Tr. #1 Farm

Was shot this date with 7000# Armstrong and 2100# Dupont Gelatin quarts

Number of Shells

Length of Shells 5"X10"

Top of Shot 2251'

Bottom of Shot 3209'

Top of Brown Shale Sand 2250 feet (Name of Sand)

Bottom of White Slate Sand 3209' feet (Name of Sand)

Total Depth of Well 3209'

Results: When Shut In - Br. Shale - 2 1/10 W-2" - 207 MCF

Remarks:

Signed [Signature] District Supt.

NOTE-When a well is shot this form must be filled out and sent to the General Superintendent.

10/27/2023

**U.S. DEPARTMENT OF ENERGY**  
Federal Energy Regulatory Commission  
Washington, D.C. 20426

**APPLICATION FOR DETERMINATION OF THE MAXIMUM LAWFUL  
PRICE UNDER THE NATURAL GAS POLICY ACT (NGPA)**  
(Sections 102, 103, 107 and 108)

**PLEASE READ BEFORE COMPLETING THIS FORM:**

General Instructions:

Complete this form if you are applying for price classification under sections 102, 103, 107 or 108 of the NGPA. A separate application is required for each well. If any reservoir qualifies for a category which differs from the category applicable to the producing well, separate applications must be made for the producing well and the reservoir. Complete each appropriate item on the reverse side of this page. The code numbers used in items 4.0 and 6.0 can be obtained from the Buyer/Seller Code Book. If there is more than one purchaser or contract, identify the additional information in the space below. Enter any additional remarks in the space below.

Submit the completed application to the appropriate Jurisdictional Agency as listed in title 18 of the CFR, part 274.501. If there are any questions, call (202) 275-4539.

Specific Instructions for Item 2.0, Type of Determination:

| <u>Section of NGPA</u> | <u>Category Code</u> | <u>Description</u>                        |
|------------------------|----------------------|---|
| 102                    | 1                    | New OCS Lease                             |
| 102                    | 2                    | New onshore well (2.5 mile test)          |
| 102                    | 3                    | New onshore well (1,000 feet deeper test) |
| 102                    | 4                    | New onshore reservoir                     |
| 102                    | 5                    | New reservoir on old OCS Lease            |
| 103                    | -                    | New onshore production well               |
| 107                    | -                    | High cost natural gas                     |
| 108                    | -                    | Stripper well                             |

Other Purchasers/Contracts:

| <u>Contract Date</u><br>(Mo. Day Yr.) | <u>Purchaser</u> | <u>Buyer Code</u> |
|---------------------------------------|------------------|-------------------|
| _____                                 | _____            | _____             |
| _____                                 | _____            | _____             |
| _____                                 | _____            | _____             |

Remarks:

RECEIVED

|  |   |                    |                                |   |
|--|---|--------------------|--------------------------------|---|
| 1.0 API well number:<br>(If not assigned, leave blank 14 digits.)  | <u>47-099-01399-</u>  |                    |                                |   |
| 2.0 Type of determination being sought<br>(Use the codes found on the front of this form.)                                   | <u>107DU</u><br>Section of NGPA   | -<br>Category Code | JUN 15 1982                    |   |
| 3.0 Depth of the deepest completion location<br>(Only needed if sections 103 or 107 in 2.0 above.)                           | OIL & GAS DIVISION<br><u>3209</u> feet DEPT. OF MINES   |                    |                                |   |
| 4.0 Name, address and code number of applicant<br>(35 letters per line maximum. If code number not available, leave blank.)  | Columbia Gas Transmission Corporation<br>Name<br>P. O. Box 1273<br>Street<br>Charleston<br>City     |                    | WV<br>State                    | 25325<br>Zip Code                           |
| 5.0 Location of this well (Complete (a) or (b).)<br>(a) For onshore wells<br>(35 letters maximum for field name.)            | <u>WU Field Area B</u><br>Field Name<br><u>Wayne</u><br>County                                      |                    |                                |   |
| (b) For OCS wells  | Area Name <u>NA</u> Block Number _____<br>Date of Lease _____<br>Mo. Day Yr. OCS Lease Number _____ |                    |                                |   |
| (c) Name and identification number of this well (35 letters and digits maximum.)   | <u>TCO Min. Tr. No. 1</u> <u>809151</u>   |                    |                                |   |
| (d) If code 4 or 5 in 2.0 above, name of the reservoir (35 letters maximum.)   | <u>NA</u>   |                    |                                |   |
| 6.0 (a) Name and code number of the purchaser<br>(35 letters and digits maximum. If code number not available, leave blank.) | *<br>Name   |                    | 004030<br>Buyer Code           |   |
| (b) Date of the contract:  | *<br>Mo. Day Yr.  |                    |                                |   |
| (c) Estimated total annual production from the well  | <u>9</u> Million Cubic Feet   |                    |                                |   |
|  |   | (a) Base Price     | (b) Tax                        | (c) All Other Prices [Indicate (+) or (-).] |
| 7.0 Contract price<br>(As of filing date. Complete to 3 decimal places.)   | S/MMBTU   | -.-.-              | -.-.-                          | -.-.-                                       |
| 8.0 Maximum lawful rate<br>(As of filing date. Complete to 3 decimal places.)  | S/MMBTU   | <u>Dereg</u>       | -.-.-                          | -.-.-                                       |
| 9.0 Person responsible for this application:   | Albert H. Mathena, Jr., Director, Production Eng.   |                    |                                |   |
| Agency Use Only  | Name  |                    |                                |   |
| Date Received by Juris. Agency   | <u>Albert H. Mathena Jr</u><br>Signature  |                    |                                |   |
| Date Received by FERC  | <u>6-9-82</u><br>Date Application is Completed  |                    | (304) 346-0951<br>Phone Number |   |

\*This is a pipeline production well. No contract exists and no sales are made.

10/27/2023

DEPARTMENT OF MINES OIL AND GAS DIVISION

Operator's Well No. 809151

API Well No.

47 - 099 - 01399  
State County Permit

WELL CLASSIFICATION FORM  
HIGH COST GAS WELL - DEVONIAN SHALE  
NGPA Section 107

DESIGNATED AGENT James L. Weekley

ADDRESS P. O. Box 1273  
Charleston, WV 25325

LOCATION Elevation 787.02'  
Watershed \_\_\_\_\_

WELL OPERATOR Columbia Gas Trans. Corp.

ADDRESS P. O. Box 1273  
Charleston, WV 25325

Dist. Stonewall County Wayne Quad. \_\_\_\_\_

Gas Purchase Contract No. N.A.

GAS PURCHASER N.A.

Meter Chart Code \_\_\_\_\_

ADDRESS \_\_\_\_\_

Date of Contract N.A.

This is a pipeline production well and no gas purchase contract exists.

Date surface drilling began: 3-30-1962

Indicate the bottom hole pressure of the well and explain how this was calculated.

*See Supplement*

AFFIDAVIT

I, Albert H. Mathena, Jr., having been first sworn according to law, state that I have calculated the percentage of footage of the producing interval which is not Devonian Shale as indicated by a Gamma Ray index of less than 0.7 if a Gamma Ray log described in subparagraph (3)(i) or (3)(ii)(A) has been filed, or as indicated by the report described in subparagraph (3)(ii)(B); I have demonstrated that the percentage of potentially disqualifying non-shale footage is equal to or less than five (5) percent of the gross Devonian age interval; and I have no knowledge of any information not described in the application which is inconsistent with a conclusion that the well qualifies as a high-cost natural gas well.

Albert H Mathena Jr

STATE OF WEST VIRGINIA

COUNTY OF KANAWHA, TO-WIT:

I, Larry G. Burdette, a Notary Public in and for the state and county aforesaid, do certify that Albert H. Mathena, Jr., whose name is signed to the writing above, bearing date the 9 day of June, 19 82, has acknowledged the same before me, in my county aforesaid.

**10/27/2023**

Given under my hand and official seal this 9 day of June, 19 82. My term of office expires on the 13 day of August, 19 85.

Larry G Burdette  
Notary Public

(NOTARIAL SEAL)

1884

*[Faint, illegible handwriting throughout the page]*

*[Faint handwriting]*

10/27/2023





Wayne - 1399

State of West Virginia  
Department of Mines  
Oil and Gas Division  
Charleston 25305

WALTER N. MILLER  
DIRECTOR

THEODORE M. STREET  
ADMINISTRATOR

BEFORE THE OFFICE OF OIL AND GAS  
OF THE DEPARTMENT OF MINES  
OF THE STATE OF WEST VIRGINIA

IN THE MATTER OF THE APPLICATIONS )  
OF COLUMBIA GAS TRANSMISSION )  
CORPORATION REQUESTING CLASSI- )  
FICATION UNDER SECTION 107 OF THE )  
NATURAL GAS POLICY ACT OF CERTAIN )  
WELLS IN BOONE, CABELL, JACKSON, )  
KANAWHA, LINCOLN, LOGAN, MINGO )  
AND WAYNE COUNTIES, WEST VIRGINIA. )

CAUSE NO. 33

ORDER NO. 1

REPORT OF THE OFFICE

This cause came before the Administrator of the Office of Oil and Gas on June 28, 1982, at 1:00 p.m., in Conference Room C, Capitol Conference Center, Charleston, West Virginia, after giving notice of hearing as required by law on the applications of Columbia Gas Transmission Corporation for certification of certain wells in Boone, Cabell, Jackson, Kanawha, Lincoln, Logan, Mingo and Wayne Counties as Devonian Shale wells under Section 107(c)(4) of the Natural Gas Policy Act.

FINDINGS OF FACT

1. Applicant is an operator within the meaning of paragraph (w) of Chapter 22-4-1.
2. Applicant has made filings for certification pursuant to Rule 34.04.
3. The Natural Gas Policy Act (NGPA) in Section 107, Ceiling Price For High-Cost Natural Gas--(c) Definition of High-Cost Natural Gas-- "For purposes of this section, the term "high-cost natural gas" means natural gas determined in accordance with Section 503 to be....(4) produced from Devonian Shale."
4. The Federal Energy Regulatory Commission (FERC) by Rule 272.101-(c) prescribes the method by which the jurisdictional agency may determine gas produced from Devonian Shale.
5. Exhibits refer to evidence gathered at a public hearing held June 28, 1982.

10/27/2023



6. Exhibits No. 2 and 3 lists the wells to be under consideration for Section 107 pricing. All these wells are located on Exhibits No. 4 and 5 and have been completed in the Devonian Shale.

7. Applicant, by letter dated June 25, 1982 (Exhibit No. 3) requested that eight (8) of the wells listed on Attachment A be stricken from the docket for hearing and they have been withdrawn.

8. Exhibit No. 6 shows random sampling of already qualified Devonian Shale wells.

9. Various cross-sections throughout the interval show gamma ray logs of the wells (see Exhibits Nos. 7, 8 and 9).

10. No well has any non-shale greater than 5% in the Devonian interval penetrated.

11. No gamma ray logs are available on these wells since they were all drilled before logging was common in West Virginia.

CONCLUSION OF LAW

1. That due notice of the time, place and purpose of the hearing has been given in all respects as required by law.

2. That pursuant to Chapter 22, Article 4, Code of West Virginia of 1931, as amended, the Office has jurisdiction over the subject matter embraced in said notice, and the persons interested therein, and jurisdiction to promulgate the hereinafter prescribed Order.

ORDER

NOW, therefore, based on the aforementioned Findings of Fact and Conclusion of Law, it is found by the Administrator that Columbia Gas Transmission Corporation's applications for classification under Section 107 of the Natural Gas Policy Act for certain wells in Boone, Cabell, Jackson, Kanawha, Lincoln, Logan, Mingo and Wayne Counties, identified in Attachment A, are approved.

The Office of Oil and Gas further incorporates the Report of the Office and Findings of Fact and Conclusion of Law dated June 28, 1982, as if the same were fully set forth and includes hereto the Report of the Office and Findings of Fact and Conclusion of Law as a part of this Order.

Entered this 12th day of July, 1983.

IN THE NAME OF THE STATE OF WEST VIRGINIA:

OFFICE OF OIL AND GAS  
OF THE DEPARTMENT OF MINES  
OF THE STATE OF WEST VIRGINIA

By:

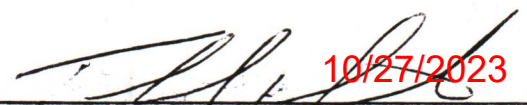

10/27/2023

Theodore M. Streit, Administrator

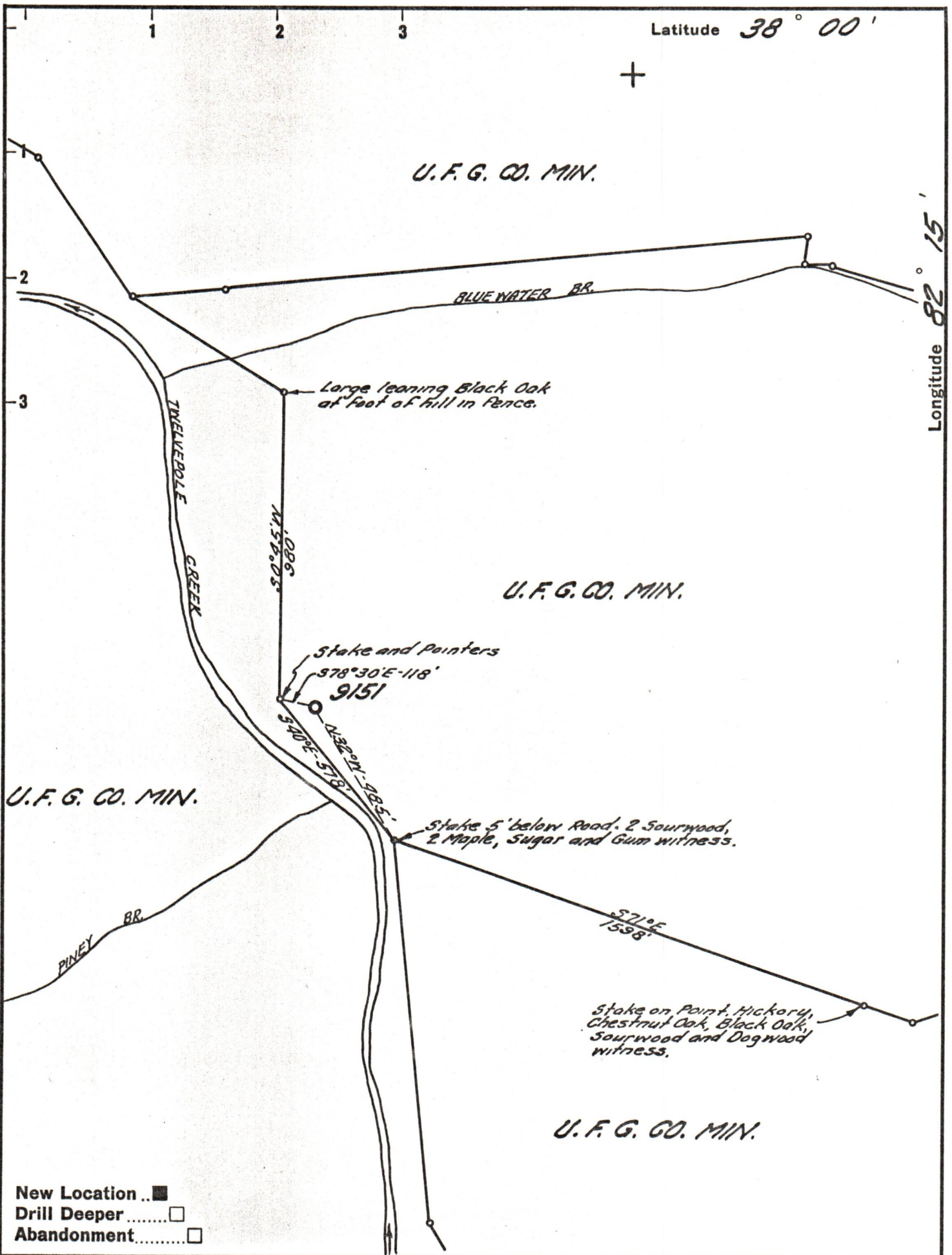

Company UNITED FUEL GAS CO.  
 Address CHARLESTON, W. VA.  
 Farm UNITED FUEL GAS CO. MIN.  
 Tract 1 Acres 40,578.<sup>86</sup> Lease No. NO REF.  
 Well (Farm) No. \_\_\_\_\_ Serial No. 9151  
 Elevation (Spirit Level) 787.02'  
 Quadrangle NAUGATUCK  
 County WAYNE District GRANT  
 Engineer Seybert R. Ferrell  
 Engineer's Registration No. 2529  
 File No. 24-33 Drawing No. \_\_\_\_\_  
 Date 2-19-62 Scale 1" = 400'

STATE OF WEST VIRGINIA  
 DEPARTMENT OF MINES  
 OIL AND GAS DIVISION  
 CHARLESTON

**WELL LOCATION MAP**  
 FILE NO. WAY-1377 10/27/2023

+ Denotes location of well on United States Topographic Maps, scale 1 to 62,500, latitude and longitude lines being represented by border lines as shown.

- Denotes one inch spaces on border line of original tracing.