



STATE OF WEST VIRGINIA
DEPARTMENT OF MINES
OIL AND GAS DIVISION

NOTICE OF PROPOSED LOCATION OF OIL AND GAS WELL

To THE DEPARTMENT OF MINES,
Charleston, W. Va.

Marian Burgess Leach et al
COAL OPERATOR OR COAL OWNER
309 Lock Lane, Richmond, Virginia
ADDRESS

COAL OPERATOR OR COAL OWNER

ADDRESS
Same

OWNER OF MINERAL RIGHTS

ADDRESS

OWENS, LIBBEY-OWENS GAS DEPARTMENT
NAME OF WELL OPERATOR
P. O. Box 4168, Charleston 4, W. Va.
COMPLETE ADDRESS

November 22, 19 61

PROPOSED LOCATION
Lincoln District
Wayne County

Well No. 7 (Serial No. 1156) ^{38° 05'} _{82° 25'} ^{992.6}

Marian Burgess Leach et al Farm
285 Acres

GENTLEMEN:

The undersigned well operator is entitled to drill upon the above named farm or tract of land for oil and gas, ~~having fee title thereto, (or as the case may be)~~ under grant or lease dated January 2, 1959, made by Marian Burgess Leach et al, to Owens-Illinois Glass Company & Libbey Owens Ford Glass Co., and recorded on the 23rd day of May, 1959, in the office of the County Clerk for said County in Book 50, page 195.

The enclosed plat was prepared by a competent engineer and shows the proposed location of a well to be drilled for oil and gas by the undersigned well operator on the farm and in the Magisterial District and County above named, determined by survey and courses and distances from two permanent points, or land marks.

The undersigned well operator is informed and believes there are no coal operators operating beds of coal beneath said farm or tract of land on which said well is located, or within 500 feet of the boundaries of the same, who have mapped their workings and filed their maps as required by law, excepting the coal operators or coal owners (if any) above named as addressees.

The above named coal operators or coal owners (if any) are notified that any objections they may desire to make to such proposed location, or which they are required to make by Section 3 of said Code, if the drilling of a well at said proposed location will cause a dangerous condition in or about their respective coal mines, must be received by, or filed with the Department of Mines within ten* days from the receipt of a copy of this notice and accompanying plat by said Department. Said coal operators are further notified that forms for use in making such objections will be furnished to them by the Department of Mines promptly on request and that all such objections must set forth as definitely as is reasonably possible the ground or grounds on which such objections are based and indicate the direction and distance the proposed location should be moved to overcome same.

(The next paragraph is to be completed only in Department's copy.)

Copies of this notice and the enclosed plat were mailed by registered mail, or delivered to the above named coal operators or coal owners at their above shown respective address ~~day or before,~~ ~~or~~ on the same day with the mailing or delivery of this copy to the Department of Mines at Charleston, West Virginia.

Very truly yours,

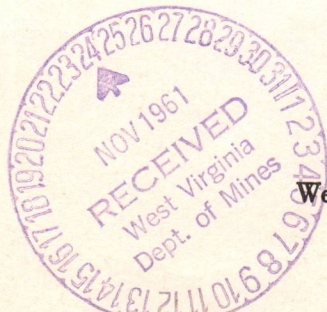

Address of Well Operator }

OWENS, LIBBEY-OWENS GAS DEPARTMENT
WELL OPERATOR
P. O. Box 4168
STREET
Charleston 4,
CITY OR TOWN 10/27/2023
West Virginia
STATE

*Section 3 . . . If no such objections be filed or be found by the department of mines, within said period of ten days from the receipt of said notice and plat by the department of mines, to said proposed location, the department shall forthwith issue to the well operator a drilling permit reciting the filing of such plat, that no objections have been made by the coal operators to the location, or found thereto by the department, and that the same is approved and the well operator authorized to proceed to drill at said location.

1387



DEPARTMENT OF MINES
AND GEOLOGY

NOTICE OF PROPOSED LOCATION OF OIL AND GAS WELL

To the Board of Supervisors
County of Loudoun, Virginia

James H. ...
300 ...
Loudoun, Virginia

James H. ...
300 ...
Loudoun, Virginia

Proposed Location
Section 12
Township 12
Range 12
(Section 12, Township 12, Range 12)

Proposed Location
Section 12
Township 12
Range 12
(Section 12, Township 12, Range 12)

James H. ...
300 ...
Loudoun, Virginia

James H. ...
300 ...
Loudoun, Virginia

The undersigned has been granted a lease by the Board of Supervisors of Loudoun County, Virginia, for the purpose of exploring for and producing oil and gas in the above described section of land. The lease was granted on the 12th day of ... 1999.

The undersigned has been granted a lease by the Board of Supervisors of Loudoun County, Virginia, for the purpose of exploring for and producing oil and gas in the above described section of land. The lease was granted on the 12th day of ... 1999.

James H. ...
300 ...
Loudoun, Virginia

James H. ...
300 ...
Loudoun, Virginia

10/27/2023

December 4, 1961

Owens, Libbey-Owens Gas Department
P. O. Box 4168
Charleston, West Virginia

Att: Mr. A. H. Smith

Gentlemen:

Enclosed is Permit WAY-1387 for drilling Well
No. 7 S-1156 on Marian Burgess Leach et al Lease, Lincoln
District, Wayne County.

Very truly yours,

Assistant Director
OIL AND GAS DIVISION

MG/mc

Enclosure

cc: Mr. Kenneth E. Butcher, Inspector

Mr. R. C. Tucker, Assistant
State Geologist

10/27/2023

Formation	Color	Hard or Soft	Top ³⁷	Bottom	Oil, Gas or Water	Depth Found	Remarks
Broken Sand	Dark	Med.	727	802			
Sand	Light	Hard	802	931			
Sand	Light	Med.	931	945	Water 945'	Salty	
Settling Sand	Light	Med.	945	959			
Slate	Dark	Soft	959	1013	Water 1013'	Hole filling up	
Sand	White	Hard	1013	1045			
Settling Sand	Light	Hard	1045	1067			
Sand	White	Hard	1067	1245			
Slate	Light	Soft	1245	1272			
Little Lime	Dark	Hard	1272	1304			
Pencil Cave	Dark	Soft	1304	1306			
Big Lime	Grey	Hard	1306	1454			
					2-12-62		
					SIM 1323 =	Sand IM 1323	
					Installed 7"	casing at 1323'	set on a casing shoe with 2 centralizers.
					Gas 1396'	20.7 MCF	
					Gas 1400'	29.3 MCF	
Big Lime	White	Hard	1454	1464			
Keener Sand	White	Hard	1464	1506			
Injun Sand	Grey	Hard	1506	1589	Gas 1588'	35.0 MCF	
					Test 1603'	33.0 MCF	
Slate	Dark	Soft	1589	1603	SIM 1603 =	Sand IM 1603	
					2-26-62		
					Birdwell made gamma-ray	and temperature	logs.
					3-19-62		
					Installed 4½"	casing at 1604' 6"	on a shoe with a Baker Cement Float Collar set from 1601' to 1599' and three centralizers.
					Dowell Division cemented 4½"	casing with 18 sacks of Cealment cement and 20# of flac. Used 61½ bbl. of water to circulate hole, 3 bbl. to mix cement and 26 bbl. to chase plug.	
					3-23-62		
					Birdwell perforated 4½"	casing from 1586' to 1590' with 6 shots per foot; total 25 shots.	
					3-27-62		
					Dowell Division riverfraced Injun Sand using 26,000# of 20-40 sand, 250 gals. Mud Acid, 471 bbl. of total water, including 385 bbls. sand laden water. 3:00 A.M. Test 2.68 MCF		
					3-28-62		
					Test 4:00 P.M. 172 MCF		
					3-29 to 4-18-62		
					Gas vibrating.		
					4-18-62		
					Gas tested 144 MCF before bailing.		
					Test 8 hrs. 144 MCF		
					Test 12 " 144 MCF		
					Final Open Flow:		
					Big Injun 144 MCF		

10/27/2023

Date May 4, 1962

APPROVED OWENS, LIBBEY-OWENS GAS DEPARTMENT, Owner

By A. H. Smith
A. H. Smith, Mgr. (Title) Land, Engrg. & Geol.



STATE OF WEST VIRGINIA
DEPARTMENT OF MINES
OIL AND GAS DIVISION 37

Quadrangle Wayne

Permit No. Way-1387

WELL RECORD

Oil or Gas Well GAS
(KIND)

Company OWENS, LIBBEY-OWENS GAS DEPARTMENT
Address P. O. Box 4168, Charleston 4, W. Va.
Farm Marian Burgess "C" Acres Pt. 557
Location (waters) _____
Well No. 7 (Serial No. 1156) Elev. 992.68'
District Lincoln County Wayne
The surface of tract is owned in fee by _____
Address _____
Mineral rights are owned by Mrs. Marian B. Leach
309 Lock Lane Address Richmond, Va.
Drilling commenced January 18, 1962
Drilling completed February 22, 1962
Date Shot _____ From _____ To _____
With _____
Open Flow _____ /10ths Water in _____ Inch
_____ /10ths Merc. in _____ Inch
Volume _____ Cu. Ft.
Rock Pressure _____ lbs. _____ hrs.
Oil _____ bbls., 1st 24 hrs.

Casing and Tubing	Used in Drilling	Left in Well	Packers
Size			Kind of Packer
16			
13			
10			Size of
8x 5/8"	445'	445'	
6x 7"	1325'3"	1325'3"	Depth set
5x 4 1/2"	1605'10"	1605'10"	
3			Perf. top
2			Perf. bottom
Liners Used			Perf. top
			Perf. bottom

WELL ACIDIZED _____

CASING CEMENTED 4 1/2" SIZE 1605' No. Ft. 3/19/62 Date
Dowell cemented with 18 sacks Cement & 20# Flac.
Used 6 1/2 bbl. water to circulate hole.
COAL WAS ENCOUNTERED AT _____ FEET _____ INCHES
133 FEET 36 INCHES 269 FEET 36 INCHES
322 FEET 36 INCHES _____ FEET _____ INCHES

WELL FRACTURED Dowell Division riverfracted Injun Sand using 26,000 lbs. of 20-40 sand, 250 gals. Mud Acid, and 471 bbls. of total water, including 385 bbls. sand laden water.

RESULT AFTER TREATMENT 144 MCF - Injun Sand

ROCK PRESSURE AFTER TREATMENT 187 lbs. in 48 hrs.

Fresh Water 60 Feet Salt Water 945 ; 1013 Feet

Formation	Color	Hard or Soft	Top	Bottom	Oil, Gas or Water	Depth	Remarks
Surface	Yellow	Soft	0	10			
Sand	Light	Soft	10	21			
Slate	Dark	Soft	21	53			
Sand	Light	Med.	53	63	Water 60'	2 BPH	
Slate	Dark	Soft	63	83			
Sand	Yellow	Soft	83	133			
Coal	Black	Soft	133	136			
Slate	Dark	Soft	136	185			
Broken Sand	Dark	Soft	185	190			
Slate	Dark	Soft	190	216			
Shell	Dark	Hard	216	220			
Sand	Light	Hard	220	225			
Slate	Dark	Soft	225	240			
Sand	Light	Med.	240	269			
Coal	Black	Soft	269	272			
Slate	Dark	Soft	272	282			
Sand	Grey	Med.	282	322			
Coal	Dark	Soft	322	325			
Slate	Dark	Soft	325	335			
Sand	Light	Med.	335	383			
Slate	Dark	Soft	383	418			
Sand	Grey	Med.	418	441			
Sand	Light	Med.	441	578			
Slate	Grey	Soft	578	593			
Slate	Dark	Soft	593	635			
Sand	Dark	Soft	635	650			
Slate	Dark	Soft	650	670			
Salt Sand	White	Med.	670	727			

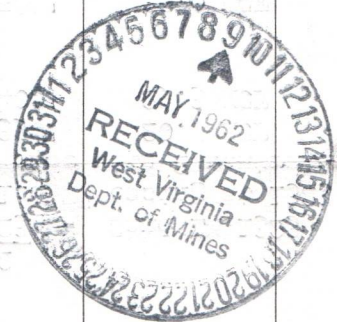

SIM 441 = Sand IM 441
Installed 8-5/8" casing at 445' set
on shoe in red clay with 2 centralizers
10/27/2023

STATE OF WEST VIRGINIA
DEPARTMENT OF MINES
OIL AND GAS DIVISION

INSPECTOR'S WELL REPORT

Permit No. Way-1387

Oil or Gas Well _____
(KIND)

Company <u>Allen-Telby - Owens</u>	CASING AND TUBING	USED IN DRILLING	LEFT IN WELL	PACKERS
	Address <u>Charles ton, WVA</u>	Size		
Farm <u>Marian Burgess</u>	16			Size of _____
Well No. <u>7</u>	13			Depth set _____
District <u>Jericoem</u> County <u>Wayne</u>	10			Perf. top _____
Drilling commenced _____	8 1/4			Perf. bottom _____
Drilling completed _____ Total depth _____	6 5/8			Perf. top _____
Date shot _____ Depth of shot _____	5 3/16			Perf. bottom _____
Initial open flow _____ /10ths Water in _____ Inch	3			Liners Used _____
Open flow after tubing _____ /10ths Merc. in _____ Inch	2			Perf. top _____
Volume _____ Cu. Ft.				Perf. bottom _____
Rock pressure _____ lbs. _____ hrs.	CASING CEMENTED _____ SIZE _____ No. FT. _____ Date _____			
Oil _____ bbls., 1st 24 hrs.	COAL WAS ENCOUNTERED AT _____ FEET _____ INCHES			
Fresh water _____ feet _____ feet	_____ FEET _____ INCHES _____ FEET _____ INCHES			
Salt water _____ feet _____ feet	_____ FEET _____ INCHES _____ FEET _____ INCHES			

Drillers' Names Delvey Kingrey

Remarks: Drilling Depth 1013 - Cable tool

2-6-62
DATE



H. E. Butcher
DISTRICT WELL INSPECTOR

10/27/2023

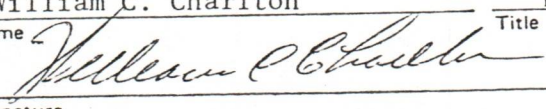
1.0 API well number: (If not available, leave blank. 14 digits.)	47-099-1387			
2.0 Type of determination being sought: (Use the codes found on the front of this form.)	108 Section of NGPA	NA Category Code		
3.0 Depth of the deepest completion location: (Only needed if sections 103 or 107 in 2.0 above.)	NA feet			
4.0 Name, address and code number of applicant: (35 letters per line maximum. If code number not available, leave blank.)	Industrial Gas Corporation Name P. O. Box 1473 Street Charleston, City		WV State	25325 Zip Code
5.0 Location of this well: [Complete (a) or (b).] (a) For onshore wells (35 letters maximum for field name.)	NA Field Name Wayne County NA State			
(b) For OCS wells:	NA Area Name		NA Block Number	
Date of Lease:				
Mo. Day Yr.			NA OCS Lease Number	
(c) Name and identification number of this well: (35 letters and digits maximum.)	Marian Burgess "C" 7-1156			
(d) If code 4 or 5 in 2.0 above, name of the reservoir: (35 letters maximum.)	NA			
6.0 (a) Name and code number of the purchaser: (35 letters and digits maximum. If code number not available, leave blank.)	See Addendum "A" Houdaille Industries, Inc. Name		N/Available Buyer Code	
(b) Date of the contract:	1 2 2 6 7 3 Mo. Day Yr.			
(c) Estimated annual production:	2.5 MMcf.			
7.0 Contract price: See Addendum "A" (As of filing date. Complete to 3 decimal places.)	(a) Base Price (\$/MMBTU) 1 2 8 3	(b) Tax 0 0 5 1	(c) All Other Prices [Indicate (+) or (-).] 0.0 0 3	(d) Total of (a), (b) and (c) 1.3 3 6
8.0 Maximum lawful rate: (As of filing date. Complete to 3 decimal places.)	2 2 4 3	0 3 0 2	0.0	2.5 4 5
9.0 Person responsible for this application:	William C. Charlton Name Division Counsel Title  Signature 02/28/79 Date Application is Completed (304) 342-8166 Phone Number			
Agency Use Only Date Received by Juris. Agency FEB 28 1979 Date Received by FERC				

10/27/2023

WELL DETERMINATION REPORT

PARTICIPANTS:

DATE: OCT 19 1979

BUYER-SELLER CODE

WELL OPERATOR: Industrial Gas Corporation

009283

FIRST PURCHASER: Houdaille Industries, Inc.

OTHER: _____

W. Va. Department of Mines, Oil & Gas Division
 WELL DETERMINATION FILE NUMBER
790228 - 108-099-1387
 Use Above File Number on all Communications
 Relating to Determination of this Well

Qualifies as Section 108, stoppage well.
Planned

CHECK EACH ITEM AS COMPLETE OR NOTE WHAT IS MISSING

ITEM NO.

- 1 FERC-121 Items not completed - Line No. _____
 - 2 IV-1 - Agent William C. Charlton
 - 3 IV-2 - Well Permit
 - 4 IV-6 - Well Plat
 - 5 IV-35- Well Record Drilling Deepening _____
 - 6 IV-36- Gas-Oil Test: Gas Only _____ Was Oil Produced? _____ Ratio _____
 - 7 IV-39- Annual Production 2 years
 - 8 IV-40- 90 day Production 6390 Days off Line: _____
 - 9 IV-48- Application for Certification. Complete?
 - 10 - 17 IV Form #51 - 52 - 53 - 54 - 55 - (56) - 57 - 58. Complete Affidavit Signed
 - 18 - 28 Other: Survey _____ Logs _____ Geological Charts _____ Structure Map _____
- 1:4000 Map _____ Well Tabulations _____ Gas Analyses _____
- (5) Commenced: 1-18-62
Date Completed: 2-22-62 Deepened _____
 - (5) Traced: _____
 - (5) Production Depth: 1306-1454; 1506-1603
 - (5) Production Formation: Big Lime; In Jun Sand
 - (5) Final Oper Flow _____
 - (5) Initial Potential: 144 mcfD - In Jun
 - (5) Static R.P. Initially: 187 # 48 hrs.
 - (6) Other Gas Test: _____
 - (7) Avg. Daily Gas from Annual Production: $\frac{2493}{256} = 9.7$ mcf
 - (8) Avg. Daily Gas from 90-day ending w/1-120 days: $\frac{638}{63} = 10.1$ mcf
 - (8) Line Pressure: 39 # $\frac{790}{20} = 39.5$ PSIG from Daily Report
 - (5) Oil Production: NO From Completion Report _____

10/27/2023

- (10-17) Does lease inventory indicate enhanced recovery being done: NO
- (10-17) Is affidavit signed? Notarized?

Does official well record with the Department confirm the submitted information? yes

Additional Information _____ Does computer program confirm? _____

Was Determination Objected to? _____ By Whom: MA

STATE OF WEST VIRGINIA
DEPARTMENT OF MINES, OIL AND GAS DIVISION

Date 02/28, 1979
Operator's Well No. 7-1156
API Well No. 47 - 099 - 1387
State County Permit

WELL CLASSIFICATION FORM

STRIPPER GAS WELL
NGPA Section 108

DESIGNATED AGENT William C. Charlton
ADDRESS P. O. Box 1473
Charleston, WV 25325

WELL OPERATOR Industrial Gas Corporation LOCATION: Elevation 992.68'
ADDRESS P. O. Box 1473 Watershed Not Available
Charleston, WV 25325 Dist. Lincoln County Wayne Quad. Wayne
GAS PURCHASER * Gas Purchase Contract No. *
ADDRESS Meter Chart Code R0437
Date of Contract *

*See FERC-121 - Addendum "A"

* * * * *

Provide a complete inventory of the lease and production equipment used for the well for the previous 24 months or, if less than 24 months, the period the well has been in production. Include a complete list of equipment or processes used in connection with recognized enhanced recovery techniques during completion or production. (Attach separate sheets, if necessary.)

(See Attachment)

List all records reasonably available to you which contain information relevant to a determination of eligibility (including production records, B&O Tax Records and royalty payment records) and indicate the location of such records:

All records required to determine production by meter stations are maintained in Charleston, West Virginia.

B&O Tax Records are located in Charleston, West Virginia, our Boston, Massachusetts office and the Houston, Texas office.

Royalty payment instructions are located in Charleston, West Virginia office and Houston, Texas office.

10/27/2023

Describe the search made of any records listed above:

I have made a diligent search of the production records located in Charleston, West Virginia. They were the records utilized in making the determination herein.

Are you aware of any other information which would tend to be inconsistent with the information specified above? Yes ___ No X. If yes, indicate the type and source of the information.

AFFIDAVIT

I, Lawrence B. Mentzer, having been first sworn according to law, state that I have caused to be made a diligent search of those records hereinbefore indicated in the manner herein described, that the information contained in this document is true and accurate and that on the basis of the records and examinations hereinbefore described, and to the best of my information, knowledge and belief, the well for which this certification is sought qualifies as a stripper well.

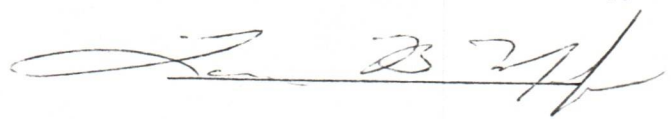

STATE OF WEST VIRGINIA,
COUNTY OF Kanawha, TO WIT:

I, Charlotte I. Mathews, a Notary Public in and for the state and county aforesaid, do certify that Lawrence B. Mentzer whose name is signed to the writing above, bearing date the 28 day of February, 19 79, has acknowledged the same before me, in my county aforesaid.

Given under my hand and official seal this 28 day of February, 19 79.

My term of office expires on the 5th day of December, 19 85.

10/27/2023

Charlotte I. Mathews
Notary Public

STATE OF WEST VIRGINIA
DEPARTMENT OF MINES, OIL AND GAS DIVISION

Date February 28, 1979

Operator's Well No. 7-1156

API Well No. 47 - 099 - 1387
State County Permit

Previous File No. NA
(If Applicable)

STATE APPLICATION FOR WELL CLASSIFICATION

WELL OPERATOR Industrial Gas Corporation
ADDRESS P. O. Box 1473
Charleston, W. Va. 25325

DESIGNATED AGENT William C. Charlton
ADDRESS P. O. Box 1473
Charleston, W. Va. 25325

Gas Purchase Contract No. * _____ and Date _____
Meter Chart Code R0437 (Month, day and year)

Name of First Purchaser * _____

(Street or P. O. Box)

(City) (State) (Zip Code)

FERC Seller Code 009283 FERC Buyer Code _____

- TYPE OF DETERMINATION BEING SOUGHT:
- (1) Initial determination (See FERC Form 121.) Section of NGPA 108 Category Code NA
 - (2) Determination that increased production is the result of enhanced recovery technology.
 - (3) Determination of a seasonally affected well.

(*See FERC-121 Addendum "A")

William C. Charlton Division Counsel
Name (Print) Title
William C. Charlton
Signature
P. O. Box 1473
Street or P. O. Box
Charleston, W. Va. 25325
City State (Zip Code)
(304) 342-8166
Area Phone Number
Code

(Certificate of Proof of Service to Purchaser)

See Separate Certificate Attached

(All of the above to be completed by the Operator/Applicant)

(To be completed by Jurisdictional Agency. Executed copy to be returned to Operator/Applicant and purchaser, if known).

The Department of Mines has received a request for certification of the above described well as meeting the requirements of Section _____ under the Natural Gas Policy Act of 1978. (NGPA); or for determination that increased production is the result of enhanced recovery technology under Section 108 of (NGPA); or for determination of a seasonally affected well under Section 108 of (NGPA).

All interested parties are hereby notified that on the _____ day of _____, 19____, at the office of the Oil and Gas Division in Charleston, West Virginia, or as soon thereafter as it may be heard, there will be a public hearing, if requested, or if objection is filed.

This Application is assigned File No. _____

Initial review of information submitted indicates the well is. is not entitled to certification as claimed under the Natural Gas Policy Act (NGPA). A review of this evidence and any additional evidence will be made at the time appointed for a public hearing or as soon thereafter as the matter may be heard.

Unless objections are timely filed or a request for a hearing is made within fifteen (15) days, a hearing will not be held except on ex parte motion of the department and the matter will go to determination.

WEST VIRGINIA DEPARTMENT OF MINES

William C. Charlton
Director

FEB 28 1979

Date received by
Jurisdictional Agency

By _____
Title _____ 10/27/2023

IV-39-WC

STATE OF WEST VIRGINIA
DEPARTMENT OF MINES
DIVISION OF OIL AND GAS

ANNUAL REPORT OF MONTHLY PRODUCTION-197A
GAS VOLUMES IN MFC 2 14.73
OIL IN DARRELLS 2 60 DEGREES
OPERATOR Industrial Gas Corporation
COUNTY Wayne

REPORT NO. CCA101P1 PG 00002
CURRENT DATE - 2/28/79
REPORT DATE - 2/28/79

API	FARM	Burgess "C"	7-1156	Wayne	AVG. FLOW PRESSURE	SHUT-IN PRESSURE	NA	TOTALS						
47-099-01387	216	242	154	182	155	92	35	222	146	140	256	258	0A5	2098
GAS MFC														
OIL BBL	J-	F-	M-	A-	M-	J-	J-	A-	B-	0-	H-	D-	OIL	
DAYS ONLINE	31	33	27	30	32	29	27	37	29	25	19	23		342

1977

API	FARM	Burgess "C"	7-1156	Wayne	AVG. FLOW PRESSURE	SHUT-IN PRESSURE	NA	TOTALS						
47-099-01387	409	260	159	125	161	194	145	250	152	107	251	280	0A5	2493
GAS MFC														
OIL BBL	J-	F-	M-	A-	M-	J-	J-	A-	B-	0-	H-	D-	OIL	
DAYS ONLINE	26	19	19	15	20	24	23	20	27	7	27	29		256

1978

296
90

SUMMARIZATION SCHEDULE
Section 271. 804 (b)

In accordance with Section 271.804(b) please list all other wells which are to be used in determining this well classification under Part 271 Subpart H.

10/27/2023

API NUMBERS 47-099-1218; 47-099-1260; 47-099-1292; 47-099-1355; 47-099-1369; 47-099-1387

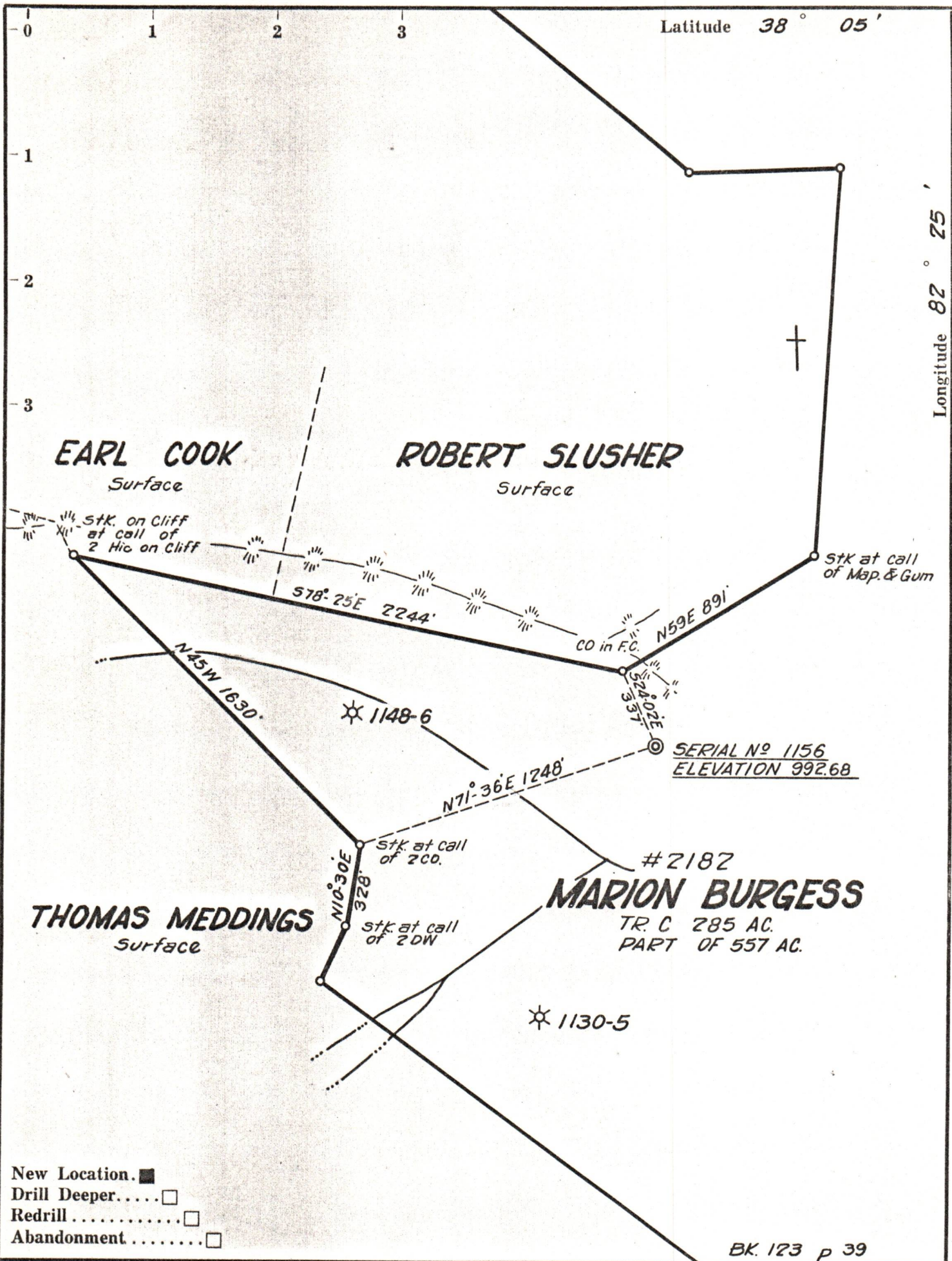

Company OWENS, LIBBEY-OWENS GAS DEPT.
 Address BOX 4188 CHARLESTON, WVA
 Farm MARION BURGESS
 Tract C Acres 285 Lease No. 2182
 Well (Farm) No. 7 Serial No. 1156
 Elevation (Spirit Level) 992.68
 Quadrangle WAYNE
 County WAYNE District LINCOLN
 Engineer T.S. Flannery
 Engineer's Registration No. 269
 File No. _____ Drawing No. _____
 Date OCT 30, 1961 Scale 1" = 500 FT.

STATE OF WEST VIRGINIA
 DEPARTMENT OF MINES
 OIL AND GAS DIVISION
 CHARLESTON

WELL LOCATION MAP 10/27/2023
 FILE NO. WAY-1387

+ Denotes location of well on United States Topographic Maps, scale 1 to 62,500, latitude and longitude lines being represented by border lines as shown.

— Denotes one inch spaces on border line of original tracing.