

NOTICE OF PROPOSED LOCATION OF OIL AND GAS WELLS

Note:
Original location F-3 will not be drilled this is to take its place.
Dyer & Perazzo
Jack Dyer
Wayne, W. Va.

Koontz & Zimmerman
Wayne, W. Va.

Dec. 8th

Lincoln

Wayne

F-3

Koontz & Zimmerman

Koontz & Zimmerman

Wayne, W. Va.

30th

Koontz & Zimmerman

Dyer & Perazzo

March, 1961

Dyer & Perazzo

Jack Dyer

Wayne

West Virginia

10/27/2023

October 13, 1961

Dyer & Ferzacca
Wayne
West Virginia

Att: Mr. Jack Dyer

Gentlemen:

Enclosed are permits for drilling the following wells:

<u>PERMIT NO.</u>	<u>WELL NO.</u>	<u>FARM</u>	<u>DISTRICT</u>	<u>COUNTY</u>
WAY-1376	F-1	Roy Copley	Butler	Wayne
WAY-1377	F-3	Koontz & Zimmerman	Lincoln	Wayne

Please post one copy of the permits at the well site and send us two copies of the well record when drilling is completed.

Please refer to directive regarding casing of oil and gas wells sent you previously.

Very truly yours,

Assistant Director
OIL AND GAS DIVISION

MG/jb

enclosure

cc: Mr. Kenneth E. Butcher, Inspector
Mr. R. C. Tucker, Assistant
State Geologist

10/27/2023

December 22, 1961

Dyer and Ferzacca
c/o Mr. Jack Dyer
Wayne, West Virginia

Dear Sirs:

Enclosed is Permit WAY-1377-Revised for
drilling Well No. F-3 on Koontz & Zimmerman Farm,
Lincoln District, Wayne County.

Please post one copy of permit at the well
site and send us two copies of the well record when
drilling is completed.

Please refer to directive regarding casing
of oil and gas wells sent you previously.

Very truly yours,

Assistant Director
OIL AND GAS DIVISION

MG/d
enclosure

cc: Mr. Kenneth E. Butcher, Inspector

Mr. R. C. Tucker, Assistant
State Geologist

bc: Mr. C. E. Roberts, Deputy
Securities Commissioner

10/27/2023



STATE OF WEST VIRGINIA
 DEPARTMENT OF MINES
 CHARLESTON

May 2, 1963
 "Centennial Year"

C
O
P
Y

Mr. Jack Dyer
 c/o Dyer and Ferzacca
 Wayne, West Virginia

Dear Mr. Dyer:

We find that we have requested well drilling records a number of times for the following well locations and have not been able to receive them from you. These data must be filed before permit for your Well No. 5 on the Koontz and Zimmerman Farm, Lincoln District, Wayne County, can be issued.

<u>PERMIT NO.</u>	<u>FARM</u>	<u>WELL NO.</u>	<u>DISTRICT</u>
WAY-1359	Koontz & Zimmerman	F-2	Lincoln
WAY-1376	Roy Copley	F-1	Butler
WAY-1377-Revised	Koontz & Zimmerman	F-3	Lincoln
WAY-1419	Koontz & Zimmerman	F-4	Lincoln

Some of these locations date back to 1961.

Yours very truly,

Assistant Director
 OIL AND GAS DIVISION

MG/sm

cc: Mr. Kenneth Butcher, Inspector

10/27/2023



STATE OF WEST VIRGINIA
 DEPARTMENT OF MINES
 CHARLESTON

May 2, 1953
 "Centennial Year"

COPY

Dear Mr. Dyer:
 Wayne, West Virginia
 c/o Dyer and Ferris
 Rt. Jack Dyer

We find that we have requested well drilling records a number of times for the following well locations and have not been able to receive them from you. These data must be filed before permit for your Well No. 5 on the Koontz and Zimmerman farm, Lincoln District, Wayne County, can be issued.

<u>DISTRICT</u>	<u>WELL NO.</u>	<u>YARN</u>	<u>PERMIT NO.</u>
Lincoln	F-2	Koontz & Zimmerman	WAY-1259
Butler	F-1	Roy Copley	WAY-1276
Lincoln	F-3	Koontz & Zimmerman	WAY-1277-Revise
Lincoln	F-4	Koontz & Zimmerman	WAY-1419

Some of these locations date back to 1951.

Yours very truly,

Assistant Director
 OIL AND GAS DIVISION

cc: Mr. Kenneth Butcher, Inspector

10/27/2023

Formation	Color	Hard or Soft	Top	Bottom	Oil, Gas or Water	Depth Found	Remarks
Slate & Shells			1105	1140			
Sand			1140	1168			
Slate			1168	1195			
Fine			1195	1305			
Slate			1205	1208			
Lime shell			1208	1215			
Water Sand			1215	1235			
Maxon Sand			1235	1250			
Slate			1250	1373			
Little Lime			1273	1295			
Slate			1295	1298			
Big Lime			1298	1410			
Slate			1410	1412			
Sand Kenners			1412	1468			
Red Injun			1468	1490			
Gray Injun			1490	1565			



10/27/2023

DEPARTMENT OF MINE Date 4-25, 1963

APPROVED Jacklyn, Owner
By Partner
(Title)

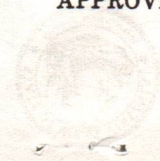



STATE OF WEST VIRGINIA
DEPARTMENT OF MINES
OIL AND GAS DIVISION

Quadrangle Wayne

Permit No. Way 1377

WELL RECORD

Oil or Gas Well Gas
(KIND)

Company DYER & Ferzacca
Address Box #7, Wayne, W.Va.
Farm Kounce & Zimmerman Acres 371
Location (waters) Lost Creek
Well No. 3 Elev. 700
District Lincoln County Wayne
The surface of tract is owned in fee by Kounce and Zimmerman
Address Sharon, Pa.
Mineral rights are owned by SAME
Address SAME

Drilling commenced March 12, 1962
Drilling completed JUNE 30, 1962
Date Shot From To
With

Open Flow 22/10ths Water in 1" Inch
/10ths Merc. in _____ Inch
Volume 47,000 Cu. Ft.
Rock Pressure 445 lbs. 24 Hrs hrs.
Oil _____ bbls., 1st 24 hrs.
WELL ACIDIZED _____

WELL FRACTURED 25000 # Sand
450 bbls Water Fractured at 1535'
RESULT AFTER TREATMENT 880,000
ROCK PRESSURE AFTER TREATMENT 445 #
Fresh Water 225 Feet Salt Water 880 Feet

Casing and Tubing	Used in Drilling	Left in Well	Packers
Size			Kind of Packer
16			
13			
10	<u>20'</u>	<u>20'</u>	Size of
8 1/4	<u>305'</u>	<u>305'</u>	
6 5/8	<u>1306'</u>		Depth set
5 1/2 <u>4 1/2"</u>	<u>1564'</u>	<u>1564'</u>	
3			Perf. top
2			Perf. bottom
Liners Used			Perf. top
			Perf. bottom

CASING CEMENTED 4 1/2 SIZE 1564 No. Ft. 6/30/62 Date

COAL WAS ENCOUNTERED AT 225 FEET 4' INCHES
____ FEET _____ INCHES _____ FEET _____ INCHES
____ FEET _____ INCHES _____ FEET _____ INCHES

Formation	Color	Hard or Soft	Top	Bottom	Oil, Gas or Water	Depth	Remarks
Clay			0	2			
Sand			2	50			
Slate			50	60			
Sand			60	140			
Slate			140	150			
Sand			150	170			
Slate			170	210			
Sand			210	225			Show Gas at 815'
Sand			225	229			Show Oil 1425'
Coal			229	260			
Slate			260	330			Gas at 1535'
Sand			330	350			
Slate			350	445			
Sand			445	460			
Sand Broken			445	460			
Slate			460	520			
Sand			520	550			
Slate			550	785			
Salt Sand			785	980			
Slate			980	995			
Sand			995	1005			
Slate & Shells			1005	1025			
Sand			1025	1105			



STATE OF WEST VIRGINIA
DEPARTMENT OF MINES
OIL AND GAS DIVISION

INSPECTOR'S WELL REPORT

Permit No. Way-1377

Oil or Gas Well oil & Gas
(KIND)

Company <u>D. & F. Gas Co.</u>	CASING AND TUBING	USED IN DRILLING	LEFT IN WELL	PACKERS
	Address <u>Wayne, W.Va.</u>	Size		
Farm <u>Keating & Zimmerman</u>	16			Kind of Packer
Well No. <u>#3</u>	13			
District _____ County <u>Wayne</u>	10			Size of
Drilling commenced <u>Mar. 13-62</u>	8 1/4			Depth set
Drilling completed <u>Apr-7-62</u> Total depth	6 5/8			Perf. top
Date shot _____ Depth of shot _____	5 3/16			Perf. bottom
Initial open flow <u>500000 estimated</u> /10ths Water in _____ Inch	3			Perf. top
Open flow after tubing _____ /10ths Merc. in _____ Inch	2			Perf. bottom
Volume _____ Cu. Ft.	Liners Used			Perf. top
Rock pressure _____ lbs. _____ hrs.				Perf. bottom
Oil _____ bbls. 1st 24 hrs.	CASING CEMENTED _____ SIZE _____ No. FT. _____ Date			
Fresh water <u>225</u> feet <u>2 barrels per hr.</u>	COAL WAS ENCOUNTERED AT <u>4</u> FEET _____ INCHES			
Salt water <u>880</u> feet <u>hole full</u>	_____ FEET _____ INCHES _____ FEET _____ INCHES			

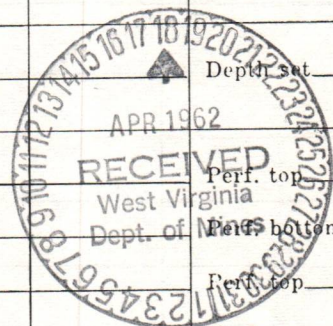

Drillers' Names Perna Swanson

Remarks: They have no accurate test on oil as yet.
Cable tools

4-9-62
DATE

K.E. Butcher
DISTRICT WELL INSPECTOR
10/27/2023

May 25, 1962
"Centennial '63"

Dyer & Ferzacca
Wayne
West Virginia

Attention Mr. Jack Dyer

Gentlemen:

Please send us two copies of the completion drilling record for Well No. F-3 on Koontz & Zimmerman Farm, Lincoln District, Wayne County - Permit WAY-1377.

Forms OG-10 are enclosed and we will appreciate the information as soon as possible.

Very truly yours,

Assistant Director
OIL AND GAS DIVISION

MG/d

cc: Mr. Kenneth E. Butcher, Inspector

10/27/2023

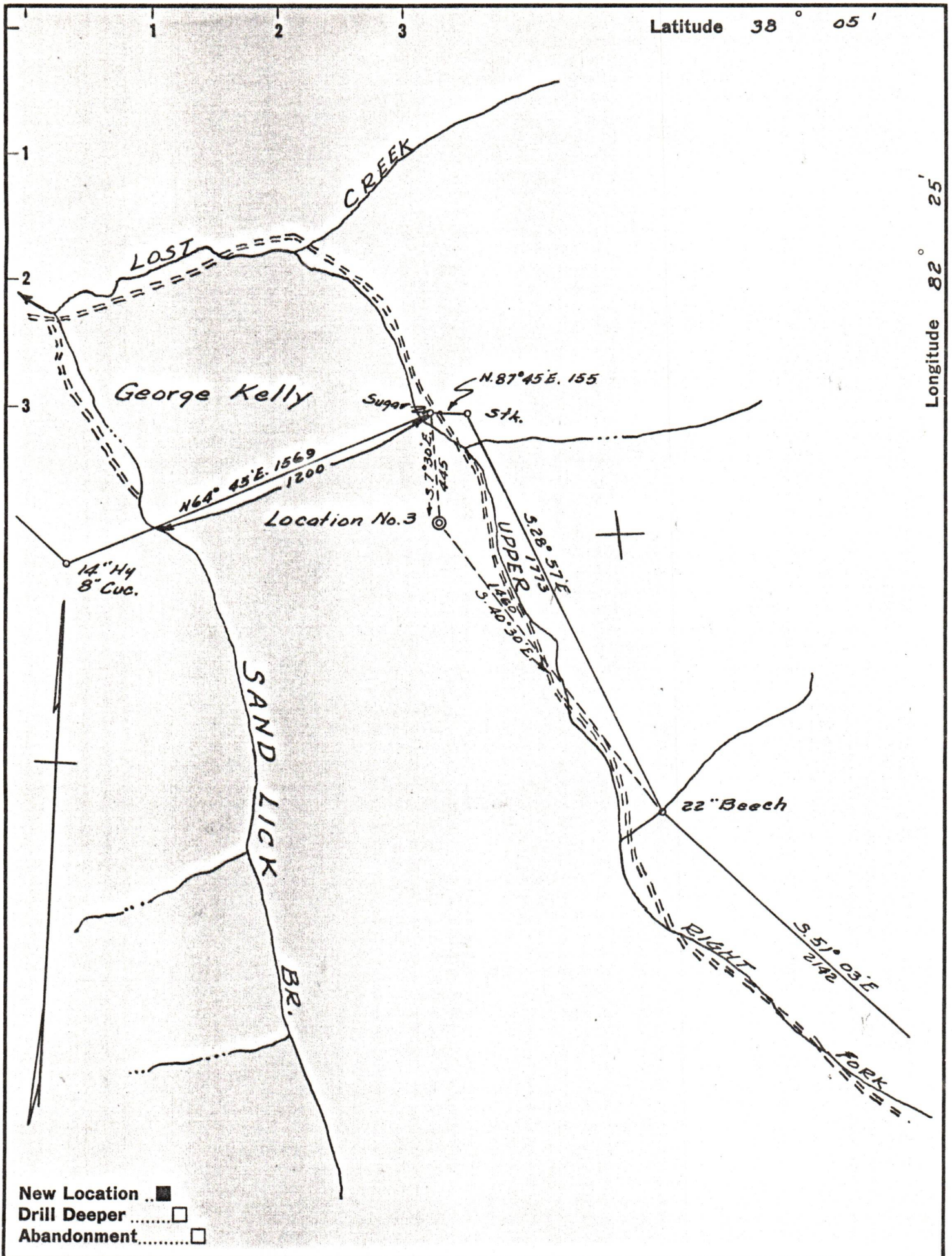

Company DYER & FERZACCA

Address WAYNE, W.VA.

Farm KOONTZ & ZIMMERMAN

Tract _____ Acres 371 Lease No. _____

Well (Farm) No. 3 Serial No. _____

Elevation (Spirit Level) 700

Quadrangle WAYNE

County WAYNE District LINCOLN

Engineer G.B. Owing

Engineer's Registration No. 309

File No. _____ Drawing No. _____

Date 9-29-61 Scale 1" = 500'

STATE OF WEST VIRGINIA
DEPARTMENT OF MINES
OIL AND GAS DIVISION
CHARLESTON

WELL LOCATION MAP
FILE NO. WAY-1377 10/27/2023

+ Denotes location of well on United States Topographic Maps, scale 1 to 62,500, latitude and longitude lines being represented by border lines as shown.

- Denotes one inch spaces on border line of original tracing.

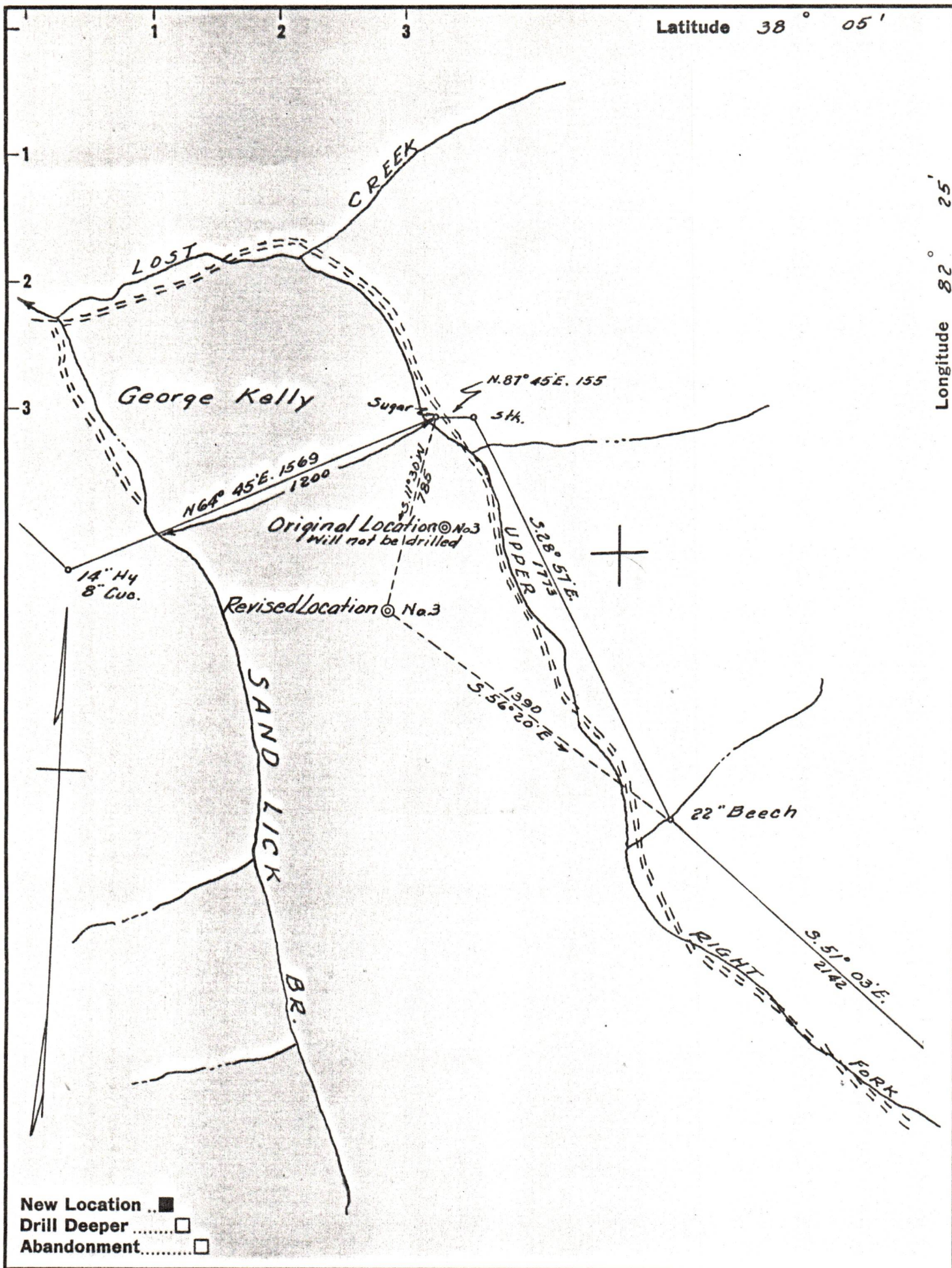

Company DYER & FERZACCA

Address WAYNE, W.VA.

Farm KOONTZ & ZIMMERMAN

Tract _____ Acres 371 Lease No. _____

Well (Farm) No. 3 Serial No. _____

Elevation (Spirit Level) 875

Quadrangle WAYNE

County WAYNE District LINCOLN

Engineer J. C. Ewing

Engineer's Registration No. 309

File No. _____ Drawing No. _____

Date 12-8-61 Scale 1" = 500'

STATE OF WEST VIRGINIA
DEPARTMENT OF MINES
OIL AND GAS DIVISION
CHARLESTON

WELL LOCATION MAP

FILE NO. WAY-1377-REVISED 10/27/2023

+ Denotes location of well on United States Topographic Maps, scale 1 to 62,500, latitude and longitude lines being represented by border lines as shown.

- Denotes one inch spaces on border line of original tracing.