





October 7, 1961

United Fuel Gas Company  
P. O. Box 1273  
Charleston 25, West Virginia

Att: Mr. Bernard Moon

Gentlemen:

Enclosed are permits for drilling the following wells:

<u>PERMIT NO.</u>	<u>WELL NO.</u>	<u>FARM</u>	<u>DISTRICT</u>	<u>COUNTY</u>
WAY-1371	9106	United Fuel Gas Co. Min. Tr.#1	Lincoln	Wayne
WAY-1372 ✓	9107	United Fuel Gas Co. Min. Tr.#1	Lincoln	Wayne

Very truly yours,

Assistant Director  
OIL AND GAS DIVISION

MG/jb  
enclosure

cc: Mr. Kenneth E. Butcher, Inspector

Mr. R. C. Tucker, Assistant  
State Geologist

10/27/2023







STATE OF WEST VIRGINIA  
DEPARTMENT OF MINES  
OIL AND GAS DIVISION

Quadrangle Wayne

Permit No. WAY-1372

WELL RECORD

Oil or Gas Well Gas

(KIND)

Company United Fuel Gas Company  
 Address P.O. Box 1273 Charleston 25, W. Va.  
 Farm United Fuel Gas Co. Min. Tr. #1 Acres 13,672.82  
 Location (waters) Lost Creek of Tug River  
 Well No. 9107 Elev. 718.76  
 District Lincoln County Wayne  
 The surface of tract is owned in fee by \_\_\_\_\_  
 Address \_\_\_\_\_  
 Mineral rights are owned by United Fuel Gas Company  
 Address Charleston, W. Va.  
 Drilling commenced 4-8-63  
 Drilling completed 4-27-63  
 Date Shot \_\_\_\_\_ From \_\_\_\_\_ To \_\_\_\_\_  
 With \_\_\_\_\_  
 Open Flow \_\_\_\_\_ /10ths Water in \_\_\_\_\_ Inch  
42 /10ths Merc. in 3" Inch  
 Volume 2,268,000 - Injun Cu. Ft.  
 Rock Pressure 48 lbs. 510 hrs.  
 Oil \_\_\_\_\_ bbls., 1st 24 hrs.  
 WELL ACIDIZED \_\_\_\_\_  
 WELL FRACTURED \_\_\_\_\_

Casing and Tubing	Used in Drilling	Left in Well	Packers
Size			Kind of Packer
16			
13			
10 <u>3/4</u>	<u>31"</u>	<u>Pulled</u>	Size of
8 <u>5/8</u>		<u>252'</u>	
6 <u>7"</u>	<u>1109'</u>	<u>Pulled</u>	Depth set
5 <u>3/16</u>			
3 <u>1/2</u>	<u>Cemented</u>	<u>1366'</u>	Perf. top
2			Perf. bottom
Liners Used			Perf. top
			Perf. bottom

CASING CEMENTED \_\_\_\_\_ SIZE \_\_\_\_\_ No. Ft. \_\_\_\_\_ Date \_\_\_\_\_

COAL WAS ENCOUNTERED AT \_\_\_\_\_ FEET \_\_\_\_\_ INCHES  
 \_\_\_\_\_ FEET \_\_\_\_\_ INCHES \_\_\_\_\_ FEET \_\_\_\_\_ INCHES  
 \_\_\_\_\_ FEET \_\_\_\_\_ INCHES \_\_\_\_\_ FEET \_\_\_\_\_ INCHES

RESULT AFTER TREATMENT

ROCK PRESSURE AFTER TREATMENT

Fresh Water 40 Feet Salt Water \_\_\_\_\_ Feet

Formation	Color	Hard or Soft	Top	Bottom	Oil, Gas or Water	Depth	Remarks
Clay			0	20	Hole full water	40'	
Slate			20	60			
Sand			60	125	Hole filling up at	660'	
Slate			125	320			
Sand			320	350	Hole filled up at	1140'	
Slate			350	445			
Sand			445	470	Show gas	1140'	
Slate			470	595			
Sand			595	660	Show gas	1266-1278'	
Water Sand			660	720			
Slate			720	760	Perforated at	1313'	with two <del>in</del> radial jets
Sand			760	985			
Slate & Shells			985	1008			
Sand			1008	1038	Fractured Injun 5-2-63 with	450 abbls. sand laden fluid and	40,000# Sand.
Slate			1038	1048	Final open flow after fracture	42/10 Merc. 3" 2,268 M	
Lime			1048	1073			
Slate			1073	1075			
Big Lime			1075	1257			
Injun			1257	1294			
Slate & Shells			1294	1370	Shut in 5-6-63 in	3 1/2" tubing.	
Total Depth			1370'				

LOGS RUN:  
Gamma Ray  
Laterolog  
Density  
P.D.C.

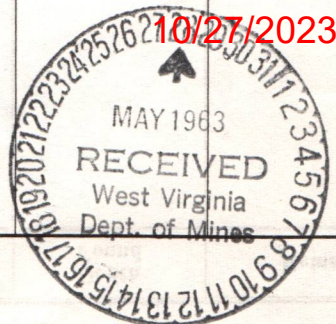



STATE OF WEST VIRGINIA  
DEPARTMENT OF MINES  
OIL AND GAS DIVISION

INSPECTOR'S WELL REPORT

Permit No. Way-1372

Oil or Gas Well \_\_\_\_\_  
(KIND)

		CASING AND TUBING	USED IN DRILLING	LEFT IN WELL	PACKERS
Company	<u>W.F.G. Co.</u>	Size			
Address	<u>Charleston, W. Va.</u>	16			Kind of Packer
Farm	<u>W.F.G. Co.</u>	13			
Well No.	<u>9107</u>	10	<u>31'</u>		Size of
District	<u>Lincoln</u> County <u>Wayne</u>	8 1/4	<u>252'</u>		
Drilling commenced	<u>4-8-63</u>	6 5/8			Depth set
Drilling completed		5 3/16			
Date shot		3			Perf. top
Initial open flow		2			Perf. bottom
Open flow after tubing		Liners Used			Perf. top
Volume					Perf. bottom
Rock pressure		CASING CEMENTED	SIZE	No. FT.	Date
Oil					
Fresh water	<u>40 hole full</u>	COAL WAS ENCOUNTERED AT	FEET	INCHES	
Salt water			FEET	INCHES	FEET INCHES
			FEET	INCHES	FEET INCHES

Drillers' Names Hal Vickers  
Contr. Maxine Perkins Cable Tools  
 Remarks: Total Depth 500'

4-10-63  
DATE

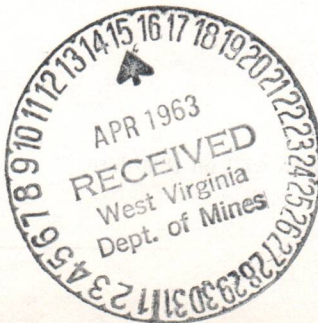

K. E. Butcher  
 DISTRICT WELL INSPECTOR  
 10/27/2023







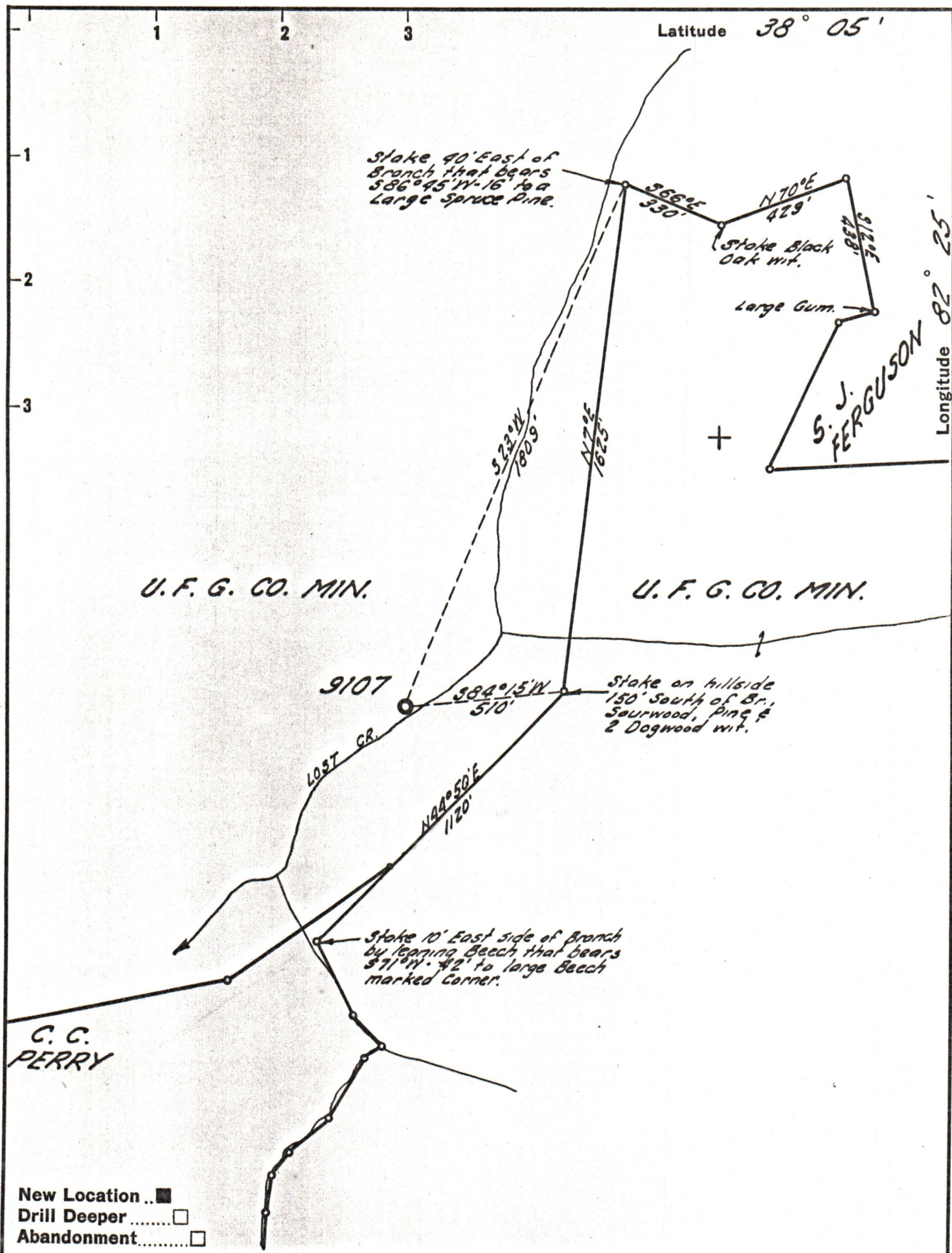

New Location ..   
 Drill Deeper .....   
 Abandonment.....

Company UNITED FUEL GAS CO.  
 Address CHARLESTON, W.VA.  
 Farm UNITED FUEL GAS CO. MIN.  
 Tract 1 Acres 13672.82 Lease No. NO REF.  
 Well (Farm) No. \_\_\_\_\_ Serial No. 9107  
 Elevation (Spirit Level) 718.76'  
 Quadrangle WAYNE  
 County WAYNE District LINCOLN  
 Engineer Seybert R. Howell  
 Engineer's Registration No. 2529  
 File No. 16-37 Drawing No. \_\_\_\_\_  
 Date 8-22-61 Scale 1" = 400'

STATE OF WEST VIRGINIA  
 DEPARTMENT OF MINES  
 OIL AND GAS DIVISION  
 CHARLESTON

**WELL LOCATION MAP**

FILE NO. WAY-1372

10/27/2023

+ Denotes location of well on United States Topographic Maps, scale 1 to 62,500, latitude and longitude lines being represented by border lines as shown.

- Denotes one inch spaces on border line of original tracing.