

*file 9-7856
Mr. E. Murray
Telephone
272-3201
(Mr. Hemsworth)*



STATE OF WEST VIRGINIA

DEPARTMENT OF MINES

OIL AND GAS DIVISION

*Send permit to:
Pampas Petroleum Co.
Wayne, W. Va.
att: Mr. O. L. Hemsworth*

NOTICE OF PROPOSED LOCATION OF OIL AND GAS WELL

To THE DEPARTMENT OF MINES,
Charleston, W. Va.

Wilson Buskirk and S. S. Buskirk,

COAL OPERATOR OR COAL OWNER

Guardians for Ira J. Buskirk
Wayne, West Virginia

ADDRESS

(No coal operations)

COAL OPERATOR OR COAL OWNER

ADDRESS

Same as above

OWNER OF MINERAL RIGHTS

ADDRESS

Pampas Petroleum Company

NAME OF WELL OPERATOR

Kennedy Bldg., Tulsa, Oklahoma

COMPLETE ADDRESS

September 20, 19 61

PROPOSED LOCATION

Butler District

Wayne County

Well No. 2 ^{380 15'} _{82° 25' E. 829.9}

S. S. Buskirk Farm

74 Acres

GENTLEMEN:

The undersigned well operator is entitled to drill upon the above named farm or tract of land for oil and gas, having fee title thereto, (or as the case may be) under grant or lease dated November 25, 1929, made by Wilson Buskirk, Ira J. Buskirk, and S. S. Buskirk, their guardian, to The Chartiers Oil Company, and recorded on the 23rd day of December, 1929, in the office of the County Clerk for said County in Book 14, page 343.

The enclosed plat was prepared by a competent engineer and shows the proposed location of a well to be drilled for oil and gas by the undersigned well operator on the farm and in the Magisterial District and County above named, determined by survey and courses and distances from two permanent points, or land marks.

The undersigned well operator is informed and believes there are no coal operators operating beds of coal beneath said farm or tract of land on which said well is located, or within 500 feet of the boundaries of the same, who have mapped their workings and filed their maps as required by law, excepting the coal operators or coal owners (if any) above named as addressees.

The above named coal operators or coal owners (if any) are notified that any objections they may desire to make to such proposed location, or which they are required to make by Section 3 of said Code, if the drilling of a well at said proposed location will cause a dangerous condition in or about their respective coal mines, must be received by, or filed with the Department of Mines within ten* days from the receipt of a copy of this notice and accompanying plat by said Department. Said coal operators are further notified that forms for use in making such objections will be furnished to them by the Department of Mines promptly on request and that all such objections must set forth as definitely as is reasonably possible the ground or grounds on which such objections are based and indicate the direction and distance the proposed location should be moved to overcome same.

(The next paragraph is to be completed only in Department's copy.)

Copies of this notice and the enclosed plat were mailed by registered mail, or delivered to the above named coal operators or coal owners at their above shown respective address _____ day _____ before, or on the same day with the mailing or delivery of this copy to the Department of Mines at Charleston, West Virginia.

Very truly yours, PAMPAS PETROLEUM COMPANY

W. Boyce White Manager
WELL OPERATOR

1020 Kennedy Building

STREET

Tulsa 3

CITY OR TOWN

Oklahoma

STATE

10/27/2023



Address of Well Operator }

*Section 3 If no such objections be filed or be found by the department of mines, within said period of ten days from the receipt of said notice and plat by the department of mines, to said proposed location, the department shall forthwith issue to the well operator a drilling permit reciting the filing of such plat, that no objections have been made by the coal operators to the location, or found thereto by the department, and that the same is approved and the well operator authorized to proceed to drill at said location.

1370



STATE OF WEST VIRGINIA
DEPARTMENT OF MINES
OIL AND GAS DIVISION

Handwritten notes and signatures in the top right corner.

NOTICE OF PROPOSED LOCATION OF OIL AND GAS WELL

To the Department of Mines
Charleston, W. Va.

Parsons Petroleum Company

Wilson Masarik and J. Masarik

Kennedy Oil Co., Inc., Oil and Gas

Operators for the J. Masarik
Lease, West Virginia

September 30, 1951

(No coal operations)

Butler

ADDRESS

State

State as above

Well No. 2

SECTION OF MINERAL RIGHTS

J. S. Masarik

OWNER

OWNER

The undersigned well operator is notified in full upon the above named lease of land for

oil and gas having the following: (1) as the lessor and his heirs, assigns, executors, administrators,

Wilson Masarik, J. S. Masarik, and

Parsons Petroleum Company, and recorded on the

at December, 1951, in the office of the County Clerk for the County of

Butler, West Virginia.

The undersigned was granted by a competent engineer and shows the proposed location of a well

to be drilled for oil and gas by the undersigned well operator on the farm and in the West Virginia District

and County above named, delineated by survey and corners and distances from the permanent points of

land marks.

The undersigned well operator is informed and believes there are no coal operations existing on

or coal operations on said land or part of land on which and well is located within 500 feet of the boundary

of the same, who have worked these workings and had this lease as part of the same, including the

coal operations on coal owners (if any) above named as follows:

The above named coal operators or coal owners (if any) are notified that any operations they may

desire to make to and proposed location, or which they are required to make by section 5 of said Code,

the drilling of a well at said proposed location will cause a dangerous condition on or about their respective

coal mines, and that the Department of Mines, Oil and Gas, and the County of Butler, West Virginia, are notified

that for the use of the parties herein named, the Department of Mines, Oil and Gas, and the County of Butler, West Virginia,

are notified that if such operations are to be made on the land or part of the land on which the proposed location

is located, the parties herein named shall be held liable for any and all damages caused by such operations

to the property of the parties herein named, and that the parties herein named shall be held liable for any and all

damages caused by such operations to the property of the parties herein named, and that the parties herein named

shall be held liable for any and all damages caused by such operations to the property of the parties herein named,

and that the parties herein named shall be held liable for any and all damages caused by such operations to the

property of the parties herein named, and that the parties herein named shall be held liable for any and all

damages caused by such operations to the property of the parties herein named, and that the parties herein named

shall be held liable for any and all damages caused by such operations to the property of the parties herein named,

and that the parties herein named shall be held liable for any and all damages caused by such operations to the

property of the parties herein named, and that the parties herein named shall be held liable for any and all

P. L. KENNEDY COMPANY

JOS. KENNEDY COMPANY

Witness

CLERK

Attest
Oil Operator



10/27/2023

October 5, 1961

Pampas Petroleum Company
Wayne
West Virginia

Att: Mr. O. L. Hemsworth

Gentlemen:

Enclosed is Permit WAY-1370 for drilling Well No. 2 on S. S. Buskirk Lease, Butler District, Wayne County.

Please post one copy of permit at the well site and send us two copies of the well record when drilling is completed.

Please note the enclosed directive regarding casing of oil and gas wells.

Very truly yours,

Assistant Director
OIL AND GAS DIVISION

MG/jb
enclosures

cc: Mr. Kenneth E. Butcher, Inspector

Mr. R. C. Tucker, Assistant
State Geologist

10/27/2023

November 3, 1961

Mr. O. L. Hensworth
Wayne, West Virginia

Dear Mr. Hensworth:

Enclosed is the original record book for Well No. 2,
drilled under Permit Way-1370, on the S. S. Buskirk Farm, Butler
District, Wayne County.

Also enclosed, you will find a copy of the completion
drilling record.

Very truly yours,

Assistant Director
OIL AND GAS DIVISION

MG/d

cc: Mr. Kenneth E. Butcher, Inspector

Enclosure

10/27/2023



STATE OF WEST VIRGINIA
DEPARTMENT OF MINES
OIL AND GAS DIVISION

Quadrangle Wayne

Permit No. WAY-1370

WELL RECORD

Oil or Gas Well _____
(KIND)

Company Pampas Petroleum Company
Address 1020 Kennedy Building, Tulsa 3, Oklahoma
Farm S. S. Buskirk Acres 74
Location (waters) _____
Well No. 2 Elev. 829.9
District Butler County Wayne
The surface of tract is owned in fee by W. B. & S. S. Buskirk, Guardians for Address Wayne, West Virginia
Ira J. Buskirk
Mineral rights are owned by Same as surface Address Wayne, West Virginia

Casing and Tubing	Used in Drilling	Left in Well	Packers
Size			Kind of Packer
16			
13			
10 3/4	12'		Size of
8 5/8	271' 8"		
6 5/8			Depth set
5 3/16			
3			Perf. top
2			Perf. bottom
Liners Used			Perf. top
			Perf. bottom

Drilling commenced 10-3-61
Drilling completed 11-3-61
Date Shot _____ From _____ To _____
With _____
Open Flow /10ths Water in _____ Inch
/10ths Merc. in _____ Inch
Volume _____ Cu. Ft.
Rock Pressure _____ lbs. _____ hrs.
Oil _____ bbls., 1st 24 hrs.
WELL ACIDIZED _____
WELL FRACTURED _____

CASING CEMENTED _____ SIZE _____ No. Ft. _____ Date _____
COAL WAS ENCOUNTERED AT _____ FEET _____ INCHES
_____ FEET _____ INCHES FEET _____ INCHES
_____ FEET _____ INCHES FEET _____ INCHES

RESULT AFTER TREATMENT _____

ROCK PRESSURE AFTER TREATMENT _____

Fresh Water _____ Feet Salt Water _____ Feet

Formation	Color	Hard or Soft	Top	Bottom	Oil, Gas or Water	Depth	Remarks
Surface			0	10			
Sand			10	132			
Slate			132	138			
Sand			138	150			
Slate			150	228			
Sand			228	261			
White Slate			261	314			
Sand			314	327			
D. Slate			327	338			
Broken Sand			338	350			
D. Slate			350	357			
D. Slate			357	424			
Sand			424	589			
Slate			589	606			
Sand			606	756			
Slate			756	845			
Sand			845	865			
Salte			865	915			
Sand			915	932			
Salt Sand			932	937			
Slate Break			937	1028			
Sand			1028	1047			
Slate							
Sand			1047	1064			
Slate, White			1064	1098			
Sand			1098	1135			

Water at 338 to 350
2 bailers per hr.
water 415 Salty
top water level in hole 234'

incomplete well

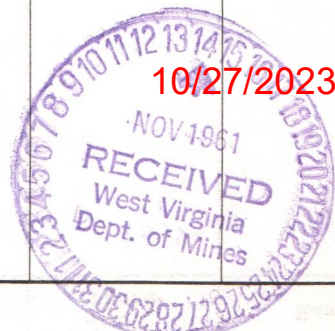



STATE OF WEST VIRGINIA
DEPARTMENT OF MINES
OIL AND GAS DIVISION

RECORDED
INDEXED
JAN 1962

Quadrangle Wayne

Permit No. WAY-1370

WELL RECORD

Oil or Gas Well Dry
(KIND)

Company Pampas Petroleum Company
Address 1020 Kennedy Bldg., Tulsa 3, Oklahoma
Farm S. S. Buskirk Acres 74
Location (waters) Patrick Creek
Well No. 2 (lost hole) Elev. 829.9
District Butler County Wayne
The surface of tract is owned in fee by Wilson & Ira J. Buskirk Address Wayne, West. Va.
Mineral rights are owned by Wilson & Ira J. Buskirk Address Wayne, West Va.
Drilling commenced October 3, 1961
Drilling completed October 18, 1961
Date Shot From To
With
Open Flow /10ths Water in Inch
/10ths Merc. in Inch
Volume Cu. Ft.
Rock Pressure lbs. hrs.
Oil bbls., 1st 24 hrs.
WELL ACIDIZED
WELL FRACTURED

Casing and Tubing	Used in Drilling	Left in Well	Packers
Size			Kind of Packer
16			
13			
10	13	none	Size of
8 1/4	271	none	
6 5/8			Depth set
5 3/16			
3			Perf. top
2			Perf. bottom
Liners Used			Perf. top
			Perf. bottom

CASING CEMENTED SIZE No. Ft. Date
COAL WAS ENCOUNTERED AT FEET INCHES
FEET INCHES FEET INCHES
FEET INCHES FEET INCHES

RESULT AFTER TREATMENT

ROCK PRESSURE AFTER TREATMENT

Fresh Water Feet Salt Water Feet

Formation	Color	Hard or Soft	Top	Bottom	Oil, Gas or Water	Depth	Remarks
Surface			0	11			
Sand rock			11	261			
Slate	White		261	314			
Sand			314	327			
Slate	Dark		327	338			
Sand			338	350	2 blrs. /hr.	338-350	Broken
Slate	Dark		350	357			
Sand			357	424	8 " "	415	
Slate			424	589			
Sand			589	606			
Slate			606	756			
Sand			756	860			
Shale			860	883			
Sand			883	915			
Salt Sand			915	932			
Shale			932	937			
Sand			937	1028			
Slate			1028	1047			
Sand	White		1047	1135			
		Total Depth		1135			

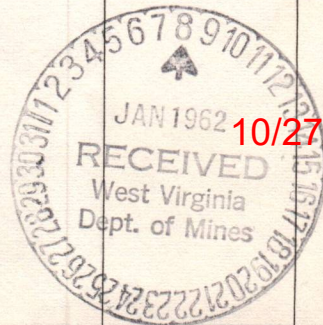



STATE OF WEST VIRGINIA
DEPARTMENT OF MINES
OIL AND GAS DIVISION

Quadrangle Wayne

Permit No. WAY-1370 - Revised Location **WELL RECORD**

Oil or Gas Well Gas
(KIND)

Company Pampas Petroleum Company
Address 1020 Kennedy Bldg., Tulsa 3, Okla.
Farm S. S. Buskirk Acres 74
Location (waters) Patrick Creek
Well No. 2 Elev. 829.9
District Butler County Wayne
The surface of tract is owned in fee by Wilson and Ira J. Buskirk Address Wayne, West Va.
Mineral rights are owned by Wilson & Ira J. Buskirk Address Wayne, West Va.
Drilling commenced November 16, 1961
Drilling completed December 12, 1961
Date Shot _____ From _____ To _____
With _____
Open Flow _____ /10ths Water in _____ Inch
11 /10ths Merc. in Two Inch
Volume 584,000 Cu. Ft.
Rock Pressure 325 lbs. lbs. 8 hrs.
Oil _____ bbls., 1st 24 hrs.
WELL ACIDIZED _____
WELL FRACTURED _____

Casing and Tubing	Used in Drilling	Left in Well	Packers
Size			Kind of Packer
16			
13			
10	10	10	Size of
8 1/4	272	272	
6 5/8 7"OD	1268	1268	Depth set
5 3/16			
3			Perf. top
2			Perf. bottom
Liners Used			Perf. top
			Perf. bottom

CASING CEMENTED _____ SIZE _____ No. Ft. _____ Date _____

COAL WAS ENCOUNTERED AT _____ FEET _____ INCHES
_____ FEET _____ INCHES _____ FEET _____ INCHES
_____ FEET _____ INCHES _____ FEET _____ INCHES

RESULT AFTER TREATMENT _____
ROCK PRESSURE AFTER TREATMENT _____
Fresh Water _____ Feet _____ Salt Water _____ Feet _____

Formation	Color	Hard or Soft	Top	Bottom	Oil, Gas or Water	Depth	Remarks
Surface			0	10			
Sand			10	134			
Shale	White		134	149			
Shale	Dark		149	183			
Sand	White		183	197	1/2 blr.	197	
Shale	White		197	217			
Sand	Light		217	249			
Shale	White		249	315			
Sand	White		315	330	1 blr.	320-330	
Shale	Dark		330	345			
Slate&Shells			345	425	3 blrs.	395	
Shale	Gray		425	440			
Sand	White		440	456			
Shale & Shells			456	535	5 blrs.	525	
Shale	Dark		535	575			
Shale&Shells			575	758			
Sand			758	833			
Shale			833	850			
Sand			850	915			
Salt Sand			915	1024			
Shale&Shells			1024	1030			
Shale break			1030	1033			
Sand			1033	1080			
Salt Sand			1080	1190			
Shale	Dark		1190	1206			
Salt Sand			1206	1232			
Shale			1232	1234			
Little Lime			1234	1262			
Big Lime			1262	1354			



Gas 1340-1343, 1344-1350
- Total Depth

STATE OF WEST VIRGINIA
DEPARTMENT OF MINES
OIL AND GAS DIVISION

INSPECTOR'S PLUGGING REPORT

Permit No. Way-1370 P Well No. 2

COMPANY Pampas Petrol. Co. ADDRESS Tulsa, Okla

FARM S.S. Buskirk DISTRICT Butler COUNTY Wayne

Filling Material Used Clay Stone Cement

Liner Location Amount Packer Location

PLUGS USED AND DEPTH PLACED			BRIDGES	CASING AND TUBING		
CEMENT-THICKNESS	WOOD-SIZE	LEAD	CONSTRUCTION-LOCATION	RECOVERED	SIZE	LOST
			<u>Clay</u> <u>915' - 1135'</u>			

Drillers' Names Walter Lane

Remarks:

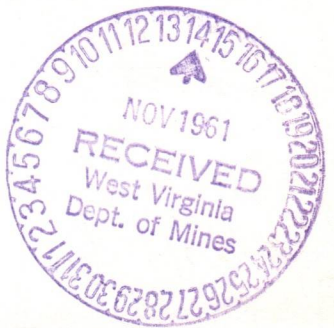

11-6-61 I hereby certify I visited the above well on this date.
DATE

H. E. Butcher
DISTRICT WELL INSPECTOR

10/27/2023

STATE OF WEST VIRGINIA
DEPARTMENT OF MINES
OIL AND GAS DIVISION

INSPECTOR'S WELL REPORT

Permit No. _____

Oil or Gas Well _____
(KIND)

	CASING AND TUBING	USED IN DRILLING	LEFT IN WELL	PACKERS
Company _____	Size			
Address _____	16			Kind of Packer _____
Farm _____	13			
Well No. _____	10			Size of _____
District _____ County _____	8 1/4			
Drilling commenced _____	6 5/8			Depth set _____
Drilling completed _____ Total depth _____	5 3/16			
Date shot _____ Depth of shot _____	3			Perf. top _____
Initial open flow _____ /10ths Water in _____ Inch	2			Perf. bottom _____
Open flow after tubing _____ /10ths Merc. in _____ Inch	Liners Used _____			Perf. top _____
				Perf. bottom _____

Volume _____ Cu. Ft. CASING CEMENTED _____ SIZE _____ No. FT. _____ Date _____

Rock pressure _____ lbs. _____ hrs. _____

Oil _____ bbls., 1st 24 hrs. COAL WAS ENCOUNTERED AT _____ FEET _____ INCHES

Fresh water _____ feet _____ feet _____ FEET _____ INCHES _____ FEET _____ INCHES

Salt water _____ feet _____ feet _____ FEET _____ INCHES _____ FEET _____ INCHES

Drillers' Names _____

Remarks:

DATE

DISTRICT WELL INSPECTOR

10/27/2023

STATE OF WEST VIRGINIA
DEPARTMENT OF MINES
OIL AND GAS DIVISION

INSPECTOR'S PLUGGING REPORT

Permit No. Way-1370P Well No. 2

COMPANY Lampas Petrol. Co. ADDRESS Tulsa, Okla.

FARM S.S. Bus Kirk DISTRICT Butler COUNTY Butler
Wayne

Filling Material Used Clay Stone Cement

Liner Location Amount Packer Location

PLUGS USED AND DEPTH PLACED			BRIDGES	CASING AND TUBING		
CEMENT-THICKNESS	WOOD-SIZE	LEAD	CONSTRUCTION-LOCATION	RECOVERED	SIZE	LOST
905-915-			Perm Bridge 375-	271-	8 5/8	
370-375-			Stone 365- - 370-			

Drillers' Names Walter Lowe

Remarks:

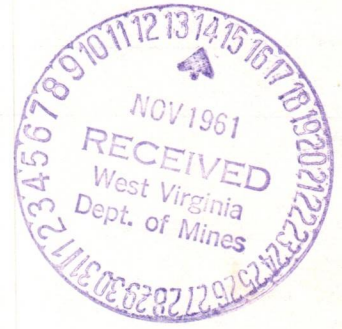

11-7-61 I hereby certify I visited the above well on this date.
DATE

J. E. Butcher
DISTRICT WELL INSPECTOR

10/27/2023

STATE OF WEST VIRGINIA
DEPARTMENT OF MINES
OIL AND GAS DIVISION

INSPECTOR'S WELL REPORT

Permit No. _____

Oil or Gas Well _____
(KIND)

	CASING AND TUBING	USED IN DRILLING	LEFT IN WELL	PACKERS
Company _____				
Address _____	Size			
Farm _____	16			Kind of Packer _____
Well No. _____	13			
District _____ County _____	10			Size of _____
Drilling commenced _____	8 1/4			
Drilling completed _____ Total depth _____	6 5/8			Depth set _____
Date shot _____ Depth of shot _____	5 3/16			
Initial open flow _____ /10ths Water in _____ Inch	3			Perf. top _____
Open flow after tubing _____ /10ths Merc. in _____ Inch	2			Perf. bottom _____
Volume _____ Cu. Ft.	Liners Used			Perf. top _____
Rock pressure _____ lbs. _____ hrs.				Perf. bottom _____
Oil _____ bbls., 1st 24 hrs.	CASING CEMENTED _____ SIZE _____ No. FT. _____ Date _____			
Fresh water _____ feet _____ feet	COAL WAS ENCOUNTERED AT _____ FEET _____ INCHES			
Salt water _____ feet _____ feet	_____ FEET _____ INCHES _____ FEET _____ INCHES			
	_____ FEET _____ INCHES _____ FEET _____ INCHES			

Drillers' Names _____

Remarks:

DATE

DISTRICT WELL INSPECTOR

10/27/2023

STATE OF WEST VIRGINIA
DEPARTMENT OF MINES
OIL AND GAS DIVISION

INSPECTOR'S WELL REPORT

Permit No. _____

Oil or Gas Well _____
(KIND)

	CASING AND TUBING	USED IN DRILLING	LEFT IN WELL	PACKERS
Company _____	Size			
Address _____	16			Kind of Packer _____
Farm _____	13			
Well No. _____	10			Size of _____
District _____ County _____	8 1/4			
Drilling commenced _____	6 5/8			Depth set _____
Drilling completed _____ Total depth _____	5 3/16			
Date shot _____ Depth of shot _____	3			Perf. top _____
Initial open flow _____ /10ths Water in _____ Inch	2			Perf. bottom _____
Open flow after tubing _____ /10ths Merc. in _____ Inch	Liners Used _____			Perf. top _____
Volume _____ Cu. Ft.				Perf. bottom _____
Rock pressure _____ lbs. _____ hrs.	CASING CEMENTED _____ SIZE _____ No. FT. _____ Date _____			
Oil _____ bbls., 1st 24 hrs.	COAL WAS ENCOUNTERED AT _____ FEET _____ INCHES			
Fresh water _____ feet _____ feet	_____ FEET _____ INCHES _____ FEET _____ INCHES			
Salt water _____ feet _____ feet	_____ FEET _____ INCHES _____ FEET _____ INCHES			

Drillers' Names _____

Remarks:

DATE

DISTRICT WELL INSPECTOR

10/27/2023

STATE OF WEST VIRGINIA
DEPARTMENT OF MINES
OIL AND GAS DIVISION

INSPECTOR'S WELL REPORT

Permit No. Way-1370

Oil or Gas Well Gas
(KIND)

		CASING AND TUBING	USED IN DRILLING	LEFT IN WELL	PACKERS
Company	<u>Pampas Petrol. oil co</u>				
Address	<u>Tulsa okla.</u>	Size			
Farm	<u>J. W. & Wilson Buskerk</u>	16			Kind of Packer
Well No.	<u>2</u>	13			
District	<u>Butler</u> County <u>Wayne</u>	10	<u>10-</u>		Size of
Drilling commenced	<u>11-16-61</u>	8 1/4	<u>272-</u>		
Drilling completed	<u>12-11-61</u> Total depth <u>1354-</u>	6 3/8	<u>1268-</u>		Depth set
Date shot		5 3/16			
Initial open flow	/10ths Water in <u>2</u> Inch	3			Perf. top
Open flow after tubing	<u>11</u> /10ths Merc. in <u>2</u> Inch	2			Perf. bottom
Volume	<u>584,000</u> Cu. Ft.	Liners Used			Perf. top
Rock pressure	lbs. hrs.				Perf. bottom
Oil	bbls., 1st 24 hrs.	CASING CEMENTED	SIZE	No. FT.	Date
Fresh water	<u>192-</u> feet <u>542-</u> <u>hole ball</u> feet				
Salt water	<u>None</u> feet	COAL WAS ENCOUNTERED AT	<u>None</u>		FEET INCHES
					FEET INCHES
					FEET INCHES

Drillers' Names Walter Jone

Remarks: Will acidize in near future Cable tools

12-18-61
DATE

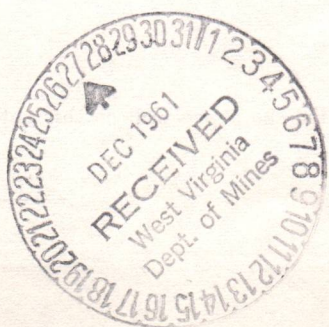

J. E. Batcher
DISTRICT WELL INSPECTOR
10/27/2023

STATE OF WEST VIRGINIA
 DEPARTMENT OF MINES
 OIL AND GAS DIVISION
INSPECTOR'S PLUGGING REPORT

Permit No. _____ Well No. _____

COMPANY _____ ADDRESS _____

FARM _____ DISTRICT _____ COUNTY _____

Filling Material Used _____

Liner	Location	Amount	Packer	Location		
PLUGS USED AND DEPTH PLACED			BRIDGES	CASING AND TUBING		
CEMENT-THICKNESS	WOOD-SIZE	LEAD	CONSTRUCTION-LOCATION	RECOVERED	SIZE	LOST

Drillers' Names _____

Remarks: _____

_____ I hereby certify I visited the above well on this date.
DATE

DISTRICT WELL INSPECTOR

10/27/2023

PROPOSED MANNER OF PLUGGING AND FILLING WELL

(REQUIRED BY RULES AND REGULATIONS)

WEST VIRGINIA DEPARTMENT OF MINES

OIL AND GAS DIVISION

WORK ORDER

Well to be plugged and filled as follows:

Work order prepared by the Department of Mines

Incomplete Well

Total depth 1135' - lost tools

Fill with clay from bottom to 915'

Neat cement 915' - 905'

Set a permanent Bridge at 375'

2 sacks neat cement & 5' crushed stone on bridge

Fill with clay to surface

Will skid rig

No Marker required

To the Department of Mines
Coal Owner or Operator,
Lease or Property Owner.

Gentlemen:

This "work order" is submitted for your approval and concurrence and unless notified of your disapproval or non-concurrence, the undersigned will proceed with the plugging and filling of said well in the above described manner on the date inspector is notified after permit is issued.

Very truly yours,

Well Operator

No objections have been filed by the coal owner or coal operator, or any available adjacent lease or property owners or interposed by the Department of Mines to the manner herein described for the plugging and filling of the well above mentioned. Therefore, the same is hereby approved

3rd day of NOVEMBER, 19 61.

DEPARTMENT OF MINES
Oil and Gas Division

By:

M. E. Giffels

NOTE: This "work order" shall be filed in triplicate, one copy for the files of the Department of Mines; one to be approved or corrected and returned to the well operator as his authority for plugging said well; and one for the well inspector.

10/27/2023



STATE OF WEST VIRGINIA
DEPARTMENT OF MINES
OIL AND GAS DIVISION

NOTICE OF INTENTION TO PLUG AND ABANDON WELL

(REQUIRED BY SECTION 9, ARTICLE 4, CHAPTER 22 OF THE CODE)

To THE DEPARTMENT OF MINES,
Charleston, W. Va.

Coal Operator	<u>Pampas Petroleum Company</u>	Name of Well Operator
Address	<u>Kennedy Bldg., Tulsa, Oklahoma</u>	Complete Address
Coal Owner	<u>November 3, 1961</u>	Date
Address	<u>WELL TO BE ABANDONED</u>	
Lease or Property Owner	<u>Butler</u>	District
Address	<u>Wayne</u>	County
	<u>Well No. 2</u>	
	<u>S. S. Buskirk</u>	Farm

Inspector to be notified KENNETH BUTCHER
BARBOURSVILLE, W. VA. Telephone Number REgent 6-1933

Gentlemen:— **24 HOURS IN ADVANCE OF PLUGGING**

The undersigned well operator is about to abandon the above described well and will commence

the work of plugging and abandoning said well on the date inspector is notified (which date shall not be less than five days after the day on which this notice so mailed is received, or in due course should be received by the Department of Mines).

This notice is given you in order that your respective representatives may be present at the plugging and filling of said well. You are further notified that whether you are represented or not represented the undersigned will proceed on that date, or shortly thereafter, to plug and fill said well in the manner required by Section 10, Article 4, Chapter 22 of the Code and given in detail on the reverse side of this notice, in "Work Order."

This notice is being mailed by registered mail to each of you at the above addresses on the above date.

Very truly yours,

Pampas Petroleum Co
By J. L. Hambrick
Well Operator

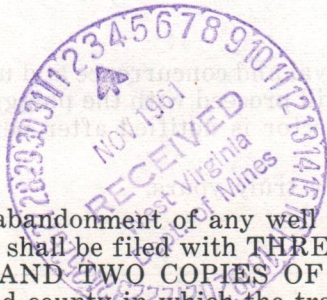

NOTE: Upon the abandonment of any well drilled prior to June 1, 1929, a plat prepared by a registered engineer, shall be filed with THREE COPIES OF APPLICATION, (OG-9) AND "WORK ORDER" AND TWO COPIES OF THE WELL RECORD, (OG-10). The map must show the district and county in which the tract of land is located, the name and acreage of same, the name or names of the owners and names of adjacent tracts and the location of the well to be abandoned, determined by survey with the courses and distances of such well from two permanent points or landmarks on said tract.

10/27/2023

NOTE: In case plugging is not commenced within four months from the date of permit, same shall expire and be of no further force or effect.

NOTE: PERMIT IS NOT TRANSFERABLE.

WAY-1370-P

Permit Number

STATE OF WEST VIRGINIA
DEPARTMENT OF MINES
OIL AND GAS DIVISION

AFFIDAVIT OF PLUGGING AND FILLING WELL

AFFIDAVIT SHOULD BE MADE IN TRIPLICATE, ONE COPY MAILED TO THE DEPARTMENT, ONE COPY TO BE RETAINED BY THE WELL OPERATOR AND THE THIRD COPY (AND EXTRA COPIES IF REQUIRED) SHOULD BE MAILED TO EACH COAL OPERATOR AT THEIR RESPECTIVE ADDRESSES.

<p>None COAL OPERATOR OR OWNER</p> <p>ADDRESS</p> <p>COAL OPERATOR OR OWNER</p> <p>ADDRESS</p> <p>Wilson Buskirk and Ira J. Buskirk LEASE OR PROPERTY OWNER Wayne, West Virginia ADDRESS</p>	<p>Pampas Petroleum Company NAME OF WELL OPERATOR</p> <p>1020 Kennedy Bldg., Tulsa 3, Oklahoma COMPLETE ADDRESS</p> <p>December 28, 19 61 WELL AND LOCATION</p> <p>Butler District</p> <p>Wayne County</p> <p>Well No. 2 (lost hole) S. S. BUSKIRK (Wilson and I. J. Buskirk) Farm</p> <p>K. E. Butcher</p>
--	---

STATE INSPECTOR SUPERVISING PLUGGING.....

AFFIDAVIT

STATE OF WEST VIRGINIA,

County of Wayne } ss:

Walter Lowe and Lloyd Lowe
being first duly sworn according to law depose and say that they are experienced in the work of plugging and filling oil and gas wells and were employed by Pampas Petroleum Company, well operator, and participated in the work of plugging and filling the above well, that said work was commenced on the 6th day of November, 19 61, and that the well was plugged and filled in the following manner:

SAND OR ZONE RECORD	FILLING MATERIAL	PLUGS USED	CASING	
			CSG PULLED	CSG LEFT IN
FORMATION		SIZE & KIND		
(T.D. 1135')	Clay and mud 1135-915		8-5/8"	None
	Neat cement 915-905		10"	None
	Permanent bridge at 375 with 2 sacks neat cement and 5 ft. crushed stone on top of bridge; filled with clay to surface			
	<i>Hole lost due to fishing job; Plugged lost hole and spudded right 15 feet for new hole.</i>			
COAL SEAMS		DESCRIPTION OF MONUMENT		
(NAME)		<i>monument not required</i>		
(NAME)				
(NAME)				
(NAME)				

and that the work of plugging and filling said well was completed on the 8th day of November, 19 61.

And further deponents saith not.

Sworn to and subscribed before me this 3rd day of Jan., 1962.

My commission expires:
June 12th 1968

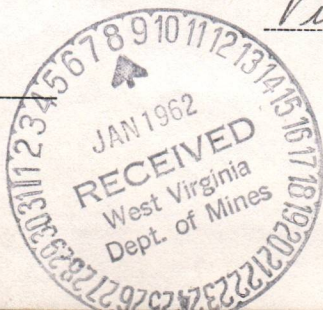

W.A. Lowe
Lloyd Lowe
Virgil Mills
10/27/2023
Notary Public.
Permit No. WAY-1370

AFFIDAVIT OF PLUGGING AND FILLING WELL

AFFIDAVIT SHOULD BE MADE IN TRIPPLICATE. THE COPY MADE BY THE OPERATOR, ONE COPY TO BE RETURNED TO THE
WELL OPERATOR AND THE THIRD COPY (AND EXTRA COPIES IF REQUIRED) SHOULD BE KEPT BY EACH WELL OPERATOR AT HIS RESPECTIVE
ADDRESS.

NAME OF WELL OPERATOR: Pappas Petroleum Company
 NAME OF WELL OPERATOR OR OWNER: None
 ADDRESS: 1020 Kennedy Blvd., Tulsa 3, Oklahoma
 ADDRESS: None
 WELL NAME LOCATION: Butler
 ADDRESS: Wilson Buskirk and Irs J. Buskirk
 COUNTY: Wayne
 COUNTY: Wayne
 STATE: West Virginia
 STATE: West Virginia
 DATE: December 28, 1961
 DATE: November 1961
 SIGNATURE: K. A. Butcher
 SIGNATURE: K. A. BUSKIRK
 SIGNATURE: (Wilson and I. J. Buskirk)

AFFIDAVIT

STATE OF WEST VIRGINIA

County of Wayne

I, the undersigned, being duly sworn according to law, depose and say that they are experienced in the work of
 plugging and filling oil and gas wells and were employed by Pappas Petroleum Company
 well operator, and participated in the work of plugging and filling the above well that said work
 was commenced on the 6th day of November, 1961, and that the well was plugged
 and filled in the following manner:

DATE ON LOG RECORD	FILLING MATERIAL	PIG USES	CASING
(11.11.61)	Clay and mud	8-5/8"	None
	Neat cement	10"	None
	Permanent bridge at with 2 sacks neat cement and 5 ft. crushed stone on top of bridge; filled with clay to surface		

and that the work of plugging and filling said well was completed on the 8th day of
 November, 1961.
 And further deponents say not.

10/27/2023



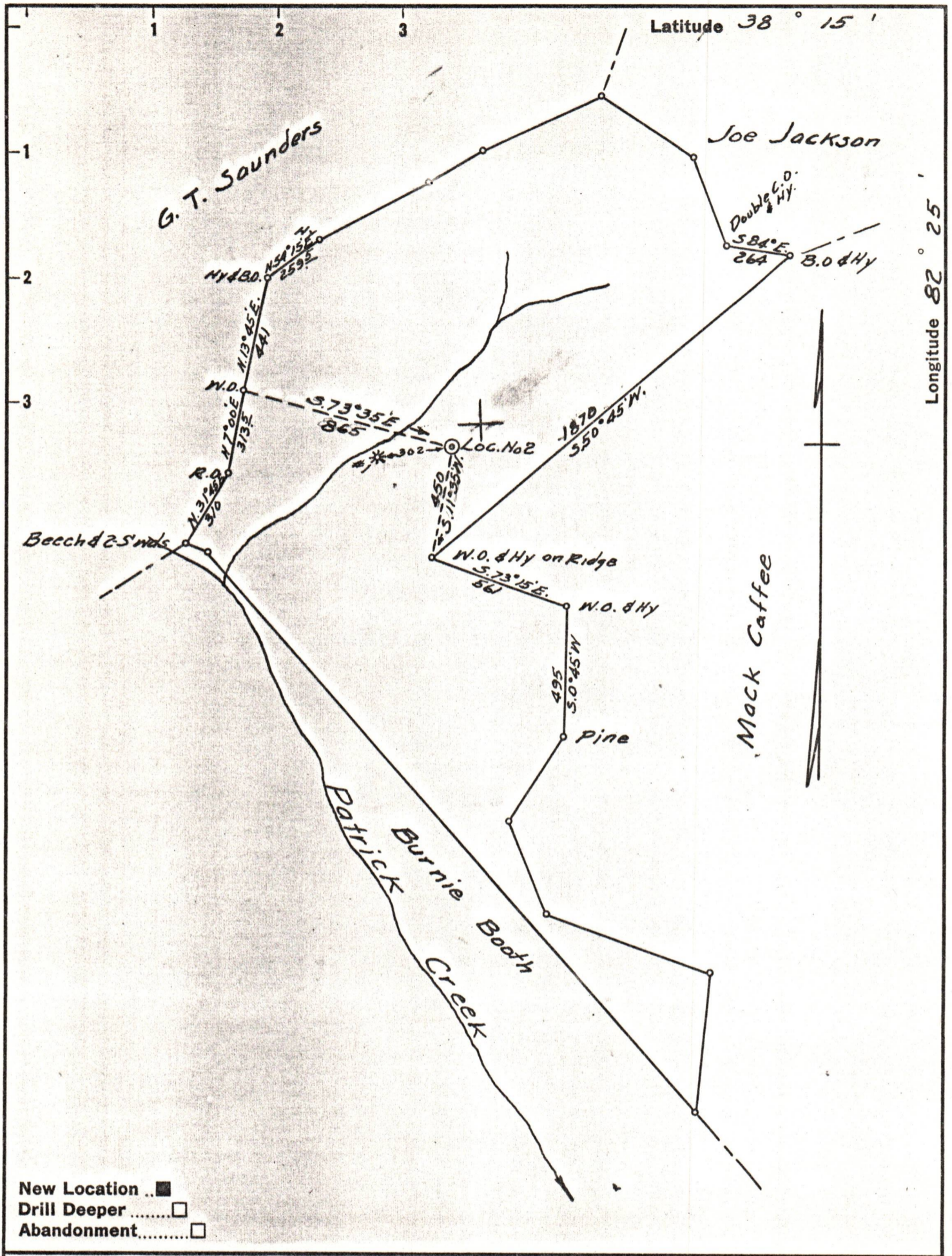

Company PAMPAS PETROLEUM

Address TULSA OKLAHOMA

Farm I. J. & Wilson Buskirk

Tract _____ Acres 74 Lease No. _____

Well (Farm) No. 2 Serial No. _____

Elevation (Spirit Level) 829.9

Quadrangle Wayne

County Wayne District Butler

Engineer G. C. Ewing

Engineer's Registration No. 309

File No. _____ Drawing No. _____

Date 9-23-61 Scale 1" = 500'

STATE OF WEST VIRGINIA
 DEPARTMENT OF MINES
 OIL AND GAS DIVISION
 CHARLESTON

WELL LOCATION MAP

FILE NO. WAY-1370 10/27/2023

+ Denotes location of well on United States Topographic Maps, scale 1 to 62,500, latitude and longitude lines being represented by border lines as shown.

- Denotes one inch spaces on border line of original tracing.