



STATE OF WEST VIRGINIA
DEPARTMENT OF MINES
OIL AND GAS DIVISION

NOTICE OF PROPOSED LOCATION OF OIL AND GAS WELL

To THE DEPARTMENT OF MINES,
Charleston, W. Va.

J. C. Thompson Estate
COAL OPERATOR OR COAL OWNER
Pritchard, W. Va.
ADDRESS

COAL OPERATOR OR COAL OWNER
ADDRESS
Same
OWNER OF MINERAL RIGHTS
ADDRESS

OWENS, LIBBEY-OWENS GAS DEPARTMENT
NAME OF WELL OPERATOR
P. O. Box 4168, Charleston 4, W. Va.
COMPLETE ADDRESS

August 25, 1961
PROPOSED LOCATION
Butler District
Wayne County
Well No. 1 (Serial No. 1146) ^{38°15'} 82°30' E. 908.8
J. C. Thompson Farm
85 Acres

GENTLEMEN:

The undersigned well operator is entitled to drill upon the above named farm or tract of land for oil and gas, ~~having fee title thereto, (or as the case may be)~~ under grant or lease dated June 12, 1958, made by J. C. & Tennessee Thompson, to Owens-Illinois Glass Co. & Libbey-Owens-Ford Glass Co., and recorded on the 30th day of August, 1958, in the office of the County Clerk for said County in Book 49, page 107.

The enclosed plat was prepared by a competent engineer and shows the proposed location of a well to be drilled for oil and gas by the undersigned well operator on the farm and in the Magisterial District and County above named, determined by survey and courses and distances from two permanent points, or land marks.

The undersigned well operator is informed and believes there are no coal operators operating beds of coal beneath said farm or tract of land on which said well is located, or within 500 feet of the boundaries of the same, who have mapped their workings and filed their maps as required by law, excepting the coal operators or coal owners (if any) above named as addressees.

The above named coal operators or coal owners (if any) are notified that any objections they may desire to make to such proposed location, or which they are required to make by Section 3 of said Code, if the drilling of a well at said proposed location will cause a dangerous condition in or about their respective coal mines, must be received by, or filed with the Department of Mines within ten* days from the receipt of a copy of this notice and accompanying plat by said Department. Said coal operators are further notified that forms for use in making such objections will be furnished to them by the Department of Mines promptly on request and that all such objections must set forth as definitely as is reasonably possible the ground or grounds on which such objections are based and indicate the direction and distance the proposed location should be moved to overcome same.

(The next paragraph is to be completed only in Department's copy.)

Copies of this notice and the enclosed plat were mailed by registered mail, or delivered to the above named coal operators or coal owners at their above shown respective address same day before, or on the same day with the mailing or delivery of this copy to the Department of Mines at Charleston, West Virginia.

Very truly yours,

OWENS, LIBBEY-OWENS GAS DEPARTMENT
WELL OPERATOR
P. O. Box 4168
STREET
Charleston 4,
CITY OR TOWN
West Virginia
STATE

10/27/2023



Address of Well Operator }

*Section 3 If no such objections be filed or be found by the department of mines, within said period of ten days from the receipt of said notice and plat by the department of mines, to said proposed location, the department shall forthwith issue to the well operator a drilling permit reciting the filing of such plat, that no objections have been made by the coal operators to the location, or found thereto by the department, and that the same is approved and the well operator authorized to proceed to drill at said location.

1362

September 7, 1961

Owens, Libby-Owens Gas Department
P. O. Box 4168
Charleston 4, West Virginia

Att: Mr. A. H. Smith

Gentlemen:

Enclosed is Permit WAY-1362 for drilling Well
No. 1 on J. C. Thompson Lease, Butler District, Wayne County.

Very truly yours,

Assistant Director
OIL AND GAS DIVISION

MG/n
enclosure
cc Mr. Kenneth E. Butcher, Inspector

Mr. R. C. Tucker, Assistant
State Geologist

10/27/2023

Formation	Color	Hard or Soft	Top ¹⁷	Bottom	Oil, Gas or Water	Depth Found	Remarks
Slate	Light	Soft	845	853			
Sand	Light	Soft	853	901	Salty Water	865-885'	Hole full
Slate	Dark	Soft	901	906			
Sand	Light	Soft	906	926			
Slate	Dark	Soft	926	945			
Sand	Dark	Soft	945	963			
Slate	Dark	Soft	963	1017			
Sand	Light	Soft	1017	1093			
Sand	Light	Med.	1093	1106			
Sand	White	Med.	1106	1137			
Sand	Grey	Med.	1137	1194			
Slate	Dark	Soft	1194	1213	SIM 1206 = Sand IM 1206 Installed 8-5/8" csg. at 1206'		
Sl & Shls	Dark	Soft	1213	1298			
Sand	Light	Med.	1298	1308			
Water Sand	Light	Med.	1308	1323			
Big Lime	Grey	Hard	1323	1342			
Big Lime	White	Hard	1342	1356	SIM 1349 = Sand IM 1349 Installed 7" csg. at 1349' with centralizers at 1340'7" and 1269'		
Big Lime	Yellow	Hard	1356	1368			
Big Lime	White	Hard	1368	1451			
Injun Sand	Grey	Med.	1451	1515			
Injun Sand	Dark	Hard	1515	1580			
Stray Sand	Grey	Med.	1580	1667			
Sl & Shls	Grey	Med.	1667	1790			
Sl & Shls	Grey	Med.	1790	2055			
Coffee Shale	Brown	Soft	2055	2076			
Berea Sand	Grey	Soft	2076	2086	Gas 2080' 9.6 MCF Gas 2085' 41.4 MCF		
Slate	Light	Soft	2086	2087			
Gritty Shell	Light	Hard	2087	2101	12-18-61 Schlumberger logged well. Gamma ray and Temperature logs taken.		
Gritty Shell	Dark	Hard	2101	2106			
Sl & Shls	Grey	Med.	2106	2113			
Gritty Shell	Grey	Hard	2113	2133	Test 2133' 33.2 MCF		
			Total Depth 2133		12-22-61 Installed 4 1/2" csg. at 2133' set on a Casing shoe with 4 centralizers Dowell Division cemented 4 1/2" casing. Circulated with 85 bbls. water and 25 bags cement.		
					12-26-61 Schlumberger perforated 4 1/2" casing from 2084' to 2092', four shots per foot alternating with crack jets and capsule jets.		
					12-28-61 Dowell Division riverfraced Berea using 20,000# 20-40 sand, 250 gal. Mud Acid, and 439 bbls. water.		
					12-29-61 to 1-4-62 Bailed and tested.		
					Final Open Flow: Berea 268 MCF		

10/27/2023

Date January 12, 19 62

APPROVED OWENS, LIBBEY-OWENS GAS DEPARTMENT, Owner

By A. H. Smith
A. H. Smith, Mgr. (Title) Land, Ingrg. & Geol



STATE OF WEST VIRGINIA
DEPARTMENT OF MINES
OIL AND GAS DIVISION / 7

Quadrangle Louise

Permit No. Way-1362

WELL RECORD

Oil or Gas Well GAS
(KIND)

Company OWENS, LIBBEY-OWENS GAS DEPARTMENT
Address P. O. Box 4168, Charleston 4, W. Va.
Farm J. C. Thompson Acres 85

Location (waters) _____
Well No. 1 (Serial No. 1146) Elev. 904.88
District Butler County Wayne

The surface of tract is owned in fee by _____
Address _____

Mineral rights are owned by Fred Demron, Adm.
Address Pritchard, W. Va.

Drilling commenced 10-31-61
Drilling completed 12-21-61

Date Shot _____ From _____ To _____
With _____

Open Flow _____ /10ths Water in _____ Inch
_____ /10ths Merc. in _____ Inch

Volume _____ Cu. Ft.

Rock Pressure _____ lbs. _____ hrs.

Oil _____ bbls., 1st 24 hrs.

WELL ACIDIZED _____

WELL FRACTURED 12-28-61 Riverfraced by Dowell using 20,000# 20-40 sand, 250 Gal. Mud Acid, and 439 bbls. water.

RESULT AFTER TREATMENT Berea 268 MCF

ROCK PRESSURE AFTER TREATMENT 580 lbs. in 83 hours

Fresh Water 184 Feet 695-699 Salt Water 865-885 Feet

Casing and Tubing	Used in Drilling	Left in Well	Packers
Size			Kind of Packer
16			
13			
10 - 3/4"	539'4"	539'4"	Size of
8 x 5/8"	1202'9"	1202'9"	
6 x 7"	1347'3"	1347'3"	Depth set
5 x 7 1/2"	2134'5"	2134'5"	
3			Perf. top <u>2084'</u>
2			Perf. bottom <u>2092'</u>
Liners Used			Perf. top _____
			Perf. bottom _____

CASING CEMENTED 4 1/2" SIZE 2133 No. Ft. 12-22-61 Date
Circulated with 85 bbl. water and 25 bags cement.

COAL WAS ENCOUNTERED AT 166 FEET 24 INCHES
____ FEET _____ INCHES FEET _____ INCHES
____ FEET _____ INCHES FEET _____ INCHES

Formation	Color	Hard or Soft	Top	Bottom	Oil, Gas or Water	Depth	Remarks
Surface	Yellow	Soft	0	10			
Red Rock	Red	Soft	10	20			
Slate	Dark	Soft	20	86			
Red Rock	Red	Soft	86	92			
Slate	Dark	Soft	92	166			
Coal	Black	Soft	166	168			
Slate	Dark	Soft	168	193	Fresh water	184' 3 BPH	
Red Rock	Red	Soft	193	208			
Slate	Light	Soft	208	300			
Sand	Light	Soft	300	310			
Slate	Light	Soft	310	385			
Sand	Light	Soft	385	408			
Slate	Dark	Soft	408	428			
Slate	Dark	Soft	428	458			
Sand	Dark	Soft	458	470			
Slate	Light	Soft	470	506			
Sand	Grey	Soft	506	535			
Slate	Light	Soft	535	545	SIM 540 = Sand IM 536 Installed 10-3/4" casing at 540' set on Larkin Csg. Shoe with casing set in red clay		
Broken Sand	Light	Soft	545	586			
Slate	Grey	Soft	586	677			
Slate	Grey	Soft	677	695			
Sand	Grey	Soft	695	701	Water 695-699'	4 BPH	
Slate	Light	Soft	701	765			
Sand	Light	Soft	765	780			
Slate	Grey	Soft	780	822			
Broken Sand	Light	Soft	822	845			

(over)



<p>1.0 API well number: (If not available, leave blank. 14 digits.)</p>	<p style="font-size: 1.2em;">47-099-1362</p>																	
<p>2.0 Type of determination being sought: (Use the codes found on the front of this form.)</p>	<p style="font-size: 1.2em;">108</p> <p style="font-size: 0.8em;">Section of NGPA</p>		<p style="font-size: 1.2em;">NA</p> <p style="font-size: 0.8em;">Category Code</p>															
<p>3.0 Depth of the deepest completion location: (Only needed if sections 103 or 107 in 2.0 above.)</p>	<p style="font-size: 1.2em;">NA</p> <p style="font-size: 0.8em;">feet</p>																	
<p>4.0 Name, address and code number of applicant: (35 letters per line maximum. If code number not available, leave blank.)</p>	<p style="font-size: 1.2em;">Industrial Gas Corporation</p> <p style="font-size: 0.8em;">Name</p> <p style="font-size: 1.2em;">P. O. Box 1473</p> <p style="font-size: 0.8em;">Street</p> <p style="font-size: 1.2em;">Charleston</p> <p style="font-size: 0.8em;">City</p>			<p style="font-size: 1.2em;">009283</p> <p style="font-size: 0.8em;">Seller Code</p>														
<p>5.0 Location of this well: [Complete (a) or (b).] (a) For onshore wells (35 letters maximum for field name.)</p>	<p style="font-size: 1.2em;">NA</p> <p style="font-size: 0.8em;">Field Name</p> <p style="font-size: 1.2em;">Wayne</p> <p style="font-size: 0.8em;">County</p>		<p style="font-size: 1.2em;">WV</p> <p style="font-size: 0.8em;">State</p>															
<p>(b) For OCS wells:</p>	<p style="font-size: 1.2em;">NA</p> <p style="font-size: 0.8em;">Area Name</p>		<p style="font-size: 1.2em;">NA</p> <p style="font-size: 0.8em;">Block Number</p>															
<p style="font-size: 0.8em;">Date of Lease:</p> <table style="margin: auto; border-collapse: collapse;"> <tr> <td style="border: 1px solid black; width: 15px; height: 15px;"></td> <td style="border: 1px solid black; width: 15px; height: 15px;"></td> <td style="border: 1px solid black; width: 15px; height: 15px;"></td> <td style="border: 1px solid black; width: 15px; height: 15px;"></td> <td style="border: 1px solid black; width: 15px; height: 15px;"></td> <td style="border: 1px solid black; width: 15px; height: 15px;"></td> <td style="border: 1px solid black; width: 15px; height: 15px;"></td> </tr> <tr> <td style="font-size: 0.7em;">Mo.</td> <td style="font-size: 0.7em;">Day</td> <td style="font-size: 0.7em;">Yr.</td> <td colspan="4"></td> </tr> </table>												Mo.	Day	Yr.				
Mo.	Day	Yr.																
<p>(c) Name and identification number of this well: (35 letters and digits maximum.)</p>	<p style="font-size: 1.2em;">J. C. Thompson</p>		<p style="font-size: 1.2em;">1-1146</p>															
<p>(d) If code 4 or 5 in 2.0 above, name of the reservoir: (35 letters maximum.)</p>	<p style="font-size: 1.2em;">NA</p>																	
<p>6.0 (a) Name and code number of the purchaser: (35 letters and digits maximum. If code number not available, leave blank.)</p>	<p style="font-size: 1.2em;">See Addendum "A"</p> <p style="font-size: 1.2em;">Houdaille Industries, Inc.</p> <p style="font-size: 0.8em;">Name</p>			<p style="font-size: 1.2em;">N/Available</p> <p style="font-size: 0.8em;">Buyer Code</p>														
<p>(b) Date of the contract:</p>	<table style="margin: auto; border-collapse: collapse;"> <tr> <td style="border: 1px solid black; width: 15px; height: 15px;"></td> <td style="border: 1px solid black; width: 15px; height: 15px;"></td> <td style="border: 1px solid black; width: 15px; height: 15px;"></td> <td style="border: 1px solid black; width: 15px; height: 15px;"></td> <td style="border: 1px solid black; width: 15px; height: 15px;"></td> <td style="border: 1px solid black; width: 15px; height: 15px;"></td> <td style="border: 1px solid black; width: 15px; height: 15px;"></td> </tr> <tr> <td style="font-size: 0.7em;">Mo.</td> <td style="font-size: 0.7em;">Day</td> <td style="font-size: 0.7em;">Yr.</td> <td colspan="4"></td> </tr> </table>											Mo.	Day	Yr.				
Mo.	Day	Yr.																
<p>(c) Estimated annual production:</p>	<p style="font-size: 1.2em;">5.7</p> <p style="font-size: 0.8em;">MMcf.</p>																	
<p>7.0 Contract price: (As of filing date. Complete to 3 decimal places.)</p>	<table border="1" style="width: 100%; border-collapse: collapse;"> <thead> <tr> <th style="font-size: 0.8em;">(a) Base Price (\$/MMBTU)</th> <th style="font-size: 0.8em;">(b) Tax</th> <th style="font-size: 0.8em;">(c) All Other Prices [Indicate (+) or (-).]</th> <th style="font-size: 0.8em;">(d) Total of (a), (b) and (c)</th> </tr> </thead> <tbody> <tr> <td style="text-align: center;">1 2 8 3</td> <td style="text-align: center;">0 0 5 1</td> <td style="text-align: center;">0 0 0 3</td> <td style="text-align: center;">1 3 3 6</td> </tr> <tr> <td style="text-align: center;">2 . 2 4 3</td> <td style="text-align: center;">0 . 3 0 2</td> <td style="text-align: center;">0 . 0</td> <td style="text-align: center;">2 . 5 4 5</td> </tr> </tbody> </table>	(a) Base Price (\$/MMBTU)	(b) Tax	(c) All Other Prices [Indicate (+) or (-).]	(d) Total of (a), (b) and (c)	1 2 8 3	0 0 5 1	0 0 0 3	1 3 3 6	2 . 2 4 3	0 . 3 0 2	0 . 0	2 . 5 4 5	<p style="font-size: 1.2em;">See Addendum "A"</p>	<p style="font-size: 1.2em;">1 2 8 3</p> <p style="font-size: 1.2em;">0 0 5 1</p> <p style="font-size: 1.2em;">0 0 0 3</p> <p style="font-size: 1.2em;">1 3 3 6</p>			
(a) Base Price (\$/MMBTU)	(b) Tax	(c) All Other Prices [Indicate (+) or (-).]	(d) Total of (a), (b) and (c)															
1 2 8 3	0 0 5 1	0 0 0 3	1 3 3 6															
2 . 2 4 3	0 . 3 0 2	0 . 0	2 . 5 4 5															
<p>8.0 Maximum lawful rate: (As of filing date. Complete to 3 decimal places.)</p>	<p style="font-size: 1.2em;">2 . 2 4 3</p>	<p style="font-size: 1.2em;">0 . 3 0 2</p>	<p style="font-size: 1.2em;">0 . 0</p>	<p style="font-size: 1.2em;">2 . 5 4 5</p>														
<p>9.0 Person responsible for this application:</p>	<table border="1" style="width: 100%; border-collapse: collapse;"> <tr> <td style="width: 30%; font-size: 0.8em;"> Agent/Use Only Date Received by Juris. Agency FEB 28 1979 Date Received by FERC </td> <td style="width: 70%;"> <p style="font-size: 1.2em;">William C. Charlton</p> <p style="font-size: 0.8em;">Name</p> <p style="font-size: 1.2em;">Division Counsel</p> <p style="font-size: 0.8em;">Title</p> <p style="font-size: 1.2em;"><i>William C. Charlton</i></p> <p style="font-size: 0.8em;">Signature</p> <p style="font-size: 1.2em;">02 / 28 / 79</p> <p style="font-size: 0.8em;">Date Application is Completed</p> <p style="font-size: 1.2em;">(304) 342-8166</p> <p style="font-size: 0.8em;">Phone Number</p> </td> </tr> </table>				Agent/Use Only Date Received by Juris. Agency FEB 28 1979 Date Received by FERC	<p style="font-size: 1.2em;">William C. Charlton</p> <p style="font-size: 0.8em;">Name</p> <p style="font-size: 1.2em;">Division Counsel</p> <p style="font-size: 0.8em;">Title</p> <p style="font-size: 1.2em;"><i>William C. Charlton</i></p> <p style="font-size: 0.8em;">Signature</p> <p style="font-size: 1.2em;">02 / 28 / 79</p> <p style="font-size: 0.8em;">Date Application is Completed</p> <p style="font-size: 1.2em;">(304) 342-8166</p> <p style="font-size: 0.8em;">Phone Number</p>												
Agent/Use Only Date Received by Juris. Agency FEB 28 1979 Date Received by FERC	<p style="font-size: 1.2em;">William C. Charlton</p> <p style="font-size: 0.8em;">Name</p> <p style="font-size: 1.2em;">Division Counsel</p> <p style="font-size: 0.8em;">Title</p> <p style="font-size: 1.2em;"><i>William C. Charlton</i></p> <p style="font-size: 0.8em;">Signature</p> <p style="font-size: 1.2em;">02 / 28 / 79</p> <p style="font-size: 0.8em;">Date Application is Completed</p> <p style="font-size: 1.2em;">(304) 342-8166</p> <p style="font-size: 0.8em;">Phone Number</p>																	

10/27/2023

WELL DETERMINATION REPORT

PARTICIPANTS:

DATE:

OCT 19 1979

BUYER-SELLER CODE

WELL OPERATOR: Industrial Gas Corporation 009283

FIRST PURCHASER: Houdaille Industries, Inc.

OTHER: _____

W. Va. Department of Mines, Oil & Gas Division
 WELL DETERMINATION FILE NUMBER
790228-108-099-1362
 Use Above File Number on all Communications
 Relating to Determination of this Well

Qualifies as Section 108, stuffer well.

Robert [Signature]

CHECK EACH ITEM AS COMPLETE OR NOTE WHAT IS MISSING

ITEM NO.

- 1 FERC-121 Items not completed - Line No. _____
- 2 IV-1 - Agent William C. Charlton
- 3 IV-2 - Well Permit
- 4 IV-6 - Well Plat
- 5 IV-35- Well Record Drilling Deepening _____
- 6 IV-36- Gas-Oil Test: Gas Only _____ Was Oil Produced? _____ Ratio _____
- 7 IV-39- Annual Production 2 years
- 8 IV-40- 90 day Production 85 Days off Line: _____
- 9 IV-48- Application for Certification. Complete?
- 10 - 17 IV Form #51 - 52 - 53 - 54 - 55 - 56 - 57 - 58. Complete Affidavit Signed
- 18 - 28 Other: Survey _____ Logs _____ Geological Charts _____ Structure Map _____
 1:4000 Map _____ Well Tabulations _____ Gas Analyses _____
- (5) Date ~~Completed~~: Commenced: 10-31-61
12-28-61 Deepened _____
 Frac: _____
- (5) Production Depth: 2084-92"
- (5) Production Formation: Berea & Galt
- (5) Final Open Flow
 Initial Potential: 268 mcf
- (5) Static R.P. After Frac
58#
- (6) Other Gas Test: _____
- (7) Avg. Daily Gas from Annual Production: $\frac{5373}{364} = 14.8$ mcf
- (8) Avg. Daily Gas from 90-day ending w/1-120 days $\frac{958}{85} = 11.3$ mcf
- (8) Line Pressure: 34# PSIG from Daily Rep
- (5) Oil Production: NO From Completion Report 10/27/2023
- (10-17) Does lease inventory indicate enhanced recovery being done: NO
- (10-17) Is affidavit signed? Notarized?
- Does official well record in the Department confirm the submitted information? yes
- Additional Information _____ Does computer program confirm? _____
- Was Determination Objected to? _____ By Whom? mk

STATE OF WEST VIRGINIA
DEPARTMENT OF MINES, OIL AND GAS DIVISION

Date 02/28, 1979

Operator's Well No. 1-1146

API Well No. 47 - 099 - 1362
State County Permit

WELL CLASSIFICATION FORM

STRIPPER GAS WELL

NGPA Section 108

DESIGNATED AGENT William C. Charlton

ADDRESS P. O. Box 1473

Charleston, WV 25325

WELL OPERATOR Industrial Gas Corporation LOCATION: Elevation 904.88'

ADDRESS P. O. Box 1473

Charleston, WV 25325

Watershed Not Available

Dist. Butler County Wayne Quad. Louisa

GAS PURCHASER *

Gas Purchase Contract No. *

ADDRESS

Meter Chart Code R0510

Date of Contract *

*See FERC-121 - Addendum "A"

* * * * *

Provide a complete inventory of the lease and production equipment used for the well for the previous 24 months or, if less than 24 months, the period the well has been in production. Include a complete list of equipment or processes used in connection with recognized enhanced recovery techniques during completion or production. (Attach separate sheets, if necessary.)

(See Attachment)

List all records reasonably available to you which contain information relevant to a determination of eligibility (including production records, B&O Tax Records and royalty payment records) and indicate the location of such records:

All records required to determine production by meter stations are maintained in Charleston, West Virginia.

B&O Tax Records are located in Charleston, West Virginia, our Boston, Massachusetts office and the Houston, Texas office.

Royalty payment instructions are located in Charleston, West Virginia office and Houston, Texas office.

10/27/2023

Describe the search made of any records listed above:

I have made a diligent search of the production records located in Charleston, West Virginia. They were the records utilized in making the determination herein.

Are you aware of any other information which would tend to be inconsistent with the information specified above? Yes ___ No X. If yes, indicate the type and source of the information.

AFFIDAVIT

I, Lawrence B. Mentzer, having been first sworn according to law, state that I have caused to be made a diligent search of those records hereinbefore indicated in the manner herein described, that the information contained in this document is true and accurate and that on the basis of the records and examinations hereinbefore described, and to the best of my information, knowledge and belief, the well for which this certification is sought qualifies as a stripper well.



STATE OF WEST VIRGINIA,

COUNTY OF Kanawha, TO WIT:

I, Charlotte I. Mathews, a Notary Public in and for the state and county aforesaid, do certify that Lawrence B. Mentzer whose name is signed to the writing above, bearing date the 28 day of February, 19 79, has acknowledged the same before me, in my county aforesaid.

Given under my hand and official seal this 28 day of February, 19 79.

My term of office expires on the 5th day of December, 19 85.

10/27/2023

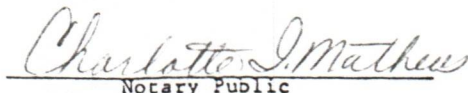

Notary Public

STATE OF WEST VIRGINIA
DEPARTMENT OF MINES, OIL AND GAS DIVISION

Date February 28, 1979

Operator's Well No. 1-1146
API Well No. 47 - 099 - 1362
State County Permit
Previous File No. NA
(If Applicable)

STATE APPLICATION FOR WELL CLASSIFICATION

WELL OPERATOR Industrial Gas Corporation

DESIGNATED AGENT William C. Charlton

ADDRESS P. O. Box 1473
Charleston, W. Va. 25325

ADDRESS P. O. Box 1473
Charleston, W. Va. 25325

Gas Purchase Contract No. * _____ and Date _____
(Month, day and year)

Meter Chart Code R0510

Name of First Purchaser * _____

(Street or P. O. Box)

(City)

(State)

(Zip Code)

FERC Seller Code 009283

FERC Buyer Code _____

TYPE OF DETERMINATION BEING SOUGHT:

- (1) Initial determination (See FERC Form 121.) 108 Section of NGPA NA Category Code
- (2) Determination that increased production is the result of enhanced recovery technology.
- (3) Determination of a seasonally affected well.

(*See FERC-121 Addendum "A")

William C. Charlton Division Counsel
Name (Print) Title

William C. Charlton
Signature

P. O. Box 1473
Street or P. O. Box

Charleston, W. Va. 25325
City State (Zip Code)

(304) 342-8166
Area Phone Number
Code

(Certificate of Proof of Service to Purchaser)

See Separate Certificate Attached

(All of the above to be completed by the Operator/Applicant)

(To be completed by Jurisdictional Agency. Executed copy to be returned to Operator/Applicant and purchaser, if known).

The Department of Mines has received a request, for certification of the above described well as meeting the requirements of Section _____ under the Natural Gas Policy Act of 1978. (NGPA); or for determination that increased production is the result of enhanced recovery technology under Section 108 of (NGPA); or for determination of a seasonally affected well under Section 108 of (NGPA)

All interested parties are hereby notified that on the _____ day of _____, 19____, at the office of the Oil and Gas Division in Charleston, West Virginia, or as soon thereafter as it may be heard, there will be a public hearing, if requested, or if objection is filed.

This Application is assigned File No. _____.

Initial review of information submitted indicates the well is. is not entitled to certification as claimed under the Natural Gas Policy Act (NGPA). A review of this evidence and any additional evidence will be made at the time appointed for a public hearing or as soon thereafter as the matter may be heard.

Unless objections are timely filed or a request for a hearing is made within fifteen (15) days, a hearing will not be held except on ex parte motion of the department and the matter will go to determination.

WEST VIRGINIA DEPARTMENT OF MINES

[Signature]
Director

By _____

Title 10/27/2023

FEB 28 1979

Date received by
Jurisdictional Agency

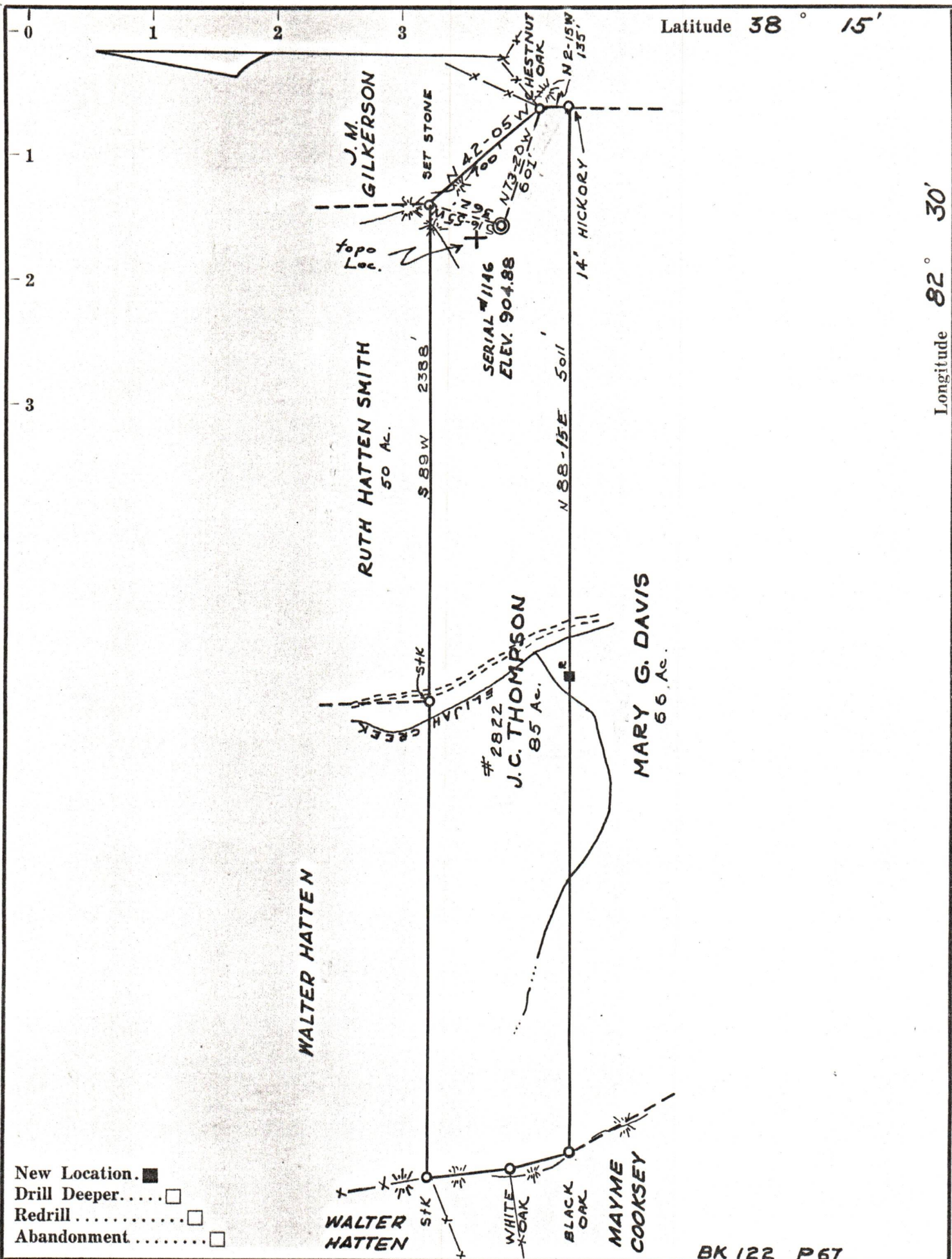

- New Location.
- Drill Deeper.....
- Redrill.....
- Abandonment.....

Company OWENS, LIBBEY - OWENS GAS DEPT.

Address BOX 4168 CHARLESTON 4 WEST VA

Farm J. C. THOMPSON

Tract _____ Acres 85 Lease No. 2822

Well (Farm) No. 1 Serial No. 1146

Elevation (Spirit Level) 904.88

Quadrangle LOUISA

County WAYNE District BUTLER

Engineer T.S. Flannery

Engineer's Registration No. 269

File No. _____ Drawing No. _____

Date AUG. 25, 1961 Scale 1" = 600'

STATE OF WEST VIRGINIA
DEPARTMENT OF MINES
OIL AND GAS DIVISION
CHARLESTON

WELL LOCATION MAP
FILE NO. WAY-1362

+ Denotes location of well on United States Topographic Maps, scale 1 to 62,500, latitude and longitude lines being represented by border lines as shown.

— Denotes one inch spaces on border line of original tracing.