





Formation	Color	Hard or Soft	Top <sup>23</sup>	Bottom	Oil, Gas or Water	Depth Found	Remarks
Sand	Dark	Med.	1410	1430			
Slate	Dark	Soft	1430	1440			
Sand	Light	Hard	1440	1456			
Slate	Light	Soft	1456	1459			
Slate	Dark	Soft	1459	1482			
Slate	Light	Soft	1482	1498			
Red Rock	Red	Soft	1498	1504			
Slate	Light	Soft	1504	1510			
Slate	Dark	Soft	1510	1540			
Little Lime	Dark	Hard	1540	1564			
Break	Dark	Soft	1564	1568			
Big Lime	Light	Hard	1568	1592	SIM 1571 =	Sand IM 1568	
Big Lime	Grey	Hard	1592	1615			
Big Lime	Light	Hard	1615	1627			
					<u>11-19-60</u>		
					Installed 7" casing at 1621' on shoe with 2 centralizers set at 1614'5" and 1578'10"		
Big Lime	Yellow	Med.	1627	1653			
Big Lime	Grey	Hard	1653	1753	Gas 1703'		10.6 MCF
Big Lime	Light	Hard	1753	1770			
Red Rock	---	Med.	1770	1788	Test 1775'		5.0 MCF
Grey Injun	Grey	Med.	1788	1821	Gas 1791'		8.5 MCF
					Gas 1800'		29. MCF
Sand, Bro.	Dark	Med.	1821	1856			
Slate	Dark	Soft	1856	1861			
Sl & Shls	Light	Hard	1861	1897			
Sl & Shls	Dark	Med.	1897	1945			
Sl & Shls	Light	Med.	1945	1995			
Slate	Light	Soft	1995	2053			
Sl & Shls	Light	Soft	2053	2208	Test 2106'		22.9 MCF
Shells, Pkr.	Light	Hard	2208	2220	Gas 2120'		23.7 MCF
Slate	Dark	Soft	2220	2275			
Sl & Shls	Grey	Med.	2275	2314			
Sl & Shls	Dark	Med.	2314	2325			
Coffee Shale	Brown	Med.	2325	2347	Test 2346'		20. MCF
Berea	Light	Hard	2347	2350			
Berea	Grey	Hard	2350	2365	Gas 2365'		27.7 MCF
Berea	Light	Hard	2365	2374	Gas 2370'		28.4 MCF
Slate	Light	Med.	2374	2389			
Shells	Grey	Hard	2389	2408			
Slate	Grey	Med.	2408	2412			
Shells	Grey	Hard	2412	2425			
Shells	Dark	Med.	2425	2429			
Br. Shale	Brown	Med.	2429	2490			
Shells	Grey	Hard	2490	2496			
Slate	Grey	Med.	2496	2506			
Sl & Shls	Light	Med.	2506	2541			
Slate	Grey	Med.	2541	2550			
Shells	Grey	Hard	2550	2562			
Slate	Grey	Soft	2562	2570			
Sl & Shls	Light	Med.	2570	2596			
Slate	Grey	Med.	2596	2605			
Shells	Grey	Hard	2605	2613			
Sl & Shls	Light	Med.	2613	2636			
Sl & Shls	Grey	Med.	2636	2660			
Sl & Shls	Light	Med.	2660	2700			
Slate	Grey	Med.	2700	2733			
Slate	Light	Soft	2733	2793			
Shells	Grey	Hard	2793	2800			
Slate	White	Soft	2800	2843	Test 2835'		23.7 MCF
Br. Shale	Brown	Med.	2843	2940	Gas 2847'		25.6 MCF
					Gas 2866'		27.3 MCF
Slate	Light	Med.	2940	2950			
Br. Shale	Brown	Med.	2950	3036	SIM 3036 =	Sand IM 3034	
Br. Shale	Brown	Soft	3036	3065	Test 3056'		27.3 MCF
					Gas 3065'		30.0 MCF

08/25/2023

Date January 17, 1961

APPROVED OWENS, LIBBEY-OWENS GAS DEPARTMENT, Owner

By *C. H. Smith*  
A. H. Smith, Mgr (Title) Land, Engrg. & Geol.





STATE OF WEST VIRGINIA  
DEPARTMENT OF MINES  
OIL AND GAS DIVISION 23

Quadrangle Wayne

Permit No. Way-1321

**WELL RECORD**

Oil or Gas Well GAS  
(KIND)

Company OWENS, LIBBEY-OWENS GAS DEPARTMENT  
Address P. O. BOX 4168, Charleston 4, W. Va.  
Farm Wilson Coal Land Co. Acres 9872.23  
Location (waters) \_\_\_\_\_  
Well No. 81 (Serial No. 1111) Elev. 996.  
District Grant County Wayne  
The surface of tract is owned in fee by \_\_\_\_\_  
Address \_\_\_\_\_  
Mineral rights are owned by Owens, Libbey-Owens Gas  
Department Address Charleston, W. Va.  
Drilling commenced 10-25-60  
Drilling completed 12-21-60  
Date Shot 12-27-60 From 2800 To 3354  
With 5,350 lbs. Trojan Powder  
Open Flow /10ths Water in \_\_\_\_\_ Inch  
/10ths Merc. in \_\_\_\_\_ Inch  
Volume Br. Shale 66 MCF; Big Injun 22 M Cu. Ft.  
Rock Pressure Br. Shale 410 lbs. 43 hrs.  
Big Injun 452 lbs. 43 hrs.  
Oil \_\_\_\_\_ bbls., 1st 24 hrs.  
Fresh water 210; 390 feet feet  
Salt water 1200 feet feet

Casing and Tubing	Used in Drilling	Left in Well	Packers
Size			
16			Kind of Packer
13			"Oilwell" Hookwall
10			Size of
8 5/8	343'6"	343'6"	3 1/2 x 7 x 16
6 3/4	1617'6"	1617'6"	Depth set
5 3/16			2206 - 2210
3 1/2	----	2213'3"	Perf. top
2			Perf. bottom
Liners Used			Perf. top
			Perf. bottom

CASING CEMENTED \_\_\_\_\_ SIZE \_\_\_\_\_ No. Ft. \_\_\_\_\_ Date \_\_\_\_\_

COAL WAS ENCOUNTERED AT \_\_\_\_\_ FEET \_\_\_\_\_ INCHES  
\_\_\_\_\_ FEET \_\_\_\_\_ INCHES FEET \_\_\_\_\_ INCHES  
\_\_\_\_\_ FEET \_\_\_\_\_ INCHES FEET \_\_\_\_\_ INCHES

Formation	Color	Hard or Soft	Top	Bottom	Oil, Gas or Water	Depth Found	Remarks
Sand	White	Med.	---	100			
Sand	Dark	Med.	100	177			
Slate	Dark	Soft	177	185			
Sand	Light	Med.	185	204			
Bro. Sand	Light	Soft	204	242	Water at 210', enough to drill with		
Sand	Dark	Med.	242	263			
Slate	Dark	Soft	263	274			
Sand	Light	Med.	274	293			
Sl & Sand	Light	Soft	293	344	11-1-60		
					Installed 8-5/8" casing at 344' on shoe with 2 centralizers set at 336'9" and 298'8"		
Sand, Bro.	Light	Med.	344	370			
Sand	Dark	Med.	370	440	Water at 390', 4 BPH		
Sand	Dark	Soft	440	460			
Slate	Dark	Soft	460	470			
Sand	Light	Soft	470	520			
Sl & Shls	Dark	Med.	520	590	Water about gone at 590'		
Sand	Light	Med.	590	650			
Slate	Dark	Soft	650	667			
Sl & Shls	Black	Med.	667	732			
Sl & Shls	Dark	Soft	732	870			
Sand	Dark	Hard	870	905			
Slate	Dark	Soft	905	1050			
Sand	White	Med.	1050	1090			
Slate	Dark	Soft	1090	1095			
Sl & Shls	Dark	Hard	1095	1113			
Sand	Light	Med.	1113	1130			
Salt Sand	White	Med.	1130	1218			
					Water, hole full at 1200'		
Sand	White	Med.	1218	1264			
Salt Sand, Bro.	Dark	Med.	1264	1301			
Sl & Shls	Dark	Muddy	1301	1333			
Sand, Bro.	Dark	Med.	1333	1369	Water level 400' at 1369		
Sand	Light	Med.	1369	1395			
Slate	Dark	Soft	1395	1410			



08/25/2023









STATE OF WEST VIRGINIA  
DEPARTMENT OF MINES  
OIL AND GAS DIVISION 23 A

Quadrangle Wayne

Permit No. Way-1321

WELL RECORD

CONTINUED

Oil or Gas Well GAS  
(KIND)

Company OWENS, LIBBEY-OWENS GAS DEPARTMENT  
Address P. O. BOX 4168, Charleston 4, W. Va.  
Farm Wilson Coal Land Co. Acres 9872.23  
Location (waters) \_\_\_\_\_  
Well No. 81 (Serial No. 1111) Elev. 996.  
District Grant County Wayne  
The surface of tract is owned in fee by \_\_\_\_\_  
Address \_\_\_\_\_  
Mineral rights are owned by \_\_\_\_\_  
Address \_\_\_\_\_  
Drilling commenced \_\_\_\_\_  
Drilling completed \_\_\_\_\_  
Date Shot \_\_\_\_\_ From \_\_\_\_\_ To \_\_\_\_\_  
With \_\_\_\_\_  
Open Flow \_\_\_\_\_ /10ths Water in \_\_\_\_\_ Inch  
\_\_\_\_\_ /10ths Merc. in \_\_\_\_\_ Inch  
Volume \_\_\_\_\_ Cu. Ft.  
Rock Pressure \_\_\_\_\_ lbs. \_\_\_\_\_ hrs.  
Oil \_\_\_\_\_ bbls., 1st 24 hrs.  
Fresh water \_\_\_\_\_ feet \_\_\_\_\_ feet  
Salt water \_\_\_\_\_ feet \_\_\_\_\_ feet

Casing and Tubing	Used in Drilling	Left in Well	Packers
Size			Kind of Packer
16			
13			Size of
10			
8 1/4			Depth set
6 5/8			
5 3/16			Perf. top
3			Perf. bottom
2			
Liners Used			Perf. top
			Perf. bottom

CASING CEMENTED \_\_\_\_\_ SIZE \_\_\_\_\_ No. Ft. \_\_\_\_\_ Date \_\_\_\_\_

COAL WAS ENCOUNTERED AT \_\_\_\_\_ FEET \_\_\_\_\_ INCHES  
\_\_\_\_\_ FEET \_\_\_\_\_ INCHES \_\_\_\_\_ FEET \_\_\_\_\_ INCHES  
\_\_\_\_\_ FEET \_\_\_\_\_ INCHES \_\_\_\_\_ FEET \_\_\_\_\_ INCHES

Formation	Color	Hard or Soft	Top	Bottom	Oil, Gas or Water	Depth Found	Remarks
Br. Shale	Brown	Med.	3065	3116			
Br. Shale	Brown	Soft	3116	3153	Test 3153'		27.3 MCF
Br. Shale	Brown	Med.	3153	3305	Gas 3164'		29. MCF
					Test 3209'		29. MCF
					Gas-3220'		29.5 MCF
					Test 3305'		29. MCF
Br. Shale	Brown	Soft	3305	3335	Gas 3316'		30.3 MCF
Slate	White	Soft	3335	3356			
			Total Depth 3356		SIM 3356 = Sand IM 3357		
					12-27-60		
					Shot with 5,350# Trojan Powder from 2800 to 3354 (1:36 P.M.)		
					Test Before Shot:		35 MCF
					" 15 Min. After Shot:		590 MCF
					" 1 Hr. " "		213 MCF
					" 23 Hrs. " "		92 MCF
					12-28-60		
					Installed 3 1/2" tubing at 2213' with "Oilwell" Hookwall Pkr. set from 2206' to 2210'		
					Final Open Flow:		
					Br. Shale		66 MCF
					Big Injun		22 MCF
							88 MCF
					Shut-in in 3 1/2" tubing at 6:50 P.M. 29 Hrs. after shot. 08/25/2023		

(Over)

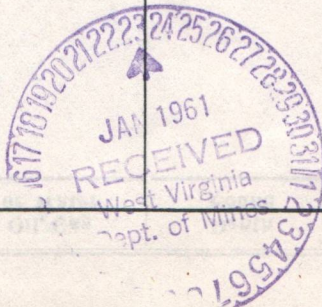



1.0 API well number: (If not available, leave blank. 14 digits.)	47-099-1321															
2.0 Type of determination being sought: (Use the codes found on the front of this form.)	108 Section of NGPA	NA Category Code														
3.0 Depth of the deepest completion location: (Only needed if sections 103 or 107 in 2.0 above.)	NA feet															
4.0 Name, address and code number of applicant: (35 letters per line maximum. If code number not available, leave blank.)	Industrial Gas Corporation Name P. O. Box 1473 Street Charleston City		WV State	25325 Zip Code  009283 Seller Code												
5.0 Location of this well: [Complete (a) or (b).] (a) For onshore wells (35 letters maximum for field name.)	NA Field Name Wayne County		WV State													
(b) For OCS wells:	NA Area Name		NA Block Number  Date of Lease: Mo. Day Yr.      NA OCS Lease Number													
(c) Name and identification number of this well: (35 letters and digits maximum.)	Wilson Coal Land Co.    81-1111															
(d) If code 4 or 5 in 2.0 above, name of the reservoir: (35 letters maximum.)	NA															
6.0 (a) Name and code number of the purchaser: (35 letters and digits maximum. If code number not available, leave blank.)	See Addendum "A" Houdaille Industries, Inc. Name		N/Available Buyer Code													
(b) Date of the contract:	1, 2, 2, 6, 7, 3 Mo. Day Yr.															
(c) Estimated annual production:	8.4 MMcf.															
7.0 Contract price: (As of filing date. Complete to 3 decimal places.)	(a) Base Price (\$/MMBTU) 1 2 8 3	(b) Tax 0 0 5 1	(c) All Other Prices [Indicate (+) or (-).] 0 0 0 3	(d) Total of (a), (b) and (c) 1 3 3 6												
8.0 Maximum lawful rate: (As of filing date. Complete to 3 decimal places.)	2.2 4 3	0.3 0 2	0.0	2.5 4 5												
9.0 Person responsible for this application:	<table border="1" style="width:100%; border-collapse: collapse;"> <tr> <td style="width:30%; text-align: center;">Agency Use Only</td> <td colspan="3" style="text-align: center;">William C. Charlton    Division Counsel</td> </tr> <tr> <td style="text-align: center;">Date Received by Juris. Agency FEB 28 1979</td> <td colspan="3" style="text-align: center;">Name <i>William C. Charlton</i> Signature</td> </tr> <tr> <td style="text-align: center;">Date Received by FERC</td> <td style="text-align: center;">02/ 28/79 Date Application is Completed</td> <td colspan="2" style="text-align: center;">(304) 342-8166 Phone Number</td> </tr> </table>				Agency Use Only	William C. Charlton    Division Counsel			Date Received by Juris. Agency FEB 28 1979	Name <i>William C. Charlton</i> Signature			Date Received by FERC	02/ 28/79 Date Application is Completed	(304) 342-8166 Phone Number	
Agency Use Only	William C. Charlton    Division Counsel															
Date Received by Juris. Agency FEB 28 1979	Name <i>William C. Charlton</i> Signature															
Date Received by FERC	02/ 28/79 Date Application is Completed	(304) 342-8166 Phone Number														

08/25/2023



WELL DETERMINATION REPORT

PARTICIPANTS:

DATE: OCT 10 1979

BUYER-SELLER CODE

WELL OPERATOR: Industrial Gas Corporation

009283

FIRST PURCHASER: Houdaille Industries, Inc.

OTHER: \_\_\_\_\_

W. Va. Department of Mines, Oil & Gas Division  
 WELL DETERMINATION FILE NUMBER  
790228-108-099-1321  
 Use Above File Number on all Communications  
 Relating to Determination of this Well

*Qualifies as Section 108, storage well.*  
*Robert [Signature]*

CHECK EACH ITEM AS COMPLETE OR NOTE WHAT IS MISSING

ITEM NO.

- 1 FERC-121  Items not completed - Line No. \_\_\_\_\_
- 2 IV-1 - Agent William C. Charlton
- 3 IV-2 - Well Permit
- 4 IV-6 - Well Plat
- 5 IV-35- Well Record  Drilling  Deepening \_\_\_\_\_
- 6 IV-36  Gas-Oil Test: Gas Only \_\_\_\_\_ Was Oil Produced? \_\_\_\_\_ Ratio \_\_\_\_\_
- 7 IV-39- Annual Production 2 years
- 8 IV-40- 90 day Production 85 Days off Line: \_\_\_\_\_
- 9 IV-48- Application for Certification. Complete?
- 10 - 17 IV Form #51 - 52 - 53 - 54 - 55  56  57 - 58. Complete  Affidavit Signed
- 18 - 28 Other: Survey \_\_\_\_\_ Logs \_\_\_\_\_ Geological Charts \_\_\_\_\_ Structure Map \_\_\_\_\_  
 1:4000 Map \_\_\_\_\_ Well Tabulations \_\_\_\_\_ Gas Analyses \_\_\_\_\_
- (5) Date Commenced: 10-25-60  
Completed: 12-27-60 Deepened \_\_\_\_\_  
Frac:
- (5) Production Depth: 1653-1753; 1788-1821; 2053-2268; 2365-2374; 3153-3335;
- (5) Production Formation: Big Lima; Grey InJun; Sl & Shls; Berea; Br. Shale;
- (5) Final Open Flow  
 Initial Potential: 88 MCFD
- (5) After Frac  
 Static R.P. Br. Shale 410# 43hrs; Big InJun 452# 43hrs
- (6) Other Gas Test: \_\_\_\_\_
- (7) Avg. Daily Gas from Annual Production  $\left(\frac{8377}{364}\right) = 23.01$  MCF
- (8) Avg. Daily Gas from 90-day ending w/1-120 days  $\left(\frac{2177}{85}\right) = 25.61$  MCF
- (8) Line Pressure: 38# PSIG from Daily Report
- (5) Oil Production: NO From Completion Report 08/25/2023
- (10-17) Does lease inventory indicate enhanced recovery being done: NO
- (10-17) Is affidavit signed?  Notarized?

Does official well records on the Department confirm the submitted information? yes

Additional Information \_\_\_\_\_ Does computer program confirm? \_\_\_\_\_

Was Determination Objective? \_\_\_\_\_ By Whom? MJK



STATE OF WEST VIRGINIA  
DEPARTMENT OF MINES, OIL AND GAS DIVISION

Date 02/28, 1979  
Operator's Well No. 81-1111  
API Well No. 47 - 099 - 1321  
State County Permit

WELL CLASSIFICATION FORM

STRIPPER GAS WELL  
NGPA Section 108

DESIGNATED AGENT William C. Charlton  
ADDRESS P. O. Box 1473  
Charleston, WV 25325

WELL OPERATOR Industrial Gas Corporation LOCATION: Elevation 996'  
ADDRESS P. O. Box 1473 Watershed Not Available  
Charleston, WV 25325 Dist. Grant County Wayne Quad. Wayne  
GAS PURCHASER \* Gas Purchase Contract No. \*  
ADDRESS Meter Chart Code R0002  
Date of Contract \*

\*See FERC-121 - Addendum "A"

\* \* \* \* \*

Provide a complete inventory of the lease and production equipment used for the well for the previous 24 months or, if less than 24 months, the period the well has been in production. Include a complete list of equipment or processes used in connection with recognized enhanced recovery techniques during completion or production. (Attach separate sheets, if necessary.)

(See Attachment)

List all records reasonably available to you which contain information relevant to a determination of eligibility (including production records, B&O Tax Records and royalty payment records) and indicate the location of such records:

All records required to determine production by meter stations are maintained in Charleston, West Virginia.

B&O Tax Records are located in Charleston, West Virginia, our Boston, Massachusetts office and the Houston, Texas office.

Royalty payment instructions are located in Charleston, West Virginia office and Houston, Texas office.

08/25/2023



Describe the search made of any records listed above:

I have made a diligent search of the production records located in Charleston, West Virginia. They were the records utilized in making the determination herein.

Are you aware of any other information which would tend to be inconsistent with the information specified above? Yes  No . If yes, indicate the type and source of the information.

AFFIDAVIT

I, Lawrence B. Mentzer, having been first sworn according to law, state that I have caused to be made a diligent search of those records hereinbefore indicated in the manner herein described, that the information contained in this document is true and accurate and that on the basis of the records and examinations hereinbefore described, and to the best of my information, knowledge and belief, the well for which this certification is sought qualifies as a stripper well.



STATE OF WEST VIRGINIA,

COUNTY OF Kanawha, TO WIT:

I, Charlotte I. Mathews, a Notary Public in and for the state and county aforesaid, do certify that Lawrence B. Mentzer whose name is signed to the writing above, bearing date the 28 day of February, 19 79, has acknowledged the same before me, in my county aforesaid.

Given under my hand and official seal this 28 day of February, 1979.

My term of office expires on the 5th day of December, 1985.

08/25/2023

Charlotte I. Mathews  
Notary Public



Operator's Well No. 81-1111

API Well No. 47 - 099 - 1321  
State County Permit

STATE APPLICATION FOR WELL CLASSIFICATION

Previous File No. NA  
(If Applicable)

WELL OPERATOR Industrial Gas Corporation

DESIGNATED AGENT William C. Charlton

ADDRESS P. O. Box 1473  
Charleston, W. Va. 25325

ADDRESS P. O. Box 1473  
Charleston, W. Va. 25325

Gas Purchase Contract No. \* \_\_\_\_\_ and Date \_\_\_\_\_  
(Month, day and year)

Meter Chart Code R0002

Name of First Purchaser \* \_\_\_\_\_

(Street or P. O. Box)

(City)

(State)

(Zip Code)

FERC Seller Code 009283

FERC Buyer Code \_\_\_\_\_

TYPE OF DETERMINATION BEING SOUGHT:

- (1) Initial determination (See FERC Form 121.) Section of NGPA 108 Category Code NA
- (2) Determination that increased production is the result of enhanced recovery technology.
- (3) Determination of a seasonally affected well.

(\*See FERC-121 Addendum "A" )

William C. Charlton Division Counsel  
Name (Print) Title

[Signature]  
Signature

P. O. Box 1473

Street or P. O. Box

Charleston, W. Va. 25325

City State (Zip Code)

(304) 342-8166  
Area Code Phone Number

(Certificate of Proof of Service to Purchaser)

See Separate Certificate Attached

(All of the above to be completed by the Operator/Applicant)

(To be completed by Jurisdictional Agency. Executed copy to be returned to Operator/Applicant and purchaser, if known).

The Department of Mines has received a request,  for certification of the above described well as meeting the requirements of Section \_\_\_\_\_ under the Natural Gas Policy Act of 1978, (NGPA);  or for determination that increased production is the result of enhanced recovery technology under Section 108 of (NGPA);  or for determination of a seasonally affected well under Section 108 of (NGPA)

All interested parties are hereby notified that on the \_\_\_\_\_ day of \_\_\_\_\_, 19\_\_\_\_, at the office of the Oil and Gas Division in Charleston, West Virginia, or as soon thereafter as it may be heard, there will be a public hearing, if requested, or if objection is filed.

This Application is assigned File No. \_\_\_\_\_

Initial review of information submitted indicates the well  is.  is not entitled to certification as claimed under the Natural Gas Policy Act (NGPA). A review of this evidence and any additional evidence will be made at the time appointed for a public hearing or as soon thereafter as the matter may be heard.

Unless objections are timely filed or a request for a hearing is made within fifteen (15) days, a hearing will not be held except on ex parte motion of the department and the matter will go to determination.

WEST VIRGINIA DEPARTMENT OF MINES

[Signature]

Director

FEB 28 1979

Date received by Jurisdictional Agency \_\_\_\_\_

By \_\_\_\_\_ Title \_\_\_\_\_

08/25/2023



U.S. DEPARTMENT OF ENERGY  
Federal Energy Regulatory Commission  
Washington, D.C. 20426

**APPLICATION FOR DETERMINATION OF THE MAXIMUM LAWFUL  
PRICE UNDER THE NATURAL GAS POLICY ACT (NGPA)**  
(Sections 102, 103, 107 and 108)

**PLEASE READ BEFORE COMPLETING THIS FORM:**

General Instructions:

Complete this form if you are applying for price classification under sections 102, 103, 107 or 108 of the NGPA. A separate application is required for each well. If any reservoir qualifies for a category which differs from the category applicable to the producing well, separate applications must be made for the producing well and the reservoir. Complete each appropriate item on the reverse side of this page. The code numbers used in items 4.0 and 6.0 can be obtained from the Buyer/Seller Code Book. If there is more than one purchaser or contract, identify the additional information in the space below. Enter any additional remarks in the space below.

Submit the completed application to the appropriate Jurisdictional Agency as listed in title 18 of the CFR, part 274.501. If there are any questions, call (202) 275-4539.

Specific Instructions for Item 2.0, Type of Determination:

<u>Section of NGPA</u>	<u>Category Code</u>	<u>Description</u>
102	1	New OCS Lease
102	2	New onshore well (2.5 mile test)
102	3	New onshore well (1,000 feet deeper test)
102	4	New onshore reservoir
102	5	New reservoir on old OCS Lease
103	-	New onshore production well
107	-	High cost natural gas
108	-	Stripper well

Other Purchasers/Contracts:

<u>Contract Date</u> (Mo. Day Yr.)	<u>Purchaser</u>	<u>Buyer Code</u>
06/08/79	Industrial Gas Corporation	009283
_____	_____	_____
_____	_____	_____

Remarks:



FERC-121

1.0 API well number: (If not available, leave blank. 14 digits.)	<u>47- 099-1321</u>																												
2.0 Type of determination being sought: (Use the codes found on the front of this form.)	<u>107</u> Section of NGPA		<u>NA</u> Category Code																										
3.0 Depth of the deepest completion location: (Only needed if sections 103 or 107 in 2.0 above.)	<u>NA</u> feet																												
4.0 Name, address and code number of applicant: (35 letters per line maximum. If code number not available, leave blank.)	<u>Tug Fork Corporation</u> Name		<u>N/A</u> Seller Code																										
	<u>P. O. Box 3711</u> Street																												
	<u>Charleston</u>		<u>WV</u>	<u>25337</u>																									
	City		State	Zip Code																									
5.0 Location of this well: [Complete (a) or (b).] (a) For onshore wells (35 letters maximum for field name.)	<u>NA</u> Field Name																												
	<u>Wayne</u>		<u>WV</u>																										
	County		State																										
(b) For OCS wells:	<u>NA</u> Area Name		<u>NA</u> Block Number																										
	Date of Lease:																												
	<table border="1" style="margin: auto;"> <tr> <td style="width: 20px;">Mo.</td> <td style="width: 20px;">Day</td> <td style="width: 20px;">Yr.</td> </tr> <tr> <td style="text-align: center;"> </td> <td style="text-align: center;"> </td> <td style="text-align: center;"> </td> </tr> </table>		Mo.	Day	Yr.				<u>NA</u> OCS Lease Number																				
Mo.	Day	Yr.																											
(c) Name and identification number of this well: (35 letters and digits maximum.)	<u>Wilson Coal Land Co.</u>		<u>81-1111</u>																										
(d) If code 4 or 5 in 2.0 above, name of the reservoir: (35 letters maximum.)	<u>NA</u>																												
6.0 (a) Name and code number of the purchaser: (35 letters and digits maximum. If code number not available, leave blank.)	<u>Tennessee Gas Pipeline Company</u> Name		<u>018629</u> Buyer Code																										
(b) Date of the contract:	<table border="1" style="margin: auto;"> <tr> <td style="width: 20px;">Mo.</td> <td style="width: 20px;">Day</td> <td style="width: 20px;">Yr.</td> </tr> <tr> <td style="text-align: center;">0</td> <td style="text-align: center;">8</td> <td style="text-align: center;">1,7,8,0</td> </tr> </table>				Mo.	Day	Yr.	0	8	1,7,8,0																			
Mo.	Day	Yr.																											
0	8	1,7,8,0																											
(c) Estimated annual production:	<u>8.4</u> MMcf.																												
	(a) Base Price (\$/MMBTU)	(b) Tax	(c) All Other Prices [Indicate (+) or (-).]	(d) Total of (a), (b) and (c)																									
7.0 Contract price: (As of filing date. Complete to 3 decimal places.)	<u>2.404</u>	<u>-.324</u>	<u>0.0</u>	<u>2.728</u>																									
8.0 Maximum lawful rate: (As of filing date. Complete to 3 decimal places.)	<u>2.404</u>	<u>-.324</u>	<u>0.0</u>	<u>2.728</u>																									
9.0 Person responsible for this application:	<table border="1" style="width:100%; border-collapse: collapse;"> <tr> <td style="width:30%; text-align: center;">                     Agency Use Only                 </td> <td colspan="3"> <u>Lawrence B. Mentzer</u> </td> <td style="text-align: center;"> <u>Corporate Attorney</u> </td> </tr> <tr> <td style="text-align: center;">                     Date Received by Juris. Agency                 </td> <td colspan="3">                 Name             </td> <td style="text-align: center;">                 Title             </td> </tr> <tr> <td style="text-align: center;">                     Date Received by FERC                 </td> <td colspan="3" style="text-align: center;">                  Signature             </td> <td style="text-align: center;">                 Date Application is Completed             </td> </tr> <tr> <td></td> <td colspan="3" style="text-align: center;"> <u>MAR 03 1980</u> </td> <td style="text-align: center;"> <u>(304) 342-8166</u> </td> </tr> <tr> <td></td> <td colspan="3"></td> <td style="text-align: center;">                 Phone Number             </td> </tr> </table>				Agency Use Only	<u>Lawrence B. Mentzer</u>			<u>Corporate Attorney</u>	Date Received by Juris. Agency	Name			Title	Date Received by FERC	Signature			Date Application is Completed		<u>MAR 03 1980</u>			<u>(304) 342-8166</u>					Phone Number
Agency Use Only	<u>Lawrence B. Mentzer</u>			<u>Corporate Attorney</u>																									
Date Received by Juris. Agency	Name			Title																									
Date Received by FERC	Signature			Date Application is Completed																									
	<u>MAR 03 1980</u>			<u>(304) 342-8166</u>																									
				Phone Number																									

08/25/2023



DATE: AUG 12 1980

OFFICE USE

NO. \_\_\_\_\_

NAME: Tug Fork Corp.

NA

ADDRESS: Tennessee Gas Pipeline Co.

D18629

FILE NO. \_\_\_\_\_

Department of Mines, Oil & Gas Division  
 WELL DETERMINATION FILE NUMBER

00331-107-099-1321

Above File Number on all Communications  
 Relating to Determination of this Well

CHECK EACH ITEM AS COMPLETE OR NONE IF NOT IS MISSING

- 20-100  Plans not completed - Date No. \_\_\_\_\_
- 20-11 Permit Lawrence B. Mentzer
- 20-2 Well Permit \_\_\_\_\_
- 20-6 Well Plat
- 20-25 Well Record  Drilling  Sealing \_\_\_\_\_
- 20-34 Gas-Oil Tests: Gas Only \_\_\_\_\_ Was Oil Produced? \_\_\_\_\_ Ratio \_\_\_\_\_
- 20-35 Annual Production No Prod.
- 20-40 30 day Production \_\_\_\_\_ Days off line: \_\_\_\_\_
- 20-45 Application for certification:
- 20-50 - 51 - 52 - 53 - 54 - 55 - 56 - 57 - 58  \_\_\_\_\_
- 20-55 Survey \_\_\_\_\_ Test \_\_\_\_\_ Test Log \_\_\_\_\_
- Structure Map \_\_\_\_\_ Section Map \_\_\_\_\_ Well Test Log \_\_\_\_\_
- Gas Analyses \_\_\_\_\_

- 3) Date completed: 10/25/60 Date completed 12/27/60 Reported \_\_\_\_\_
- 4) Production depths: 3305/35; 3036/65; 2843/2940; 2365/74
- 5) Production Formations: Br. Shale; —; —; Berea
- 6) Final Open Flow: 66 mcf/d
- 7) Meter Test: S.F. 452 #
- 8) Other Gas Tests: \_\_\_\_\_
- 9) Avg. Daily Gas from Annual Production: No Prod
- 10) Avg. Daily Gas from 30-day ending w/1 - 100 days: " "
- 11) Line Pressure: None 08/25/2023 1510 from Daily Page
- 12) Oil Production: No From Completion Report \_\_\_\_\_
- 13) Does lease agreement indicate enhanced recovery being done? No
- 14) Is there a well record with the Department containing the submitted information? Yes



STATE OF WEST VIRGINIA  
DEPARTMENT OF MINES, OIL AND GAS DIVISION

MAD 2 2 1980  
Date \_\_\_\_\_, 19\_\_\_\_  
Operator's Well No. 81-1111  
API Well No. 47 - 099 - 1321  
State County Permit

WELL CLASSIFICATION FORM

HIGH COST GAS WELL  
NGPA Section 107

WELL OPERATOR Tug Fork Corporation  
ADDRESS P. O. Box 3711  
Charleston, W. Va. 25337

GAS PURCHASER Tennessee Gas Pipeline Company  
ADDRESS P. O. Box 2511  
Houston, Texas 77001

DESIGNATED AGENT Lawrence B. Mentzer  
ADDRESS P. O. Box 3711  
Charleston, W. Va. 25337  
LOCATION: Elevation 996  
Watershed N/A  
Dist Grant County Wayne Quad. Wayne  
Gas Purchase Contract No. TF-1  
Meter Chart Code R0002  
Date of Contract 08/17/80

\* \* \* \* \*

AFFIDAVIT

I, James O. Sayre, having been first sworn according to law, state that, the well is producing natural gas produced from the fractures, micropores and bedding planes of shales deposited during the Paleozoic Devonian Period as generally found in the subsurface of the Appalachian Basin and in the surface out crops around its periphery. For the purposes of this statement, Devonian shale is defined as that shale stratigraphic interval that lies between the base of the Mississippian Berea Sand or, if absent, that of the Osage Series, and the top of the Onondaga limestone formation or its chert equivalent, the top of the Huntersville group of carbonates. I have no knowledge of any information not included in the application which is inconsistent with a conclusion that the well qualifies as a high cost natural gas well.

James O. Sayre  
Geologist

STATE OF WEST VIRGINIA,  
COUNTY OF Kanawha, TO WIT:

I, Charlotte I. Mathews, a Notary Public in and for the state and county aforesaid, do certify that James O. Sayre, whose name is signed to the writing above, bearing date the 3<sup>rd</sup> day of March, 1980, has acknowledged the same before me, in my county aforesaid.

Given under my hand and official seal this 3<sup>rd</sup> day of March, 1980.  
My term of office expires on the 5<sup>th</sup> day of December, 1985.

Charlotte I. Mathews  
Notary Public

[NOTARIAL SEAL]

08/25/2023



ELECTRIC LOGS

With reference to this well, please note that, at the time of the drilling hereof, neither electric logs nor the technology for logging were available. In lieu of actual electric logs on this well, we hereby refer to the gamma ray log and temperature log of the Columbia Gas Transmission #20402, Permit No. Lincoln 1656. Our geologist(s) submit that these logs are representative of the area and shows the same or similar formations and structures as encountered in the well herein filed for.

Please refer to 107 Tug Fork well certification filing on Well No. 33-497, API No. 47-005-0397 for a copy of the said gamma ray and temperature logs applicable herein.

08/25/2023



IV-39-WC

STATE OF WEST VIRGINIA  
DEPARTMENT OF MINES  
DIVISION - OIL AND GAS

ANNUAL REPORT OF MONTHLY PRODUCTION-1977  
GAS VOLUMES IN MFC @ 14.73  
OIL IN DARRELLS @ 60 DEGREES  
10, 18  
OPERATOR : Industrial Gas Corporation

REPORT NO. CCA101P1 PG 00002  
CURRENT DATE - 2/28/79  
REPORT DATE - 2/28/79

47-099-01321		81-1111		Wayne		AVG. FLOW PRESSURE		38		SHUT-IN PRESSURE		NA		TOTALS
API	FARM	Wilson Coal	81-1111	COUNTY	Wayne	AVG.	FLOW PRESSURE	38		SHUT-IN PRESSURE	NA			8366
GAS MFC	734	793	655	692	663	596	535	870	652	648	795	733	0A3	
OIL BBL	J-	F-	M-	A-	M-	J-	J-	A-	B-	0-	H-	D-	OIL	
DAYS ONLINE	30	34	27	31	32	29	27	37	30	28	31	29		365

1977

47-099-01321		81-1111		Wayne		AVG. FLOW PRESSURE		38		SHUT-IN PRESSURE		NA		TOTALS
API	FARM	Wilson Coal	81-1111	COUNTY	Wayne	AVG.	FLOW PRESSURE	38		SHUT-IN PRESSURE	NA			8377
GAS MFC	837	699	659	711	747	641	583	655	668	786	728	663	0A5	
OIL BBL	J-	F-	M-	A-	M-	J-	J-	A-	B-	0-	H-	D-	OIL	
DAYS ONLINE	34	30	27	31	32	29	30	31	35	27	30	28		364

1978

SUMMARIZATION SCHEDULE

Section 271. 804 (b)

In accordance with Section 271.804 (b) please list all other wells which are to be used in determining this well classification under Part 271 Subpart H.

- API NUMBERS 47-099-1321; 47-099-0340; 47-099-0341; 47-099-0342; 47-099-0490; 47-099-0516; 47-099-0633;
- 47-099-0397; 47-099-0210; 47-099-0230; 47-099-0560; 47-099-0753; 47-099-0761; 47-099-0792; 47-099-0793;
- 47-099-1466; 47-099-1487; 47-099-1488; 47-099-1490; 47-099-1491; 47-099-1495; 47-099-1500; 47-099-1507;
- 47-099-0049; 47-099-0036; 47-099-0193; 47-099-0312; 47-099-0328; 47-099-0330; 47-099-0347; 47-099-0382;
- 47-099-0409; 47-099-0434; 47-099-0487; 47-099-0584; 47-099-0819; 47-099-0820; 47-099-0871; 47-099-0853;
- 47-099-0856; 47-099-0862; 47-099-0961; 47-099-1274; 47-099-0790; 47-099-0634; 47-099-0019;
- 47-099-0001; 47-099-0037; 47-099-0041; 47-099-0021; 47-099-0015; 47-099-0013; 47-099-0053; 47-099-1548;
- 47-099-1550; 47-099-1551; 47-099-0043; 47-099-0038; 47-099-0050; 47-099-0877; 47-099-0066; 47-099-0247;
- 47-099-0253; 47-099-0260; 47-099-0854; 47-099-1291; 47-099-0972; 47-099-1486; 47-099-1464; 47-099-1499;
- 47-099-1508; 47-099-0561; 47-099-0598; 47-099-0304; 47-099-0824; 47-099-0838; 47-099-0641;
- 47-099-0019; 47-099-0015; 47-099-1471; 47-099-1337.

08/25/2023



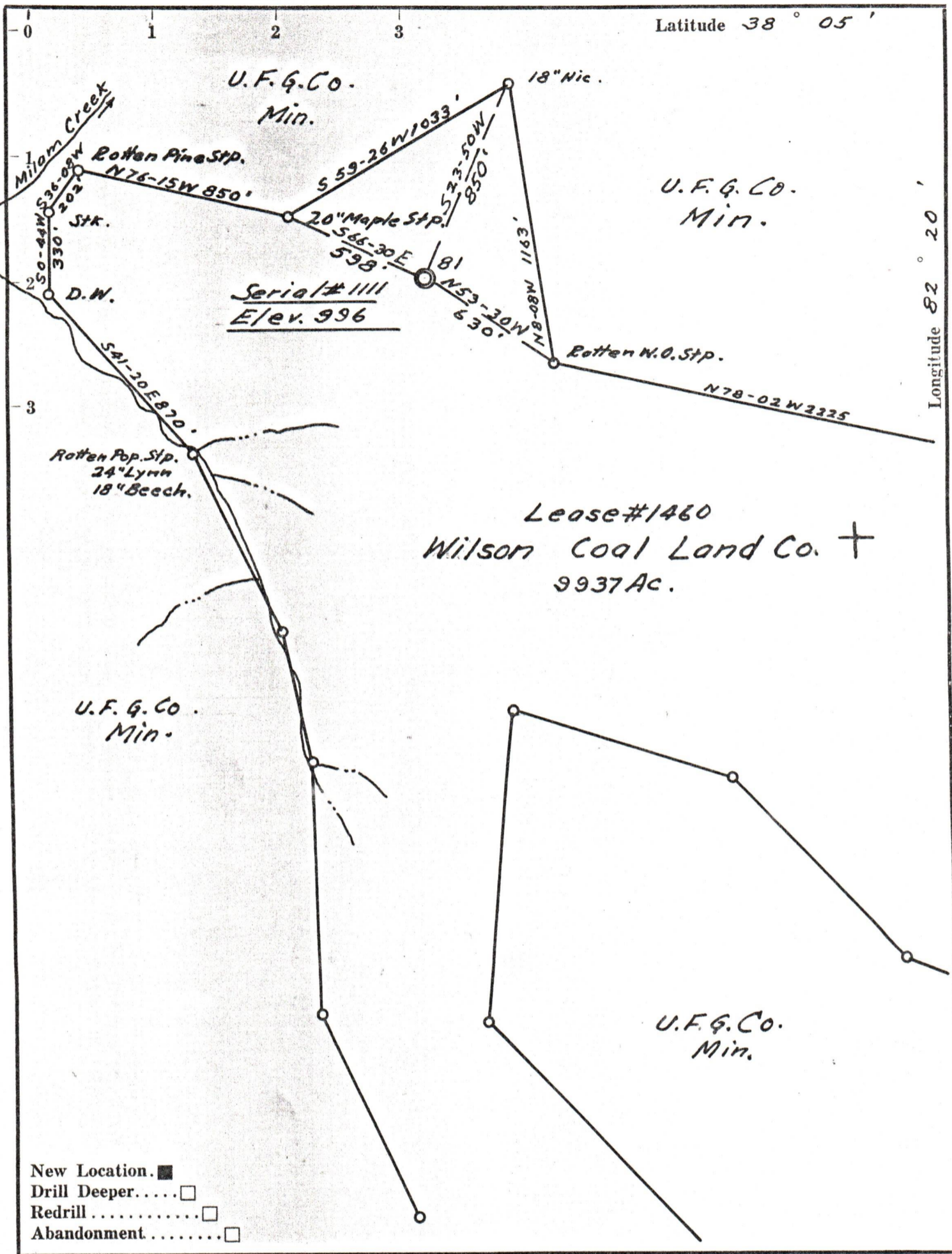

Company Owens, Libbey-Owens Gas Dept.  
 Address Box 4168 Charleston 4, W. Va.  
 Farm Wilson Coal Land Co.  
 Tract \_\_\_\_\_ Acres 9937 Lease No. 1460  
 Well (Farm) No. 81 Serial No. 1111  
 Elevation (Spirit Level) 996  
 Quadrangle Wayne  
 County Wayne District Grant  
 Engineer T.S. Flournoy  
 Engineer's Registration No. 269  
 File No. \_\_\_\_\_ Drawing No. \_\_\_\_\_  
 Date Aug. 15, 1960 Scale 1" = 500 Ft.

STATE OF WEST VIRGINIA  
 DEPARTMENT OF MINES  
 OIL AND GAS DIVISION  
 CHARLESTON

WELL LOCATION MAP  
 FILE NO. WAY-1321 08/25/2023

+ Denotes location of well on United States Topographic Maps, scale 1 to 62,500, latitude and longitude lines being represented by border lines as shown.

— Denotes one inch spaces on border line of original tracing.