



STATE OF WEST VIRGINIA
DEPARTMENT OF MINES
OIL AND GAS DIVISION

NOTICE OF PROPOSED LOCATION OF OIL AND GAS WELL

To THE DEPARTMENT OF MINES,
Charleston, W. Va.

COAL OPERATOR OR COAL OWNER

ADDRESS

COAL OPERATOR OR COAL OWNER

ADDRESS

United Fuel Gas Company
OWNER OF MINERAL RIGHTS

ADDRESS

United Fuel Gas Company
NAME OF WELL OPERATOR

Charleston, W. Va.
COMPLETE ADDRESS

July 20, 1960
PROPOSED LOCATION

Grant District

Wayne County

Well No. 8991 *38°05' 82°15' E. 981.21'*

United Fuel Gas Co. Min. Tr. #1 Farm

GENTLEMEN:

The undersigned well operator is entitled to drill upon the above named farm or tract of land for oil and gas, having fee title thereto, (or as the case may be) under grant or lease dated December 26, 1946, made by Huntington Development & Gas Co., to United Fuel Gas Company, and recorded on the 27th day of December, 1946, in the office of the County Clerk for said County in Book 234, page 318.

The enclosed plat was prepared by a competent engineer and shows the proposed location of a well to be drilled for oil and gas by the undersigned well operator on the farm and in the Magisterial District and County above named, determined by survey and courses and distances from two permanent points, or land marks.

The undersigned well operator is informed and believes there are no coal operators operating beds of coal beneath said farm or tract of land on which said well is located, or within 500 feet of the boundaries of the same, who have mapped their workings and filed their maps as required by law, excepting the coal operators or coal owners (if any) above named as addressees.

The above named coal operators or coal owners (if any) are notified that any objections they may desire to make to such proposed location, or which they are required to make by Section 3 of said Code, if the drilling of a well at said proposed location will cause a dangerous condition in or about their respective coal mines, must be received by, or filed with the Department of Mines within ten* days from the receipt of a copy of this notice and accompanying plat by said Department. Said coal operators are further notified that forms for use in making such objections will be furnished to them by the Department of Mines promptly on request and that all such objections must set forth as definitely as is reasonably possible the ground or grounds on which such objections are based and indicate the direction and distance the proposed location should be moved to overcome same.

(The next paragraph is to be completed only in Department's copy.)

Copies of this notice and the enclosed plat were mailed by registered mail, or delivered to the above named coal operators or coal owners at their above shown respective address _____ day _____ before, or on the same day with the mailing or delivery of this copy to the Department of Mines at Charleston, West Virginia.

Very truly yours,

UNITED FUEL GAS COMPANY

WELL OPERATOR

P. O. Box 1273

STREET

Charleston 25

CITY OR TOWN

West Virginia

STATE

08/25/2023



Address of Well Operator }

*Section 3. If no such objections be filed or be found by the department of mines, within said period of ten days from the receipt of said notice and plat by the department of mines, to said proposed location, the department shall forthwith issue to the well operator a drilling permit reciting the filing of such plat, that no objections have been made by the coal operators to the location, or found thereto by the department, and that the same is approved and the well operator authorized to proceed to drill at said location.

1310

WAY-1310

PERMIT NUMBER

Formation	Color	Hard or Soft	Top 20	Bottom	Oil, Gas or Water	Depth Found	Remarks
Big Line			1580	1740	Show of Oil & Gas at 1640'		
Injun Sand			1740	1790			
Slate			1790	1835			
Shell			1835	1880			
Slate			1880	2152			
Shell			2152	2156			
Slate			2156	2175			
Shell			2175	2182			
Slate			2182	2295			
Brown Shale			2295	2342			
Berea Sand			2342	2370	Gas increased to 3/10 W - 1" at 2346'		
Slate			2370	2420			
Brown Shale			2420	2480			
Slate			2480	3060			
Brown Shale			3060	3355	Gas Pay at 3330' - 4/10 W - 1"		
Slate			3355	3388	When drilling completed 4/10 W - 1"		
Total Depth			3388'				

08/25/2023

Date January 16, 19 61

APPROVED UNITED FUEL GAS COMPANY, Owner

By S. D. Fennell
 (Title) Supt., Civil Engineering Dept.





STATE OF WEST VIRGINIA
DEPARTMENT OF MINES
OIL AND GAS DIVISION 20

Quadrangle Wayne

Permit No. WAY-1310

WELL RECORD

Oil or Gas Well Gas DRY
(KIND)

Company United Fuel Gas Company
Address P.O. Box 1273; Charleston 25, W. Va.
Farm United Fuel Gas Co. Min. Tr. #1 Acres 40,496.86
Location (waters) 12 Pole Creek
Well No. 8991 Elev. 981.21
District Grant County Wayne
The surface of tract is owned in fee by _____
Address _____
Mineral rights are owned by United Fuel Gas Co.
Address Charleston, W. Va.
Drilling commenced 9-28-60
Drilling completed 12-20-60
Date Shot 12-27-60 From _____ To _____
With 9900# Ind. Gelatin
Open Flow 12 /10ths Water in 1 Inch
/10ths Merc. in _____ Inch
Volume 37,000 Cu. Ft.
Rock Pressure - lbs. 18 hrs.
Oil _____ bbls., 1st 24 hrs.

Casing and Tubing	Used in Drilling	Left in Well	Packers
Size			Kind of Packer
16			
13			
10 3/4		12'	Size of
8 5/8		378	
7"	1636'	Pulled	Depth set
5 3/16			
3 1/2		1869'	Perf. top
2			Perf. bottom
Liners Used			Perf. top
			Perf. bottom

WELL ACIDIZED _____
WELL FRACTURED _____

CASING CEMENTED	SIZE	No. Ft.	Date
COAL WAS ENCOUNTERED AT <u>141</u> FEET <u>60</u> INCHES			

RESULT AFTER TREATMENT

ROCK PRESSURE AFTER TREATMENT

Fresh Water 160 Feet Salt Water 1110' Feet

Formation	Color	Hard or Soft	Top	Bottom	Oil, Gas or Water	Depth	Remarks
Surface			0	11	Frac. 1/6/61 W/10,900 Gal. Water & 16,000# Sand-Breakdown Pressure 1850# Max. Treating Pressure 1600#-Treating Pressure 1500#-Injection Rate 13-1/4 Bbls. per min. 1 1/2# Sand per gal. Shut in Pressure 800#.		
Sand			11	55			
Slate			55	110			
Sand			110	139			
Slate			139	141			
Coal			141	146			
Slate			146	150			
Sand			150	185			
Slate			185	225			Water at 160' - 3 Bailers per 2 Hrs.
Sand			225	290			
Slate			290	320			
Sand			320	375			
Slate			375	380			
Sand			380	420			
Slate			420	480			
Sand			480	515			
Slate			515	527			
Sand			527	555			
Slate			555	620			
Sand			620	660			
Slate			660	700			
Broken Sand			700	825			
Slate			825	900			
Sand			900	940			
Shell			940	950			
Slate & Shells			950	1000			
Salt Sand			1000	1250			
Slate & Shells			1250	1320		Water at 1110' - Hole Full	
Sand			1320	1560			
Little Lime			1560	1580			



08/25/2023

STATE OF WEST VIRGINIA
DEPARTMENT OF MINES
OIL AND GAS DIVISION

INSPECTOR'S WELL REPORT

Permit No. WAY-1310

Oil or Gas Well 8991
(KIND)

Company <u>United Fuel Gas Company</u>	CASING AND TUBING	USED IN DRILLING	LEFT IN WELL	PACKERS
Address <u>P.O. Box 1273 Charleston, W. Va.</u>	Size			
Farm <u>U.F.G.Co. Min. Tr. #1</u>	16			Kind of Packer
Well No. <u>8991</u>	13			
District <u>Grant</u> County <u>Wayne</u>	10	<u>11'5"</u>		Size of
Drilling commenced <u>9 - 28 - 60</u>	8 1/4	<u>378'</u>		
Drilling completed _____ Total depth _____	6 5/8	<u>1625'</u>		Depth set
Date shot _____ Depth of shot _____	5 3/16			
Initial open flow _____ /10ths Water in _____ Inch	3			Perf. top
Open flow after tubing _____ /10ths Merc. in _____ Inch	2			Perf. bottom
Volume _____ Cu. Ft.	Liners Used			Perf. top
Rock pressure _____ lbs. _____ hrs.				Perf. bottom
Oil _____ bbls., 1st 24 hrs.	CASING CEMENTED _____ SIZE _____ No. FT. _____ Date _____			
Fresh water <u>160</u> feet _____ feet	COAL WAS ENCOUNTERED AT <u>141</u> FEET <u>60</u> INCHES			
Salt water <u>1110</u> feet _____ feet	_____ FEET _____ INCHES _____ FEET _____ INCHES			
	_____ FEET _____ INCHES _____ FEET _____ INCHES			

Drillers' Names James Davis
Sansom Davis

Remarks: Salt Sand 1000'-1250'; Big Lime 1580'-1740'; Berea Sand 2342'-2370';
Brown shale 2420'-2480'; drilling depth 3040'. Transportation by
Company truck.

12-15-60
DATE

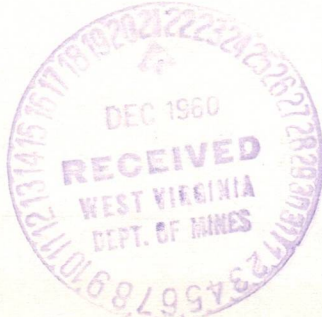

J.W. Pack
DISTRICT WELL INSPECTOR
08/25/2023

STATE OF WEST VIRGINIA
DEPARTMENT OF MINES
OIL AND GAS DIVISION

INSPECTOR'S WELL REPORT

Permit No. WAY-1310

Oil or Gas Well Gas
(KIND)

Company	CASING AND TUBING	USED IN DRILLING	LEFT IN WELL	PACKERS
<u>United Fuel Gas Company</u>	Size			Kind of Packer
<u>P.O. Box 1273</u>	16			
<u>Charleston, W. Va.</u>	13			
<u>Farm U.F.G.Co. Min. Tr. #1</u>	10	<u>11'</u>		Size of
<u>Well No. 8991</u>	8 1/4	<u>378'</u>		
<u>District Grant County Wayne</u>	6 5/8	<u>1625'</u>		Depth set
<u>Drilling commenced</u>	5 3/16			
<u>Drilling completed</u> Total depth <u>3388'</u>	3			Perf. top
<u>Date shot 12/27/60</u> Depth of shot <u>2420'</u>	2			Perf. bottom
<u>Initial open flow 3</u> /10ths Water in <u>1</u> Inch	Liners Used			Perf. top
<u>Open flow after tubing</u> /10ths Merc. in <u></u> Inch				Perf. bottom
<u>Volume 18,000</u> Cu. Ft.	CASING CEMENTED _____ SIZE _____ No. FT. _____ Date _____			
<u>Rock pressure</u> lbs. _____ hrs. _____	COAL WAS ENCOUNTERED AT _____ FEET _____ INCHES			
<u>Oil</u> _____ bbls., 1st 24 hrs.	_____ FEET _____ INCHES	_____ FEET _____ INCHES	_____ FEET _____ INCHES	_____ FEET _____ INCHES
<u>Fresh water</u> _____ feet _____ feet				
<u>Salt water</u> _____ feet _____ feet				

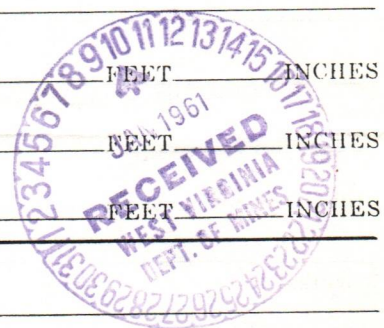

Drillers' Names James Davis

Sampson Davis
Remarks: Berea Sand 2342'-2370'; Brown shale 3060'-3355'; shot with 9,900 Lbs. from 3388' to 2420'; tested 36 hours after shot- 12/10 Water 1".

1-3-61
DATE

J.W. Pack
DISTRICT WELL INSPECTOR
08/25/2023

STATE OF WEST VIRGINIA
DEPARTMENT OF MINES
OIL AND GAS DIVISION
INSPECTOR'S PLUGGING REPORT

Permit No. WAY-1310*P Well No. 8991
COMPANY United Fuel Gas Company ADDRESS P. O. Box 1273
Charleston, West Va.
FARM U.F.G.Co. Min. Tr. #1 DISTRICT Grant COUNTY Wayne

Filling Material Used _____

PLUGS USED AND DEPTH PLACED			BRIDGES	CASING AND TUBING		
CEMENT-THICKNESS	WOOD-SIZE	LEAD	CONSTRUCTION-LOCATION	RECOVERED	SIZE	LOST

Drillers' Names _____

Remarks: Haven't started to plug well due to weather and road conditions. Well Service, Inc. will run cement and Aquagel well when work is resumed.

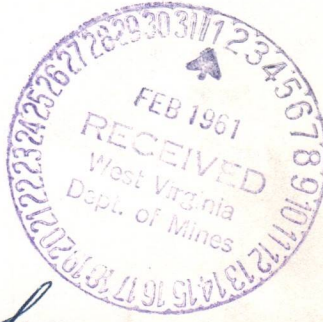

1-27-61
DATE

I hereby certify I visited the above well on this date.

Jw. Pack
DISTRICT WELL INSPECTOR

08/25/2023

STATE OF WEST VIRGINIA
DEPARTMENT OF MINES
OIL AND GAS DIVISION

INSPECTOR'S WELL REPORT

Permit No. _____ Oil or Gas Well _____
(KIND)

	CASING AND TUBING	USED IN DRILLING	LEFT IN WELL	PACKERS
Company _____	Size			
Address _____	16			Kind of Packer _____
Farm _____	13			
Well No. _____	10			Size of _____
District _____ County _____	8 1/4			
Drilling commenced _____	6 5/8			Depth set _____
Drilling completed _____ Total depth _____	5 3/16			
Date shot _____ Depth of shot _____	3			Perf. top _____
Initial open flow _____ /10ths Water in _____ Inch	2			Perf. bottom _____
Open flow after tubing _____ /10ths Merc. in _____ Inch	Liners Used			Perf. top _____
Volume _____ Cu. Ft.				Perf. bottom _____

CASING CEMENTED _____ SIZE _____ No. FT. _____ Date _____

Rock pressure _____ lbs. _____ hrs.

Oil _____ bbls., 1st 24 hrs. COAL WAS ENCOUNTERED AT _____ FEET _____ INCHES

Fresh water _____ feet _____ feet _____ FEET _____ INCHES _____ FEET _____ INCHES

Salt water _____ feet _____ feet _____ FEET _____ INCHES _____ FEET _____ INCHES

Drillers' Names _____

Remarks: _____

DATE _____

DISTRICT WELL INSPECTOR
08/25/2023

APPROVED JANUARY 16, 1961

Never plugged, well.

W. E. Gippich
 Assistant Director
 OIL AND GAS DIVISION

January 13, 1961

Mrs. Marie Griffith
 State Department of Mines
 Capital Building
 Charleston, West Virginia

Dear Mrs. Griffith:

We propose to plug and abandon Well No. 8991, Grant District, Wayne County, West Virginia, Map Square 24-35, in the following manner:

Aquagel	1853' - 1650'
3 $\frac{1}{2}$ " X 7" Packer set at	1853'
3 $\frac{1}{2}$ " Tubing cemented back to	1650'
Cut 3 $\frac{1}{2}$ " Tubing at	1650'
Cement	1650' - 1630'
Pull 3 $\frac{1}{2}$ " Tubing to	1580'
Aquagel	1630' - 1580'
Cement	1580' - 1560' - 20' above Big Lime
Pull 3 $\frac{1}{2}$ " Tubing to	1000'
Aquagel	1560' - 1000'
Cement	1000' - 980' - 20' above Salt Sand
Pull 3 $\frac{1}{2}$ " Tubing to	420'
Aquagel	980' - 420'
Cement	420' - 390' - 30' below 8" Casing
Pull 3 $\frac{1}{2}$ " Tubing	
Pull 8" Casing	378'
Run 3 $\frac{1}{2}$ " Tubing back to	176'
Aquagel	390' - 176' - 30' below Coal Seam
Cement	176' - 121' - 20' above Coal Seam
Pull 3 $\frac{1}{2}$ " Tubing to	30'
Aquagel	121' - 30'
Cement	30' - Surface
Pull balance of 3 $\frac{1}{2}$ " Tubing	

Erect monument 30" above the surface with inscription
 "United Fuel Gas Co. Well No. 8991 - Abandoned Date
 ".

Yours very truly,

W. B. Osbourn
 W. B. Osbourn
 Division Superintendent

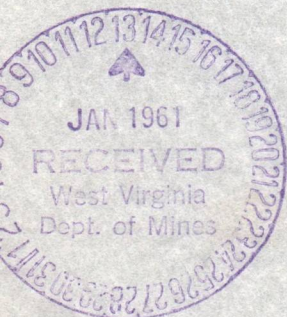

08/25/2023

M. E. ...
Assistant Director
OIL AND GAS DIVISION

January 13, 1961

Mrs. Marie Griffith
State Department of Mines
Capital Building
Charleston, West Virginia

Dear Mrs. Griffith:

We propose to plug and abandon Well No. 8221, owned
Director, Wayne County, West Virginia, Map Square 21-35, in
the following manner:

- Aguegal 1550' - 1550'
- 3 1/2" Packer set at 1550'
- 3 1/2" Tubing cemented back to 1550'
- 3 1/2" Tubing at 1550'
- Cement 1550' - 1550'
- Full 3 1/2" Tubing to 1550'
- Aguegal 1550' - 1550'
- Cement 1550' - 1550'
- Full 3 1/2" Tubing to 1000'
- Aguegal 1550' - 1000'
- Cement 1000' - 980'
- Full 3 1/2" Tubing to 980'
- Aguegal 980' - 980'
- Cement 980' - 980'
- Full 3 1/2" Tubing
- Full 8" casing 378'
- Full 3 1/2" Tubing back to 378'
- Aguegal 378' - 378'
- Cement 378' - 378'
- Full 3 1/2" Tubing to 30'
- Aguegal 30' - 30'
- Cement 30' - 30'
- Full balance of 3 1/2" Tubing

First cement 30" above the surface with inscription
"Plugged Well Gas Co. Well No. 8221 - Abandoned Date
"

Yours very truly,
[Signature]
W. E. ...
Division Superintendent



08/25/2023



STATE OF WEST VIRGINIA
DEPARTMENT OF MINES
OIL AND GAS DIVISION

NOTICE OF INTENTION TO PLUG AND ABANDON WELL

(REQUIRED BY SECTION 9, ARTICLE 4, CHAPTER 22 OF THE CODE)

To THE DEPARTMENT OF MINES,
Charleston, W. Va.

Coal Operator _____

Address _____

Coal Owner _____

Address _____

United Fuel Gas Company
Lease or Property Owner

Charleston, W. Va.
Address _____

United Fuel Gas Company
Name of Well Operator _____

Charleston, West Virginia
Complete Address _____

January 16, 1961
Date _____

WELL TO BE ABANDONED

Grant _____ District _____

Wayne _____ County _____

Well No. 8991 _____

United Fuel Gas Co. Min. Tr. #1 Farm

Inspector to be notified MR. JAMES W. PACK
Hamlin, West Virginia Telephone Number _____

Approved January 16, 1961

Gentlemen:—

The undersigned well operator is about to abandon the above described well and will commence the work of plugging and abandoning said well on the date inspector is notified (which date shall not be less than five days after the day on which this notice so mailed is received, or in due course should be received by the Department of Mines).

This notice is given you in order that your respective representatives may be present at the plugging and filling of said well. You are further notified that whether you are represented or not represented the undersigned will proceed on that date, or shortly thereafter, to plug and fill said well in the manner required by Section 10, Article 4, Chapter 22 of the Code and given in detail on the reverse side of this notice, in "Work Order."

This notice is being mailed by registered mail to each of you at the above addresses on the above date.

Very truly yours,

UNITED FUEL GAS COMPANY
Well Operator

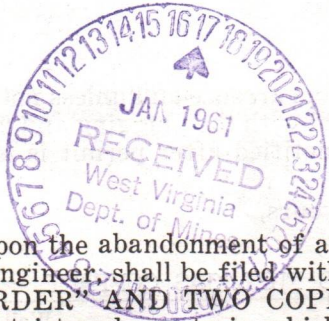

NOTE: Upon the abandonment of any well drilled prior to June 1, 1929, a plat prepared by a registered engineer, shall be filed with THREE COPIES OF APPLICATION, (OG-9) AND "WORK ORDER" AND TWO COPIES OF THE WELL RECORD, (OG-10). The map must show the district and county in which the tract of land is located, the name and acreage of same, the name or names of the owners and names of adjacent tracts and the location of the well to be abandoned, determined by survey with the courses and distances of such well from two permanent points or landmarks on said tract.

08/25/2023

NOTE: In case plugging is not commenced within four months from the date of permit, same shall expire and be of no further force or effect.

NOTE: PERMIT IS NOT TRANSFERABLE.

WAY - 1310 - P

Permit Number

PROPOSED MANNER OF PLUGGING AND FILLING WELL

(REQUIRED BY RULES AND REGULATIONS)

WEST VIRGINIA DEPARTMENT OF MINES

OIL AND GAS DIVISION

WORK ORDER

Well to be plugged and filled as follows:

Aquagel	1853' - 1650'
3 1/2" x 7" Packer set at	1853'
3 1/2" Tubing cemented back to	1650'
Cut 3 1/2" Tubing at	1650'
Cement	1650' - 1630'
Pull 3 1/2" Tubing to	1580'
Aquagel	1630' - 1580'
Cement	1580' - 1560' - 20' above Big Lime
Pull 3 1/2" Tubing to	1000'
Aquagel	1560' - 1000'
Cement	1000' - 980' - 20' above Salt Sand
Pull 3 1/2" Tubing to	420'
Aquagel	980' - 420'
Cement	420' - 390' - 30' below 8" Casing
Pull 3 1/2" Tubing	
Pull 8" Casing	378'
Run 3 1/2" Tubing back to	176'
Aquagel	390' - 176' - 30' below Coal Seam
Cement	176' - 121' - 20' above Coal Seam
Pull 3 1/2" Tubing to	30'
Aquagel	121' - 30'
Cement	30' - Surface
Pull balance of 3 1/2" Tubing.	

Erect monument 30" above the surface with inscription "United Fuel Gas Co. Well No. 8991 - Abandoned Date _____."

To the Department of Mines
Coal Owner or Operator,
Lease or Property Owner.

Gentlemen:

This "work order" is submitted for your approval and concurrence and unless notified of your disapproval or non-concurrence, the undersigned will proceed with the plugging and filling of said well in the above described manner on the date inspector is notified after permit is issued.

Very truly yours,

UNITED FUEL GAS COMPANY

Well Operator

No objections have been filed by the coal owner or coal operator, or any available adjacent lease or property owners or interposed by the Department of Mines to the manner herein described for the plugging and filling of the well above mentioned. Therefore, the same is hereby approved 08/25/2023

Approved 16th day of JANUARY, 19 61.

DEPARTMENT OF MINES
Oil and Gas Division

By: M.E. Gisselle
ASSISTANT DIRECTOR-OIL AND GAS DIVISION

NOTE: This "work order" shall be filed in triplicate, one copy for the files of the Department of Mines; one to be approved or corrected and returned to the well operator as his authority for plugging said well; and one for the well inspector.

STATE OF WEST VIRGINIA
DEPARTMENT OF MINES
OIL AND GAS DIVISION

AFFIDAVIT OF PLUGGING AND FILLING WELL

AFFIDAVIT SHOULD BE MADE IN TRIPLICATE, ONE COPY MAILED TO THE DEPARTMENT, ONE COPY TO BE RETAINED BY THE WELL OPERATOR AND THE THIRD COPY (AND EXTRA COPIES IF REQUIRED) SHOULD BE MAILED TO EACH COAL OPERATOR AT THEIR RESPECTIVE ADDRESSES.

COAL OPERATOR OR OWNER	United Fuel Gas Company
ADDRESS	P.O. Box 1273-Charleston, W. Va.
COAL OPERATOR OR OWNER	February 9, 19 61
ADDRESS	Grant District
LEASE OR PROPERTY OWNER	Wayne County
ADDRESS	Well No. 8991
	United Fuel Gas Co. Min. Tr. #1 Farm
STATE INSPECTOR SUPERVISING PLUGGING	James W. Pack

AFFIDAVIT

STATE OF WEST VIRGINIA,

County of Wayne } ss:

JAMES DAVIS

and

SAMPSON DAVIS

being first duly sworn according to law depose and say that they are experienced in the work of plugging and filling oil and gas wells and were employed by R. H. ADKINS DRILLING COMPANY, well operator, and participated in the work of plugging and filling the above well, that said work was commenced on the 1st day of February, 19 61, and that the well was plugged and filled in the following manner:

SAND OR ZONE RECORD	FILLING MATERIAL	PLUGS USED	CASING	
			CSG PULLED	CSG LEFT IN
FORMATION	Aquagel 1853' - 1674'	SIZE & KIND		
	3 1/2" Tubing cemented to 1674'	10-3/4"	0	12'
	Cut 3 1/2" Tubing @ 1674'	8-5/8"	378'	0
	Cement 1674' - 1654'	3-1/2"	1674'	195'
	Pulled 3 1/2" Tubing to 1580'			
	Aquagel 1654' - 1580'			
	Cement 1580' - 1560'			
	Pulled 3 1/2" Tubing to 1000'			
	Aquagel 1560' - 1000'			
	Cement 1000' - 980'			
	Pulled 3 1/2" Tubing to 420'			
	Aquagel 980' - 420'			
	Cement 420' - 390'			
	Pulled 3 1/2" Tubing			
	Pulled 8-5/8" Casing 378'			
	Run 3 1/2" Tubing back to 176'			
COAL SEAMS	Aquagel 390' - 176'			
(NAME)	Cement 176' - 121'	DESCRIPTION OF MONUMENT		
(NAME)	Pulled 3 1/2" Tubing to 30'	Erected monument 30" above the surface with inscription " United		
(NAME)	Aquagel 121' - 30'	Fuel Gas Co. Well No. 8991 - Abandoned		
(NAME)	Cement 30' - Surface	Date 2-2-61:		

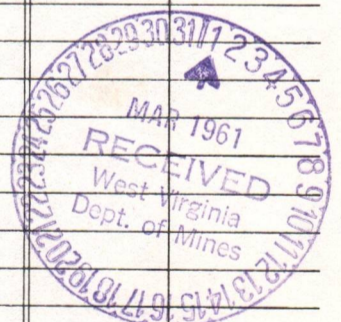

Pulled balance of 3-1/2" Tubing and that the work of plugging and filling said well was completed on the 2nd day of February, 19 61.

And further deponents saith not.

X Sampson Davis
X James Davis 08/25/2023

Sworn to and subscribed before me this 20 day of Feb, 1961.

My commission expires: June 7, 1967

W. J. Anderson
Notary Public.

Permit No. WAY-1310-P

AFFIDAVIT OF PLUGGING AND FILLING WELL

AFFIDAVIT SHOULD BE MADE IN TRIPLICATE. ONE COPY TO BE RETAINED BY THE WELL OPERATOR AND THE OTHER TWO COPIES TO BE FORWARDED TO THE DEPARTMENT OF MINES AND GEOLOGY AT THE TIME THE WELL IS PLUGGED AND FILLING IS COMPLETED.

NAME OF WELL OPERATOR: United Fuel Gas Company
 LOCAL OPERATOR OR OWNER: P.O. Box 1273-Charleston, W. Va.
 ADDRESS: February 9, 1951
 WELL LOCATION: Grant
 COUNTY: Wayne
 NAME OF PROPERTY OWNER: James M. Pack
 WELL NO.: 8991
 UNITED FUEL GAS CO., MIN. TR. #1
 STATE INSPECTOR: JAMES M. PACK

AFFIDAVIT

STATE OF WEST VIRGINIA

County of Wayne

JAMES DAVIS

SAMUEL DAVIS

being first duly sworn according to law, depose and say that they are experienced in the work of plugging and filling oil and gas wells and were employed by H. H. ADKINS DRILLING COMPANY, well operator, and participated in the work of plugging and filling the above well, that said work was commenced on the day of February 1951 and that the well was plugged and filled in the following manner:

DATE	TIME	DESCRIPTION OF MATERIAL	DEPTH	REMARKS
1951	0	10-3/4"	1071'	Added
1951	0	8-1/2"	1071'	3 1/2" tubing cemented to 1071'
1951	1071'	3-1/2"	1071' - 1580'	Out 3 1/2" tubing 0
			1580'	Cement
			1580'	Filled 3 1/2" tubing to
			1580' - 1580'	Annular
			1580' - 1580'	Cement
			1000'	Filled 3 1/2" tubing to
			1580' - 1000'	Annular
			1000' - 980'	Cement
			1580'	Filled 3 1/2" tubing to
			980' - 1580'	Annular
			1580' - 370'	Cement
				Filled 3 1/2" tubing
			370'	Filled 8-5/8" casing
			170'	Run 3 1/2" tubing back to
			390' - 170'	Annular
			170' - 1580'	Cement
				Filled 3 1/2" tubing to
			1580' - 30'	Annular
			30' - 30'	Cement

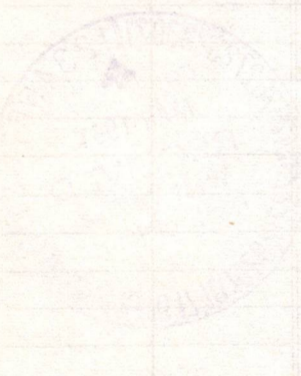

Filled balance of 3-1/2" tubing
 and that the work of plugging and filling said well was completed on the day of February 1951.

Subscribed and sworn to before me this day of February 1951.
 Notary Public
 Form No. WVA-1310-P

8/25/2023

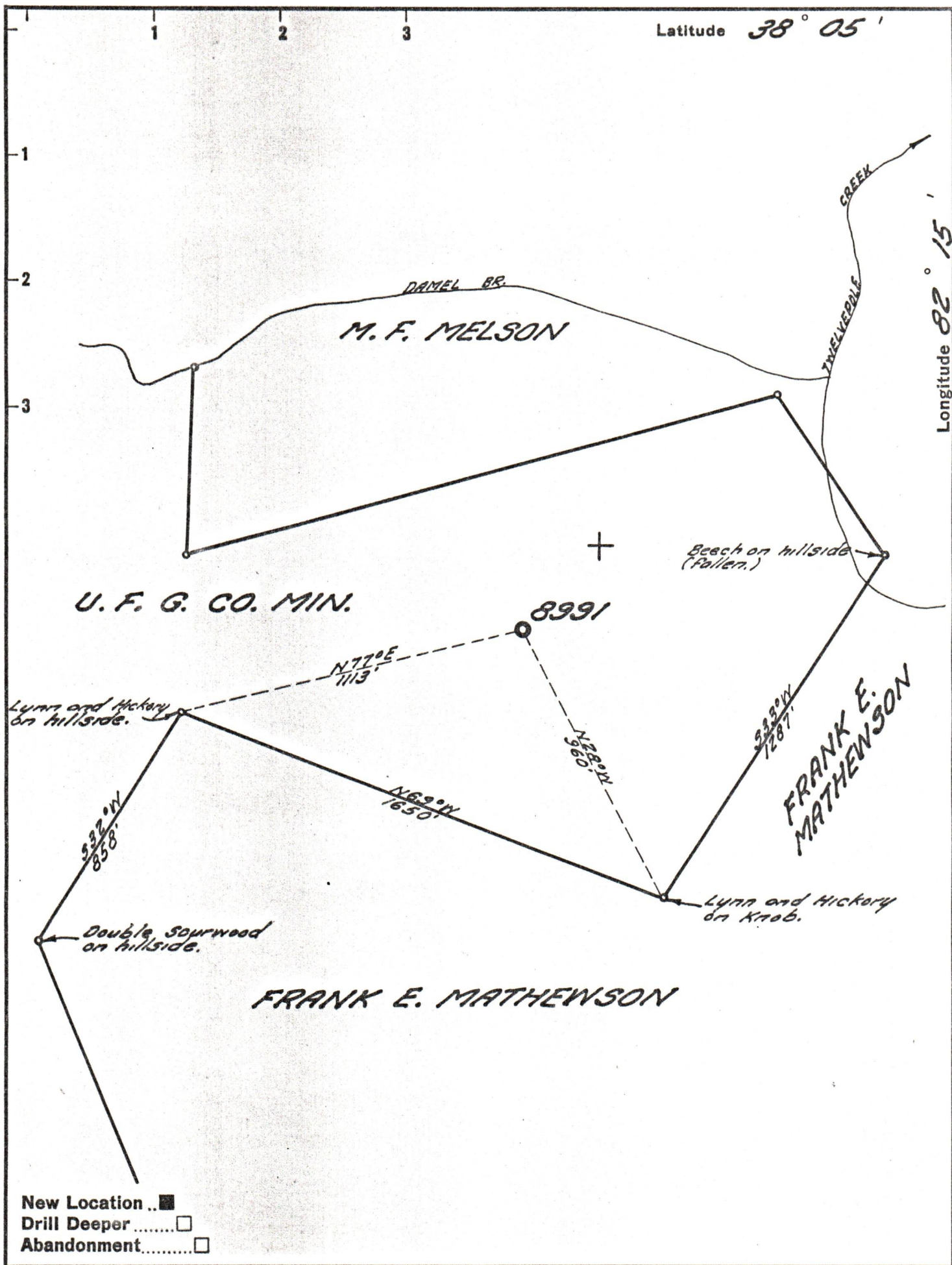

New Location ..
 Drill Deeper
 Abandonment

Company UNITED FUEL GAS CO.
 Address CHARLESTON, W.VA.
 Farm UNITED FUEL GAS CO. MIN.
 Tract 1 Acres 40.496⁸⁶ Lease No. NO REF.
 Well (Farm) No. _____ Serial No. 8991
 Elevation (Spirit Level) 981.21'
 Quadrangle WAYNE
 County WAYNE District GRANT
 Engineer Seibert R. Stuvell
 Engineer's Registration No. 2529
 File No. 24-35 Drawing No. _____
 Date 7-6-60 Scale 1" = 400'

STATE OF WEST VIRGINIA
 DEPARTMENT OF MINES
 OIL AND GAS DIVISION
 CHARLESTON

WELL LOCATION MAP
 FILE NO. WAY-1310 08/25/2023

+ Denotes location of well on United States Topographic Maps, scale 1 to 62,500, latitude and longitude lines being represented by border lines as shown.

- Denotes one inch spaces on border line of original tracing.