



STATE OF WEST VIRGINIA
DEPARTMENT OF MINES
OIL AND GAS DIVISION

NOTICE OF PROPOSED LOCATION OF OIL AND GAS WELL

To THE DEPARTMENT OF MINES,
Charleston, W. Va.

None
COAL OPERATOR OR COAL OWNER

R.B. Eichholz & J.B. Hyman
NAME OF WELL OPERATOR

ADDRESS

216-prince st. Alexandria, Virginia
COMPLETE ADDRESS

COAL OPERATOR OR COAL OWNER

Now 6, 1959
PROPOSED LOCATION

ADDRESS

Butler District

R.L. Boys, Heirs,
OWNER OF MINERAL RIGHTS
Ballard Boys, adm.
Fort Gay, W. Va., R.F.D. - #1
ADDRESS

Wayne County

Well No. 1 38° 15'
82° 30' E. 635.0'

Halter Boys Farm
100 acres

GENTLEMEN:

The undersigned well operator is entitled to drill upon the above named farm or tract of land for oil and gas, having fee title thereto, (or as the case may be) under grant or lease dated Sept 10th 1956, made by R.L. Boys, Heirs, to Wayne Lyeon & Co. C. McClure, and recorded on the 27th day of April 1957, in the office of the County Clerk for said County in Book 47, page 18.

The enclosed plat was prepared by a competent engineer and shows the proposed location of a well to be drilled for oil and gas by the undersigned well operator on the farm and in the Magisterial District and County above named, determined by survey and courses and distances from two permanent points, or land marks.

The undersigned well operator is informed and believes there are no coal operators operating beds of coal beneath said farm or tract of land on which said well is located, or within 500 feet of the boundaries of the same, who have mapped their workings and filed their maps as required by law, excepting the coal operators or coal owners (if any) above named as addressees.

The above named coal operators or coal owners (if any) are notified that any objections they may desire to make to such proposed location, or which they are required to make by Section 3 of said Code, if the drilling of a well at said proposed location will cause a dangerous condition in or about their respective coal mines, must be received by, or filed with the Department of Mines within ten* days from the receipt of a copy of this notice and accompanying plat by said Department. Said coal operators are further notified that forms for use in making such objections will be furnished to them by the Department of Mines promptly on request and that all such objections must set forth as definitely as is reasonably possible the ground or grounds on which such objections are based and indicate the direction and distance the proposed location should be moved to overcome same.

(The next paragraph is to be completed only in Department's copy.)

Copies of this notice and the enclosed plat were mailed by registered mail, or delivered to the above named coal operators or coal owners at their above shown respective address _____ day _____ before, or on the same day with the mailing or delivery of this copy to the Department of Mines at Charleston, West Virginia.

Very truly yours,

R.B. Eichholz & J.B. Hyman
WELL OPERATOR

216-prince Street
STREET

Alexandria
CITY OR TOWN

Virginia
STATE

By Wayne Lyeon

08/25/2023

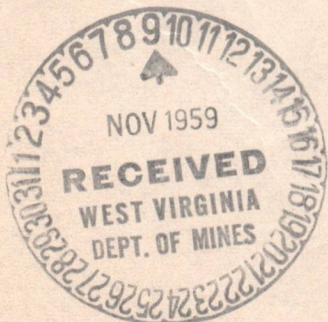

Address of Well Operator }

*Section 3 . . . If no such objections be filed or be found by the department of mines, within said period of ten days from the receipt of said notice and plat by the department of mines, to said proposed location, the department shall forthwith issue to the well operator a drilling permit reciting the filing of such plat, that no objections have been made by the coal operators to the location, or found thereto by the department, and that the same is approved and the well operator authorized to proceed to drill at said location.

1242

WAY-1242

PERMIT NUMBER

A-10-

November 19, 1959

Messrs. R. B. Eichholz and
J. B. Hyman
216 Prince Street
Alexandria, Virginia

Dear Sirs:

Enclosed are permits for drilling the following wells -

Permit No.	Well No.	Farm	District
WAY-1241	2	H. S. Blankenship	Butler
WAY-1242	1	Walter Boys	Butler

Please post one copy of each permit at the well site. When drilling is completed, please send us two copies of the well record for each location.

Please note the enclosed directive on casing of wells.

Very truly yours,

Crawford L. Wilson, Director
DEPARTMENT OF MINES

Assistant Director
OIL AND GAS DIVISION

MG/m
encl:
cc Mr. James W. Pack, Inspector

Mr. R. C. Tucker, Assistant
State Geologist

B-1



STATE OF WEST VIRGINIA DEPARTMENT OF MINES OIL AND GAS DIVISION

Quadrangle KENOVA

Permit No. 1242-Way

WELL RECORD

Oil or Gas Well Gas (KIND)

Company R.B. Eichholz & J.B. Hyman, Address 216 Prince St. Alexandria, Va. Farm Walter Boys Acres 108 Location (waters) Queens Creek, Well No. 1 Elev. 635' District Butler County Wayne The surface of tract is owned in fee by Walter Boys Prichard, W. Va. Mineral rights are owned by Boys Heirs Ballard Boys, Adm. Address Fort Gay, W. Va.

Table with columns: Casing and Tubing, Used in Drilling, Left in Well, Packers. Includes tubing sizes (16, 13, 10, 8 3/4, 7" O.D., 5 3/16, 3, 2" tubing), depths (1085, 1445, 1845, 76), and packer details (2" tubing Anchor packer, Depth set 1625', Perf. top/bottom).

Drilling commenced Dec. 12th, 1959 Drilling completed Jan. 25th, 1960 Date Shot Feb. 2nd, 1960 From 1845 To 1827 With 1983 lbs. Gelatin Open Flow 19 /10ths Water in 2 Inch /10ths Merc. in Inch Volume 184,000 Cu. Ft. Rock Pressure 550 lbs. 12 hrs. Oil none bbls., 1st 24 hrs. WELL ACIDIZED no

CASING CEMENTED no SIZE No. Ft. Date COAL WAS ENCOUNTERED AT none FEET INCHES FEET INCHES FEET INCHES

WELL FRACTURED

RESULT AFTER TREATMENT

ROCK PRESSURE AFTER TREATMENT

Fresh Water 170 Feet Salt Water Feet 850

Table with columns: Formation, Color, Hard or Soft, Top, Bottom, Oil, Gas or Water, Depth, Remarks. Lists geological layers from Surface to Bottom hole with corresponding depths.

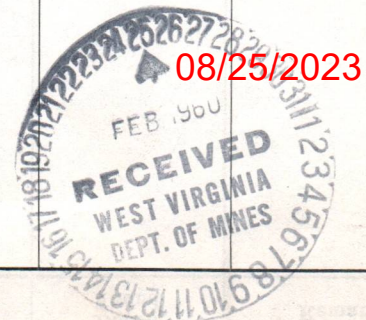

STATE OF WEST VIRGINIA
DEPARTMENT OF MINES
OIL AND GAS DIVISION

INSPECTOR'S WELL REPORT

Permit No. WAY-1242

Oil or Gas Well Gas
(KIND)

Company <u>R.B.Eichholz & J.B.Hyman</u> Address <u>216 Prince Street</u> <u>Alexandria, Va.</u> Farm <u>Walter Boys</u> Well No. <u>1</u> District <u>Butler</u> County <u>Wayne</u> Drilling commenced _____ Drilling completed _____ Total depth _____ Date shot _____ Depth of shot _____ Initial open flow _____ /10ths Water in _____ Inch Open flow after tubing _____ /10ths Merc. in _____ Inch Volume _____ Cu. Ft. Rock pressure _____ lbs. _____ hrs. Oil _____ bbls., 1st 24 hrs. Fresh water _____ feet _____ feet Salt water _____ feet _____ feet	<table border="1" style="width: 100%; border-collapse: collapse;"> <thead> <tr> <th style="width: 25%;">CASING AND TUBING</th> <th style="width: 25%;">USED IN DRILLING</th> <th style="width: 25%;">LEFT IN WELL</th> <th style="width: 25%;">PACKERS</th> </tr> </thead> <tbody> <tr> <td>Size</td> <td></td> <td></td> <td>Kind of Packer</td> </tr> <tr> <td>16</td> <td></td> <td></td> <td></td> </tr> <tr> <td>13</td> <td></td> <td></td> <td></td> </tr> <tr> <td>10</td> <td></td> <td></td> <td>Size of</td> </tr> <tr> <td>8 1/4</td> <td></td> <td></td> <td></td> </tr> <tr> <td>6 3/8</td> <td></td> <td></td> <td>Depth set</td> </tr> <tr> <td>5 3/16</td> <td></td> <td></td> <td></td> </tr> <tr> <td>3</td> <td></td> <td></td> <td>Perf. top</td> </tr> <tr> <td>2</td> <td></td> <td></td> <td>Perf. bottom</td> </tr> <tr> <td>Liners Used</td> <td></td> <td></td> <td>Perf. top</td> </tr> <tr> <td></td> <td></td> <td></td> <td>Perf. bottom</td> </tr> </tbody> </table> <table border="1" style="width: 100%; border-collapse: collapse; margin-top: 10px;"> <thead> <tr> <th style="width: 40%;">CASING CEMENTED</th> <th style="width: 20%;">SIZE</th> <th style="width: 20%;">No. FT.</th> <th style="width: 20%;">Date</th> </tr> </thead> <tbody> <tr> <td> </td> <td> </td> <td> </td> <td> </td> </tr> </tbody> </table> <table border="1" style="width: 100%; border-collapse: collapse; margin-top: 10px;"> <thead> <tr> <th style="width: 40%;">COAL WAS ENCOUNTERED AT</th> <th style="width: 20%;">FEET</th> <th style="width: 20%;">INCHES</th> <th style="width: 20%;"> </th> </tr> </thead> <tbody> <tr> <td> </td> <td> </td> <td> </td> <td> </td> </tr> <tr> <td> </td> <td> </td> <td> </td> <td> </td> </tr> <tr> <td> </td> <td> </td> <td> </td> <td> </td> </tr> </tbody> </table>	CASING AND TUBING	USED IN DRILLING	LEFT IN WELL	PACKERS	Size			Kind of Packer	16				13				10			Size of	8 1/4				6 3/8			Depth set	5 3/16				3			Perf. top	2			Perf. bottom	Liners Used			Perf. top				Perf. bottom	CASING CEMENTED	SIZE	No. FT.	Date					COAL WAS ENCOUNTERED AT	FEET	INCHES													
CASING AND TUBING	USED IN DRILLING	LEFT IN WELL	PACKERS																																																																						
Size			Kind of Packer																																																																						
16																																																																									
13																																																																									
10			Size of																																																																						
8 1/4																																																																									
6 3/8			Depth set																																																																						
5 3/16																																																																									
3			Perf. top																																																																						
2			Perf. bottom																																																																						
Liners Used			Perf. top																																																																						
			Perf. bottom																																																																						
CASING CEMENTED	SIZE	No. FT.	Date																																																																						
COAL WAS ENCOUNTERED AT	FEET	INCHES																																																																							

Drillers' Names _____

Remarks: Location has been made but not moved in as of this date

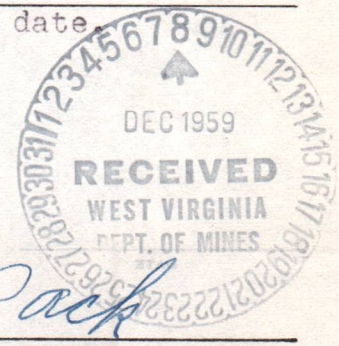

12-1-59

DATE

DISTRICT WELL INSPECTOR

08/25/2023

STATE OF WEST VIRGINIA
DEPARTMENT OF MINES
OIL AND GAS DIVISION
INSPECTOR'S PLUGGING REPORT

Permit No. _____ Well No. _____

COMPANY _____ ADDRESS _____

FARM _____ DISTRICT _____ COUNTY _____

Filling Material Used _____

Liner _____ Location _____ Amount _____ Packer _____ Location _____

PLUGS USED AND DEPTH PLACED			BRIDGES	CASING AND TUBING		
CEMENT-THICKNESS	WOOD-SIZE	LEAD	CONSTRUCTION-LOCATION	RECOVERED	SIZE	LOST

Drillers' Names _____

Remarks: _____

DATE I hereby certify I visited the above well on this date.

DISTRICT WELL INSPECTOR
08/25/2023

B-3

STATE OF WEST VIRGINIA
DEPARTMENT OF MINES
OIL AND GAS DIVISION

INSPECTOR'S WELL REPORT

Permit No. WAY-1242

Oil or Gas Well 1
(KIND)

Company	CASING AND TUBING	USED IN DRILLING	LEFT IN WELL	PACKERS
<u>R.B. Eichholtz & J.B. Hyman</u>	Size			
<u>216 Prince Street</u>	16			Kind of Packer
<u>Alexandria, Va.</u>	13			
<u>Walter Boys</u>	10	<u>40'</u>		Size of
<u>1</u>	8 1/4	<u>310'</u>		Depth set
<u>Butler</u> County <u>Wayne</u>	6 5/8	<u>1085' (pulled)</u>		<u>1545'</u>
<u>12-8-60</u>	5 3/16	<u>1545'</u>		<u>shoe</u>
<u>1-25-60</u> Total depth <u>1848'</u>	3			Perf. top
<u>1-25-60</u> Depth of shot <u>1848'</u>	2			Perf. bottom
<u>14</u> /10ths Water in <u>2</u> Inch	Liners Used			Perf. top
<u>178,000</u> Cu. Ft.				Perf. bottom
<u>178,000</u> Cu. Ft.	CASING CEMENTED	SIZE	No. FT.	Date
<u>170</u> feet				
<u>850</u> feet	COAL WAS ENCOUNTERED AT	FEET	INCHES	

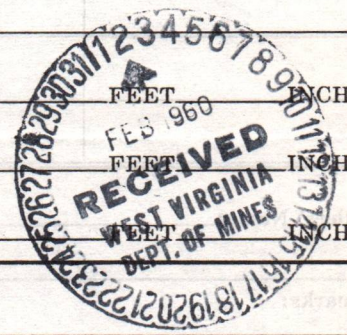

Drillers' Names Nick Compton
Edd Barnett

Remarks: Salt Sand 722'; Big Lime 977'; Injun Sand 1215'; Berea 1823'-1848'; shot first time with 100 Lbs. Well to be shot three times.

1-26-60

DATE

J.W. Paack

DISTRICT WELL INSPECTOR

08/25/2023

STATE OF WEST VIRGINIA
DEPARTMENT OF MINES
OIL AND GAS DIVISION
INSPECTOR'S PLUGGING REPORT

Permit No. _____ Well No. _____

COMPANY _____ ADDRESS _____

FARM _____ DISTRICT _____ COUNTY _____

Filling Material Used _____

Liner			Location			Amount			Packer			Location		
PLUGS USED AND DEPTH PLACED						BRIDGES			CASING AND TUBING					
CEMENT-THICKNESS		WOOD-SIZE	LEAD	CONSTRUCTION-LOCATION			RECOVERED	SIZE	LOST					

Drillers' Names _____

Remarks: _____

_____ DATE _____ I hereby certify I visited the above well on this date.

E-4

Fort Gay W. Va
Feb 24 1960

Department of Mines,
Oil & Gas Division,
Charleston, West Virginia

Dear Sirs:

Enclosed find well Record 1242-WAY-OF
Halter Boys # 1. - Butler District - Wayne Co.

Could you please mail me about a dozen of
well Record forms - O.B. #10. - also some application
sheets for Drilling permits - O.B. #1.

I also would appreciate very much to get a copy of
United Carbon Well # 1. on Minnie Lyeon Farm.
Butler District, Wayne County, permit way - 337
and Drilled in 1944.

Thanking you for your cooperation

I am

yours very truly

Wayne Lyeon

Sent 2-29-60

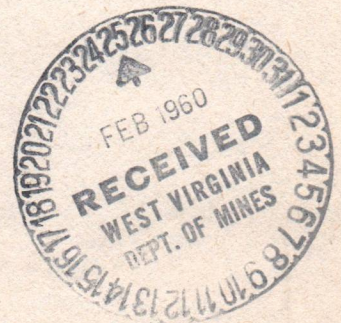

08/25/2023

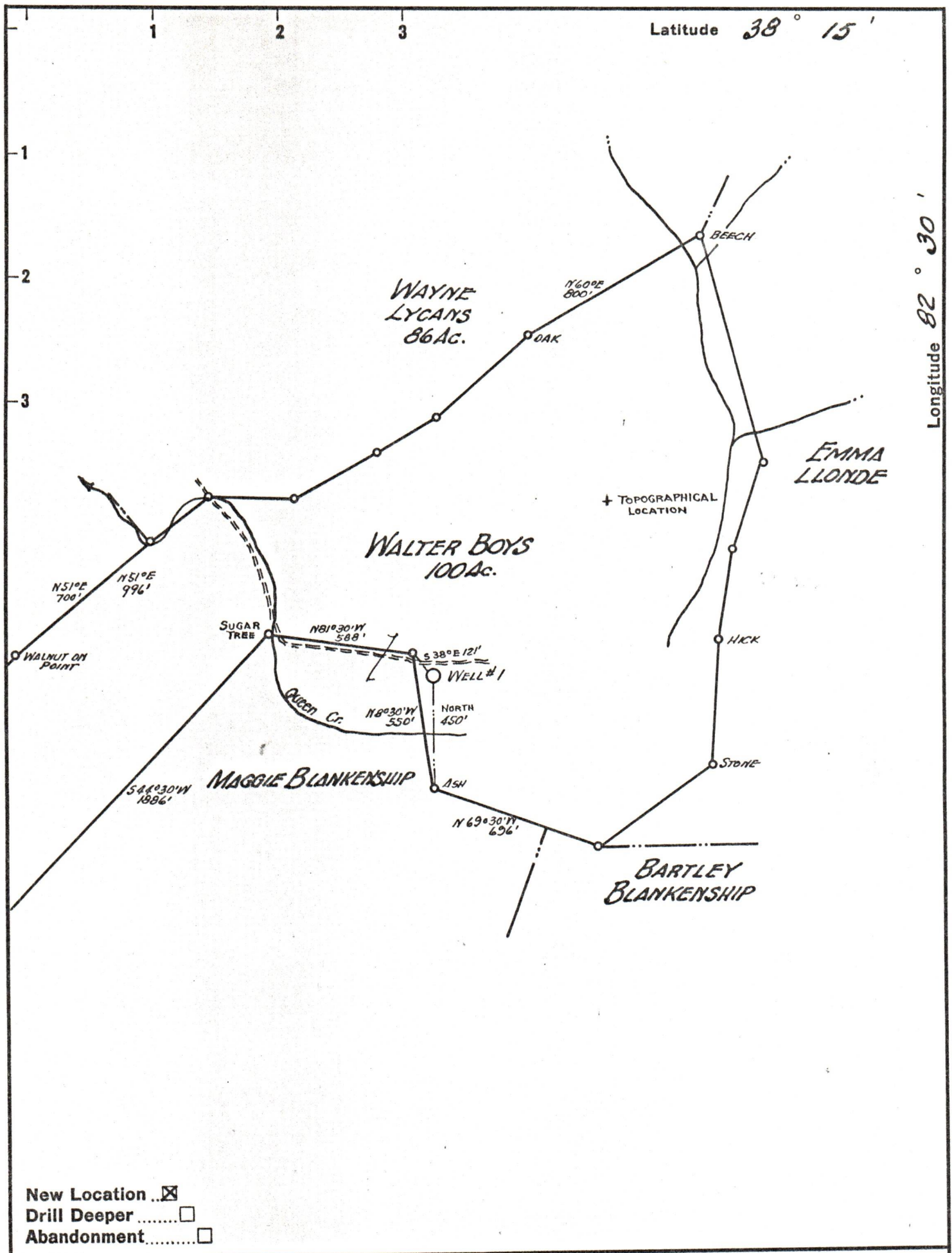

New Location
 Drill Deeper
 Abandonment

Company R.B. EICHHOLZ & J.B. HYMAN
 Address ALEXANDRIA, VA.
 Farm WALTER BOYS
 Tract 1 Acres 100 Lease No. _____
 Well (Farm) No. 1 Serial No. _____
 Elevation (Spirit Level) 635.0
 Quadrangle LOUISA, W. VA.
 County WAYNE District BUTLER
 Engineer Robert Wallace Jr.
 Engineer's Registration No. _____
 File No. _____ Drawing No. _____
 Date OCT 31, 1959 Scale 1" = 500'

STATE OF WEST VIRGINIA
 DEPARTMENT OF MINES
 OIL AND GAS DIVISION
 CHARLESTON

WELL LOCATION MAP

FILE NO. WAY-1248 08/25/2023

+ Denotes location of well on United States Topographic Maps, scale 1 to 62,500, latitude and longitude lines being represented by border lines as shown.

- Denotes one inch spaces on border line of original tracing.