



STATE OF WEST VIRGINIA
DEPARTMENT OF MINES
OIL AND GAS DIVISION

NOTICE OF PROPOSED LOCATION OF OIL AND GAS WELL

To THE DEPARTMENT OF MINES,
Charleston, W. Va.

way-1156

COAL OPERATOR OR COAL OWNER	Velma Gas Company
ADDRESS	% Woodrow Dingess Harts, West Virginia
COAL OPERATOR OR COAL OWNER	July 29, 19 59
ADDRESS	PROPOSED LOCATION
OWNER OF MINERAL RIGHTS	Butler District
ADDRESS	Wayne County
	Well No. 2 38° 15' 82° 25' E. 665'
	Bernie Booth Farm
	40 acres

GENTLEMEN:

The undersigned well operator is entitled to drill upon the above named farm or tract of land for oil and gas, having fee title thereto, (or as the case may be) under grant or lease dated December 5, 1958, made by Bernie & Haney Booth, to Woodrow Dingess, and recorded on the _____ day of _____, in the office of the County Clerk for said County in Book 49, page 259-60-61.

The enclosed plat was prepared by a competent engineer and shows the proposed location of a well to be drilled for oil and gas by the undersigned well operator on the farm and in the Magisterial District and County above named, determined by survey and courses and distances from two permanent points, or land marks.

The undersigned well operator is informed and believes there are no coal operators operating beds of coal beneath said farm or tract of land on which said well is located, or within 500 feet of the boundaries of the same, who have mapped their workings and filed their maps as required by law, excepting the coal operators or coal owners (if any) above named as addressees.

The above named coal operators or coal owners (if any) are notified that any objections they may desire to make to such proposed location, or which they are required to make by Section 3 of said Code, if the drilling of a well at said proposed location will cause a dangerous condition in or about their respective coal mines, must be received by, or filed with the Department of Mines within ten* days from the receipt of a copy of this notice and accompanying plat by said Department. Said coal operators are further notified that forms for use in making such objections will be furnished to them by the Department of Mines promptly on request and that all such objections must set forth as definitely as is reasonably possible the ground or grounds on which such objections are based and indicate the direction and distance the proposed location should be moved to overcome same.

(The next paragraph is to be completed only in Department's copy.)

Copies of this notice and the enclosed plat were mailed by registered mail, or delivered to the above named coal operators or coal owners at their above shown respective address _____ day before, or on the same day with the mailing or delivery of this copy to the Department of Mines at Charleston, West Virginia.

Very truly yours,
Velma Gas Company
Woodrow Dingess
WELL OPERATOR

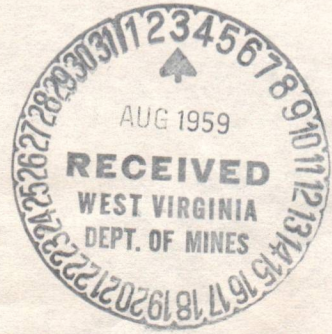

Address of Well Operator }

STREET
Harts
CITY OR TOWN
West Virginia
STATE

08/25/2023

*Section 3 If no such objections be filed or be found by the department of mines, within said period of ten days from the receipt of said notice and plat by the department of mines, to said proposed location, the department shall forthwith issue to the well operator a drilling permit reciting the filing of such plat, that no objections have been made by the coal operators to the location, or found thereto by the department, and that the same is approved and the well operator authorized to proceed to drill at said location.



STATE OF WEST VIRGINIA
DEPARTMENT OF MINES
OIL AND GAS DIVISION

NOTICE OF PROPOSED LOCATION OF OIL AND GAS WELL

To The Department of Mines
Charleston, W. Va.

NAME OF WELL OPERATOR
Velmis Gas Company
COMPLETE ADDRESS
Woodrow Diggins
Harts, West Virginia

COAL OPERATOR OR COAL OWNER
ADDRESS

PROPOSED LOCATION
July 29
1958

COAL OPERATOR OR COAL OWNER
ADDRESS

District
Butler
County
Wayne

ADDRESS

Well No. 22-22-2-1
Bernie Booth
Farm

OWNER OF MINERAL RIGHTS
ADDRESS
W. Va.

The undersigned well operator is entitled to drill upon the above named farm or tract of land for oil and gas having for title thereto, (or as the case may be) under grant or lease dated December 5, 1958 made by Bernie & Hanev Booth to Woodrow Diggins and recorded on the _____ day _____

at _____ in the office of the County Clerk for said County in Book 42, page 252-60-61

The enclosed plan was prepared by a competent engineer and shows the proposed location of a well to be drilled for oil and gas by the undersigned well operator on the farm and in the Mineral District and County above named, determined by survey and courses and distances from two permanent points on land marks.

The undersigned well operator is informed and believes there are no coal operators operating pads of coal beneath said farm or tract of land on which said well is located, or within 500 feet of the boundary of the same, who have mapped their workings and filed their maps as required by law, excepting the coal operators or coal owners (if any) above named as addressees.

The above named coal operators or coal owners (if any) are notified that any objections they may desire to make to such proposed location, or which they are required to make by Section 8 of said Code, if the drilling of a well at said proposed location will cause a dangerous condition in or about their respective coal mines, must be received by or filed with the Department of Mines within ten days from the receipt of a copy of this notice and accompanying plat by said Department. Said coal operators are further notified that forms for use in making such objections will be furnished to them by the Department of Mines promptly on request and that all such objections must set forth as definitely as is reasonably possible the ground or grounds on which such objections are based and indicate the direction and distance the proposed location should be moved to overcome same.

(The next paragraph is to be completed only in Department's copy.)
Copies of this notice and the enclosed plat were mailed by registered mail, or delivered in the above named coal operators or coal owners at their above shown respective address _____ day before _____ or on the same day with the mailing or delivery of this copy to the Department of Mines at Charleston, West Virginia.

Very truly yours,
Woodrow Diggins
WELL OPERATOR

Address of Well Operator
Harts
West Virginia

Address of Well Operator

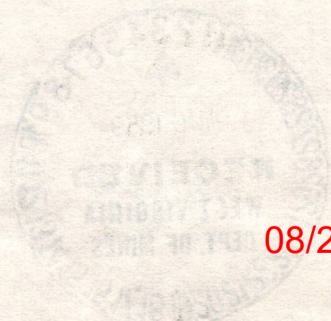

08/25/2023

Section 8. . . . If no such objections be filed or be found by the department of mines, within said period of ten days from the receipt of said notice and plat by the department of mines, for said proposed location, the department shall forthwith issue to the well operator a drilling permit reciting the filing of such plat, that no objections have been made by the coal operators in the location or found thereby by the department, and that the same is approved and the well operator authorized to proceed to drill at said location.

Permit Number

A-10

August 3, 1959

Mr. James W. Pack, Inspector
Oil and Gas Wells
Hamlin, West Virginia

Dear Mr. Pack:

We are in receipt of application for permit
to drill Well No. 2 on Bernie Boeth Farm, Butler District,
Wayne County from Velma Gas Company. Permit number will
be WAY-1216.

Very truly yours,

Crawford L. Wilson, Director
DEPARTMENT OF MINES

BY

Assistant Director
OIL AND GAS DIVISION

MG/m

08/25/2023

A-11

August 13, 1959

Valma Gas Company
c/o Mr. Woodrow Dingess
Harts, West Virginia

Dear Sirs:

Enclosed is Permit WAY-1216 for drilling
Well No. 2 on Bernie Booth Farm, Butler District, Wayne
County.

Please post one copy of permit at the well
site. When drilling is completed, please send us two
copies of the well record.

Very truly yours,

Crawford L. Wilson, Director
DEPARTMENT OF MINES

BY

Assistant Director
OIL AND GAS DIVISION

MG/m

encl:

cc Mr. James W. Pack, Inspector

Mr. R. C. Tucker, Assistant
State Geologist

78910112 08/25/2023

July 28-1960

Mr. F. H. [unclear]
Assistant Director
Oil & Gas Division

Dear Sir:
Please send me my papers to
fill out my well permit # 2
Butler Dist.
Permit # W-101-1316
A permit will send you also.

James L. [unclear]
Rt # 2 Box 117
Brambleton, Va

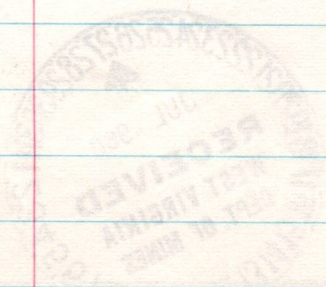

B-2

Formation	Color	Hard or Soft	Top 18	Bottom	Oil, Gas or Water	Depth Found	Remarks
Little Lime			1060	1090			
Shell-Lime			1090	1240	Big Lime	1188'-1192'	Little Gas P
Slate			1240	1242			
Injun Sand		Soft	1242	1360	Injun Sand		
Slate-Shells			1360	1730			
Shell			1730	1745			
Slate-Shell			1745	1800			
Shell			1800	1815			
Slate-Shell			1815	1830			
Coffee Shell			1830	1855	Coffee Shell		
Brewer Sand			1855	1863	Brewer Sand		Small Gas Pa
Pocket			1863	1871	Pocket	8'	
TOTAL DEPTH				1871'			
First shot 2000# Gas Well B							
Second shot 6000# Gas Well B							

08/25/2023

Date _____, 19____

APPROVED _____, Owner

By _____ (Title)

B-1



STATE OF WEST VIRGINIA
DEPARTMENT OF MINES
OIL AND GAS DIVISION 18

Quadrangle Wayne

Permit No. WAY-1216

WELL RECORD

Oil or Gas Well _____ (KIND)

Company Velma Gas Company
Address Branchland, W. Va.
Farm Bernie Booth Acres 40
Location (waters) Patrick Creek
Well No. Booth Well #2 Elev. 665'
District Butler County Wayne
The surface of tract is owned in fee by Bernie Booth
Honey Booth Address Wayne, W. Va.
Mineral rights are owned by Paul & Woodrow Dingess
Address Branchland, W. Va.
Drilling commenced October 14, 1959
Drilling completed June 29, 1960
Date Shot 5/31 From 3/10 To 3/10
With 6000 Gas Well B.
Open Flow 3 /10ths Water in 2 Inch
/10ths Merc. in _____ Inch
Volume _____ Cu. Ft.
Rock Pressure 250 lbs. 60 hrs.
Oil _____ bbls., 1st 24 hrs.
WELL ACIDIZED _____
WELL FRACTURED _____

Casing and Tubing	Used in Drilling	Left in Well	Packers
Size			Kind of Packer
16			
13			
10		25	Size of
8 1/4		239	
6 5/8		1386	Depth set
5 3/16			
3			Perf. top
2			Perf. bottom
Liners Used			Perf. top
			Perf. bottom

CASING CEMENTED _____ SIZE _____ No. Ft. _____ Date _____
COAL WAS ENCOUNTERED AT _____ FEET _____ INCHES
_____ FEET _____ INCHES _____ FEET _____ INCHES
_____ FEET _____ INCHES _____ FEET _____ INCHES

RESULT AFTER TREATMENT

ROCK PRESSURE AFTER TREATMENT

Fresh Water 40 Feet 40 to 75 Salt Water 700 Feet to 885

Formation	Color	Hard or Soft	Top	Bottom	Oil, Gas or Water	Depth	Remarks
Sand	Gray	Soft	0	20	Water	40'	Water
Slate			20	45			
Sand			45	75			
Slate			75	100			
Sand & Slate			100	120			
Sand	Gray	Soft	120	135	Coal	5'	Coal
Coal			135	140			
Slate			140	165			
Sand			165	185			
Slate			185	200			
Sand			200	226			
Slate			226	255			
Sand			255	275			
Slate			275	350			
Sand			350	370			
Slate	Soft	Soft	370	400	Salt Water	700'	08/25/2023
Sand			400	426			
Slate			426	435			
Sand			435	450			
Slate			450	500			
Sand			500	530			
Slate			530	580			
Sand			580	616			
Slate			616	645			
Salt Sand			645	885			
Slate	885	905					
Sand	905	985					
Slate	985	1000					
Sand	1000	1015					
Slate	1015	1060					

STATE OF WEST VIRGINIA
DEPARTMENT OF MINES
OIL AND GAS DIVISION

INSPECTOR'S WELL REPORT

Permit No. WAY-1216

Oil or Gas Well Gas
(KIND)

Company <u>Velma Gas Company</u>	CASING AND TUBING	USED IN DRILLING	LEFT IN WELL	PACKERS
Address <u>Harts, West Va.</u>	Size			Kind of Packer
Farm <u>Bernie Booth</u>	16			
Well No. <u>2</u>	13			Size of
District <u>Butler</u> County <u>Wayne</u>	10			
Drilling commenced <u>10-1-59</u>	8 1/4			Depth set
Drilling completed _____ Total depth _____	6 5/8			
Date shot _____ Depth of shot _____	5 3/16			Perf. top
Initial open flow _____ /10ths Water in _____ Inch	3			Perf. bottom
Open flow after tubing _____ /10ths Merc. in _____ Inch	2			Perf. top
Volume _____ Cu. Ft.	Liners Used			Perf. bottom
Rock pressure _____ lbs. _____ hrs.				
Oil _____ bbls., 1st 24 hrs.	CASING CEMENTED _____ SIZE _____ No. FT. _____ Date _____			
Fresh water _____ feet _____ feet	COAL WAS ENCOUNTERED AT _____ FEET _____ INCHES			
Salt water _____ feet _____ feet	_____ FEET _____ INCHES _____ FEET _____ INCHES			

Drillers' Names Edgar Blankenship

Remarks: Rigging machine up and starting to spud - depth 18ft.

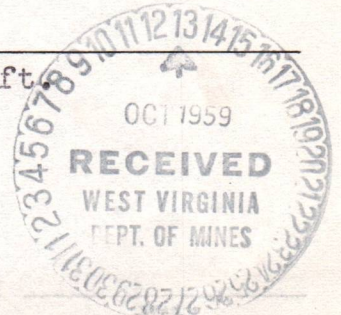

10-6-59

DATE

J.W. Pack

DISTRICT WELL INSPECTOR

08/25/2023

STATE OF WEST VIRGINIA
DEPARTMENT OF MINES
OIL AND GAS DIVISION

INSPECTOR'S PLUGGING REPORT

Permit No. _____

Well No. _____

COMPANY _____ ADDRESS _____

FARM _____ DISTRICT _____ COUNTY _____

Filling Material Used _____

Liner _____ Location _____ Amount _____ Packer _____ Location _____

PLUGS USED AND DEPTH PLACED			BRIDGES	CASING AND TUBING		
CEMENT-THICKNESS	WOOD-SIZE	LEAD	CONSTRUCTION-LOCATION	RECOVERED	SIZE	LOST

Drillers' Names _____

Remarks: _____

DATE I hereby certify I visited the above well on this date.

13-4

STATE OF WEST VIRGINIA
DEPARTMENT OF MINES
OIL AND GAS DIVISION

INSPECTOR'S WELL REPORT

Permit No. WAY-1216

Oil or Gas Well Gas
(KIND)

Company <u>Velma Gas Company</u>	CASING AND TUBING	USED IN DRILLING	LEFT IN WELL	PACKERS
Address <u>Harts, West Va.</u>	Size			
Farm <u>Bernie Booth</u>	16			Kind of Packer
Well No. <u>2</u>	13			
District <u>Butler</u> County <u>Wayne</u>	10	25'		Size of
Drilling commenced <u>10-1-59</u>	8 1/4			
Drilling completed _____ Total depth _____	6 3/8			Depth set
Date shot _____ Depth of shot _____	5 3/16			
Initial open flow _____ /10ths Water in _____ Inch	3			Perf. top
Open flow after tubing _____ /10ths Merc. in _____ Inch	2			Perf. bottom
Volume _____ Cu. Ft.	Liners Used			Perf. top
Rock pressure _____ lbs. _____ hrs.				Perf. bottom
Oil _____ bbls., 1st 24 hrs.	CASING CEMENTED _____ SIZE _____ No. FT. _____ Date _____			
Fresh water <u>40</u> feet _____ feet	COAL WAS ENCOUNTERED AT _____ FEET _____ INCHES			
Salt water _____ feet _____ feet	_____ FEET _____ INCHES _____ FEET _____ INCHES			

Drillers' Names Edgar Blankenship

Remarks: Drilling depth - 160'.

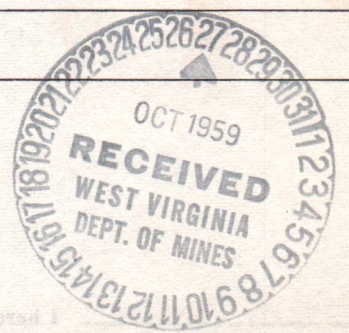

J.W. pack

10-23-59

DATE

DISTRICT WELL INSPECTOR
08/25/2023

STATE OF WEST VIRGINIA
DEPARTMENT OF MINES
OIL AND GAS DIVISION

INSPECTOR'S PLUGGING REPORT

Permit No. _____

Well No. _____

COMPANY _____ ADDRESS _____

FARM _____ DISTRICT _____ COUNTY _____

Filling Material Used _____

Liner	Location	Amount	Packer	Location	
PLUGS USED AND DEPTH PLACED			BRIDGES	CASING AND TUBING	
CEMENT-THICKNESS	WOOD-SIZE	LEAD	CONSTRUCTION-LOCATION	RECOVERED	SIZE LOST

Drillers' Names _____

Remarks:

_____ I hereby certify I visited the above well on this date.

DATE

DISTRICT WELL INSPECTOR
08/25/2023

B-5

STATE OF WEST VIRGINIA
DEPARTMENT OF MINES
OIL AND GAS DIVISION

INSPECTOR'S WELL REPORT

Permit No. WAY-1216

Oil or Gas Well 2
(KIND)

Company <u>Velma Gas Company</u>	CASING AND TUBING	USED IN DRILLING	LEFT IN WELL	PACKERS
Address <u>Harts, W. Va.</u>	Size			
Farm <u>Bernie Booth</u>	16			Kind of Packer
Well No. <u>2</u>	13			
District <u>Butler</u> County <u>Wayne</u>	10	25'		Size of
Drilling commenced <u>10-1-59</u>	8 1/4			
Drilling completed _____ Total depth _____	6 5/8			Depth set
Date shot _____ Depth of shot _____	5 3/16			
Initial open flow _____ /10ths Water in _____ Inch	3			Perf. top
Open flow after tubing _____ /10ths Merc. in _____ Inch	2			Perf. bottom
Volume _____ Cu. Ft.	Liners Used			Perf. top
Rock pressure _____ lbs. _____ hrs.				Perf. bottom
Oil _____ bbls., 1st 24 hrs.	CASING CEMENTED _____ SIZE _____ No. FT. _____ Date _____			
Fresh water <u>40</u> feet _____ feet	COAL WAS ENCOUNTERED AT <u>135</u> FEET <u>60</u> INCHES			
Salt water _____ feet _____ feet	_____ FEET _____ INCHES _____ FEET _____ INCHES			
	_____ FEET _____ INCHES _____ FEET _____ INCHES			

Drillers' Names Edgar Blankenship

Remarks: Well not in operation on day of visit. The 8-1/4" casing has been run. I figure the well is approximately 350 ft. deep.

11-23-59
DATE



J.W. Pack
DISTRICT WELL INSPECTOR

08/25/2023

STATE OF WEST VIRGINIA
DEPARTMENT OF MINES
OIL AND GAS DIVISION

INSPECTOR'S PLUGGING REPORT

Permit No. _____ Well No. _____

COMPANY _____ ADDRESS _____

FARM _____ DISTRICT _____ COUNTY _____

Filling Material Used _____

Liner	Location	Amount	Packer	Location	
PLUGS USED AND DEPTH PLACED			BRIDGES	CASING AND TUBING	
CEMENT-THICKNESS	WOOD-SIZE	LEAD	CONSTRUCTION-LOCATION	RECOVERED	SIZE LOST

Drillers' Names _____

Remarks: _____

_____ well not in operation on day of visit. The 5-1/2" casing has been run. I figure the well is approximately 350 feet deep.

_____ I hereby certify I visited the above well on this date.
DATE

DISTRICT WELL INSPECTOR
08/25/2023

B-6

STATE OF WEST VIRGINIA
DEPARTMENT OF MINES
OIL AND GAS DIVISION

INSPECTOR'S WELL REPORT

Permit No. WAY-1216

Oil or Gas Well Gas
(KIND)

Company <u>Velma Gas Company</u>	CASING AND TUBING	USED IN DRILLING	LEFT IN WELL	PACKERS
Address <u>Harts, W. Va.</u>	Size			
Farm <u>Bernie Booth</u>	16			Kind of Packer
Well No. <u>2</u>	13			
District <u>Butler</u> County <u>Wayne</u>	10	25'		Size of
Drilling commenced <u>10-1-59</u>	8 1/4	239'		
Drilling completed _____ Total depth _____	6 5/8			Depth set
Date shot _____ Depth of shot _____	5 3/16			
Initial open flow _____ /10ths Water in _____ Inch	3			Perf. top
Open flow after tubing _____ /10ths Merc. in _____ Inch	2			Perf. bottom
Volume _____ Cu. Ft.	Liners Used			Perf. top
Rock pressure _____ lbs. _____ hrs.				Perf. bottom
Oil _____ bbls., 1st 24 hrs.	CASING CEMENTED _____ SIZE _____ No. FT. _____ Date _____			
Fresh water <u>40</u> feet _____ feet	COAL WAS ENCOUNTERED AT <u>135</u> FEET <u>60</u> INCHES			
Salt water <u>700</u> feet _____ feet	_____ FEET _____ INCHES _____ FEET _____ INCHES			

Drillers' Names Edgar Blankenship

Remarks: Salt Sand 645'-885'; drilling depth 945'. Working day-light, running 1 - 8 hour shift on well. Changing drilling lines to-day.

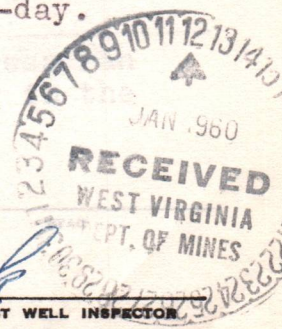

DATE 1-6-60

08/25/2023

STATE OF WEST VIRGINIA
 DEPARTMENT OF MINES
 OIL AND GAS DIVISION
INSPECTOR'S PLUGGING REPORT

Permit No. _____

Well No. _____

COMPANY _____ ADDRESS _____

FARM _____ DISTRICT _____ COUNTY _____

Filling Material Used _____

PLUGS USED AND DEPTH PLACED			BRIDGES	CASING AND TUBING		
CEMENT-THICKNESS	WOOD-SIZE	LEAD	CONSTRUCTION-LOCATION	RECOVERED	SIZE	LOST

Drillers' Names _____

Remarks: _____

Visited well and found it plugged down. The casing tools are hanging in the derrick and drilling tools have not been strung up.

_____ I hereby certify I visited the above well on this date.

DATE

08/25/2023
 DISTRICT WELL INSPECTOR

PROPOSED MANNER OF PLUGGING
 (REQUIRED BY RULES AND REGULATIONS)
WEST VIRGINIA DEPARTMENT OF MINES
OIL AND GAS DIVISION
WORK ORDER

Well to be plugged and filled as follows:

1871-1390 Clay & Stone

Pull 7" Casing

1390-1366 Cement

1366-1195 Clay & Stone

1195-1180 Cement

1180-750 Fill Material

750-700 Clay & Stone

700-690 Cement

690-680 Stone

680-240 Fill material

Pull 8" Casing

240-220 Clay

220-210 Cement

210-200 Stone

200-170 Clay & Stone

170-115 Cement

115-100 Stone

100-45 Clay & Stone

45-35 Cement

35-10 Clay & Stone

10-0 Cement with monument according to Rule 14, 1973 Regs.

PS Form 3811, Nov. 1973

● SENDER: Complete items 1 and 2. Add your address in the "RETURN TO" space on reverse.

1. The following service is requested (check one).
 Show to whom and date delivered..... 15¢
 Show to whom, date, & address of delivery.. 35¢
 DELIVER ONLY TO ADDRESSEE and show to whom and date delivered..... 65¢
 DELIVER ONLY TO ADDRESSEE and show to whom, date, and address of delivery 85¢

2. ARTICLE ADDRESSED TO:
 Mills Drilling Company
 P.O. Box 65
 Wayne, W.Va. 25570

3. ARTICLE DESCRIPTION:
 REGISTERED NO. CERTIFIED NO. INSURED NO.
 _____ 18759 _____
 (Always obtain signature of addressee or agent)

I have received the article described above.
 SIGNATURE *Mills Drilling Co.*
Carl Osburn

4. DATE OF DELIVERY _____ POSTMARK **JUN 16 1975**

5. ADDRESS (Complete only if requested)

6. UNABLE TO DELIVER BECAUSE: _____ CLERK'S INITIALS *DR*

RETURN RECEIPT, REGISTERED, INSURED AND CERTIFIED MAIL

* GPO : 1974 O - 527 - 803

To the Department of Mines
 Coal Owner or Operator,
 Lease or Property Owner.

**IF PARTIAL PLUGGING
 PLEASE SUBMIT REVISED WELL RECORD
 WHEN WORK IS COMPLETED.**

Gentlemen:

This "work order" is submitted for your approval and concurrence and unless notified of your disapproval or non-concurrence, the undersigned will proceed with the plugging and filling of said well in the above described manner on the date inspector is notified after permit is issued.

Very truly yours,

Woodrow Dinges
 Well Operator

No objections have been filed by the coal owner or coal operator, or any available adjacent lease or property owners or interposed by the Department of Mines to the manner herein described for the plugging and filling of the well above mentioned. Therefore, the same is hereby approved this

1st day of *April*, 19*75*.

DEPARTMENT OF MINES **08/25/2023**
 Oil and Gas Division

By: *Robert H. [Signature]* / *Approved by Harry [Signature]*

NOTE: This "work order" shall be filed in triplicate, one copy for the files of the Department of Mines; one to be approved or corrected and returned to the well operator as his authority for plugging said well; and one for the well inspector.



RECEIVED

MAR 31 1975

OIL & GAS DIVISION
DEPT. OF MINES

STATE OF WEST VIRGINIA
DEPARTMENT OF MINES
OIL AND GAS WELLS DIVISION

NOTICE OF INTENTION TO PLUG AND ABANDON WELL

(REQUIRED BY SECTION 9, ARTICLE 4, CHAPTER 22 OF THE CODE)

To THE DEPARTMENT OF MINES,
Charleston, W. Va.

Coal Not Operated
Coal Operator

Velma Gas Company
Name of Well Operator

Address

Branchland, WV
Complete Address

Coal Owner

3-24-75
Date

WELL TO BE ABANDONED

Address

Butler District

Bernie Booth
Lease or Property Owner

Wayne County

Route # 1
Wayne, WV
Address

Well No. 2
Bernie Booth Farm

Inspector Kenneth E. Butcher Telephone 236 4885

TO BE NOTIFIED 24 HOURS IN ADVANCE OF PLUGGING OPERATIONS

Gentlemen:—

The undersigned well operator is about to abandon the above described well and will commence

the work of plugging and abandoning said well on the date inspector is notified (which date shall not be less than five days after the day on which this notice so mailed is received, or in due course should be received by the Department of Mines).

This notice is given you in order that your respective representatives may be present at the plugging and filling of said well. You are further notified that whether you are represented or not represented the undersigned will proceed on that date, or shortly thereafter, to plug and fill said well in the manner required by Section 10, Article 4, Chapter 22 of the Code and given in detail on the reverse side of this notice, in "Work Order."

This notice is being mailed by registered mail to each of you at the above addresses on the above date.

Very truly yours,

Woodrow Dingess
Well Operator

NOTE: Upon the abandonment of any well drilled prior to June 1, 1929, a plat prepared by a registered engineer, shall be filed with THREE COPIES OF APPLICATION, (OG-9) AND "WORK ORDER" AND TWO COPIES OF THE WELL RECORD, (OG-10). The map must show the district and county in which the tract of land is located, the name and acreage of same, the name or names of the owners and names of adjacent tracts and the location of the well to be abandoned, determined by survey with the courses and distances of such well from two permanent points or landmarks on said tract, in compliance with Rule 5 of the Rules and Regulations.

NOTE: In case plugging is not commenced within four months from the date of permit, same shall expire and be of no further force or effect.

NOTE: PERMIT IS NON TRANSFERABLE.

~~ESTIMATED~~ BOND Plug

WAY-1216 - P

Permit Number

AFFIDAVIT, FORM OG-8, MANNER WELL PLUGGED MUST BE SUBMITTED TO OBTAIN RELEASE OF WELL UNDER BOND.

08/25/2023

STATE OF WEST VIRGINIA
DEPARTMENT OF MINES
OIL AND GAS WELLS DIVISION

RECEIVED

MAY 9 1975

OIL & GAS DIVISION
DEPT. OF MINES

AFFIDAVIT OF PLUGGING AND FILLING WELL

AFFIDAVIT SHOULD BE MADE IN TRIPPLICATE. ONE COPY MAILED TO THE DEPARTMENT, ONE COPY TO BE RETAINED BY THE WELL OPERATOR AND THE THIRD COPY (AND EXTRA COPIES IF REQUIRED) SHOULD BE MAILED TO EACH COAL OPERATOR AT THEIR RESPECTIVE ADDRESSES.

<u>Coal not operated</u>	<u>Velma Gas Company</u>
COAL OPERATOR OR OWNER	NAME OF WELL OPERATOR
_____	<u>Branchland, WV</u>
ADDRESS	COMPLETE ADDRESS
_____	<u>5-1</u> 19 <u>75</u>
COAL OPERATOR OR OWNER	WELL AND LOCATION
_____	<u>Butler</u> District
ADDRESS	<u>Wayne</u> County
<u>Burnie Booth</u>	Well No. <u>2</u>
LEASE OR PROPERTY OWNER	<u>Burnie Booth</u> Farm
<u>Route # 1</u>	<u>Kenneth E. Butcher</u>
<u>Wayne, WV 25570</u>	STATE INSPECTOR SUPERVISING PLUGGING
ADDRESS	

AFFIDAVIT

STATE OF WEST VIRGINIA, }
County of Wayne } ss:
Donald Followay and Sam Dingess
being first duly sworn according to law depose and say that they are experienced in the work of plugging and filling oil and gas wells and were employed by Mills Drilling Co., well operator, and participated in the work of plugging and filling the above well, that said work was commenced on the 9th day of April, 19 75, and that the well was plugged and filled in the following manner:

SAND OR ZONE RECORD FORMATION	FILLING MATERIAL	PLUGS USED SIZE & KIND	CASING	
			CSG PULLED	CSG LEFT IN
1871-1390	Clay & Stone			
Ripped 7" Casing	@1365 and pulled	7"	1365	21
1390-1366	Cement	8"	239	0
1366-1195	Clay & Stone	10"	0	25
1195-1180	Cement			
1180-700	Clay & Stone			
700-690	Cement			
690-240	Clay & Stone			
Pulled 8" Casing	@ 239			
240-220	Clay			
220-210	Cement			
210-200	Stone			
170-115	Cement			
115-100	Stone			
100-45	Stone & Clay			
45-35	Cement			
35-10	Clay & Stone			
10-Surface COAL SEAMS	Cement with monument			
(NAME)		DESCRIPTION OF MONUMENT		
(NAME)		7" Casing cemented 7' below surface & rising 3' above surface, inscribed		
(NAME)		Velma Gas Co. Burnie Booth # 2		
(NAME)		4-21-75		

and that the work of plugging and filling said well was completed on the 21st day of April, 19 75

And further deponents saith not.

Donald Followay
Sam Dingess 08/25/2023
Pilar Harrison

Sworn to and subscribed before me this 5th day of May, 19 75

My commission expires:
April 17, 1978

Notary Public.
Permit No. WAY-1216-P

STATE OF WEST VIRGINIA
DEPARTMENT OF MINES
OIL AND GAS WELLS DIVISION

RECEIVED
JUN 13 1975
OIL & GAS DIVISION
DEPT. OF MINES

INSPECTOR'S WELL REPORT

Permit No. Way-1216P

Oil or Gas Well _____
(KIND)

Company	CASING AND TUBING	USED IN DRILLING	LEFT IN WELL	PACKERS
<u>Mills Drilling Co</u>	Size			
<u>Wayne, WVA,</u>	16			Kind of Packer
<u>Bernie Booth</u>	13			
Well No. <u>2</u>	10			Size of
District <u>Butler</u> County <u>Wayne</u>	8 1/4			
Drilling commenced _____	6 5/8			Depth set
Drilling completed _____ Total depth _____	5 3/16			
Date shot _____ Depth of shot _____	3			Perf. top
Initial open flow _____ /10ths Water in _____ Inch	2			Perf. bottom
Open flow after tubing _____ /10ths Merc. in _____ Inch	Liners Used			Perf. top
Volume _____ Cu. Ft.				Perf. bottom
Rock pressure _____ lbs. _____ hrs.	CASING CEMENTED _____ SIZE _____ No. FT. _____ Date _____			
Oil _____ bbls., 1st 24 hrs.	NAME OF SERVICE COMPANY _____			
Fresh water _____ feet _____ feet	COAL WAS ENCOUNTERED AT _____ FEET _____ INCHES			
Salt water _____ feet _____ feet	_____ FEET _____ INCHES _____ FEET _____ INCHES			
	_____ FEET _____ INCHES _____ FEET _____ INCHES			

Drillers' Names _____

Remarks:

Final inspection made on this well.

6-11-75
DATE

K. E. Butcher
INSPECTOR

08/25/2023

STATE OF WEST VIRGINIA
 DEPARTMENT OF MINES
 OIL AND GAS WELLS DIVISION

INSPECTOR'S PLUGGING REPORT

Permit No. _____ Well No. _____

COMPANY _____ ADDRESS _____

FARM _____ DISTRICT _____ COUNTY _____

Filling Material Used _____

Liner	Location	Amount	Packer	Location		
PLUGS USED AND DEPTH PLACED			BRIDGES	CASING AND TUBING		
CEMENT-THICKNESS	WOOD-SIZE	LEAD	CONSTRUCTION-LOCATION	RECOVERED	SIZE	LOST

Drillers' Names _____

Remarks: _____

_____ I hereby certify I visited the above well on this date.

DATE

DISTRICT WELLS INSPECTOR
08/25/2023



State of West Virginia

Department of Mines

Oil and Gas Division

Charleston 25305

June 13, 1975

Mills Drilling Company

P O Box 65

Wayne, W.Va. 25570

In Re: Permit No. WAY-1216-P
Farm Bernie Booth
Well No. 2
District Butler
County Wayne

Gentlemen:

The final inspection report for the well which is described above has been received in this office. Only the column checked below applies.

 The bond covering the well designated by the above permit number has been released under your Blanket Bond.

XXXXX Please return the enclosed cancelled bond which covered the well designated by the above permit number to the Surety Company who executed said bond in your behalf, in order that they may give you credit on their records.

Very truly yours,

Deputy Director
Oil and Gas Division

RLD/cc (Velma Gas Company)
Enclosure: Single Bond dated 3-24-75 (Fidelity & Deposit Co. of Maryland)

08/25/2023

0.6

STATE OF WEST VIRGINIA
DEPARTMENT OF MINES
OIL AND GAS DIVISION

INSPECTOR'S WELL REPORT

Permit No. WAY-1216

Oil or Gas Well Gas
(KIND)

Company	CASING AND TUBING	USED IN DRILLING	LEFT IN WELL	PACKERS
<u>Velma Gas Company</u>	Size			
<u>Harts, W. Va.</u>	16			Kind of Packer
<u>Bernie Booth</u>	13			
<u>2</u>	10	<u>25'</u>		Size of
<u>Butler</u> County <u>Wayne</u>	8 1/4	<u>239'</u>		Depth set
<u>10-1-59</u>	6 5/8	<u>1385'</u>		<u>APR 1960</u>
	5 3/16			RECEIVED
	3			WEST VIRGINIA
	2			Perf. top
	Liners Used			Perf. bottom
				Perf. top
				Perf. bottom
Initial open flow _____ /10ths Water in _____ Inch	CASING CEMENTED <u>10 sks</u> SIZE <u>7"</u> No. FT. _____ Date _____			
Open flow after tubing _____ /10ths Merc. in _____ Inch	COAL WAS ENCOUNTERED AT <u>135</u> FEET <u>60</u> INCHES			
Volume _____ Cu. Ft.	_____ FEET _____ INCHES _____ FEET _____ INCHES			
Rock pressure _____ lbs. _____ hrs.	_____ FEET _____ INCHES _____ FEET _____ INCHES			
Oil _____ bbls., 1st 24 hrs.	_____ FEET _____ INCHES _____ FEET _____ INCHES			
Fresh water <u>40</u> feet _____ feet				
Salt water <u>700</u> feet _____ feet				

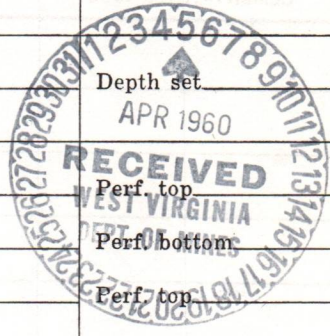

Drillers' Names Edgar Blankenship

Thermon Moore

Remarks: Salt Sand 645'-885'; Big Lime 1090'-1240'; Injun Sand 1242'-1360'; show of gas in Injun sand 1350'-1355'; show gas in Big Lime 1188'-1192'; drilling depth 1856' in Brown shale.

3/28/60

DATE

Jw. Pack

DISTRICT WELL INSPECTOR

08/25/2023

STATE OF WEST VIRGINIA
DEPARTMENT OF MINES
OIL AND GAS DIVISION
INSPECTOR'S PLUGGING REPORT

Permit No. _____ Well No. _____
COMPANY _____ ADDRESS _____
FARM _____ DISTRICT _____ COUNTY _____
Filling Material Used _____

Liner		Location	Amount	Packer	Location		
PLUGS USED AND DEPTH PLACED			BRIDGES		CASING AND TUBING		
CEMENT-THICKNESS	WOOD-SIZE	LEAD	CONSTRUCTION-LOCATION		RECOVERED	SIZE	LOST

Drillers' Names _____

Remarks: _____

_____ I hereby certify I visited the above well on this date.
DATE

DISTRICT WELL INSPECTOR
08/25/2023

OG-11
C-11

STATE OF WEST VIRGINIA
DEPARTMENT OF MINES
OIL AND GAS DIVISION

INSPECTOR'S WELL REPORT

Permit No. WAY-1216

Oil or Gas Well Gas
(KIND)

Company <u>Velma Gas Company</u>	CASING AND TUBING	USED IN DRILLING	LEFT IN WELL	PACKERS
Address <u>Harts, West Va.</u>	Size			Kind of Packer
Farm <u>Bernie Booth</u>	16			
Well No. <u>2</u>	13			
District <u>Butler</u> County <u>Wayne</u>	10	<u>25'</u>		Size of
Drilling commenced <u>10-1-59</u>	8 1/4	<u>239'</u>		Depth set
Drilling completed <u>3-30-60</u> Total depth <u>1868'</u>	6 5/8	<u>1386'</u>		
Date shot <u>not shot</u> Depth of shot	5 3/16			Perf. top
Initial open flow _____/10ths Water in _____ Inch	3			Perf. bottom
Open flow after tubing _____/10ths Merc. in _____ Inch	2			Perf. top
Volume _____ Cu. Ft.	Liners Used			Perf. bottom
Rock pressure _____ lbs. _____ hrs.	CASING CEMENTED _____ SIZE _____ No. FT. _____ Date _____			
Oil <u>1 Bbl.</u> _____ bbls., 1st <u>48</u> hrs.	COAL WAS ENCOUNTERED AT <u>135</u> FEET <u>60</u> INCHES			
Fresh water <u>40</u> feet _____ feet	_____ FEET _____ INCHES _____ FEET _____ INCHES			
Salt water <u>700</u> feet _____ feet	_____ FEET _____ INCHES _____ FEET _____ INCHES			

Drillers' Names Edgar Blankenship

Remarks: Big Lime 1090'-1240'; Injun Sand 1242'-1360'; Berea Sand 1843'-1853'; total depth 1868'. Salt Sand 645'-998'. Woodrow Dingess, drilling contractor

4/7/60
DATE

RECEIVED
WEST VIRGINIA
DEPT. OF MINES
APR 960
J.W. Pack
DISTRICT WELL INSPECTOR
08/25/2023

STATE OF WEST VIRGINIA
DEPARTMENT OF MINES
OIL AND GAS DIVISION
INSPECTOR'S PLUGGING REPORT

Permit No. _____ Well No. _____

COMPANY _____ ADDRESS _____

FARM _____ DISTRICT _____ COUNTY _____

Filling Material Used _____

Liner			Location	Amount	Packer	Location
PLUGS USED AND DEPTH PLACED			BRIDGES		CASING AND TUBING	
CEMENT-THICKNESS	WOOD-SIZE	LEAD	CONSTRUCTION-LOCATION		RECOVERED	SIZE LOST

Drillers' Names _____

Remarks: _____

_____ DATE I hereby certify I visited the above well on this date.

DISTRICT WELL INSPECTOR
08/25/2023

c-8

STATE OF WEST VIRGINIA
DEPARTMENT OF MINES
OIL AND GAS WELLS DIVISION

RECEIVED

APR 17 1975

INSPECTOR'S PLUGGING REPORT

OIL & GAS DIVISION
DEPT. OF MINES

Permit No. Way-1216 P Well No. 2

COMPANY Delma Gas Co. ADDRESS Branchland

FARM Bernie Booth DISTRICT Butler COUNTY Wayne

Filling Material Used Clay Stone Cement

Liner Location Amount Packer Location

PLUGS USED AND DEPTH PLACED			BRIDGES	CASING AND TUBING		
CEMENT-THICKNESS	WOOD-SIZE	LEAD	CONSTRUCTION-LOCATION	RECOVERED	SIZE	LOST
	Clay stone		1390 - 1440	1360	6 5/8	26

Drillers' Names Don Falloway
Conr. Mills Drilling Co.

Remarks:
6 5/8" pipe ripped, one joint left in the hole.

4-15-75 I hereby certify I visited the above well on this date.

DATE

R.E. Butcher
DISTRICT INSPECTOR

08/25/2023

STATE OF WEST VIRGINIA
DEPARTMENT OF MINES
OIL AND GAS WELLS DIVISION

INSPECTOR'S WELL REPORT

Permit No. _____

Oil or Gas Well _____
(KIND)

	CASING AND TUBING	USED IN DRILLING	LEFT IN WELL	PACKERS
Company _____	Size			
Address _____	16			Kind of Packer _____
Farm _____	13			
Well No. _____	10			Size of _____
District _____ County _____	8 1/4			
Drilling commenced _____	6 5/8			Depth set _____
Drilling completed _____ Total depth _____	5 3/16			
Date shot _____ Depth of shot _____	3			Perf. top _____
Initial open flow _____ /10ths Water in _____ Inch	2			Perf. bottom _____
Open flow after tubing _____ /10ths Merc. in _____ Inch	Liners Used			Perf. top _____
Volume _____ Cu. Ft.				Perf. bottom _____
Rock pressure _____ lbs. _____ hrs.	CASING CEMENTED _____ SIZE _____ No. FT. _____ Date _____			
Oil _____ bbls., 1st 24 hrs.	NAME OF SERVICE COMPANY _____			
Fresh water _____ feet _____ feet	COAL WAS ENCOUNTERED AT _____ FEET _____ INCHES			
Salt water _____ feet _____ feet	_____ FEET _____ INCHES _____ FEET _____ INCHES			
	_____ FEET _____ INCHES _____ FEET _____ INCHES			

Drillers' Names _____

Remarks: _____

DATE

DISTRICT WELL INSPECTOR
08/25/2023

C-9

RECEIVED

APR 21 1975

STATE OF WEST VIRGINIA
DEPARTMENT OF MINES
OIL AND GAS WELLS DIVISION

OIL & GAS DIVISION
DEPT. OF MINES

INSPECTOR'S PLUGGING REPORT

Permit No. Way-1216P Well No. 2

COMPANY Velma Gas Co. ADDRESS Branchland, W.Va.

FARM Burnie Booth DISTRICT Butler COUNTY Wayne

Filling Material Used Clay Stone Cement

Liner Location Amount Packer Location

PLUGS USED AND DEPTH PLACED			BRIDGES	CASING AND TUBING		
CEMENT-THICKNESS	WOOD-SIZE	LEAD	CONSTRUCTION-LOCATION	RECOVERED	SIZE	LOST
1180'-1195'	Clay Stone		1195'-1366'			
690'-700'	" & "		700'-1180'			
			240'-690'			

Drillers' Names Joe A. Symate
Conts. Mills Drilling Co.

Remarks: Part of this work performed on 4-16-75,

4-17-75 I hereby certify I visited the above well on this date.
DATE

R. E. Butcher
DISTRICT INSPECTOR

08/25/2023

STATE OF WEST VIRGINIA
DEPARTMENT OF MINES
OIL AND GAS WELLS DIVISION

INSPECTOR'S WELL REPORT

Permit No. _____

Oil or Gas Well _____
(KIND)

Company _____ Address _____ Farm _____ Well No. _____ District _____ County _____ Drilling commenced _____ Drilling completed _____ Total depth _____ Date shot _____ Depth of shot _____ Initial open flow _____ /10ths Water in _____ Inch Open flow after tubing _____ /10ths Merc. in _____ Inch Volume _____ Cu. Ft. Rock pressure _____ lbs. _____ hrs. Oil _____ bbls., 1st 24 hrs. Fresh water _____ feet _____ feet Salt water _____ feet _____ feet	CASING AND TUBING	USED IN DRILLING	LEFT IN WELL	PACKERS
	Size			Kind of Packer _____
	16			
	13			Size of _____
	10			
	8 1/4			Depth set _____
	6 5/8			
	5 3/16			Perf. top _____
	3			Perf. bottom _____
	2			Perf. top _____
	Liners Used			Perf. bottom _____
	CASING CEMENTED _____ SIZE _____ No. FT. _____ Date _____			
	NAME OF SERVICE COMPANY _____			
	COAL WAS ENCOUNTERED AT _____ FEET _____ INCHES			
	_____ FEET _____ INCHES _____ FEET _____ INCHES			
	_____ FEET _____ INCHES _____ FEET _____ INCHES			

Drillers' Names _____

Remarks:

C-10

STATE OF WEST VIRGINIA
DEPARTMENT OF MINES
OIL AND GAS WELLS DIVISION

RECEIVED

APR 24 1975

OIL & GAS DIVISION
DEPT. OF MINES

INSPECTOR'S PLUGGING REPORT

Permit No. Way-1216P Well No. 2
COMPANY Helma Gas Co. ADDRESS Branchland, W. Va.
FARM Bernie Booth DISTRICT Butler COUNTY Wayne
Filling Material Used Clay Stone Cement

PLUGS USED AND DEPTH PLACED			BRIDGES	CASING AND TUBING		
CEMENT-THICKNESS	WOOD-SIZE	LEAD	CONSTRUCTION-LOCATION	RECOVERED	SIZE	LOST
210" - 220"	Clay & stone		220" - 240"			
115" - 170"	Clay & stone		170" - 210"			
35" - 45"	Clay & stone		45" - 115"			
0" - 10"	Clay & stone		10" - 35"			

Drillers' Names Joe Shumate
Centr. Clifford Mills
Remarks:

Part of this work performed on 4-21-75, biggest part.

4-22-75 I hereby certify I visited the above well on this date.
DATE

K.E. Butcher
DISTRICT WELLS INSPECTOR

08/25/2023

STATE OF WEST VIRGINIA
DEPARTMENT OF MINES
OIL AND GAS WELLS DIVISION

INSPECTOR'S WELL REPORT

Permit No. _____

Oil or Gas Well _____
(KIND)

	CASING AND TUBING	USED IN DRILLING	LEFT IN WELL	PACKERS
Company _____	Size			
Address _____	16			Kind of Packer _____
Farm _____	13			
Well No. _____	10			Size of _____
District _____ County _____	8 1/4			
Drilling commenced _____	6 5/8			Depth set _____
Drilling completed _____ Total depth _____	5 3/16			
Date shot _____ Depth of shot _____	3			Perf. top _____
Initial open flow _____ /10ths Water in _____ Inch	2			Perf. bottom _____
Open flow after tubing _____ /10ths Merc. in _____ Inch	Liners Used			Perf. top _____
Volume _____ Cu. Ft.				Perf. bottom _____
Rock pressure _____ lbs. _____ hrs.	CASING CEMENTED _____ SIZE _____ No. FT. _____ Date _____			
Oil _____ bbls., 1st 24 hrs.	NAME OF SERVICE COMPANY _____			
Fresh water _____ feet _____ feet	COAL WAS ENCOUNTERED AT _____ FEET _____ INCHES			
Salt water _____ feet _____ feet	_____ FEET _____ INCHES _____ FEET _____ INCHES			
	_____ FEET _____ INCHES _____ FEET _____ INCHES			

Drillers' Names _____

Remarks:

DATE

DISTRICT WELL INSPECTOR
08/25/2023

E-7
July 27, 1960

Mr. Woodrow Dingess
Velma Gas Company
Route #2 Box 197
Branchland, West Virginia

Dear Mr. Dingess:

Enclosed are Forms OG-10 for filing
two copies of the completed drilling record for Well
No. 2 on Bernie Booth Farm, Wayne County, Permit WAY-1216
as requested in your letter of July 25.

Extra forms are enclosed for possible
future use.

Very truly yours,

CRAWFORD L. WILSON
Director
DEPARTMENT OF MINES

Assistant Director
OIL AND GAS DIVISION

MG/m
enclosures
cc Mr. James W. Pack, Inspector
Oil and Gas Wells
Hamlin, West Virginia

08/25/2023

Latitude 38° 15'

Longitude 82° 25'

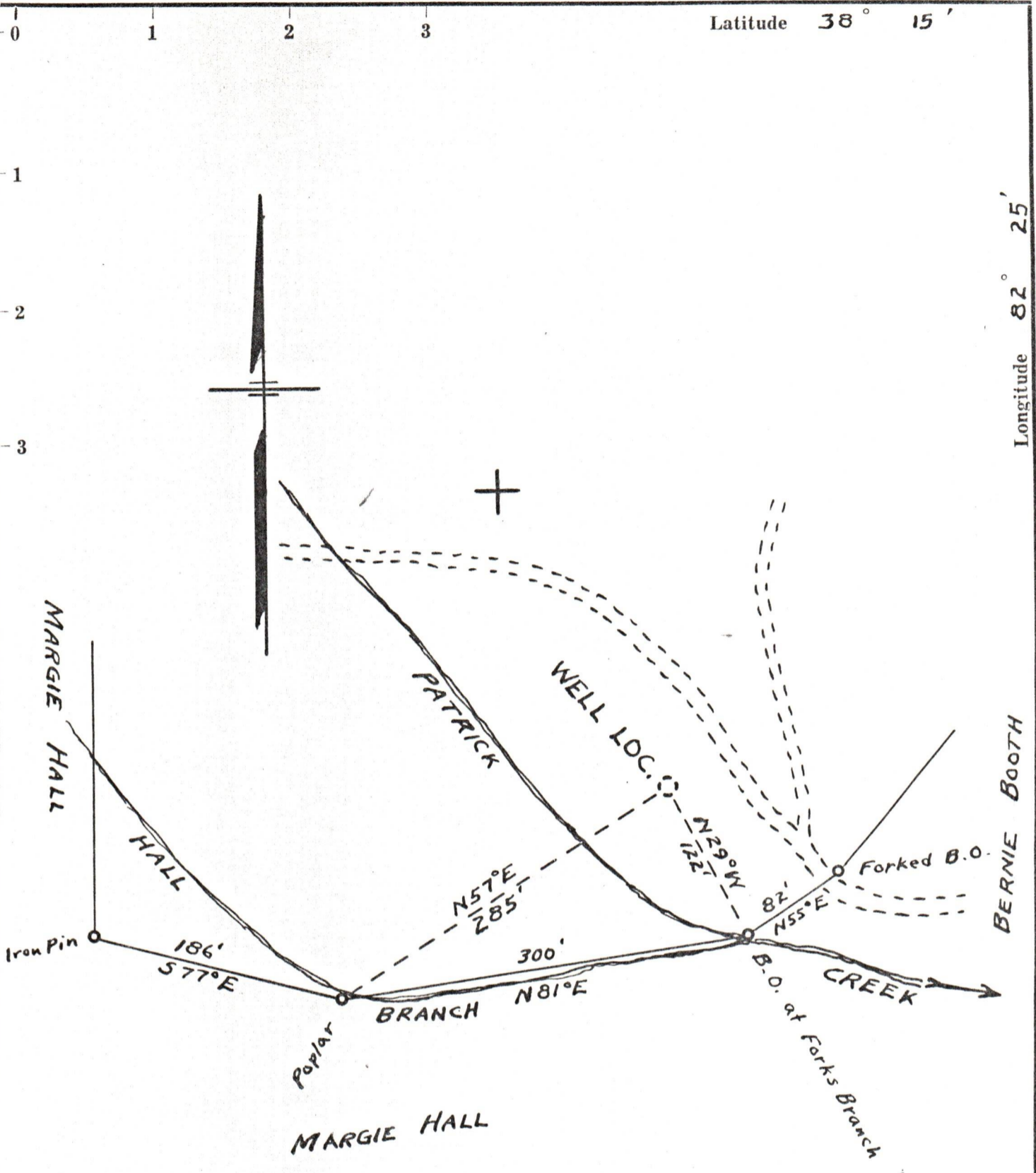

New Location
 Drill Deeper.....
 Redrill.....
 Abandonment..... issued 4-1-75

Company	VELMA GAS Co.	
Branchland Address	HARTS, W. VA. 25506	
Farm	BERNIE BOOTH	
Tract	Acres 40	Lease No.
Well (Farm) No.	2	Serial No.
Elevation (Spirit Level)	665'	
Quadrangle	WAYNE	
County	WAYNE	District BUTLER
Engineer	W. J. Galloway	
Engineer's Registration No.	3148	
File No.	79	Drawing No.
Date	7-15-59	Scale 1"=100'

STATE OF WEST VIRGINIA
 DEPARTMENT OF MINES
 OIL AND GAS DIVISION
 CHARLESTON

WELL LOCATION MAP
 FILE NO. WAY-1216-P

08/25/2023

+ Denotes location of well on United States Topographic Maps, scale 1 to 62,500, latitude and longitude lines being represented by border lines as shown.

- Denotes one inch spaces on border line of original tracing.

47-099