



STATE OF WEST VIRGINIA
DEPARTMENT OF MINES
OIL AND GAS DIVISION

NOTICE OF PROPOSED LOCATION OF OIL AND GAS WELL

To THE DEPARTMENT OF MINES,
Charleston, W. Va.

| | |
|--------------------|--|
| Lafayette Ferguson | Sweetland Land & Mineral Co. |
| Fort Gay, W. Va. | 1012 1st Hunt. Nat. Bank Bldg. Huntington, W. Va. |
| ADDRESS | COMPLETE ADDRESS |

| | |
|-----------------------------|---|
| COAL OPERATOR OR COAL OWNER | June 2nd, 1959, 19 |
| ADDRESS | PROPOSED LOCATION |
| Lafayette Ferguson | Butler District |
| OWNER OF MINERAL RIGHTS | Cabell <i>Hayne</i> County |
| Fort Gay | Well No. F-2, S-99 <i>38° 15'</i> <i>82° 30' Elw. 825'</i> |
| ADDRESS | Lafayette Ferguson Farm <i>75 acres</i> |

GENTLEMEN:

The undersigned well operator is entitled to drill upon the above named farm or tract of land for oil and gas, having fee title thereto, (or as the case may be) under grant or lease dated Jan. 21st, 1949, made by Lafayette Ferguson, to United Fuel Gas Co. (Assigned to S. L. & M. Co), and recorded on the 11th day of March, 1949, in the office of the County Clerk for said County in Book 38, page 422.

The enclosed plat was prepared by a competent engineer and shows the proposed location of a well to be drilled for oil and gas by the undersigned well operator on the farm and in the Magisterial District and County above named, determined by survey and courses and distances from two permanent points, or land marks.

The undersigned well operator is informed and believes there are no coal operators operating beds of coal beneath said farm or tract of land on which said well is located, or within 500 feet of the boundaries of the same, who have mapped their workings and filed their maps as required by law, excepting the coal operators or coal owners (if any) above named as addressees.

The above named coal operators or coal owners (if any) are notified that any objections they may desire to make to such proposed location, or which they are required to make by Section 3 of said Code, if the drilling of a well at said proposed location will cause a dangerous condition in or about their respective coal mines, must be received by, or filed with the Department of Mines within ten* days from the receipt of a copy of this notice and accompanying plat by said Department. Said coal operators are further notified that forms for use in making such objections will be furnished to them by the Department of Mines promptly on request and that all such objections must set forth as definitely as is reasonably possible the ground or grounds on which such objections are based and indicate the direction and distance the proposed location should be moved to overcome same.

(The next paragraph is to be completed only in Department's copy.)

Copies of this notice and the enclosed plat were mailed by registered mail, or delivered to the above named coal operators or coal owners at their above shown respective address _____ day _____ before, or on the same day with the mailing or delivery of this copy to the Department of Mines at Charleston, West Virginia.

Very truly yours,

Sweetland Land & Mineral Co.
WELL OPERATOR
1012 First Hunt. Nat. Bank Bldg.
STREET
Huntington, W. Va.
CITY OR TOWN
West Virginia.
STATE

Address of Well Operator }

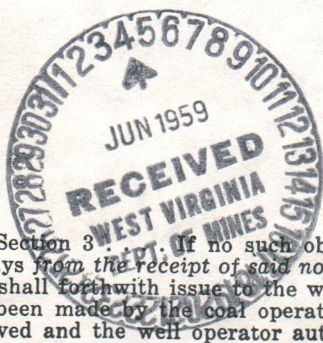

*Section 3 of no such objections be filed or be found by the department of mines, within said period of ten days from the receipt of said notice and plat by the department of mines, to said proposed location, the department shall forthwith issue to the well operator a drilling permit reciting the filing of such plat, that no objections have been made by the coal operators to the location, or found thereto by the department, and that the same is approved and the well operator authorized to proceed to drill at said location.



STATE OF WEST VIRGINIA
DEPARTMENT OF MINES
OIL AND GAS DIVISION

NOTICE OF PROPOSED LOCATION OF OIL AND GAS WELL

To the Department of Mines
Charleston, W. Va.

Proposed Location: Butler
County: Putnam
Well No: W-2, 3-99

Proposed Location: Butler
County: Putnam
Well No: W-2, 3-99

Proposed Location: Butler
County: Putnam
Well No: W-2, 3-99

Proposed Location: Butler
County: Putnam
Well No: W-2, 3-99

Proposed Location: Butler
County: Putnam
Well No: W-2, 3-99

Proposed Location: Butler
County: Putnam
Well No: W-2, 3-99

Proposed Location: Butler
County: Putnam
Well No: W-2, 3-99

Proposed Location: Butler
County: Putnam
Well No: W-2, 3-99

Proposed Location: Butler
County: Putnam
Well No: W-2, 3-99

Proposed Location: Butler
County: Putnam
Well No: W-2, 3-99

Proposed Location: Butler
County: Putnam
Well No: W-2, 3-99

Proposed Location: Butler
County: Putnam
Well No: W-2, 3-99

Proposed Location: Butler
County: Putnam
Well No: W-2, 3-99

Proposed Location: Butler
County: Putnam
Well No: W-2, 3-99

Proposed Location: Butler
County: Putnam
Well No: W-2, 3-99

Proposed Location: Butler
County: Putnam
Well No: W-2, 3-99

Proposed Location: Butler
County: Putnam
Well No: W-2, 3-99

Proposed Location: Butler
County: Putnam
Well No: W-2, 3-99

Proposed Location: Butler
County: Putnam
Well No: W-2, 3-99

Proposed Location: Butler
County: Putnam
Well No: W-2, 3-99

08/25/2023



The enclosed copy was prepared by a competent engineer and shows the proposed location of a well to be drilled for oil and gas by the undersigned well operator on the land and in the Mineral District and County above named, determined by survey and courses and distances from two permanent points on land marked.

The undersigned well operator is informed and believes there are no coal operators operating beds of coal beneath said farm or tract of land on which said well is located or within 500 feet of the boundary of the same, who have mapped their workings and filed their maps as required by law, excepting the coal operators or coal owners (if any) above named as addressees.

The above named coal operators or coal owners (if any) are notified that any objections they may desire to make to said proposed location or which they are required to make by Section 3 of said Code, if the drilling of a well at said proposed location will cause a dangerous condition in or about their respective coal mines, must be received by or filed with the Department of Mines within ten days from the receipt of a copy of this notice and accompanying plat by said Department. Said coal operators are further notified that forms for stating objections will be furnished to them by the Department of Mines promptly on request and that all such objections must set forth as definitely as is reasonably possible the ground or grounds on which such objections are based and indicate the direction and distance the proposed location should be moved to overcome same.

The next paragraph is to be completed only in Department's copy.)

Copies of this notice and the enclosed plat were mailed by registered mail, or delivered to the above named coal operators or coal owners at their above shown respective addresses _____ day _____ before or on the same day with the mailing or delivery of this copy to the Department of Mines at Charleston, West Virginia.

Very truly yours,

Sweetland Land & Mineral Co.

1013 First Hunt. Nat. Bank Bldg.

Huntington, W. Va.

West Virginia.

STATE

CITY OR TOWN

STREET

Address of Well Operator

WELL OPERATOR

PERMIT NUMBER

W-2-117

W-2-117

W-2-117

W-2-117



STATE OF WEST VIRGINIA
DEPARTMENT OF MINES
OIL AND GAS DIVISION

Louisa

WELL RECORD

Permit No. WAY-1197

Oil or Gas Well Gas
(KIND)

Company Sweetland Land And Mineral Co.
Address 1012 FHN Bank Bldg., Huntington, W. Va.
Farm Lafayette Ferguson Acres 75-3/8
Location (waters) Queens Creek
Well No. 99 F-2 Elev. 825'
District Butler County Wayne
The surface of tract is owned in fee by Lafayette Ferguson
Address RFD, Prichard, W. Va.
Mineral rights are owned by Lafayette Ferguson
Address RFD, Prichard, W. Va.
Drilling commenced July 2, 1959
Drilling completed September 5, 1959
Date Shot 8/22/59 From 2113' to 2094'
With 180# Gelatin and 2000# Hercomite B.

| Casing and Tubing | Used in Drilling | Left in Well | Packers |
|-------------------|-----------------------------|--------------------------------|---|
| Size | | | |
| 16 | | | Kind of Packer <u>Parmaco</u> |
| 18 | | | <u>Bottom Hole 16" Rub. And Spang Anchor</u> |
| 10 | <u>13'10"</u> | <u>13'10"</u> | <u>3 Step 20" Rubber</u> |
| 8 1/4 | <u>327'8"</u> | <u>327'8"</u> | Size of _____ |
| 6 5/8 | <u>1643'6"</u> | <u>1643'6"</u> | Depth set <u>Parmaco set at 1643' and Spang Anchor at 1657'</u> |
| 5 3/16 | | | Perf. top _____ |
| 3 | | | Perf. bottom _____ |
| 2 | <u>2128'</u> | <u>2128'</u> | Perf. top _____ |
| Liners Used | <u>64' of 5" perforated</u> | <u>liner in bottom of hole</u> | Perf. bottom _____ |

Open Flow 10/10ths Water in 2 Inch
/10ths Merc. in _____ Inch
Volume 133 M Cu. Ft.
Rock Pressure 460 lbs. 43 hrs.
Oil _____ bbls., 1st 24 hrs.
Fresh water _____ feet
Salt water _____ feet

| CASING CEMENTED | SIZE | No. Ft. | Date |
|-------------------------|------|---------|--------|
| COAL WAS ENCOUNTERED AT | | FEET | INCHES |
| | FEET | INCHES | FEET |
| | FEET | INCHES | FEET |

| Formation | Color | Hard or Soft | Top | Bottom | Oil, Gas or Water | Depth Found | Remarks |
|----------------|-------|--------------|------|--------|-------------------|-------------|---------|
| Clay | Red | | 0 | 8 | | | |
| Slate | | | 8 | 50 | | | |
| Sand | | | 50 | 95 | | | |
| Coal | | | 95 | 98 | | | |
| Slate | | | 98 | 114 | | | |
| Sand | | | 114 | 160 | | | |
| Slate | | | 160 | 203 | | | |
| Sand | | | 203 | 276 | | | |
| Coal | | | 276 | 280 | | | |
| Slate | | | 280 | 385 | | | |
| Sand | | | 385 | 503 | | | |
| Slate | | | 503 | 650 | | | |
| Sand | | | 650 | 710 | | | |
| Slate | | | 710 | 775 | | | |
| Sand | | | 775 | 785 | | | |
| Slate & Shells | | | 785 | 825 | | | |
| Salt Sand | | | 825 | 940 | | | |
| Slate | | | 940 | 950 | | | |
| Salt Sand | | | 950 | 1060 | | | |
| Maxon Sand | | | 1060 | 1288 | | | |
| Big Lime | | | 1288 | 1460 | | | |
| Injun | | | 1460 | 1520 | | | |
| Slate | | | 1520 | 1530 | | | |
| Shells | | | 1530 | 1608 | | | |
| Slate | | | 1608 | 1615 | | | |
| Shell | | | 1615 | 1700 | | | |
| Slate & Shells | | | 1700 | 1914 | | | |
| Packer Shell | | | 1914 | 1928 | | | |
| Slate | | | 1928 | 2032 | | | |
| Shells | | | 2032 | 2070 | | | |
| Shell | Brown | | 2070 | 2094 | | | |
| Berea Sand | | | 2094 | 2104 | | | |
| Slate | | | 2104 | 2120 | - Total Depth | | |

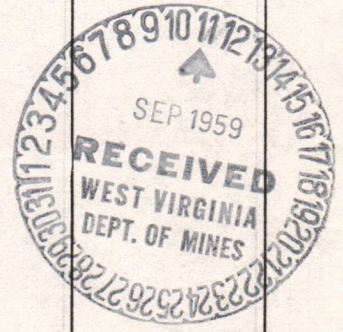

08/25/2023

STATE OF WEST VIRGINIA
DEPARTMENT OF MINES
OIL AND GAS DIVISION

INSPECTOR'S WELL REPORT

Permit No. WAY-1197

Oil or Gas Well F-2 S-99
(KIND)

| | | | | |
|---|---|---|---------------------|---|
| <p>Company <u>Sweetland Land & Min. Co.</u> <u>1012 Huntington Nat'l Bank</u> Address <u>Huntington, W. Va.</u> Farm <u>Lafayette Ferguson</u> Well No. <u>F-2 S-99</u> District <u>Butler</u> County <u>Wayne</u> Drilling commenced <u>7/2/59</u> Drilling completed <u>8/15/59</u> Total depth <u>2120'</u> Date shot <u>8/17/59</u> Depth of shot <u>2094'</u> Initial open flow <u>4</u> /10ths Water in <u>2</u> Inch Open flow after tubing <u>14</u> /10ths W.C. in <u>2</u> Inch Volume <u>158,000</u> Cu. Ft. Rock pressure <u>137#</u> lbs. <u>1</u> hrs. Oil _____ bbls., 1st 24 hrs. Fresh water <u>370</u> feet _____ feet Salt water <u>980</u> feet _____ feet</p> | <p>CASING AND TUBING</p> <p>Size</p> <p>16</p> <p>13</p> <p>10</p> <p>8 1/4</p> <p>6 3/8</p> <p>5 3/16</p> <p>3</p> <p>2</p> <p>Liners Used</p> | <p>USED IN DRILLING</p> <p>13'10"</p> <p>328'</p> <p>1643'</p> <p>2120'</p> | <p>LEFT IN WELL</p> | <p>PACKERS</p> <p>Kind of Packer <u>Anchor Packer</u></p> <p>Size of <u>2" X 7"</u></p> <p>Depth set <u>1913'</u></p> <p>Perf. top <u>2090'</u></p> <p>Perf. bottom <u>2121'</u></p> <p>Perf. top _____</p> <p>Perf. bottom _____</p> |
| <p>CASING CEMENTED _____ SIZE _____ No. FT. _____ Date _____</p> | | <p>COAL WAS ENCOUNTERED AT <u>95</u> FEET <u>36</u> INCHES</p> <p><u>276</u> FEET <u>48</u> INCHES FEET INCHES</p> <p>FEET INCHES FEET INCHES</p> | | |

Drillers' Names Clarence Mason
Oliver Parsons

Remarks: Running 2" tubing on 8-26-59; Testing 12/10 Water 2" after shot.

8-26-59

DATE

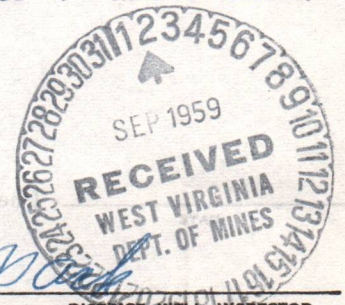

J.W. Parsons

DISTRICT WELL INSPECTOR

08/25/2023

RECEIVED
 JUN 25 1979
 DEPT. OF MINES
 GAS DIVISION

| | | | | |
|--|--|---------------------------|--|--|
| 1.0 API well number (If not available, leave blank. 14 digits.) | 47-099-1197 | | | |
| 2.0 Type of determination being sought. (Use the codes found on the front of this form.) | 108 Section of NGPA | Stripper Category Code | | |
| 3.0 Depth of the deepest completion location. (Only needed if sections 103 or 107 in 2.0 above.) | _____ feet | | | |
| 4.0 Name, address and code number of applicant. (36 letters per line maximum. If code number not available, leave blank.) | Sweetland Land And Mineral Co. Name 1012 First Huntington Bldg. Street Huntington, W. Va. 25701 City State Zip Code | | | Seller Code |
| 5.0 Location of this well. (Complete (a) or (b).) (a) For onshore wells (36 letters maximum for field name.) | BUTLER Field Name WAYNE County W. Va. State | | | State |
| (b) For OCS wells | Area Name _____ Block Number _____ Date of Lease: _____ Mo. Day Yr. OCS Lease Number _____ | | | |
| (c) Name and identification number of this well. (36 letters and digits maximum.) | LAFAYETTE FERGUSON #2. SPA 6200 | | | |
| (d) If code 4 or 6 in 2.0 above, name of the reservoir. (36 letters maximum.) | _____ | | | |
| 6.0 (a) Name and code number of the purchaser. (36 letters and digits maximum. If code number not available, leave blank.) | Columbia Gas Transmission Corp. Name | | | 4030 Buyer Code |
| (b) Date of the contract. | _____ Mo. Day Yr. | | | |
| (c) Estimated annual production | 9.5 MMcf. | | | |
| 7.0 Contract price. (As of filing date. Complete to 3 decimal places.) | (a) Base Price (\$/MMBTU) 2.352 | (b) Tax _____ | (c) All Other Prices [Indicate (+) or (-).] _____ | (d) Total of (a), (b) and (c) _____ |
| 8.0 Maximum lawful rate (As of filing date. Complete to 3 decimal places.) | 2.352 | _____ | _____ | 2.352 |
| 9.0 Person responsible for the application | E. B. Curry Operator Name Title _____ Signature (6/22/79) (304) 523-0682 Date Application is Completed Phone Number | | | |
| Agency Use Only Date Received by Juris. Agency JUN 25 1979 Date Received by FERC | | | | |

08/25/2023

WELL DETERMINATION REPORT

PARTICIPANTS:

DATE:

FEB 1 1980

BUYER-SELLER CODE

WELL OPERATOR: Sweetland Land & Mineral Co

018381

FIRST PURCHASER: Columbia Gas Transmission Corp

004030

OTHER:

Quantities to 108, string and

Permit

W. Va. Department of Mines, Oil & Gas Division

WELL DETERMINATION FILE NUMBER

790625-108-099-119

Use Above File Number on all Communications Relating to Determination of this Well

CHECK EACH ITEM AS COMPLETE OR NOTE WHAT IS MISSING

ITEM NO.

- 1 FERC-121 Items not completed - Line No. _____
- 2 IV-1 - Agent E. B. Curry
- 3 IV-2 - Well Permit _____
- 4 IV-6 - Well Plat
- 5 IV-35- Well Record Drilling Deepening _____
- 6 IV-36- Gas-Oil Test: Gas Only _____ Was Oil Produced? _____ Ratio _____
- 7 IV-39- Annual Production 1,93 years
- 8 IV-40- 90 day Production 90 Days off Line: _____
- 9 IV-48- Application for Certification. Complete?
- 10 - 17 IV Form #51 - 52 - 53 - 54 - 55 - 56 - 57 - 58. Complete Affidavit Signed
- 18 - 28 Other: Survey _____ Logs _____ Geological Charts _____ Structure Map _____

1:4000 Map _____ Well Tabulations _____ Gas Analyses _____

(5) Date Completed: 6-2-59 8-22-59 Deepened _____

(5) Production Depth: 2094 - 2113

(5) Production Formation: Berea, Slate

(5) Initial Potential: 133 MCF

(5) Static R.P. Initially: 460 #

(6) Other Gas Test: _____

(7) Avg. Daily Gas from Annual Production: 2964.2 / 365 = 8.1 MCF; No Oil

(8) Avg. Daily Gas from 90-day ending w/1-120 days 789 / 90 = 8.7 MCF; No Oil

(8) Line Pressure: 50 # PSIG from Daily Report

(5) Oil Production: - From Completion Report -

(10-17) Does lease inventory indicate enhanced recovery being done: No 08/25/2023

(10-17) Is affidavit signed? Yes Notarized? Yes

Does official well record with the Department confirm the submitted information? Yes

Additional Information _____ Does computer program confirm? _____

Was Determination Objected to? _____ By Whom? _____

DM

STATE OF WEST VIRGINIA
DEPARTMENT OF MINES, OIL AND GAS DIVISION

Date 6/25 1979
Operator's Well No. Layette Ferguson #2
API Well No. 0
State 099 County Wayne Permit 1197

WELL CLASSIFICATION FORM

STRIPPER GAS WELL

NGPA Section 108

DESIGNATED AGENT E. B. Curry

ADDRESS Same

WELL OPERATOR Sweetland Land And Mineral Co

ADDRESS 1012 First Huntington Bldg.

Huntington, W. Va. 25701

GAS PURCHASER Columbia Gas Trans. Corp.

ADDRESS P. O. Box 1273

Charleston, W. Va. 25325

LOCATION. Elevation _____

Watershed Fork Creek

Dist. Buttly County Wayne Quad. _____

Gas Purchase Contract No. 6200

Meter Chart Code 804209

Date of Contract _____

* * * * *
Provide a complete inventory of the lease and production equipment used for the well for the previous 24 months or, if less than 24 months, the period the well has been in production. Include a complete list of equipment or processes used in connection with recognized enhanced recovery techniques during completion or production. (Attach separate sheets, if necessary.)

Wellhead, valves, switches.

List all records reasonably available to you which contain information relevant to a determination of eligibility (including production records, MO Tax Records and royalty payment records) and indicate the location of such records:

Drilling, production, tax, and royalty payments, all in applicant's office.

08/25/2023

Describe the search made of any records listed above

Diligent search of all available records was made.

Are you aware of any other information which would tend to be inconsistent with the information specified above? Yes ___ No X. If yes, indicate the type and source of the information

AFFIDAVIT

I, E. B. Curry, having been first sworn according to law, state that I have caused to be made a diligent search of those records heretofore indicated in the writing herein described, that the information contained in this document is true and accurate and that on the basis of the records and examinations heretofore described, and to the best of my information, knowledge and belief, the well for which this certification is sought qualifies as a strippey well.

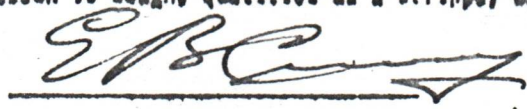

State of West Virginia
County of Jackson, to-wit:

I, Deborah L. Clendenin, a Notary Public in and for the state and county aforesaid, do certify that E. B. CURRY, whose name is signed to the writing above, bearing date the 31st day of May, 1979, has acknowledged the same before me, in my county aforesaid. Given under my hand this the 31st day of May, 1979. My Commission expires: April 7, 1985

Deborah L. Clendenin
Notary Public

08/25/2023

COLUMBIA GAS TRANSMISSION CORP.
GAS MEASUREMENT DETAIL STATEMENT

SWEETLAND LAND AND MINERAL CO

3

ACCOUNT NAME _____

RATE NUMBER .66850

AGREEMENT NUMBER 006200

ACCOUNT NUMBER 20 4767

BILLING MO APRIL 1979

| STATION NUMBER | PERIOD | | | | ORIFICE PLATE AND TUBE SIZE | FLOW CONDITIONS | | | | DISPLACEMENT METER REMOVAL INDEX READINGS | INTEGRATION OR DISPLACEMENT METER REGISTRATION | MCF |
|-------------------------|-----------|-------|--------|------|-----------------------------|---------------------|------------------|---|----------|---|--|--------|
| | BEGINNING | | ENDING | | | FLOWING TEMPERATURE | SPECIFIC GRAVITY | AVERAGE HOURLY $\sqrt{\frac{h_w P}{d^5}}$ | PRESSURE | | | |
| | MO | DATE | MO | DATE | | | | | | | | |
| 804076-1-1 | 00-00 | 03-09 | | | | | | | | | | |
| 804076-1-1 | 03-09 | 04-09 | .250 | 2 | 60 | 787 | 13.2 | 43.0 | | 451 | | 143 |
| | | | | | | | | | | METER TOTAL | | 143 |
| | | | | | | | | | | 1,000000 | | 143 |
| | | | | | | | | | | RATE | AMOUNT | |
| | | | | | | | | | | 0.66850 | 95.60 | |
| 804204-1-1 | 00-00 | 03-09 | | | | | | | | | | |
| 804204-1-1 | 03-09 | 04-09 | .375 | 2 | 60 | 676 | 15.8 | 62.0 | | 537 | | 41 |
| | | | | | | | | | | METER TOTAL | | 41 |
| | | | | | | | | | | 1,000000 | | 41 |
| | | | | | | | | | | RATE | AMOUNT | |
| | | | | | | | | | | 0.66850 | 274.7 | |
| | | | | | | | | | | TOTAL MCF | | 554 |
| | | | | | | | | | | TOTAL PURCHASED MCF | | 554 |
| | | | | | | | | | | TOTAL PURCHASED AMOUNT | | 370.35 |
| | | | | | | | | | | SUMMARIZATION OF LOCAL GAS PURCHASE | | |
| | | | | | | | | | | PAYEE NAME | INTEREST | AMOUNT |
| SOC. SEC. NO. OR ID NO. | | | | | | | | | | SWEETLAND LAND AND MINERAL CO | 1.000000 | 370.3 |
| 550-28-9725 | | | | | | | | | | TOTAL | 1.000000 | 370.3 |

2 wells on meter
 YEARLY = $\frac{5929}{2} = 2964.2$
 PRO. = $\frac{2964.2}{365} = 8.1 \text{ MCF}$

JUNE 1978 - April 1979

90-Day = $\frac{1578}{2} = 789$
 $\frac{789}{90} = 8.7 \text{ MCF}$

08/25/2023

Latitude 38° 15'

Longitude 82° 30'

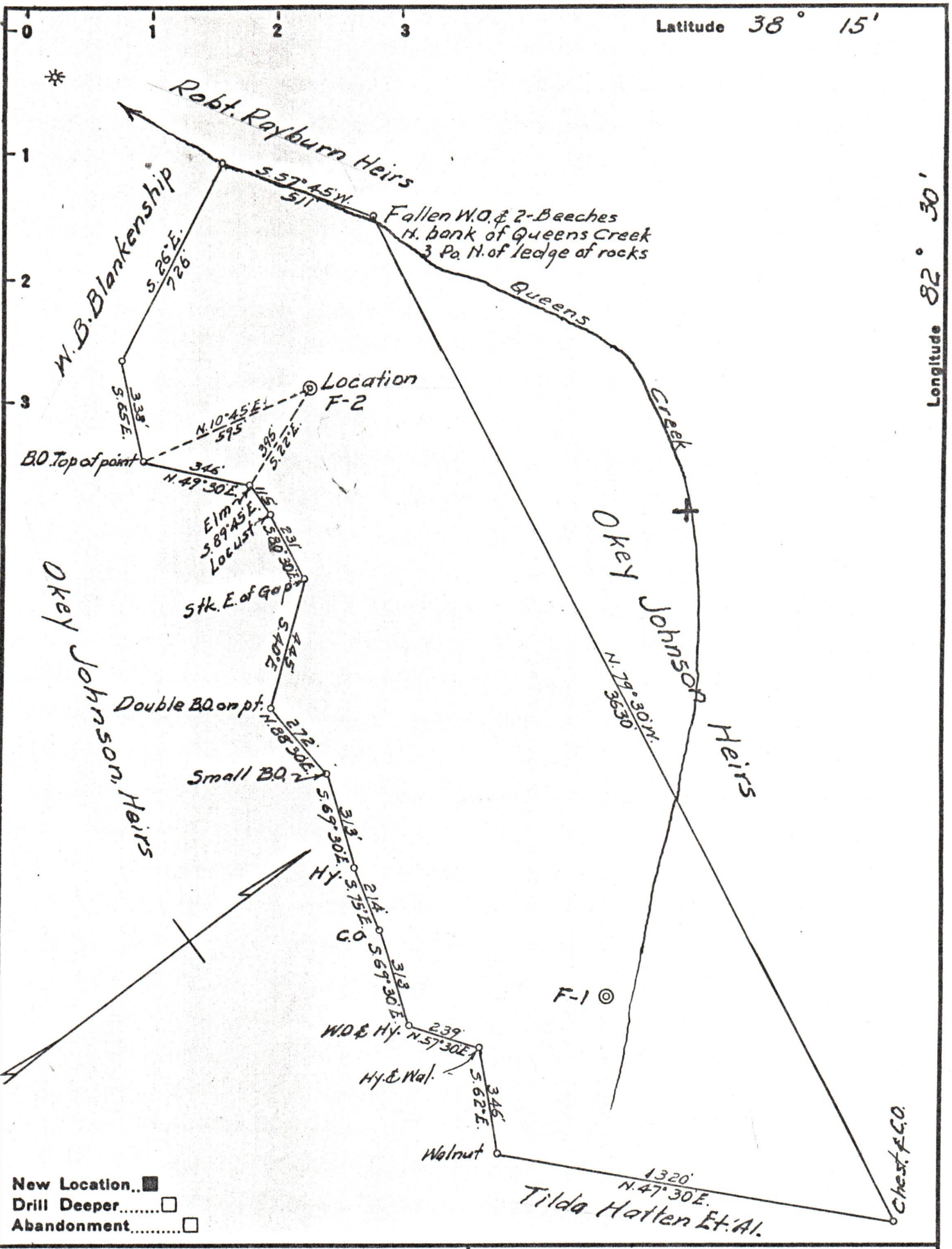

New Location..
 Drill Deeper.....
 Abandonment.....

Company SWEETLANDLAND & MINERAL CO.
 Address HUNTINGTON, W. VA.
 Farm LAFAYETTE FERGUSON
 Tract _____ Acres 75 1/2 Lease No. _____
 Well (Farm) No. 2 Serial No. 99
 Elevation (Spirit Level) 825
 Quadrangle LOUISA
 County WAYNE District BUTLER
 Engineer G. B. Ewing
 Engineer's Registration No. 309
 File No. _____ Drawing No. _____
 Date May 29th 1959 Scale 1" = 400'

STATE OF WEST VIRGINIA
 DEPARTMENT OF MINES
 OIL AND GAS DIVISION
 CHARLESTON

WELL LOCATION MAP
 FILE NO. WAY-1197 08/25/2023

+ Denotes location of well on United States Topographic Maps, scale 1 to 62,500, latitude and longitude lines being represented by border lines as shown.

- Denotes one inch spaces on border line of original tracing.