



STATE OF WEST VIRGINIA
DEPARTMENT OF MINES
OIL AND GAS DIVISION

NOTICE OF PROPOSED LOCATION OF OIL AND GAS WELL

To THE DEPARTMENT OF MINES,
Charleston, W. Va.

Max E. Lester et als
COAL OPERATOR OR COAL OWNER

604 - 5th Avenue, Huntington, W. Va.
ADDRESS

COAL OPERATOR OR COAL OWNER

ADDRESS

Same

OWNER OF MINERAL RIGHTS

ADDRESS

OWENS, LIBBEY-OWENS GAS DEPARTMENT
NAME OF WELL OPERATOR

P. O. Box 4158, Charleston 4, W. Va.
COMPLETE ADDRESS

October 31, 19 58

PROPOSED LOCATION

Butler District

Wayne County

Well No. 3 (Serial No. 1052) *Lat. 38° 15' Lon. 82° 30' Elev. 883.96*

Max E. Lester et als Farm

83 acres

GENTLEMEN:

The undersigned well operator is entitled to drill upon the above named farm or tract of land for oil and gas, ~~having fee title thereto, (or as the case may be)~~ under grant or lease dated 17th March, 1952, made by Max E. Lester et als, to Owens-Illinois Glass Co. & Libbey-Owens-Ford Glass Co., and recorded on the 22nd day of August, 1952, in the office of the County Clerk for said County in Book 43, page 54.

The enclosed plat was prepared by a competent engineer and shows the proposed location of a well to be drilled for oil and gas by the undersigned well operator on the farm and in the Magisterial District and County above named, determined by survey and courses and distances from two permanent points, or land marks.

The undersigned well operator is informed and believes there are no coal operators operating beds of coal beneath said farm or tract of land on which said well is located, or within 500 feet of the boundaries of the same, who have mapped their workings and filed their maps as required by law, excepting the coal operators or coal owners (if any) above named as addressees.

The above named coal operators or coal owners (if any) are notified that any objections they may desire to make to such proposed location, or which they are required to make by Section 3 of said Code, if the drilling of a well at said proposed location will cause a dangerous condition in or about their respective coal mines, must be received by, or filed with the Department of Mines within ten* days from the receipt of a copy of this notice and accompanying plat by said Department. Said coal operators are further notified that forms for use in making such objections will be furnished to them by the Department of Mines promptly on request and that all such objections must set forth as definitely as is reasonably possible the ground or grounds on which such objections are based and indicate the direction and distance the proposed location should be moved to overcome same.

(The next paragraph is to be completed only in Department's copy.)

Copies of this notice and the enclosed plat were mailed by registered mail, or delivered to the above named coal operators or coal owners at their above shown respective address day--before, or on the same day with the mailing or delivery of this copy to the Department of Mines at Charleston, West Virginia.

Very truly yours,

OWENS, LIBBEY-OWENS GAS DEPARTMENT

P. O. Box 4158
WELL OPERATOR

Charleston,
STREET

West Virginia
CITY OR TOWN

STATE

08/18/2023

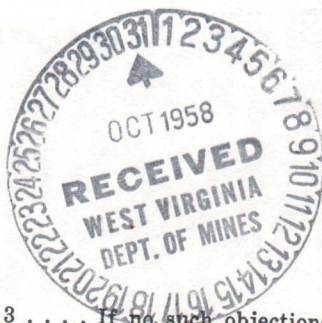

Address of Well Operator }

*Section 3 If no such objections be filed or be found by the department of mines, within said period of ten days from the receipt of said notice and plat by the department of mines, to said proposed location, the department shall forthwith issue to the well operator a drilling permit reciting the filing of such plat, that no objections have been made by the coal operators to the location, or found thereto by the department, and that the same is approved and the well operator authorized to proceed to drill at said location.

1140

WAY-1140

PERMIT NUMBER



STATE OF WEST VIRGINIA
DEPARTMENT OF MINES
OIL AND GAS DIVISION

NOTICE OF PROPOSED LOCATION OF OIL AND GAS WELL

To The Department of Mines
Charleston, W. Va.

OWENS, LINDSEY-OWENS GAS TREATMENT

Mr. E. Lester of Oil

NAME OF WELL OPERATOR

NAME OF COAL OWNER

P. O. Box 1155, Charleston, W. Va.

COMPLETE ADDRESS

ADDRESS

October 21, 1952

PROPOSED LOCATION

NAME OF COAL OWNER

County
District

COUNTY

Site

Water

OWNER OF MINERAL RIGHTS

Well No. 2 (Serial No. 1052) (See 22030, 22031, 22032)

Mr. E. Lester of Oil

ADDRESS

The undersigned well operator is entitled to drill upon the above named farm or tract of land for

oil and gas (under appropriate) under grant or lease dated 1952

to Mr. E. Lester of Oil made by the undersigned well operator and recorded on the day

in the office of the County Clerk for said County in

Book 43 page 25

The enclosed plat was prepared by a competent engineer and shows the proposed location of a well

to be drilled for oil and gas by the undersigned well operator on the farm and in the Magisterial District

and County above named, determined by survey and courses and distances from two permanent points or

land marks.

The undersigned well operator is informed and believes there are no coal operators operating here

of coal beneath said farm or tract of land on which said well is located, or within 500 feet of the bound-

aries of the same who have mapped their workings and filed their maps as required by law, excepting the

coal operators or coal owners (if any) above named as abovesaid.

The above named coal operators or coal owners (if any) are notified that any objections they may

desire to make to such proposed location of which they are required to make by Section 8 of said Code, if

the filing of a well or proposed location will cause a dangerous condition in or about their respective

coal mines, must be received by or filed with the Department of Mines within ten days from the receipt of

a copy of this notice and accompanying plat by said Department. Said coal operators are further notified

that failure to file such objections will be deemed to be a consent by the Department of Mines promptly

on request and that all such objections must set forth as definitely as is reasonably possible the ground or

grounds on which such objections are based and indicate the question and distance the proposed location should

be moved to obviate same.

(The next paragraph is to be completed only in Department's copy.)

Copies of this notice and the enclosed plat were mailed by registered mail, or delivered to the above

named coal operators or coal owners at their above shown respective addresses

on the same day with the mailing or delivery of this copy to the Department of Mines at Charleston,

West Virginia.

Very truly yours,

OWENS, LINDSEY-OWENS GAS TREATMENT

WELL OPERATOR

P. O. Box 1155

STREET

Charleston

Address

of Well Operator

CITY OR TOWN

West Virginia

STATE

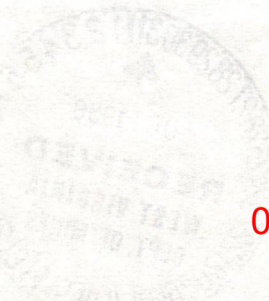

08/18/2023

Section 8. If any objections be filed or be found by the department of mines within said period of ten days from the receipt of said notice and plat by the department of mines to said proposed location, the department shall forthwith cause the well operator a drilling permit vesting the thing of such plat, that no objections have been made by the coal operator, to the location of land thereon by the department, and that the same is approved and the well operator authorized to proceed to drill at said location.

WAY-1110

PERMIT NUMBER

B-2

Formation	Color	Hard or Soft	Top /o	Bottom	Oil, Gas or Water	Depth Found	Remarks
Sand	Light	Soft	1137	1173			
Slate	White	Soft	1173	1176			
Sand	Light	Soft	1176	1180			
Slate	Dark	Soft	1180	1200			
Sand	Light	Hard	1200	1225	SIM 1225		
Sand	Light	Med.	1225	1259			
Sand	Light	Hard	1259	1269			
Little Lime	--	Hard	1269	1289			
Break	Light	Soft	1289	1291			
Big Lime *	White	Hard	1291	1457			
Grey Injun	Grey	Hard	1457	1477	Water level 290' at 1477'		
					SIM 1477		
Grey Injun	Grey	Hard	1477	1545			
Grey Injun	Grey	Med.	1545	1612			
Grey Injun	Grey	Hard	1612	1630			
Sand, Bro.	Dark	Med.	1630	1636			
Sand, Bro.	Grey	Hard	1636	1645			
Shells	Dark	Hard	1645	1649	SIM 1649 = Sand IM 1650		
					12-5-58		
					Ran 7" casing at 1648'9" on shoe		
Shells	Dark	Hard	1649	1657	12-6-58		Test in 39 hours casing dry
Shells	Dark	Hard	1657	1662			
Slate	Dark	Soft	1662	1689			
Sl. & Shls.	Dark	Soft	1689	1755			
Slate	Dark	Soft	1755	1816			
Sl. & Shls.	Dark	Soft	1816	1878			
Slate	Light	Soft	1878	1920			
Shells	Dark	Hard	1920	1929			
Slate	Dark	Soft	1929	1935	SIM 1935 = Sand IM 1929		
Sl. & Shls.	Dark	Soft	1935	1983			
Shells	Dark	Med.	1983	1988			
Slate	Dark	Soft	1988	2022			
Packer Shls.	Dark	Hard	2022	2033	SIM 2035 = Sand IM 2035		
Sl. & Shls.	Dark	Hard	2033	2051			
Coffee Shale	Brown	Soft	2051	2080			
Berea	White	Hard	2080	2087	Gas 2083 14/10 W 5/8 = 11.4 M		
Sand	White	Hard	2087	2103	Gas 2087 39.9		
					Test 2090 20/10 W 1 = 35		
Slate	White	Soft	2103	2108	Test 2103 27.1		
					Test 2108 24.7		
					Shut in at 4:40 P.M. 12-12-58		
					12-16-58		
					Shot Beria with 200# Detonite from		
					2080 to 2097 at 3:55 P.M. Tamped		
					with 20' pea gravel. Time bomb		
					set for 2 hours. Test in 4 hours		
					10/10 W 1 = 24.7 M		
					12-17-58 Tamp drilled out at 1:30 P.M.		
					Tests while cleaning out:		
					38 Hrs. 61 M		
					12-19-58 Shot Beria with 1000# Det.		
					from 2080 to 2097 at 12:36 P.M.		
					Tamped with 35' pea gravel. T.B.		
					set for 2 hours. Test BS 47 hrs.		
					61 M Hole caved above tools. Cleaned		
					out above tools to fish them out.		
					12-28, 29, 30, 31, 1-1 Fishing		
					1-22-59 7 A.M. 14/10 W 1 1/2 = 66 M		
					Ran 3 1/2" tubing at 2111' with "Oilwell"		
					Comb. Wall & Anchor packer.		
					Final open flow: Beria 17/10 W 1 1/2 =		
					73 MCF		

08/18/2023

Date April 23, 19 59
 APPROVED Owens, Libbey-Owens, Gas Department, Owner
 By A. H. Smith (Title) Geologist



STATE OF WEST VIRGINIA
DEPARTMENT OF MINES
OIL AND GAS DIVISION /0

Quadrangle **Wayne**
Permit No. **Way-1140**
2021/8/18

WELL RECORD

Oil or Gas Well **Gas**
(KIND)

Company **OWENS, LIBREY-OWENS GAS DEPARTMENT**

Address **F. O. Box 4168, Charleston 4, W. Va.**

Farm **Max Lester**

Location (waters) **83 Acres**

Well No. **3 (Serial No. 1052)**

Elev. **883.96**

District **Butler**

County **Wayne**

The surface of tract is owned in fee by **Max Lester**

Address **Huntington, W. Va.**

Mineral rights are owned by **Max Lester**

Address **604 - 5th Avenue,**

Drilling commenced **11-11-58**

Drilling completed **12-12-58**

Date Shot **From** **To**

Open Flow **10ths Water in** **Inch**

Volume **73 MCF in Berea** **Cu. Ft.**

Rock Pressure **470#** **lbs.** **7 days** **hrs.**

Oil **1st 24 hrs.**

WELL ACIDIZED

WELL FRACTURED

RESULT AFTER TREATMENT

ROCK PRESSURE AFTER TREATMENT

Fresh Water **350** **Feet**

Salt Water **350** **Feet**

Casing and Tubing	Used in Drilling	Left in Well	Packers
Size 8-5/8"	Size 402'6"	Kind of Packer "O11we11" Comb.	
7"	1648'9"	Size of W & A	
3 3/4"	2113'	3 3/4 x 7 x 16	
	5 3/16	Depth set 2026 - 2032	
	3	Perf. top .22'	
	2	Perf. bottom 2089'	
		Perf. top 2111	
		Perf. bottom	

CASING CEMENTED	SIZE	No. Ft.	Date
COAL WAS ENCOUNTERED AT	185	FEET 36	INCHES
	48	FEET 48	INCHES
		FEET 367	INCHES
Water at 350, 3 BPH		367	300
		300	245
		245	230
		230	188
		188	185
		185	160
		160	81
		81	15

Formation	Color	Hard or Soft	Top	Bottom	Oil, Gas or Water	Depth	Remarks
Surface	Light	Soft	0	15			
Sand	Light	Soft	15	81			
Sand	Dark	Soft	81	160			
Sand	Light	Soft	160	185			
Coal	Black	Soft	185	188			
Sand	Light	Soft	188	230			
Slate	Dark	Soft	230	245			
Sand, Bro.	Light	Soft	245	300			
Sand	Light	Soft	300	367			
Coal	Black	Soft	367	371			
Sand	Light	Soft	371	402 2/3			
Sand	Light	Soft	402	432			
Shale	Dark	Soft	432	458			
Sand, Bro.	Light	Soft	458	480			
Slate	Dark	Soft	480	534			
Sand	Light	Soft	534	565			
Slate	Dark	Soft	565	625			
Sand	-	-	625	660			
Slate	-	-	660	765			
Sand, Bro.	Light	Soft	765	795			
Slate	Dark	Soft	795	823			
Sand	Dark	Soft	823	835			
Slate	Dark	Soft	835	844			
Salt Sand	Light	Med.	844	923			
Slate	Dark	Soft	923	935			
Sand	Light	Med.	935	971			
Sand	White	Soft	971	1132			
Slate	Dark	Soft	1132	1137			



Water at 350, 3 BPH
Ran 8-5/8" casing at 402'6"
on shoe

B-3

STATE OF WEST VIRGINIA
DEPARTMENT OF MINES
OIL AND GAS DIVISION

INSPECTOR'S WELL REPORT

Permit No. WAY-1140

Oil or Gas Well _____
(KIND)

Company Owens Libby Owens Gas Dept.
P.O. Box 1458

Address Charleston, W. Va.

Farm M. E. Lester

Well No. 3 Sr 1052

District Bulter County Wayne

Drilling commenced 11-11-58

Drilling completed _____ Total depth _____

Date shot _____ Depth of shot _____

Initial open flow _____ /10ths Water in _____ Inch

Open flow after tubing _____ /10ths Merc. in _____ Inch

Volume _____ Cu. Ft.

Rock pressure _____ lbs. _____ hrs.

Oil _____ bbls., 1st 24 hrs.

Fresh water _____ feet _____ feet

Salt water _____ feet _____ feet

CASING AND TUBING	USED IN DRILLING	LEFT IN WELL	PACKERS
Size			Kind of Packer _____
16			Size of _____
13			Depth set _____
10	12'-	wood	Perf. top _____
8 1/4			Perf. bottom _____
6 5/8			Perf. top _____
5 3/16			Perf. bottom _____
3			
2			
Liners Used			

CASING CEMENTED _____ SIZE _____ No. FT. _____ Date _____

COAL WAS ENCOUNTERED AT _____ FEET _____ INCHES

_____ FEET _____ INCHES FEET _____ INCHES

_____ FEET _____ INCHES FEET _____ INCHES

Drillers' Names John Chadwick

Guss Hall

Remarks: Visited well #3 and found to be drilling at 218'.

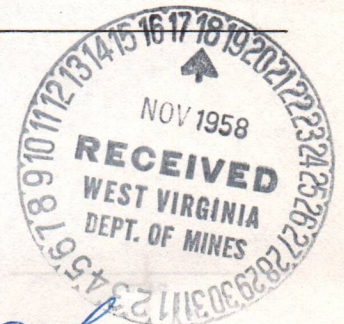

Jw. pack

11-13-58

DATE

DISTRICT WELL INSPECTOR

08/18/2023

A-10

OWENS, LIBBEY-OWENS GAS DEPARTMENT

5793 MACCORKLE AVENUE

P. O. BOX 4158

CHARLESTON 4, WEST VIRGINIA



October 31, 1958

W. Va. Department of Mines
Oil & Gas Division
Charleston, West Virginia

Gentlemen:

We are submitting an application for a permit to drill Well No. 3 on our Max Lester et als tract situated in Wayne County, Butler District, West Virginia. Attached to the application is a plat showing the proposed location of said well.

Very truly yours,

OWENS, LIBBEY-OWENS GAS DEPARTMENT

By T. S. Flournoy
T. S. Flournoy, Chief Engineer

TSF/ed
Enclosures

cc: Max E. Lester
604 Fifth Ave.
Huntington, W. Va.

Izzie Caniff
Box 721
Russell, Ky.

Garnet Lester
1258 Prairie Ave.
Des Plaines, Ill.

Muss Lester
Ft. Gay, W. Va.

Ruth Chadwick
Wayne, W. Va.



08/18/2023

OWENS LIBBY-OWENS GAS DEPARTMENT

5703 MACCORKLE AVENUE
P.O. BOX 1122
CHARLESTON 4, WEST VIRGINIA



October 31, 1953

W. W. Department of Mines
O. I. Division
Charleston, West Virginia

Dear Sir:

The new equipment, an application for a permit to
install will be on our list of the units attached
in the County, West Virginia, West Virginia, West Virginia
of the application as a list showing the proposed location
of the units.

Very truly yours,

OWENS LIBBY-OWENS GAS DEPARTMENT

T. A. Liberty, Chief Engineer

Very truly yours,
T. A. Liberty

W. W. Department of Mines
O. I. Division
Charleston, West Virginia

W. W. Department of Mines
O. I. Division
Charleston, West Virginia

W. W. Department of Mines
O. I. Division
Charleston, West Virginia

W. W. Department of Mines
O. I. Division
Charleston, West Virginia

W. W. Department of Mines
O. I. Division
Charleston, West Virginia

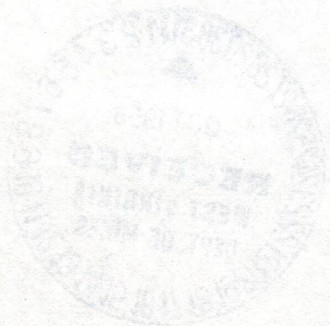

A-11

October 31, 1958

Mr. James W. Pack, Inspector
Oil and Gas Wells
Hamlin, West Virginia

Dear Mr. Pack:

We are in receipt of application for permit to
drill Well No. 3 - SR-1052 on Max E. Lester et als Tract,
Butler District, Wayne County from Owens, Libby-Owens Gas
Department. Permit number will be WAY-1140.

Very truly yours,

Crawford L. Wilson, Director
WEST VIRGINIA DEPARTMENT OF MINES

BY: _____

Assistant Director
OIL AND GAS DIVISION

MG/dm

08/18/2023

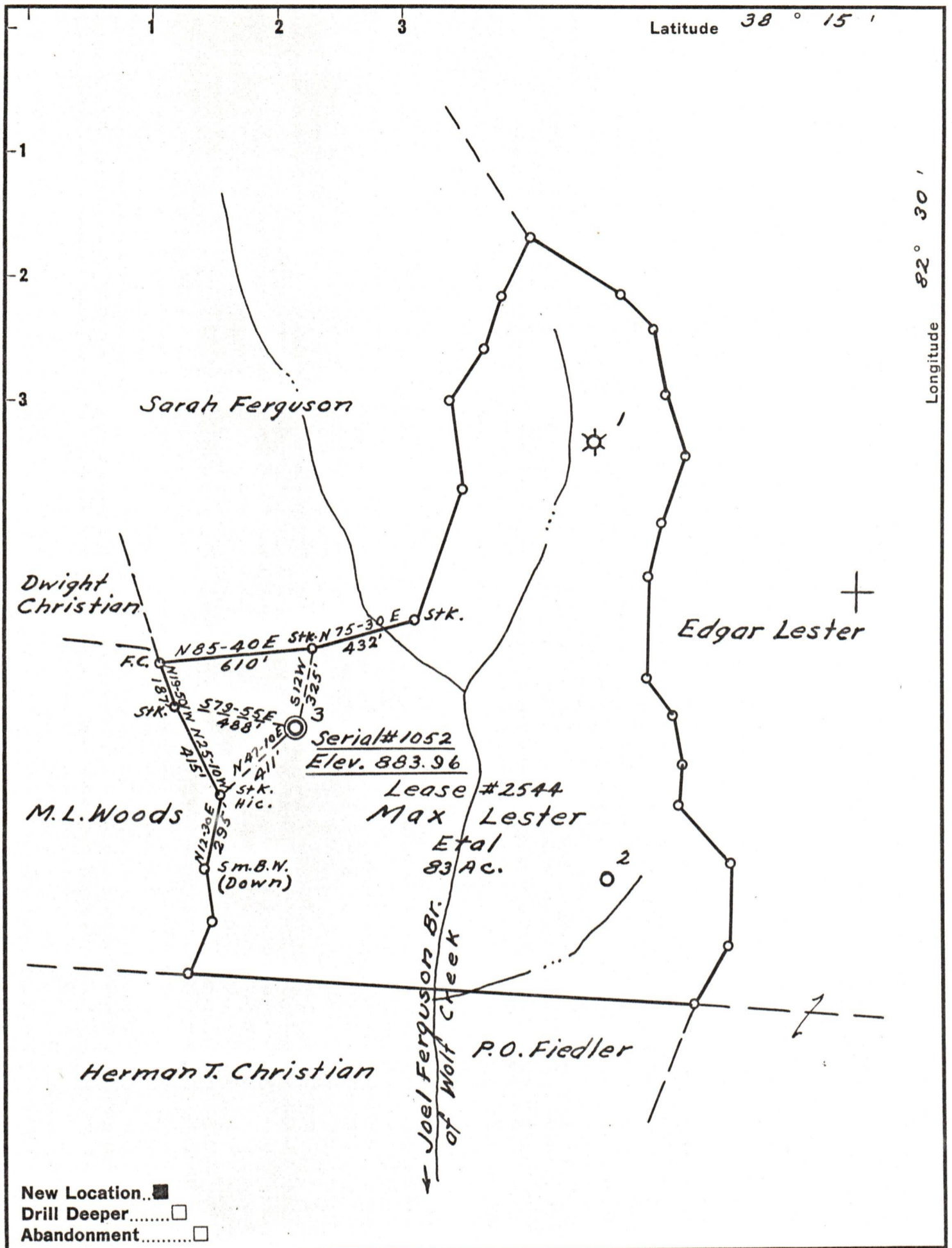

New Location..
 Drill Deeper.....
 Abandonment.....

Company Owens, Libbey-Owens Gas Dept.
 Address Box 4158 Charleston 4 W. Va.
 Farm Max Lester Etal
 Tract _____ Acres 83 Lease No. 2544
 Well (Farm) No. 3 Serial No. 1052
 Elevation (Spirit Level) 883.96
 Quadrangle Louisa 1 S 4.65" W 0.67"
 County Wayne District Butler
 Engineer T.S. Flournoy
 Engineer's Registration No. 269
 File No. _____ Drawing No. _____
 Date Sept. 19, 1958 Scale 1" = 500 Ft.

STATE OF WEST VIRGINIA
 DEPARTMENT OF MINES
 OIL AND GAS DIVISION
 CHARLESTON

WELL LOCATION MAP

FILE NO. WAY-1140

08/18/2023

+ Denotes location of well on United States Topographic Maps, scale 1 to 62,500, latitude and longitude lines being represented by border lines as shown.

- Denotes one inch spaces on border line of original tracing.