



STATE OF WEST VIRGINIA  
DEPARTMENT OF MINES  
OIL AND GAS DIVISION

NOTICE OF PROPOSED LOCATION OF OIL AND GAS WELL

To THE DEPARTMENT OF MINES,  
Charleston, W. Va.

_____	<u>Wolf Gas Co.</u>
COAL OPERATOR OR COAL OWNER	NAME OF WELL OPERATOR
_____	<u>Hamlin W. Va.</u>
ADDRESS	COMPLETE ADDRESS
_____	<u>Sept 3, 1958</u>
COAL OPERATOR OR COAL OWNER	PROPOSED LOCATION
_____	<u>Butler</u> District
ADDRESS	<u>Wayne</u> County
_____	Well No. <u>1</u> <u>Dist. 38° 10'</u> <u>Loc. 82° 30' Ecl. 851.31'</u>
OWNER OF MINERAL RIGHTS	<u>Pearl Toney</u> Farm
_____	<u>93-acre</u>
ADDRESS	

GENTLEMEN:

The undersigned well operator is entitled to drill upon the above named farm or tract of land for oil and gas, having fee title thereto, (or as the case may be) under grant or lease dated JULY 18, 1957, made by PEARL TONEY, to R. H. Adkins, and recorded on the 7 day of AUGUST, 1957, in the office of the County Clerk for said County in Book 47, page 268.

The enclosed plat was prepared by a competent engineer and shows the proposed location of a well to be drilled for oil and gas by the undersigned well operator on the farm and in the Magisterial District and County above named, determined by survey and courses and distances from two permanent points, or land marks.

The undersigned well operator is informed and believes there are no coal operators operating beds of coal beneath said farm or tract of land on which said well is located, or within 500 feet of the boundaries of the same, who have mapped their workings and filed their maps as required by law, excepting the coal operators or coal owners (if any) above named as addressees.

The above named coal operators or coal owners (if any) are notified that any objections they may desire to make to such proposed location, or which they are required to make by Section 3 of said Code, if the drilling of a well at said proposed location will cause a dangerous condition in or about their respective coal mines, must be received by, or filed with the Department of Mines within ten\* days from the receipt of a copy of this notice and accompanying plat by said Department. Said coal operators are further notified that forms for use in making such objections will be furnished to them by the Department of Mines promptly on request and that all such objections must set forth as definitely as is reasonably possible the ground or grounds on which such objections are based and indicate the direction and distance the proposed location should be moved to overcome same.

(The next paragraph is to be completed only in Department's copy.)

Copies of this notice and the enclosed plat were mailed by registered mail, or delivered to the above named coal operators or coal owners at their above shown respective address \_\_\_\_\_ day \_\_\_\_\_ before, or on the same day with the mailing or delivery of this copy to the Department of Mines at Charleston, West Virginia.

Very truly yours,

Wolf Gas Co.  
WELL OPERATOR  
by R. H. Adkins  
STREET  
Hamlin  
CITY OR TOWN  
STATE

Address of Well Operator }

08/18/2023



\*Section 3 . . . . If no such objections be filed or be found by the department of mines, within said period of ten days from the receipt of said notice and plat by the department of mines, to said proposed location, the department shall forthwith issue to the well operator a drilling permit reciting the filing of such plat, that no objections have been made by the coal operators to the location, or found thereto by the department, and that the same is approved and the well operator authorized to proceed to drill at said location.

1130

WAY-1130

PERMIT NUMBER

September 22, 1958

Mr. Paul Joachim, Engineer  
United Fuel Gas Company  
P. O. Box 1273  
Charleston 25, West Virginia

Dear Paul:

Enclosed is tracing for Peal Toney, Jr.,  
Well No. 1, Butler District, Wayne County - WAY-1130  
which you wish to revise.

Very truly yours,

Assistant Director  
OIL AND GAS DIVISION

MG/dm  
encl: - 1

*DU*

08/18/2023





STATE OF WEST VIRGINIA  
DEPARTMENT OF MINES  
OIL AND GAS DIVISION

WELL RECORD

Permit No. Way-1130

Quadrants *Shaw* 202/81/80

Company - Wolfe Gas Company

Address - Hamlin, W. Va.

Farm - Pearl Toney

Location (waters) - Big Hurricane Creek

Well No. #1 on Pearl Toney

District - Butler

County - Wayne

The surface of tract is owned in fee by Pearl Toney

Address - Ft. Gay, W. Va.

Mineral rights are owned by - Same

Address -

Drilling commenced - Oct. 6, 1958

Drilling completed - Nov 7, 1958

Date Shot - 11-12-58

From 2027 To 2043

1600 Lbs. Detonite

Open Flow 10 /10ths Water in 3

Inch 10 /10ths Merc. in 300M.

Volume - 600 Lbs.

Rock Pressure - lbs. 72

hrs. 24

Oil - 265

Fresh water - 840

Salt water - 1112

Oil or Gas Well Gas (kind)

Casing and Tubing Used in Drilling

Size 16  
13  
10  
8%  
6%  
5 3/16

Kind of Packer Gas Anchor

Left in Well 10' 2"

Perf. top 1 joint 2063'

Perf. bottom in 1590'

Perf. top Berea 1980'

Perf. bottom 1590'

Perf. top Berea 1980'

Perf. bottom 1590'

Perf. top Berea 1980'

Perf. bottom 1590'

Perf. top Berea 1980'

Perf. bottom 1590'

Perf. top Berea 1980'

Perf. bottom 1590'

Perf. top Berea 1980'

Perf. bottom 1590'

Perf. top Berea 1980'

Perf. bottom 1590'

Perf. top Berea 1980'

Formation	Color	Hard or Soft	Top	Bottom	Oil, Gas or Water	Depth Found	Remarks
Mud			00	12		12	
Sand Rock			40	40		40	
Slate			55	55		55	
Sand			65	65		65	
Slate & Shell			330	330		330	
Sand			418	418		418	
Slate & Shell			440	440		440	
Sand			570	570		570	
Slate & Shell			685	685		685	
Sand			727	727		727	
Slate & Shell			788	788		788	
Slate			840	840		840	
Salt Sand			1112	1112		1112	
Slate			1134	1134		1134	
Sand			1228	1228		1228	
Slate & Shell			1228	1228		1228	
Big Lime			1305	1305		1305	
Slate			1450	1450		1450	
Injun Sand			1460	1460		1460	
Slate & Shells			1540	1540		1540	
Squaw Sand			1565	1565		1565	
Slate			1580	1580		1580	
Shell			1584	1584		1584	
Slate & Shell			1605	1605		1605	
Slate			1800	1800		1800	
Slate & Shell			1820	1820		1820	
Slate			1920	1920		1920	
Big Shell			1955	1955		1955	
Slate			1995	1995		1995	
Slate			2010	2010		2010	
Brown Shale			2027	2027		2027	
Berea Sand			2043	2043		2043	
Slate & Shell			2063	2063		2063	



(Over)

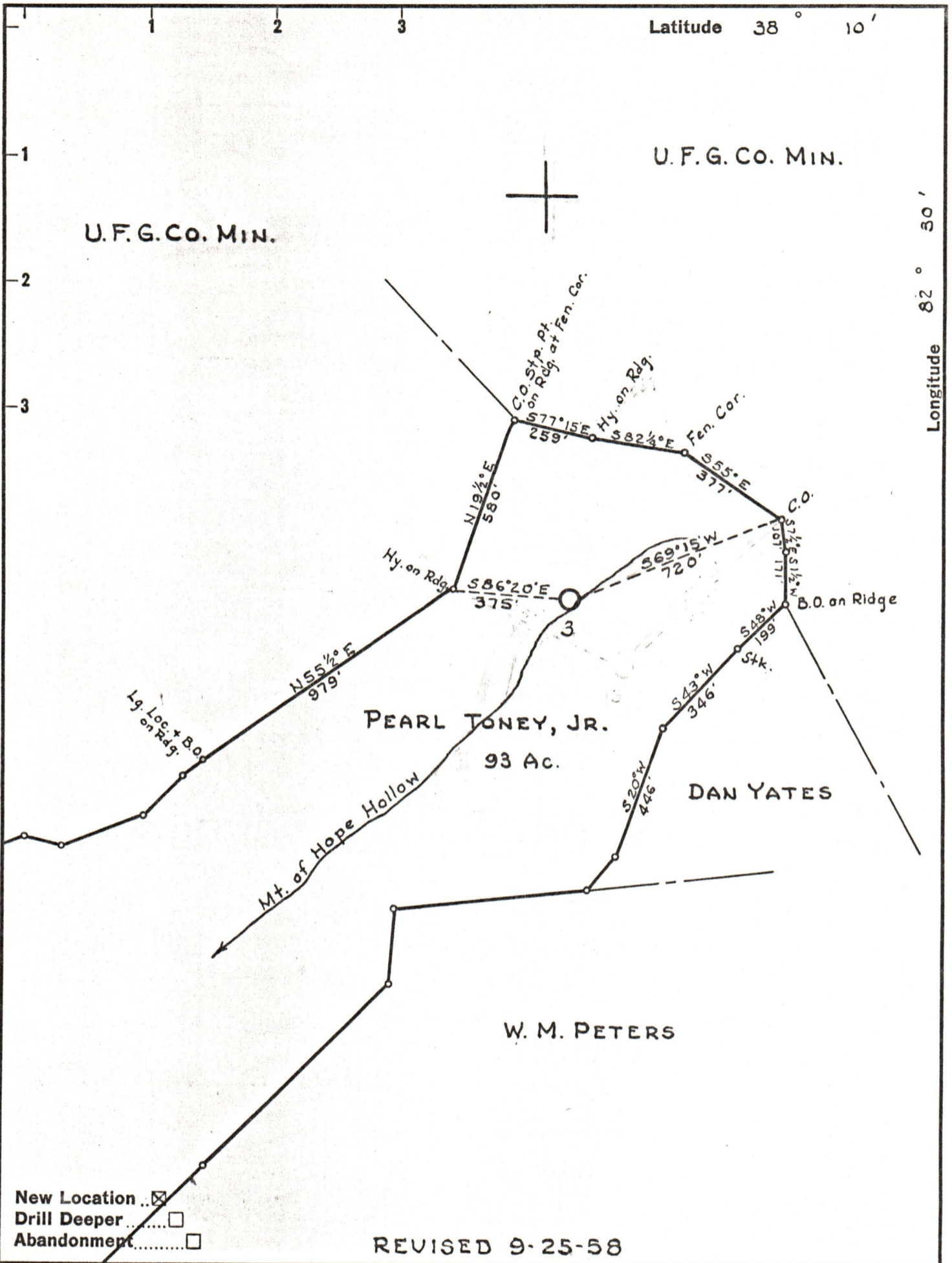

Company	WOLF GAS CO.		
Address	HAMLIN, W. VA.		
Farm	PEARL TONEY, JR.		
Tract	1	Acres	93
Lease No.	3		
Well (Farm) No.	1	Serial No.	3
Elevation (Spirit Level)	851.31		
Quadrangle	LOUISA		
County	WAYNE	District	BUTLER
Engineer	PAUL E. JOACHIM		
Engineer's Registration No.	669		
File No.	13	Drawing No.	13
Date	Aug. 8, 1958		
Scale	1" = 400'		

STATE OF WEST VIRGINIA  
DEPARTMENT OF MINES  
OIL AND GAS DIVISION  
CHARLESTON

WELL LOCATION MAP  
FILE NO. WAY-1130 08/18/2023

+ Denotes location of well on United States Topographic Maps, scale 1 to 62,500, latitude and longitude lines being represented by border lines as shown.

- Denotes one inch spaces on border line of original tracing.