



STATE OF WEST VIRGINIA  
DEPARTMENT OF MINES  
OIL AND GAS DIVISION

NOTICE OF PROPOSED LOCATION OF OIL AND GAS WELL

To THE DEPARTMENT OF MINES,  
Charleston, W. Va.

Barney Asbury

COAL OPERATOR OR COAL OWNER

Wayne, W. Va.

ADDRESS

COAL OPERATOR OR COAL OWNER

ADDRESS

Same

OWNER OF MINERAL RIGHTS

ADDRESS

OWENS, LIBBEY-OWENS GAS DEPARTMENT

NAME OF WELL OPERATOR

P. O. Box 4158, Charleston 4, W. Va.

COMPLETE ADDRESS

December 6, 19 57

PROPOSED LOCATION

Butler District

Wayne County

Well No. 1031 - 1

Barney Asbury Farm

GENTLEMEN:

The undersigned well operator is entitled to drill upon the above named farm or tract of land for oil and gas, ~~having fee title thereto, (or as the case may be)~~ under grant or lease dated 12-9-1948, made by E. D. Bunn & C. W. Osborne, to Owens-Illinois Glass Co. & Libbey-Owens-Ford Glass Co., and recorded on the 8th day of January, 1949, in the office of the County Clerk for said County in Book 38, page 309.

The enclosed plat was prepared by a competent engineer and shows the proposed location of a well to be drilled for oil and gas by the undersigned well operator on the farm and in the Magisterial District and County above named, determined by survey and courses and distances from two permanent points, or land marks.

The undersigned well operator is informed and believes there are no coal operators operating beds of coal beneath said farm or tract of land on which said well is located, or within 500 feet of the boundaries of the same, who have mapped their workings and filed their maps as required by law, excepting the coal operators or coal owners (if any) above named as addressees.

The above named coal operators or coal owners (if any) are notified that any objections they may desire to make to such proposed location, or which they are required to make by Section 3 of said Code, if the drilling of a well at said proposed location will cause a dangerous condition in or about their respective coal mines, must be received by, or filed with the Department of Mines within ten\* days from the receipt of a copy of this notice and accompanying plat by said Department. Said coal operators are further notified that forms for use in making such objections will be furnished to them by the Department of Mines promptly on request and that all such objections must set forth as definitely as is reasonably possible the ground or grounds on which such objections are based and indicate the direction and distance the proposed location should be moved to overcome same.

(The next paragraph is to be completed only in Department's copy.)

Copies of this notice and the enclosed plat were mailed by registered mail, or delivered to the above named coal operators or coal owners at their above shown respective address Same day ~~before~~, or on the same day with the mailing or delivery of this copy to the Department of Mines at Charleston, West Virginia.

Very truly yours,

OWENS, LIBBEY-OWENS GAS DEPARTMENT

WELL OPERATOR

P. O. Box 4158

STREET

Charleston

CITY OR TOWN

West Virginia

STATE

08/18/2023

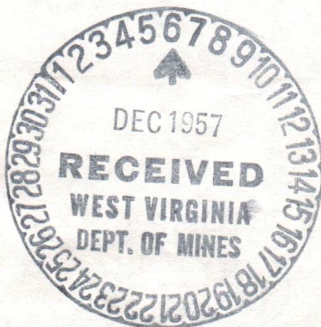

Address of Well Operator }

\*Section 3 . . . . If no such objections be filed or be found by the department of mines, within said period of ten days from the receipt of said notice and plat by the department of mines, to said proposed location, the department shall forthwith issue to the well operator a drilling permit reciting the filing of such plat, that no objections have been made by the coal operators to the location, or found thereto by the department, and that the same is approved and the well operator authorized to proceed to drill at said location.

1066





STATE OF WEST VIRGINIA  
DEPARTMENT OF MINES  
OIL AND GAS DIVISION

NOTICE OF PROPOSED LOCATION OF OIL AND GAS WELL

To The Department of Mines  
Charleston, W. Va.

OWENS, LIBBEY-OWENS GAS DEPARTMENT

Barney Asbury

NAME OF WELL OPERATOR

COAL OPERATOR OR COAL OWNER

P. O. Box 1158, Charleston, W. Va.

Wayne, W. Va.

COMPLETE ADDRESS

ADDRESS

December 6, 1912

COAL OPERATOR OR OIL OWNER

PROPOSED LOCATION

Butler

ADDRESS

Wayne

Same

OWNER OF MINERAL RIGHT

Well No. 1031 - 1

Barney Asbury

ADDRESS

Gentlemen:

The undersigned well operator is entitled to drill upon the above named farm or tract of land for oil and gas, having the mineral rights (under grant or lease dated 12-2-1912)

made by B. D. Bunn & G. W. Osborne

Owens-Libbey-Owens Gas Co., and recorded on the 6th day

of January, 1912, in the office of the County Clerk for said County in

Book 36, Page 309

The enclosed plat was prepared by a competent engineer and shows the proposed location of a well to be drilled for oil and gas by the undersigned well operator on the farm and in the Mineral District and County above named, determined by survey and course and distance from two permanent points, or land marks.

The undersigned well operator is informed and believes there are no coal operators operating beds of coal beneath said farm or tract of land on which said well is located, or within 500 feet of the boundary of the same, who have mapped their workings and filed their maps as required by law, excepting the coal operators or coal owners (if any) above named as addressees.

The above named coal operators or coal owners (if any) are notified that any objections they may desire to make to such proposed location, or which they are required to make by Section 3 of said Code, if the drilling of a well at said proposed location will cause a dangerous condition in or about their respective coal mines, must be received by or filed with the Department of Mines within ten days from the receipt of a copy of this notice and accompanying plat by said Department. Said coal operators are further notified that forms for use in making such objections will be furnished to them by the Department of Mines promptly on request and that all such objections must set forth as definitely as is reasonably possible the ground or grounds on which such objections are based and indicate the direction and distance the proposed location should be moved to overcome same.

The next paragraph is to be completed only in Department's copy.)

Copies of this notice and the enclosed plat were mailed by registered mail, or delivered to the above

named coal operators or coal owners at their above shown respective address, Same day, 1912.

Very truly yours,

OWENS, LIBBEY-OWENS GAS DEPARTMENT

WELL OPERATOR

P. O. Box 1158

STREET

Charleston

Address

Well Operator

CITY OR TOWN

West Virginia

STATE

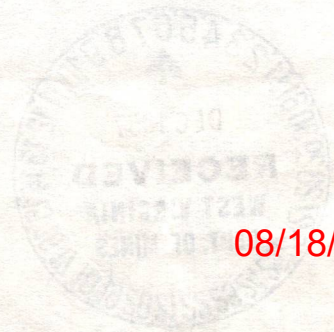

Section 3. If no such objections be filed or be found by the department of mines within said period of ten days from the receipt of said notice and plat by the department of mines to said proposed location, the department shall forthwith issue to the well operator a drilling permit, and the coal operators and coal owners who have been notified the coal operators to the location, or found thereby by the department, and that the same is approved and the well operator authorized to proceed to drill at said location.

Way-1068 Permit Number



# OWENS, LIBBEY-OWENS GAS DEPARTMENT

5793 MACCORKLE AVENUE  
P. O. BOX 4158  
CHARLESTON 4, WEST VIRGINIA



December 6, 1957

W. Va. Department of Mines  
Oil & Gas Division  
Charleston, West Virginia

Gentlemen:

We are submitting an application for a permit to drill well No. 1 on our Barney Asbury tract situated in Butler District, Wayne County, West Virginia. Attached to the application is a plat showing the proposed location of said well.

Very truly yours,

OWENS, LIBBEY-OWENS GAS DEPARTMENT

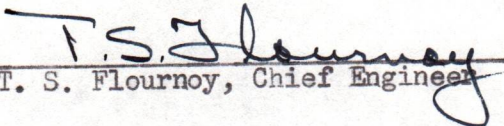
By   
T. S. Flourney, Chief Engineer

TSF/ed  
Enclosures

cc: Mr. Barney Asbury  
Wayne, W. Va.

08/18/2023



OWENS LIBBEY-OWENS GAS DEPARTMENT

2700 MACCORKLE AVENUE  
P. O. BOX 100  
CHARLESTON 4, WEST VIRGINIA



September 6, 1957

W. A. Department of Mines  
Oils & Gas Division  
Charleston, West Virginia

Gentlemen:

We are submitting an application for a permit to  
drill well No. 1 on our Barney Ashby tract situated  
in Carter-Decker, Wayne County, West Virginia.  
Attached to the application is a plat showing the  
proposed location of said well.

Very truly yours,

OWENS LIBBEY-OWENS GAS DEPARTMENT

T. S. Blount  
T. S. Blount, Chief Engineer

139/ed  
-mlawwre

cc: Mr. Barney Ashby  
Wayne W. Va.



Formation	Color	Hard or Soft	Top	Bottom	Oil, Gas or Water	Depth Found	Remarks
Sand	Dark	Med.	1122	1193			
Slate	Dark	Soft	1193	1203			
Sand	Light	Med.	1203	1268			
Slate	Light	Med.	1268	1304			
Sand	Light	Med.	1304	1377			
Slate	Dark	Med.	1377	1381			
Slate	Dark	Soft	1381	1412			
Slate	Dark	Med.	1412	1417			
Sand	Dark	Hard	1417	1435			
Little Lime	Dark	Med.	1435	1446			
Little Lime	Dark	Hard	1446	1453			
Bro. Slate	Dark	Soft	1453	1456			
Big Lime	Light	Hard	1456	1473	Water level 475' at 1473'		
Big Lime	White	Hard	1473	1618	Sand IM 1473		
					Oil show at 1608'		
Grey Injun	Grey	Med.	1618	1626			
Slate	Blue	Soft	1626	1650			
Grey Injun	Grey	Med.	1650	1800	Water level 400' at 1690'		
					SIM 1690 = Sand IM 1680		
Slate	Dark	Soft	1800	1806			
Lime Shells	Dark	Hard	1806	1820	Ran 7" casing on shoe at 1820' in 2		
					sacks Aquagel & 25 sacks cement by		
					Halliburton Co.		
Shells			1820	1826			
Sl. & Shls.	Grey	Med.	1826	1965			
Slate	Dark	Med.	1965	2166			
Pkr. Shells	Dark	Hard	2166	2182	SIM 2182 = Sand IM 2182		
Br. Shale	Brown	Soft	2182	2222			
Berea	Grey	Hard	2222	2228	SIM 2223 = Sand IM 2223		
Slate	Grey	Med.	2228	2242			
Shells	Grey	Hard	2242	2248			
Sl. & Shls.	Dark	Med.	2248	2272			
Shells	Grey	Hard	2272	2282	Oil show 2272-2280		
Sl. & Shls.	Grey	Med.	2282	2292			
Shells	Dark	Hard	2292	2310	Oil test at 2292', 2 qts. in 7 hrs.		
					Gas at 2307'		1.5 MCF
					SIM 2310 = Sand IM 2310		
Slate	Light	Soft	2310	2323			
Br. Shale	Brown	Soft	2323	2455			
Slate	White	Soft	2455	2474			
Slate	Dark	Med.	2474	2526			
Slate	White	Med.	2526	2541			
Br. Shale	Brown	Soft	2541	2578			
Br. Shale	Brown	Med.	2578	2606	Gas test 2606'		1.5 MCF
					SIM 2606 = Sand IM 2606		
Br. Shale	Brown	Soft	2606	2821	Gas-? 2632'		1.7 MCF
					Gas test 2682'		1.5
Slate	Grey	Med.	2821	2851	Gas-? 2825'		1.8
Br. Shale	Brown	Soft	2851	3016			
Slate	White	Soft	3016	3037	Gas test 3037'		1.5
					SIM 3037 = Sand IM 3031		
			Total Depth	3037			
					3-26-58		
					Shot well with 5200# Detonite from		
					2497' to 3039 ft.		
					Test before shot:		1.2 MCF
					15 Min. A.S. :		446.
					1 Hr. "		83.
					19 Hrs. "		11.4
					45 " "		6.
					3-31-58		
					Shot well with 1200# Detonite from 2228		
					to 2317 ft.		
					Test before shot:		4.6 MCF
					15 Min. A.S.		
					2 Hrs. "		39.9

08/18/2023

Date May 9, 19 58

APPROVED OWENS, LIBBEY-OWENS GAS DEPARTMENT, Owner

By *C. H. Smith*  
A. H. Smith (Title) Geologist





STATE OF WEST VIRGINIA  
DEPARTMENT OF MINES  
OIL AND GAS DIVISION 7

Quadrangle Louisa

Permit No. Way-1066

WELL RECORD

Oil or Gas Well Gas  
(KIND)

Company OWENS, LIBBEY-OWENS GAS DEPARTMENT  
Address P. O. Box 4158, Charleston 4, W. Va.  
Farm Barney Asbury "A" Acres 251  
Location (waters) \_\_\_\_\_  
Well No. 1 (Serial No. 1031) Elev. 1038.38  
District Butler County Wayne  
The surface of tract is owned in fee by \_\_\_\_\_  
Address \_\_\_\_\_  
Mineral rights are owned by Barney Asbury  
Address Wayne, W. Va.

Casing and Tubing	Used in Drilling	Left in Well	Packers
Size			Kind of Packer
16			
13			
10			Size of
8 5/8	577'3"	577'3"	Depth set
7"	1819'9"	1819'9"	
5 3/16			
3 1/2	---	2329'	Perf. top 2239
2			Perf. bottom 2327
Liners Used			Perf. top
			Perf. bottom

Drilling commenced 1-20-58  
Drilling completed 3-22-58  
Date Shot 4 times 3-26; 3-31; 4-10; 4-25; From 2497-3039 To 2228-2317  
With 5200#; 1200#; 1600#; 4500# Detonite 2229-2316  
Open Flow /10ths Water in 2229-2317 Inch  
/10ths Merc. in \_\_\_\_\_ Inch  
Volume Berea Sand 92 M Cu. Ft.  
Rock Pressure 535 lbs. 40 hrs.  
Oil \_\_\_\_\_ bbls., 1st 24 hrs.

CASING CEMENTED \_\_\_\_\_ SIZE \_\_\_\_\_ No. Ft. \_\_\_\_\_ Date \_\_\_\_\_  
COAL WAS ENCOUNTERED AT 251 FEET 36 INCHES  
379 FEET 48 INCHES FEET INCHES  
FEET INCHES FEET INCHES

WELL ACIDIZED \_\_\_\_\_  
WELL FRACTURED \_\_\_\_\_

RESULT AFTER TREATMENT \_\_\_\_\_  
ROCK PRESSURE AFTER TREATMENT \_\_\_\_\_  
Fresh Water 216, 450, 598, 700 Feet 995 Salt Water \_\_\_\_\_ Feet

Formation	Color	Hard or Soft	Top	Bottom	Oil, Gas or Water	Depth	Remarks
Soil	Yellow	Soft	0	4			
Sandstone	Yellow	Soft	4	54			
Slate	Grey	Soft	54	60			
Slate	Light	Soft	60	167			
Sand	Light	Soft	167	251	Water at 216', 1/2 B.P.H.		
Coal	Black	Soft	251	254			
Slate	Dark	Soft	254	320			
Sand	Grey	Soft	320	336			
Slate	Light	Soft	336	379			
Coal	Black	Soft	379	383			
Slate	Dark	Soft	383	423			
Sand	Light	Med.	423	535	Water at 450', 2-1/2 B.P.H.		
Sand, Bro.	Dark	Med.	535	558			
Slate	Dark	Med.	558	577	Ran 8-5/8" casing on shoe at 577'3"		
Slate	Dark	Med.	577	581			
Sand	White	Med.	581	622	Water at 598', 6 B.P.H.		
Slate	Dark	Soft	622	664			
Slate	Dark	Med.	664	700			
Sand	White	Med.	700	751	Water at 700-710', hole full		
Slate	Dark	Soft	751	781			
Sand	Light	Med.	781	821			
Slate	Dark	Soft	821	950			
Sand	Light	Hard	950	967			
Sand	Dark	Med.	967	992			
Slate	Dark	Med.	992	995	Water level 480' at 995		
Slate	Dark	Soft	995	1006			
Sand	Dark	Med.	1006	1066			
Sand	Light	Med.	1066	1102			
Slate	Dark	Soft	1102	1112			
Sand	Light	Med.	1112	1122			

(over)

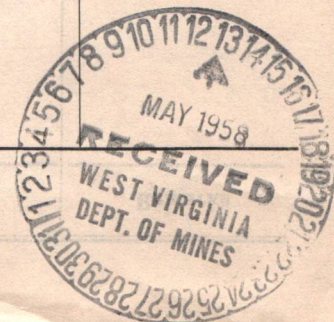



Formation	Color	Hard or Soft	Top 7A	Bottom	Oil, Gas or Water	Depth Found	Remarks
					4-25-58 Shot well with 4500# Detonite from 2229 to 2317 ft. Tamped with 20' pea gravel Time bomb set for 2 hours Test B.S.: 85 MCF		
					4-26-58 Opened well at 7:30 A.M. Cleaned out to 2246 ft. Tests while cleaning out: 15 Min. 167 MCF 1 Hr. 127 MCF 14-1/2 Hrs. 86		
					4-28-58 47 Hrs. A.S. 93 MCF 124 " " 92 MCF Stain of oil SIM 2326 = Sand IM 2327		
					5-1-58 Set 3-1/2" tubing on bottom and picked up 18" set on 7" casing on Hinderliter Head. Final open flow: Berea 92 MCF		
					Shut-in in 3-1/2" tubing at 7 P.M. 131 hours after shot.		

08/18/2023

Date April 9, 19 58

APPROVED OWENS, LIBBEY-OWENS GAS DEPARTMENT, Owner

By C. H. Smith  
A. H. Smith (Title) Geologist





STATE OF WEST VIRGINIA  
DEPARTMENT OF MINES  
OIL AND GAS DIVISION

Quadrangle Louisa

WELL RECORD

Permit No. Way-1066

Oil or Gas Well Gas  
(KIND)

Company OWENS, LIBBEY-OWENS GAS DEPARTMENT  
 Address P. O. Box 4158, Charleston 4, W. Va.  
 Farm Barney Asbury "A" Acres 251  
 Location (waters) \_\_\_\_\_  
 Well No. 1 (Serial No. 1031) Elev. 1038.38  
 District \_\_\_\_\_ County \_\_\_\_\_  
 The surface of tract is owned in fee by \_\_\_\_\_  
 Address \_\_\_\_\_  
 Mineral rights are owned by \_\_\_\_\_  
 Address \_\_\_\_\_  
 Drilling commenced \_\_\_\_\_  
 Drilling completed \_\_\_\_\_  
 Date Shot \_\_\_\_\_ From \_\_\_\_\_ To \_\_\_\_\_  
 With \_\_\_\_\_  
 Open Flow \_\_\_\_\_ /10ths Water in \_\_\_\_\_ Inch  
 \_\_\_\_\_ /10ths Merc. in \_\_\_\_\_ Inch  
 Volume \_\_\_\_\_ Cu. Ft.  
 Rock Pressure \_\_\_\_\_ lbs. \_\_\_\_\_ hrs.  
 Oil \_\_\_\_\_ bbls., 1st 24 hrs.  
 WELL ACIDIZED \_\_\_\_\_  
 WELL FRACTURED \_\_\_\_\_

Casing and Tubing	Used in Drilling	Left in Well	Packers
Size			Kind of Packer _____
16			
13			
10			Size of _____
8 1/4			
6 5/8			Depth set _____
5 3/16			
3			Perf. top _____
2			Perf. bottom _____
Liners Used			Perf. top _____
			Perf. bottom _____

CASING CEMENTED \_\_\_\_\_ SIZE \_\_\_\_\_ No. Ft. \_\_\_\_\_ Date \_\_\_\_\_

COAL WAS ENCOUNTERED AT \_\_\_\_\_ FEET \_\_\_\_\_ INCHES  
 \_\_\_\_\_ FEET \_\_\_\_\_ INCHES FEET \_\_\_\_\_ INCHES  
 \_\_\_\_\_ FEET \_\_\_\_\_ INCHES FEET \_\_\_\_\_ INCHES

RESULT AFTER TREATMENT \_\_\_\_\_  
 ROCK PRESSURE AFTER TREATMENT \_\_\_\_\_  
 Fresh Water \_\_\_\_\_ Feet \_\_\_\_\_ Salt Water \_\_\_\_\_ Feet \_\_\_\_\_

Formation	Color	Hard or Soft	Top	Bottom	Oil, Gas or Water	Depth	Remarks
Continued from previous page:					4-1; 4-4; 4-7; Bailing oil		
					Gas test 165 Hrs. A.S.:		21.4 MCF
					4-10-58		
					Oil averaged 3/10 gal. per hour in 72 hour test		
					Shot well with 1600# Detonite from 2229 to 2316 ft.		
					Tamped with 30' pea gravel		
					Time bomb set for 2 hours		
					Test B.S.:		20.7 MCF
					Shot went off at 2:26 P.M.		
					Did not blow out tamp		
					Test 15 Min. A.S.:		18.8 MCF
					4-11-58		
					Drilling out tamp		
					Shot hole uncovered at 4 P.M.		
					Gas test 5 P.M.		158 MCF
					4-18; 4-19;		
					4-14; 4-15; 4-16; 4-17; Cleaning out		
					Test 4-19; 10:30 A.M.		86 MCF
					Shut well in.		
					4-21-58 Blew well at 5:45 A.M.		
					Test 8 A.M.		131 MCF
					10:45 "		95
					4-22; 4-23; 4-24; Cleaned out to 2317'; Smear of oil.		



08/18/2023



STATE OF WEST VIRGINIA  
DEPARTMENT OF MINES  
OIL AND GAS WELLS DIVISION

INSPECTOR'S WELL REPORT

Permit No. Way 1066-P

Oil or Gas Well \_\_\_\_\_  
(KIND)

Company Address Farm Well No. District County	CASING AND TUBING	USED IN DRILLING	LEFT IN WELL	PACKERS
	<u>Blue Creek Gas Co</u> <u>Charleston WVA</u> <u>Barney Asbury</u> <u>One Serial no 1031</u> <u>Butler</u> County <u>Wayne</u>	Size 16 13 10 8 1/4 6 5/8 5 3/16 3 2	<u>Busted Collar</u> <u>out</u>	<u>1400</u>
Drilling commenced _____ Drilling completed _____ Total depth <u>1400</u> Date shot _____ Depth of shot _____ Initial open flow _____ /10ths Water in _____ Inch Open flow after tubing _____ /10ths Merc. in _____ Inch Volume _____ Cu. Ft. Rock pressure _____ lbs. _____ hrs. Oil _____ bbls., 1st 24 hrs. Fresh water _____ feet _____ feet Salt water _____ feet _____ feet	CASING CEMENTED _____ SIZE _____ No. FT. _____ Date _____ NAME OF SERVICE COMPANY _____ COAL WAS ENCOUNTERED AT _____ FEET _____ INCHES _____ FEET _____ INCHES FEET _____ INCHES _____ FEET _____ INCHES FEET _____ INCHES			

Drillers' Names: Homer Graves

Remarks: mounted Shudder

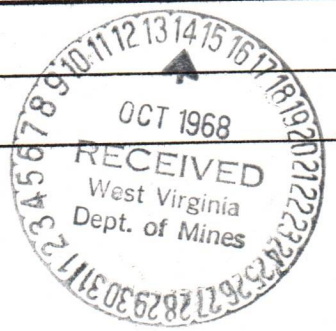

[Signature]

DISTRICT WELL INSPECTOR  
08/18/2023

Oct 7, 68  
DATE







STATE OF WEST VIRGINIA  
DEPARTMENT OF MINES  
OIL AND GAS DIVISION

## INSPECTOR'S WELL REPORT

Permit No. \_\_\_\_\_

Oil or Gas Well \_\_\_\_\_  
(KIND)

	CASING AND TUBING	USED IN DRILLING	LEFT IN WELL	PACKERS
Company _____				
Address _____	Size			Kind of Packer _____
Farm _____	16			
Well No. _____	13			Size of _____
District _____ County _____	10			
Drilling commenced _____	8 1/4			Depth set _____
Drilling completed _____ Total depth _____	6 5/8			
Date shot _____ Depth of shot _____	5 3/16			Perf. top _____
Initial open flow _____ /10ths Water in _____ Inch	3			
Open flow after tubing _____ /10ths Merc. in _____ Inch	2			Perf. bottom _____
Volume _____ Cu. Ft.	Liners Used _____			Perf. top _____
Rock pressure _____ lbs. _____ hrs.				Perf. bottom _____
Oil _____ bbls., 1st 24 hrs.	CASING CEMENTED _____ SIZE _____ No. FT. _____ Date _____			
Fresh water _____ feet _____ feet	NAME OF SERVICE COMPANY _____			
Salt water _____ feet _____ feet	COAL WAS ENCOUNTERED AT _____ FEET _____ INCHES			
	_____ FEET _____ INCHES _____ FEET _____ INCHES			
	_____ FEET _____ INCHES _____ FEET _____ INCHES			

Drillers' Names \_\_\_\_\_

Remarks:

DATE

DISTRICT WELL INSPECTOR

08/18/2023





STATE OF WEST VIRGINIA  
DEPARTMENT OF MINES  
OIL AND GAS DIVISION

**NOTICE OF INTENTION TO PLUG AND ABANDON WELL**

(REQUIRED BY SECTION 9, ARTICLE 4, CHAPTER 22 OF THE CODE)

TO THE DEPARTMENT OF MINES,  
Charleston, W. Va.

Coal Operator	<u>Blue Creek Gas Company</u>
Address	Name of Well Operator <u>P. O. Box 6357</u> <u>Charleston, W. Va. 25302</u>
Coal Owner	Complete Address
Address	Date <u>September 13, 1968</u>
<u>Barney Asbury</u>	WELL TO BE ABANDONED
Lease or Property Owner	<u>Butler</u> District
<u>Wayne, W. Va.</u>	<u>Wayne</u> County
Address	Well No. <u>1 (Serial No. 1031)</u>
	<u>Barney Asbury "A"</u> Farm

Inspector Mr. E. L. Lusher, Box 37-A, Lavalette, W. Va. 25535 Telephone Huntington 525-6868

**TO BE NOTIFIED 24 HOURS IN ADVANCE OF PLUGGING OPERATIONS**

Gentlemen:—

The undersigned well operator is about to abandon the above described well and will commence the work of plugging and abandoning said well on the date inspector is notified (which date shall not be less than five days after the day on which this notice so mailed is received, or in due course should be received by the Department of Mines).

This notice is given you in order that your respective representatives may be present at the plugging and filling of said well. You are further notified that whether you are represented or not represented the undersigned will proceed on that date, or shortly thereafter, to plug and fill said well in the manner required by Section 10, Article 4, Chapter 22 of the Code and given in detail on the reverse side of this notice, in "Work Order."

This notice is being mailed by registered mail to each of you at the above addresses on the above date. 9/13/68

Very truly yours, BLUE CREEK GAS COMPANY

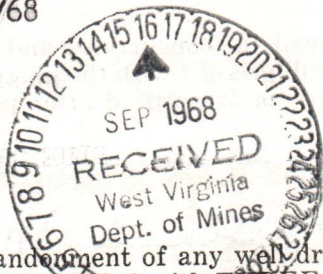

By: Stanley M. Rubin  
Well Operator

NOTE: Upon the abandonment of any well drilled prior to June 1, 1929, a plat prepared by a registered engineer, shall be filed with **THREE COPIES OF APPLICATION, (OG-9) AND "WORK ORDER" AND TWO COPIES OF THE WELL RECORD, (OG-10).** The map must show the district and county in which the tract of land is located, the name and acreage of same, the name or names of the owners and names of adjacent tracts and the location of the well to be abandoned, determined by survey with the courses and distances of such well from two permanent points or landmarks on said tract, in compliance with Rule 5 of the Rules and Regulations.

NOTE: In case plugging is not commenced within four months from the date of permit, same shall expire and be of no further force or effect. 08/18/2023

NOTE: PERMIT IS NON TRANSFERABLE.

WAY-1066-P

Permit Number

AFFIDAVIT, FORM OG-8, MANNER WELL PLUGGED MUST BE SUBMITTED TO OBTAIN RELEASE OF WELL UNDER BOND



PROPOSED MANNER OF PLUGGING AND FILLING WELL

(REQUIRED BY RULES AND REGULATIONS)

WEST VIRGINIA DEPARTMENT OF MINES

OIL AND GAS DIVISION

WORK ORDER

Well to be plugged and filled as follows:

Pull 3" - 2329'

Set Bridge at 2218 sealing off Berea Sand  
Rock 2218-2208  
Cement 2208-2198  
Clay 2198-2098  
Cement 2098-2088

Pull 7" - 1820'

Bridge at 1600  
Rock 1600-1590  
Cement 1590-1580  
Clay 1580-1480  
Cement 1480-1470

Pull 8" - 577'

Bridge 597  
Rock 597-587  
Cement 587-577  
Clay 577-567  
Bridge 567  
Cement 567-557  
Clay 557-423  
Cement 423-360  
Clay 360-294  
Cement 294-230

Fill with clay from 230 to surface

Erect monument in compliance with Rule 5 of the Rules and Regulations

To the Department of Mines  
Coal Owner or Operator,  
Lease or Property Owner.

IF PARTIAL PLUGGING  
PLEASE SUBMIT REVISED WELL RECORD  
WHEN WORK IS COMPLETED.

Gentlemen:

This "work order" is submitted for your approval and concurrence and unless notified of your disapproval or non-concurrence, the undersigned will proceed with the plugging and filling of said well in the above described manner on the date inspector is notified after permit is issued.

Very truly yours, BLUE CREEK GAS COMPANY

By: Stanley M. Rubin  
Well Operator

No objections have been filed by the coal owner or coal operator, or any available adjacent lease or property owners or interposed by the Department of Mines to the manner herein described for the plugging and filling of the well above mentioned. Therefore, the same is hereby approved this

17th day of September, 19 68.

DEPARTMENT OF MINES 08/18/2023  
Oil and Gas Division

By: Robert [Signature]

NOTE: This "work order" shall be filed in triplicate, one copy for the files of the Department of Mines; one to be approved or corrected and returned to the well operator as his authority for plugging said well; and one for the well inspector.





FORM OG-8

STATE OF WEST VIRGINIA
DEPARTMENT OF MINES
OIL AND GAS DIVISION

AFFIDAVIT OF PLUGGING AND FILLING WELL

AFFIDAVIT SHOULD BE MADE IN TRIPPLICATE, ONE COPY MAILED TO THE DEPARTMENT, ONE COPY TO BE RETAINED BY THE WELL OPERATOR AND THE THIRD COPY (AND EXTRA COPIES IF REQUIRED) SHOULD BE MAILED TO EACH COAL OPERATOR AT THEIR RESPECTIVE ADDRESSES.

Blue Creek Gas Company
NAME OF WELL OPERATOR
P. O. Box 6357, Charleston, W. Va. 25302
COMPLETE ADDRESS
November 26, 1948
WELL AND LOCATION
Butler District
Wayne County
Well No. 1 (Serial No. 1031)
Barney Asbury "A" Farm
STATE INSPECTOR SUPERVISING PLUGGING E. L. Lusher

AFFIDAVIT

STATE OF WEST VIRGINIA,

County of Kanawha } ss:
Homer Groves and Roger Meadows

being first duly sworn according to law depose and say that they are experienced in the work of plugging and filling oil and gas wells and were employed by Blue Creek Gas Company, well operator, and participated in the work of plugging and filling the above well, that said work was commenced on the 26th day of September, 1948, and that the well was plugged and filled in the following manner:

Table with columns: SAND OR ZONE RECORD, FILLING MATERIAL, PLUGS USED, CASING. Includes a circular 'RECEIVED' stamp from the West Virginia Dept. of Mines dated NOV 1948.

and that the work of plugging and filling said well was completed on the 9th day of October, 1948. And further deponents saith not.

Homer Groves 08/18/2023
Roger Meadows
Daniel Rubin
Notary Public.

My commission expires: July 28, 1970

Permit No. WAY-1066-P











STATE OF WEST VIRGINIA  
DEPARTMENT OF MINES  
OIL AND GAS DIVISION

## INSPECTOR'S WELL REPORT

Permit No. \_\_\_\_\_

Oil or Gas Well \_\_\_\_\_  
(KIND)

	CASING AND TUBING	USED IN DRILLING	LEFT IN WELL	PACKERS
Company _____	Size _____			
Address _____	16 _____			Kind of Packer _____
Farm _____	13 _____			
Well No. _____	10 _____			Size of _____
District _____ County _____	8 1/4 _____			
Drilling commenced _____	6 5/8 _____			Depth set _____
Drilling completed _____ Total depth _____	5 3/16 _____			
Date shot _____ Depth of shot _____	3 _____			Perf. top _____
Initial open flow _____ /10ths Water in _____ Inch	2 _____			Perf. bottom _____
Open flow after tubing _____ /10ths Merc. in _____ Inch	Liners Used _____			Perf. top _____
Volume _____ Cu. Ft.				Perf. bottom _____
Rock pressure _____ lbs. _____ hrs.	CASING CEMENTED _____ SIZE _____ No. FT. _____ Date _____			
Oil _____ bbls., 1st 24 hrs.	NAME OF SERVICE COMPANY _____			
Fresh water _____ feet _____ feet	COAL WAS ENCOUNTERED AT _____ FEET _____ INCHES			
Salt water _____ feet _____ feet	_____ FEET _____ INCHES _____ FEET _____ INCHES			
	_____ FEET _____ INCHES _____ FEET _____ INCHES			

Drillers' Names \_\_\_\_\_

Remarks: \_\_\_\_\_

20-1-15-201

DATE \_\_\_\_\_

DISTRICT WELL INSPECTOR 08/18/2023





State of West Virginia

Department of Mines  
Oil and Gas Division  
Charleston 5

December 17, 1968

Blue Creek Gas Company  
P. O. Box 6357  
Charleston, W. Va. 25302

IN RE: Permit	<u>WAY-1066-P</u>
Farm	<u>Barney Asbury "A"</u>
Well No.	<u>1 (S-1031)</u>
District	<u>Butler</u>
County	<u>Wayne</u>

Gentlemen:

The final inspection report for the Well which is described above has been received in this office.

Please be advised that the Well which is covered by the above permit number has been released under your Blanket Bond.

Very truly yours,

Deputy Director  
Oil and Gas Wells Division

b

08/18/2023



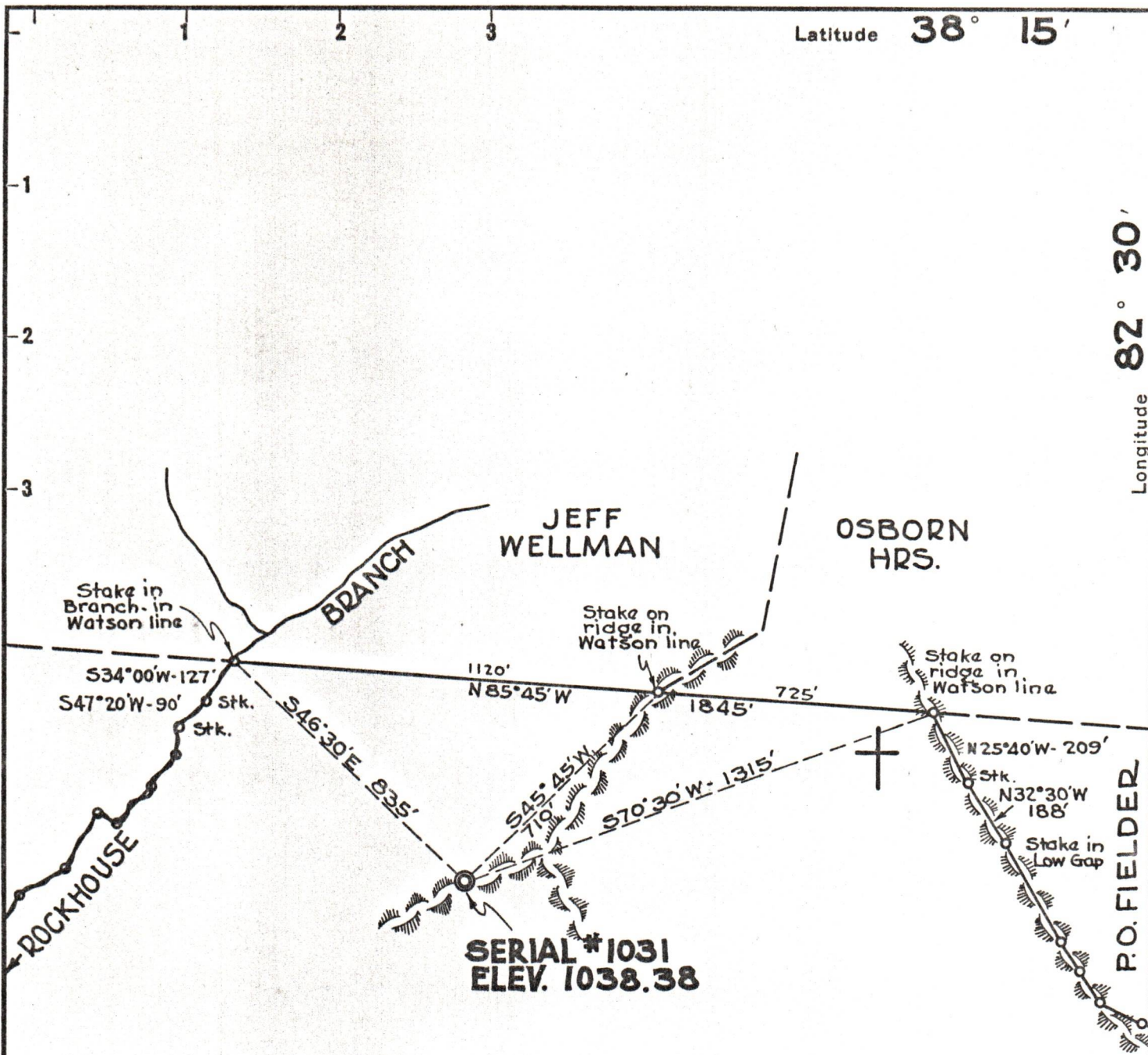

Latitude 38° 15'

Longitude 82° 30'

**#2321  
BARNEY ASBURY  
251 ACRES  
JAMES PARSLEY-SURE.**

New Location...   
 Drill Deeper.....   
 Abandonment.....  9-17-68

BK112P3840

Company Blue Creek Gas Co.  
~~OWENS LIBBEY OWENS GAS DEPT.~~  
 Address BOX 4158 CHARLESTON 4, W.VA.  
 Farm BARNEY ASBURY  
 Tract \_\_\_\_\_ Acres 251 Lease No. 2321  
 Well (Farm) No. 1 Serial No. 1031  
 Elevation (Spirit Level) 1038.38  
 Quadrangle LOUISA  
 County WAYNE District BUTLER  
 Engineer T. S. FLOURNOY  
 Engineer's Registration No. 269  
 File No. \_\_\_\_\_ Drawing No. \_\_\_\_\_  
 Date 12-3-57 Scale 1" = 400 FT.

STATE OF WEST VIRGINIA  
 DEPARTMENT OF MINES  
 OIL AND GAS DIVISION  
 CHARLESTON

WELL LOCATION MAP  
 FILE NO. WAY-1066-P 08/18/2023

+ Denotes location of well on United States Topographic Maps, scale 1 to 62,500, latitude and longitude lines being represented by border lines as shown.  
 - Denotes one inch spaces on border line of original tracing.