



STATE OF WEST VIRGINIA
DEPARTMENT OF MINES
OIL AND GAS DIVISION

NOTICE OF PROPOSED LOCATION OF OIL AND GAS WELL

To THE DEPARTMENT OF MINES,
Charleston, W. Va.

G. W. Workman Est., Ed Workman, Exec.
COAL OPERATOR OR COAL OWNER

Wayne, West Virginia
ADDRESS

G. W. Workman Est.
~~COAL OPERATOR OR COAL OWNER~~ COAL OWNER

ADDRESS

OWNER OF MINERAL RIGHTS

ADDRESS

Owens, Libbey-Owens Gas Department
NAME OF WELL OPERATOR

P. O. Box 4158, Charleston 4, W. Va.
COMPLETE ADDRESS

May 14, 19 56
PROPOSED LOCATION

Butler District

Wayne County

Well No. 5 (Serial No. 958) 38° 15'
82° 25'

G. W. Workman Farm

GENTLEMEN:

The undersigned well operator is entitled to drill upon the above named farm or tract of land for oil and gas, having fee title thereto, (or as the case may be) under grant or lease dated April 15, 1929, made by Ed Workman et al, to Owens Bottle Co. & Libbey-Owens Sheet Glass Co. (Now Owens-Illinois Glass Co. & Libbey-Owens-Ford Glass Co.) and recorded on the 4th day of June, 1929, in the office of the County Clerk for said County in Book 13, page 362.

The enclosed plat was prepared by a competent engineer and shows the proposed location of a well to be drilled for oil and gas by the undersigned well operator on the farm and in the Magisterial District and County above named, determined by survey and courses and distances from two permanent points, or land marks.

The undersigned well operator is informed and believes there are no coal operators operating beds of coal beneath said farm or tract of land on which said well is located, or within 500 feet of the boundaries of the same, who have mapped their workings and filed their maps as required by law, excepting the coal operators or coal owners (if any) above named as addressees.

The above named coal operators or coal owners (if any) are notified that any objections they may desire to make to such proposed location, or which they are required to make by Section 3 of said Code, if the drilling of a well at said proposed location will cause a dangerous condition in or about their respective coal mines, must be received by, or filed with the Department of Mines within ten* days from the receipt of a copy of this notice and accompanying plat by said Department. Said coal operators are further notified that forms for use in making such objections will be furnished to them by the Department of Mines promptly on request and that all such objections must set forth as definitely as is reasonably possible the ground or grounds on which such objections are based and indicate the direction and distance the proposed location should be moved to overcome same.

(The next paragraph is to be completed only in Department's copy.)

Copies of this notice and the enclosed plat were mailed by registered mail, or delivered to the above named coal operators or coal owners at their above shown respective address _____ day _____ before or on the same day with the mailing or delivery of this copy to the Department of Mines at Charleston, West Virginia.

Very truly yours,

OWENS, LIBBEY-OWENS GAS DEPARTMENT
WELL OPERATOR

P. O. Box 4158
STREET

Charleston 4,
CITY OR TOWN

West Virginia
STATE

02/02/2024

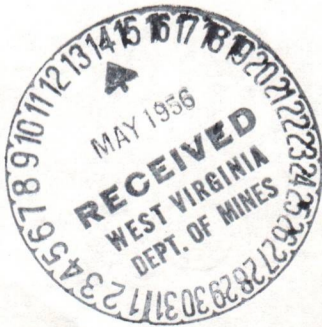

Address of Well Operator }

*Section 3 If no such objections be filed or be found by the department of mines, within said period of ten days from the receipt of said notice and plat by the department of mines, to said proposed location, the department shall forthwith issue to the well operator a drilling permit reciting the filing of such plat, that no objections have been made by the coal operators to the location, or found thereto by the department, and that the same is approved and the well operator authorized to proceed to drill at said location.

1015



STATE OF WEST VIRGINIA
DEPARTMENT OF MINES
OIL AND GAS DIVISION

NOTICE OF PROPOSED LOCATION OF OIL AND GAS WELL

To THE DEPARTMENT OF MINES
Charleston, W. Va.

G. W. Workman Est., Ed Workman, Exec.

Owens, Libbey-Owens Gas Department

Wayne, West Virginia

P. O. Box 1153, Charleston 11, W. Va.

G. W. Workman Est.

May 11, 1929

COAL OPERATOR OF COAL OWNER

PROPOSED LOCATION

ADDRESS

Wayne

OWNER OF MINERAL RIGHTS

Wayne

of No 2 (Serial No. 958)

ADDRESS

G. W. Workman

ENTIREMENT

The undersigned well operator is entitled to drill upon the above named farm or tract of land for

oil and gas having for this purpose (or as the case may be) under lease or lease dated April 15,

1929 to Ed Workman of Ed

Owens Bottle Co. & Libbey-Owens Sheet Glass Co. (now Owens-Illinois Glass Co. & Libbey-Owens-Ford Glass Co.)

in the office of the County Clerk for said County in

June, 1929

The enclosed plat was prepared by a competent engineer and shows the proposed location of a well to be drilled for oil and gas by the undersigned well operator on the farm and in the Mineral Rights and Grants above named, determined by survey and corners and distances from two permanent points or land marks.

The undersigned well operator is informed and believes there are no coal operators operating beds of coal beneath and tract of land on which said well is located or within 300 feet of the boundary of the same who have mapped their workings and filed their maps as required by law, excepting the coal operators of coal owners (if any) above named as aforesaid.

The above named coal operator of coal owners (if any) are notified that any objections they may desire to make to such proposed location, or which they are required to make by Section 3 of said Code, in the drilling of a well at said proposed location will cause a change of location in or about their respective coal mines must be received by or filed with the Department of Mines within ten days from the receipt of this notice and accompanying plat by said Department. Said coal operators are further notified that forms for use in making such objections will be furnished to them by the Department of Mines promptly on request and that all such objections must set forth specifically, as far as may be possible, the ground or grounds on which such objections are based and indicate the location and distance the proposed location should be moved to overcome same.

The next paragraph is to be completed only in Department's copy.

Copies of this notice and the enclosed plat were mailed by registered mail or delivered to the above

named coal operator or coal owners at their above shown respective addresses by

on the same day with the mailing or delivery of this copy to the Department of Mines at Charleston, West Virginia.

Very truly yours,

OWENS, LIBBEY-OWENS GAS DEPARTMENT

WELL OPERATOR

P. O. Box 1153

STREET

Charleston 11

CITY OR TOWN

West Virginia

STATE

Address of Well Operator

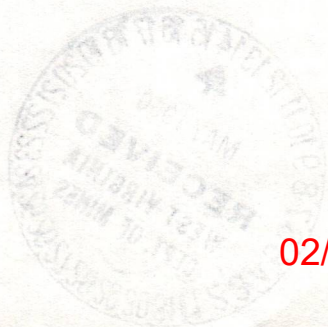

02/02/2024

Section 3 of said Code provides that the Department of Mines shall be notified of any proposed location of a well to be drilled for oil and gas by the undersigned well operator on the farm and in the Mineral Rights and Grants above named, determined by survey and corners and distances from two permanent points or land marks. The undersigned well operator is informed and believes there are no coal operators operating beds of coal beneath and tract of land on which said well is located or within 300 feet of the boundary of the same who have mapped their workings and filed their maps as required by law, excepting the coal operators of coal owners (if any) above named as aforesaid. The above named coal operator of coal owners (if any) are notified that any objections they may desire to make to such proposed location, or which they are required to make by Section 3 of said Code, in the drilling of a well at said proposed location will cause a change of location in or about their respective coal mines must be received by or filed with the Department of Mines within ten days from the receipt of this notice and accompanying plat by said Department. Said coal operators are further notified that forms for use in making such objections will be furnished to them by the Department of Mines promptly on request and that all such objections must set forth specifically, as far as may be possible, the ground or grounds on which such objections are based and indicate the location and distance the proposed location should be moved to overcome same.

Permit Number

A-10

OWENS, LIBBEY-OWENS GAS DEPARTMENT

5793 MACCORKLE AVENUE

P. O. BOX 4158

CHARLESTON 4, WEST VIRGINIA



May 14, 1956

W. Va. Department of Mines
Oil & Gas Division
Charleston, West Virginia

Gentlemen:

We are submitting an application for a permit to drill Well No. 5, on our G. W. Workman tract, situated in Butler District, Wayne County, West Virginia.

Attached to the application is a plat showing the proposed location of said well. Will you please issue us a permit to begin drilling this well at your earliest convenience.

Yours very truly,

OWENS, LIBBEY-OWENS GAS DEPARTMENT

By T. S. Flournoy
T. S. Flournoy
Chief Engineer

TSF/hjl
Enclosures (2)

CC: G. W. Workman Est.,
Ed Workman Exec.
Wayne, West Virginia

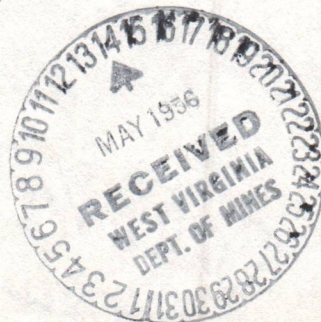

02/02/2024

OWENS, LIBBEY-OWENS GAS DEPARTMENT

845 MACCORRIE AVENUE
CHARLESTON, WEST VIRGINIA



July 11, 1936

W. Va. Department of Mines
Oil & Gas Division
Charleston, West Virginia

Gentlemen:

We are submitting an application for a permit to
drill well No. 2, on our G. W. Norman tract, situated in
Butler District, Wayne County, West Virginia.

Attached to the application is a plat showing the
proposed location of said well. Will you please issue us a
permit to begin drilling this well at your earliest con-
venience.

Yours very truly,

OWENS, LIBBEY-OWENS GAS DEPARTMENT

T. S. Kinnery
T. S. Kinnery
Chief Engineer

TSL/njl
Enclosures (2)

CC: G. W. Norman Esq.,
Ed Norman Esq.,
Wayne, West Virginia



B-3

May 24, 1956

Owens, Libbey-Owens Gas Department
P. O. Box 4158
Charleston, West Virginia

Gentlemen:

Enclosed is permit WAY-1015 to drill well
No. 5-Sr-958 on the G. W. Workman farm, Butler District,
Wayne County.

Very truly yours,

Administrative Assistant
OIL AND GAS DIVISION

CNH:K
Encl-1

CC: Inspector O. C. Allen

02/02/2024

B-2

Formation	Color	Hard or Soft	Top 28	Bottom	Oil, Gas or Water	Depth Found	Remarks
Little Lime	-	-	1068	1085			
Slate	-	-	1085	1087			
Big Lime	White	Hard	1087	1257	Oil 1215'	"smell"	
Grey Injun	Grey	Hard	1257	1380			
Grey Injun	Grey	Med.	1380	1409			
Sand, Bro.	Grey	Med.	1409	1421			
Lime, Black	Black	-	1421	1424			
Lime Shell	Dark	Hard	1424	1430			
Sl. & Shls.	Dark	Med.	1430	1783			Ran 7" casing on shoe at 1424 ft.
Slate	Dark	Med.	1783	1803			
Packer Shells	Dark	Hard	1803	1815			
Slate	Dark	Med.	1815	1858			
Coffee Shale	Dark	Soft	1858	1871			
Berea Sand	Grey	Hard	1871	1881	Gas pay 1873' - 1875'		8.3 M
Sl. & Shls.	Light	Med.	1881	1891	Gas 1880'		163 M
Sl. & Shls.	Light	Hard	1891	1902	Test 1883'		154 M
					Filled hole back to 1882'		
			Total Depth	1902			
			Total Depth After Shot	1904			
					6-21-56 Shot well with 150# Detonite from 1871 to 1882'; tamped with 11' Pea Gravel. Used time bomb set for 3 hours. Shot went off at 3:35 P.M.		
					Test before shot:		114 MC
					" 15 Min. A.S. :		188
					9 Hrs. "		160
					41 " "		147
					6-23-56 Shot second time with 800# Detonite from 1871 to 1885'; tamped with 18' Pea Gravel. Used time bomb set for 2 hours. Shot went off at 12:45 P.M. Tamp cleaned out at 6:45 P.M.		
					Test before shot:		147 MC
					" 5 Min. A.S. :		489
					" 1 Hr. "		468
					" 4 Hrs. "		316
					9 " "		264
					58 " "		210
					6-26-56 Shot third time with 700# Detonite from 1871 to 1886'; tamped with 10' Pea Gravel. Used time bomb set for 2 hours.		
					Test before shot:		208 MC
					Tests while cleaning out:		
					1 Hr. A.S.:		140 MC
					94 Hrs. "		175
					6-30-56 Ran 3 1/2" tubing with bottom set combination wall anchor packer set at 1908 ft.		
					Test before tubing (95 hrs. A.S.)		175 M
					Final Open Flow:		
					Berea Sand		177 MCF
					Well shut in in 3 1/2" tubing 100 hours after shot.		

02/02/2024

Date July 6, 1956

APPROVED OWENS, LIBBEY-OWENS GAS DEPARTMENT, Owner

By *A. H. Smith*
A. H. Smith (Title) Geologist



Salt water at 740'; settling sand; hole filling up.

Water at 320', 3 B.P.H.

Ran 8-5/8" casing on shoe at 262 ft.

Water at 90 ft.

Formation	Color	Hard or Soft	Top	Bottom	Oil, Gas or Water	Depth Found	Remarks
Clay & Mud	Blue	Soft	0	30			
Slate	Dark	Soft	30	40			
Sand	Light	-	40	48			
Sand	Grey	Soft	48	75			
Sand, Bro.	White	Soft	75	115			Water at 90 ft.
Sand	White	Soft	115	150			
Sand	Dark	-	150	160			
Slate	Black	-	160	162			
Coal	Black	-	162	162			
Slate	Grey	Soft	162	197			
Sand	Light	Soft	197	227			
Sand	Dark	Soft	227	235			
Slate	Light	Soft	235	245			
Sand, Bro.	White	Soft	245	277			Ran 8-5/8" casing on shoe at 262 ft.
Sand	Light	Soft	277	297			
Slate	Light	Soft	297	317			
Sand	Light	Soft	317	347			Water at 320', 3 B.P.H.
Slate	Dark	Soft	347	474			
Sand	Light	Soft	474	504			
Slate	Light	Soft	504	537			
Slate	Dark	Soft	537	567			
Sand	White	Med.	567	600			
Sand	Light	Soft	600	620			
Slate	Light	Soft	620	650			
Sand	White	Med.	650	808			Salt water at 740'; settling sand; hole filling up.
Sand	Light	Soft	808	810			
Break	Dark	Med.	810	868			
Sand	White	Med.	868	873			
Slate	Dark	Soft	873	924			
Sand	White	Hard	924	929			
Slate	Blue	Soft	929	949			
Slate	Dark	Soft	949	979			
Sand	White	Hard	979	999			
Slate	Dark	Soft	999	1044			
Sand	Light	Med.	1044	1065			
Slate	Dark	Soft	1065	1068			

Company Owens, Libbey-Owens Gas Department
 Address P. O. Box 4158, Charleston 4, W. Va.
 Farm G. W. Workman Est. 600 Acres
 Location (waters) 672.34 Elev
 Well No. 5 (Serial No. 958)
 District Butler County Wayne
 The surface of tract is owned in fee by
 Address Ed Workman
 Mineral rights are owned by Wayne, W. Va.
 Address 5-19-56
 Drilling commenced 6-21-56
 Drilling completed 3 times
 Date Shot (see remarks)
 Open Flow /10ths Water in Inch
 Volume Beresa Sand 177 M Cu. Ft.
 Rock Pressure 480 lbs.
 Oil 90, 320 feet
 Fresh water 740 feet
 Salt water feet

Oil or Gas Well (KIND)
 Gas

STATE OF WEST VIRGINIA
 DEPARTMENT OF MINES
 OIL AND GAS DIVISION 28
 WELL RECORD
 Permit No. Way-1015
 02/02/2024

Casing and Tubing	Used in Drilling	Left in Well	Packers	Kind of Packer	Comb. W. A.	Size of	Depth set	Perf. top	Perf. bottom	Liners Used
36" 3/4	36" 1/4	36" 1/4		3 3/8 x 7 x 16		1424'	1908'	1908'	1883-190	2
8 1/2 x 5/8	262' 6"	262' 6"		1808 - 1814		1424'	1908'	1908'	1883-190	3 1/2
10 3/4	36" 1/4	36" 1/4		1808 - 1814		1424'	1908'	1908'	1883-190	5 3/16
13	36" 1/4	36" 1/4		1808 - 1814		1424'	1908'	1908'	1883-190	8 1/2 x 5/8
16	36" 1/4	36" 1/4		1808 - 1814		1424'	1908'	1908'	1883-190	10 3/4
18	36" 1/4	36" 1/4		1808 - 1814		1424'	1908'	1908'	1883-190	13
20	36" 1/4	36" 1/4		1808 - 1814		1424'	1908'	1908'	1883-190	16
22	36" 1/4	36" 1/4		1808 - 1814		1424'	1908'	1908'	1883-190	18
24	36" 1/4	36" 1/4		1808 - 1814		1424'	1908'	1908'	1883-190	20
26	36" 1/4	36" 1/4		1808 - 1814		1424'	1908'	1908'	1883-190	22
28	36" 1/4	36" 1/4		1808 - 1814		1424'	1908'	1908'	1883-190	24
30	36" 1/4	36" 1/4		1808 - 1814		1424'	1908'	1908'	1883-190	26
32	36" 1/4	36" 1/4		1808 - 1814		1424'	1908'	1908'	1883-190	28
34	36" 1/4	36" 1/4		1808 - 1814		1424'	1908'	1908'	1883-190	30
36	36" 1/4	36" 1/4		1808 - 1814		1424'	1908'	1908'	1883-190	32
38	36" 1/4	36" 1/4		1808 - 1814		1424'	1908'	1908'	1883-190	34
40	36" 1/4	36" 1/4		1808 - 1814		1424'	1908'	1908'	1883-190	36
42	36" 1/4	36" 1/4		1808 - 1814		1424'	1908'	1908'	1883-190	38
44	36" 1/4	36" 1/4		1808 - 1814		1424'	1908'	1908'	1883-190	40
46	36" 1/4	36" 1/4		1808 - 1814		1424'	1908'	1908'	1883-190	42
48	36" 1/4	36" 1/4		1808 - 1814		1424'	1908'	1908'	1883-190	44
50	36" 1/4	36" 1/4		1808 - 1814		1424'	1908'	1908'	1883-190	46
52	36" 1/4	36" 1/4		1808 - 1814		1424'	1908'	1908'	1883-190	48
54	36" 1/4	36" 1/4		1808 - 1814		1424'	1908'	1908'	1883-190	50
56	36" 1/4	36" 1/4		1808 - 1814		1424'	1908'	1908'	1883-190	52
58	36" 1/4	36" 1/4		1808 - 1814		1424'	1908'	1908'	1883-190	54
60	36" 1/4	36" 1/4		1808 - 1814		1424'	1908'	1908'	1883-190	56
62	36" 1/4	36" 1/4		1808 - 1814		1424'	1908'	1908'	1883-190	58
64	36" 1/4	36" 1/4		1808 - 1814		1424'	1908'	1908'	1883-190	60
66	36" 1/4	36" 1/4		1808 - 1814		1424'	1908'	1908'	1883-190	62
68	36" 1/4	36" 1/4		1808 - 1814		1424'	1908'	1908'	1883-190	64
70	36" 1/4	36" 1/4		1808 - 1814		1424'	1908'	1908'	1883-190	66
72	36" 1/4	36" 1/4		1808 - 1814		1424'	1908'	1908'	1883-190	68
74	36" 1/4	36" 1/4		1808 - 1814		1424'	1908'	1908'	1883-190	70
76	36" 1/4	36" 1/4		1808 - 1814		1424'	1908'	1908'	1883-190	72
78	36" 1/4	36" 1/4		1808 - 1814		1424'	1908'	1908'	1883-190	74
80	36" 1/4	36" 1/4		1808 - 1814		1424'	1908'	1908'	1883-190	76
82	36" 1/4	36" 1/4		1808 - 1814		1424'	1908'	1908'	1883-190	78
84	36" 1/4	36" 1/4		1808 - 1814		1424'	1908'	1908'	1883-190	80
86	36" 1/4	36" 1/4		1808 - 1814		1424'	1908'	1908'	1883-190	82
88	36" 1/4	36" 1/4		1808 - 1814		1424'	1908'	1908'	1883-190	84
90	36" 1/4	36" 1/4		1808 - 1814		1424'	1908'	1908'	1883-190	86
92	36" 1/4	36" 1/4		1808 - 1814		1424'	1908'	1908'	1883-190	88
94	36" 1/4	36" 1/4		1808 - 1814		1424'	1908'	1908'	1883-190	90
96	36" 1/4	36" 1/4		1808 - 1814		1424'	1908'	1908'	1883-190	92
98	36" 1/4	36" 1/4		1808 - 1814		1424'	1908'	1908'	1883-190	94
100	36" 1/4	36" 1/4		1808 - 1814		1424'	1908'	1908'	1883-190	96



B-1

B-4

STATE OF WEST VIRGINIA
DEPARTMENT OF MINES
OIL AND GAS DIVISION

INSPECTOR'S WELL REPORT

Permit No. Way-1015

Oil or Gas Well _____
(KIND)

Company W. O. Gas Dept.
 Address Charleston, W. Va
 Farm G. W. Workman
 Well No. 5-SN-958
 District Butler County Wayne
 Drilling commenced 5-18-56
 Drilling completed _____ Total depth _____
 Date shot _____ Depth of shot _____
 Initial open flow _____ /10ths Water in _____ Inch
 Open flow after tubing _____ /10ths Merc. in _____ Inch
 Volume _____ Cu. Ft.
 Rock pressure _____ lbs. _____ hrs.
 Oil _____ bbls., 1st 24 hrs.
 Fresh water _____ feet _____ feet
 Salt water _____ feet _____ feet

CASING AND TUBING	USED IN DRILLING	LEFT IN WELL	PACKERS
Size			
16			Kind of Packer
13			
10	<u>34'</u>		Size of
8 1/4	<u>260'</u>		
6 5/8			Depth set
5 3/16			
3			Perf. top
2			Perf. bottom
Liners Used			Perf. top
			Perf. bottom

CASING CEMENTED _____ SIZE _____ No. FT. _____ Date _____
 COAL WAS ENCOUNTERED AT _____ FEET _____ INCHES
 _____ FEET _____ INCHES FEET _____ INCHES
 _____ FEET _____ INCHES FEET _____ INCHES

Drillers' Names Burgess Mills - Hawthorne Gray
Clifford Miller cont.
 Remarks: _____

5-28-56
DATE

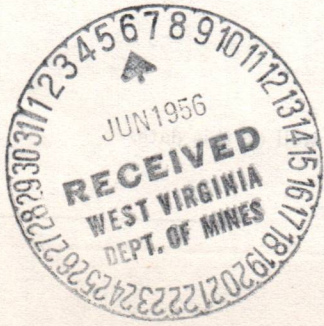

O. C. Allen

DISTRICT NO. 0210212024

STATE OF WEST VIRGINIA
DEPARTMENT OF MINES
OIL AND GAS DIVISION
INSPECTOR'S PLUGGING REPORT

Permit No. _____ Well No. _____

COMPANY _____ ADDRESS _____

FARM _____ DISTRICT _____ COUNTY _____

Filling Material Used _____

Liner Location Amount Packer Location

PLUGS USED AND DEPTH PLACED			BRIDGES	CASING AND TUBING		
CEMENT-THICKNESS	WOOD-SIZE	LEAD	CONSTRUCTION-LOCATION	RECOVERED	SIZE	LOST

Drillers' Names _____

Remarks: _____

_____ I hereby certify I visited the above well on this date.
DATE

_____ DISTRICT WELL INSPECTOR
02/02/2024

FERC-121

1.0 API well number: (If not available, leave blank. 14 digits.)	<u>47-099-1015</u>							
2.0 Type of determination being sought: (Use the codes found on the front of this form.)	<u>108</u> Section of NGPA	<u>NA</u> Category Code						
3.0 Depth of the deepest completion location: (Only needed if sections 103 or 107 in 2.0 above.)	<u>NA</u> feet							
4.0 Name, address and code number of applicant: (35 letters per line maximum. If code number not available, leave blank.)	<u>Industrial Gas Corporation</u> Name <u>P. O. Box 1473</u> Street <u>Charleston</u> <u>WV</u> <u>25325</u> City State Zip Code		<u>009283</u> Seller Code					
5.0 Location of this well: [Complete (a) or (b).] (a) For onshore wells (35 letters maximum for field name.)	<u>NA</u> Field Name <u>Wayne</u> County		<u>WV</u> State					
(b) For OCS wells:	<u>NA</u> Area Name	<u>NA</u> Block Number	Date of Lease: Mo. Day Yr. <u>NA</u> OCS Lease Number					
(c) Name and identification number of this well: (35 letters and digits maximum.)	<u>G. W. Workman 5-958</u>							
(d) If code 4 or 5 in 2.0 above, name of the reservoir: (35 letters maximum.)	<u>NA</u>							
6.0 (a) Name and code number of the purchaser: (35 letters and digits maximum. If code number not available, leave blank.)	<u>See Addendum "A"</u> <u>Houdaille Industries, Inc.</u> Name		<u>N/Available</u> Buyer Code					
(b) Date of the contract:	<u>1 2 2 6 7 3</u> Mo. Day Yr.							
(c) Estimated annual production:	<u>1.5</u> MMcf.							
	(a) Base Price (\$/MMBTU)	(b) Tax	(c) All Other Prices [Indicate (+) or (-).]	(d) Total of (a), (b) and (c)				
7.0 Contract price: <u>See Addendum "A"</u> (As of filing date. Complete to 3 decimal places.)	<u>1 2 8 3</u>	<u>0 0 5 1</u>	<u>0 0 0 3</u>	<u>1 3 3 6</u>				
8.0 Maximum lawful rate: (As of filing date. Complete to 3 decimal places.)	<u>2.2 4 3</u>	<u>0.3 0 2</u>	<u>0.0</u>	<u>2.5 4 5</u>				
9.0 Person responsible for this application:	<table border="1"> <tr> <td>Agency Use Only</td> <td rowspan="3"> <u>William C. Charlton</u> <u>Division Counsel</u> Name Title <u>William C. Charlton</u> Signature <u>02/28/79</u> <u>(304) 342-8166</u> Date Application is Completed Phone Number </td> </tr> <tr> <td>Date Received by Juris. Agency</td> </tr> <tr> <td>Date Received by FERC</td> </tr> </table>				Agency Use Only	<u>William C. Charlton</u> <u>Division Counsel</u> Name Title <u>William C. Charlton</u> Signature <u>02/28/79</u> <u>(304) 342-8166</u> Date Application is Completed Phone Number	Date Received by Juris. Agency	Date Received by FERC
Agency Use Only	<u>William C. Charlton</u> <u>Division Counsel</u> Name Title <u>William C. Charlton</u> Signature <u>02/28/79</u> <u>(304) 342-8166</u> Date Application is Completed Phone Number							
Date Received by Juris. Agency								
Date Received by FERC								

FT7900306/2-2

02/02/2024

WELL DETERMINATION REPORT

PARTICIPANTS: DATE: 001 10 1979 BUYER-SELLER CODE
WELL OPERATOR: Industrial Gas Corporation 009283
FIRST PURCHASER: Houdaille Industries, Inc.
OTHER:

W. Va. Department of Mines, Oil & Gas Division
WELL DETERMINATION FILE NUMBER
790228-108-099-1015
Use Above File Number on all Communications
Relating to Determination of this Well

Qualifies as Section 108. Plugger well
P. 108

CHECK EACH ITEM AS COMPLETE OR NOTE WHAT IS MISSING

ITEM NO.

- 1 FERC-121 Items not completed - Line No. _____
- 2 IV-1 - Agent William C. Charlton
- 3 IV-2 - Well Permit
- 4 IV-6 - Well Plat
- 5 IV-35- Well Record Drilling Deepening
- 6 IV-36- Gas-Oil Test: Gas Only Was Oil Produced? No Ratio _____
- 7 IV-39- Annual Production 2 years
- 8 IV-40- 90 day Production 87 Days off Line: _____
- 9 IV-48- Application for Certification. Complete?
- 10 - 17 IV Form #51 - 52 - 53 - 54 - 55 - 56 - 57 - 58. Complete Affidavit Signed
- 18 - 28 Other: Survey _____ Logs _____ Geological Charts _____ Structure Map _____
1:4000 Map _____ Well Tabulations _____ Gas Analyses _____
- (5) Date Commenced: 5-19-56
Date Drac: 6-21-56 (drilling) Deepened _____
- (5) Production Depth: 1873-1875, 1880, 1883,
- (5) Production Formation: Berea & slate & shells
- (5) Initial Potential: F.O.F.: 177 Mcf
- (5) Static R.P. after P. Drac: 480# - 36 hrs.
- (6) Other Gas Test: _____
- (7) Avg. Daily Gas from Annual Production: 3.5 Mcf (1288/366)
- (8) Avg. Daily Gas from 90-day ending w/1-120 days none within 120 days
- (8) Line Pressure: 36 PSIG from Daily Report
- (5) Oil Production: _____ From Completion Report _____ 02/02/2024
- (10-17) Does lease inventory indicate enhanced recovery being done: No
- (10-17) Is affidavit signed? Notarized?

Does official well rec: with the Department confirm the submitted information? Yes
Additional Information: _____ Does computer program confirm? _____
Was Determination Obsolete? to? _____ By Whom? _____

STATE OF WEST VIRGINIA
DEPARTMENT OF MINES, OIL AND GAS DIVISION

Date 02/28, 1979
Operator's Well No. 5-958
API Well No. 47 - 099 - 1015
State County Permit

WELL CLASSIFICATION FORM

STRIPPER GAS WELL
NGPA Section 108

DESIGNATED AGENT William C. Charlton

ADDRESS P. O. Box 1473
Charleston, WV 25325

WELL OPERATOR Industrial Gas Corporation LOCATION: Elevation 672.34'

ADDRESS P. O. Box 1473 Watershed Not Available
Charleston, WV 25325 Dist. Butler County Wayne Quad. Wayne

GAS PURCHASER * _____ Gas Purchase Contract No. * _____

ADDRESS _____ Meter Chart Code R0361

Date of Contract * _____

*See FERC-121 - Addendum "A"

* * * * *

Provide a complete inventory of the lease and production equipment used for the well for the previous 24 months or, if less than 24 months, the period the well has been in production. Include a complete list of equipment or processes used in connection with recognized enhanced recovery techniques during completion or production. (Attach separate sheets, if necessary.)

(See Attachment)

List all records reasonably available to you which contain information relevant to a determination of eligibility (including production records, B&O Tax Records and royalty payment records) and indicate the location of such records:

All records required to determine production by meter stations are maintained in Charleston, West Virginia.

B&O Tax Records are located in Charleston, West Virginia, our Boston, Massachusetts office and the Houston, Texas office.

Royalty payment instructions are located in Charleston, West Virginia office and Houston, Texas office.

02/02/2024

Describe the search made of any records listed above:

I have made a diligent search of the production records located in Charleston, West Virginia. They were the records utilized in making the determination herein.

Are you aware of any other information which would tend to be inconsistent with the information specified above? Yes No . If yes, indicate the type and source of the information.

AFFIDAVIT

I, Lawrence B. Mentzer, having been first sworn according to law, state that I have caused to be made a diligent search of those records hereinbefore indicated in the manner herein described, that the information contained in this document is true and accurate and that on the basis of the records and examinations hereinbefore described, and to the best of my information, knowledge and belief, the well for which this certification is sought qualifies as a stripper well.

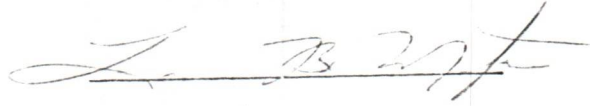

STATE OF WEST VIRGINIA,
COUNTY OF Kanawha, TO WIT:

I, Charlotte I. Mathews, a Notary Public in and for the state and county aforesaid, do certify that Lawrence B. Mentzer whose name is signed to the writing above, bearing date the 28 day of February, 19 79, has acknowledged the same before me, in my county aforesaid. Given under my hand and official seal this 28 day of February, 19 79. My term of office expires on the 5th day of December, 19 85.

02/02/2024

Charlotte I. Mathews
Notary Public

STATE OF WEST VIRGINIA
DEPARTMENT OF MINES, OIL AND GAS DIVISION

Date February 28, 19 79

Operator's Well No. 5-958

API Well No. 47 - 099 - 1015
State County Permit

Previous File No. NA
(If Applicable)

STATE APPLICATION FOR WELL CLASSIFICATION

WELL OPERATOR Industrial Gas Corporation

DESIGNATED AGENT William C. Charlton

ADDRESS P. O. Box 1473
Charleston, W. Va. 25325

ADDRESS P. O. Box 1473
Charleston, W. Va. 25325

Gas Purchase Contract No. * _____ and Date _____
(Month, day and year)

Meter Chart Code R0361

Name of First Purchaser * _____

(Street or P. O. Box)

(City)

(State)

(Zip Code)

FERC Seller Code 009283

FERC Buyer Code _____

TYPE OF DETERMINATION BEING SOUGHT:

- (1) Initial determination (See FERC Form 121.) Section of NGPA 108 Category Code NA
- (2) Determination that increased production is the result of enhanced recovery technology.
- (3) Determination of a seasonally affected well.

(*See FERC-121 Addendum "A")

William C. Charlton Division Counsel
Name (Print) Title

William C. Charlton
Signature

P. O. Box 1473
Street or P. O. Box

Charleston, W. Va. 25325
City State (Zip Code)

(304) 342-8166
Area Code Phone Number

Code

(Certificate of Proof of Service to Purchaser)

See Separate Certificate Attached

(All of the above to be completed by the Operator/Applicant)

(To be completed by Jurisdictional Agency. Executed copy to be returned to Operator/Applicant and purchaser, if known).

The Department of Mines has received a request, for certification of the above described well as meeting the requirements of Section _____ under the Natural Gas Policy Act of 1978. (NGPA); or for determination that increased production is the result of enhanced recovery technology under Section 108 of (NGPA); or for determination of a seasonally affected well under Section 108 of (NGPA)

All interested parties are hereby notified that on the _____ day of _____, 19____, at the office of the Oil and Gas Division in Charleston, West Virginia, or as soon thereafter as it may be heard, there will be a public hearing, if requested, or if objection is filed.

This Application is assigned File No. _____

Initial review of information submitted indicates the well is. is not entitled to certification as claimed under the Natural Gas Policy Act (NGPA). A review of this evidence and any additional evidence will be made at the time appointed for a public hearing or as soon thereafter as the matter may be heard.

Unless objections are timely filed or a request for a hearing is made within fifteen (15) days, a hearing will not be held except on ex parte motion of the department and the matter will go to determination.

WEST VIRGINIA DEPARTMENT OF MINES

Robert A. Hill
Director

Date received by _____
Jurisdictional Agency

By _____ Title _____ **02/02/2024**

FEB 28 1979

D-1
IV-39-WC

STATE OF WEST VIRGINIA
DEPARTMENT - MINES
DIVISION - OIL AND GAS

ANNUAL REPORT OF MONTHLY PRODUCTION-197A

GAS VOLUMES IN MFC @ 14.73
OIL IN BARRELS @ 60 DEGREES
Industrial Gas Corporation

REPORT NO. CCA101P1 PG. 000002
CURRENT DATE - 2/28/79
REPORT DATE - 2/28/79

API	FARM	Workman	5-958	COUNTY	Wayne	AVG. FLOW PRESSURE	23	SHUT-IN PRESSURE	NA	TOTALS
GAS MFC	81	99	69	84	65	50	93	59	79	902
OIL BBL	J-	F-	M-	M-	J-	J-	A-	0-	H-	OIL
DAYS ONLINE	30	34	27	32	28	18	37	28	32	355

1977

API	FARM	Workman	5-958	COUNTY	Wayne	AVG. FLOW PRESSURE	36	SHUT-IN PRESSURE	NA	TOTALS
GAS MFC	112	94	93	212	191	152	153	0	0	1288
OIL BBL	J-	F-	M-	M-	J-	J-	A-	0-	H-	OIL
DAYS ONLINE	36	27	28	32	30	30	31	27	30	366

1978

SUMMARIZATION SCHEDULE
Section 271. 804 (b)

In accordance with Section 271.804(b) please list all other wells which are to be used in determining this well classification under Part 271 Subpart H.

02/02/2024

API NUMBERS 47-099-0958; 47-099-0980; 47-099-1015; 47-099-1019; 47-099-1205; 47-099-1202

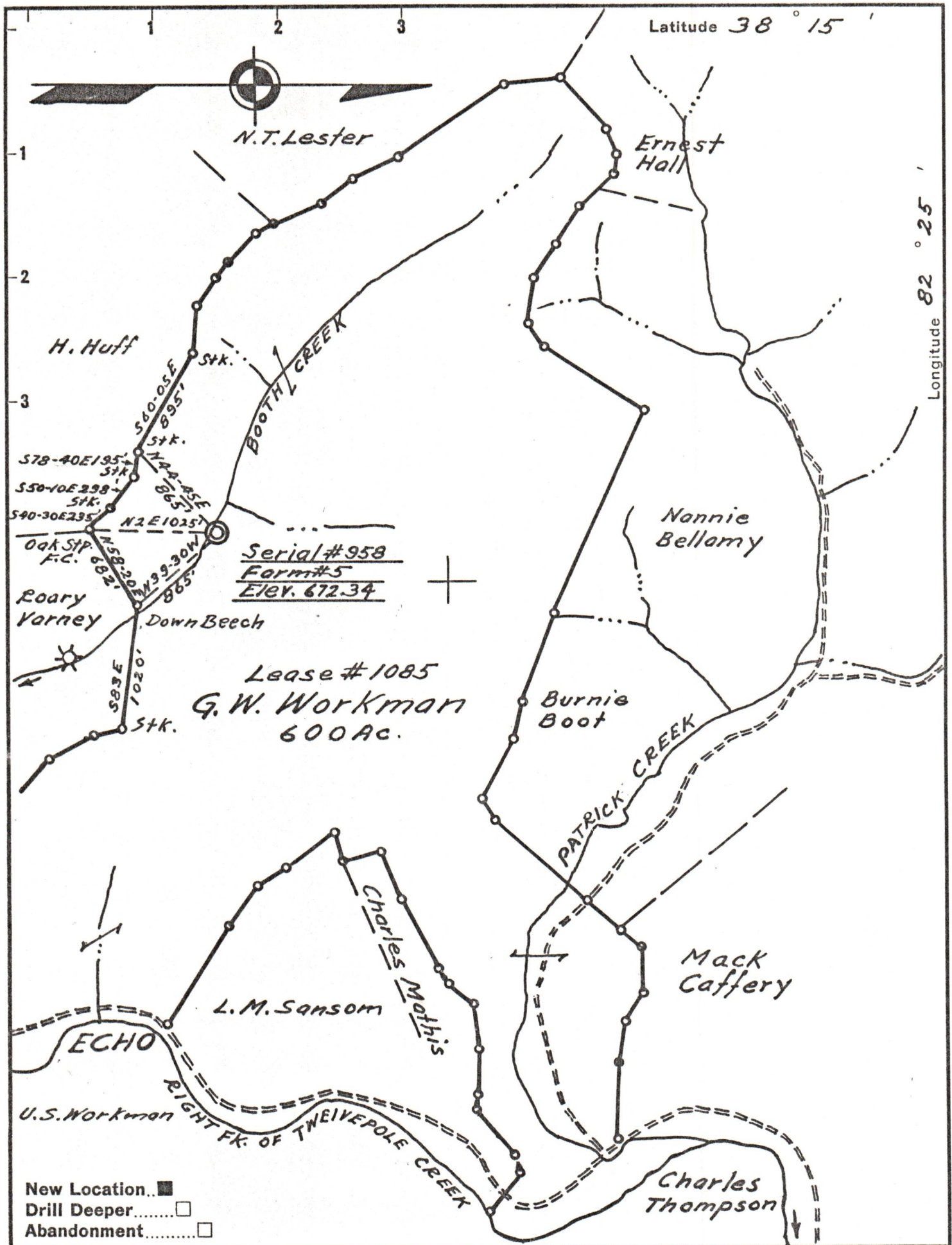

Company Owens, Libbey-Owens Gas Dept.

Address Box 4158 Charleston 4 W. Va.

Farm G. Workman

Tract _____ Acres 600 Lease No. 1085

Well (Farm) No. 5 Serial No. 958

Elevation (Spirit Level) 672.34

Quadrangle Wayne 354.58" N 3.98"

County Wayne District Butler

Engineer T. S. Flournoy

Engineer's Registration No. 269

File No. _____ Drawing No. _____

Date May 8, 1956 Scale 1" = 1000'

STATE OF WEST VIRGINIA
DEPARTMENT OF MINES
OIL AND GAS DIVISION
CHARLESTON

WELL LOCATION MAP

FILE NO. WAY-1015

02/02/2024

+ Denotes location of well on United States Topographic Maps, scale 1 to 62,500, latitude and longitude lines being represented by border lines as shown.

- Denotes one inch spaces on border line of original tracing.