



STATE OF WEST VIRGINIA
DEPARTMENT OF MINES
OIL AND GAS DIVISION

NOTICE OF PROPOSED LOCATION OF OIL AND GAS WELL

To THE DEPARTMENT OF MINES,
Charleston, W. Va.

| | |
|-----------------------------|--|
| None | Whites Ck. Production Co. |
| COAL OPERATOR OR COAL OWNER | NAME OF WELL OPERATOR |
| | %E. L. Lusher, Rt. 1, Kenova, W. Va |
| ADDRESS | COMPLETE ADDRESS |
| | Feb. 6, 19 54 |
| COAL OPERATOR OR COAL OWNER | PROPOSED LOCATION |
| | Ceredo District |
| ADDRESS | Wayne County |
| | Well No. 1 38° 15' |
| OWNER OF MINERAL RIGHTS | C R Varnum Farm 82° 30' |
| | |
| ADDRESS | |

GENTLEMEN:

The undersigned well operator is entitled to drill upon the above named farm or tract of land for oil and gas, having fee title thereto, (or as the case may be) under grant or lease dated 1-20-53 made by C R Varnum, to E L Lusher, and recorded on the _____ day of Not Yet Recorded, in the office of the County Clerk for said County in Book _____, page _____.

The enclosed plat was prepared by a competent engineer and shows the proposed location of a well to be drilled for oil and gas by the undersigned well operator on the farm and in the Magisterial District and County above named, determined by survey and courses and distances from two permanent points, or land marks.

The undersigned well operator is informed and believes there are no coal operators operating beds of coal beneath said farm or tract of land on which said well is located, or within 500 feet of the boundaries of the same, who have mapped their workings and filed their maps as required by law, excepting the coal operators or coal owners (if any) above named as addressees.

The above named coal operators or coal owners (if any) are notified that any objections they may desire to make to such proposed location, or which they are required to make by Section 3 of said Code, if the drilling of a well at said proposed location will cause a dangerous condition in or about their respective coal mines, must be received by, or filed with the Department of Mines within ten* days from the receipt of a copy of this notice and accompanying plat by said Department. Said coal operators are further notified that forms for use in making such objections will be furnished to them by the Department of Mines promptly on request and that all such objections must set forth as definitely as is reasonably possible the ground or grounds on which such objections are based and indicate the direction and distance the proposed location should be moved to overcome same.

(The next paragraph is to be completed only in Department's copy.)

Copies of this notice and the enclosed plat were mailed by registered mail, or delivered to the above named coal operators or coal owners at their above shown respective address _____ day _____ before, or on the same day with the mailing or delivery of this copy to the Department of Mines at Charleston, West Virginia.

Very truly yours,

Whites Ck. Production Co.

WELL OPERATOR
%E L Lusher, Rt. 1, Kenova W Va.

Address of Well Operator }

STREET

CITY OR TOWN

02/09/2024

STATE

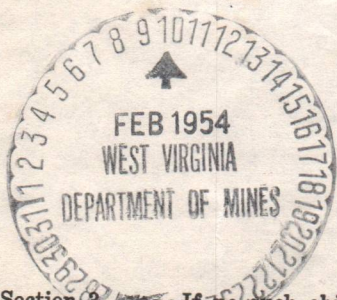

*Section 3. If no such objections be filed or be found by the department of mines, within said period of ten days from the receipt of said notice and plat by the department of mines, to said proposed location, the department shall forthwith issue to the well operator a drilling permit reciting the filing of such plat, that no objections have been made by the coal operators to the location, or found thereto by the department, and that the same is approved and the well operator authorized to proceed to drill at said location.

909
February 10, 1954

Mr. George H. Hall, Engineer
Southeastern Gas Company
P. O. Box 2387
Charleston, West Virginia

Dear Mr. Hall:

We are returning tracing for well location No. 1 on the C. R. Varnum Tract, Ceredo District, Wayne County for additional information.

The courses and distances immediately adjoining the permanent landmark on the northwest corner, should be given and the names of all the property owners on adjoining tracts. The information on Latitude seems to be incorrect in accordance with the position of the "cross" and believe this should be 38 degrees, 20 minutes.

Please return to us as soon as possible.

Very truly yours,

Administrative Assistant
OIL AND GAS DIVISION

MG:g

02/09/2024

February 20, 1954

Whites Creek Production Company
c/o Mr E. L. Lusher
Route 1
Kenova, West Virginia

Gentlemen:

Enclosed is permit WAY-909 to drill Well
No. 1 on the C. R. Varnum Farm, Ceredo District,
Wayne County.

Very truly yours,

Administrative Assistant
OIL AND GAS DIVISION

CNH:K
Encl-2

CC: Inspector O. C. Allen

02/09/2024

| Formation | Color | Hard or Soft | Top 3 | Bottom | Oil, Gas or Water | Depth Found | Remarks |
|-------------|---------|--------------|-----------|-----------|-------------------|-------------|---------|
| White Shale | | | 2,285 ft. | 2,320 ft. | | | |
| Brown Shale | (Light) | | 2,320 ft. | 2,350 ft. | | | |
| Brown Shale | (Dark) | | 2,350 ft. | 2,715 ft. | | | |
| White Slate | | | 2,715 ft. | 2,891 ft. | | | |
| Brown Shale | | | 2,891 ft. | 2,922 ft. | | | |
| Total Depth | | | | 2,922 ft. | | | |

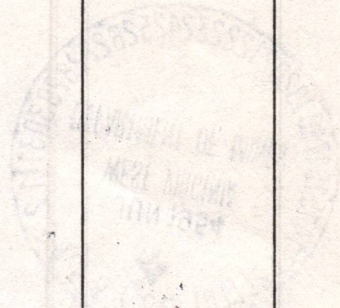

02/09/2024

Date June 7, 1954

APPROVED _____, Owner

By Luther Fusher
(Title) partner



STATE OF WEST VIRGINIA
DEPARTMENT OF MINES
OIL AND GAS DIVISION 3

WELL RECORD

Permit No. **WAV-909**

Cards

4202/60/20

Company Whites Creek Production Co.

Address Route 1, Kenova, W. Va.

Farm C. R. Varnum

Acres 125

Location (waters) Rice Branch

Well No. 1

Elev. 572'

District Ceredo

County Wayne

The surface of tract is owned in fee by C. R. Varnum

Address Huntington, W. Va.

Mineral rights are owned by C. R. Varnum

Address Huntington, W. Va.

Drilling commenced March 9, 1954

Drilling completed May 21, 1954

Date Shot May 23

From 2,315 To 2,715

With 4,000 lbs. Dupont gelatin

Open Flow 7/10ths Water in one

Volume Cu. Ft.

Rock Pressure lbs. 400

Oil bbls., 1st 24 hrs. 180

Fresh water feet 992

Salt water feet 2,025

Oil or Gas Well **Gas** (KIND)

| Casing and Tubing | Used in Drilling | Left in Well | Packers |
|-------------------|------------------|--------------|--------------|
| 16 | | | |
| 13 | Wood Conductor | 16 ft. | |
| 10 | 1 1/2 in. 9 in. | 143' 9" | |
| | 8 1/2 in. 1,239' | Pulled | |
| | 6 1/2 in. 1,966' | 3" 1,966' | |
| | | 5" Depth set | |
| | | | Perf. top |
| | | | Perf. bottom |
| | | | Liners Used |
| | | | Perf. top |
| | | | Perf. bottom |

CASING CEMENTED SIZE No. Ft. Date

COAL WAS ENCOUNTERED AT FEET INCHES

FEET INCHES

FEET INCHES

Remarks

| Formation | Color | Hard or Soft | Top | Bottom | Oil, Gas or Water | Depth Found | Remarks |
|----------------------|-------|--------------|-----------|-----------|-------------------|-------------|---------|
| Surface Blue Mud | | | 16 ft. | 16 ft. | | | |
| Slate | | | 25 ft. | 25 ft. | | | |
| Sand | | | 32 ft. | 131 ft. | | | |
| Slate | | | 131 ft. | 150 ft. | | | |
| Broken Sand | | | 150 ft. | 170 ft. | | | |
| Sand | | | 170 ft. | 206 ft. | | | |
| Broken Sand | | | 206 ft. | 230 ft. | | | |
| Slate | | | 230 ft. | 235 ft. | | | |
| Sand | | | 235 ft. | 344 ft. | | | |
| White Slate | | | 344 ft. | 375 ft. | | | |
| Sand | | | 375 ft. | 421 ft. | | | |
| Slate | | | 421 ft. | 438 ft. | | | |
| Sand | | | 438 ft. | 487 ft. | | | |
| Slate | | | 487 ft. | 495 ft. | | | |
| Broken Sand | | | 495 ft. | 502 ft. | | | |
| Slate | | | 502 ft. | 545 ft. | | | |
| Sand | | | 545 ft. | 585 ft. | | | |
| Slate & Shells | | | 585 ft. | 645 ft. | | | |
| Sand | | | 645 ft. | 680 ft. | | | |
| Slate | | | 680 ft. | 880 ft. | | | |
| Salt Sand | | | 880 ft. | 1,082 ft. | | | |
| Slate | | | 1,082 ft. | 1,102 ft. | | | |
| Maxton Sand | | | 1,102 ft. | 1,230 ft. | | | |
| Big Lime | | | 1,230 ft. | 1,320 ft. | | | |
| Kenner Sand (Broken) | | | 1,320 ft. | 1,345 ft. | | | |
| Injun Sand (Broken) | | | 1,345 ft. | 1,425 ft. | | | |
| Slate | | | 1,425 ft. | 1,435 ft. | | | |
| Broken Sand | | | 1,435 ft. | 1,460 ft. | | | |
| Slate | | | 1,460 ft. | 1,898 ft. | | | |
| Coffee Shale | | | 1,898 ft. | 1,928 ft. | | | |
| Berea Grit | | | 1,928 ft. | 1,954 ft. | | | |
| Slate | | | 1,954 ft. | 1,965 ft. | | | |
| Shells | | | 1,965 ft. | 1,996 ft. | | | |
| Slate | | | 1,996 ft. | 2,025 ft. | | | |
| Brown Shale | | | 2,025 ft. | 2,138 ft. | | | |
| White Slate | | | 2,138 ft. | 2,240 ft. | | | |
| Brown Shale | | | 2,240 ft. | 2,285 ft. | | | |

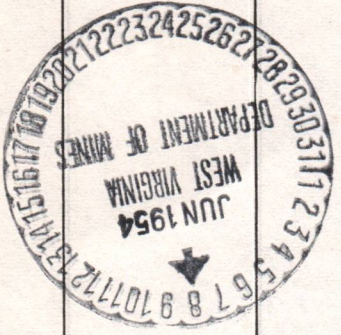

(Over)



STATE OF WEST VIRGINIA
DEPARTMENT OF MINES
OIL AND GAS DIVISION

WELL RECORD

Quadrant **4202/60/20**
Ceredo

Permit No. **WV-909**

Company **Whites Creek Production Company**

Address **RFD #1 - Kenova, W. Va.**

Farm **C. R. Varnum**

Location (waters) **Rich Branch**

Well No. **1**

Elev. **572'**

District **Ceredo**

County **Wayne**

The surface of tract is owned in fee by **C. R. Varnum**

Huntington, W. Va. Address **Same**

Mineral rights are owned by **Same**

Address **March 9, 1954**

Drilling commenced **May 21, 1954**

Date Shot **5/23/54**

From **2315'** To **2715'**

With **4000 lbs. Dupont gelatin**

Open Flow **7** /10ths Water in Inch

Volume **400** lbs. hrs.

Rock Pressure **48** hrs.

Oil **57** feet

Fresh water **180** feet

Salt water **1025** feet

Formation **Surf. Mud**

Blue Mud

Slate

Sand

Slate

Broken Sand

Sand

Broken Sand

Slate

White Slate

Sand

Sand

Slate

Broken Sand

Sand

Slate & Shell

Sand

Salt Sand

Slate

MAXTON Sand

BIG LIME

Keener Sand (Broken)

Injun Sand (Broken)

Slate

Broken Sand

Slate

Coffee Shale

BERRA GRIT

Slate

Shells

Slate

Brown Shale

White Slate

Oil or Gas Well **Gas**

Packers **Left in Well**

Used in Drilling **Conductor**

Casing and Tubing **Wood**

Size **16**

Kind of Packer **16**

Left in Well **16**

Size of **1 1/2" x 9"**

Depth set **1966'**

Perf. top **5/3/16**

Perf. bottom **3**

Perf. top **2**

Perf. bottom **2**

Liners Used

Perf. top

Perf. bottom

Perf. top

Perf. bottom

Open Flow **7** /10ths Water in Inch

Volume **400** lbs. hrs.

Rock Pressure **48** hrs.

Oil **57** feet

Fresh water **180** feet

Salt water **1025** feet

Formation **Surf. Mud**

Blue Mud

Slate

Sand

Slate

Broken Sand

Sand

Broken Sand

Slate

White Slate

Sand

Sand

Slate & Shell

Sand

Salt Sand

Slate

MAXTON Sand

BIG LIME

Keener Sand (Broken)

Injun Sand (Broken)

Slate

Broken Sand

Slate

Coffee Shale

BERRA GRIT

Slate

Shells

Slate

Brown Shale

White Slate



Brown Shale 2240-2285
Shale & Slate 2285 - 2922
Total Depth 2922

(Over)

STATE OF WEST VIRGINIA
DEPARTMENT OF MINES
OIL AND GAS DIVISION

INSPECTOR'S WELL REPORT

Permit No. May-909

Oil or Gas Well _____
(KIND)

Company Whites Creek Production Co.

Address % E.L. Lusher R#1, Kinross

Farm O.K. Varnum

Well No. 1

District Curdo County Wayne

Drilling commenced _____

Drilling completed _____ Total depth _____

Date shot _____ Depth of shot _____

Initial open flow _____ /10ths Water in _____ Inch

Open flow after tubing _____ /10ths Merc. in _____ Inch

Volume _____ Cu. Ft.

Rock pressure _____ lbs. _____ hrs.

Oil _____ bbls., 1st 24 hrs.

Fresh water _____ feet _____ feet

Salt water _____ feet _____ feet

| CASING AND TUBING | USED IN DRILLING | LEFT IN WELL | PACKERS |
|-------------------|------------------|--------------|----------------------|
| 19 7/8 | | | Kind of Packer _____ |
| 16 | | | Size of _____ |
| 13 | | | Depth set _____ |
| 10 | | | Perf. top _____ |
| 8 1/4 | | | Perf. bottom _____ |
| 6 5/8 | | | Perf. top _____ |
| 5 3/16 | | | Perf. bottom _____ |
| 3 | | | |
| 2 | | | |
| Liners Used | | | |

CASING CEMENTED _____ SIZE _____ No. FT. _____ Date _____

COAL WAS ENCOUNTERED AT _____ FEET _____ INCHES

_____ FEET _____ INCHES FEET _____ INCHES

_____ FEET _____ INCHES FEET _____ INCHES

Drillers' Names E.L. Lusher, Contractor

Remarks: Rigging up.

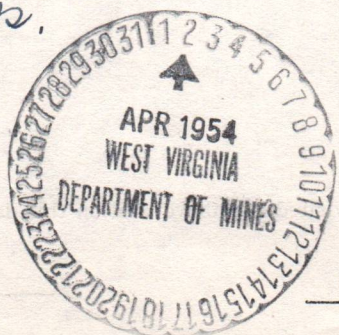

3-2-54

DATE

O.C. Allen

DISTRICT WELL INSPECTOR

02/09/2024

STATE OF WEST VIRGINIA
DEPARTMENT OF MINES
OIL AND GAS DIVISION

INSPECTOR'S WELL REPORT

Permit No. _____

Oil or Gas Well _____
(KIND)

| Company _____ Address _____ Farm _____ Well No. _____ District _____ County _____ Drilling commenced _____ Drilling completed _____ Total depth _____ Date shot _____ Depth of shot _____ Initial open flow _____ /10ths Water in _____ Inch Open flow after tubing _____ /10ths Merc. in _____ Inch Volume _____ Cu. Ft. Rock pressure _____ lbs. _____ hrs. Oil _____ bbls., 1st 24 hrs. Fresh water _____ feet _____ feet Salt water _____ feet _____ feet | CASING AND TUBING | USED IN DRILLING | LEFT IN WELL | PACKERS |
|---|---|------------------|--------------|----------------------|
| | Size | | | Kind of Packer _____ |
| | 16 | | | |
| | 13 | | | |
| | 10 | | | Size of _____ |
| | 8 1/4 | | | |
| | 6 5/8 | | | Depth set _____ |
| | 5 3/16 | | | |
| | 3 | | | Perf. top _____ |
| | 2 | | | Perf. bottom _____ |
| | Liners Used | | | Perf. top _____ |
| | | | | Perf. bottom _____ |
| | CASING CEMENTED _____ SIZE _____ No. FT. _____ Date _____ | | | |
| | COAL WAS ENCOUNTERED AT _____ FEET _____ INCHES | | | |
| | _____ FEET _____ INCHES _____ FEET _____ INCHES | | | |
| | _____ FEET _____ INCHES _____ FEET _____ INCHES | | | |

Drillers' Names _____

Remarks: _____

DATE _____

DISTRICT WELL INSPECTOR _____
02/09/2024

STATE OF WEST VIRGINIA
DEPARTMENT OF MINES
OIL AND GAS DIVISION

INSPECTOR'S WELL REPORT

Permit No. _____

Oil or Gas Well _____
(KIND)

| | | CASING AND TUBING | USED IN DRILLING | LEFT IN WELL | PACKERS |
|---|--|---|------------------|--------------|----------------------|
| Company _____ | | Size | | | Kind of Packer _____ |
| Address _____ | | 16 | | | |
| Farm _____ | | 13 | | | |
| Well No. _____ | | 10 | | | Size of _____ |
| District _____ County _____ | | 8 1/4 | | | |
| Drilling commenced _____ | | 6 5/8 | | | Depth set _____ |
| Drilling completed _____ Total depth _____ | | 5 3/16 | | | |
| Date shot _____ Depth of shot _____ | | 3 | | | Perf. top _____ |
| Initial open flow _____ /10ths Water in _____ Inch | | 2 | | | Perf. bottom _____ |
| Open flow after tubing _____ /10ths Merc. in _____ Inch | | Liners Used | | | Perf. top _____ |
| Volume _____ Cu. Ft. | | | | | Perf. bottom _____ |
| Rock pressure _____ lbs. _____ hrs. | | CASING CEMENTED _____ SIZE _____ No. FT. _____ Date _____ | | | |
| Oil _____ bbls., 1st 24 hrs. | | COAL WAS ENCOUNTERED AT _____ FEET _____ INCHES | | | |
| Fresh water _____ feet _____ feet | | _____ FEET _____ INCHES _____ FEET _____ INCHES | | | |
| Salt water _____ feet _____ feet | | _____ FEET _____ INCHES _____ FEET _____ INCHES | | | |

Drillers' Names _____

Remarks: _____

STATE OF WEST VIRGINIA
DEPARTMENT OF MINES
OIL AND GAS DIVISION

INSPECTOR'S WELL REPORT

Permit No. _____

Oil or Gas Well _____
(KIND)

| | | CASING AND TUBING | USED IN DRILLING | LEFT IN WELL | PACKERS |
|---|--|---|------------------|--------------|----------------------|
| Company _____ | | Size | | | |
| Address _____ | | 16 | | | Kind of Packer _____ |
| Farm _____ | | 13 | | | |
| Well No. _____ | | 10 | | | Size of _____ |
| District _____ County _____ | | 8 1/4 | | | |
| Drilling commenced _____ | | 6 5/8 | | | Depth set _____ |
| Drilling completed _____ Total depth _____ | | 5 3/16 | | | |
| Date shot _____ Depth of shot _____ | | 3 | | | Perf. top _____ |
| Initial open flow _____ /10ths Water in _____ Inch | | 2 | | | Perf. bottom _____ |
| Open flow after tubing _____ /10ths Merc. in _____ Inch | | Liners Used | | | Perf. top _____ |
| Volume _____ Cu. Ft. | | | | | Perf. bottom _____ |
| Rock pressure _____ lbs. _____ hrs. | | CASING CEMENTED _____ SIZE _____ No. FT. _____ Date _____ | | | |
| Oil _____ bbls., 1st 24 hrs. | | COAL WAS ENCOUNTERED AT _____ FEET _____ INCHES | | | |
| Fresh water _____ feet _____ feet | | _____ FEET _____ INCHES _____ FEET _____ INCHES | | | |
| Salt water _____ feet _____ feet | | _____ FEET _____ INCHES _____ FEET _____ INCHES | | | |

Drillers' Names _____

Remarks:

DATE

DISTRICT WELL INSPECTOR

02/09/2024

STATE OF WEST VIRGINIA
DEPARTMENT OF MINES
OIL AND GAS DIVISION

INSPECTOR'S WELL REPORT

Permit No. _____

Oil or Gas Well _____
(KIND)

| | | CASING AND TUBING | USED IN DRILLING | LEFT IN WELL | PACKERS |
|---|--|---|------------------|--------------|----------------------|
| Company _____ | | Size | | | |
| Address _____ | | 16 | | | Kind of Packer _____ |
| Farm _____ | | 13 | | | |
| Well No. _____ | | 10 | | | Size of _____ |
| District _____ County _____ | | 8 1/4 | | | |
| Drilling commenced _____ | | 6 5/8 | | | Depth set _____ |
| Drilling completed _____ Total depth _____ | | 5 3/16 | | | |
| Date shot _____ Depth of shot _____ | | 3 | | | Perf. top _____ |
| Initial open flow _____ /10ths Water in _____ Inch | | 2 | | | Perf. bottom _____ |
| Open flow after tubing _____ /10ths Merc. in _____ Inch | | Liners Used | | | Perf. top _____ |
| | | | | | Perf. bottom _____ |
| Volume _____ Cu. Ft. | | CASING CEMENTED _____ SIZE _____ No. FT. _____ Date _____ | | | |
| Rock pressure _____ lbs. _____ hrs. | | | | | |
| Oil _____ bbls., 1st 24 hrs. | | COAL WAS ENCOUNTERED AT _____ FEET _____ INCHES | | | |
| Fresh water _____ feet _____ feet | | _____ FEET _____ INCHES _____ FEET _____ INCHES | | | |
| Salt water _____ feet _____ feet | | _____ FEET _____ INCHES _____ FEET _____ INCHES | | | |

Drillers' Names _____

Remarks: _____

DATE _____

DISTRICT _____ DATE 02/09/2024

PROPOSED MANNER OF PLUGGING AND FILLING WELL

(REQUIRED BY RULES AND REGULATIONS)

WEST VIRGINIA DEPARTMENT OF MINES
OIL AND GAS DIVISION
WORK ORDER

Well to be plugged and filled as follows:

WORK ORDER PREPARED BY THE DEPARTMENT OF MINES

Total Depth 2922' -- Well shot from 2315 to 2715'

SET A PERMANENT BRIDGE AT 2000' - 35' below 6-5/8" casing
and above shot hole
2 sacks neat cement and 5' crushed stone on bridge

PULL 6-5/8" CASING AS HOLE IS FILLED AND PLUGGED

Fill with clay from bridge to 1850'

Neat Cement 1850' - 1840'

5' crushed stone on cement plug - sealing off Berea Sand

SET A PERMANENT BRIDGE AT 1400' - bottom of Big Injun

2 sacks neat cement and 5' crushed stone on bridge

Fill with clay to 1230' - top of Big Lime

Neat Cement 1230' - 1220'

5' crushed stone on cement plug - sealing hole completely below Big Lime

SET A PERMANENT BRIDGE AT 1080' - a point in the Salt Sands

2 sacks neat cement and 5' crushed stone on bridge

Fill with clay to 900' - a point above all salt water

Neat Cement 900' - ~~890'~~

5' crushed stone on cement plug - sealing off all salt water

Pull balance of 6-5/8" casing

SET A PERMANENT BRIDGE AT 250'

2 sacks neat cement and 5' crushed stone on bridge

Pull 10" casing and

Fill with clay to surface

Erect marker such as is described in Rule 18, 1931 Regulations

To the Department of Mines
Coal Owner or Operator,
Lease or Property Owner.

Gentlemen:

This "work order" is submitted for your approval and concurrence and unless notified of your disapproval or non-concurrence, the undersigned will proceed with the plugging and filling of said well in the above described manner on the date stated in the notice of intention to plug and abandon the said well on opposite side of this sheet.

Very truly yours,

Well Operator.

No objections have been filed by the coal owner or coal operator, or any available adjacent lease or property owners or interposed by the Department of Mines to the manner herein described for the plugging and filling of the well above mentioned. Therefore, the same is hereby approved this

11th day of JANUARY, 1956, 19

DEPARTMENT OF MINES
Oil and Gas Division

By: C. N. Hall

NOTE: This "work order" shall be filed in triplicate, one copy for the files of the Department of Mines; one to be approved or corrected and returned to the well operator as his authority for plugging said well; and one for the well inspector.

02/09/2024



STATE OF WEST VIRGINIA
DEPARTMENT OF MINES
OIL AND GAS DIVISION

NOTICE OF INTENTION TO PLUG AND ABANDON WELL

(REQUIRED BY SECTION 9, ARTICLE 4, CHAPTER 22 OF THE CODE)

To THE DEPARTMENT OF MINES,
Charleston, W. Va.

Coal Operator or Coal Owner
Address

WHITE CREEK PRODUCTION COMPANY

Name of Well Operator
c/o Luther Lusher
RFD #1 - Barboursville, W. Va.
Complete Address

Coal Operator or Coal Owner
Address

JANUARY 11, 1956 19

WELL TO BE ABANDONED

CEREDO District

WAYNE County

Lease or Property Owner
Address

Well No. 1
C. R. VARNUM Farm

Inspector to be notified O. C. ALLEN - TELEPHONE WAYNE 89-J

24 HOURS IN ADVANCE OF PLUGGING DATE

Gentlemen:—

The undersigned well operator is about to abandon the above described well and will commence the work of plugging and abandoning said well on the date inspector is notified (which date shall not be less than five days after the day on which this notice so mailed is received, or in due course should be received by the Department of Mines).

This notice is given you in order that your respective representatives may be present at the plugging and filling of said well. You are further notified that whether you are represented or not represented the undersigned will proceed on that date, or shortly thereafter, to plug and fill said well in the manner required by Section 10, Article 4, Chapter 22 of the Code and given in detail on the reverse side of this notice, in "Work Order."

This notice is being mailed by registered mail to each of you at the above addresses on the above date.

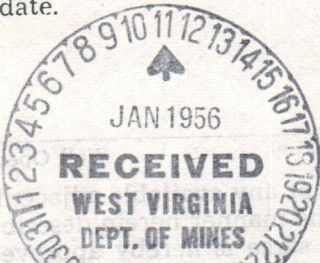

Very truly yours,

Luther Lusher

Well Operator.

NOTE: Upon the abandonment of all wells drilled prior to June 1, 1929, a plat prepared by a registered engineer, showing the district and county in which the tract of land is located, the name and acreage of same, the names of the owners and adjacent tracts, and the location of the about to be abandoned well, determined by survey, and the courses and distances of such well from two permanent points or landmarks on said tract, shall be submitted with this notice.

NOTE: In case plugging is not commenced within four months from the above date, this permit shall expire and be of no further force or effect.

WAY-909-P

PERMIT NUMBER

(over)

02/09/2024

STATE OF WEST VIRGINIA
DEPARTMENT OF MINES
OIL AND GAS DIVISION

AFFIDAVIT OF PLUGGING AND FILLING WELL

AFFIDAVIT SHOULD BE MADE IN TRIPPLICATE, ONE COPY MAILED TO THE DEPARTMENT, ONE COPY TO BE RETAINED BY THE WELL OPERATOR AND THE THIRD COPY (AND EXTRA COPIES IF REQUIRED) SHOULD BE MAILED TO EACH COAL OPERATOR AT THEIR RESPECTIVE ADDRESSES.

| | | |
|--------------------------------------|--------------------------------------|-----------------------|
| COAL OPERATOR OR OWNER | White Creek Production Co. | NAME OF WELL OPERATOR |
| ADDRESS | Luther Lusher-- Barboursville, W.Va. | COMPLETE ADDRESS |
| COAL OPERATOR OR OWNER | February 21 1956 | WELL AND LOCATION |
| ADDRESS | Ceredo | District |
| LEASE OR PROPERTY OWNER | Wayne | County |
| ADDRESS | Well No. 1 | |
| | C. R. Varnum | Farm |
| STATE INSPECTOR SUPERVISING PLUGGING | D. C. Allen | |

AFFIDAVIT

STATE OF WEST VIRGINIA,

County of Cabell

SS:

H. J. Woodall

and

Ralph Kirtley

being first duly sworn according to law depose and say that they are experienced in the work of plugging and filling oil and gas wells and were employed by Luther Lusher, well operator, and participated in the work of plugging and filling the above well, that said work was commenced on the 12 day of January, 1956, and that the well was plugged and filled in the following manner:

| SAND OR ZONE RECORD | FILLING MATERIAL | | PLUGS USED | CASING | |
|---------------------|------------------|-------|------------|---------------|------------|
| | FORMATION | | | SIZE & KIND | CSG PULLED |
| | Set Bridge At | 2050' | | | |
| | Clay | 2050' | 2000' | 6 5/8" Casing | 1983' |
| | Cement | 2000' | 1990' | 10" Casing | 147' |
| | Stone | 1990' | 1985' | | |
| | Clay | 1985' | 1850' | | |
| | Cement | 1850' | 1840' | | |
| | Stone | 1840' | 1835' | | |
| | Set Bridge At | 1400' | | | |
| | Cement | 1400' | 1390' | | |
| | Stone | 1390' | 1385' | | |
| | Clay | 1385' | 1230' | | |
| | Cement | 1220' | 1220' | | |
| | Stone | 1220' | 1215' | | |
| | Set Bridge At | 1080' | | | |
| | Cement | 1080' | 1075' | | |
| | Stone | 1075' | 1070' | | |
| | Clay | 1070' | 900' | | |
| | Cement | 900' | 890' | | |
| (NAME) | Stone | 890' | 885' | | |
| (NAME) | Cement | 250' | 245' | | |
| (NAME) | Clay | 245' | 0' | | |

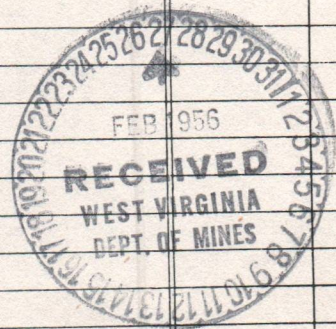

DESCRIPTION OF MONUMENT
Erected Cement Marker 30" Above Surface With Inscription W.C.P. Co. Well # 1 A B W 2 - 21 - 56

and that the work of plugging and filling said well was completed on the 21 day of February, 1956.

And further deponents saith not.

Sworn to and subscribed before me this 25th day of February, 1956.

H. J. Woodall
Ralph Kirtley
Ellen B. Sorlage
Notary Public.

My commission expires: My Commission Expires June 4, 1962

Permit No. May 909 P

AFFIDAVIT OF PLUGGING AND FILLING WELL

ATTORNEY SHOULD BE MADE IN TRIPlicate. THE ORIGINAL SHOULD BE FILED IN THE OFFICE OF THE REGISTER AND THE OTHER COPIES SHOULD BE FILED IN THE OFFICE OF THE COUNTY CLERK OF THE COUNTY WHERE THE WELL IS LOCATED.

Walter Jones, Registrar

John Jones, Jr., Plaintiff

County of Cabell, West Virginia

County of Cabell, West Virginia

County of Cabell, West Virginia

Well No. 1

County of Cabell, West Virginia

J. G. Allen

AFFIDAVIT

STATE OF WEST VIRGINIA

County of Cabell

J. J. Woodall

I, J. J. Woodall, being first duly sworn, according to law sworn and say that I am a resident in the County of Cabell, State of West Virginia, and was employed by John Jones, Jr., Plaintiff, and participated in the work of plugging and filling the above well, that said well was plugged on the 12 day of January, 1935, and that the well was plugged and filled in the following manner:

| Depth on logs | Material used | Remarks |
|---------------|---------------|----------------|
| 0 to 10' | Clay | Set surface at |
| 10 to 15' | Clay | |
| 15 to 20' | Clay | |
| 20 to 25' | Clay | |
| 25 to 30' | Clay | |
| 30 to 35' | Clay | |
| 35 to 40' | Clay | |
| 40 to 45' | Clay | |
| 45 to 50' | Clay | |
| 50 to 55' | Clay | |
| 55 to 60' | Clay | |
| 60 to 65' | Clay | |
| 65 to 70' | Clay | |
| 70 to 75' | Clay | |
| 75 to 80' | Clay | |
| 80 to 85' | Clay | |
| 85 to 90' | Clay | |
| 90 to 95' | Clay | |
| 95 to 100' | Clay | |
| 100 to 105' | Clay | |
| 105 to 110' | Clay | |
| 110 to 115' | Clay | |
| 115 to 120' | Clay | |
| 120 to 125' | Clay | |
| 125 to 130' | Clay | |
| 130 to 135' | Clay | |
| 135 to 140' | Clay | |
| 140 to 145' | Clay | |
| 145 to 150' | Clay | |
| 150 to 155' | Clay | |
| 155 to 160' | Clay | |
| 160 to 165' | Clay | |
| 165 to 170' | Clay | |
| 170 to 175' | Clay | |
| 175 to 180' | Clay | |
| 180 to 185' | Clay | |
| 185 to 190' | Clay | |
| 190 to 195' | Clay | |
| 195 to 200' | Clay | |
| 200 to 205' | Clay | |
| 205 to 210' | Clay | |
| 210 to 215' | Clay | |
| 215 to 220' | Clay | |
| 220 to 225' | Clay | |
| 225 to 230' | Clay | |
| 230 to 235' | Clay | |
| 235 to 240' | Clay | |
| 240 to 245' | Clay | |
| 245 to 250' | Clay | |
| 250 to 255' | Clay | |
| 255 to 260' | Clay | |
| 260 to 265' | Clay | |
| 265 to 270' | Clay | |
| 270 to 275' | Clay | |
| 275 to 280' | Clay | |
| 280 to 285' | Clay | |
| 285 to 290' | Clay | |
| 290 to 295' | Clay | |
| 295 to 300' | Clay | |
| 300 to 305' | Clay | |
| 305 to 310' | Clay | |
| 310 to 315' | Clay | |
| 315 to 320' | Clay | |
| 320 to 325' | Clay | |
| 325 to 330' | Clay | |
| 330 to 335' | Clay | |
| 335 to 340' | Clay | |
| 340 to 345' | Clay | |
| 345 to 350' | Clay | |
| 350 to 355' | Clay | |
| 355 to 360' | Clay | |
| 360 to 365' | Clay | |
| 365 to 370' | Clay | |
| 370 to 375' | Clay | |
| 375 to 380' | Clay | |
| 380 to 385' | Clay | |
| 385 to 390' | Clay | |
| 390 to 395' | Clay | |
| 395 to 400' | Clay | |
| 400 to 405' | Clay | |
| 405 to 410' | Clay | |
| 410 to 415' | Clay | |
| 415 to 420' | Clay | |
| 420 to 425' | Clay | |
| 425 to 430' | Clay | |
| 430 to 435' | Clay | |
| 435 to 440' | Clay | |
| 440 to 445' | Clay | |
| 445 to 450' | Clay | |
| 450 to 455' | Clay | |
| 455 to 460' | Clay | |
| 460 to 465' | Clay | |
| 465 to 470' | Clay | |
| 470 to 475' | Clay | |
| 475 to 480' | Clay | |
| 480 to 485' | Clay | |
| 485 to 490' | Clay | |
| 490 to 495' | Clay | |
| 495 to 500' | Clay | |

and that the work of plugging and filling said well was completed on the 12 day of January, 1935.

And further deposes as follows:

Sworn to and subscribed before me this 12 day of January, 1935.

My commission expires _____



02/09/2024

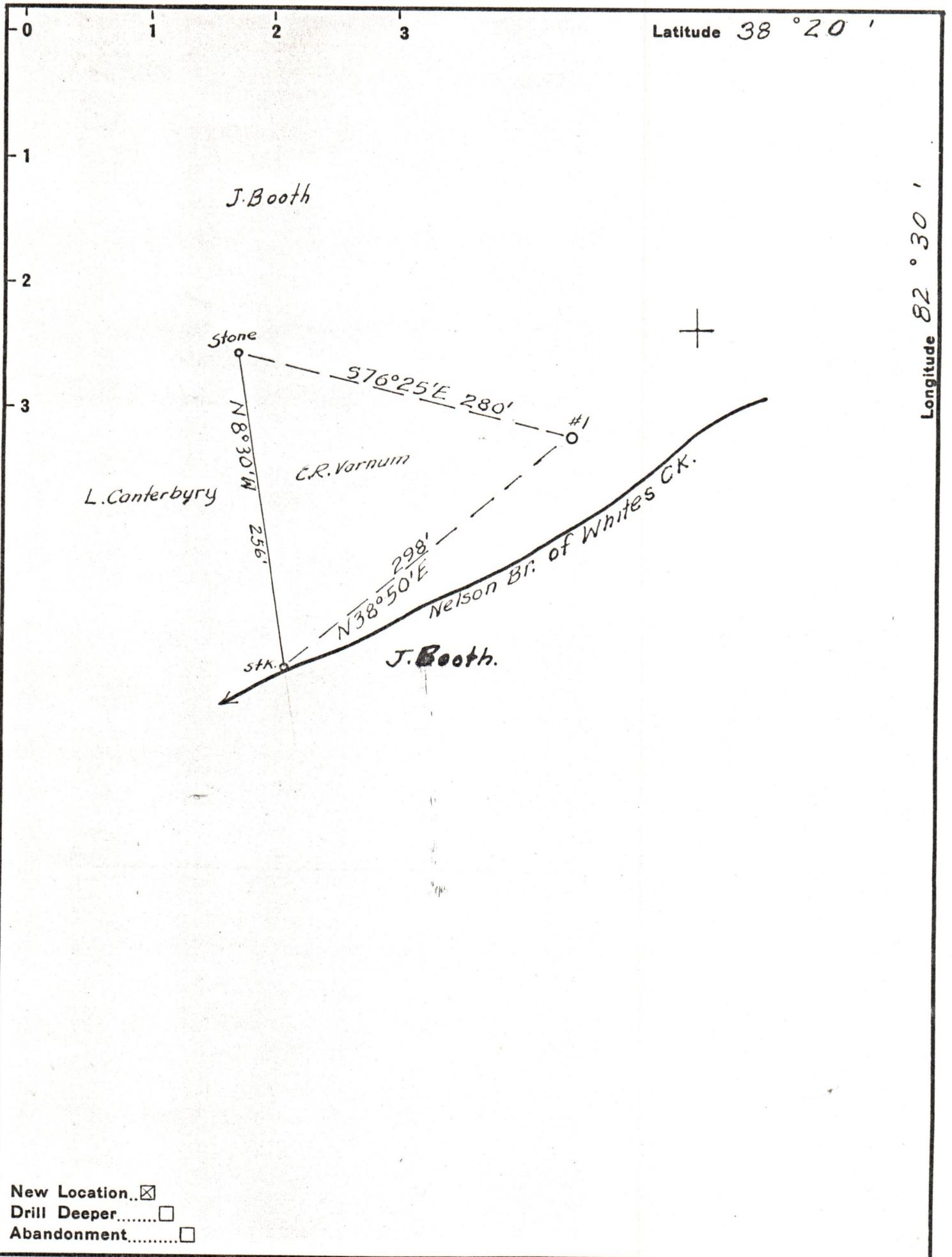

New Location
 Drill Deeper
 Abandonment

Company Whites CK. Production Co.
 Address E.L. Lusher Rt. 1, Kenova, W.Va.
 Farm C.R. Varnum
 Tract _____ Acres 200+ Lease No. _____
 Well (Farm) No. 1 Serial No. _____
 Elevation (Spirit Level) 572.0
 Quadrangle Ceredo
 County Wayne District Ceredo
 Engineer G.H. Hall
 Engineer's Registration No. 2602
 File No. _____ Drawing No. _____
 Date 1-6-54 Scale 1"=100'

STATE OF WEST VIRGINIA
 DEPARTMENT OF MINES
 OIL AND GAS DIVISION
 CHARLESTON

WELL LOCATION MAP 02/09/2024
 FILE NO. WAY-909

+ Denotes location of well on United States Topographic Maps, scale 1 to 62,500, latitude and longitude lines being represented by border lines as shown.

- Denotes one inch spaces on border line of original tracing.