



STATE OF WEST VIRGINIA  
DEPARTMENT OF MINES  
OIL AND GAS DIVISION

NOTICE OF PROPOSED LOCATION OF OIL AND GAS WELL

To THE DEPARTMENT OF MINES,  
Charleston, W. Va.

COAL OPERATOR OR COAL OWNER

---

ADDRESS

---

COAL OPERATOR OR COAL OWNER

---

ADDRESS

United Fuel Gas Company

---

OWNER OF MINERAL RIGHTS

Charleston, W. Va.

---

ADDRESS

UNITED FUEL GAS COMPANY

---

NAME OF WELL OPERATOR

P. O. Box 1273  
Charleston 25, W. Va.

---

COMPLETE ADDRESS

October 2, 19 53

---

PROPOSED LOCATION

Grant District

---

Wayne County

---

Well No. 8155 <sup>38° 05'</sup>  
<sub>72° 15'</sub>

---

U. F. G. Co. Min. Tr. #1 Farm

GENTLEMEN:

The undersigned well operator is entitled to drill upon the above named farm or tract of land for oil and gas, having fee title thereto, (or as the case may be) under grant or deed <sup>deed</sup> ~~lease~~ dated December 26, 1946, made by Huntington Development & Gas Co., to United Fuel Gas Company, and recorded on the 27th day of December, 1946, in the office of the County Clerk for said County in Book 234, page 318.

The enclosed plat was prepared by a competent engineer and shows the proposed location of a well to be drilled for oil and gas by the undersigned well operator on the farm and in the Magisterial District and County above named, determined by survey and courses and distances from two permanent points, or land marks.

The undersigned well operator is informed and believes there are no coal operators operating beds of coal beneath said farm or tract of land on which said well is located, or within 500 feet of the boundaries of the same, who have mapped their workings and filed their maps as required by law, excepting the coal operators or coal owners (if any) above named as addressees.

The above named coal operators or coal owners (if any) are notified that any objections they may desire to make to such proposed location, or which they are required to make by Section 3 of said Code, if the drilling of a well at said proposed location will cause a dangerous condition in or about their respective coal mines, must be received by, or filed with the Department of Mines within ten\* days from the receipt of a copy of this notice and accompanying plat by said Department. Said coal operators are further notified that forms for use in making such objections will be furnished to them by the Department of Mines promptly on request and that all such objections must set forth as definitely as is reasonably possible the ground or grounds on which such objections are based and indicate the direction and distance the proposed location should be moved to overcome same.

(The next paragraph is to be completed only in Department's copy.)

Copies of this notice and the enclosed plat were mailed by registered mail, or delivered to the above named coal operators or coal owners at their above shown respective address same day before, or on the same day with the mailing or delivery of this copy to the Department of Mines at Charleston, West Virginia.

Very truly yours,

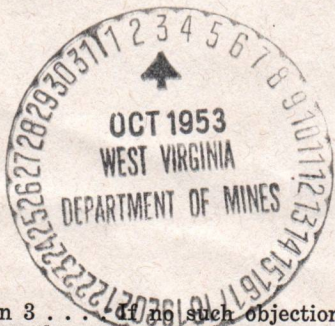

Address of Well Operator }

UNITED FUEL GAS COMPANY

---

WELL OPERATOR

P. O. Box 1273

---

STREET

Charleston 25,

---

CITY OR TOWN

West Virginia

---

STATE

02/09/2024

\*Section 3 . . . if no such objections be filed or be found by the department of mines, within said period of ten days from the receipt of said notice and plat by the department of mines, to said proposed location, the department shall forthwith issue to the well operator a drilling permit reciting the filing of such plat, that no objections have been made by the coal operators to the location, or found thereto by the department, and that the same is approved and the well operator authorized to proceed to drill at said location.

October 13, 1953

United Fuel Gas Company  
P. O. Box 1273  
Charleston, West Virginia

Gentlemen:

Enclosed is permit WAY-897 to drill Well  
No. 8155 on the United Fuel Gas Company Mineral Tract  
#1, Grant District, Wayne County.

Very truly yours,

Administrative Assistant  
OIL AND GAS DIVISION

CNH:K  
Encl-2

CC: Inspector O. C. Allen

02/09/2024

| Formation   | Color | Hard or Soft | Top   | Bottom | Oil, Gas or Water | Depth Found | Remarks |
|-------------|-------|--------------|-------|--------|-------------------|-------------|---------|
| White Slate |       |              | 3000  | 3009   |                   |             |         |
| Total depth |       |              | 3009' |        |                   |             |         |
|             |       |              | 2990  | 2990   |                   |             |         |
|             |       |              | 2980  | 2980   |                   |             |         |
|             |       |              | 2970  | 2970   |                   |             |         |
|             |       |              | 2960  | 2960   |                   |             |         |
|             |       |              | 2950  | 2950   |                   |             |         |
|             |       |              | 2940  | 2940   |                   |             |         |
|             |       |              | 2930  | 2930   |                   |             |         |
|             |       |              | 2920  | 2920   |                   |             |         |
|             |       |              | 2910  | 2910   |                   |             |         |
|             |       |              | 2900  | 2900   |                   |             |         |
|             |       |              | 2890  | 2890   |                   |             |         |
|             |       |              | 2880  | 2880   |                   |             |         |
|             |       |              | 2870  | 2870   |                   |             |         |
|             |       |              | 2860  | 2860   |                   |             |         |
|             |       |              | 2850  | 2850   |                   |             |         |
|             |       |              | 2840  | 2840   |                   |             |         |
|             |       |              | 2830  | 2830   |                   |             |         |
|             |       |              | 2820  | 2820   |                   |             |         |
|             |       |              | 2810  | 2810   |                   |             |         |
|             |       |              | 2800  | 2800   |                   |             |         |
|             |       |              | 2790  | 2790   |                   |             |         |
|             |       |              | 2780  | 2780   |                   |             |         |
|             |       |              | 2770  | 2770   |                   |             |         |
|             |       |              | 2760  | 2760   |                   |             |         |
|             |       |              | 2750  | 2750   |                   |             |         |
|             |       |              | 2740  | 2740   |                   |             |         |
|             |       |              | 2730  | 2730   |                   |             |         |
|             |       |              | 2720  | 2720   |                   |             |         |
|             |       |              | 2710  | 2710   |                   |             |         |
|             |       |              | 2700  | 2700   |                   |             |         |
|             |       |              | 2690  | 2690   |                   |             |         |
|             |       |              | 2680  | 2680   |                   |             |         |
|             |       |              | 2670  | 2670   |                   |             |         |
|             |       |              | 2660  | 2660   |                   |             |         |
|             |       |              | 2650  | 2650   |                   |             |         |
|             |       |              | 2640  | 2640   |                   |             |         |
|             |       |              | 2630  | 2630   |                   |             |         |
|             |       |              | 2620  | 2620   |                   |             |         |
|             |       |              | 2610  | 2610   |                   |             |         |
|             |       |              | 2600  | 2600   |                   |             |         |
|             |       |              | 2590  | 2590   |                   |             |         |
|             |       |              | 2580  | 2580   |                   |             |         |
|             |       |              | 2570  | 2570   |                   |             |         |
|             |       |              | 2560  | 2560   |                   |             |         |
|             |       |              | 2550  | 2550   |                   |             |         |
|             |       |              | 2540  | 2540   |                   |             |         |
|             |       |              | 2530  | 2530   |                   |             |         |
|             |       |              | 2520  | 2520   |                   |             |         |
|             |       |              | 2510  | 2510   |                   |             |         |
|             |       |              | 2500  | 2500   |                   |             |         |
|             |       |              | 2490  | 2490   |                   |             |         |
|             |       |              | 2480  | 2480   |                   |             |         |
|             |       |              | 2470  | 2470   |                   |             |         |
|             |       |              | 2460  | 2460   |                   |             |         |
|             |       |              | 2450  | 2450   |                   |             |         |
|             |       |              | 2440  | 2440   |                   |             |         |
|             |       |              | 2430  | 2430   |                   |             |         |
|             |       |              | 2420  | 2420   |                   |             |         |
|             |       |              | 2410  | 2410   |                   |             |         |
|             |       |              | 2400  | 2400   |                   |             |         |
|             |       |              | 2390  | 2390   |                   |             |         |
|             |       |              | 2380  | 2380   |                   |             |         |
|             |       |              | 2370  | 2370   |                   |             |         |
|             |       |              | 2360  | 2360   |                   |             |         |
|             |       |              | 2350  | 2350   |                   |             |         |
|             |       |              | 2340  | 2340   |                   |             |         |
|             |       |              | 2330  | 2330   |                   |             |         |
|             |       |              | 2320  | 2320   |                   |             |         |
|             |       |              | 2310  | 2310   |                   |             |         |
|             |       |              | 2300  | 2300   |                   |             |         |
|             |       |              | 2290  | 2290   |                   |             |         |
|             |       |              | 2280  | 2280   |                   |             |         |
|             |       |              | 2270  | 2270   |                   |             |         |
|             |       |              | 2260  | 2260   |                   |             |         |
|             |       |              | 2250  | 2250   |                   |             |         |
|             |       |              | 2240  | 2240   |                   |             |         |
|             |       |              | 2230  | 2230   |                   |             |         |
|             |       |              | 2220  | 2220   |                   |             |         |
|             |       |              | 2210  | 2210   |                   |             |         |
|             |       |              | 2200  | 2200   |                   |             |         |
|             |       |              | 2190  | 2190   |                   |             |         |
|             |       |              | 2180  | 2180   |                   |             |         |
|             |       |              | 2170  | 2170   |                   |             |         |
|             |       |              | 2160  | 2160   |                   |             |         |
|             |       |              | 2150  | 2150   |                   |             |         |
|             |       |              | 2140  | 2140   |                   |             |         |
|             |       |              | 2130  | 2130   |                   |             |         |
|             |       |              | 2120  | 2120   |                   |             |         |
|             |       |              | 2110  | 2110   |                   |             |         |
|             |       |              | 2100  | 2100   |                   |             |         |
|             |       |              | 2090  | 2090   |                   |             |         |
|             |       |              | 2080  | 2080   |                   |             |         |
|             |       |              | 2070  | 2070   |                   |             |         |
|             |       |              | 2060  | 2060   |                   |             |         |
|             |       |              | 2050  | 2050   |                   |             |         |
|             |       |              | 2040  | 2040   |                   |             |         |
|             |       |              | 2030  | 2030   |                   |             |         |
|             |       |              | 2020  | 2020   |                   |             |         |
|             |       |              | 2010  | 2010   |                   |             |         |
|             |       |              | 2000  | 2000   |                   |             |         |

02/09/2024

Date March 18, 19 54

APPROVED UNITED FUEL GAS CO., Owner

By S.R. Ferrell  
(Title)  
Mgr. Civil Engineering Dept.



STATE OF WEST VIRGINIA  
DEPARTMENT OF MINES  
OIL AND GAS DIVISION

Quadrangle Wayne

Permit No. MAY-897

2024/09/20

Company UNITED FUEL GAS CO.

Address P.O. Box 1273, Charleston 25, W. Va.

Farm U.F.G. Co. Min. Tr. #1 Acres 39,286.10

Location (waters) Miami Creek

Well No. 8155 Elev. 743.30

District Grant County Wayne

The surface of tract is owned in fee by

Address United Fuel Gas Co.

Mineral rights are owned by

Address Charleston, W. Va.

Drilling commenced 10-29-53

Drilling completed 2-4-54

Date Shot 2-8-54 From 1950 To 3009

With 6,933-1/3# Gelatin

Open Flow 16 /10ths Water in 2

Volume 251,000 Cn. Ft.

Rock Pressure 445 lbs. 48

Oil 60 feet

Fresh water 800 feet

Salt water 800 feet

Oil or Gas Well Has (KIND)

WELL RECORD

|                         |                 |                  |                   |      |    |                 |    |         |       |        |      |                 |           |         |         |               |                |                 |  |
|-------------------------|-----------------|------------------|-------------------|------|----|-----------------|----|---------|-------|--------|------|-----------------|-----------|---------|---------|---------------|----------------|-----------------|--|
| Packers                 | Left in Well in | Used in Drilling | Casing and Tubing | Size | 16 | 13              | 10 | 8 3/4   | 6 3/8 | 5 3/16 | 1427 | 1443'           | Depth set | 1438'   | Size of | 3" x 7" x 10" | Kind of Packer | Anchor          |  |
|                         |                 |                  |                   | Size | 16 | 13              | 10 | 8 3/4   | 6 3/8 | 5 3/16 | 1427 | 1443'           | Depth set | 1438'   | Size of | 3" x 7" x 10" | Kind of Packer | Anchor          |  |
| Casing Cemented         |                 | No. Ft.          |                   | Date |    | Casing Cemented |    | No. Ft. |       | Date   |      | Casing Cemented |           | No. Ft. |         | Date          |                | Casing Cemented |  |
| COAL WAS ENCOUNTERED AT |                 | 183              |                   | FEET |    | 24              |    | INCHES  |       | 183    |      | FEET            |           | 24      |         | INCHES        |                | 183             |  |
| Oil                     |                 | 60               |                   | FEET |    | 330             |    | FEET    |       | 36     |      | INCHES          |           | 330     |         | FEET          |                | 36              |  |
| Fresh water             |                 | 800              |                   | FEET |    | 330             |    | FEET    |       | 36     |      | INCHES          |           | 330     |         | FEET          |                | 36              |  |
| Salt water              |                 | 800              |                   | FEET |    | 330             |    | FEET    |       | 36     |      | INCHES          |           | 330     |         | FEET          |                | 36              |  |

| Formation      | Color          | Hard or Soft | Top  | Bottom | Oil, Gas or Water                          | Depth Found | Remarks |
|----------------|----------------|--------------|------|--------|--|-------------|---------|
| Surface        | Sand           | 0            | 10   | 10     | Water 60' hole full                        |             |         |
| Slate          | Slate          | 10           | 116  | 183    | Water 800'                                 |             |         |
| Coal           | Coal           | 183          | 185  | 185    |  |             |         |
| Sand           | Sand           | 185          | 185  | 300    | Gas 1375' 2/10 W 2" 60 M                   |             |         |
| Slate          | Slate          | 215          | 300  | 315    | Gas in bottom of Berea Grit 6/10 W 1" 26 M |             |         |
| Slate          | Slate          | 315          | 315  | 330    |  |             |         |
| Coal           | Coal           | 330          | 330  | 333    | Gas 2920' 4/10 W 1" 21 M                   |             |         |
| Slate          | Slate          | 333          | 333  | 366    |  |             |         |
| Shell          | Shell          | 366          | 375  | 375    | Gas 2970' 10/10 W 1" 33 M                  |             |         |
| Sand           | Sand           | 375          | 400  | 400    | Gas 3011' 10/10 W 1" 33 M                  |             |         |
| Slate & Shells | Slate & Shells | 400          | 425  | 465    | Gas 3018' 10/10 W 1" 33 M                  |             |         |
| Sand           | Sand           | 425          | 465  | 500    |  |             |         |
| Slate & Shells | Slate & Shells | 465          | 500  | 535    |  |             |         |
| Sand           | Sand           | 500          | 535  | 628    |  |             |         |
| Slate          | Slate          | 535          | 628  | 700    | Test before shot 30/10 W 1" 58 M           |             |         |
| Sand           | Sand           | 628          | 700  | 700    | Shot 12-9-53 with 200# Detonite from       |             |         |
| Sand           | Sand           | 700          | 760  | 760    | 1374-1388'                                 |             |         |
| Slate          | Slate          | 760          | 770  | 770    | Test after shot 60/10 W 1" 82 M            |             |         |
| Salt Sand      | Salt Sand      | 770          | 770  | 800    | Test before shot 18/10 W 1" 45 M           |             |         |
| Water Sand     | Water Sand     | 800          | 800  | 977    | Shot 2-8-54 with 6,933-1/3# Gelatin from   |             |         |
| Slate          | Slate          | 977          | 977  | 985    | 1950-3009'                                 |             |         |
| Sand           | Sand           | 985          | 1015 | 1015   | Test 1 hr. after shot 8/10 Merc. 2" 440 M  |             |         |
| Slate          | Slate          | 1015         | 1015 | 1050   | Test 18 hrs. after shot 16/10 W 2" 169 M   |             |         |
| Sand           | Sand           | 1050         | 1060 | 1060   |  |             |         |
| Lime Shell     | Lime Shell     | 1060         | 1090 | 1090   |  |             |         |
| Maxon Sand     | Maxon Sand     | 1090         | 1245 | 1350   |  |             |         |
| Lime (Big)     | Lime (Big)     | 1245         | 1350 | 1373   |  |             |         |
| Red Infum      | Red Infum      | 1350         | 1373 | 1388   |  |             |         |
| Grey Infum     | Grey Infum     | 1373         | 1388 | 1496   |  |             |         |
| Slate          | Slate          | 1496         | 1496 | 1930   |  |             |         |
| Slate & Shells | Slate & Shells | 1930         | 1930 | 1940   |  |             |         |
| Berea Grit     | Berea Grit     | 1940         | 1962 | 1962   |  |             |         |
| Shell          | Shell          | 1962         | 1982 | 2070   |  |             |         |
| Brown Shale    | Brown Shale    | 1982         | 2070 | 2100   |  |             |         |
| Shell          | Shell          | 2070         | 2100 | 2670   |  |             |         |
| Slate          | Slate          | 2100         | 2670 | 3000   |  |             |         |

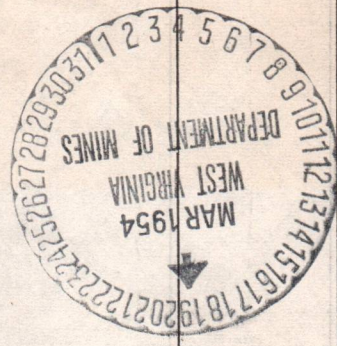

Water 60' hole full

Water 800'

Gas 1375' 2/10 W 2" 60 M

Gas in bottom of Berea Grit 6/10 W 1" 26 M

Gas 2920' 4/10 W 1" 21 M

Gas 2970' 10/10 W 1" 33 M

Gas 3011' 10/10 W 1" 33 M

Gas 3018' 10/10 W 1" 33 M

Test before shot 30/10 W 1" 58 M

Shot 12-9-53 with 200# Detonite from

1374-1388'

Test after shot 60/10 W 1" 82 M

Test before shot 18/10 W 1" 45 M

Shot 2-8-54 with 6,933-1/3# Gelatin from

1950-3009'

Test 1 hr. after shot 8/10 Merc. 2" 440 M

Test 18 hrs. after shot 16/10 W 2" 169 M

Infum - 82 M

FINAL OPEN FLOW-251 M-Berea & Shale-169M

48 Hr. R.P. 352# Casting

48 Hr. R.P. 445# Tubing

Shut in 2-11-54 in 3" Tubing.

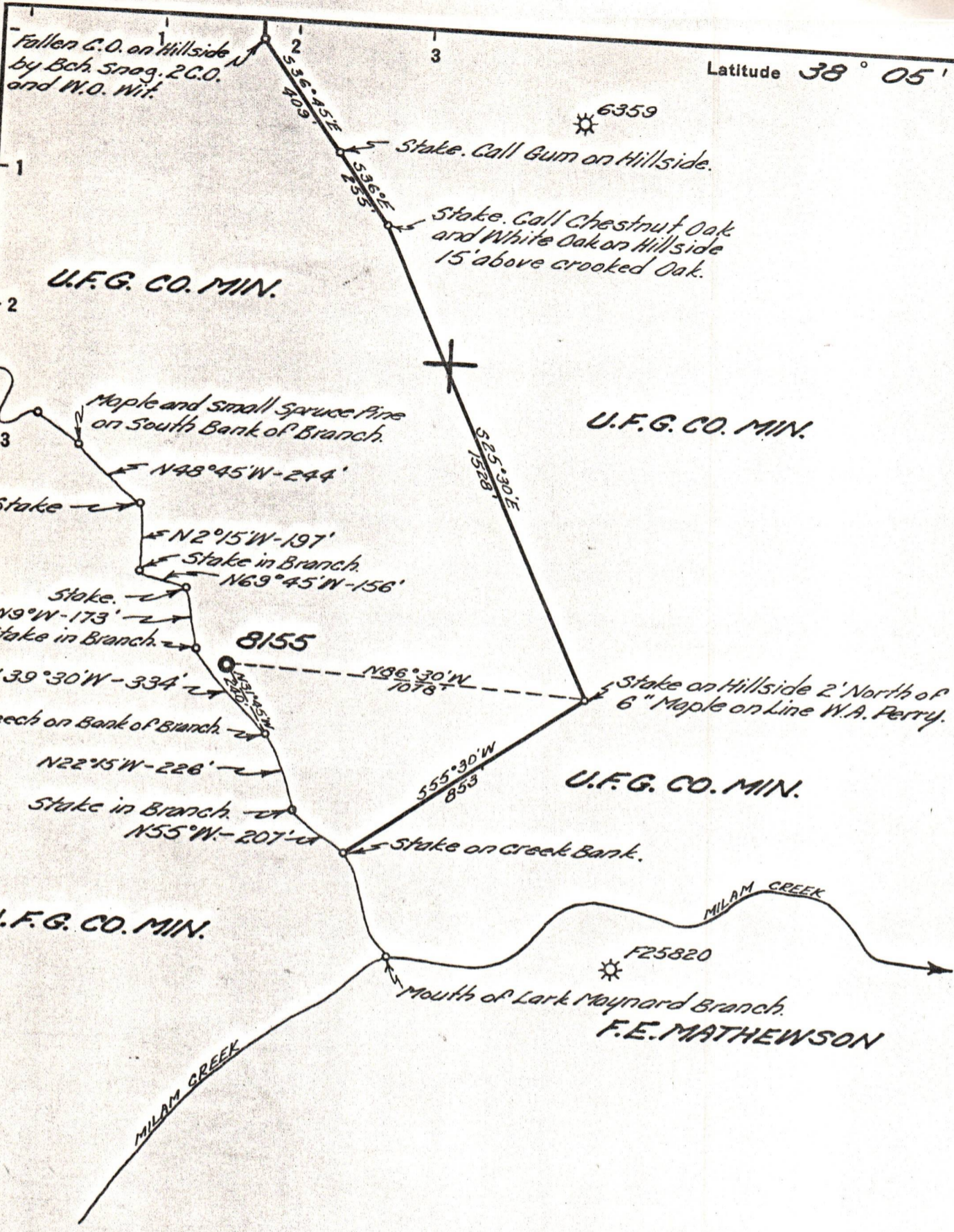

New Location   
 Drill Deeper   
 Abandonment

Company UNITED FUEL GAS CO.  
 Address CHARLESTON, W. VA.  
 Farm UNITED FUEL GAS CO. MIN.  
 Tract 1 Acres 39286.10 REF. 24689  
 Well (Farm) No. \_\_\_\_\_ Serial No. 8155  
 Elevation (Spirit Level) 743.30'  
 Quadrangle WAYNE  
 County WAYNE District GRANT  
 Engineer Seibert R. Jewell  
 Engineer's Registration No. 2529  
 File No. 24-37 Drawing No. \_\_\_\_\_  
 Date 9-15-53 Scale 1" = 400'

STATE OF WEST VIRGINIA  
 DEPARTMENT OF MINES  
 OIL AND GAS DIVISION  
 CHARLESTON

WELL LOCATION MAP  
 FILE NO. WAY-897 02/09/2024

+ Denotes location of well on United States Topographic Maps, scale 1 to 62,500, latitude and longitude lines being represented by border lines as shown.  
 - Denotes one inch spaces on border line of original tracing.