



STATE OF WEST VIRGINIA  
DEPARTMENT OF MINES  
OIL AND GAS DIVISION

NOTICE OF PROPOSED LOCATION OF OIL AND GAS WELL

To The DEPARTMENT OF MINES,  
Charleston, W. Va.

State of West Virginia  
COAL OPERATOR OR COAL OWNER  
Conservation Commission  
Charleston 5, W. Va.  
ADDRESS

OWENS, LIBBEY-OWENS GAS DEPARTMENT  
NAME OF WELL OPERATOR  
P. O. Box 4158, Charleston 4, W. Va.  
COMPLETE ADDRESS

COAL OPERATOR OR COAL OWNER  
ADDRESS

May 19, 1953

OWNER OF MINERAL RIGHTS  
ADDRESS

PROPOSED LOCATION  
Lincoln District  
Wayne County  
Well No. 69 (O.L.O. Serial #883) <sup>38°00'</sup> <sub>82°20'</sub>  
Wilson Coal Land Company Farm

GENTLEMEN:

The undersigned well operator is entitled to drill upon the above named farm or tract of land for oil and gas, having fee title thereto, ~~(or as the case may be)~~ under grant or lease dated December 17, 1936, made by H. Rummell Anderson & Thomas B. Jackson - Special Commissioners, to Owens-Illinois Glass Co. & Libbey-Owens-Ford Glass Co., and recorded on the 23rd day of December, 1936, in the office of the County Clerk for said County in Book 188, page L-33.

The enclosed plat was prepared by a competent engineer and shows the proposed location of a well to be drilled for oil and gas by the undersigned well operator on the farm and in the Magisterial District and County above named, determined by survey and courses and distances from two permanent points, or land marks.

The undersigned well operator is informed and believes there are no coal operators operating beds of coal beneath said farm or tract of land on which said well is located, or within 500 feet of the boundaries of the same, who have mapped their workings and filed their maps as required by law, excepting the coal operators or coal owners (if any) above named as addressees.

The above named coal operators or coal owners (if any) are notified that any objections they may desire to make to such proposed location, or which they are required to make by Section 3 of said Code, if the drilling of a well at said proposed location will cause a dangerous condition in or about their respective coal mines, must be received by, or filed with the Department of Mines within ten\* days from the receipt of a copy of this notice and accompanying plat by said Department. Said coal operators are further notified that forms for use in making such objections will be furnished to them by the Department of Mines promptly on request and that all such objections must set forth as definitely as is reasonably possible the ground or grounds on which such objections are based and indicate the direction and distance the proposed location should be moved to overcome same.

(The next paragraph is to be completed only in Department's copy.)

Copies of this notice and the enclosed plat were mailed by registered mail, or delivered to the above named coal operators or coal owners at their above shown respective address \_\_\_\_\_ day \_\_\_\_\_ before, or on the same day with the mailing or delivery of this copy to the Department of Mines at Charleston, West Virginia.

Very truly yours,

OWENS, LIBBEY-OWENS GAS DEPARTMENT  
WELL OPERATOR  
P. O. Box 4158  
STREET  
Charleston 4, W.  
CITY OR TOWN  
West Virginia  
STATE

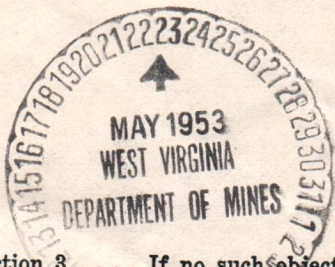

Address of Well Operator }

02/09/2024

\*Section 3 . . . . If no such objections be filed or be found by the department of mines, within said period of ten days from the receipt of said notice and plat by the department of mines, to said proposed location, the department shall forthwith issue to the well operator a drilling permit reciting the filing of such plat, that no objections have been made by the coal operators to the location, or found thereto by the department, and that the same is approved and the well operator authorized to proceed to drill at said location.





STATE OF WEST VIRGINIA  
DEPARTMENT OF MINES  
OIL AND GAS DIVISION

NOTICE OF PROPOSED LOCATION OF OIL AND GAS WELL

To The Department of Mines  
Charleston, W. Va.

State of West Virginia

Coal Operator or Coal Owner

Charleston, W. Va.

Address

Coal Operator on Coal Owner

Address

Owner of Mineral Rights

Address

OWENS, LIBBY-OWENS GAS DEVELOPMENT

NAME OF WELL OPERATOR

P. O. Box 1158, Charleston, W. Va.

COMPLETE ADDRESS

May 19, 1933

PROPOSED LOCATION

Lincoln

District

Lincoln

County

Well No. 69 (L.S.O. Serial 4883) 11.0 20

Wilson Coal Land Company

GENTLEMEN:  
The undersigned well operator is entitled to drill upon the above named farm or tract of land for

oil and gas, having the title thereto, for as the case may be, under grant of lease dated

December 17, 1930, made by Jackson - Jackson Coal Company to

Owens-Libby-Owens Co., a Libby-Owens-Lord Lease Co., and recorded on the

of Recorder, 1930, in the office of the County Clerk for said County in

Book 188, page 1-33

The enclosed plat was prepared by a competent engineer and shows the proposed location of a well to be drilled for oil and gas by the undersigned well operator on the farm and in the Mineral District of said County above named, determined by survey and courses and distances from two permanent points, or land marks.

The undersigned well operator is informed and believes there are no coal operators operating beds of coal beneath said farm or tract of land on which said well is located, or within 500 feet of the head-airs of the same, who have mapped their workings and filed their maps as required by law, excepting the coal operators or coal owners (if any) above named as addressees.

The above named coal operators or coal owners (if any) are notified that any objections they may desire to make to such proposed location, or which they are required to make by Section 3 of said Code, if the drilling of a well at said proposed location will cause a dangerous condition in or about their respective coal mines, must be received by or filed with the Department of Mines within ten days from the receipt of a copy of this notice and accompanying plat by said Department. Said coal operators are further notified that forms for use in making such objections will be furnished to them by the Department of Mines promptly on request and that all such objections must set forth as definitely as is reasonably possible the ground or grounds on which such objections are based and indicate the direction and distance the proposed location should be moved to become same.

(The next paragraph is to be completed only in Department's copy.)

Copies of this notice and the enclosed plat were mailed by registered mail, or delivered to the above named coal operators or coal owners at their above shown respective addresses, have been mailed, or on the same day with the mailing or delivery of this copy to the Department of Mines at Charleston, West Virginia.

Very truly yours,

OWENS, LIBBY-OWENS GAS DEVELOPMENT

WELL OPERATOR

P. O. Box 1158

CHARLESTON

Charleston, W. Va.

CITY OR TOWN

STATE

Address of Well Operator



02/09/2024

Section 3. If no such objection be filed or be found by the department of mines within the said period of ten days from the receipt of this notice and plat by the department of mines, to said proposed location, the department shall issue to the well operator a drilling permit, and the well operator shall proceed to drill at said location, and the well operator authorized to proceed to drill at said location.

Permit Number 11-0-20



# OWENS, LIBBEY-OWENS GAS DEPARTMENT

5793 MACCORKLE AVENUE

P. O. BOX 4158

CHARLESTON 4, WEST VIRGINIA

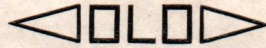

May 22, 1953

W. Va. Department of Mines  
Oil and Gas Division  
Charleston 5, W. Va.

Gentlemen:

We are enclosing an application for a permit to drill well No. 69 (Serial No. O.L.O. 883) on our Wilson Coal Land Company tract. A plat showing the proposed location of said well is also enclosed.

Yours very truly,

A handwritten signature in dark ink, appearing to read 'T. S. Flournoy'.

T. S. Flournoy  
Chief Engineer

TSF:bb

cc: W. Va. Conservation  
Commission.

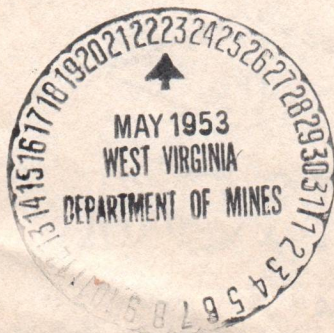

02/09/2024



OWENS, LIBBY-OWENS GAS DEPARTMENT

375 MACCRAE AVENUE  
CHARLESTON 4, WEST VIRGINIA

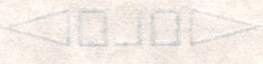

MAY 24 1953

... of lines  
... division  
...  
...  
...

We are enclosing an application for a permit  
to drill well No. 32 (State No. 100) on our tract  
and have company report. A plan showing the proposed loc-  
ation of said well is also enclosed.

Very truly yours,

*[Handwritten signature]*

T. S. ...  
Chief Engineer

cc: W. W. ...  
...

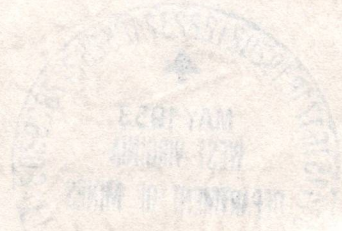





STATE OF WEST VIRGINIA  
DEPARTMENT OF MINES  
CHARLESTON

Joseph Bierer  
~~Assistant Secretary~~  
CHIEF

June 2, 1953

Owens, Libbey-Owens Gas Department  
P. O. Box 4158  
Charleston, West Virginia

Gentlemen:

Enclosed are permits for the drilling of the following wells:

<u>Permit No.</u>	<u>Well No.</u>	<u>Farm</u>	<u>District</u>
Lin-1114	19-Sr-867	Stein and McComas	Harts Creek
✓ Way-877	69-Sr-883	Wilson Coal Land Co.	Lincoln

Very truly yours,

Administrative Assistant  
OIL AND GAS DIVISION

CNH:K  
Encl-4

CC: Inspectors Dana E. Lawson  
O. C. Allen

02/09/2024





STATE OF WEST VIRGINIA  
 DEPARTMENT OF MINES  
 CHARLESTON

Joseph Hilerer  
 CHIEF

June 2, 1923

Owens, Liphey-Owens Gas Department  
 P. O. Box 1158  
 Charleston, West Virginia

Gentlemen:

Enclosed are permits for the drilling of the following

wells:

Permit No.	Well No.	Owner	Location
Lin-1111	12-St-807	Stain and McGowan	Harts Creek
Way-877	69-St-883	Wilson Coal Land Co.	Lincoln

Very truly yours,

Administrative Assistant  
 OIL AND GAS DIVISION

DMH:k  
 Enclosed

CC: Inspector Dan E. Lawson  
 O. D. Allen





STATE OF WEST VIRGINIA DEPARTMENT OF MINES OIL AND GAS DIVISION 6

Naugateck

WELL RECORD

Permit No. Way-877

Oil or Gas Well Gas (KIND)

Company OWENS, LIBBEY-OWENS GAS DEPARTMENT Address P. O. Box 1158, Charleston 4, W. Va. Farm Wilson Coal Land Co. Acres 9937 Location (waters) Well No. 69 (Serial #883) Elev. 1289.5 District Lincoln County Wayne The surface of tract is owned in fee by Address Mineral rights are owned by State of W. Va., Conservation Commission Address Charleston 5, W. Va. Drilling commenced 6-2-53 Drilling completed 8-12-53 Date Shot 8-13-53 From 2199 To 3440 With 8,950# Detonite Open Flow /10ths Water in Inch /10ths Merc. in Inch Volume Maxton S. 95 M; Br. Shale 137 M Cu. Ft. Rock Pressure Max. 341, Br. Sha. lbs. 370# 64 Max. 48 Sh. lbs. Oil bbls., 1st 24 hrs. Fresh water feet Salt water 1208 feet

Table with 4 columns: Casing and Tubing, Used in Drilling, Left in Well, Packers. Rows include sizes like 16, 18, 10-3/4, 8 1/2-5/8, 4 5/8 7, 5 3/16, 3-1/2, 3-1/2 and packer details like Parmaco HW, Size of 8 1/2 x 3 1/2 x 16, Depth set 1559-1664.

CASING CEMENTED SIZE No. Ft. Date COAL WAS ENCOUNTERED AT 58 FEET 24 INCHES 433 FEET 36 INCHES FEET INCHES FEET INCHES

Main well log table with 8 columns: Formation, Color, Hard or Soft, Top, Bottom, Oil, Gas or Water, Depth Found, Remarks. Lists geological layers from Surface down to 1182 feet depth, including Sand, Coal, Slate, and Broken Sand.

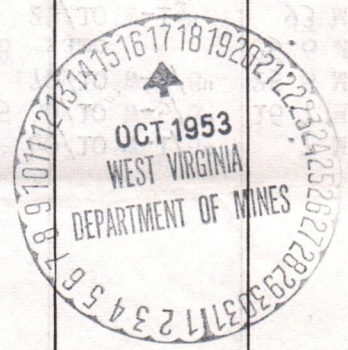

02/09/2024









(Cont.)

STATE OF WEST VIRGINIA
DEPARTMENT OF MINES
OIL AND GAS DIVISION 6A

WELL RECORD

Permit No. Way-877

Oil or Gas Well Gas (KIND)

Company OWENS, LIBBEY-OWENS GAS DEPARTMENT
Address Charleston 4, W.Va., P.O. Box 4158
Farm Acres
Location (waters)
Well No. Elev.
District County
The surface of tract is owned in fee by
Address
Mineral rights are owned by
Address
Drilling commenced
Drilling completed
Date Shot From To
With
Open Flow /10ths Water in Inch
/10ths Merc. in Inch
Volume Cu. Ft.
Rock Pressure lbs. hrs.
Oil bbls., 1st 24 hrs.
Fresh water feet feet
Salt water feet feet

Table with columns: Casing and Tubing, Used in Drilling, Left in Well, Packers. Rows include sizes (16, 13, 10, 8 1/4, 6 5/8, 5 3/16, 3, 2) and Liners Used.

CASING CEMENTED SIZE No. Ft. Date
COAL WAS ENCOUNTERED AT FEET INCHES
FEET INCHES FEET INCHES
FEET INCHES FEET INCHES

Main well log table with columns: Formation, Color, Hard or Soft, Top, Bottom, Oil, Gas or Water, Depth Found, Remarks. Includes entries for Shell, Br. Shale, Slate and detailed remarks on drilling operations.

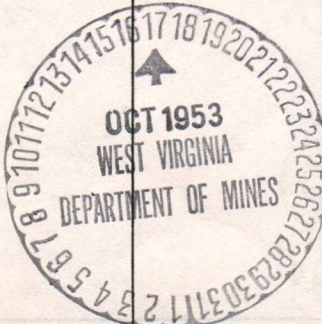

(OVER)

(Over)

02/09/2024







02/09/2024

FERC-121

1.0 API well number: (If not available, leave blank. 14 digits.)		47-099-0877	
2.0 Type of determination being sought: (Use the codes found on the front of this form.)		108	
3.0 Depth of the deepest completion location: (Only needed if sections 103 or 107 in 2.0 above.)		NA	
4.0 Name, address and code number of applicant: (35 letters per line maximum. If code number not available, leave blank.)		Industrial Gas Corporation P. O. Box 1473 Street Charleston WV 25325 City	
5.0 Location of this well: (Complete (a) or (b).)		NA	
(a) For onshore wells (35 letters maximum for field name.)		Field Name Wayne	
(b) For OCS wells:		County WV	
(c) Name and identification number of this well: (35 letters and digits maximum.)		Wilson Coal Land Co. 69-883	
(d) If code 4 or 5 in 2.0 above, name of the reservoir: (35 letters maximum.)		NA	
6.0 (a) Name and code number of the purchaser: (35 letters and digits maximum. If code number not available, leave blank.)		See Addendum "A"	
(b) Date of the contract:		1 2 2 6 7 3 Mo. Day Yr.	
(c) Estimated annual production:		1.9 MMcf.	
7.0 Contract price: See Addendum "A"		(a) Base Price (\$/MMBTU) 1 2 8 3	
(b) Tax		0 0 5 1	
(c) All Other Prices (Indicate (+) or (-).)		0 0 0 3	
(d) Total of (a), (b) and (c)		1 3 3 6	
8.0 Maximum lawful rate: (As of filing date. Complete to 3 decimal places.)		2.243	
9.0 Person responsible for this application:		0.302	
		0.0	
		2.545	
Agency Use Only		Date Received by Juris. Agency 02/28/79	
Date Received by FERC		Date Application is Completed (304) 342-8166 Phone Number	
Name William C. Charlton		Signature	
Title Division Counsel			

F17900308/2-2



WELL DETERMINATION REPORT

ARTICIPANTS:

DATE: OCT 10 1979

BUYER-SELLER CODE

WELL OPERATOR: Industrial Gas Corporation

009283

FIRST PURCHASER: Houdaille Industries, Inc.

OTHER: \_\_\_\_\_

*Quincy section 108. Stages used.*

*Resected last year in April 1978*  
*Pratt*

W. Va. Department of Mines, Oil & Gas Division

WELL DETERMINATION FILE NUMBER

790228-108-099-0877

Use Above File Number on all Communications

Relating to Determination of this Well

*new production 7/3/80 MW*

CHECK EACH ITEM AS COMPLETE OR NOTE WHAT IS MISSING

ITEM NO.

- 1 FERC-121  Items not completed - Line No. \_\_\_\_\_
- 2 IV-1 - Agent  William C. Charlton
- 3 IV-2 - Well Permit
- 4 IV-6 - Well Plat
- 5 IV-35- Well Record  Drilling  Deepening
- 6 IV-36- Gas-Oil Test:  Gas Only \_\_\_\_\_ Was Oil Produced? \_\_\_\_\_ Ratio \_\_\_\_\_
- 7 IV-39- Annual Production 2 years
- 8 IV-40- 90 day Production 85 Days off Line: 5
- 9 IV-48- Application for Certification. Complete?
- 10 - 17 IV Form #51 - 52 - 53 - 54 - 55 -  56 - 57 - 58. Complete  Affidavit Signed
- 18 - 28 Other: Survey \_\_\_\_\_ Logs \_\_\_\_\_ Geological Charts \_\_\_\_\_ Structure Map \_\_\_\_\_
- 1:4000 Map \_\_\_\_\_ Well Tabulations \_\_\_\_\_ Gas Analyses \_\_\_\_\_
- (5) Date ~~Completed~~ Commenced: 6-2-53  
Date Frac: 8-12-53 (anil) Deepened \_\_\_\_\_
- (5) Production Depth: 1597-1052; 3224 3278 3293 3384 3394
- (5) Production Formation: Marton, Bn Shale
- (5) ~~Initial Potential:~~ F.o.F.: 232 MCF
- (5) Static R.P. ~~initially:~~ after frac: 370 #
- (6) Other Gas Test: \_\_\_\_\_
- (7) Avg. Daily Gas from Annual Production:  $\frac{2369}{305} = 6.4 \text{ MCF NO OIL}$
- (8) Avg. Daily Gas from 90-day ending w/1-120 days  $\frac{454}{98} = 4.6 \text{ MCF, NO OIL}$
- (8) Line Pressure: 41 # PSIG from Daily Report
- (5) Oil Production: Yes From Completion Report 766, 1105, 1140, 202/09/2024
- (10-17) Does lease inventory indicate enhanced recovery being done: NO
- (10-17) Is affidavit signed?  Notarized?

Does official well rec. with the Department confirm the submitted information? Yes

Additional Information \_\_\_\_\_ Does computer program confirm? \_\_\_\_\_

Was Determination Obje. to? \_\_\_\_\_ By Whom? \_\_\_\_\_

*JM*

*OK*



STATE OF WEST VIRGINIA  
DEPARTMENT OF MINES, OIL AND GAS DIVISION

Date 02/28 19 79

Operator's Well No. 69-883

API Well No. 47 - 099 - 0877  
State County Permit

WELL CLASSIFICATION FORM

STRIPPER GAS WELL

NGPA Section 108

DESIGNATED AGENT William C. Charlton

ADDRESS P. O. Box 1473  
Charleston, WV 25325

WELL OPERATOR Industrial Gas Corporation LOCATION: Elevation 1,289.5'

ADDRESS P. O. Box 1473  
Charleston, WV 25325

Watershed Not Available

Dist. Lincoln County Wayne Quad. Naugatuck

GAS PURCHASER \* \_\_\_\_\_

Gas Purchase Contract No. \* \_\_\_\_\_

ADDRESS \_\_\_\_\_

Meter Chart Code R0002

Date of Contract \* \_\_\_\_\_

\*See FERC-121 - Addendum "A"

\* \* \* \* \*

Provide a complete inventory of the lease and production equipment used for the well for the previous 24 months or, if less than 24 months, the period the well has been in production. Include a complete list of equipment or processes used in connection with recognized enhanced recovery techniques during completion or production. (Attach separate sheets, if necessary.)

(See Attachment)

List all records reasonably available to you which contain information relevant to a determination of eligibility (including production records, B&O Tax Records and royalty payment records) and indicate the location of such records:

All records required to determine production by meter stations are maintained in Charleston, West Virginia.

B&O Tax Records are located in Charleston, West Virginia, our Boston, Massachusetts office and the Houston, Texas office.

Royalty payment instructions are located in Charleston, West Virginia office and Houston, Texas office.

02/09/2024



Describe the search made of any records listed above:

I have made a diligent search of the production records located in Charleston, West Virginia. They were the records utilized in making the determination herein.

Are you aware of any other information which would tend to be inconsistent with the information specified above? Yes  No . If yes, indicate the type and source of the information.

AFFIDAVIT

I, Lawrence B. Mentzer, having been first sworn according to law, state that I have caused to be made a diligent search of those records hereinbefore indicated in the manner herein described, that the information contained in this document is true and accurate and that on the basis of the records and examinations hereinbefore described, and to the best of my information, knowledge and belief, the well for which this certification is sought qualifies as a stripper well.

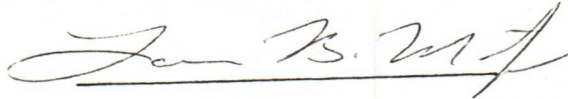

STATE OF WEST VIRGINIA,

COUNTY OF Kanawha, TO WIT:

I, Charlotte I. Mathews, a Notary Public in and for the state and county aforesaid, do certify that Lawrence B. Mentzer whose name is signed to the writing above, bearing date the 28 day of February, 19 79, has acknowledged the same before me, in my county aforesaid.

Given under my hand and official seal this 28 day of February, 19 79.

My term of office expires on the 5th day of December, 19 85.

  
Notary Public

02/09/2024



RECEIVED

MAR 31 1980

FERC-121

1.0 API well number: (If not available, leave blank. 14 digits.)	47- 099-0877							
2.0 Type of determination being sought: (Use the codes found on the front of this form.)	107 Section of NGPA	NA Category Code						
3.0 Depth of the deepest completion location: (Only needed if sections 103 or 107 in 2.0 above.)	NA feet							
4.0 Name, address and code number of applicant: (35 letters per line maximum. If code number not available, leave blank.)	Tug Fork Corporation Name P. O. Box 3711 Street Charleston WV 25337 City State Zip Code			N/A Seller Code				
5.0 Location of this well: [Complete (a) or (b).] (a) For onshore wells (35 letters maximum for field name.)	NA Field Name Wayne County WV State							
(b) For OCS wells:	NA Area Name Date of Lease: Mo. Day Yr.			NA Block Number NA OCS Lease Number				
(c) Name and identification number of this well: (35 letters and digits maximum.)	Wilson Coal Land Co.			69-883				
(d) If code 4 or 5 in 2.0 above, name of the reservoir: (35 letters maximum.)	NA							
6.0 (a) Name and code number of the purchaser: (35 letters and digits maximum. If code number not available, leave blank.)	Tennessee Gas Pipeline Company Name			018629 Buyer Code				
(b) Date of the contract:	08, 17, 80 Mo. Day Yr.							
(c) Estimated annual production:	1.9 MMcf.							
	(a) Base Price (\$/MMBTU)	(b) Tax	(c) All Other Prices [Indicate (+) or (-).]	(d) Total of (a), (b) and (c)				
7.0 Contract price: (As of filing date. Complete to 3 decimal places.)	2.404	.324	0.0	2.728				
8.0 Maximum lawful rate: (As of filing date. Complete to 3 decimal places.)	2.404	.324	0.0	2.728				
9.0 Person responsible for this application:	Lawrence B. Mentzer Name Corporate Attorney Title Signature MAR 3 1980 Date Application is Completed (304) 342-8166 Phone Number							
<table border="1"> <tr> <td>Agency Use Only</td> </tr> <tr> <td>Date Received by Juris. Agency</td> </tr> <tr> <td>MAR 21 1980</td> </tr> <tr> <td>Date Received by FERC</td> </tr> </table>					Agency Use Only	Date Received by Juris. Agency	MAR 21 1980	Date Received by FERC
Agency Use Only								
Date Received by Juris. Agency								
MAR 21 1980								
Date Received by FERC								

FT7900S06/2-2

02/09/2024



DATE: AUG 14 1980

WELL-SEALER CODE

RECIPIENTS:

WELL OPERATOR: Tug Fork Corp.  
FIRST PURCHASER: Tennessee Gas Pipeline Co.

NA  
018629

OTHER:

U.S. Department of Mines, Oil & Gas Division  
WELL DETERMINATION FILE NUMBER  
800331-107-099-0877  
Use Above File Number on all Communications  
Relating To Determination of this Well

CHECK EACH ITEM AS COMPLETE OR NOTE THAT IS MISSING

W. NO.

- 1. FERC-121  Items not completed - Line No. \_\_\_\_\_
- 2. IV-1 Agent Lawrence B. Mentzer
- 3. IV-2 Well Permit \_\_\_\_\_
- 4. IV-6 Well Plat
- 5. IV-35 Well Record  Drilling  Deepening \_\_\_\_\_
- 6. IV-36 Gas-Oil Test: Gas Only \_\_\_\_\_ Was Oil Produced? \_\_\_\_\_ Ratio \_\_\_\_\_
- 7. IV-39 Annual Production No Prod years
- 8. IV-40 90 day Production \_\_\_\_\_ Days off line: \_\_\_\_\_
- 9. IV-45 Application for certification. Complete?
- 10. IV Form #31 - 52 - 53 - 54 - 55 - 56 - 57 - 58
- 11. Others: Survey \_\_\_\_\_ Geological Maps: \_\_\_\_\_  
Structure Map \_\_\_\_\_ 1:25000 Map \_\_\_\_\_ Well Tabulations \_\_\_\_\_  
Gas Analyses \_\_\_\_\_
- (12) Date commenced: 6/2/53 Date completed 8/13/53 Reopened \_\_\_\_\_
- (13) Production Depth: 3349/3420; 3333/44; 3130/3303; 3044/3120
- (14) Production Formation: Br. Shale; \_\_\_\_\_; \_\_\_\_\_; Slate
- (15) Final Open Flow: 137 mcf/d
- (16) Water Free. P.P. 370 #
- (17) Other Gas Tests: \_\_\_\_\_
- (18) Avg. Daily Gas from Annual Production: No Prod
- (19) Avg. Daily Gas from 90-day ending w/1 - 120 Days: " "
- (20) Line Pressure: None PSIG from Daily Report
- (21) Oil Production: yes From Completion Report 2440; 1140; 1105; 766  
02/09/2024
- (22) Does lease inventory indicate enhanced recovery being done No
- (23) Is affidavit signed \_\_\_\_\_
- (24) Is official well record with the Department confirm the submitted information? yes
- (25) Additional information: \_\_\_\_\_ Does computer program confirm? PL



STATE OF WEST VIRGINIA  
DEPARTMENT OF MINES, OIL AND GAS DIVISION

Date MAR 3 1980, 1980

Operator's Well No. 69-883

API Well No. 47 - 099 - 0877  
State County Permit

WELL CLASSIFICATION FORM

HIGH COST GAS WELL  
NGPA Section 107

DESIGNATED AGENT Lawrence B. Mentzer

ADDRESS P. O. Box 3711  
Charleston, W. Va. 25337

LOCATION: Elevation 1289.5

Watershed N/A

Dist. Lincoln County Wayne Quad. Naugatuck

WELL OPERATOR Tug Fork Corporation

ADDRESS P. O. Box 3711  
Charleston, W. Va. 25337

GAS PURCHASER Tennessee Gas Pipeline Company Gas Purchase Contract No. TF-1

ADDRESS P. O. Box 2511  
Houston, Texas 77001

Meter Chart Code R0002

Date of Contract 08/17/80

\* \* \* \* \*

AFFIDAVIT

I, James O. Sayre, having been first sworn according to law, state that, the well is producing natural gas produced from the fractures, micropores and bedding planes of shales deposited during the Paleozoic Devonian Period as generally found in the subsurface of the Appalachian Basin and in the surface out crops around its periphery. For the purposes of this statement, Devonian shale is defined as that shale stratigraphic interval that lies between the base of the Mississippian Berea Sand or, if absent, that of the Osage Series, and the top of the Onondaga limestone formation or its chert equivalent, the top of the Huntersville group of carbonates. I have no knowledge of any information not included in the application which is inconsistent with a conclusion that the well qualifies as a high cost natural gas well.

James O. Sayre  
Geologist

STATE OF WEST VIRGINIA,  
COUNTY OF Kanawha, TO WIT:

I, Charlotte I. Mathews, a Notary Public in and for the state and county aforesaid, do certify that James O. Sayre, whose name is signed to the writing above, bearing date the 3rd day of March, 1980, has acknowledged the same before me, in my county aforesaid.

Given under my hand and official seal this 3rd day of March, 1980  
My term of office expires on the 5th day of December, 1985.

Charlotte I. Mathews  
Notary Public

[NOTARIAL SEAL]



ELECTRIC LOGS

With reference to this well, please note that, at the time of the drilling hereof, neither electric logs nor the technology for logging were available. In lieu of actual electric logs on this well, we hereby refer to the gamma ray log and temperature log of the Caldwell & Colton Min. #20,289-T, Permit No. Wayne 1581. Our geologist(s) submit that these logs are representative of the area and shows the same or similar formations and structures as encountered in the well herein filed for.

Please refer to 107 Tug Fork well certification filing on Well No. 3-521, API No. 47-099-0019 for a copy of the said gamma ray and temperature logs applicable herein.

02/09/2024







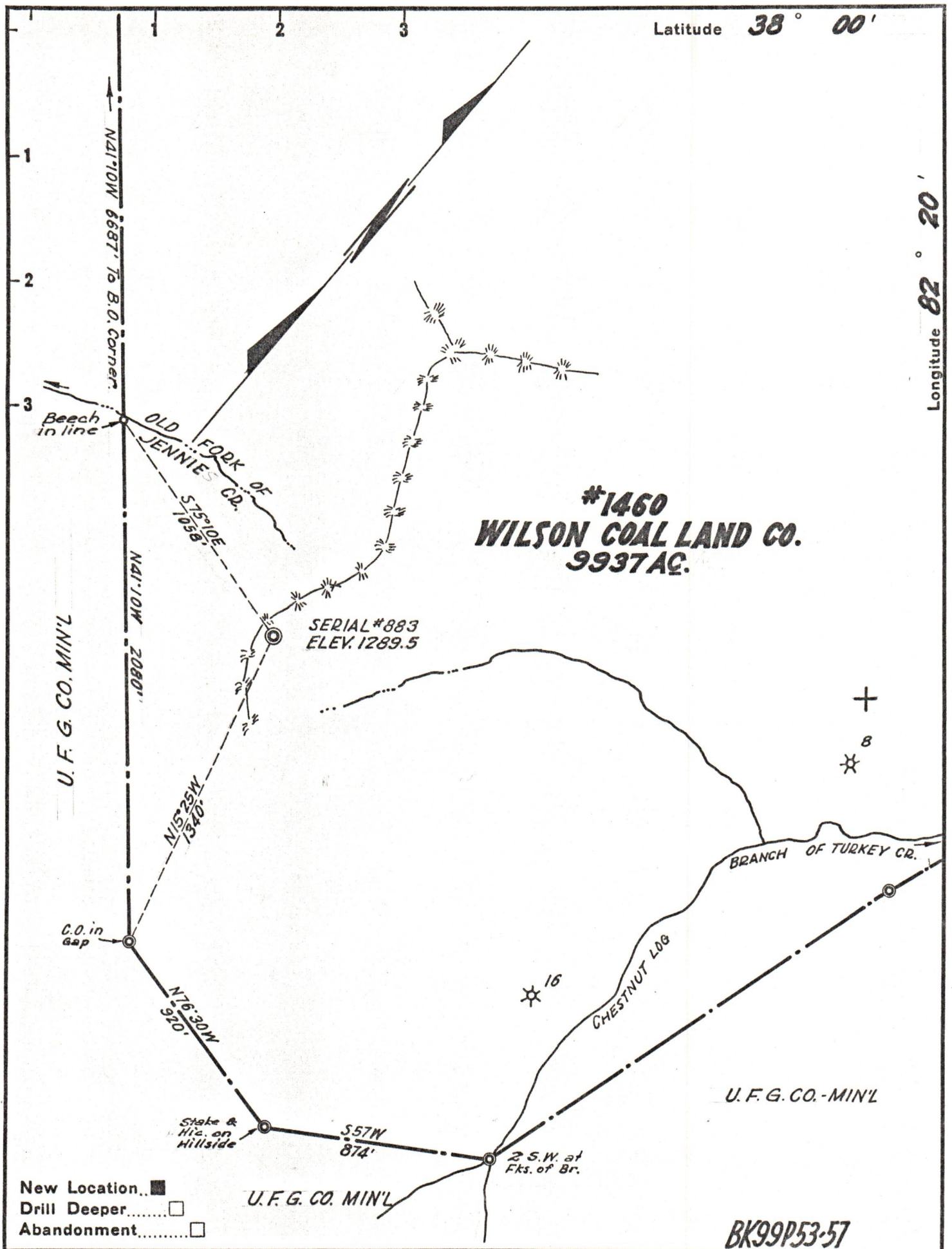

Company OWENS, LIBBEY-OWENS GAS DEPT.  
 Address BOX 4158 CHARLESTON 4, W. VA.  
 Farm WILSON COAL LAND CO.  
 Tract \_\_\_\_\_ Acres 9937 Lease No. 1460  
 Well (Farm) No. 69 Serial No. 883  
 Elevation (Spirit Level) 1289.5  
 Quadrangle NAUGATUCK 1 S5.52" W-0.63"  
 County WAYNE District LINCOLN  
 Engineer T. S. FLOURNOY  
 Engineer's Registration No. 269  
 File No. \_\_\_\_\_ Drawing No. \_\_\_\_\_  
 Date MAY 12, 1953 Scale 1" = 500 FT.

STATE OF WEST VIRGINIA  
 DEPARTMENT OF MINES  
 OIL AND GAS DIVISION  
 CHARLESTON

WELL LOCATION MAP  
 FILE NO. WAY-877 02/09/2024

+ Denotes location of well on United States Topographic Maps, scale 1 to 62,500, latitude and longitude lines being represented by border lines as shown.

- Denotes one inch spaces on border line of original tracing.