



STATE OF WEST VIRGINIA
DEPARTMENT OF MINES
OIL AND GAS DIVISION

NOTICE OF PROPOSED LOCATION OF OIL AND GAS WELL

To THE DEPARTMENT OF MINES,
Charleston, W. Va.

(Not a coal area.)

COAL OPERATOR OR COAL OWNER

ADDRESS

COAL OPERATOR OR COAL OWNER

ADDRESS

OWNER OF MINERAL RIGHTS

ADDRESS

Wm. Adkins Gas Co.

NAME OF WELL OPERATOR

Barboursville, W.Va. Rt.2

COMPLETE ADDRESS

May 8th, 19 49.

PROPOSED LOCATION

Union District

Wayne County

Well No. 1

39.20
81.20

Wm. Adkins Farm

GENTLEMEN:

The undersigned well operator is entitled to drill upon the above named farm or tract of land for oil and gas, having fee title thereto, (or as the case may be) under grant or lease dated 9-14-47, made by R.M.Adkins, to Frank Smith & Zelda Smith, his wife, and recorded on the 13th day of September, 1947, in the office of the County Clerk for said County in Book 5, page 8.

The enclosed plat was prepared by a competent engineer and shows the proposed location of a well to be drilled for oil and gas by the undersigned well operator on the farm and in the Magisterial District and County above named, determined by survey and courses and distances from two permanent points, or land marks.

The undersigned well operator is informed and believes there are no coal operators operating beds of coal beneath said farm or tract of land on which said well is located, or within 500 feet of the boundaries of the same, who have mapped their workings and filed their maps as required by law, excepting the coal operators or coal owners (if any) above named as addressees.

The above named coal operators or coal owners (if any) are notified that any objections they may desire to make to such proposed location, or which they are required to make by Section 3 of said Code, if the drilling of a well at said proposed location will cause a dangerous condition in or about their respective coal mines, must be received by, or filed with the Department of Mines within ten* days from the receipt of a copy of this notice and accompanying plat by said Department. Said coal operators are further notified that forms for use in making such objections will be furnished to them by the Department of Mines promptly on request and that all such objections must set forth as definitely as is reasonably possible the ground or grounds on which such objections are based and indicate the direction and distance the proposed location should be moved to overcome same.

(The next paragraph is to be completed only in Department's copy.)

Copies of this notice and the enclosed plat were mailed by registered mail, or delivered to the above named coal operators or coal owners at their above shown respective address _____ day _____ before, or on the same day with the mailing or delivery of this copy to the Department of Mines at Charleston, West Virginia.

Very truly yours,

Hubert Lusher

WELL OPERATOR

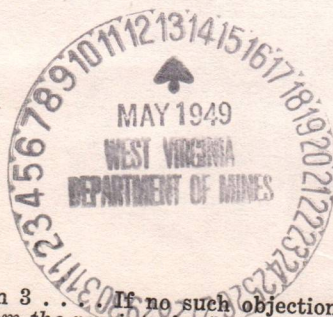

Address of Well Operator }

Barboursville, Rt. 2

STREET

CITY OR TOWN

W. Va.

STATE

11/10/2023

*Section 3 . . . If no such objections be filed or be found by the department of mines, within said period of ten days from the receipt of said notice and plat by the department of mines, to said proposed location, the department shall forthwith issue to the well operator a drilling permit reciting the filing of such plat, that no objections have been made by the coal operators to the location, or found thereto by the department, and that the same is approved and the well operator authorized to proceed to drill at said location.

RECLAMATION PLAN

WELL NO. One

QUADRANGLE _____

SCALE _____

Locate and show (1) Well Location (2) Access Road (3) Well Site (4) Drilling Pit and (5) Necessary Drainage Features.

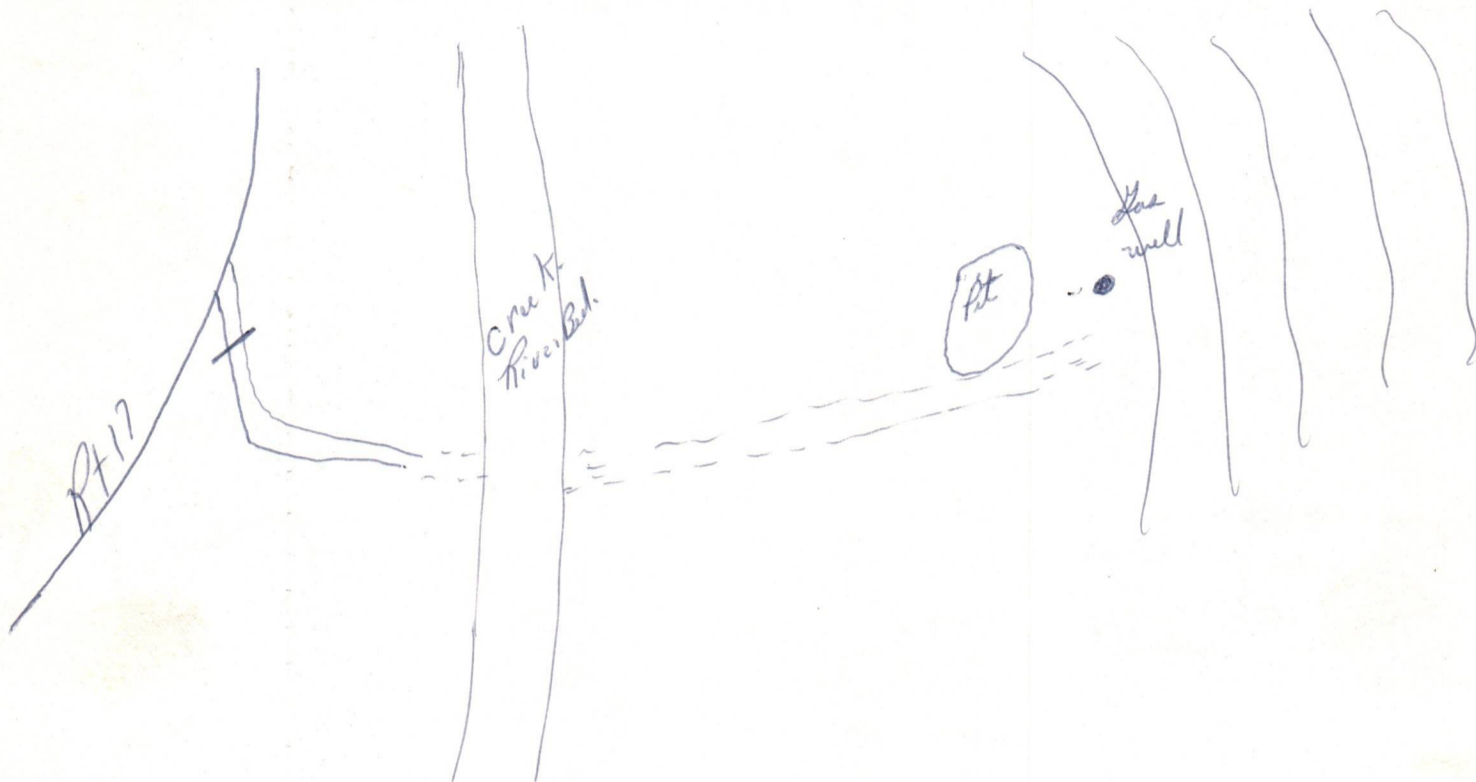

COMPANY NAME GAS SUPPLY CORPORATION PERMIT NO. WAYNE-684-P

FARM ROBERT ADKINS DISTRICT UNION COUNTY WAYNE

STATEMENT OF RECLAMATION PLAN:

Not to scale; drawing of all roads, locations, ditches, drains, pits, silt traps, etc.

The road going to well is used by farmer.
 1. We will ~~be~~ *reclaim*. The ~~land~~ *land* around well and fill in the pit.
 2. ~~pick up~~ *pick up* all material ~~and~~ *and* seed ~~seed~~ *seed*.

This plan was observed and agreed upon between the well operator, contractor, and the district oil and gas inspector. 11/10/2023

Please indicate () "YES" if the district inspector was present. *Burdette*

"I have read and understand the reclamation requirements as set forth in Chapter 22, Article 4, Section 12-b and will carry out the specified requirements."

Submitted By: *Richard D. Mulford* Title *Sect. Ins.* Date *11-8-78*

A-11

October 11, 1978

RECEIVED

OCT 12 1978

OIL & GAS DIVISION
DEPT. OF MINES

Department of Mines
State of West Virginia
Charleston, West Virginia

Gentlemen:

Enclosed you will find application for a plugging permit. This well was drilled by H. H. Lusher & Sons and the drilling permit was issued to them. It was drilled on the Robert Adkins farm on the waters of Millers Fork on Fisher Bowen Branch. Well was commenced in May, 1949, and completed in July, 1949, the drilling permit has been lost hoping this will supply the necessary information for this permit.

We, the Gas Supply Corporation, took this well over to try to put it back into production but have failed. We have a drilling rig set up over this well and would like to get the well plugged as soon as possible so as to be able to move the rig and material out before bad weather.

Yours truly,

GAS SUPPLY CORPORATION

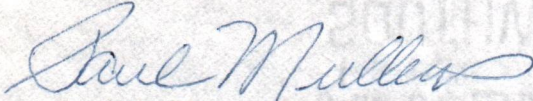
Paul Mullens, President

11/10/2023



State of West Virginia

Department of Mines
Oil and Gas Division

Charleston 25305

WALTER N. MILLER
DIRECTOR

ROBERT L. DODD - P. E.
DEPUTY DIRECTOR

October 13, 1978

Mr. Paul Mullens, President
Gas Supply Corporation
Box 56
Lavalette, WV 25535

REG: WAYNE-684-P
UNION DISTRICT, WELL NO. 1
ROBERT ADKINS FARM

Dear Mr. Mullens:

The above subject permit to plug cannot be issued until a proposed method of reclamation is submitted in compliance with Chapter 22, Article 4, Section 1k (g).

Upon receipt of the proposed plan of reclamation we will issue your permit to plug.

Very truly yours,

Fred Burdette - Supervising Inspector
Oil and Gas Division

FB/ljw

11/10/2023

Formation	Color	Hard or Soft	Top	Bottom	Oil, Gas or Water	Depth Found	Remarks
Black Slate			1687	1735			
Slate & Shells			1735	1988			
White Slate			1988	2175			
Coffee Shale			2175	2205			
Brears Grit			2205	2220			
Brears Shells			2220	2230			
White Slate			2230	2540			
Gray Shale			2540	2720			
Brown Shale			2720	2755			
Gray Shale			2755	2840			
Brown Shale			2840	2945			
White Slate			2945	2955			
Brown Shale			2955	3205			
White Slate			3205				
Total Depth				3205			

11/10/2023

DEPARTMENT OF MINES
BUREAU OF METALLOGY

Date _____, 19____

APPROVED _____, Owner

By _____

(Title)



STATE OF WEST VIRGINIA
DEPARTMENT OF MINES
OIL AND GAS DIVISION

Handwritten: Guyandot

WELL RECORD

Permit No. Wayle 84

Oil or Gas Well _____
(KIND)

Company Robert M. Adkins Gas Co.
Address Barboursville, W.Va. Route 2
Farm Robert M. Adkins Acres 160
Location (waters) Millers Fork
Well No. one Elev. 598'
District Union County Wayne
The surface of tract is owned in fee by _____
Address _____
Mineral rights are owned by W W Lushert Sons
Route 2 #48 Address Barboursville, W.Va.
Drilling commenced May 23, 1949
Drilling completed July 17, 1949
Date Shot July 19 From 2800 To 3205
With Merckus Julliton
Open Flow 20/10ths Water in _____ Inch
_____ /10ths Merc. in _____ Inch
Volume _____ Cu. Ft.
Rock Pressure 400 lbs. _____ hrs.
Oil _____ bbls., 1st 24 hrs.
Fresh water 300 feet _____ feet
Salt water 1090 feet _____ feet

Casing and Tubing	Used in Drilling	Left in Well	Packers
Size			
16		✓	Kind of Packer
13		✓	
10		<u>23-10</u>	Size of
8 1/4		<u>383-8</u>	
6%		<u>1629-4</u>	Depth set
5 3/16		✓	
		✓	Perf. top
		✓	Perf. bottom
Liners Used		✓	Perf. top
			Perf. bottom

CASING CEMENTED	SIZE	No. Ft.	Date
COAL WAS ENCOUNTERED AT _____ FEET _____ INCHES			
_____ FEET _____ INCHES _____ FEET _____ INCHES			
_____ FEET _____ INCHES _____ FEET _____ INCHES			

Formation	Color	Hard or Soft	Top	Bottom	Oil, Gas or Water	Depth Found	Remarks
Surphus			0	24			
Slate			24	440			
Sand			40	55			
Red Rock			55	75			
Slate			75	115			
Red Mud			115	135			
Sand			135	170			
Red Mud			170	185			
Slate			185	200			
Sand			200	235			
Slate			235	255			
Red Rock			255	270			
Slate			270	300			
Sand			300	335			
Slate			335	355			
Sand			355	380			
Slate			380	465			
Sand			465	510			
Slate			510	540			
Sand			540	575			
Black Slate			575	615			
Sand			615	700			
Slate			700	745			
Sand			745	810			
Slate			810	850			
Sand			850	873			
White Slate			873	930			
Sand			930	940			
Black Slate			940	975			
Salt Sand			975	1135			
Black Slate			1135	1165			
Maxon Sand			1165	1295			
Slate & Shells			1295	1370			
Little Lime			1370	1400			
Brake Slate			1400	1403			
Big Lime			1403	1570			
Injun Sand			1570	1600			
Slate & Shells			1600	1665			
Sand			1665	1685			
Slate			1685	1687			



B-3

STATE OF WEST VIRGINIA
DEPARTMENT OF MINES
OIL AND GAS WELLS DIVISION

RECEIVED
NOV 30 1978

INSPECTOR'S PLUGGING REPORT OIL & GAS DIVISION
DEPT. OF MINES

Permit No. Way-684P Well No. 1
COMPANY Gas Supply Corp. ADDRESS Java letter WVA
FARM Robert Adkins DISTRICT Union COUNTY Wayne
Filling Material Used Clay Stone Cement

Liner Location Amount Packer Location

PLUGS USED AND DEPTH PLACED

BRIDGES

CASING AND TUBING

CEMENT-THICKNESS

WOOD-SIZE

LEAD

CONSTRUCTION-LOCATION

RECOVERED

SIZE

LOST

1370 - 1400 Clay Stone 1100 - 1370

Drillers' Names Willard Franklin

Conts Willard Franklin

Remarks: Filling hole as 7" pipe is pulled.

11-28-78
DATE

I hereby certify I visited the above well on this date.

M.E. Butcher
DISTRICT WELL INSPECTOR

11/10/2023

STATE OF WEST VIRGINIA
DEPARTMENT OF MINES
OIL AND GAS WELLS DIVISION

INSPECTOR'S WELL REPORT

Permit No. _____

Oil or Gas Well _____
(KIND)

Company _____ Address _____ Farm _____ Well No. _____ District _____ County _____ Drilling commenced _____ Drilling completed _____ Total depth _____ Date shot _____ Depth of shot _____ Initial open flow _____ /10ths Water in _____ Inch Open flow after tubing _____ /10ths Merc. in _____ Inch Volume _____ Cu. Ft. Rock pressure _____ lbs. _____ hrs. Oil _____ bbls., 1st 24 hrs. Fresh water _____ feet Salt water _____ feet	CASING AND TUBING	USED IN DRILLING	Left in Well	PACKERS
	Size			
16				
13				Size of _____
10				Depth set _____
8 1/4				
6 3/4				Perf. top _____
5 3/16				Perf. bottom _____
3				Perf. top _____
2				Perf. bottom _____
Liners Used				Perf. top _____
				Perf. bottom _____

CASING CEMENTED _____ SIZE _____ No. FT. _____ Date _____

NAME OF SERVICE COMPANY _____

COAL WAS ENCOUNTERED AT _____ FEET _____ INCHES

_____ FEET _____ INCHES _____ FEET _____ INCHES

_____ FEET _____ INCHES _____ FEET _____ INCHES

Drillers' Names _____

Remarks: _____

B-4

STATE OF WEST VIRGINIA
DEPARTMENT OF MINES
OIL AND GAS WELLS DIVISION

RECEIVED
DEC - 1 1978

INSPECTOR'S PLUGGING REPORT

OIL & GAS DIVISION
DEPT. OF MINES

Permit No. Way-684P Well No. 1

COMPANY Gas Supply Corp. ADDRESS Javallette, W.Va.

FARM Robert Adams DISTRICT Union COUNTY Waymi

Filling Material Used Clay stone Cement

Liner Location Amount Packer Location

PLUGS USED AND DEPTH PLACED

BRIDGES

CASING AND TUBING

CEMENT-THICKNESS WOOD-SIZE LEAD CONSTRUCTION-LOCATION RECOVERED SIZE LOST

1070-1100 Claystone 750-1070

Will recover all 7" pipe. 1629 7"

Drillers' Names Willard Franklin
Conr. Willard Franklin

Remarks:

11-29-78

DATE I hereby certify I visited the above well on this date.

K. E. Butcher
DISTRICT WELL INSPECTOR

11/10/2023

503

STATE OF WEST VIRGINIA
DEPARTMENT OF MINES
OIL AND GAS WELLS DIVISION

INSPECTOR'S WELL REPORT

Permit No. _____

Oil or Gas Well _____
(KIND)

Company _____ Address _____ Farm _____ Well No. _____ District _____ County _____ Drilling commenced _____ Drilling completed _____ Total depth _____ Date shot _____ Depth of shot _____ Initial open flow _____ /10ths Water in _____ Inch Open flow after tubing _____ /10ths Merc. in _____ Inch Volume _____ Cu. Ft. Rock pressure _____ lbs. _____ hrs. Oil _____ bbls., 1st 24 hrs. Fresh water _____ feet _____ feet Salt water _____ feet _____ feet	CASING AND TUBING	USED IN DRILLING	Left in Well	PACKERS
	Size			
16				
13				Size of _____
10				
8 1/4				Depth set _____
6 3/8				
5 3/16				Perf. top _____
3				Perf. bottom _____
2				Perf. top _____
Liners Used _____				Perf. bottom _____

CASING CEMENTED _____ SIZE _____ No. FT. _____ Date _____

NAME OF SERVICE COMPANY _____

COAL WAS ENCOUNTERED AT _____ FEET _____ INCHES

_____ FEET _____ INCHES _____ FEET _____ INCHES

_____ FEET _____ INCHES _____ FEET _____ INCHES

Drillers' Names _____

Remarks: _____

11/10/2023

B-5

STATE OF WEST VIRGINIA
DEPARTMENT OF MINES
OIL AND GAS WELLS DIVISION

RECEIVED

DEC - 4 1978

OIL & GAS DIVISION
DEPT. OF MINES

INSPECTOR'S PLUGGING REPORT

Permit No. Way 684P Well No. _____

COMPANY Gas supply Corp ADDRESS Jewett, WVA.

FARM Robert Adkins DISTRICT Union COUNTY Wayne

Filling Material Used Clay Stone Cement

Liner Location Amount Packer Location

PLUGS USED AND DEPTH PLACED			BRIDGES	CASING AND TUBING		
CEMENT-THICKNESS	WOOD-SIZE	LEAD	CONSTRUCTION-LOCATION	RECOVERED	SIZE	LOST
	<u>Clay Stone</u>		<u>385-1070</u>			

Drillers' Names Willard Franklin
Center, Willard Franklin

Remarks: Well is filled as 7" pipe is pulled.

11-30-78 I hereby certify I visited the above well on this date.
DATE

H. C. Butcher
DISTRICT WELL INSPECTOR
11/10/2023

503

STATE OF WEST VIRGINIA
DEPARTMENT OF MINES
OIL AND GAS WELLS DIVISION

INSPECTOR'S WELL REPORT

Permit No. _____

Oil or Gas Well _____
(KIND)

Company _____ Address _____ Farm _____ Well No. _____ District _____ County _____ Drilling commenced _____ Drilling completed _____ Total depth _____ Date shot _____ Depth of shot _____ Initial open flow _____ /10ths Water in _____ Inch Open flow after tubing _____ /10ths Merc. in _____ Inch Volume _____ Cu. Ft. Rock pressure _____ lbs. _____ hrs. Oil _____ bbls., 1st 24 hrs. Fresh water _____ feet _____ feet Salt water _____ feet _____ feet	CASING AND TUBING	USED IN DRILLING	Left in Well	PACKERS
	Size			Kind of Packer _____
	16			
	13			
	10			Size of _____
	8 1/4			
	6 3/8			Depth set _____
	5 3/16			
	3			Perf. top _____
	2			Perf. bottom _____
	Liners Used _____			Perf. top _____
				Perf. bottom _____

CASING CEMENTED _____ SIZE _____ No. FT. _____ Date _____

NAME OF SERVICE COMPANY _____

COAL WAS ENCOUNTERED AT _____ FEET _____ INCHES

_____ FEET _____ INCHES _____ FEET _____ INCHES

_____ FEET _____ INCHES _____ FEET _____ INCHES

Drillers' Names _____

Remarks: _____

STATE OF WEST VIRGINIA
DEPARTMENT OF MINES
OIL AND GAS WELLS DIVISION

INSPECTOR'S WELL REPORT

Permit No. _____

Oil or Gas Well _____
(KIND)

Company _____ Address _____ Farm _____ Well No. _____ District _____ County _____ Drilling commenced _____ Drilling completed _____ Total depth _____ Date shot _____ Depth of shot _____ Initial open flow _____ /10ths Water in _____ Inch Open flow after tubing _____ /10ths Merc. in _____ Inch Volume _____ Cu. Ft. Rock pressure _____ lbs. _____ hrs. Oil _____ bbls., 1st 24 hrs. Fresh water _____ feet _____ feet Salt water _____ feet _____ feet	CASING AND TUBING	USED IN DRILLING	Left in Well	PACKERS
	Size			Kind of Packer _____
	16			
	13			
	10			Size of _____
	8 1/4			
	6 5/8			Depth set _____
	5 3/16			
	3			Perf. top _____
	2			Perf. bottom _____
	Liners Used _____			Perf. top _____
				Perf. bottom _____

CASING CEMENTED _____ SIZE _____ No. FT. _____ Date _____

NAME OF SERVICE COMPANY _____

COAL WAS ENCOUNTERED AT _____ FEET _____ INCHES

_____ FEET _____ INCHES _____ FEET _____ INCHES

_____ FEET _____ INCHES _____ FEET _____ INCHES

Drillers' Names _____

Remarks: _____

B-7

STATE OF WEST VIRGINIA
DEPARTMENT OF MINES
OIL AND GAS WELLS DIVISION

RECEIVED

DEC - 6 1978

INSPECTOR'S PLUGGING REPORT

OIL & GAS DIVISION
DEPT. OF MINES

Permit No. Way-684P Well No. 1
COMPANY Gas Supply Corp. ADDRESS Javalette, W Va.
FARM Robert Adams DISTRICT Union COUNTY Wayne
Filling Material Used Clay Stone Cement

Liner Location Amount Packer Location

PLUGS USED AND DEPTH PLACED

BRIDGES

CASING AND TUBING

PLUGS USED AND DEPTH PLACED			BRIDGES	CASING AND TUBING		
CEMENT-THICKNESS	WOOD-SIZE	LEAD	CONSTRUCTION-LOCATION	RECOVERED	SIZE	LOST

Finish pulling 7" pipe.

Drillers' Names Willard Franklin
Contr. Willard Franklin
Remarks:

12-4-78
DATE

I hereby certify I visited the above well on this date.

K.E. Butcher
11/10/2023
DISTRICT WELL INSPECTOR

STATE OF WEST VIRGINIA
DEPARTMENT OF MINES
OIL AND GAS WELLS DIVISION

INSPECTOR'S WELL REPORT

Permit No. _____

Oil or Gas Well _____
(KIND)

Company _____	CASING AND TUBING	USED IN DRILLING	Left in Well	PACKERS
Address _____	Size			
Farm _____	16			Kind of Packer _____
Well No. _____	13			
District _____ County _____	10			Size of _____
Drilling commenced _____	8 1/4			Depth set _____
Drilling completed _____ Total depth _____	6 3/8			Perf. top _____
Date shot _____ Depth of shot _____	5 3/16			Perf. bottom _____
Initial open flow _____ /10ths Water in _____ Inch	3			Perf. top _____
Open flow after tubing _____ /10ths Merc. in _____ Inch	2			Perf. bottom _____
Volume _____ Cu. Ft.	Liners Used _____			Perf. top _____
Rock pressure _____ lbs. _____ hrs.	CASING CEMENTED _____ SIZE _____ No. FT. _____ Date _____			
Oil _____ bbls., 1st 24 hrs.	NAME OF SERVICE COMPANY _____			
Fresh water _____ feet _____ feet	COAL WAS ENCOUNTERED AT _____ FEET _____ INCHES			
Salt water _____ feet _____ feet	_____ FEET _____ INCHES _____ FEET _____ INCHES			
	_____ FEET _____ INCHES _____ FEET _____ INCHES			

Drillers' Names _____

Remarks: _____

DATE _____

DISTRICT WELL INSPECTOR 11/10/2023

STATE OF WEST VIRGINIA
DEPARTMENT OF MINES
OIL AND GAS WELLS DIVISION

INSPECTOR'S WELL REPORT

Permit No. _____

Oil or Gas Well _____
(KIND)

Company _____	CASING AND TUBING	USED IN DRILLING	Left in Well	PACKERS
Address _____	Size			Kind of Packer _____
Farm _____	16			
Well No. _____	13			
District _____ County _____	10			Size of _____
Drilling commenced _____	8 1/4			
Drilling completed _____ Total depth _____	6 3/8			Depth set _____
Date shot _____ Depth of shot _____	5 3/16			
Initial open flow _____ /10ths Water in _____ Inch	3			Perf. top _____
Open flow after tubing _____ /10ths Merc. in _____ Inch	2			Perf. bottom _____
Volume _____ Cu. Ft.	Liners Used			Perf. top _____
Rock pressure _____ lbs. _____ hrs.				Perf. bottom _____

CASING CEMENTED _____ SIZE _____ No. FT. _____ Date _____

NAME OF SERVICE COMPANY _____

COAL WAS ENCOUNTERED AT _____ FEET _____ INCHES

_____ FEET _____ INCHES _____ FEET _____ INCHES

_____ FEET _____ INCHES _____ FEET _____ INCHES

Drillers' Names _____

Remarks: _____

DATE _____

DISTRICT WELL INSPECTOR 11/10/2020

c-7

STATE OF WEST VIRGINIA
DEPARTMENT OF MINES
OIL AND GAS WELLS DIVISION

RECEIVED
DEC 11 1978

INSPECTOR'S PLUGGING REPORT OIL & GAS DIVISION
DEPT. OF MINES

Permit No. 47-099-0684 P Well No. _____

COMPANY Gas Supply Corp ADDRESS Javalette, wva,

FARM Robert Adkins DISTRICT Union COUNTY Wayne

Filling Material Used Clay Stone Cement

PLUGS USED AND DEPTH PLACED			BRIDGES	CASING AND TUBING		
CEMENT-THICKNESS	WOOD-SIZE	LEAD	CONSTRUCTION-LOCATION	RECOVERED	SIZE	LOST
<u>0 - 30</u>						

Drillers' Names Willard Franklin
Centr. Willard Franklin

Remarks: Finished on this date.

12-8-78 I hereby certify I visited the above well on this date.
DATE

K.E. Butts
DISTRICT WELL INSPECTOR
503
11/10/2023

STATE OF WEST VIRGINIA
DEPARTMENT OF MINES
OIL AND GAS WELLS DIVISION

INSPECTOR'S WELL REPORT

Permit No. 47-099-0684P

Oil or Gas Well _____
(KIND)

Company	CASING AND TUBING	USED IN DRILLING	Left in Well	PACKERS
<u>Go</u>	Size			
Address _____	16			Kind of Packer _____
Farm _____	13			
Well No. _____	10			Size of _____
District _____ County _____	8 1/4			
Drilling commenced _____	6 3/4			Depth set _____
Drilling completed _____ Total depth _____	5 3/16			
Date shot _____ Depth of shot _____	3			Perf. top _____
Initial open flow _____ /10ths Water in _____ Inch	2			Perf. bottom _____
Open flow after tubing _____ /10ths Merc. in _____ Inch	Liners Used _____			Perf. top _____
Volume _____ Cu. Ft.				Perf. bottom _____
Rock pressure _____ lbs. _____ hrs.	CASING CEMENTED _____ SIZE _____ No. FT. _____ Date _____			
Oil _____ bbls., 1st 24 hrs.	NAME OF SERVICE COMPANY _____			
Fresh water _____ feet _____ feet	COAL WAS ENCOUNTERED AT _____ FEET _____ INCHES			
Salt water _____ feet _____ feet	_____ FEET _____ INCHES _____ FEET _____ INCHES			
	_____ FEET _____ INCHES _____ FEET _____ INCHES			

Drillers' Names _____

Remarks: _____

PROPOSED MANNER OF PLUGGING AND FILLING WELL

(REQUIRED BY RULES AND REGULATIONS)

WEST VIRGINIA DEPARTMENT OF MINES

OIL AND GAS DIVISION

WORK ORDER

Well to be plugged and filled as follows: **TOTAL DEPTH 3178**

Bridge hole 2250-30' below berea sand put in bridge 2250= Put 10' of cement on bridge 2250-2240. Put red clay 2240-2140. Bridge hole at 1742 - 30' below 7" casing. Put in 10' of cement 1742-1732 = Pull 7" casing fill hole with mud and clay 1732-1632 bridge hole at 110'. Put in 10' of cement fill hole with mud and clay 100 to 3' fill hole with cement 3' to 3' above surface: Marking on top of cement Robert Adkins Well No. 1. Abandoned DATE

T.D. 3205.
 fill to 2250.
 Clay 2250-2200
 Cement 2200-2150
 fill material 2150-1450 pulling 1629' of 6 5/8" casing
 Clay 1450-1400
 Cement 1400-1370
 fill material 1370-1100
 Cement 1100-1070
 fill material 1070-385
 Pull 383' 8" of 10" casing
 Clay 385-320
 Cement 320-290
 Clay 290-30
 Cement 30' to surface
 Erect Monument - - -

To the Department of Mines
 Coal Owner or Operator,
 Lease or Property Owner.

Gentlemen:

This "work order" is submitted for your approval. In case of disapproval or non-concurrence, the undersigned will proceed with the well in the above described manner on the date inspected.

Very

PS Form 3811, Nov. 1976

● SENDER: Complete items 1, 2, and 3. Add your address in the "RETURN TO" space on reverse.

1. The following service is requested (check one).
 Show to whom and date delivered25¢
 Show to whom, date, & address of delivery45¢
 RESTRICTED DELIVERY. Show to whom and date delivered85¢
 RESTRICTED DELIVERY. Show to whom, date, and address of delivery ..\$1.05
 (Fees shown are in addition to postage charges and other fees).

2. ARTICLE ADDRESSED TO:
 Gas Supply Corporation
 Box 56 (Attn: Paul Mullens)
 Lavalette, W.Va. 25535

3. ARTICLE DESCRIPTION:
 REGISTERED NO. CERTIFIED NO. INSURED NO.
 108

(Always obtain signature of addressee or agent)

I have received the article described above.
 SIGNATURE Addressee Authorized agent
 [Signature]

4. DATE OF DELIVERY 3/1/79 POSTMARK

5. ADDRESS (Complete only if requested)

6. UNABLE TO DELIVER BECAUSE: CLERK'S INITIALS

RETURN RECEIPT, REGISTERED, INSURED AND CERTIFIED MAIL

☆ GOP: 1976-O-203-456

Well Operator

No objections have been filed by the coal owner or coal operator, or any available adjacent lease or property owners or interposed by the Department of Mines to the manner herein described for the plugging and filling of the well above mentioned. Therefore, the same is hereby approved this

8th day of Nov., 1978

DEPARTMENT OF MINES
 Oil and Gas Division 11/10/2023

By: [Signature]

NOTE: This "work order" shall be filed in triplicate, one copy for the files of the Department of Mines; one to be approved or corrected and returned to the well operator as his authority for plugging said well; and one for the well inspector.



RECEIVED

OCT 12 1978

STATE OF WEST VIRGINIA
DEPARTMENT OF MINES
OIL AND GAS WELLS DIVISION

OIL & GAS DIVISION
DEPT. OF MINES

NOTICE OF INTENTION TO PLUG AND ABANDON WELL

(REQUIRED BY SECTION 9, ARTICLE 4, CHAPTER 22 OF THE CODE)

To THE DEPARTMENT OF MINES,
Charleston, W. Va.

Coal Operator	<u>Gas Supply Corporation</u>
	Name of Well Operator
Address	<u>Box 56, Lavalette, W. Va. 25535</u>
	Complete Address
Coal Owner	<u>October 9, 1978</u>
	Date
Address	<u>Union</u> WELL TO BE ABANDONED
	District
Lease or Property Owner	<u>Wayne</u> County
	County
Address	Well No. <u>1</u>
	<u>Robert Adkins</u> Farm
	Farm

Inspector Kenneth Butcher Telephone 736-4885

TO BE NOTIFIED 24 HOURS IN ADVANCE OF PLUGGING OPERATIONS

Gentlemen:—

The undersigned well operator is about to abandon the above described well and will commence

the work of plugging and abandoning said well on the date inspector is notified (which date shall not be less than five days after the day on which this notice so mailed is received, or in due course should be received by the Department of Mines).

This notice is given you in order that your respective representatives may be present at the plugging and filling of said well. You are further notified that whether you are represented or not represented the undersigned will proceed on that date, or shortly thereafter, to plug and fill said well in the manner required by Section 10, Article 4, Chapter 22 of the Code and given in detail on the reverse side of this notice, in "Work Order."

This notice is being mailed by registered mail to each of you at the above addresses on the above date.

Very truly yours,

Paul Mullins Pres
Well Operator

NOTE: Upon the abandonment of any well drilled prior to June 1, 1929, a plat prepared by a registered engineer, shall be filed with THREE COPIES OF APPLICATION, (OG-9) AND "WORK ORDER" AND TWO COPIES OF THE WELL RECORD, (OG-10). The map must show the district and county in which the tract of land is located, the name and acreage of same, the name or names of the owners and names of adjacent tracts and the location of the well to be abandoned, determined by survey with the courses and distances of such well from two permanent points or landmarks on said tract, in compliance with Rule 5 of the Rules and Regulations.

NOTE: In case plugging is not commenced within four months from the date of permit, same shall expire and be of no further force or effect.

NOTE: PERMIT IS NON TRANSFERABLE.

BOND PLUG

AFFIDAVIT, FORM OG-8, MANNER WELL PLUGGED MUST BE SUBMITTED TO OBTAIN RELEASE OF WELL UNDER BOND.

way-684-P
Permit Number

47-099

11/10/2023

RECEIVED

JAN 15 1979

FORM OG-8

STATE OF WEST VIRGINIA
DEPARTMENT OF MINES
OIL AND GAS WELLS DIVISION

OIL & GAS DIVISION
DEPT. OF MINES

AFFIDAVIT OF PLUGGING AND FILLING WELL

AFFIDAVIT SHOULD BE MADE IN TRIPLICATE, ONE COPY MAILED TO THE DEPARTMENT, ONE COPY TO BE RETAINED BY THE WELL OPERATOR AND THE THIRD COPY (AND EXTRA COPIES IF REQUIRED) SHOULD BE MAILED TO EACH COAL OPERATOR AT THEIR RESPECTIVE ADDRESSES.

COAL OPERATOR OR OWNER Gas Supply Corporation
NAME OF WELL OPERATOR
 ADDRESS 5656 Bloss Road
Lavalette, W. Va. 25535
COMPLETE ADDRESS

COAL OPERATOR OR OWNER December 15 1978
WELL AND LOCATION

ADDRESS Union District

LEASE OR PROPERTY OWNER Wayne County

ADDRESS Well No. 1
Robert Adkins Farm

STATE INSPECTOR SUPERVISING PLUGGING Kenneth Butcher

AFFIDAVIT

STATE OF WEST VIRGINIA,

County of Wayne

SS:

Willard Franklin

and Paul Mullens

being first duly sworn according to law depose and say that they are experienced in the work of plugging and filling oil and gas wells and were employed by Gas Supply Corporation, well operator, and participated in the work of plugging and filling the above well, that said work was commenced on the 15 day of November, 1978, and that the well was plugged and filled in the following manner:

SAND OR ZONE RECORD	FILLING MATERIAL	PLUGS USED	CASING	
			CSG PULLED	CSG LEFT IN
FORMATION	T.D. 3,205	SIZE & KIND		
salt sand 975-1135	fill to 2250			
maxin sand 1165-1295	red clay 2250-2200			
big line 1403-1570	cement 2200-2150	50ft. cement		
little line 1370-1400	filled 2150-1450	pulling pipe		
engine sand 1570-1600	red clay 1450-1400	as we filled		
coffee shale 2175-2205	cement 1400-1370	30 ft. cement		
berrea grit 2205-2220	filled 1370-1100			
brown shale 2805-2920	cement 1100-1070	30 ft. cement		
white slate 2920-2925	filled 1070-385			
brown shale 2925-3178	red clay 385-320	pulled 10" casing		
white slate 3178-3205	cement 320-290	30ft. cement		
	red clay 290-30			
	cement 30 to surface			
COAL SEAMS		DESCRIPTION OF MONUMENT		
(NAME)		marking on top of cement		
(NAME)		Robert Adkins Well No. 1		
(NAME)		abn: 14 day Dec. 1978		
(NAME)				

and that the work of plugging and filling said well was completed on the 14th day of December, 1978.

And further deponents saith not.

Sworn to and subscribed before me this 12 day of January, 1979.

My commission expires:

9-9-81

Willard Franklin
Paul Mullens
Carolyn Mullens
 Notary Public.
 Permit No. Way-684-P
47-099

11/10/2023

11/10/2023

STATE OF WEST VIRGINIA
DEPARTMENT OF MINES
OIL AND GAS WELLS DIVISION

RECEIVED

FEB 28 1979

INSPECTOR'S WELL REPORT

OIL & GAS DIVISION
DEPT. OF MINES

Permit No. Way 47-099-0684P

Oil or Gas Well _____
(KIND)

Company	CASING AND TUBING	USED IN DRILLING	LEFT IN WELL	PACKERS
<u>Gas Supply Co.</u>				
<u>Javalette wva,</u>	Size			
<u>Robert Adkins</u>	<u>10</u>			Kind of Packer _____
<u>1</u>	<u>13</u>			
<u>Union County Wayne</u>	<u>10</u>			Size of _____
	<u>8 1/4</u>			
	<u>6 5/8</u>			Depth set _____
	<u>5 3/16</u>			
	<u>3</u>			Perf. top _____
	<u>2</u>			Perf. bottom _____
	Liners Used			Perf. top _____
				Perf. bottom _____
	CASING CEMENTED _____	SIZE _____	No. FT. _____	Date _____
	NAME OF SERVICE COMPANY _____			
	COAL WAS ENCOUNTERED AT _____ FEET _____ INCHES			
	_____ FEET _____ INCHES _____ FEET _____ INCHES			
	_____ FEET _____ INCHES _____ FEET _____ INCHES			

Drillers' Names _____

Remarks: Final inspection made on this well.

2-27-79

DATE

K.E. Butcher
DISTRICT WELL INSPECTOR

503

11/10/2023



State of West Virginia

Department of Mines
Oil and Gas Division

Charleston 25305
February 28, 1979

WALTER N. MILLER
DIRECTOR

ROBERT L. DODD - P. E.
DEPUTY DIRECTOR

Gas Supply Corporation
Box 56
Lavalette, W.Va. 25535

Attn: Paul Mullens

In Re: PERMIT NO WAY-684-P
FARM Robert Adkins
WELL NO One
DISTRICT Union
COUNTY Wayne

Gentlemen:

The Final Inspection Report for the above described well has been received in this office. Only the column checked below applies.

Blanket The well designated by the above permit number has been released under your Bond.

XXXXX Please return the enclosed cancelled Single Bond which covered the well designated by the above permit number to the Surety Company who executed said bond in your behalf, in order that they may give you credit on their records.

 Your well record was received and reclamation requirements approved. In accordance with Chapter 22, Article 4, Section 2, the above captioned well will remain under bond coverage for life of the well.

Very truly yours,

Robert L. Dodd

RLD/chm

Encl: Single Bond dated 10-10-78 (National Grange Mutual Insurance Co.)