



STATE OF WEST VIRGINIA  
DEPARTMENT OF MINES  
OIL AND GAS DIVISION

NOTICE OF PROPOSED LOCATION OF OIL AND GAS WELL

To THE DEPARTMENT OF MINES,  
Charleston, W. Va.

None  
COAL OPERATOR OR COAL OWNER

ADDRESS

COAL OPERATOR OR COAL OWNER

ADDRESS

UNITED FUEL GAS CO.  
OWNER OF MINERAL RIGHTS

P.O. Box 1273, Charleston 25, W. Va.  
ADDRESS

UNITED FUEL GAS CO.  
NAME OF WELL OPERATOR

% G. H. Moore  
P.O. Box 1273, Charleston 25, W. Va.  
COMPLETE ADDRESS

September 30, 19 48

PROPOSED LOCATION

Lincoln District

Wayne County

Well No. 6422 38°00'  
82°20'

UNITED FUEL GAS CO. Farm

GENTLEMEN:

The undersigned well operator is entitled to drill upon the above named farm or tract of land for oil and gas, having fee title thereto, (or as the case may be) under ~~grant~~ <sup>Deed</sup> or lease dated February 15, 1926, made by Ray Coffman et ux, to The Old Colony O. & G. Co., and recorded on the 28th day of February 1926, in the office of the County Clerk for said County in Book 148, page 87.

The enclosed plat was prepared by a competent engineer and shows the proposed location of a well to be drilled for oil and gas by the undersigned well operator on the farm and in the Magisterial District and County above named, determined by survey and courses and distances from two permanent points, or land marks.

The undersigned well operator is informed and believes there are no coal operators operating beds of coal beneath said farm or tract of land on which said well is located, or within 500 feet of the boundaries of the same, who have mapped their workings and filed their maps as required by law, excepting the coal operators or coal owners (if any) above named as addressees.

The above named coal operators or coal owners (if any) are notified that any objections they may desire to make to such proposed location, or which they are required to make by Section 3 of said Code, if the drilling of a well at said proposed location will cause a dangerous condition in or about their respective coal mines, must be received by, or filed with the Department of Mines within ten\* days from the receipt of a copy of this notice and accompanying plat by said Department. Said coal operators are further notified that forms for use in making such objections will be furnished to them by the Department of Mines promptly on request and that all such objections must set forth as definitely as is reasonably possible the ground or grounds on which such objections are based and indicate the direction and distance the proposed location should be moved to overcome same.

(The next paragraph is to be completed only in Department's copy.)

Copies of this notice and the enclosed plat were mailed by registered mail, or delivered to the above named coal operators or coal owners at their above shown respective address same day before, or on the same day with the mailing or delivery of this copy to the Department of Mines at Charleston, West Virginia.

Very truly yours,

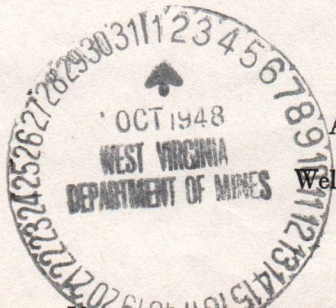

Address of Well Operator }

UNITED FUEL GAS CO.  
WELL OPERATOR

% G. H. Moore  
STREET

P.O. Box 1273, Charleston 14/17/2023  
CITY OR TOWN

West Virginia  
STATE

\*Section 3 . . . . If no such objections be filed or be found by the department of mines, within said period of ten days from the receipt of said notice and plat by the department of mines, to said proposed location, the department shall forthwith issue to the well operator a drilling permit reciting the filing of such plat, that no objections have been made by the coal operators to the location, or found thereto by the department, and that the same is approved and the well operator authorized to proceed to drill at said location.

617



Rec 7-11-80

Date July 9 1980  
Well No. 6422  
API No. 47 - Way - 617  
State County Permit

STATE OF WEST VIRGINIA  
OFFICE OF OIL AND GAS

Company Name Columbia Gas Trans Corp. Designated Agent Col. Gas. Trans Corp.  
Address P.O. Box 1273 - Chas. W.V. Address P.O. Box 98, Wayne, W. Va  
Telephone (304) 346-0951 Telephone 304-272-5556  
Landowner Columbia Gas Trans Corp. Soil Cons. District Guyan  
Revegetation to be carried out by Columbia Gas Trans. Corp. (Agent)  
This plan has been reviewed by Guyan SCD. All corrections  
and additions become a part of this plan. 7/18/80 (Date) Paul R. Doherty (SCD Agent)

Access Road	Location
Structure <u>Culvert</u> (A)	Structure _____ (1)
Spacing <u>5' dia.</u>	Material _____
Page Ref. Manual _____	Page Ref. Manual _____
Structure <u>Pit &amp; Relief Cross Drains</u> (B)	Structure _____ (2)
Spacing <u>See Manual</u>	Material _____
Page Ref. Manual <u>1:3, 1:5, 1:6</u>	Page Ref. Manual _____
Structure _____ (C)	Structure _____
Spacing _____	Material _____
Page Ref. Manual _____	Page Ref. Manual _____

RECEIVED

OCT 14 1980

OIL AND GAS DIVISION  
WEST VIRGINIA DEPARTMENT OF MINES

RECEIVED

JUL 22 1980

OIL & GAS DIVISION  
DEPT. OF MINES

All structures should be inspected regularly and repaired if necessary

Revegetation

Treatment Area I		Treatment Area II	
Lime _____ 3 Tons/acre	Lime _____ Tons/Acre	or correct to pH <u>6.5</u>	or correct to pH _____
Fertilizer <u>500#</u> lbs/acre	Fertilizer _____ lbs/acre	(10-20-20 or equivalent)	(10-20-20 or equivalent)
Mulch <u>Straw 45</u> bales 1/2 Tons/Acre	Mulch _____ Tons/Acre		
Seed* <u>K-31 25</u> lbs/acre	Seed* _____ lbs/acre		
_____ lbs/acre	_____ lbs/acre		
_____ lbs/acre	_____ lbs/acre		

\*Inoculate all legumes such as vetch, trefoil and clovers with the proper bacterium. Inoculate with 3X recommended amount.

Attach or photocopy section of involved Topographic map. Quadrangle Webb

Legend: ⊕ Well Site





Well Site Plan

- |         |                  |            |
|---------|------------------|------------|
| Legend: | Property Boundry | Diversion  |
|         | Road             | Spring     |
|         | Existing Fence   | Wet Spot   |
|         | Planned Fence    | Building   |
|         | Stream           | Drain Pipe |
|         | Open Ditch       | Waterway   |

Sketch to include well location, existing access road, roads to be constructed, wellsite, drilling pits and necessary structures numbered or lettered to correspond with first part of this plan. Include all natural drainage.

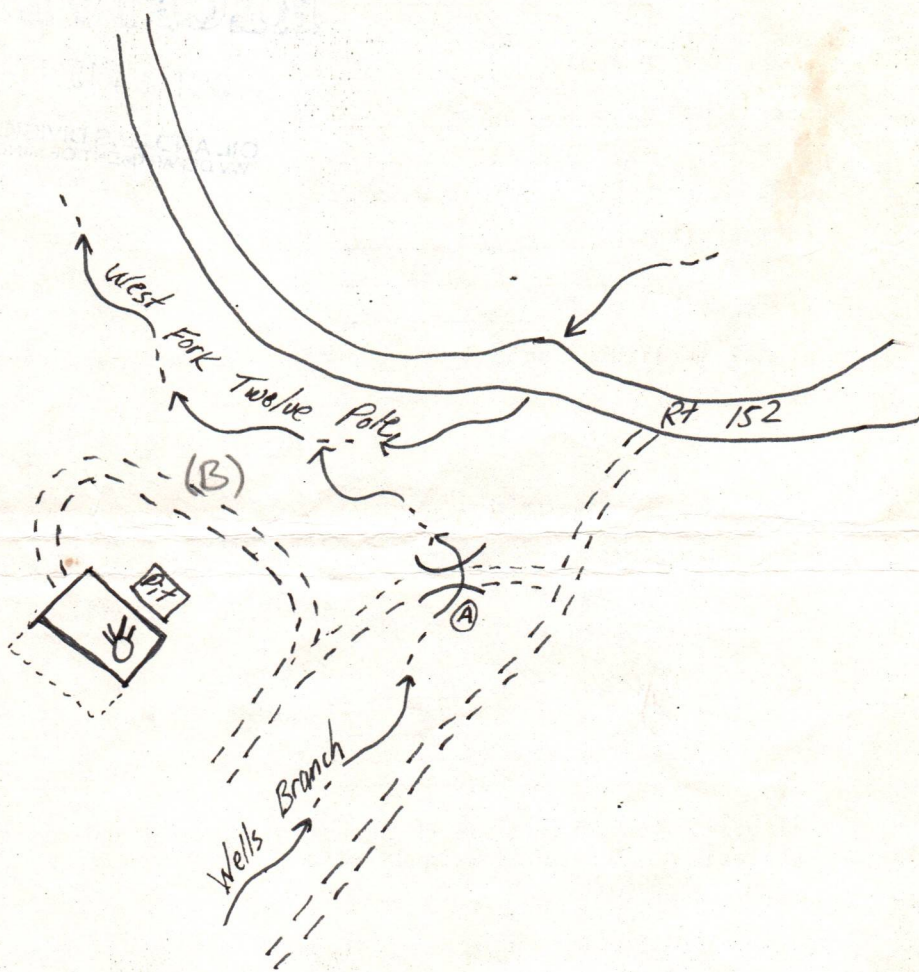

Comments: Well is to be logged and evaluated. Location is limited an enlarging is necessary. A large diameter drain will be needed to provide creek crossing. Reclamation of location as prescribed on this form.

Signature: Chuck Roberts Edwina Box 98 11/17/2023  
Address Phone Number

Please request landowners cooperation to protect new seeding for one growing season.



October 11, 1949

United Fuel Gas Company  
c/o G. H. Moore  
Box 1275  
Charleston, West Virginia

Gentlemen:

Enclosed is permit WAY-617 to drill Well  
No. 6422 on the United Fuel Gas Company Farm, Lincoln  
District, Wayne County.

Very truly yours,

Administrative Assistant  
OIL AND GAS DIVISION

CHH:K  
Encl-2

CC: Inspector D. E. Lawson

11/17/2023



Formation	Color	Hard or Soft	Top	Bottom	Oil, Gas or Water	Depth Found	Remarks
							<p>Test before shot 6/10 M-2" 381 M  Shot 10-13-48 with 6300# Gel. from 2035-2982.  Test 17 Hr. after shot 8/10 Merc. 2" 440 M.</p> <p>OPEN FLOW - 440 M - Shale  R.P. 278# 48 Hrs.</p> <p>Shut in 10-14-48 in 6-5/8" Casing.</p>
			Way 617				

11/17/2023

Date January 13, 1949

APPROVED United Fuel Gas Co., Owner

By *G.H. Moore*  
Chief Engineer (Title) R.





STATE OF WEST VIRGINIA  
DEPARTMENT OF MINES  
OIL AND GAS DIVISION

*Naugatuck*

WELL RECORD

Permit No. WAY-617

Oil or Gas Well Gas  
(KIND)

Company United Fuel Gas Co.  
Address P. O. Box 1273, Charleston 25, W. Va.  
Farm U.F.G. Co. Min. Well #3 Acres 6473  
Location (waters) East Fk of 12 Pole Cr.  
Well No. 6422 Elev. 904.83  
District Lincoln County Wayne  
The surface of tract is owned in fee by \_\_\_\_\_  
Address \_\_\_\_\_  
Mineral rights are owned by United Fuel Gas Co.  
P. O. Box 1273 Address Chas. 25, W. Va.  
Drilling commenced 8-18-48  
Drilling completed 10-11-48  
Date Shot 10-13-48 From 2035 To 2982  
With 6300# Gel.  
Open Flow /10ths Water in \_\_\_\_\_ Inch  
8 /10ths Merc. in 2" Inch  
Volume 440 M - Shale Cu. Ft.  
Rock Pressure 278 lbs. 48 hrs.  
Oil \_\_\_\_\_ bbls., 1st 24 hrs.  
Fresh water 120 feet \_\_\_\_\_ feet  
Salt water 760 feet \_\_\_\_\_ feet

Casing and Tubing	Used in Drilling	Left in Well	Packers
Size			Kind of Packer
16			
13			
10	300	300	Size of
8 1/4			
6 5/8	1321	1321	Depth set
5 3/16			
3			Perf. top
2			Perf. bottom
Liners Used			Perf. top
			Perf. bottom

CASING CEMENTED \_\_\_\_\_ SIZE \_\_\_\_\_ No. Ft. \_\_\_\_\_ Date \_\_\_\_\_  
COAL WAS ENCOUNTERED AT \_\_\_\_\_ FEET \_\_\_\_\_ INCHES  
\_\_\_\_\_ FEET \_\_\_\_\_ INCHES \_\_\_\_\_ FEET \_\_\_\_\_ INCHES  
\_\_\_\_\_ FEET \_\_\_\_\_ INCHES \_\_\_\_\_ FEET \_\_\_\_\_ INCHES

Formation	Color	Hard or Soft	Top	Bottom	Oil, Gas or Water	Depth Found	Remarks
Soil			0	12			
Sand			12	31			
Slate			31	60			
Sand			60	85			
Slate			85	110	Water	120'	
Sand			110	220			
Slate			220	285			
Sand			285	347			
Slate			347	432			
Sand			432	460			
Slate & Shells			460	577			
Sand			577	595			
Slate & Shells			595	700	Water	760'	
Sand			700	894			
Slate & Shells			894	974			
Sand			974	1045			
Slate & Shells			1045	1145			
Sand			1145	1244			
Slate			1244	1285			
Black Lime			1285	1309			
Big Lime			1309	1493			
Big Injun			1493	1548			
Slate & Shells			1548	2035	Gas	2054'	Show. 16/10 W 1" 42 M.
Berea Grit			2035	2173			
Brown Shale			2173	2220			
White Slate			2220	2445	Gas	2570'	34/10 W 1" 61M
Brown Shale			2445	2610			
White Slate			2610	2660	Gas	2730'	6/10 W 2" 103M
Brown Shale			2660	2970	Gas	2793'	20/10 W 7" OD
White Slate			2970	2982			20# 1.961 M.
Total Depth			2982'				Blew down to 6/10 M 2" 381 M.



11/17/2023







STATE OF WEST VIRGINIA  
DEPARTMENT OF MINES  
OIL AND GAS WELLS DIVISION

INSPECTOR'S WELL REPORT

Permit No. \_\_\_\_\_

Oil or Gas Well \_\_\_\_\_  
(KIND)

Company _____ Address _____ Farm _____ Well No. _____ District _____ County _____ Drilling commenced _____ Drilling completed _____ Total depth _____ Date shot _____ Depth of shot _____ Initial open flow _____ /10ths Water in _____ Inch Open flow after tubing _____ /10ths Merc. in _____ Inch Volume _____ Cu. Ft. Back pressure _____ lbs. _____ hrs. Oil _____ bbls., 1st 24 hrs. Fresh water _____ feet _____ feet Salt water _____ feet _____ feet	CASING AND TUBING	USED IN DRILLING	LEFT IN WELL	PACKERS
	Size			
	16			Kind of Packer _____
	13			
	10			Size of _____
	8 1/4			
	6 5/8			Depth set _____
	5 3/16			
	3			Perf. top _____
	2			Perf. bottom _____
	Liners Used			Perf. top _____
				Perf. bottom _____
	CASING CEMENTED _____ SIZE _____ No. FT. _____ Date _____			
	NAME OF SERVICE COMPANY _____			
	COAL WAS ENCOUNTERED AT _____ FEET _____ INCHES			
	_____ FEET	_____ INCHES	_____ FEET	_____ INCHES
	_____ FEET	_____ INCHES	_____ FEET	_____ INCHES

Drillers' Names \_\_\_\_\_

Remarks: \_\_\_\_\_

11/17/2023

DATE

DISTRICT WELL INSPECTOR







STATE OF WEST VIRGINIA  
DEPARTMENT OF MINES  
OIL AND GAS WELLS DIVISION

INSPECTOR'S WELL REPORT

Permit No. \_\_\_\_\_

Oil or Gas Well \_\_\_\_\_  
(KIND)

Company _____	CASING AND TUBING	USED IN DRILLING	LEFT IN WELL	PACKERS
Address _____	Size			
Farm _____	16			Kind of Packer _____
Well No. _____	13			
District _____ County _____	10			Size of _____
Drilling commenced _____	8 1/4			
Drilling completed _____ Total depth _____	6 5/8			Depth set _____
Date shot _____ Depth of shot _____	5 3/16			
Initial open flow _____ /10ths Water in _____ Inch	3			Perf. top _____
Open flow after tubing _____ /10ths Merc. in _____ Inch	2			Perf. bottom _____
Volume _____ Cu. Ft.	Liners Used _____			Perf. top _____
Suck pressure _____ lbs. _____ hrs.				Perf. bottom _____
Oil _____ bbls., 1st 24 hrs.	CASING CEMENTED _____ SIZE _____ No. FT. _____ Date _____			
Fresh water _____ feet _____ feet	NAME OF SERVICE COMPANY _____			
Salt water _____ feet _____ feet	COAL WAS ENCOUNTERED AT _____ FEET _____ INCHES			
	_____ FEET _____ INCHES _____ FEET _____ INCHES			
	_____ FEET _____ INCHES _____ FEET _____ INCHES			

Drillers' Names \_\_\_\_\_

Remarks: \_\_\_\_\_

11/17/2023







**STATE OF WEST VIRGINIA  
DEPARTMENT OF MINES  
OIL AND GAS WELLS DIVISION**

## INSPECTOR'S WELL REPORT

Permit No. \_\_\_\_\_

Oil or Gas Well \_\_\_\_\_  
(KIND)

	CASING AND TUBING	USED IN DRILLING	LEFT IN WELL	PACKERS
Company _____	Size			
Address _____	16 _____			Kind of Packer _____
Farm _____	13 _____			
Well No. _____	10 _____			Size of _____
District _____ County _____	8 1/4 _____			
Drilling commenced _____	6 5/8 _____			Depth set _____
Drilling completed _____ Total depth _____	5 3/16 _____			
Date shot _____ Depth of shot _____	3 _____			Perf. top _____
Initial open flow _____ /10ths Water in _____ Inch	2 _____			Perf. bottom _____
Open flow after tubing _____ /10ths Merc. in _____ Inch	Liners Used _____			Perf. top _____
Volume _____ Cu. Ft.				Perf. bottom _____
Back pressure _____ lbs. _____ hrs.	CASING CEMENTED _____ SIZE _____ No. FT. _____ Date _____			
Oil _____ bbls., 1st 24 hrs.	NAME OF SERVICE COMPANY _____			
Fresh water _____ feet _____ feet	COAL WAS ENCOUNTERED AT _____ FEET _____ INCHES			
Salt water _____ feet _____ feet	_____ FEET _____ INCHES _____ FEET _____ INCHES			
	_____ FEET _____ INCHES _____ FEET _____ INCHES			

Drillers' Names \_\_\_\_\_

Remarks: \_\_\_\_\_

11/17/2023



STATE OF WEST VIRGINIA  
DEPARTMENT OF MINES  
OIL AND GAS WELLS DIVISION

**INSPECTOR'S PLUGGING REPORT**

Permit No. 47-099-0617P Well No. 6423  
 COMPANY Col. Gas Trans Corp. ADDRESS Charleston, W. Va.  
 FARM Old Colony DISTRICT Juniata COUNTY Wayne  
 Filling Material Used Clay Stone Cement

Liner			Location	Amount	Packer	Location		
PLUGS USED AND DEPTH PLACED			BRIDGES			CASING AND TUBING		
CEMENT-THICKNESS	WOOD-SIZE	LEAD	CONSTRUCTION-LOCATION			RECOVERED	SIZE	LOST
Testing oil & preparing to lay this well.								
Col. Gas thinks that they may make an oil well out of this hole. This oil is in the Maxon sand. Maxon sand 1145-1244-								

Drillers' Names Kenneth Pennington  
Co. Tools

Remarks:

**RECEIVED**  
 JAN 22 1982  
 OIL AND GAS DIVISION  
 WV DEPARTMENT OF MINES

1-20-82  
DATE I hereby certify I visited the above well on this date.

K. E. Batches  
 503 11/17/2023  
DISTRICT WELL INSPECTOR



STATE OF WEST VIRGINIA  
DEPARTMENT OF MINES  
OIL AND GAS WELLS DIVISION

## INSPECTOR'S WELL REPORT

Permit No. \_\_\_\_\_

Oil or Gas Well \_\_\_\_\_  
(KIND)

	CASING AND TUBING	USED IN DRILLING	LEFT IN WELL	PACKERS
Company _____				
Address _____	Size			
Farm _____	16			Kind of Packer _____
Well No. _____	13			
District _____ County _____	10			Size of _____
Drilling commenced _____	8 1/4			
Drilling completed _____ Total depth _____	6 5/8			Depth set _____
Date shot _____ Depth of shot _____	5 3/16			
Initial open flow _____ /10ths Water in _____ Inch	3			Perf. top _____
Open flow after tubing _____ /10ths Merc. in _____ Inch	2			Perf. bottom _____
Volume _____ Cu. Ft.	Liners Used			Perf. top _____
Rock pressure _____ lbs. _____ hrs.				Perf. bottom _____
Oil _____ bbls., 1st 24 hrs.	CASING CEMENTED _____ SIZE _____ No. FT. _____ Date _____			
Fresh water _____ feet _____ feet	NAME OF SERVICE COMPANY _____			
Salt water _____ feet _____ feet	COAL WAS ENCOUNTERED AT _____ FEET _____ INCHES			
	_____ FEET _____ INCHES _____ FEET _____ INCHES			
	_____ FEET _____ INCHES _____ FEET _____ INCHES			

Drillers' Names \_\_\_\_\_

Remarks:

DATE

11/17/2023  
DISTRICT WELL INSPECTOR







STATE OF WEST VIRGINIA  
DEPARTMENT OF MINES  
OIL AND GAS WELLS DIVISION

INSPECTOR'S WELL REPORT

Permit No. \_\_\_\_\_

Oil or Gas Well \_\_\_\_\_  
(KIND)

Company _____ Address _____ Farm _____ Well No. _____ District _____ County _____ Drilling commenced _____ Drilling completed _____ Total depth _____ Date shot _____ Depth of shot _____ Initial open flow _____ /10ths Water in _____ Inch Open flow after tubing _____ /10ths Merc. in _____ Inch Volume _____ Cu. Ft. Rock pressure _____ lbs. _____ hrs. Oil _____ bbls., 1st 24 hrs. Fresh water _____ feet _____ feet Salt water _____ feet _____ feet	CASING AND TUBING	USED IN DRILLING	LEFT IN WELL	PACKERS
	Size			Kind of Packer _____
	16			
	13			Size of _____
	10			
	8 1/4			Depth set _____
	6 5/8			
	5 3/16			Perf. top _____
	3			Perf. bottom _____
	2			
	Liners Used _____			Perf. bottom _____
	CASING CEMENTED _____ SIZE _____ No. FT. _____ Date _____			
	NAME OF SERVICE COMPANY _____			
	COAL WAS ENCOUNTERED AT _____ FEET _____ INCHES			
	_____ FEET	_____ INCHES	_____ FEET	_____ INCHES
	_____ FEET	_____ INCHES	_____ FEET	_____ INCHES

Drillers' Names \_\_\_\_\_

Remarks: \_\_\_\_\_

RECEIVED  
OIL AND GAS DIVISION  
DEPARTMENT OF MINES  
STATE OF WEST VIRGINIA

11/17/2023

DATE

DISTRICT WELL INSPECTOR



RECEIVED  
OCT 14 1981  
OIL AND GAS DIVISION  
PROPOSED MANNER OF PLUGGING AND FILLING WELL

(REQUIRED BY RULES AND REGULATIONS)

WEST VIRGINIA DEPARTMENT OF MINES

OIL AND GAS DIVISION

WORK ORDER

Well to be plugged and filled as follows:

Formations

Br. Shale 2982-2173  
Berea 2173-2035  
Big Lime 1493-1309  
Salt Sand 894-700

Present T.D. - 2042'

Cavings 2982-2042

- (1) Cement from 2042-2000
- (2) Run tubing and gel hole
- (3) Spot cement plug from 1400<sup>5</sup> to 1300
- (4) Rip 6 5/8" casing @ 800'
- (5) Set bridge @ 800' and fill with rock and clay to 730'
- (6) Cement from 730 to 680'
- (7) Set bridge @ 60' and cement to surface

To the Department of Mines  
Coal Owner or Operator,  
Lease or Property Owner.

IF PARTIAL PLUGGING  
PLEASE SUBMIT REVISED WELL RECORD  
WHEN WORK IS COMPLETED.

Gentlemen:

This "work order" is submitted for your approval and concurrence and unless notified of your disapproval or non-concurrence, the undersigned will proceed with the plugging and filling of said well in the above described manner on the date inspector is notified after permit is issued.

Very truly yours,

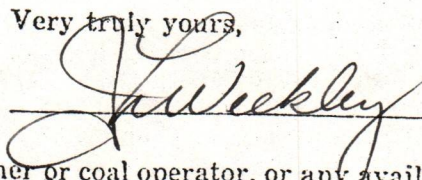

Well Operator

No objections have been filed by the coal owner or coal operator, or any available adjacent lease or property owners or interposed by the Department of Mines to the manner herein described for the plugging and filling of the well above mentioned. Therefore, the same is hereby approved this

day of Oct. 22, 1981

DEPARTMENT OF MINES  
Oil and Gas Division

By: 

NOTE: This "work order" shall be filed in triplicate, one copy for the files of the Department of Mines; one to be approved or corrected and returned to the well operator as his authority for plugging said well; and one for the well inspector.







RECEIVED

FORM OG-8

STATE OF WEST VIRGINIA  
DEPARTMENT OF MINES  
OIL AND GAS DIVISION

FEB 24 1982

OIL AND GAS DIVISION  
WV DEPARTMENT OF MINES

AFFIDAVIT OF PLUGGING AND FILLING WELL

AFFIDAVIT SHOULD BE MADE IN TRIPLICATE. ONE COPY MAILED TO THE DEPARTMENT, ONE COPY TO BE RETAINED BY THE WELL OPERATOR AND THE THIRD COPY (AND EXTRA COPIES IF REQUIRED) SHOULD BE MAILED TO EACH COAL OPERATOR AT THEIR RESPECTIVE ADDRESSES.

Not Operated  
COAL OPERATOR OR OWNER  
ADDRESS  
COAL OPERATOR OR OWNER  
ADDRESS  
TCO Mineral Tract Fee #1  
LEASE OR PROPERTY OWNER  
ADDRESS

Columbia Gas Transmission Corporation  
NAME OF WELL OPERATOR  
P. O. Box 1273 - Charleston, WV  
COMPLETE ADDRESS  
February 10 19 82  
WELL AND LOCATION  
Lincoln District  
Wayne County  
Well No. 6422  
Old Colony Oil & Gas Farm

STATE INSPECTOR SUPERVISING PLUGGING Kenneth Butcher

AFFIDAVIT

STATE OF WEST VIRGINIA,

County of Wayne

ss:

William D. Cubbedge and Charles Roberts  
being first duly sworn according to law depose and say that they are experienced in the work of plugging and filling oil and gas wells and were employed by Columbia Gas Transmission Corp., well operator, and participated in the work of plugging and filling the above well, that said work was commenced on the 21st day of December, 19 81, and that the well was plugged and filled in the following manner:

BAND OR ZONE RECORD FORMATION	FILLING MATERIAL	PLUGS USED SIZE & KIND	CASING	
			CSG PULLED	CSG LEFT IN
Br. Shale 2982-2173	Cavings 2982-2042 Cement 2042-1960			
Berea 2173-2035	Rock & Clay 1960-1500 Cement 1500-1310			
Big Lime 1493-1309	Ripped 7" casing @ 1274 Brush Bridge @ 1272		7"-1274	60'
Salt Sand 894-700	Cement 1272-1172 Rock & Clay 1172-730 Cement 730-680 Rock & Clay 680-60 Cement 60-surface			330'-10 3/4"
	Erect Monument			
COAL SEAMS			DESCRIPTION OF MONUMENT	
(NAME)			7" riser 36" high staving	
(NAME)			"Col. Gas Trans. - Well #6422	
(NAME)			P & A 2-3-82"	
(NAME)				

and that the work of plugging and filling said well was completed on the 3rd day of February, 19 82

And further deponents saith not.

Sworn to and subscribed before me this 10th day of February, 19 82.

My commission expires:

September 16, 1990

William D. Cubbedge  
Charles A. Roberts  
Sharon S. Martin  
11/17/2023  
Notary Public.

Permit No. Way 617

47-099-



OFFICE OF THE  
CLERK OF THE COURT  
WEST VIRGINIA





STATE OF WEST VIRGINIA  
DEPARTMENT OF MINES  
OIL AND GAS WELLS DIVISION

RECEIVED

MAR 12 1982

OIL AND GAS DIVISION  
WV DEPARTMENT OF MINES

INSPECTOR'S WELL REPORT

Permit No. 47-099-~~47~~ 617P

Oil or Gas Well \_\_\_\_\_  
(KIND)

Company	CASING AND TUBING	USED IN DRILLING	LEFT IN WELL	PACKERS
<u>Coli Gas Trans. Corp.</u>	Size			
<u>Charleston, W. Va.</u>	<u>16</u>			Kind of Packer _____
<u>Old Colony Oil Gas</u>	<u>13</u>			
<u>6473</u>	<u>10</u>			Size of _____
District <u>Lincoln</u> County <u>Wayne</u>	<u>8 1/4</u>			
Drilling commenced _____	<u>6%</u>			Depth set _____
Drilling completed _____ Total depth _____	<u>5 3/16</u>			
Date shot _____ Depth of shot _____	<u>3</u>			Perf. top _____
Initial open flow _____ /10ths Water in _____ Inch	<u>2</u>			Perf. bottom _____
Open flow after tubing _____ /10ths Merc. in _____ Inch	Liners Used _____			Perf. bottom _____
Volume _____ Cu. Ft.	CASING CEMENTED _____ SIZE _____ No. FT. _____ Date _____			
Rock pressure _____ lbs. _____ hrs.	NAME OF SERVICE COMPANY _____			
_____ bbls., 1st 24 hrs.	COAL WAS ENCOUNTERED AT _____ FEET _____ INCHES			
Fresh water _____ feet _____ feet	_____ FEET _____ INCHES _____ FEET _____ INCHES			
Salt water _____ feet _____ feet	_____ FEET _____ INCHES _____ FEET _____ INCHES			

Drillers' Names \_\_\_\_\_

Remarks: Final inspection made on this well.

Plug

3-10-82  
DATE

J. E. Butcher  
503  
11/17/2023  
DISTRICT WELL INSPECTOR









State of West Virginia

Department of Mines  
Oil and Gas Division

Charleston 25305

THOMAS E. HUZZEY  
DEPUTY DIRECTOR

WALTER N. MILLER  
DIRECTOR

March 18, 1982

Columbia Gas Transmission Corporation  
P. O. Box 1273  
Charleston, West Virginia 25325

IN RE: PERMIT NO. WAY-617 -P  
FARM Old Colony Oil & Gas  
WELL NO. 6422  
DISTRICT Lincoln  
COUNTY Wayne

Gentlemen:

The final inspection report for the above described well has been received in this office. Only the column checked below applies.

XXXXXX The well designated by the above permit number has been released under your Blanket Bond.

\_\_\_\_\_ Please return the enclosed cancelled single bond which covered the well designated by the above permit number to the surety company who executed said bond in your behalf, in order that they may give you credit on your records.

\_\_\_\_\_ Your well record was received and reclamation requirements approved. In accordance with Chapter 22, Article 4, Section 2, the above captioned well will remain under bond coverage for life of the well.

Very truly yours,

Thomas E. Huzzey

TEH/rl

11/17/2023