

As-Drilled

SHL Latitude: 38°45'00" (ROCK CAVE)

8,744' SHL

THRASHER

THE THRASHER GROUP, INC.
600 WHITE OAKS BLVD.
BRIDGEPORT, WV 26330
PHONE 304-624-4108

11,394' BHL
BHL Latitude: 38°47'30" (GOSHEN)

NOTES ON SURVEY

- COORDINATES SYSTEM IS UTM, NAD 83 DATUM, ZONE 17, U.S. FOOT AND WELL COORDINATES ESTABLISHED USING SURVEY GRADE GPS.
- SURFACE AND ROYALTY OWNER INFORMATION AND THEIR BOUNDARIES SHOWN HEREON WERE PLOTTED FROM DEEDS AND/OR TAX PARCEL MAPS PROVIDED BY CLIENT AND FIELD LOCATIONS.
- THIS PLAT DOES NOT REPRESENT A BOUNDARY SURVEY OF THE PARCELS SHOWN HEREON.
- NO DWELLINGS AND BUILDINGS WITHIN 625 FEET OF PROPOSED OF CENTER OF PAD.
- NO WATER WELLS OR DEVELOPED SPRINGS WITHIN 250 FEET OF PROPOSED WELL.
- NO PERENNIAL STREAMS, LAKES, PONDS, RESERVOIRS OR WETLANDS WITHIN 100 FEET OF THE LIMITS OF DISTURBANCE.
- NO NATURALLY PRODUCING TROUT STREAM WITHIN 300 FEET OF LIMITS OF DISTURBANCE.

TRACT	SURFACE OWNER	TAX PARCEL	ACRES
1	FLAMCO, INC.	1-2T-32.2	21.85
2	SUN LUMBER CO	1-2T-31	270.812
3	SUN LUMBER CO	1-2T-30.1	26.67
4	LOYCE KAY & RAYMOND M MASTERS	1-2T-31.2	0.83
5	HINKLE ARNIE L & GAYLA S	1-2T-30	5.92
6	HARRINGTON MAXINE	1-2S-25	42.35
7	ATLANTIC SEABOARD CORP.	1-2S-27	85.00
8	COASTAL FOREST RESOURCES CO	1-2S-13	187.30
9	HUMPHREY JOHN C	1-2S-24	23.125

Longitude: 80°20'00"

2,451' SHL

GRID NORTH
UTM, NAD83 DATUM, ZONE 17, US FT

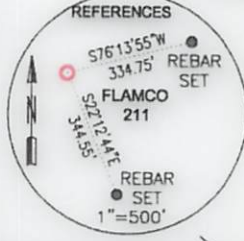
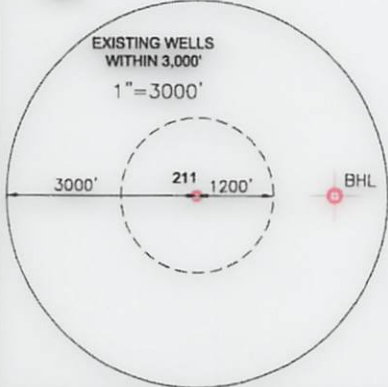

SURFACE HOLE LOCATION (SHL):	SURFACE HOLE LOCATION (SHL):
UTM (NAD83, ZONE 17, METERS): NORTHING: 4,288,487.850 EASTING: 555,268.264	UTM (NAD83, ZONE 17, METERS): NORTHING: 4,288,487.850 EASTING: 555,268.264
LANDING POINT LOCATION (LPL):	LANDING POINT LOCATION (LPL):
UTM (NAD83, ZONE 17, METERS): NORTHING: 4,288,540.516 EASTING: 555,132.905	UTM (NAD83, ZONE 17, METERS): NORTHING: 4,288,412.403 EASTING: 555,185.479
BOTTOM HOLE LOCATION (BHL):	BOTTOM HOLE LOCATION (BHL):
UTM (NAD83, ZONE 17, METERS): NORTHING: 4,290,368.285 EASTING: 554,458.207	UTM (NAD83, ZONE 17, METERS): NORTHING: 4,290,369.414 EASTING: 554,461.167

I, THE UNDERSIGNED, HEREBY CERTIFY THAT THIS PLAT IS CORRECT TO THE BEST OF MY KNOWLEDGE AND BELIEF AND SHOWS ALL THE INFORMATION REQUIRED BY LAW AND REGULATIONS ISSUED AND PRESCRIBED BY THE DEPARTMENT OF ENVIRONMENTAL PROTECTION.

P.S. 2270

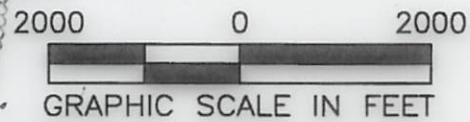

<p>(+) DENOTES LOCATION OF WELL ON UNITED STATES TOPOGRAPHIC MAPS</p> <p>WVDEP OFFICE OF OIL & GAS 601 57TH STREET CHARLESTON, WV 25034</p>	<p>MINIMUM DEGREE OF ACCURACY: 1/200</p> <p>PROVEN SURVEY SOURCE OF GRADE GPS ELEVATION: (NAVD 88, US FT)</p>	<p>OPERATOR'S WELL #: 211</p> <p>API WELL #: 47 97 03862</p> <p>STATE COUNTY PERMIT</p>
	<p>WELL TYPE: OIL WASTE DISPOSAL PRODUCTION DEEP GAS <input checked="" type="checkbox"/> LIQUID INJECTION STORAGE SHALLOW <input checked="" type="checkbox"/></p> <p>WATERSHED: RIGHT FORK OF LITTLE KANAWHA</p> <p>DISTRICT: BANKS COUNTY: UPSHUR</p> <p>SURFACE OWNER: FLAMCO INC.</p> <p>OIL & GAS ROYALTY OWNER: FLAMCO INC.</p> <p>DRILL DRILL DEEPER REDRILL FRACTURE OR STIMULATE PLUG OFF OLD FORMATION PERFORATE NEW FORMATION</p> <p>CONVERT PLUG & ABANDON CLEAN OUT & REPLUG OTHER CHANGE <input checked="" type="checkbox"/> (SPECIFY) AS-DRILLED</p> <p>TARGET FORMATION: LATERAL: MARCELLUS, PILOT HOLE: HUNTERSVILLE CHERT ESTIMATED DEPTH: LATERAL: 7,149 TVD 14,182 TMD PILOT: 7,293 TMD</p>	<p>DESIGNATED AGENT: WILLIAM VEIGEL</p> <p>ADDRESS: 65 PROFESSIONAL PLACE, SUITE 200</p> <p>CITY: BRIDGEPORT STATE: WV ZIP CODE: 26330</p>
<p>WELL OPERATOR: ARSENAL RESOURCES</p> <p>ADDRESS: 6031 WALLACE ROAD EXTENSION #300</p> <p>CITY: WEXFORD STATE: PA ZIP CODE: 15090</p>	<p>LEGEND:</p> <ul style="list-style-type: none"> PROPOSED SURFACE HOLE / BOTTOM HOLE EXISTING / PRODUCING WELLHEAD ABANDONED WELL PLUGGED & ABANDONED WELL CUT CONDUCTOR LEASE BOUNDARY 500' DHP BUFFER PROPOSED PATH AS-DRILLED PATH DHP BUFFER 	<p>REVISIONS:</p> <p>DATE: 01-05-2018</p> <p>DRAWN BY: R.DOERR</p> <p>SCALE: 1" = 2000'</p> <p>DRAWING NO: 030-3131</p> <p>WELL LOCATION PLAT</p>