

ALTON UNIT #4
211.100 AC. +-

LATITUDE 38-50-00

SCALED COOR.:

11,135' WEST
12,445' SOUTH

00-01-08

LONGITUDE

Id	Bearing	Distance
L20	N 59°57'49" W	1837.26'
L21	N 81°10'59" W	2182.84'
L22	N 4°13'13" E	742.80'
L23	N 18°26'39" W	3120.00'

COORDINATE VALUES:

NAD 27 WV SOUTH SPC:

ALT4DHS = 656,123.69' 2,226,343.16'
LAND PT. = 656,865.22' 2,226,385.64'
BOT. HOLE = 659,808.17' 2,225,350.11'

NAD 83 UTM ZONE 17 IN METERS:

ALT4DHS = 4,294,803.54 m 568,979.84 m
LAND PT. = 4,295,029.49 m 568,992.75 m
BOT. HOLE = 4,295,926.16 m 568,677.10 m

Id	Bearing	Distance
L1	N 9°04'59" E	82.17'
L2	S 32°22'49" W	277.04'
L3	N 24°10'49" W	594.00'
L4	S 68°49'11" W	297.00'
L5	N 53°40'49" W	194.51'
L6	N 18°26'39" W	729.05'
L7	N 18°26'39" W	1675.31'
L8	N 35°09'35" E	329.59'
L9	S 80°00'00" E	505.33'
L10	N 11°54'36" W	329.06'
L11	N 17°09'59" E	280.50'
L12	N 48°44'59" E	601.26'
L13	N 22°34'59" E	472.72'
L14	N 9°45'01" W	444.18'
L15	N 65°34'59" E	314.87'
L16	N 53°40'49" W	652.77'
L17	S 44°04'40" W	424.51'
L18	N 44°04'40" E	389.89'
L19	S 35°09'35" W	644.58'

GRID NORTH

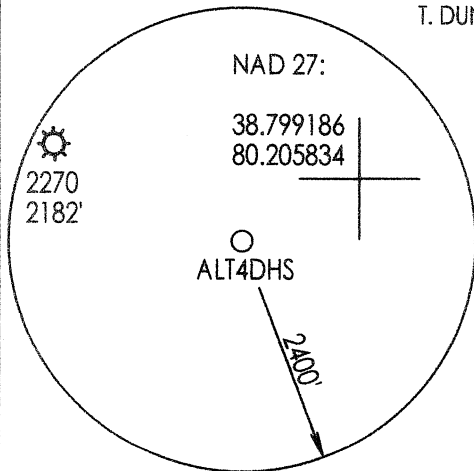

UNIT BREAKDOWN:

W. H. ODELL 63848	124.358 AC.	58.91%
D. B. TAYLOR 82877	50.081 AC.	23.72%
BOYNTON CO. 83074	30.334 AC.	14.37%
RAILROAD	5.327 AC.	2.52%
T. DUNMIRE	1.000 AC.	0.48%

WELL REFERENCES:

S38-45W, 264.58' TO 12" BIRCH
S51-05E, 257.87' TO 15" POPLAR

(+) DENOTES LOCATION OF WELL ON UNITED STATES TOPOGRAPHIC MAPS

FILE NUMBER: _____
DRAWING NUMBER: CGCALTON4DHS.PCS
SCALE: 1" = 1000'
MINIMUM DEGREE OF ACCURACY: SUBMETER
PROVEN SOURCE OF ELEVATION: DGPS SURVEY
SUBMETER SYSTEM

I THE UNDERSIGNED, HEREBY STATE THAT THIS PLAT IS CORRECT TO THE BEST OF MY KNOWLEDGE AND BELIEF AND SHOWS ALL THE INFORMATION REQUIRED BY LAW AND THE REGULATIONS ISSUED AND PRESCRIBED BY THE DEPARTMENT OF ENERGY.

(SIGNED) _____
STEPHEN D. LOSH, P.S. #674

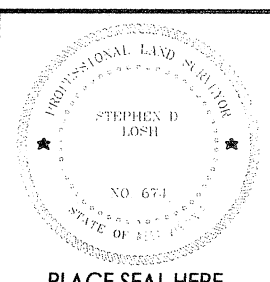

STATE OF WEST VIRGINIA
DIVISION OF ENVIRONMENTAL PROTECTION
OFFICE OF OIL AND GAS
#10 MCJUNKIN ROAD
NITRO, WV 25143-2506
FORM WW-6

LAND SURVEYING SERVICES
21 CEDAR LANE, BRIDGEPORT, WV 26330
PHONE: 304-842-2018 OR 842-5762

DATE: JANUARY 03, 2011

OPERATORS WELL NO.: ALT4DHS

API WELL NO. 47-097-03786H

STATE COUNTY PERMIT
CANCELLED

WELL TYPE: OIL ___ GAS ___ LIQUID INJECTION WASTE DISPOSAL ___ CBM ___
(IF "GAS") PRODUCTION STORAGE ___ DEEP ___ SHALLOW
LOCATION: ELEVATION 1859.00' (566.63 m) WATERSHED BUCKHANNON RIVER
DISTRICT WASHINGTON COUNTY UPSHUR
QUADRANGLE ALTON LEASE NUMBER SEE ABOVE

SURFACE OWNER DON J. WOODY, ET. AL. ACREAGE 2534.80 (6Q-10)
OIL & GAS ROYALTY OWNER W. H. ODELL, ET. AL. UNIT LEASE ACREAGE 5102.00

PROPOSED WORK: DRILL CONVERT ___ DRILL DEEPER ___ REDRILL ___ FRACTURE OR STIMULATE PLUG OFF OLD FORMATION ___
PERFORATE NEW FORMATION ___ OTHER PHYSICAL CHANGE (SPECIFY) HORIZONTAL

TARGET FORMATION MARCELLUS ESTIMATED DEPTH TVD = 7200' TMD = 11050'

WELL OPERATOR CNX GAS COMPANY LLC DESIGNATED AGENT KENT WRIGHT
ADDRESS P. O. BOX 1248 JANE LEW, WV 26378 ADDRESS P. O. BOX 1248 JANE LEW, WV 26378

COUNTY NAME

PERMIT