

Note: Location is at least 400' from all outside lease lines.

NORTH

W 00-02-08 E 11111111

056'01

2.08
.34

7 1/2'

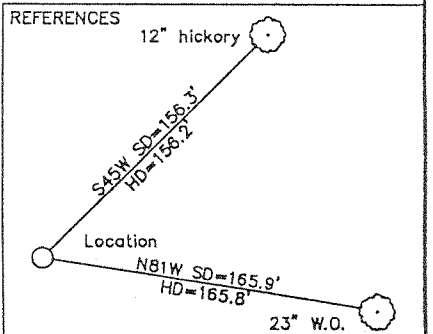

(+) DENOTES LOCATION OF WELL ON UNITED STATES TOPOGRAPHIC MAPS

FILE NO. _____
 DRAWING NO. 1
 SCALE 1" = 500'
 MINIMUM DEGREE OF ACCURACY 1 in 200
 PROVEN SOURCE OF ELEVATION BM 2900' south of location El. 1720'

I THE UNDERSIGNED, HERBY CERTIFY THAT THIS PLAT IS CORRECT TO THE BEST OF MY KNOWLEDGE AND BELIEF AND SHOWS ALL THE INFORMATION REQUIRED BY LAW AND THE REGULATIONS ISSUED AND PRESCRIBED BY THE DEPARTMENT OF ENERGY.
 (SIGNED) Jeffrey W. Adams
 R.P.E. _____ L.L.S. 791

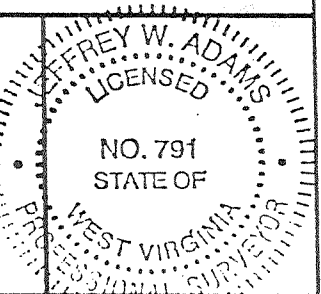

STATE OF WEST VIRGINIA
 Division of Environmental Protection
 OFFICE OF OIL AND GAS

DATE April 11 2000
 OPERATOR'S WELL NO. 624324
 API WELL NO. _____

WELL TYPE: OIL _____ GAS X LIQUID INJECTION _____ WASTE DISPOSAL _____
 (IF "GAS") PRODUCTION X STORAGE _____ DEEP X SHALLOW _____

LOCATION: ELEVATION 1806 WATER SHED Flatwoods Run
 DISTRICT Banks COUNTY Upshur
 QUADRANGLE Rock Cave

SURFACE OWNER Ralph G. Lipps, et ux. ACREAGE 35.75
 OIL & GAS ROYALTY OWNER W. W. Harper, et al. LEASE ACREAGE 40

LEASE NO. 3056511
 PROPOSED WORK: DRILL X CONVERT _____ DRILL DEEPER _____ REDRILL _____ FRACTURE OR STIMULATE _____ PLUG OFF OLD FORMATION _____ PERFORATE NEW FORMATION X OTHER PHYSICAL CHANGE IN WELL (SPECIFY) _____

PLUG AND ABANDON _____ CLEAN OUT AND REPLUG _____
 TARGET FORMATION Oriskany ESTIMATED DEPTH 7500
 WELL OPERATOR Columbia Natural Resources, Inc. DESIGNATED AGENT W. A. Watson, Jr.
 ADDRESS P.O. Box 6070, Charleston, WV 25362 ADDRESS P.O. Box 6070, Charleston, WV 25362

COUNTY NAME UPS

PERMIT 3020

DEEP WELL 5-5 259

JUN 23 2000

State of West Virginia
Division of Environmental Protection
Section of Oil and Gas

Reviewed RL

Well Operator's Report of Well Work

Farm name: LIPPS, RALPH G., ETUX Operator Well No.: 624324

LOCATION: Elevation: 1806 Quadrangle: ROCK CAVE

District: BANKS County: Upshur

Latitude: 10950 Feet South of 38 Deg. 52 Min. 30 Sec.

Longitude 2010 Feet West of 80 Deg. 20 Min. 00 Sec.

Company: COLUMBIA NATURAL RESOURCES

	Casing & Tubing	Used in drilling	Left in well	Cement fill up Cu. Ft.
Address: Rt. 1, Box 107-10	8-5/8	1769	1769	CTS
Buckhannon, WV 26201	4-1/2	7513	7513	210 SXS
Agent: R. Mark Hackett				
Inspector: Tim Bennett				
Date Permit Issued: 06/22/00				
Date Well Work Commenced: 10/19/00				
Date Well Work Completed: 12/26/00				
Verbal Plugging:				
Date Permission granted on:				
Rotary <input checked="" type="checkbox"/> Cable <input type="checkbox"/> Rig				
Total Depth (feet): 7586				
Fresh Water depths (ft): 95, 450				
Salt water depths (ft): None				
Is coal being mined in area (Y/N)? N				
Coal Depths (ft): 437-443, 518-521, 963-967				

RECEIVED
Office of Oil & Gas
Permitting
JAN 17 2001
WV Division of
Environmental Protection

OPEN FLOW DATA

Producing formation Oriskany/Chert Pay zone depth (ft) 7130 - 7346

** Gas: Initial open flow 0 MCF/d Oil: Initial open flow N/A Bbl/d

** Final open flow 2610 MCF/d Final open flow N/A Bbl/d

Time of open flow between initial and final tests 4 Hours

** Static rock Pressure 2400 psig (surface pressure) after 72 Hours

Second producing formation _____ Pay zone depth (ft) _____

Gas: Initial open flow _____ MCF/d Oil: Initial open flow _____ Bbl/d

Final open flow _____ MCF/d Final open flow _____ Bbl/d

Time of open flow between initial and final tests _____ Hours

Static rock Pressure _____ psig (surface pressure) after _____ Hours

** Comingled

NOTE: ON BACK OF THIS FORM PUT THE FOLLOWING: 1). DETAILS OF PERFORATED INTERVALS, FRACTURING OR STIMULATING, PHYSICAL CHANGE, ETC. 2). THE WELL LOG WHICH IS A SYSTEMATIC DETAILED GEOLOGICAL RECORD OF ALL FORMATIONS, INCLUDING COAL ENCOUNTERED BY THE WELLBORE.

Signed: COLUMBIA NATURAL RESOURCES, INC.

By: R. Mark Hackett

Date: 1/10/2001

FEB 23 2001

DEEP

UPS 3020

