



West Virginia Department of Environmental Protection
Office of Oil and Gas
WELL LOCATION FORM: GPS

API: 47-097-00322 P WELL NO.: WV 608116 (Reeder #1)

FARM NAME: Reeder

RESPONSIBLE PARTY NAME: EQT Production Company

COUNTY: Upshur DISTRICT: Buckhannon

QUADRANGLE: Berlin 7.5'

SURFACE OWNER: Tommy D. & Judith Cochran

ROYALTY OWNER: David H. Young Agent

UTM GPS NORTHING: 4,320,536

UTM GPS EASTING: 564,127 GPS ELEVATION: 473 m (1552 ft)

The Responsible Party named above has chosen to submit GPS coordinates in lieu of preparing a new well location plat for a plugging permit or assigned API number on the above well. The Office of Oil and Gas will not accept GPS coordinates that do not meet the following requirements:

- Datum: NAD 1983, Zone: 17 North, Coordinate Units: meters, Altitude: height above mean sea level (MSL) – meters.
- Accuracy to Datum – 3.05 meters
- Data Collection Method:
Survey grade GPS : Post Processed Differential
Real-Time Differential
Mapping Grade GPS : Post Processed Differential
Real-Time Differential
- Letter size copy of the topography map showing the well location.**

I the undersigned, hereby certify this data is correct to the best of my knowledge and belief and shows all the information required by law and the regulations issued and prescribed by the Office of Oil and Gas.

Ben R. Smyth
Signature

P.S. 2092
Title

10-6-2011
Date

RECEIVED
Office of Oil & Gas
OCT 25 2011

West Virginia Department of
Environmental Protection

Topo Quad: Berlin

Scale: 1" = 2000'

County: Upshur

Date: Sept 1, 2011

District: Buckhannon

Project No: 39-09-00-09

47-097-00322 (WV 608116)

Topo

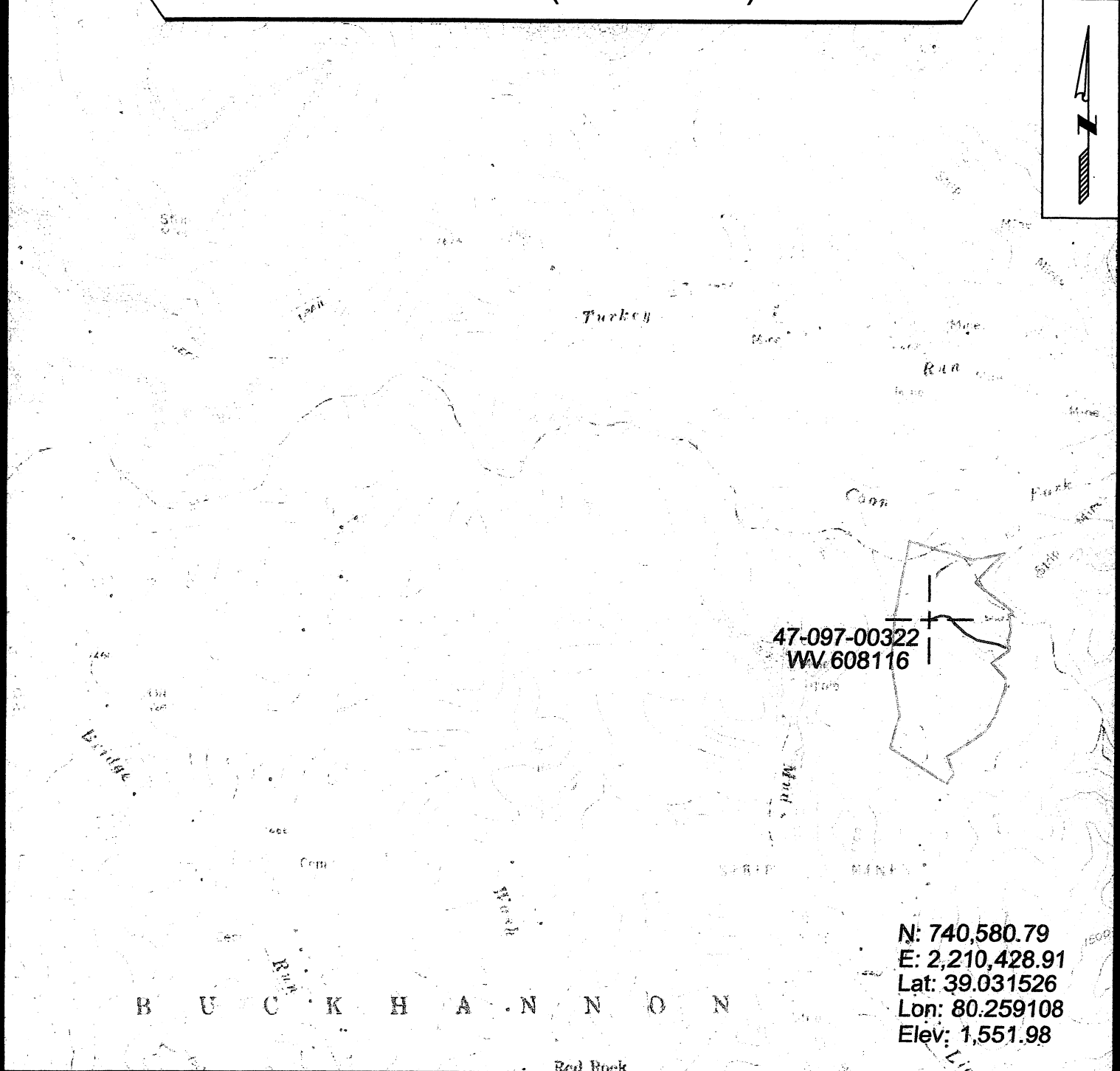

**47-097-00322
WV 608116**

N: 740,580.79
E: 2,210,428.91
Lat: 39.031526
Lon: 80.259108
Elev: 1,551.98

B U C K H A N N O N



SURVEYING AND MAPPING SERVICES PERFORMED BY:
ALLEGHENY SURVEYS, INC.
1-800-482-8606
P.O. BOX 438
BIRCH RIVER, WV 26610
PH: (304) 649-8606
FAX: (304) 649-8608

PREPARED FOR:

EQT Production Company
1710 Pennsylvania Ave.
Charleston, WV 25302