

LATITUDE 39° 20'

LONGITUDE 80° 05'

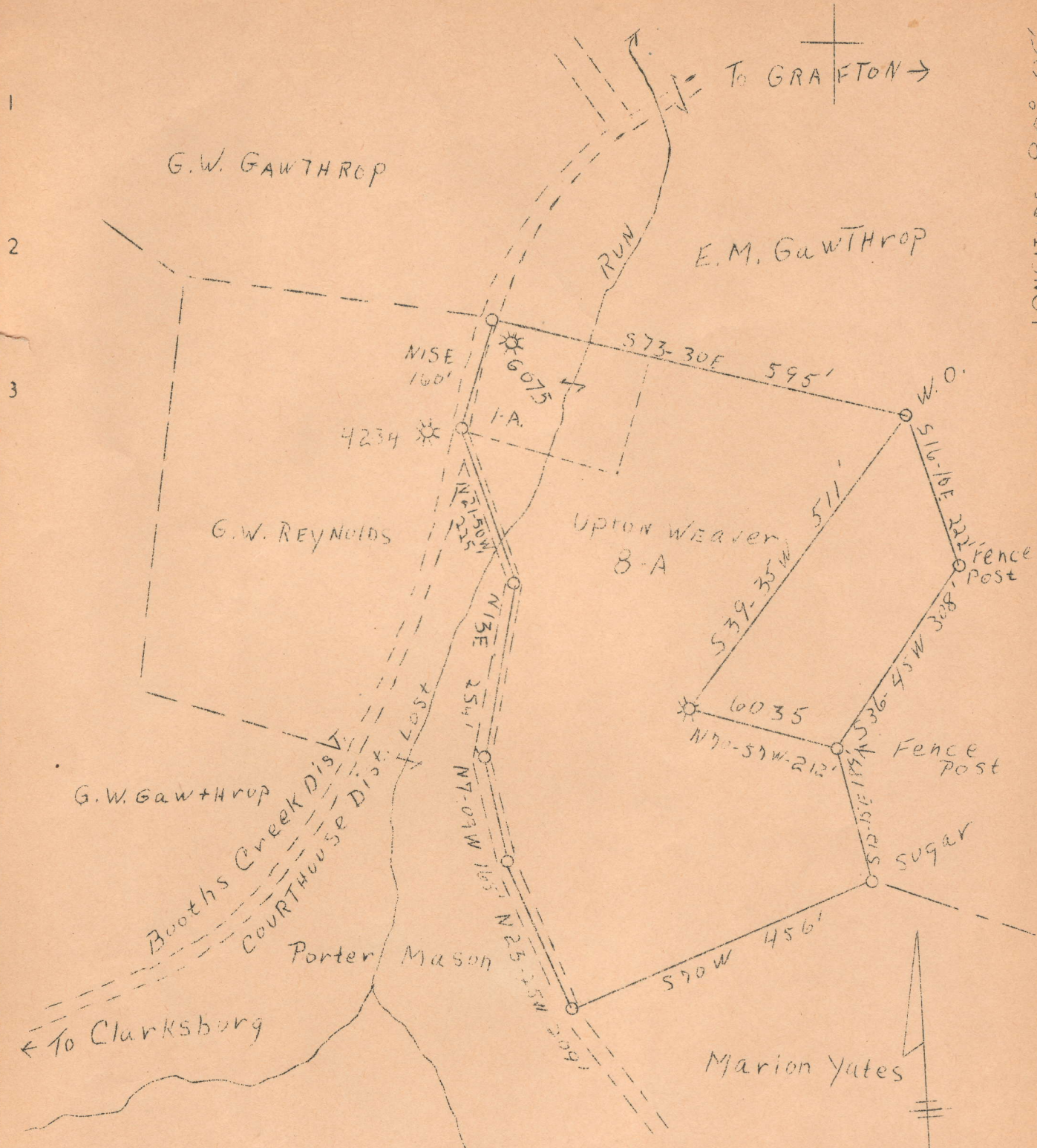

on Grafton 7 1/2 Equitable map
A b d.

0.80S
1.53W

1.55W
0.81S
MAR 29 1938

Company	Pitts. and W.Va. Gas Co.
Address	Union Bank Bldg., Clarksburg, W.Va.
Farm	Upton Weaver
Tract	Acres 8 Lease No. 16091
Well (Farm) No.	1 Serial No. 6035
Elevation (Spirit Level)	1218.0 V.A.
Quadrangle	Fairmont
County	Taylor District Courthouse
Engineer	James D. Jeffries
Engineer's Registration No.	
File No.	Drawing No.
Date	3-19-38 Scale 1"-200'

STATES OF WEST VIRGINIA
Department of Mines
OIL AND GAS DIVISION
CHARLESTON

WELL LOCATION MAP

File No. Tay-5 aov

Denotes location of well on United States Topographic Maps, scale 1 to 62500, latitude and longitude lines being represented by border lines as shown.

Denotes one inch spaces on border line of original tracing.

Company **Pittsburgh & West Va Gas Co.**
 Address **Clarksburg, West Va.**
 Farm **Upton Weaver.** Acres **8**
 Location (waters) **Fairmont-S.E. 1-5** Size
 Well No. **6035** Elev. **1218 V.A.M.**
 District **Booths Creek** County **Taylor** Kind of Packer
 The surface of tract is owned in fee by **Upton Weaver**
R.F.D.#6 - Box 85 Address **Grafton, W.Va.**
 Mineral rights are owned by **Upton Weaver**
R.F.D.#6 - Box 85 Address **Grafton, W.Va.**
 Drilling commenced **August 27th, 1917**
 Drilling completed **October 5th, 1917**
 Date shot _____ Depth of shot _____
 Open Flow _____ /10ths Water in _____ Inch
 _____ /10ths Merc. in _____ Inch
 Volume _____ Cu. Ft. CASING CEMENTED _____ SIZE _____ No. FT. _____ Date
 Rock Pressure _____ lbs. _____ hrs.
 Oil _____ bbis. 1st 24 hrs. COAL WAS ENCOUNTERED AT _____ FEET _____ INCHES
 Fresh water _____ feet _____ feet FEET _____ INCHES FEET _____ INCHES
 Salt water _____ feet _____ feet FEET _____ INCHES FEET _____ INCHES

Formation	Color	Hard or Soft	Top	Bottom	Oil Gas or Water	Depth Found	Remarks
Clay			0	30			
Sand			30	80			
Slate			80	140			
Line			140	210			
Slate			210	300			
Line			300	355			
Slate			355	435			
Big Dunkard			435	480			
Slate			480	520			
Line			520	580			
Slate			580	650			
1st. Salt Sand			650	690			
Slate			690	755			S.L. 660'
2nd. Salt Sand			755	862			S.L. 759'
Shells			862	900			
3rd. Salt Sand			900	940			
Shells			940	960			
Sand			960	1000			
Slate			1000	1060			
Line			1060	1170			
Slate			1170	1215			
Line			1215	1240			
Slate			1240	1245			
Line			1245	1279			
Slate			1279	1304			
Big Line			1304	1378			S.L. 1324'
Big Injun			1378	1500			
Slate			1500	1822			
Fifty Foot			1822	1922			S.L. 1633'
Boulders			1922	1991			
Sand			1991	2000			
Boulders			2000	2211			
8th. Sand			2211	2302	Gas	2256'	S.L. 2225'
Slate			2302	2360	Gas	2225'	
Total Depth				2360			

COAL OPERATOR OR OWNER	PITTSBURGH & WEST VIRGINIA GAS COMPANY
NAME OF WELL OPERATOR	Clear Spring, West Va.
ADDRESS	COMPLETE ADDRESS
COAL OPERATOR OR OWNER	May 25, 1938 19
ADDRESS	WELL AND LOCATION
Winton Weaver	South Creek District
LEASE OR PROPERTY OWNER	Taylor County
R.F.D. #6, Box #6, Grafton, West Va	Well No. 6035
ADDRESS	Winton Weaver Farm

AFFIDAVIT TO BE MADE IN TRIPPLICATE, ONE COPY TO BE MAILED BY REGISTERED MAIL TO THE DEPARTMENT, ONE COPY TO BE RETAINED BY THE WELL OPERATOR AND THE THIRD COPY (AND EXTRA COPIES IF REQUIRED) TO BE MAILED TO EACH COAL OPERATOR ABOVE NAMED AT THEIR RESPECTIVE ADDRESSES.

AFFIDAVIT

STATE OF WEST VIRGINIA, }
 COUNTY OF Harrison } ss:

Carsie O. Smith and Bert L. Adams
 being first duly sworn according to law depose and say that they are experienced in the work of

plugging and filling oil and gas wells and were employed by Pittsburgh & West Virginia Gas Co. well operator, and participated in the work of plugging and filling the above well, that said work

was commenced on the 25th day of April, 1938, and that the well was plugged and filled in the following manner:

Manner in which sand was plugged: Filled with Clay from total depth 2360 to 2191' - Cement 2191 to 2181' - Bridged hole at 195' - Filled with Clay 1952 to 1809' - Cement 1809 to 1799' - Bridged hole at 1530' - Filled with Clay 1530 to 1358' - Wood Plug 1358 to 1255' - Lead Plug 1255 to 1254' - Cement 1254 to 1244' - Cut 6-5/8" Casing at 1245' (Could not pull) - 45' of 6-5/8" Casing left in well. Bridged hole at 1030' - Filled with Clay 1030 to 630' - Cement 630 to 620' - Bridged hole at 250' - Filled with Clay 250 to 210' - Cement 210 to 200' - Filled with Clay 200 to 5' - Cement 5' to surface.

Manner in which coal was plugged: NO COAL

Description of monument: Cement & Iron Pipe Post - Cast Iron Plate
 Pgh. & West Va. Gas Co.
 6035

(THE ABOVE DESCRIPTION MUST BE IN DETAIL AND IN ACCORDANCE WITH THE PROVISIONS OF SECTION 10, ARTICLE 4, CHAPTER 25 OF THE CODE)

and that the work of plugging and filling said well was completed on the 23rd day of May, 1938.

And further deponents saith not.

Carsie O. Smith
Bert L. Adams
 Sworn to and subscribed before me this 3rd day of June, 1938
W. B. Rhodes

Sworn to and subscribed before me this 3rd day of June, 1938

COMPANY

FORM: G38-14263

Record of Well No. 6035 Located on Upton Weaver Farm June 25 1917
Booths Creek District Taylor County West Va State _____
 Division A District No. _____ Drilled under well Order 965
 Rig built by John Craig Began Aug 1 1917 Completed Aug 3 1917
 Well drilled by W.M. Burkart Began Aug 27 1917 Completed Oct 5 1917
 Depth of Well 2360 feet Size of Hole 6 3/8 Producing Gas

CASED WITH			REMARKS
AMOUNT	SIZE	KIND	
<u>16'</u>	<u>13"</u>	<u>Wood</u>	
<u>175'</u>	<u>10"</u>	<u>Old</u>	<u>11 ft</u>
<u>865'</u>	<u>8 1/4"</u>	<u>New</u>	<u>42 "</u>
<u>1334'</u>	<u>6 3/8</u>	<u>"</u>	<u>64 "</u>

COAL VEINS

FORMATIONS

FORMATION	COLOR	OPEN OR CLOSE HARD OR SOFT	TOP	BOTTOM	REMARKS GAS-OIL-WATER (THICKNESS OF PAY)
<u>Big Limestone</u>			<u>1304</u>	<u>1378</u>	
<u>Big Limestone</u>			<u>1378</u>	<u>1500</u>	
<u>Wright's Rock</u>			<u>1828</u>	<u>1922</u>	
<u>Sand</u>			<u>1991</u>	<u>2000</u>	
<u>Highland</u>			<u>2211</u>	<u>2302</u>	<u>It is 2238-2243</u>

NAME	TOP	BOTTOM	OIL	GAS	WATER	REMARKS
Clay		30				
Sand	30	80				
Slate	80	140				
Lime	140	210				
Slate	210	300				
Lime	300	355				
Slate	355	435				
Big Round	435	480				
Slate	480	520				
Lime	520	580				
Slate	580	650				Steel line 660
Wt. Salt Sand	650	690				
Slate	690	755				" " 757
Wt. Salt Sand	755	862				
Shells	862	900				
Wt. Salt Sand	900	940				
Shells	940	960				
Sand	960	1000				
Slate	1000	1060				
Lime	1060	1190				
Slate	1190	1215				
Lime	1215	1240				
Lime	1240	1245				
Lime	1245	1299				
Slate	1299	1304				
Big Lime	1304	1398				Steel line 1324
Big Limestone	1398	1500				
Slate	1500	1828				
Rifty Rock	1828	1928				" " 1833
Boulders	1928	1991				
Sand	1991	2000				
Boulders	2000	2211				
Rifty Sand	2211	2302				" " 2235
Slate	2302	2360		2238-2283		
Total Depth		2360				