



1) Date: March 19, 1984
 2) Operator's Well No. STOUT #3
 3) API Well No. 47 - 91 - 0408
 State County Permit

STATE OF WEST VIRGINIA
 DEPARTMENT OF MINES, OIL AND GAS DIVISION
 APPLICATION FOR A WELL WORK PERMIT

- 4) WELL TYPE: A Oil / Gas /
 B (If "Gas", Production / Underground storage / Deep / Shallow /)
- 5) LOCATION: Elevation: 1135' Watershed: Stout Hollow
 District: Flemington County: Taylor Quadrangle: Rosemont 7.5'
- 6) WELL OPERATOR Eastern American Energy Corp. 7) DESIGNATED AGENT Donald C. Supcoe
 Address P. O. Box N, Glenville, WV 26351 Address P. O. Box N, Glenville, WV 26351
(304) 462-5781 (304) 462-5781
- 8) OIL & GAS INSPECTOR TO BE NOTIFIED 9) DRILLING CONTRACTOR:
 Name Donald Ellis Name Unknown
 Address P. O. Box 47 Address _____
Belmont, WV 26134
- 10) PROPOSED WELL WORK: Drill / Drill deeper / Redrill / Stimulate
 Plug off old formation / Perforate new formation /
 Other physical change in well (specify) _____
- 11) GEOLOGICAL TARGET FORMATION, 5th Sand
- 12) Estimated depth of completed well, 2800 feet
- 13) Approximate tratra depths: Fresh, 90 feet; salt, None feet.
- 14) Approximate coal seam depths: 450 Is coal being mined in the area? Yes _____

RECEIVED
 MAR 22 1984
 OIL & GAS DIVISION
 DEPT. OF MINES

15) CASING AND TUBING PROGRAM

CASING OR TUBING TYPE	SPECIFICATIONS					FOOTAGE INTERVALS		CEMENT FILL-UP OR SACKS (Cubic feet)	PACKERS
	Size	Grade	Weight per ft.	New	Used	For drilling	Left in well		
Conductor	<u>11 3/4</u>	<u>J 55</u>	<u>65</u>		<u>X</u>	<u>25</u>	<u>-0-</u>		Kinds
Fresh water	<u>8 5/8</u>	<u>CW</u>	<u>20</u>	<u>X</u>		<u>600</u>	<u>600</u>	<u>CTS-50/50</u>	<u>Poz per</u>
Coal									<u>cause no. 35 order sizes no. 1 7/11/83</u>
Intermediate									<u>WAITING TIME 10 HRS.</u>
Production	<u>4 1/2</u>	<u>J 55</u>	<u>10.5</u>	<u>X</u>		<u>2750</u>	<u>2750</u>	<u>250 Ft.³</u>	Depths set
Tubing									<u>or as req. by rule 15.01</u>
Liners									Perforations:
									Top Bottom

OFFICE USE ONLY
 DRILLING PERMIT

Permit number 47-091-0408 Date April 10, 19 84

This permit covering the well operator and well location shown below is evidence of permission granted to drill in accordance with the pertinent legal requirements subject to the conditions contained herein and on the reverse hereof. **Notification must be given to the District Oil and Gas Inspector, (Refer to No. 8) Prior to the construction of roads, locations and pits for any permitted work.** In addition, the well operator or his contractor shall notify the proper district oil and gas inspector 24 hours before actual permitted work has commenced.)

The permitted work is as described in the Notice and Application, plat, and reclamation plan, subject to any modifications and conditions specified on the reverse hereof.
 Permit expires April 10, 1986 unless well work is commenced prior to that date and prosecuted with due diligence.

Bond: BLANKET	Agent: <u>ls</u>	Plat: <u>MH</u>	Casing: <u>MH</u>	Fee: <u>76</u>
----------------------	------------------	-----------------	-------------------	----------------

Margaret J. Hesse
 Administrator, Office of Oil and Gas

NOTE: Keep one copy of this permit posted at the drilling location.



OFFICE USE ONLY

PERMIT MODIFICATIONS AND CONDITIONS (IF ANY) TO THE PROPOSED WELL WORK

1) Date: _____

2) Operator's Well No.: _____

3) API Well No.: _____

4) Well Location: _____

5) Well Operator: _____

6) Well Location: _____

7) Designated Agent: _____

8) Oil & Gas Inspector to be Notified: _____

9) Drilling Contractor: _____

10) Proposed Well Work: _____

11) Geological Target Formation: _____

12) Estimated Depth of Completed Well: _____

13) Approximate True Depth: _____

14) Approximate Coal Seam Depth: _____

15) Casing and Tubing Program: _____

RECEIVED

DEPT. OF MINES OIL & GAS DIVISION

OFFICE USE ONLY

This part of Form IV-2(b) is to record the dates of certain occurrences and any follow-up inspections.

	Date	Date(s)
Application received		
Well work started		
Completion of the drilling process		
Well Record received		
Reclamation completed		

OTHER INSPECTIONS

Reason: _____

Reason: _____

Blanket	Agent	Plan	Casing	Fee
---------	-------	------	--------	-----

10/20/2023

NOTE: Keep one copy of this permit posted at the drilling location.

See the reverse side of the APPLICATION COPY for instructions to the well operator.



DATE March 19, 1984

WELL NO. STOUT #3

API NO. 047 - 91 - 0408

State of West Virginia
Department of Mines
Oil and Gas Division



CONSTRUCTION AND RECLAMATION PLAN

COMPANY NAME Eastern American Energy Corp.
Address P.O. Box N Glenville, WV 26351
Telephone 304-462-5781

DESIGNATED AGENT Donald C. Supcoe
Address P.O. Box N Glenville, WV 26351
Telephone 304-462-5781

LANDOWNER Tygart East Company

SOIL CONS. DISTRICT Tygart Valley

Revegetation to be carried out by Eastern American Energy Corporation (Agent)

This plan has been reviewed by Tygart Valley SCD. All corrections

and additions become a part of this plan: 3-29-84 (Date)

Junior Hedrick
(SCD Agent)

ACCESS ROAD
Structure Culvert (A)
Spacing 15" Diameter (minimum) (as needed)
Page Ref. Manual 2:7

LOCATION
Structure Diversion Ditches (1)
Material Earthen
Page Ref. Manual 2-12

Structure Drainage Ditch (B)
Spacing Earthen
Page Ref. Manual 2:12

Structure Drilling Pit (2)
Material Soil
Page Ref. Manual N/A

Structure Cross Drains (C)
Spacing 2-3% 200-250' apart 15%-60' apart
10-12% 70' apart 20%-45' apart
Page Ref. Manual 2:4

Structure Drainage Ditch (3)
Material Earthen
Page Ref. Manual N/A

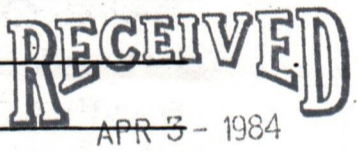

All structures should be inspected regularly and repaired if necessary. All commercial timber is to be cut and stacked and all brush and small timber to be cut and removed from the site before dirt work begins.

REVEGETATION

Treatment Area I
Lime * Tons/acre
or correct to pH 6.5
Fertilizer 500 lbs/acre
(10-20-20 or equivalent)
Mulch Hay 2 Tons/acre
Seed* Pasture Mix lbs/acre
Ky 31 Fescue 35 lbs/acre
Ladino Clover 5 lbs/acre

Treatment Area II
Lime * Tons/acre
or correct to pH 6.5
Fertilizer 500 lbs/acre
(10-20-20 or equivalent)
Mulch Hay 2 Tons/acre
Seed* Pasture Mix lbs/acre
Ky 31 Fescue 35 lbs/acre
Ladino Clover 5 lbs/acre

*Inoculate all legumes such as vetch, trefoil and clovers with the proper bacterium. Inoculate with 3X recommended amount.

* Lime according to PH test

PLAN PREPARED BY Brooks L. Harris
Eastern American Energy Corp.

ADDRESS P.O. Box N
Glenville, WV 26351

NOTES: Please request landowners' cooperation to protect new seedling for one growing season. Attach separate sheets as

ATTACH OR PHOTOCOPY SECTION OF INVOLVED TOPOGRAPHIC MAP. QUADRANGLE Rosemont 7.5'

LEGEND

Well Site  ---



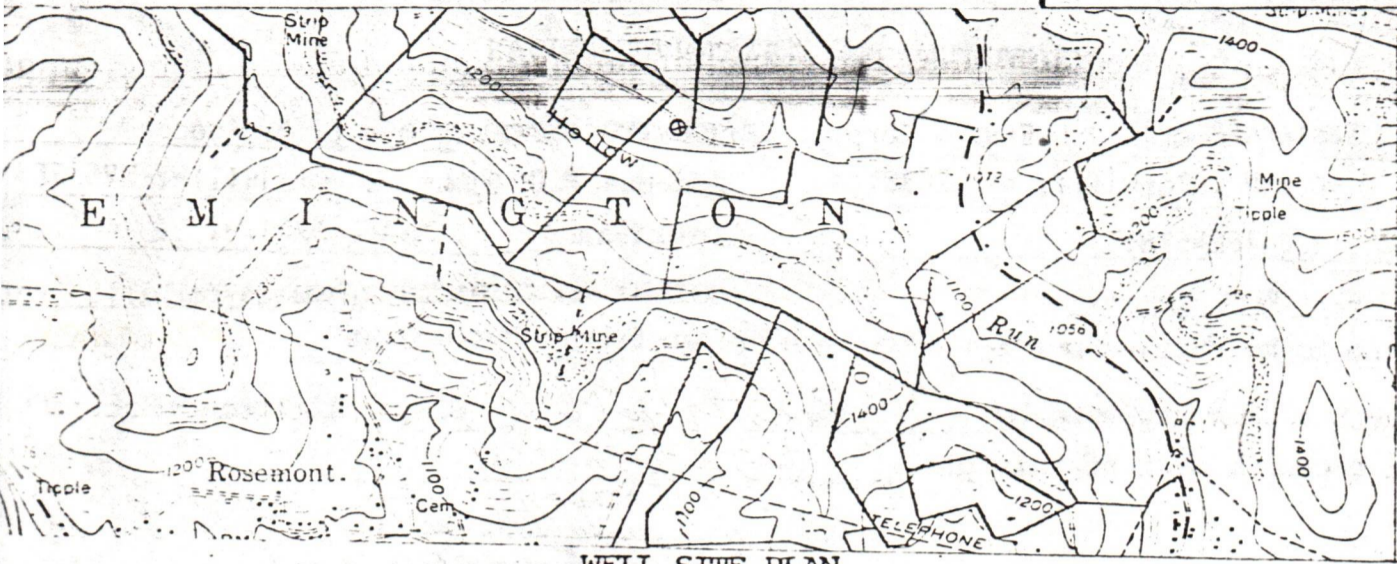





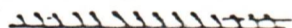

Access Road  ---



WELL SITE PLAN

Sketch to include well location, existing access road, roads to be constructed, well site drilling pits and necessary structures numbered or lettered to correspond with the first part of this plan. Include all natural drainage.

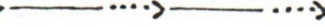
LEGEND

Property boundary 	Diversion 
Road 	Spring 
Existing fence 	Wet spot 
Planned fence 	Building 
Stream 	Drain pipe 
Open ditch 	Waterway 

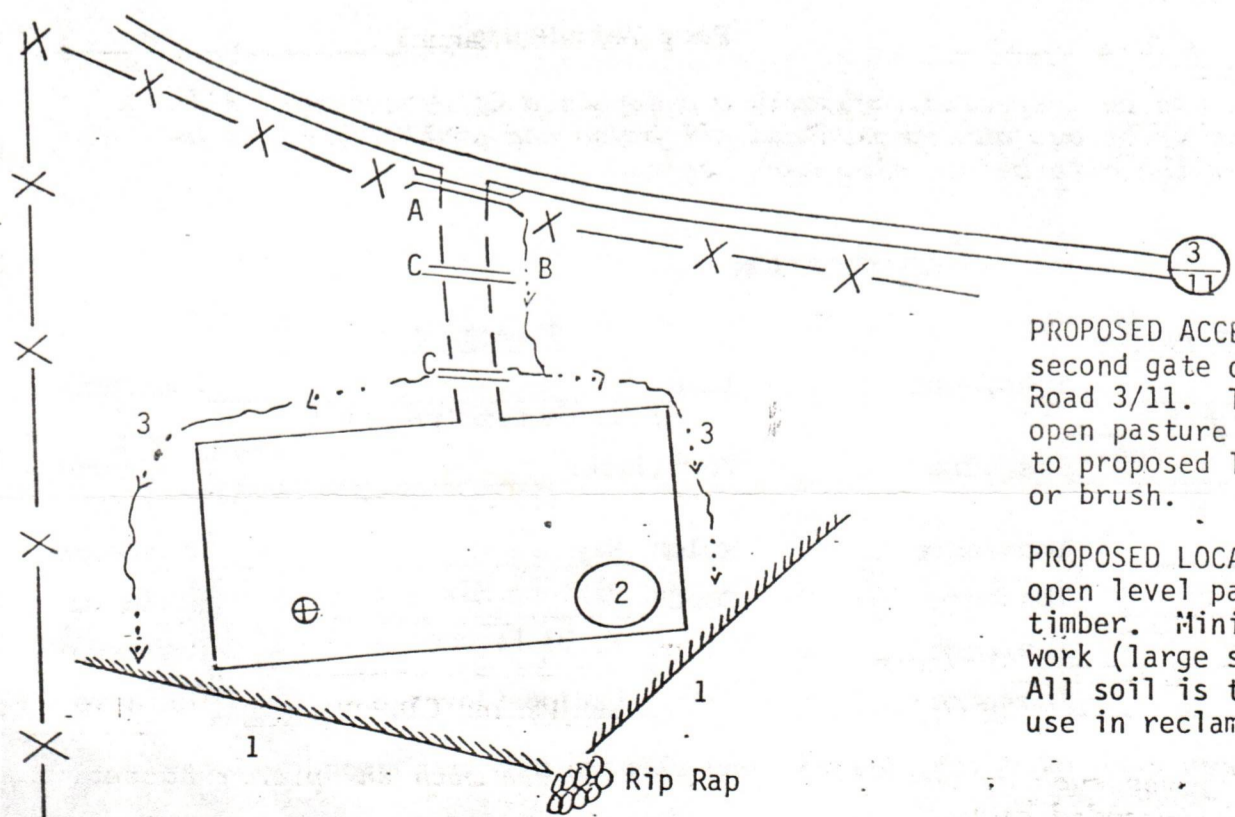

PROPOSED ACCESS ROAD: begins at second gate on south side of County Road 3/11. Thence 200' through open pasture (slightly inclined) to proposed location. No timber or brush.

PROPOSED LOCATION: Situate in open level pasture. No brush or timber. Minimum amount of earth work (large stones to be moved). All soil is to be stockpiled for use in reclamation.

10/20/2023

1) Date: March 19, 19 84
2) Operator's
Well No. STOUT #3
3) API Well No. 47-091-0408
State County Perm

STATE OF WEST VIRGINIA
DEPARTMENT OF MINES, OFFICE OF OIL & GAS
NOTICE OF APPLICATION FOR A WELL WORK PERMIT

4) SURFACE OWNER(S) OF RECORD TO BE SERVED
(i) Name Tygart East Company
Address P.O. Box 453
Philippi, WV 26416
(ii) Name _____
Address _____
(iii) Name _____
Address _____

5(i) COAL OPERATOR
Address _____
5(ii) COAL OWNER(S) WITH DECLARATION ON RECORD
Name Hillman Coal Company
Address 1900 Grant Building
Pittsburgh, PA 15219
Name Imperial Corp.
Address 437 Holden Avenue
Clarksburg, WV 26301
5(iii) COAL LESSEE WITH DECLARATION ON RECORD
Name _____
Address _____

TO THE PERSON(S) NAMED ABOVE: You should have received this Form and the following documents:

- (1) The Application for a Well Work Permit on Form IV-2(B) (or Form IV-4 if the well is to be plugged, which sets out the parties involved in the drilling or other work, and describes the well and its location and, if applicable, the proposed casing and cementing program;
- (2) The plat (surveyor's map) showing the well location on Form IV-6; and
- (3) The Construction and Reclamation Plan on Form IV-9 (unless the well work is only to plug a well), which sets out the plan for erosion and sediment control and for reclamation for the site and access road.

THE REASON YOU RECEIVED THESE DOCUMENTS IS THAT YOU HAVE RIGHTS REGARDING THE APPLICATION WHICH ARE SUMMARIZED IN THE "INSTRUCTIONS" ON THE REVERSE SIDE OF THE COPY OF THE APPLICATION (FORM IV-2(B) OR FORM 4, DESIGNATED FOR YOU. HOWEVER, YOU ARE NOT REQUIRED TO TAKE ANY ACTION AT ALL.

Take notice that under Chapter 22 of the West Virginia Code, the undersigned well operator proposes to file or has filed this Notice and Application and accompanying documents for a Well Work Permit with the Administrator of the Office of Oil and Gas, West Virginia Department of Mines, with respect to a well at the location described on attached Application and depicted on attached Form IV-6. Copies of this Notice, the Application, the plat, and the Construction and Reclamation Plan have been mailed by registered or certified mail or delivered by hand to the person(s) named above (or by publication in certain circumstances) on or before the day of mailing or delivery to the Administrator.

- 6) EXTRACTION RIGHTS
Check and provide one of the following:
 Included in the lease or leases or other continuing contract or contracts by which I hold the right to extract oil or gas.
 The requirement of Code 22-4-1-(c) (1) through (4). (See reverse side for specifics.)
- 7) ROYALTY PROVISIONS
Is the right to extract, produce or market the oil or gas based upon a lease or leases or other contract or contracts providing for flat well royalty or any similar provision for compensation to the owner of the oil or gas in place which is not inherently related to the volume of oil or gas so extracted, produced or marketed? Yes No

If the answer above is No, nothing additional is needed. If the answer is Yes, you may use Affidavit Form IV-60...

See the reverse side for line item instructions, and for instructions concerning the required copies of the Notice and Application, plat, and Construction and Reclamation Plan.

The truth of the information on the Notice and Application is verified and sworn to and the Notice is signed on behalf of the Well Operator in my County and State by
Donald C. Supcoe

WELL
OPERATOR Eastern American Energy Corporation
By Donald C. Supcoe
Its Designated Agent
Address P. O. Box N
Glennville, WV 26351
Telephone (304) 462-5781

this 14 day of March, 1984.
My commission expires April 9, 1991.

Daren S. Mardock
Notary Public, Gilmer County,
State of West Virginia

10/20/2023

I N S T R U C T I O N S T O A P P L I C A N T

CONCERNING THE LINE ITEMS:

- 1) Date of Notice.
- 2) Your well name and number.
- 3) To be filled out by the Office of Oil & Gas.
- 4) & 5) Use separate sheet if necessary.
- 4) Surface owner(s) of record to be served with Notice and Application. However, see also Code § 22-4-1b(b) if "more than three tenants in common or other co-owners of interest described in subsection (a) of this section hold interests in such lands".
- 5(i) "Coal Operator" means any person, firm, partnership, partnership association or corporation that proposes to or does operate a coal mine.
- 5(ii, iii) See Code § 22-4-20.
- 6) See Code § 22-4-11(c). However, in lieu of filing the lease(s) or other continuing contract(s), the Applicant may fill out the information in the space provided below.
- 7) See Code § § 22-4-11(d, e).

CONCERNING THE REQUIRED COPIES FOR FILING AND SERVICE:

Filing. Code § 22-4-1k and Regulation 7.02 provide that the original and required copies of the Notice and Application must be filed with the Administrator, accompanied by (i) a plat in the form prescribed by Regulation 11, (ii) a bond in one of the forms prescribed by Regulation 12, or in lieu thereof the other security allowed by Code § 22-4-1k(d) and the reclamation required by Code § 22-4-12b and Regulation 23, (iv) unless previously paid on the same well, the fees required by Code § 22-4-1a(c) and 22-3-12a, and (v) if applicable, the consent required by Code § 22-4-8a from the owner of any water well on dwelling within 200 feet of the proposed well.

Service. In addition, service must be made on the surface owner(s) and the person(s) with an interest in the coal. See Code § § 22-4-1m, 22-4-2, 22-4-2a, and 22-4-2b.

INFORMATION SUPPLIED UNDER CODE § 22-4-11(d)

IN LIEU OF FILING LEASE(S) AND OTHER CONTINUING CONTRACT(S)

Under the oath required to make the verification on the obverse side of this Notice, I depose and say that I am the person who signed the Notice for the Applicant, and that--

- (1) the tract of land is the same tract described in the Application to which this Notice applies, partly or wholly depicted in the accompanying plat, and described in the Construction and Reclamation Plan;
- (2) the parties and recordation data (if recorded) for lease(s) or other continuing contract(s) by which the Applicant claims the right to extract, produce or market the oil or gas are as follows:

<u>Grantor, lessor, etc.</u>	<u>Grantee, lessee, etc.</u>	<u>Royalty</u>	<u>Book Page</u>
Lewis M. Stout, et al	Partnership Properties Company	1/8	34/380
Partnership Properties Company	Eastern American Energy Corporation	Assess. Book	4/381



1) Date: March 19, 1984
 2) Operator's Well No. STOUT #3
 3) API Well No. 47 91
 State County Permit

**STATE OF WEST VIRGINIA
 DEPARTMENT OF MINES, OIL AND GAS DIVISION
 APPLICATION FOR A WELL WORK PERMIT**

- 4) WELL TYPE: A Oil / Gas X
 B (If "Gas", Production X / Underground storage / Deep / Shallow X)
- 5) LOCATION: Elevation: 1135' Watershed: Stout Hollow
 District: Flemington County: Taylor Quadrangle: Rosemont 7.5'
- 6) WELL OPERATOR Eastern American Energy Corp. 7) DESIGNATED AGENT Donald C. Supcoe
 Address P. O. Box N, Glenville, WV 26351 Address P. O. Box N, Glenville, WV 26351
(304) 462-5781 (304) 462-5781
- 8) OIL & GAS INSPECTOR TO BE NOTIFIED 9) DRILLING CONTRACTOR:
 Name Donald Ellis Name Unknown
 Address P. O. Box 47 Address
Belmont, WV 26134
- 10) PROPOSED WELL WORK: Drill X / Drill deeper / Redrill / Stimulate X
 Plug off old formation / Perforate new formation
 Other physical change in well (specify)
- 11) GEOLOGICAL TARGET FORMATION, 5th Sand
- 12) Estimated depth of completed well, 2800 feet
- 13) Approximate trata depths: Fresh, 90 feet; salt, None feet.
- 14) Approximate coal seam depths: 450 Is coal being mined in the area? Yes
- 15) CASING AND TUBING PROGRAM

RECEIVED
 APR 2 - 1984
 OIL & GAS DIVISION
 DEPT. OF MINES
 PACKERS

CASING OR TUBING TYPE	SPECIFICATIONS					FOOTAGE INTERVALS		CEMENT FILL-UP OR SACKS (Cubic feet)	PACKERS
	Size	Grade	Weight per ft.	New	Used	For drilling	Left in well		
Conductor	<u>13/4</u>	<u>J 55</u>	<u>65</u>		<u>X</u>	<u>25</u>	<u>-0-</u>		Kinds
Fresh water	<u>5 7/8</u>	<u>CW</u>	<u>20</u>	<u>X</u>		<u>600</u>	<u>600</u>	<u>CTS-50/50</u>	<u>02</u>
Coal									Sizes
Intermediate									
Production	<u>4 1/2</u>	<u>J 55</u>	<u>10.5</u>	<u>X</u>		<u>2750</u>	<u>2750</u>	<u>250 Ft.</u>	Depths set
Tubing									
Liners									Perforations:
									Top Bottom

The law requires a comment period for surface owners. However, the permit can be issued in less than 15 days from the filing of the Application if the surface owner(s) of record sign(s) the following "Voluntary Statement of No Objection" on a facsimile of this surface owner's copy of the Application.

VOLUNTARY STATEMENT OF NO OBJECTION

I hereby state that I have read the instructions to surface owners on the reverse side of this Application for a Well Work Permit, and that I have received copies of (1) a Notice of Application for a Well Work Permit on Form IV-2(A), (2) an Application for a Well Work Permit on Form IV-2(B), (3) a survey plat on Form IV-6, and (4) a Construction and Reclamation Plan on Form IV-9, all for proposed well work on my surface land as described therein.

I further state that I have no objection to the planned work described in these materials, and I have no objection to a permit being issued based on those materials.

(For execution by corporation, partnership, etc.) (For execution by natural persons)

NAME: Tygart East Company _____ Date: _____
 By William R. Kohl _____ (Signature)
 Its Geologist Date 3/26/84 _____ (Signature)

10/20/2023
 Surface Owner

**INSTRUCTIONS TO SURFACE OWNERS
AND
EXPLANATION OF METHODS AND TIME LIMITS TO COMMENT
ON OIL AND GAS WELL WORK PERMIT**

The well operator named in the Notice and this Application and the attached materials is applying for a permit from the State to do oil or gas well drilling or other well work. You are being served with these materials because surface owners have the right to file comments before the permit is issued. (NOTE: If the surface tract is owned by more than three persons, in multiple heirship for example, then these materials were served on you because your name appeared on the Sheriff's tax ticket on the land or because you actually occupy the surface tract. In either case, you may be the only owner who will actually receive these materials.) See Chapter 22, Article 4 of the W. Va. Code. Permits are valid for 24 months.

If you do not own any interest in the surface tract, please forward these materials to the true owner immediately if you know who it is. Also, please notify the well operator named in the materials and the Administrator of the Office of Oil and Gas in the West Virginia Department of Mines immediately.

NOTE: You are not required to file any comment at all.

Where to file comments and obtain additional information:

Administrator of the Office of Oil and Gas
West Virginia Department of Mines
1615 Washington Street East
Charleston, West Virginia 25311
(304) 348-2057

Who may file comments? If you wish to file comments, you must be an owner of record of (1) an interest in the surface tract on which the well already is or is about to be located, or (2) an interest in any other surface tract under the same oil or gas lease which will be utilized for roads or other land disturbances.

Time limits for comments. The law requires these materials to be delivered on or before the date the operator files his Application. You have **FIFTEEN (15) DAYS** after the filing date to file your comments as provided in **Methods for Filing Comments** below. You may call the Administrator's office at the above telephone number to be sure of the date. However, if you have been contacted by the well operator, and if you have signed a "voluntary statement of no objection" to any of the planned work described in these materials, then the permit may be issued at any time.

Comments must be in writing. Your comments must include your name, address and telephone number, the well operator's name and well number, and the approximate location of the proposed well site including district and county from the application. You may add other documents, such as sketches, maps or photographs to support your comments.

Methods for filing comments. Comments must be filed in person or received in the mail at the Administrator's office by the time stated above. Check with your postmaster to ensure adequate delivery time or to arrange special expedited handling.

The Administrator for Oil and Gas has the power to deny or condition a well work permit based on your comments on the following grounds:

- "(1) The proposed well work will constitute a hazard to the safety of persons; or
- "(2) The plan for soil erosion and sediment control is not adequate or effective; or
- "(3) Damage would occur to publicly owned lands or resources; or
- "(4) The proposed well work fails to protect fresh water sources or supplies."

If you want a copy of the permit as it is finally issued, or a copy of the order denying the permit, you should request a copy from the Administrator.

List of Water Testing Laboratories. The Administrator maintains a list of water testing laboratories which you can hire to test your water to establish water quality prior to and after drilling. Contact the Administrator's office or an Oil and Gas Inspector to obtain a copy of the list.



1) Date: March 19, 19 84
 2) Operator's Well No. STOUT #3
 3) API Well No. 47 91
 State County Permit

STATE OF WEST VIRGINIA
 DEPARTMENT OF MINES, OIL AND GAS DIVISION
 APPLICATION FOR A WELL WORK PERMIT

- 4) WELL TYPE: A Oil / Gas X /
 B (If "Gas", Production X / Underground storage / Deep / Shallow X /)
- 5) LOCATION: Elevation: 1135' Watershed: Stout Hollow
 District: Flemington County: Taylor Quadrangle: Rosemont 7.5'
- 6) WELL OPERATOR Eastern American Energy Corp. 7) DESIGNATED AGENT Donald C. Supcoe
 Address P. O. Box N, Glenville, WV 26351 Address P. O. Box N, Glenville, WV 26351
(304) 462-5781 (304) 462-5781
- 8) OIL & GAS INSPECTOR TO BE NOTIFIED 9) DRILLING CONTRACTOR:
 Name Donald Ellis Name Unknown
 Address P. O. Box 47 Address
Belmont, WV 26134
- 10) PROPOSED WELL WORK: Drill X / Drill deeper / Redrill / Stimulate
 Plug off old formation / Perforate new formation
 Other physical change in well (specify)
- 11) GEOLOGICAL TARGET FORMATION, 5th Sand
- 12) Estimated depth of completed well, 2800 feet
- 13) Approximate strata depths: Fresh, 90 feet; salt, None feet.
- 14) Approximate coal seam depths: 450 Is coal being mined in the area? Yes No X
- 15) CASING AND TUBING PROGRAM

RECEIVED
 APR 2 - 1984
 OIL & GAS DIVISION
 DEPT. OF MINES

CASING OR TUBING TYPE	SPECIFICATIONS					FOOTAGE INTERVALS		CEMENT FILL-UP OR SACKS (Cubic feet)	PACKERS	
	Size	Grade	Weight per ft.	New	Used	For drilling	Left in well		Kinds	Sizes
Conductor	<u>11 3/4</u>	<u>J 55</u>	<u>65</u>		<u>X</u>	<u>25</u>	<u>-0-</u>			
Fresh water	<u>8 5/8</u>	<u>CW</u>	<u>20</u>	<u>X</u>		<u>600</u>	<u>600</u>	<u>CTS-50/50</u>		<u>Poz</u>
Coal										
Intermediate										
Production	<u>4 1/2</u>	<u>J 55</u>	<u>10.5</u>	<u>X</u>		<u>2750</u>	<u>2750</u>	<u>250 Ft.</u>		<u>Depths set</u>
Tubing										
Liners										<u>Perforations:</u>
										<u>Top</u> <u>Bottom</u>

INSTRUCTIONS TO COAL OPERATOR, OWNER, OR LESSEE

The named coal operator, coal owner(s), and coal lessee are hereby notified that any objection they wish to make or are required to make by Code §22-4-3 must be filed with the Department of Mines within fifteen (15) days after the receipt of this Application by the Department.

The following waiver must be completed by the coal operator and by any coal owner or coal lessee who has recorded a declaration under Code §22-4-20, if the permit is to be issued within fifteen (15) days of the filing of the Application.

WAIVER

The undersigned coal operator / owner / lessee / of the coal under this well location has examined this proposed well location. If a mine map exists which covers the area of the well location, the well location has been added to the mine map. The undersigned has no objection to the work proposed to be done at this location, provided, the well operator has complied with all applicable requirements of the West Virginia Code and the governing regulations.

Date: March 26, 19 84
 By Hillman Coal Company
William R. Kohl
 Its Geologist

10/20/2023
 Coal Owner

DEPT. OF MINES
GAS DIVISION
RECEIVED
OCT 20 1923

10/20/2023

P 534 376 182

RECEIPT FOR CERTIFIED MAIL

NO INSURANCE COVERAGE PROVIDED
NOT FOR INTERNATIONAL MAIL

(See Reverse)

★ U.S.G.P.O. 1983-403-517

PS Form 3800, Feb. 1982

Sent to	Hillman Coal Co.
Street and No.	1900 Grant Bldg.
P.O., State and ZIP Code	Pittsburgh, PA 15219
Postage	\$.71
Certified Fee	.75
Special Delivery Fee	
Restricted Delivery Fee	
Return Receipt Showing to whom and Date Delivered	.60
Return receipt showing to whom, Date, and Address of Delivery	
TOTAL Postage and Fees	\$ 2.06
Postmark or Date	MAR 20 1984 USPO

STOUT #3 + #4

P 534 376 180

RECEIPT FOR CERTIFIED MAIL

NO INSURANCE COVERAGE PROVIDED
NOT FOR INTERNATIONAL MAIL

(See Reverse)

★ U.S.G.P.O. 1983-403-517

PS Form 3800, Feb. 1982

Sent to	Tugart East Co.
Street and No.	P.O. Box 453
P.O., State and ZIP Code	Phillippi, WV 26416
Postage	\$.71
Certified Fee	.75
Special Delivery Fee	
Restricted Delivery Fee	
Return Receipt Showing to whom and Date Delivered	.60
Return receipt showing to whom, Date, and Address of Delivery	
TOTAL Postage and Fees	\$ 2.06
Postmark or Date	MAR 20 1984 USPO

STOUT #3 + #4

PS Form 3800, Feb. 1982

★ U.S.G.P.O. 1983-403-517

Sent to	Virginia Coal Corp.
Street and No.	437 Shiloh Ave.
P.O. State and ZIP Code	Charles Town, WV 26301
Postage	\$.71
Certified Fee	.75
Special Delivery Fee	
Restricted Delivery Fee	
Return Receipt Showing to whom and Date Delivered	.60
Return receipt showing to whom, Date, and Address of Delivery	
TOTAL Postage and Fees	\$ 2.06
Postmark or Date	MAR 20 1984 USPO

RECEIPT FOR CERTIFIED MAIL
NO INSURANCE COVERAGE PROVIDED
NOT FOR INTERNATIONAL MAIL
(See Reverse)

P 534 376 181

RECEIVED
MAR 20 1984

DIVISION
DEPT. OF MINES

10/20/2023

INSPECTOR'S PERMIT SUMMARY FORM

(4-10-84)

WELL TYPE _____
ELEVATION 1135
DISTRICT Fleming
QUADRANGLE _____
COUNTY Taylor

API# 47-091-0408
OPERATOR Eastman Energy
TELEPHONE _____
FARM Tygard East
WELL # Stout 3

SURFACE OWNER _____ COMMENTS _____ TELEPHONE _____
TARGET FORMATION _____ DATE APPLICATION RECEIVED _____
DATE STARTED _____
LOCATION _____ NOTIFIED _____ DRILLING COMMENCED _____

WATER DEPTHS _____, _____, _____, _____
COAL DEPTHS _____, _____, _____, _____

CASING

Ran _____ feet of _____ "pipe on _____ with _____ fill up
Ran _____ feet of _____ "pipe on _____ with _____ fill up
Ran _____ feet of _____ "pipe on _____ with _____ fill up
Ran _____ feet of _____ "pipe on _____ with _____ fill up

RECEIVED
DEPARTMENT OF GEOLOGY
OIL AND GAS

TD _____ feet on _____

PLUGGING

MAY 21 1986

Type	From	To	Pipe Removed

Pit Discharge date: _____ Type _____

Field analysis ph _____ fe _____ cl _____

Well Record received _____

Date Released 5-15-84

Cancelled

Donald E. ...
Inspector's signature

10/20/2023

API# 47 _____ - _____

LIST ALL VISITS FOR THIS PERMIT

	DATE	TIME	PURPOSE	COMMENTS
1				
2				
3				
4				
5				
6				
7				
8				
9				
10				
11				
12				
13				
14				
15				
16				
17				
18				
19				
20				

Notes



STATE OF WEST VIRGINIA
 DEPARTMENT OF ENERGY
 DIVISION OF OIL AND GAS
 1615 Washington Street, East
 Charleston, West Virginia 25311
 Telephone: 348-3500

ARCH A. MOORE, JR.
 Governor

John Johnston
 Director

May 28, 1986

Eastern American Energy Corporation
 Post Office Box N
 Glenville, West Virginia 26351

In Re: Permit No: 47-091-0408
 Farm: Tygart East Company
 Well NO: Stout 3
 District: Flemington
 County: Taylor
 Issued: 4-10-84

Gentlemen:

The FINAL INSPECTION REPORT for the above captioned well has been received in this office. ONLY the Column checked below applies:

XXXX The well designated by the above captioned permit number has been released under your Blanket Bond.

 Please return the enclosed cancelled single bond which covered the well designated by the above captioned permit number to the surety company that executed said bond in your behalf, in order that they may give you credit on their records.

 Your well record was received and reclamation requirements approved. In accordance with Chapter 22B, Article 1, Section 26, the above captioned well will remain under bond coverage for life of the well.

XXXX PERMIT CANCELLED - NEVER DRILLED

Respectively,

Theodore M. Streit
 Deputy Director--Inspection & Enforcement

TMS/ nw

STOUT 539.00 ac. LEASE tract "A" 115.70 ac.

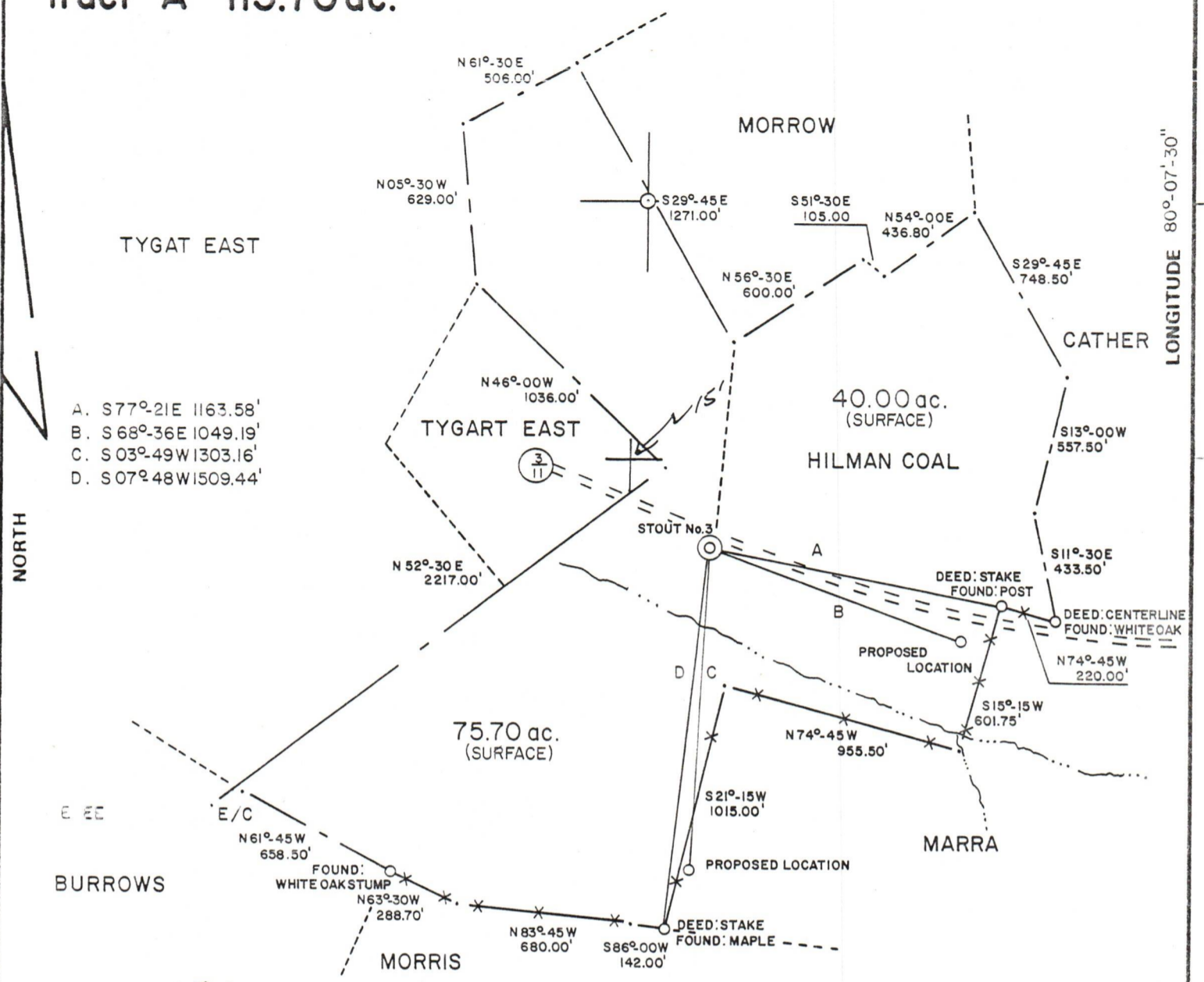

- A. S77°-21E 1163.58'
- B. S68°-36E 1049.19'
- C. S03°-49W 1303.16'
- D. S07°-48W 1509.44'

SURVEYED BY Bob F. Morris UNDER SUPERVISION OF M.H. HORNISH

FILE NO. bfn-84-08
 DRAWING NO. _____
 SCALE 1" = 600'
 MINIMUM DEGREE OF ACCURACY 1/200
 PROVEN SOURCE OF ELEVATION INTERSECTION OF COUNTY ROADS 3 & 3/11 elev. = 1072"

I THE UNDERSIGNED, HEREBY CERTIFY THAT THIS PLAT IS CORRECT TO THE BEST OF MY KNOWLEDGE AND BELIEF AND SHOWS ALL THE INFORMATION REQUIRED BY LAW AND THE REGULATIONS ISSUED AND PRESCRIBED BY THE DEPARTMENT OF MINES.
 (SIGNED) Mark H. Hornish
 R.P.E. _____ L.L.S. 763

PLACE SEAL HERE

(+) DENOTES LOCATION OF WELL ON UNITED STATES TOPOGRAPHIC MAPS
 FORM IV-6 (8-78)



DATE 3/9, 19 84
 OPERATOR'S WELL NO. STOUT No. 3
 API WELL NO. _____
47 - 091 - 0408
 STATE COUNTY PERMIT

STATE OF WEST VIRGINIA
 DEPARTMENT OF MINES
 OIL AND GAS DIVISION

Cancelled

WELL TYPE: OIL GAS LIQUID INJECTION WASTE DISPOSAL
 (IF "GAS,") PRODUCTION STORAGE DEEP SHALLOW
 LOCATION: ELEVATION 1135' WATER SHED STOUT HOLLOW
 DISTRICT FLEMINGTON COUNTY TAYLOR
 QUADRANGLE ROSEMONT 7.5"
 SURFACE OWNER TYGART EAST Co. ACREAGE 75.70
 OIL & GAS ROYALTY OWNER LLOYD A. & RUTH STOUT LEASE ACREAGE 115.70 of 539.00
 LEASE NO. _____
 PROPOSED WORK: DRILL CONVERT DRILL DEEPER REDRILL FRACTURE OR STIMULATE PLUG OFF OLD FORMATION PERFORATE NEW FORMATION OTHER PHYSICAL CHANGE IN WELL (SPECIFY) _____
 PLUG AND ABANDON CLEAN OUT AND REPLUG
 TARGET FORMATION 5th SAND ESTIMATED DEPTH 2800'
 WELL OPERATOR EASTERN AMERICAN ENERGY DESIGNATED AGENT Mr. DONALD SUPCOE
 ADDRESS P.O. BOX "N", GLENVILLE, W.Va. ADDRESS P.O. BOX "N", GLENVILLE, W.Va.

10/20/2023