

Latitude 38° 45'

Longitude 81° 25'

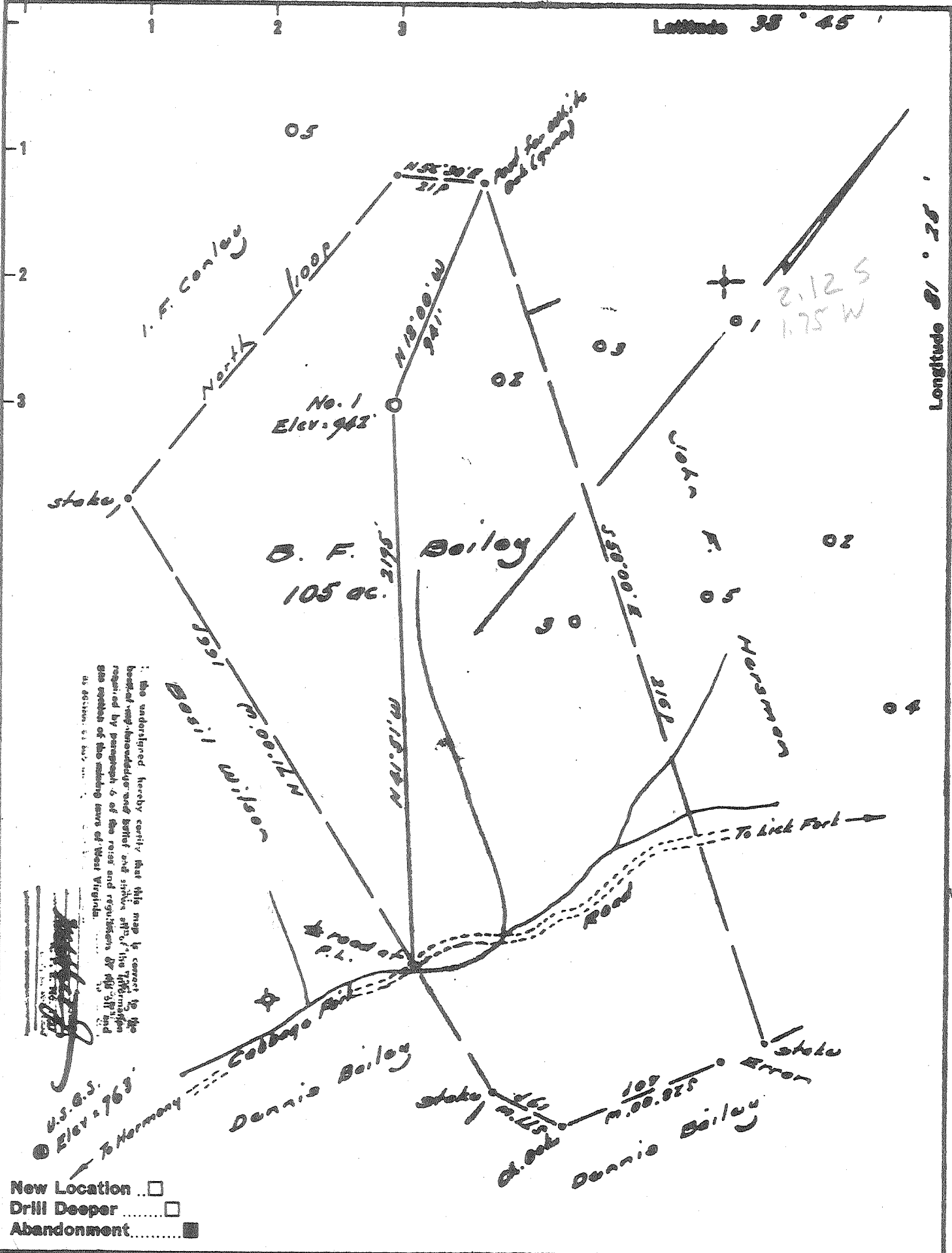

I, the undersigned hereby certify that this map is correct to the best of my knowledge and belief and under oath of the 17th day of August 1963, at the office of the State Engineer at Charleston, West Virginia.

U.S.G.S.
Elev. = 943'

- New Location
- Drill Deeper
- Abandonment

Company P & J Development Co.
 Address Hamlin, West Va.
 Farm B. F. Bailey
 Tract _____ Acres 105 Lease No. _____
 Well (Farm) No. 000 Serial No. _____
 Elevation (Spirit Level) 943'
 Quadrangle Walton
 County Roane District Harper
 Engineer W. H. [Signature]
 Engineer's Registration No. 1827
 File No. _____ Drawing No. _____
 Date Aug 16, 1963 Scale 1" = 300' = 495'

STATE OF WEST VIRGINIA
 DEPARTMENT OF MINES
 OIL AND GAS DIVISION
 CHARLESTON
see microfilm for Well Record
WELL LOCATION MAP
 FILE NO. REG-1096-A

✦ Denotes location of well on United States Topographic Maps, scale 1 to 62,500, latitude and longitude lines being represented by border lines as shown.

— Denotes one inch spaces on border line of original tracing.