

Latitude 38° 50'

Longitude 81° 30'

1565
3.765
109 W

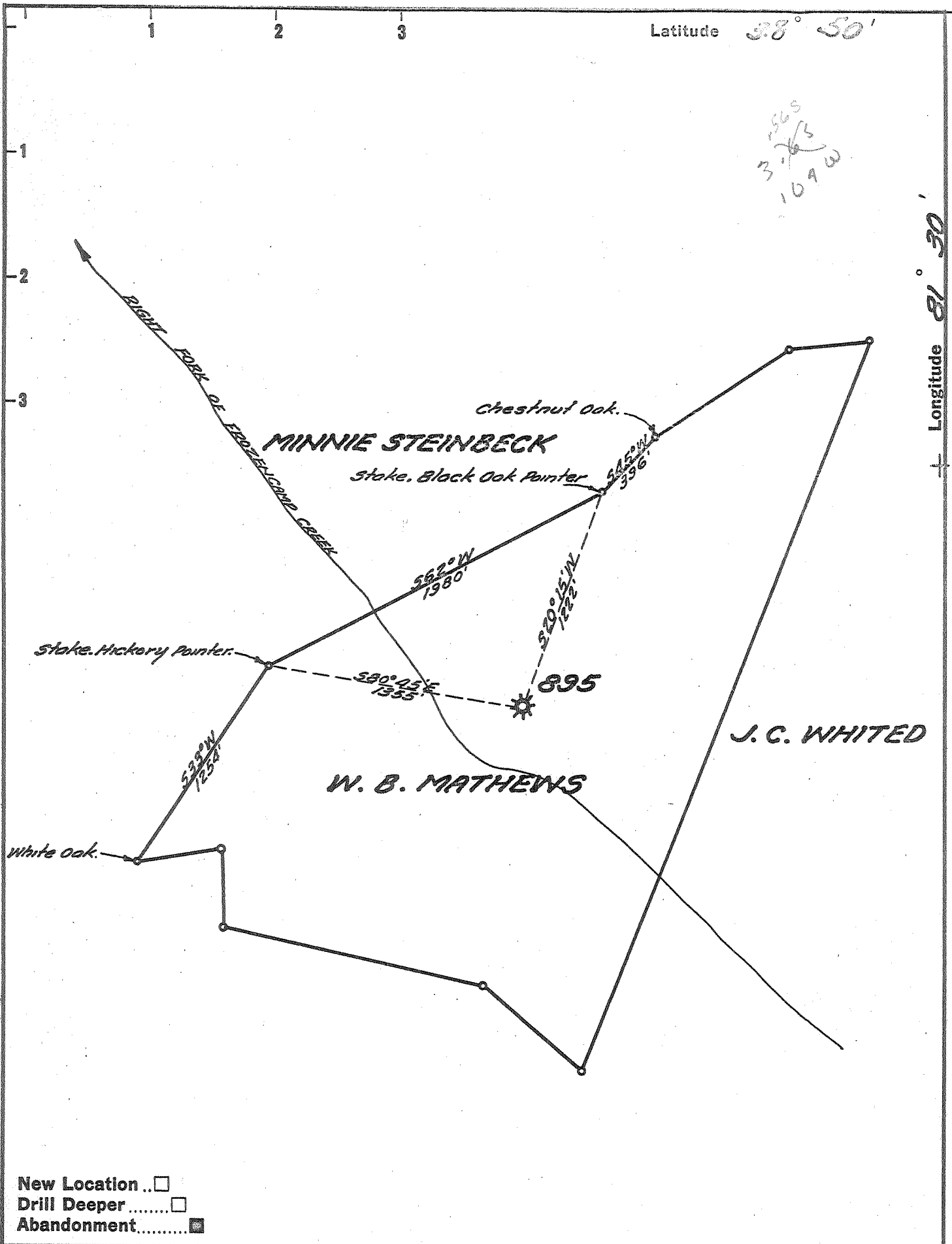

- New Location ...
- Drill Deeper
- Abandonment

Company UNITED FUEL GAS CO.
 Address CHARLESTON, W. VA.
 Farm W. B. MATHEWS
 Tract _____ Acres 196 Lease No. 11902
 Well (Farm) No. _____ Serial No. 895
 Elevation (Spirit Level) 994'
 Quadrangle RIPLEY
 County ROANE District CURTIS
 Engineer [Signature] 6
 Engineer's Registration No. 669
 File No. 68-89 Drawing No. _____
 Date 7-28-58 Scale 1" = 660'

STATE OF WEST VIRGINIA
 DEPARTMENT OF MINES
 OIL AND GAS DIVISION
 CHARLESTON

WELL LOCATION MAP
 FILE NO. ROA-1021-A

+ Denotes location of well on United States Topographic Maps, scale 1 to 62,500, latitude and longitude lines being represented by border lines as shown.

- Denotes one inch spaces on border line of original tracing.



JRW

STATE OF WEST VIRGINIA
DEPARTMENT OF MINES
OIL AND GAS DIVISION

Quadrangle Ripley

Permit No. 1071-A

WELL RECORD

Oil or Gas Well Gas
(KIND)

Company United Fuel Gas Co.
 Address P. O. Box 1273; Charleston 25, W. Va.
 Farm W. B. Mathews Acres 196
 Location (waters) Right Fork of Frozencamp Creek
 Well No. 895 Elev. 994'
 District Curtis County Roane
 The surface of tract is owned in fee by _____
 Address _____
 Mineral rights are owned by Ralph Fields, Agent
Route #1 Address Spencer, W. Va.
 Drilling commenced Feb. 16, 1917
 Drilling completed April 16, 1917
 Date Shot _____ From _____ To _____
 With _____
 Open Flow 57/10ths Water in 6-5/8 Inch
 _____/10ths Merc. in _____ Inch
 Volume 3,700,000 Cu. Ft.
 Rock Pressure 605 lbs. _____ hrs.
 Oil _____ bbls., 1st 24 hrs.
 WELL ACIDIZED _____
 WELL FRACTURED _____

Casing and Tubing	Used in Drilling	Left in Well	Packers
16 Conductor		16	Kind of Packer _____
13 _____			<u>Callanan</u>
10 _____	<u>720'</u>	<u>Pulled</u>	Size of _____
8 1/4 _____	<u>1110</u>		<u>5 3/16" x 3"</u>
6 5/8 _____		<u>2010</u>	Depth set _____
5 3/16 _____			<u>378'</u>
3 _____		<u>2562</u>	Perf. top _____
2 _____			Perf. bottom _____
Liners Used _____			Perf. top _____
			Perf. bottom _____

CASING CEMENTED _____ SIZE _____ No. Ft. _____ Date _____
 COAL WAS ENCOUNTERED AT _____ FEET _____ INCHES
 _____ FEET _____ INCHES _____ FEET _____ INCHES
 _____ FEET _____ INCHES _____ FEET _____ INCHES

RESULT AFTER TREATMENT _____

ROCK PRESSURE AFTER TREATMENT _____

Fresh Water _____ Feet _____ Salt Water _____ Feet _____

Formation	Color	Hard or Soft	Top	Bottom	Oil, Gas or Water	Depth	Remarks
Pittsburgh Sand			500	600	S. L. Measurement of 6-5/8" Casing, top Big Lime, top Berea and total depth. 6-5/8" B. H. Packer on bottom of 6-5/8" Casing. Hole reduced to 5" at 2109'		
2nd Pittsburgh Sand			665	695			
Little Dunkard			965	1015			
2nd "			1105	1185			
Gas Sand			1275	1380			
Salt Sand			1660	2002			
Big Lime			2002	2080			
Big Injun Sand			2080	2090			
Berea Sand			2505	2519			
Gas			2512				
Total Depth			2521'				

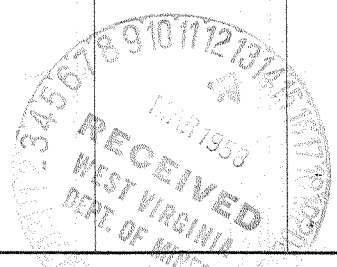

(over)

DEC 20 1958

